

CERTIFICATE OF DISPOSITION OF MATERIALS

Br.4

Estimated burden per response to comply with this mandatory collection request: 30 minutes. This submittal is used by NRC as part of the basis for its determination that the facility is released for unrestricted use. Send comments regarding burden estimate to the Records and FOIA/Privacy Services Branch (T-5 F52), U.S. Nuclear Regulatory Commission, Washington, DC 20555-0001, or by internet e-mail to infocollect@nrc.gov, and to the Desk Officer, Office of Information and Regulatory Affairs, NE08-10202, (3150-0028), Office of Management and Budget, Washington, DC 20503. If a means used to impose an information collection does not display a currently valid OMB control number, the NRC may not conduct or sponsor, and a person is not required to respond to, the information collection.

LICENSEE NAME AND ADDRESS

The Radiology Institute Imaging Center
Clinica Las Americas, Suite 202 + 108
400 F.D. Roosevelt Avenue
Hato Rey, PR 00918-2129

LICENSE NUMBER

52-24969-01

DOCKET NUMBER

03030394

LICENSE EXPIRATION DATE

June 4, 2012

- A. LICENSE STATUS (Check the appropriate box)
- This license has expired. This license has not yet expired; please terminate it.

B. DISPOSAL OF RADIOACTIVE MATERIAL

(Check the appropriate boxes and complete as necessary. If additional space is needed, provide attachments)

The licensee, or any individual executing this certificate on behalf of the licensee, certifies that:

1. No radioactive materials have ever been procured or possessed by the licensee under this license.
2. All activities authorized by this license have ceased, and all radioactive materials procured and/or possessed by the licensee under this license number cited above have been disposed of in the following manner.
- a. Transfer of radioactive materials to the licensee listed below:
7-sources to NRC License # 52-25430-03
- b. Disposal of radioactive materials:
1. Directly by the licensee:
2. By licensed disposal site:
3. By waste contractor:
23-sources to NRC License # 24-20091-01
- c. All radioactive materials have been removed such that any remaining residual radioactivity is within the limits of 10 CFR Part 20, Subpart E, and is ALARA.

C. SURVEYS PERFORMED AND REPORTED

1. A radiation survey was conducted by the licensee. The survey confirms:
- a. the absence of licensed radioactive materials
- b. that any remaining residual radioactivity is within the limits of 10 CFR 20, Subpart E, and is ALARA.
2. A copy of the radiation survey results:
- a. is attached; or b. is not attached (Provide explanation); c. was forwarded to NRC on: _____ Date
3. A radiation survey is not required as only sealed sources were ever possessed under this license, and
- a. The results of the latest leak test are attached; and/or b. No leaking sources have ever been identified.

The person to be contacted regarding the information provided on this form:

NAME	TITLE	TELEPHONE (Include Area Code)	E-MAIL ADDRESS
David Rhoe	Consultant	787-245-7248	ccmidnrc@aol.com

Mail all future correspondence regarding this license to

C. CERTIFYING OFFICIAL
I CERTIFY UNDER PENALTY OF PERJURY THAT THE FOREGOING IS TRUE AND CORRECT

PRINTED NAME AND TITLE	SIGNATURE	DATE
Luis E. Bonnet-Aleman, M.D.	<i>[Signature]</i>	March 22, 2012

WARNING: FALSE STATEMENTS IN THIS CERTIFICATE MAY BE SUBJECT TO CIVIL AND/OR CRIMINAL PENALTIES. NRC REGULATIONS REQUIRE THAT SUBMISSIONS TO THE NRC BE COMPLETE AND ACCURATE IN ALL MATERIAL RESPECT. 18 U.S.C. SECTION 1001 MAKES IT A CRIMINAL OFFENSE TO MAKE A WILLFULLY FALSE STATEMENT OR REPRESENTATION TO ANY DEPARTMENT OR AGENCY OF THE UNITED STATES AS TO ANY MATTER WITHIN ITS JURISDICTION.

577225
UNRESTRICTED MATERIALS

RADIATION SAFETY CLOSE OUT SURVEY

Date: March 21, 2012

Surveyor: David Rhoe

Facility: The Radiology Institute Imaging Center

Isotopes: Nuclear Medicine Lab/PET Tc-99m, Tl-201, Ga-67, etc

Room: 1st Floor - Nuclear Medicine Department

- A. PET/CT room
 - 1. PET/CT table
 - 2. Door handle
 - 3. Floor doorway
- B. Injection room
 - 4. Door handle
 - 5. Floor doorway & floor
- C. Injection room
 - 6. Door handle
 - 7. Floor doorway & floor
- D. Hot Lab
 - 8. Hot lab steel table
 - 9. Hot Lab cabinet
 - 10. Hot Lab floor
 - 11. Door handle
 - 12. Hot Lab doorways
 - 13. Door handles
- E. Unfinished bathroom
Never used
- F. Injection room
 - 14. Door handle
 - 15. Floor doorway & floor
- G. Injection room
 - 16. Door handle
 - 17. Floor doorway & floor
- H. Unfinished bathroom
Never used
- I. Storage room

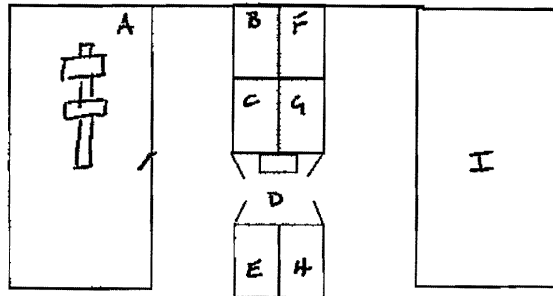

Determination of external radiation levels

Make: ludlum Model: 14C end window Serial No.: 114721

<input checked="" type="checkbox"/>	Gm	<input checked="" type="checkbox"/>	Background
<input type="checkbox"/>	NaI	<input type="checkbox"/>	As Indicated
<input type="checkbox"/>	Other		

Determination of removable surface contamination

Make: Beckman Model: Gamma 5500 Serial No.: 8044788

Make: LSC-2V Model: V2 Serial No.: 002

None Found (<2200 dpm/100 cm²)

As Indicated

No Isotopes used during the past two years

Comments: Check source reading 0.8 mR/hr - OK

RADIATION SAFETY CLOSE OUT SURVEY

Date: March 21, 2012

Surveyor: David Rhee

Facility: The Radiology Institute Imaging Center

Isotopes: Nuclear Medicine Lab/PET Tc-99m, Tl-201, Ga-67, etc

Room: 2nd Floor Nuclear Medicine Department

- J. Spect camera 1
 - 18. Door handle
 - 19. Floor doorway
 - 20. Spect table
 - 21. Floor room
 - 22. PC keyboard
- K. Thyroid uptake system
 - 23. PC keyboard
 - 24. Well counter
- L. Spect camera 2
 - 25. Table
 - 26. Floor room
 - 27. PC keyboard
- M. Hot Lab injection room
 - 28. Door handle
 - 29. Floor doorway
- N. Hot Lab Bathroom
 - 30. Door handle
 - 31. Floor doorway
 - 32. Toilet & floor
- O. Hot Lab
 - 33. Counter top
 - 34. Counter top & sink
 - 35. Door handle
 - 36. Floor doorwar and room
- P. Hot Lab injection area
 - 37. Floor area
- Q. Hallway
 - 38. Floor area

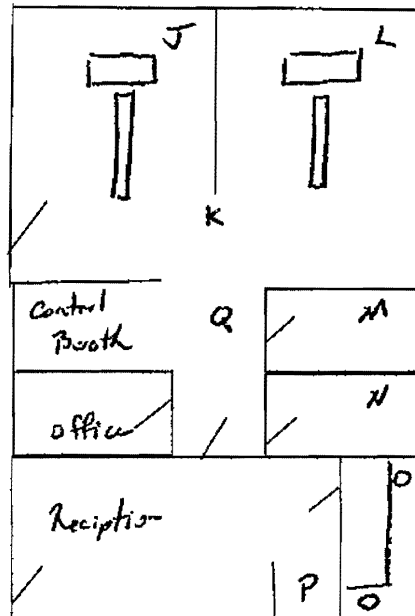

Determination of external radiation levels

Make: ludlum Model: 14C end window Serial No.: 114721

- | | | | |
|-------------------------------------|-------|-------------------------------------|--------------|
| <input checked="" type="checkbox"/> | Gm | <input checked="" type="checkbox"/> | Background |
| <input type="checkbox"/> | NaI | <input type="checkbox"/> | As Indicated |
| <input type="checkbox"/> | Other | | |

Determination of removable surface contamination

- Make: Beckman Model: Gamma 5500 Serial No.: 8044788
- Make: LSC-2V Model: V2 Serial No.: 002
- None Found (<2200 dpm/100 cm²)
- As Indicated
- No Isotopes used during the past two years

Comments: Check source reading 0.8 mR/hr - OK

RADIATION SAFETY CLOSE OUT SURVEY

Date: March 21, 2012

Surveyor: David Rhoe

Facility: The Radiology Institute Imaging Center

Isotopes: Nuclear Medicine Lab/PET Tc-99m, Tl-201, Ga-67, etc

Room: 2nd Floor Stress Room

- 39. Treadmill, Belt and handles
- 40. Table top
- 41. Sink
- 42. Floor beside treadmill
- 43. Door handle - both
- 44. Floor doorway - both

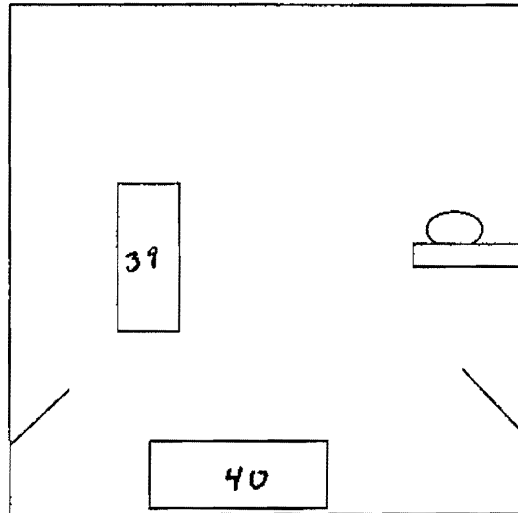

Determination of external radiation levels

Make: ludlum Model: 14C end window Serial No.: 114721

- | | |
|-------------------------|--------------------------------|
| <u> X </u> Gm | <u> X </u> Background |
| <u> </u> NaI | <u> </u> As Indicated |
| <u> </u> Other | |

Determination of removable surface contamination

- X Make: Beckman Model: Gamma 5500 Serial No.: 8044788
 Make: LSC-2V Model: V2 Serial No.: 002
 X None Found (<2200 dpm/100 cm²)
 As Indicated
 X No Isotopes used during the past two years

Comments: Check source reading 0.8 mR/hr - OK

RADIATION SAFETY CLOSE OUT SURVEY

Date: March 21, 2012

Surveyor: David Rhoe

Facility: The Radiology Institute Imaging Center

Isotopes: Nuclear Medicine Lab/PET Tc-99m, Tl-201, Ga-67, etc

Room: 2nd Floor Office besides the MD office

- 45. Door handle - both
- 46. Floor doorway - both
- 47. Desk
- 48. Floor room

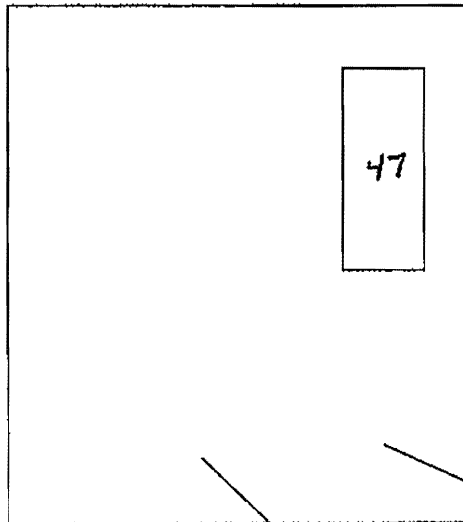

Determination of external radiation levels

Make: ludlum Model: 14C end window Serial No.: 114721

<input checked="" type="checkbox"/>	Gm	<input checked="" type="checkbox"/>	Background
<input type="checkbox"/>	NaI	<input type="checkbox"/>	As Indicated
<input type="checkbox"/>	Other		

Determination of removable surface contamination

Make: Beckman Model: Gamma 5500 Serial No.: 8044788

Make: LSC-2V Model: V2 Serial No.: 002

None Found (<2200 dpm/100 cm²)

As Indicated

No Isotopes used during the past two years

Comments: Check source reading 0.8 mR/hr - OK

RADIATION SAFETY CLOSE OUT SURVEY

Date: March 21, 2012

Surveyor: David Rhoe

Facility: The Radiology Institute Imaging Center

Isotopes: Nuclear Medicine Lab/PET Tc-99m, Tl-201, Ga-67, etc

Room: 2nd Floor - Sonograph room

- 49. Door handle
- 50. Floor - doorway
- 51. Counter top
- 52. Patient table
- 53. Room floor
- 54. Bathroom floor & toilet
- 55. Bkg
- 56. Cs-137 Std
- 57. Am-241 Std

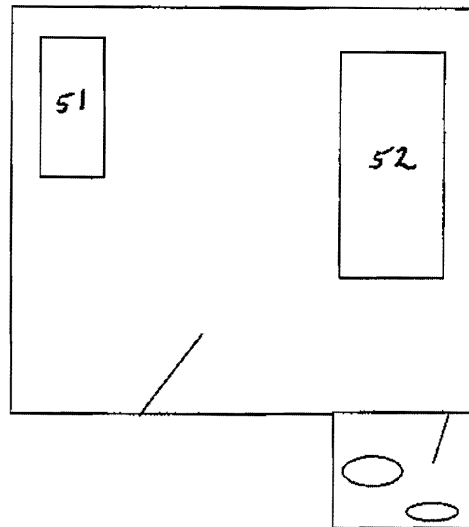

Determination of external radiation levels

Make: ludlum Model: 14C end window Serial No.: 114721

<input checked="" type="checkbox"/>	Gm	<input checked="" type="checkbox"/>	Background
<input type="checkbox"/>	NaI	<input type="checkbox"/>	As Indicated
<input type="checkbox"/>	Other		

Determination of removable surface contamination

Make: Beckman Model: Gamma 5500 Serial No.: 8044788

Make: LSC-2V Model: V2 Serial No.: 002

None Found (<2200 dpm/100 cm²)

As Indicated

No Isotopes used during the past two years

Comments: Check source reading 0.8 mR/hr - OK

Wipe #	CPM
1	63
2	63
3	64
4	72
5	71
6	82
7	96
8	81
9	67
10	76
11	74
12	69
13	92
14	64
15	68
16	90
17	83
18	70
19	67
20	73
21	68
22	87
23	82
24	69
25	85
26	95
27	101
28	69
29	84
30	94

Wipe #	CPM
31	77
32	74
33	72
34	76
35	88
36	70
37	81
38	86
39	80
40	73
41	63
42	56
43	65
44	80
45	91
46	85
47	82
48	68
49	88
50	74
51	80
52	72
53	85
54	102
Background	85
Cs-137 Std	35230
Am-241 Std	139968

All of the above readings are less than twice background.
Efficiency is 25.9%

Leak Test Record
NRC License 52-25430-01

Leak Tested For: Clinic Las Americas
Leak Tested By: David Rhoe

Standard Source: Cs-137 NES-139S
Standard Activity: 0.105 uCi Nominally
Date of Standard: 9-Sep-88

Date of Leak Test: 28-Feb-12
Decay Activity: 0.06105 From decay chart
Standard (dpm): 135531

Instrument: Gamma
Instrument Model Number: Beckman
Instrument Serial Number: 5500
8044788

Standard (cpm) 34885
Efficiency: 0.25739 25.7 %
Counting time (minutes) 1
Background (cpm) 84
Minimum Detectable Activity: 2.268E-05

Wipe (Smear) Test: All external or accessible surfaces of the source or housing are wiped with a piece of filter paper or other absorbent material which has been moistened with an appropriate solvent and the activity removed is measured.

Source ID and Serial Number	Gamma	
	Wipe Test	Sample Activity
Cs-137 s356009-36 .209 uCi 9-19-88	91	0.00016
Ba-133 s358005-001 .273 uCi 9-22-88	84	0.00015
Co-57 MED3550 5.783 mCi 8-1-04	92	0.00016
Cs-137 1360-3-11 182.7uCi 4-1-09	84	0.00015
Na-22 Sn1245-77-31 thru 36 (10 uCi x 6) 9-1-07	84	0.00015
Na-22 E4-818-1245-82 100 uCi 9-1-07	66	0.00012
Au-195 8030-004 30 uCi 5-1-89	77	0.00013
Co-57 Nes 206 SnA-2360 5.496 mCi 7-1-94	110	0.00019
Co-57 Nes 206032-090 5.0 mCi 11-17-88	92	0.00016
Eu-152 500 nCi 3-1-04	88	0.00015
Eu-152 500 nCi 11-1-98	88	0.00015
Cs-137 500 nCi 4-1-04	88	0.00015
Cs-137 500 nCi 5-1-98	88	0.00015
Cs-137 500 nCi 4-1-09	88	0.00015
Cs-137 587-63-2 0.5 uCi 5-1-98	104	0.00018
Cs-137 790-93-75 0.5 uCi 4-1-04	104	0.00018
Gd-153 A7-310 and A7-312 (250 mCi x 2) 9-1-02	246	0.00043
Gd-153 D5-739 and D4-476 (250 mCi x 2) 8-1-06	246	0.00043
Gd-153 B9-673 and B9-674 (250 mCi x 2) 10-1-04	246	0.00043
Gd-153 5697 and 5690 (250 mCi x 2) 3-1-01	246	0.00043
Moly column	102	0.00018

This test reveals that 0.005 microcuries or less was present as removable contamination. Should the removable contamination exceed 0.005 microcuries, the source must be removed from use and necessary measures taken according to NRC regulations.

David Rhoe Health/Medical Physicist

This is to acknowledge the receipt of your letter/application dated

3/22/2012, and to inform you that the initial processing which includes an administrative review has been performed.

Termination (52-24969-01)
There were no administrative omissions. Your application was assigned to a technical reviewer. Please note that the technical review may identify additional omissions or require additional information.

Please provide to this office within 30 days of your receipt of this card

A copy of your action has been forwarded to our License Fee & Accounts Receivable Branch, who will contact you separately if there is a fee issue involved.

Your action has been assigned **Mail Control Number** 577225.
When calling to inquire about this action, please refer to this control number.
You may call us on (610) 337-5398, or 337-5260.