

\\PENNONI\PROJECTS\2010\2010-2011\Bell Bend Land Development\EROSION\CS8131.dwg
 Date: 9/15/11
 User: jfm

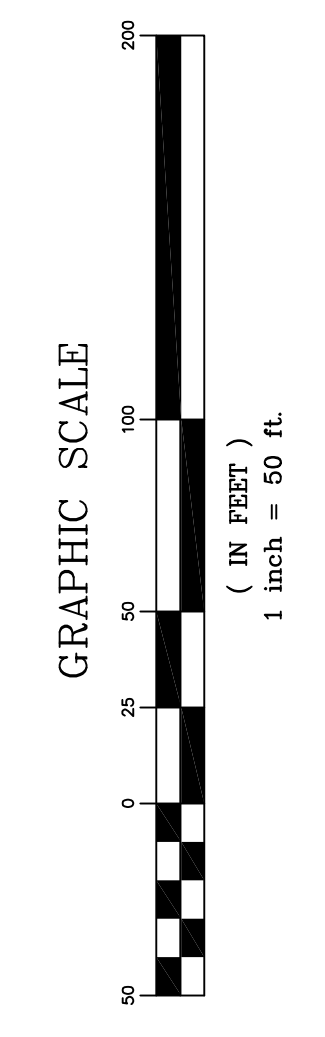
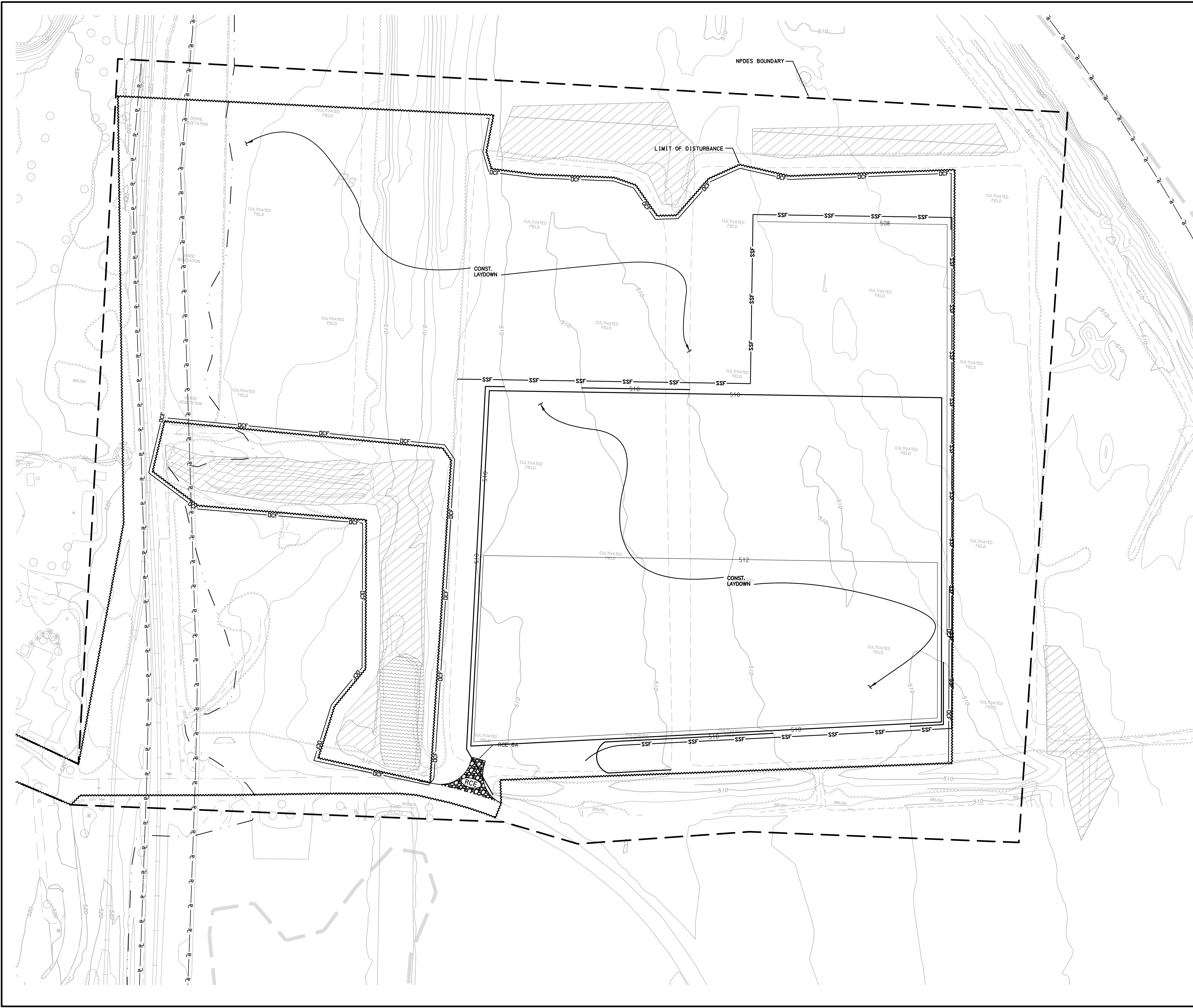

Pennoni Associates Inc.

Engineers • Surveyors • Planners • Landscape Architects

SCALE	1" = 50'
DRAWN BY	MLF
DATE	9/15/2011
APPROVED	JFM
JOB NO.	PPLS0902
SHEET	49 OF 75
DRAWING NO.	CS8131

BELL BEND NUCLEAR POWER PLANT
 EROSION AND SEDIMENTATION CONTROL PLANS
 PPL BELL BEND, LLC
 38 BOMBAY LANE, SUITE 2
 BERWICK, PA 19803

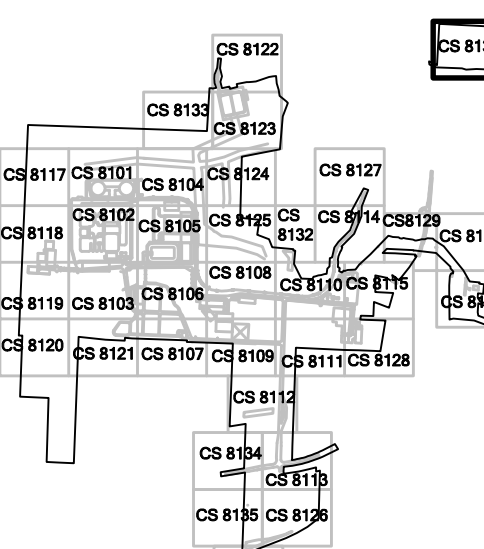

ALL DIMENSIONS MUST BE VERIFIED BY CONTRACTOR
 DIMENSIONS MUST BE VERIFIED BY FIELD
 DIMENSIONS BEFORE PROCEEDING WITH THE WORK

DATE	NO.	REVISIONS	BY
9/15/11	1	EXCESS EARTHWORK REDUCTION AND L&D COMMENTS	DFC
11/12/10	0	INITIAL SUBMISSION	DFC



100 N. Wilkes-Barre Boulevard
 Wilkes-Barre, PA 18702 (570) 824-2200

SALEM TOWNSHIP, PENNSYLVANIA
 PPL BELL BEND, LLC
 38 BOMBAY LANE, SUITE 2
 BERWICK, PA 19803

ALL DOCUMENTS PREPARED BY PENNONI ASSOCIATES ARE INSTRUMENTED BY ENGINEER IN RECORD OF THE PROJECT. THEY ARE NOT INTENDED OR REPRESENTED TO BE SUITABLE FOR REUSE BY OWNER OR OTHERS OR EXTENSIONS OF THE PROJECT OR ON ANY OTHER PROJECT. ANY REUSE WITHOUT WRITTEN APPROVAL OR PERMISSION BY PENNONI ASSOCIATES FOR THE SPECIFIC PURPOSE INTENDED WILL BE AT USER'S SOLE RISK AND WITHOUT LIABILITY OR LEGAL EXPOSURE TO PENNONI ASSOCIATES; AND OWNER SHALL INDEMNIFY AND HOLD HARMLESS PENNONI ASSOCIATES FROM ALL CLAIMS, DAMAGES, LOSSES AND EXPENSES ARISING OUT OF OR RESULTING THEREFROM.