

SEE SHEET CS8118

SEE SHEET CS8101

SEE SHEET CS8103

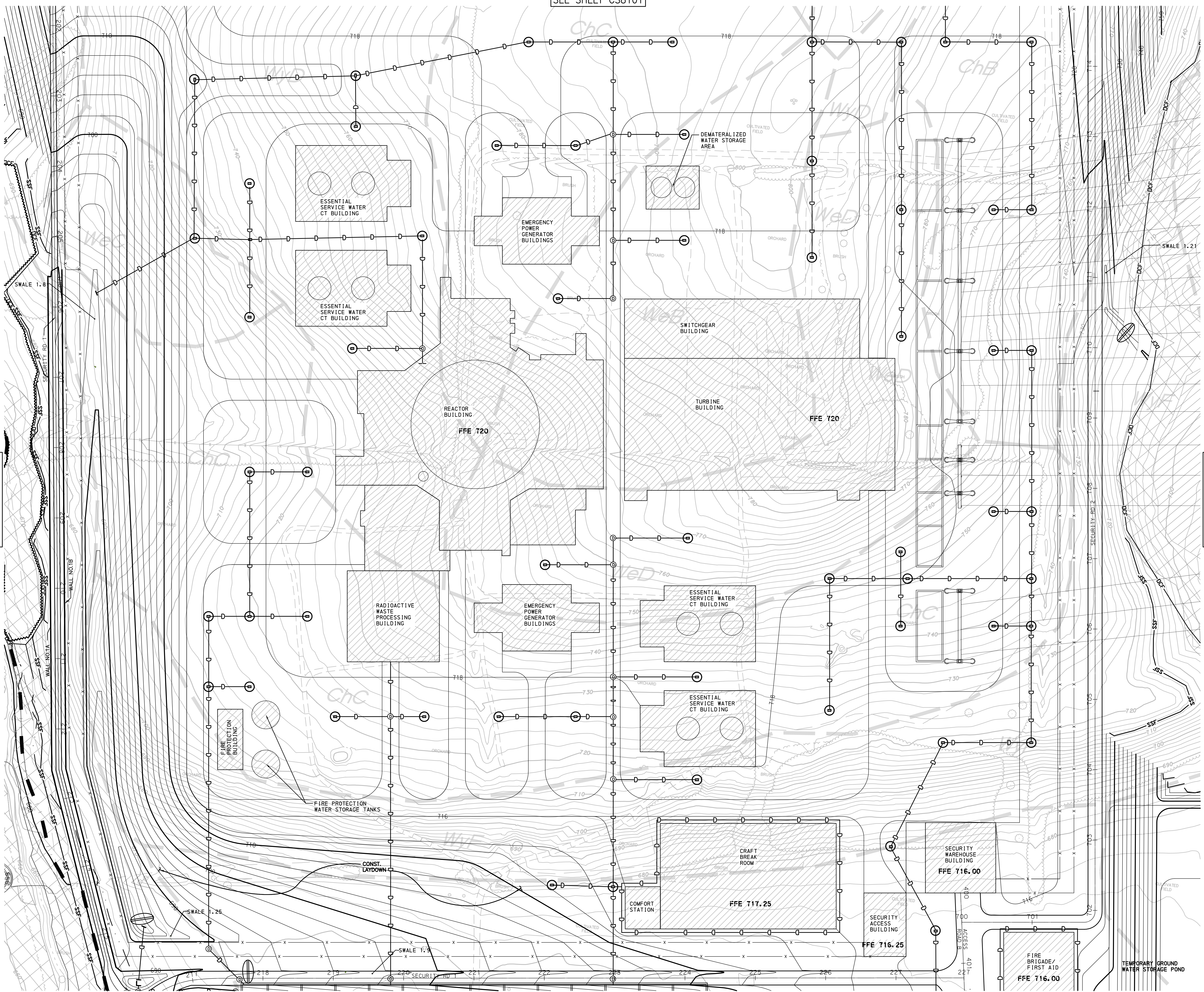

SEE SHEET CS8105

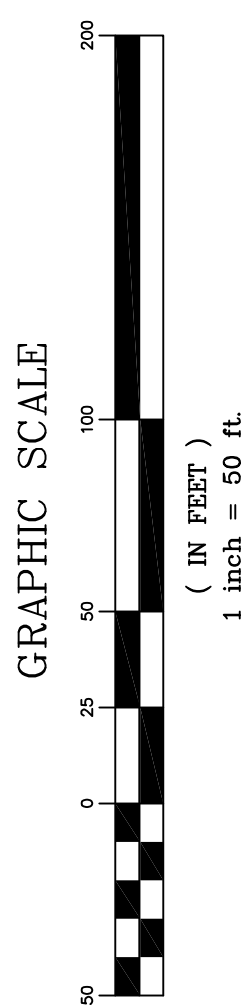

PROJECT: PPL0902 - BELL BEND NUCLEAR POWER PLANT DEVELOPMENT (VERSION: CS8102A) 9/15/2011
 DRAWN BY: MLF
 DATE: 9/15/2011
 APPROVED: JFM

Pennoni Associates Inc.
 Engineers • Surveyors • Planners • Landscape Architects

SCALE	DRAWING NO.
1"=50'	CS 8102A
DRAWN BY	
MLF	
DATE	
9/15/2011	
APPROVED	
JFM	

JOB NO.	
PPL0902	
SHEET	7 OF 75

ALL DOCUMENTS PREPARED BY PENNONI ASSOCIATES ARE INSTRUMENTED BY LICENSED SURVEYORS IN RESPECT OF THE PROJECT. THEY ARE NOT INTENDED OR REPRESENTED TO BE SUITABLE FOR REUSE BY OTHERS OR FOR EXTENSIONS OF THE PROJECT OR ON ANY OTHER PROJECT. ANY REUSE WITHOUT WRITTEN PERMISSION OR AGREEMENT BY PENNONI ASSOCIATES FOR THE SPECIFIC PURPOSE INTENDED WILL BE AT USER'S SOLE RISK AND WITHOUT LIABILITY OR LEGAL EXPOSURE TO PENNONI ASSOCIATES. AND OWNER SHALL INDEMNIFY AND HOLD HARMLESS PENNONI ASSOCIATES FROM ALL CLAIMS, DAMAGES, LOSSES AND EXPENSES ARISING OUT OF OR RESULTING THEREFROM.

BELL BEND NUCLEAR POWER PLANT
 EROSION AND SEDIMENTATION CONTROL PLANS
 PERMANENT FEATURES
PPL BELL BEND, LLC
 38 BOMBAY AVE, SUITE 2
 BETHLEHEM, PA 18020

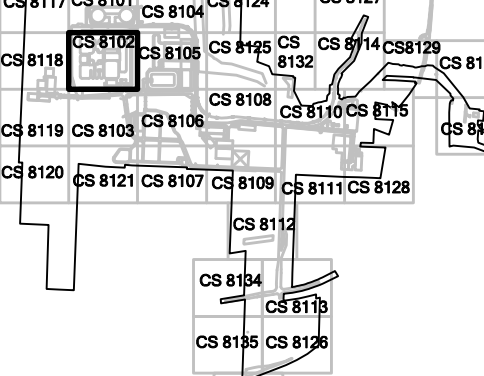

100 N. Wilkes-Barre Boulevard
 Wilkes-Barre, PA 18702 (570) 824-2200

ALL DIMENSIONS MUST BE VERIFIED BY CONTRACTOR AND OWNER. ANY DIMENSIONS NOT SHOWN MUST BE OBTAINED FROM THE WORK. DISCREPANCIES BEFORE PROCEEDING WITH THE WORK.

DATE	NO.	REVISIONS	BY
9/15/11	1	EXCESS EARTHWORK REDUCTIONS AND L2D COMMENTS	DFC
11/12/10	0	INITIAL SUBMISSION	DFC

