



**OCTOBER 6, 2011**

United States Nuclear Regulatory Commission  
Region III, Materials Licensing  
2443 Warrenville Road, Suite 210  
Lisle, IL 60532-4352

**RE: Amendment to NRC License No. 21-16754-01**

Dear Sir/Madam:

The purpose of this letter is to amend our current NRC license to reflect the following changes.

**Item #1**

Please remove the following location of use from our license:

**Home Clinic, PC  
4040 South Linden Rd.  
Flint, MI 48507**

A close-out survey was performed on September 2, 2011 of the above address and is enclosed for your review.

The last date of receipt and use of radioactive material at this site was August 10, 2011. A current copy of the leak test results for the sealed sources used at our facility is enclosed for your review. Sealed sources and radioactive waste were removed from our department for transfer to the Lake Diagnostics, 3550 Pontiac Lake Rd, Waterford, MI location listed on our NRC license prior to performing the close-out survey.

Thank you for your cooperation. If you have any questions or require additional information, please contact our physics consultant, Sharon Updike at 734-662-3197.

Respectfully Yours,

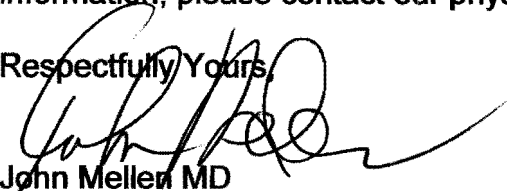
  
John Mellen MD  
Executive Management  
Radiology Associates, PC

RECEIVED OCT 12 2011

## Close-out Survey

**Date performed:** 09/02/11

**Performed by:** Van Williams, CNMT

**Comments:** Sealed sources and radioactive waste were removed from our department for transfer to the the Lake Diagnostics, 3550 Pontiac Lake Rd, Waterford, MI location listed on our NRC license prior to performing the close-out survey.

### **Instruments**

Wipe tests analyzed with a Capintec Well Counter  
s/n :171411

Radionuclide: Cobalt-57 MDA for C0-57: 196 dpm

Date Efficiency performed: 07/15/11 Conversion factor: 1.15 dpm / cpm

Area survey performed with the following survey meter:

Manufacturer: Ludlum

Type: GM

Model Number: 14C

Serial Number: 221641

Probe Model: 44-7

Annual Calibration Due: 08/03/12

Battery check acceptable: YES

Operational check acceptable: YES

Current reading: 0.85 mR/hr

### **Radionuclides Used**

#### **Unsealed**

Tc99m

#### **Sealed**

Co-57, Ba-133, Cs-137

**Last date of byproduct radiopharmaceutical use:** 03/19/10

**Visual Check:** The area was checked to ensure that all sealed sources and radioactive waste had been removed. No evidence of radioactive material was noted.

**Sealed Source Leak Testing:** No history of leaks from Sealed Sources.

**Radiation Level Survey:** No area within the department demonstrated radiation levels in excess of 0.02 mR/hr.

**Removable Contamination:** No area within the department demonstrated removable contamination in excess of 0 dpm's.

***Hot Lab, Stress and Imaging Areas***

See Diagram Attachment

**Conclusion:** No radioactive materials remain in this area. No removable contamination is present.

**CLOSEOUT SURVEY RESULTS**

Date: 9/2/2011

Performed By: Van Williams

	AREA	net cpm	net dpm	mR/h
1	Hot Lab	0 cpm	0 dpm	0.02
2	Hot Lab	0 cpm	0 dpm	0.02
3	Hot Lab	0 cpm	0 dpm	0.02
4	Hot Lab	0 cpm	0 dpm	0.02
5	Hot Lab	0 cpm	0 dpm	0.02
6	Imaging Area	0 cpm	0 dpm	0.02
7	Imaging Area	0 cpm	0 dpm	0.02
8	Imaging Area	0 cpm	0 dpm	0.02
9	Imaging Area	0 cpm	0 dpm	0.02
10	Imaging Area	0 cpm	0 dpm	0.02
11	Imaging Area	0 cpm	0 dpm	0.02
12	Imaging Area	0 cpm	0 dpm	0.02
13	Imaging Area	0 cpm	0 dpm	0.02
14	Imaging Area	0 cpm	0 dpm	0.02
15	Imaging Area	0 cpm	0 dpm	0.02
16	Imaging Area	0 cpm	0 dpm	0.02
17	Imaging Area	0 cpm	0 dpm	0.02
18	Imaging Area	0 cpm	0 dpm	0.02
19	Stress Room	0 cpm	0 dpm	0.02
20	Stress Room	0 cpm	0 dpm	0.02
21	Stress Room	0 cpm	0 dpm	0.02
22	Stress Room	0 cpm	0 dpm	0.02
23	Stress Room	0 cpm	0 dpm	0.02
24	Stress Room	0 cpm	0 dpm	0.02
25	Stress Room	0 cpm	0 dpm	0.02
26	Stress Room	0 cpm	0 dpm	0.02
27	Stress Room	0 cpm	0 dpm	0.02
28	Stress Room	0 cpm	0 dpm	0.02
29	Stress Room	0 cpm	0 dpm	0.02
30	Stress Room	0 cpm	0 dpm	0.02
31	Stress Room	0 cpm	0 dpm	0.02
32				
33				
34				
35				
36				
37				
38				
39				
40				
41				
42				

**ACTION LEVELS: 2000 dpm**

**< 0.2 mR/hr**

**COMMENTS: No evidence of removable contamination.**

Home Clinic, PC  
 4040 South Linden Rd.  
 Flint, MI



Attachment 9.1 - Facility Diagram

Area 1 - Package Receipt  
 Area 2 - Dose Preparation  
 Area 3 - RAM Waste Storage

Outside

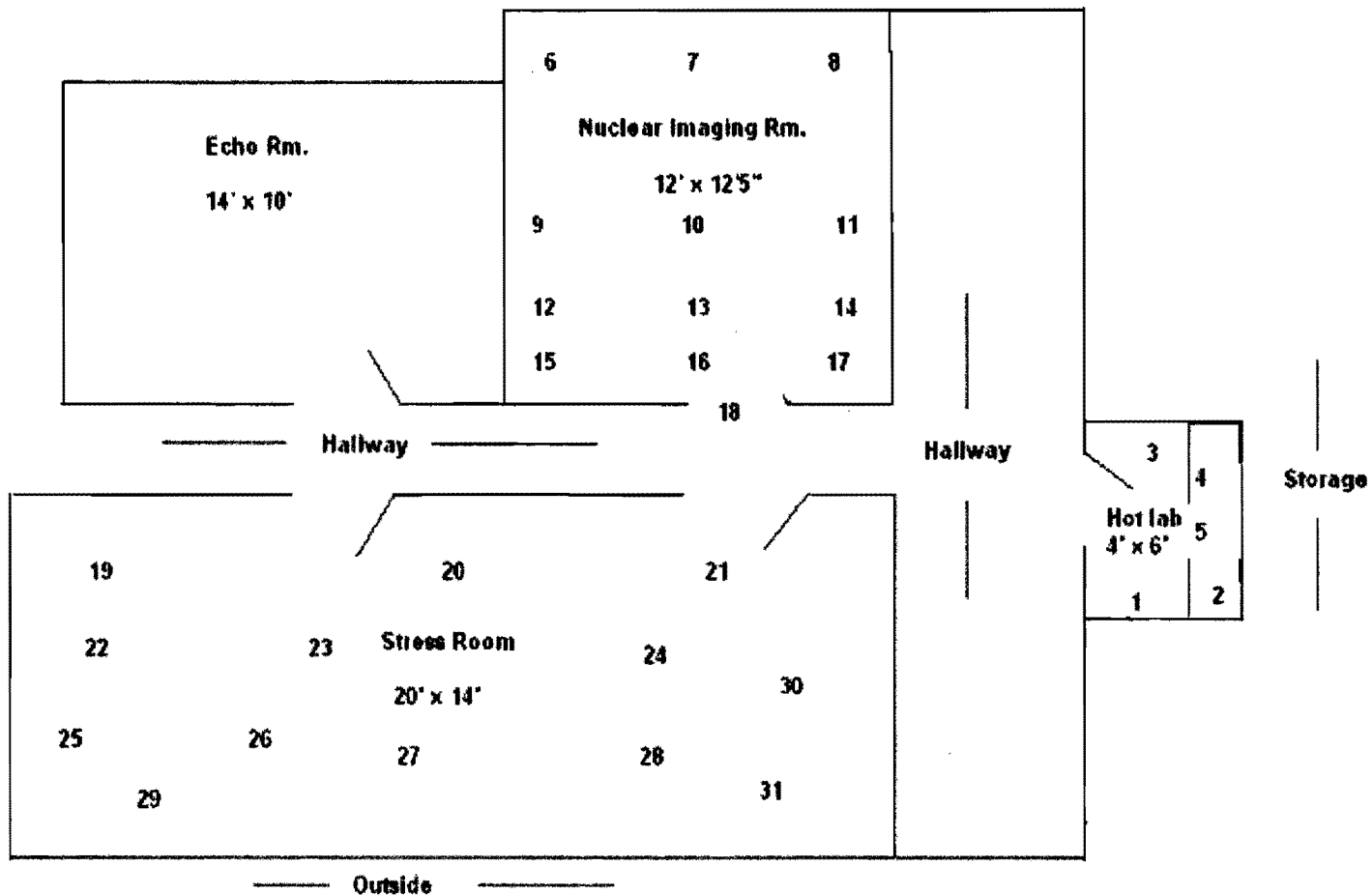

There is a basement for storage located below and nothing above the nuclear department. The hot lab will be under lock and/or key while unattended.

No room numbers assigned.

SECURITY-RELATED INFORMATION WITHHOLD UNDER 10 CFR 2.390



Licensee: Home Clinic, PC

Date: 07/15/11

Performed by: Sharon Updike

Nuclide	Type	Calibration	Calibration	Location	M/N	S/N
		Activity	Date			
Cs-137	Vial	200.2 uCi	12/01/05	Hot Lab	NONE	1140-51-8
		Current Activity: 175.82uCi				
Ba-133	Vial	247.7 uCi	12/01/05	Hot Lab	NONE	1140-57-1
		Current Activity: 172.34uCi				
Co-57	Flood	10 mCi	12/01/05	Hot Lab	NES392	1152-037
		Current Activity: 0.053mCi				

Comment: The sources listed above were leak tested using a dry wipe technique and were found to have less than 0.005 uCi removable activity. The following Minimum Detectable Activities are based upon a background at the indicated value. Background was at or below these levels when the above tests were completed.

Well Counter: Captus 3000

Nuclide	MDA	Background
Cs-137	$2.0 \times 10^{-4}$ uCi	145 counts/1 min
Ba-133	$8.8 \times 10^{-5}$ uCi	204 counts/1 min
Co-57	$1.7 \times 10^{-5}$ uCi	53 counts/1 min

RADIATION SAFETY OFFICER: \_\_\_\_\_

TO REUSE: Cover or mark through any previous shipping

Align top of FedEx Express Shipping Label h

FedEx Express US Airbill

8647 2658 6424

0200

Form ID No.

FedEx Retrieval Copy

1 From Date 10-6-11 Sender's FedEx Account Number 235965461

Sender's Name VAN WILLIAMS Phone 586 264-6079

Company RADONIX ASSOC (DR J MILLER)

Address 2465 E 14th RD

City ST-21 NS HTS State MI ZIP 48310

2 Your Internal Billing Reference

3 To Recipient's Name NRC Phone

Company UNITED STATES MICHIGAN REGULATORY COMMISSION REGION III, OFFICE OF MATERIALS LICENSING

Recipient's Address 2443 WARRENVILLE ROAD STE 210

Address To request a package be held at a specific FedEx location, print FedEx address here.

City LISIE State IL ZIP 60532 4352

4a Express Package Service 1 FedEx Priority Overnight 2 FedEx 2Day 3 FedEx Express Saver 4 FedEx Standard Overnight 5 FedEx Express Saver 6 FedEx First Overnight

4b Express Freight Service 7 FedEx 1Day Freight 8 FedEx 2Day Freight 9 FedEx 3Day Freight

5 Packaging 6 FedEx Envelope 7 FedEx Pak 8 FedEx Box 9 FedEx Tube 10 Other

6 Special Handling 7 SATURDAY Delivery 8 HOLD Weekday at FedEx Location 9 HOLD Saturday at FedEx Location

7 Payment 1 Sender 2 Recipient 3 Third Party 4 Credit Card 5 Cash/Check

8 Residential Delivery Signature Options 1 No Signature Required 2 Direct Signature 3 Indirect Signature



8647 2658 6424

This pouch is resealable.

fedex.com 1.800.GoFedEx 1.800.463.3339

MON - 10 OCT A1 \*\* 2DAY \*\* 60532 IL-US ORD

SE BDFE



Empl 539424 06OCT11 UIZA 50FC1/AM13/F5F4

Align bottom of reel and stick Airbill or Pouch

RT 373 B 6424 10.11