

Rami M. Akel, MD, FACC
Phillip G. Apprill, MD, FACC
Manoj K. Eapen, MD, FACC
Darlene L. Eyster, MD, FACC
Mark A. Friedman, MD
M. Carolyn Gamache, MD, FACC
M. Kiran Kancharla, MD, FACC
David J. Kardesch, MD, FACC

METRO HEART GROUP

OF ST. LOUIS, INC.

John W. Kilgore, MD, FACC
Roberto Pacheco-Coronado, MD
Jeffrey T. Reese, MD, FACC
Bassam A. Roukoz, MD, FACC
Robert Snitzer, MD, FACC
Mark D. Taber, MD, FACC
Richard B. Whiting, MD, FACC

U. S. Nuclear Regulatory Commission
Region III
Materials Licensing Section
2443 Warrenville Road, Suite 210
Lisle, Illinois 60532-4352

License Number 24-32184-01

Request Expedited Processing for return of Suite 1000 to the building owner as an unrestricted area.

Dear Materials Licensing Section:

This is written notification to inform NRC that storm damage repairs have been completed for Suite 3300 and we have moved our operations back into Suite 3300. There is no change in areas of use and storage in Suite 3300 (same as in the facility diagram submitted in the July 01, 2009, renewal application). August 24, 2011 was the last day we used 35.200 radiopharmaceuticals (Tc-99m & Tl-201) and 35.65 sealed source (Co-57 Flood) in Suite 1000. The gamma camera and treadmill were moved back into Suite 3300 and we commenced with imaging back in Suite 3300 on 8/26/11.

Since Jefferson Regional Medical Center (building owner) would like to remodel Suite 1000 for a new tenant, we are requesting an expedited amendment approving the release of Suite 1000 for unrestricted use. A complete close out survey of Suite 1000 (attached) was done following the **Guidelines for Decontamination of Facilities and Equipment Prior to Release for Unrestricted Use or Termination of Licenses for Byproduct, Source or Special Nuclear Material**. Radioactive materials permitted by 35.200 (Tc-99m and Tl-201), in unit dose form, were the only byproduct radiopharmaceuticals used in Suite 1000, and as stated in our previous notification (July 2011) at the end of each imaging day all waste was taken back to our Hot Lab located in Suite 3300. A Co-57 flood source was the only 35.65 source used in Suite 1000. The Co-57 flood source was last leak tested on 4/25/11, by Associates in Medical Physics, LLC. The analysis of the leak test confirmed that removable contamination was less than 0.005 uCi.

Karyn Bauman, CNMT, performed the radiation surveys and wipe tests in Suite 1000 on 8/25/11. Attached are the results of the close out survey (ambient radiation exposure and removable contamination) and a diagram noting the locations where exposure readings and wipe smears were taken in Suite 1000. The Ludlum 14C survey meter, S/N 165659, was calibrated on 8/15/11. Radiation exposure surveys were done with the survey meter set to the most sensitive scale (lowest range). There were no ambient radiation exposures in excess of 0.02 mR/hr. Background radiation exposure in the facility was 0.02mR/hr.



RECEIVED SEP 09 2011



NRC
Page 2

An efficiency test was done (7/25/11) on the Capintec CRC-15W wipe test counter, S/N 170080, using an NIST traceable Co-57 rod source. The efficiency was determined to be 87%, when using a counting window of 15 to 800 keV. Background was counted at 223 cpm, giving a lower limit of detection (LLD) of 52dpm. The minimum detectable activity (MDA) was 2.34 E-05 uCi's above background, with a background of 223 cpm. The results of all dry smear wipe tests were counts below the LLD, demonstrating no removable contamination.

If you have any additional questions, please contact me at or John Derhake (Director Nuclear Cardiology) at (314) 880-6100.

Sincerely,

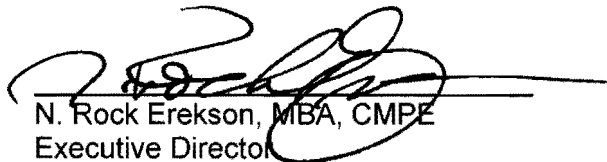

N. Rock Ereksen, MBA, CMPE
Executive Director

Attachments

Metro Heart Group of St. Louis, Inc
1390 Hwy 61
Festus, MO

Close out survey of Suite 1000, Temporary Office of Metro Heart Group of St. Louis, Inc. (Due to storm damage in Suite 3300, Suite 1000 was used from 6/23/11 until 8/24/11).

Survey and wipe tests performed in Suite 1000, camera imaging area, treadmill and chemical stress testing area, resting patient injection area, and counter area where unit dose 35.200 radiopharmaceuticals were kept during the day.

Date of Survey and wipe tests: 8/25/11

Surveys and wipe tests were performed by: Karyn Bauman, CNMT

Instruments used: 1. Surveys, Ludlum 14C, S/N 165659, calibration date 8/15/11, battery and constancy check, OK day of survey. 2. Wipe tests, Capintec CRC-15 W well counter, S/N 170080, Co-57 efficiency last done 7/25/11, 87%, CF=1.15, LLD =52 dpm

MDA = 2.34 E-05 uCi above background, when background is 288 cpm.

Location	GM survey (mR/hr)	Wipe test
Background	0.02	182 cpm
(1) Treadmill & Chemical Stress Area Floor	0.02	0 dpm
(2) Camera Area Floor	0.02	0 dpm
(3) Resting Patient Injection Area Floor	0.02	0 dpm
(4) Counter & Floor Where Unit Dose Radiopharmaceuticals Were Kept	0.02	0 dpm

Tc-99m and TI-201 were the only unsealed radiopharmaceuticals used in these areas.

Exterior

BKGD -> 02mR/hr

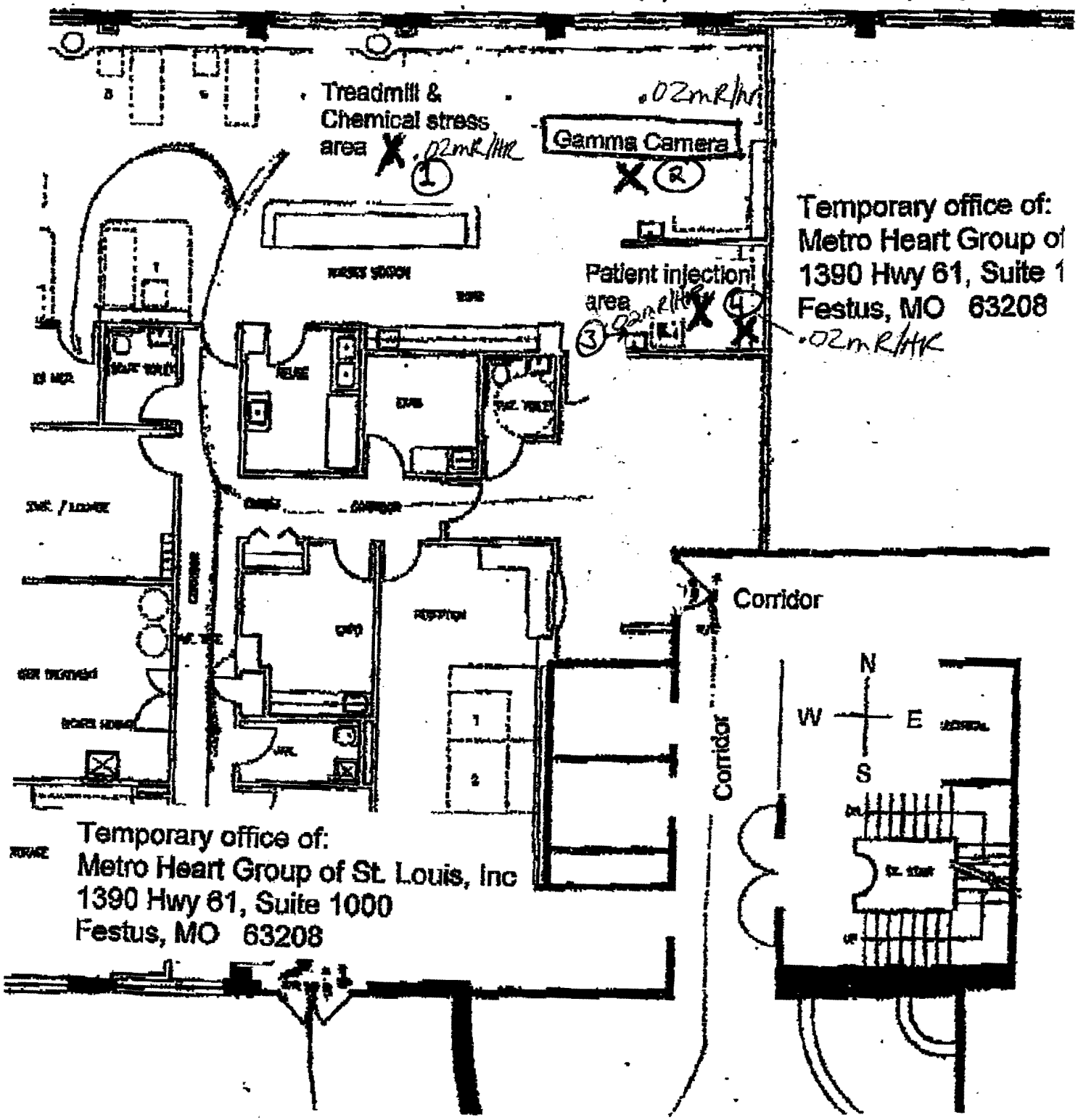

Temporary office of:
 Metro Heart Group of
 1390 Hwy 61, Suite 1
 Festus, MO 63208

Temporary office of:
 Metro Heart Group of St. Louis, Inc
 1390 Hwy 61, Suite 1000
 Festus, MO 63208

radioactive material is stored in shielded containers to keep radiation exposures within Part 20 regulations and ALARA.

Ludlum 4C S/N 165659 source Cs-137 reads 4mR/hr
 Cal. Date = 8/15/2011



Metro Heart Group of St. Louis, Inc.
 12855 N. Forty Dr, Suite 300
 St. Louis, MO 63141

PRESORTED
 FIRST CLASS



Hasler

016H26524263
\$00.71
 09/02/2011
 Mailed From 63385
 US POSTAGE



U.S. Nuclear Regulatory Commission
 Region III
 Materials Licensing Section
 443 Warrenville Road, Suite 210
 isle, IL 60532-4352

801

60532
 HMFZNM1
 Sep 06, 2011

