

9

GW-17

DISPOSAL LINE

TOPSOIL 36 (2006)

TOPSOIL 37 (2006)

TOPSOIL 38 (2006)

TOPSOIL 35 (2006)

TOPSOIL 34 (2006)

TOPSOIL 33 (2006)

HEADER HOUSE 9-3
HEADER HOUSE 9-4
HEADER HOUSE 9-5

SMU-4
SMU-5
SMU-6A
SMU-7A
SMU-7B

TOPSOIL 57 (2008)
TOPSOIL 43 (2008)
TOPSOIL 44 (2008)
TOPSOIL 45 (2008)
TOPSOIL 46 (2008)

WASTE DISPOSAL WELL SRHP#6
TOPSOIL 42 (2008)
TOPSOIL 40 (2006)

TOPSOIL 39 (2006)

TOPSOIL 56 (2008)

TOPSOIL 55 (2008)

TOPSOIL 54 (2008)

TOPSOIL 53 (2008)

TOPSOIL 52 (2008)

TOPSOIL 51 (2008)

TOPSOIL 50 (2008)

TOPSOIL 49 (2008)

TOPSOIL 48 (2008)

TOPSOIL 47 (2008)

SATELLITE SR2

CONTINUED MINE UNIT 10 DEVELOPMENT

MINE UNIT 10 DEVELOPMENT

CONTINUED MINE UNIT 10 DEVELOPMENT

PROPOSED MINE UNIT 11 DEVELOPMENT

10

116

- 2011-2013 PROPOSED AREAS OF DEVELOPMENT
- 2010-2011 NEW DISTURBANCE AREAS
- EROSION CONTROLS
- EXCURSION WELLS (CURRENT)
- EXCURSION WELLS (RESOLVED)
- SPILLS
- UNDERLYING MONITOR WELL
- OVERLYING MONITOR WELL
- PRODUCTION MONITOR WELL
- WELL FIELD TRENDS
- WELL FIELD RESTORATION WELL
- OLD PUMP TEST
- WELLS FOR UNDERGROUND WORKINGS
- AIR SAMPLING STATION
- GROUND WATER SAMPLING LOCATION
- SURFACE WATER SAMPLING STATION
- PERMIT 603 BOUNDARY
- PERMIT 653 BOUNDARY
- PIPELINE
- POWERLINES
- FENCE
- EXISTING TOPSOIL
- NEW OR ADDED TOPSOIL
- STREAM CHANNEL
- RESTORATION COMPLETE - AWAITING DECOMMISSIONING
- RESTORATION IN PROCESS
- ACTIVE PRODUCTION
- PROPOSED PRODUCTION
- PAVED ROAD
- GRAVEL ROAD
- TWO TRACK

INDEX MAP

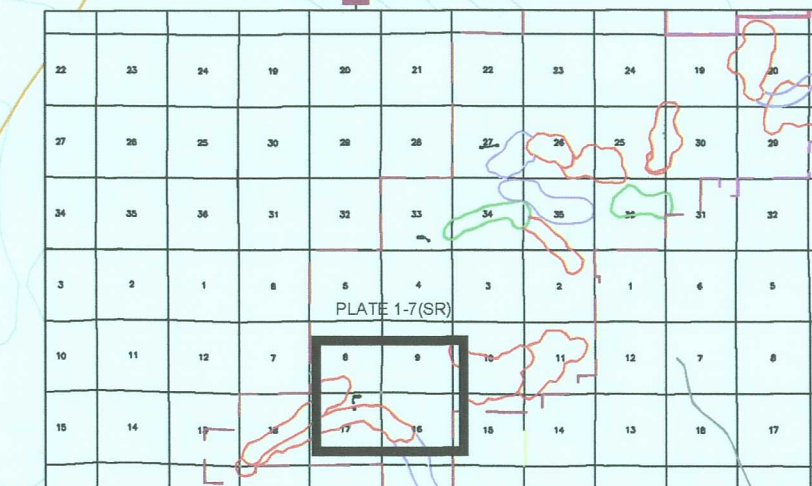

SCALE IN FEET
0 125 250 500

PLATE 1-7(SR)

CAMECO

SMITH RANCH PROJECT
PERMIT TO MINE 653

DATE: 11/11/11

BY: [Signature]

PROJECT NO: 111111

SCALE: 1" = 100'

R-74W

T-35N

T-35N

D-09