

GW-13

GW-14

15

15A

SOUTH WEST ACCESS ROAD CHANGE

GW-15

- 2011-2012 PROPOSED AREAS OF DEVELOPMENT
- 2010-2011 NEW DISTURBANCE AREAS
- EROSION CONTROLS
- EXCURSION WELLS (CURRENT)
- EXCURSION WELLS (RESOLVED)
- SPILLS
- MU or MD-?
- UNDERLYING MONITOR WELL
- MO or MS-?
- OVERLYING MONITOR WELL
- MP-?
- PRODUCTION MONITOR WELL
- WELL FIELD TRENCH WELL
- XT-?
- XR-?
- WELL FIELD RESTORATION WELL
- OLD PUMP TEST WELLS FOR OWS - ?
- UNDERGROUND WORKINGS AIR SAMPLING STATION
- AS-?
- GROUND WATER SAMPLING LOCATION
- SW-?
- SURFACE WATER SAMPLING STATION
- PERMIT 633 BOUNDARY
- PIPELINE
- POWERLINES
- FENCE
- EXISTING TOPSOIL
- NEW OR ADDED TOPSOIL
- STREAM CHANNEL
- RESTORATION COMPLETE - AWAITING DECOMMISSIONING
- RESTORATION IN PROCESS
- ACTIVE - PRODUCTION
- PROPOSED PRODUCTION
- PAVED ROAD
- GRAVEL ROAD
- TWO TRACK

INDEX MAP

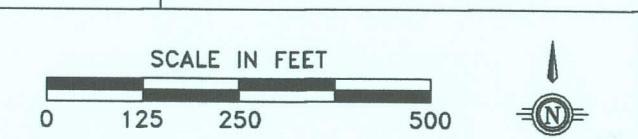
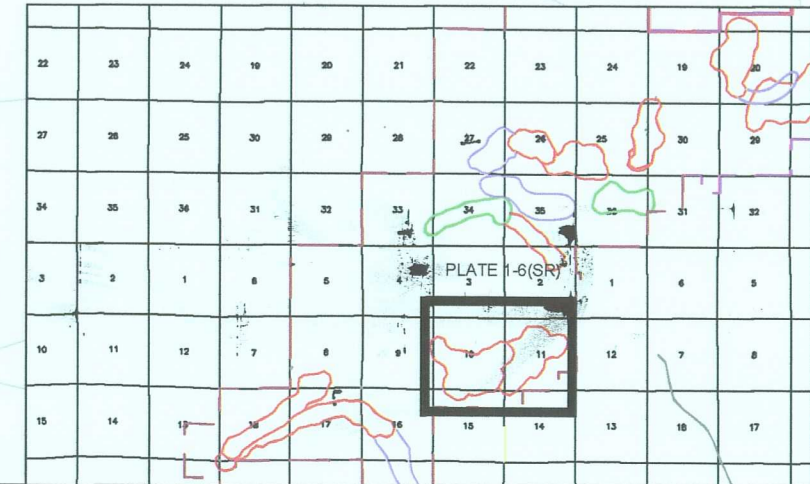

REVISIONS	DATE	BY	DESCRIPTION
1	08/11/2011	AMC	ISSUED FOR PERMIT
2	08/11/2011	AMC	REVISED TO SHOW PROPOSED RESTORATION AREAS

SMITH RANCH PROJECT PERMIT TO MINE 633