

**PROPOSED MINE UNIT 3 EXTENSION DEVELOPMENT**

**PROPOSED MINE UNIT 7 DEVELOPMENT**

**PROPOSED MINE UNIT 3 RE-COMPLETES**

**PROPOSED MINE UNIT 8 DEVELOPMENT**

**WASTE DISPOSAL WELL NO. 2**

**WASTE DISPOSAL WELL NO. 1**

- 2011-2012 PROPOSED AREAS OF DEVELOPMENT
- 2010-2011 NEW DISTURBANCE AREAS
- EROSION CONTROLS
- EXCURSION WELLS (CURRENT)
- EXCURSION WELLS (RESOLVED)
- SPILES
- UNDERLYING MONITOR WELL
- OVERLYING MONITOR WELL
- PRODUCTION MONITOR WELL
- WELL FIELD TRENDS
- WELL FIELD TRENDS
- WELL FIELD RESTORATION WELL
- OLD PUMP TEST WELLS FOR UNDERGROUND WORKINGS
- AIR SAMPLING STATION
- GROUND WATER SAMPLING LOCATION
- SURFACE WATER SAMPLING STATION
- PERMIT 603 BOUNDARY
- PERMIT 633 BOUNDARY
- PIPELINE
- POWERLINES
- FENCE
- EXISTING TOPSOIL
- NEW OR ADDED TOPSOIL
- STREAM CHANNEL
- RESTORATION COMPLETE - AWAITING DECOMMISSIONING
- RESTORATION IN PROCESS
- ACTIVE PRODUCTION
- PROPOSED PRODUCTION
- PAVED ROAD
- GRAVEL ROAD
- TWO TRACK

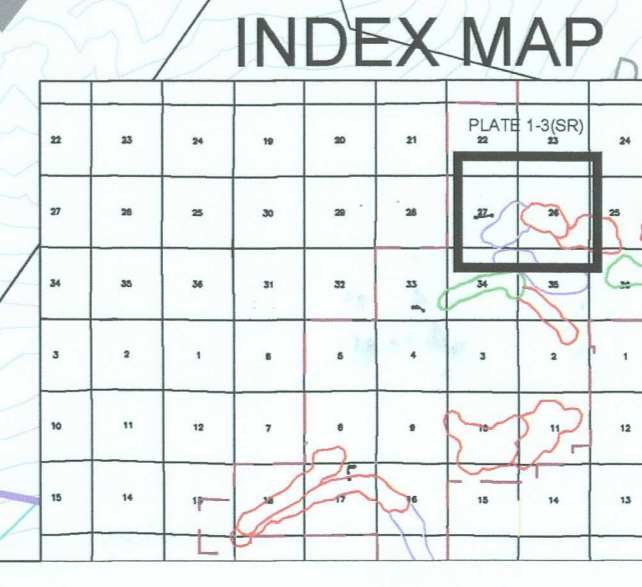

SCALE IN FEET  
0 125 250 500

PLATE 1-3(SR)

SMITH RANCH PROJECT  
PERMIT TO MINE 633

T-36N

T-35N

R-74W

D-05