

July 27, 2011

Nuclear Materials Licensing Section  
U.S. Nuclear Regulatory Commission, Region IV  
612 East Lamar Blvd., Suite 400  
Arlington, TX 76011-4125



**Re: License No. 42-27055-01**

Dear Sir or Madam:

This letter is to request an amendment to our Radioactive Materials License, No.42-27055-01. We wish to amend Condition 10. A. of the license with the removal of the branch office located at 1507 Energy Avenue, Gillette, Wyoming.

The Gillette facility was originally shared between two product segments of Schlumberger Technology Corporation: Wireline, License No. 42-00090-03, and Well Services (WS), License No. 42-27055-01. The request to remove the Gillette facility from the Wireline License was submitted under separate cover on March 21, 2011, and the license was subsequently amended with the issuance of Amendment No. 93. (See Attachment A)

Due to a downturn of business in the Gillette area, services requiring items covered under Radioactive Materials License No.42-27055-01 did not materialize. Therefore, radioactive gauges were never stored or used at this facility during the time of operation.

Schlumberger has completed the following in anticipation of this closure:

Item	Description	Results
Facility Exit Survey	A survey of the facility was completed on March 15, 2011.	The survey results showed levels consistent with background radiation measurements. (See Attachment B)

If you have any questions or require additional information, please contact me at 281-285-7460.

Sincerely,

Thomas S. Wood  
Deputy Radiation Safety Officer  
Schlumberger Technology Corporation

Attachments

# Attachment A



UNITED STATES  
NUCLEAR REGULATORY COMMISSION

REGION IV  
612 EAST LAMAR BLVD, SUITE 400  
ARLINGTON, TEXAS 76011-4125

June 20, 2011

Schlumberger Technology Corporation  
ATTN: Tom Woods  
Deputy Radiation Safety Officer  
300 Schlumberger Drive  
Mail Drop 121  
Sugar Land, Texas 77478

SUBJECT: LICENSE AMENDMENT

Dear Mr. Woods:

Please find enclosed Amendment No. 93 to NRC License No. 42-00090-03 **removing the location of use at 1507 Energy Avenue, Gillette, Wyoming as requested. Based on the submitted leak test results and the survey provided this site is released for unrestricted use in accordance with 10 CFR. 20.1402.** An environmental assessment for this action is not required, since this action is categorically excluded under 10 CFR 51.22(c)(20)(ii). You should review the enclosed document carefully and be sure that you understand all conditions. You can contact me at 817-276-6596 if you have any questions about this license.

NRC's Regulatory Issue Summary (RIS) 2005-31 provides criteria to identify security-related sensitive information and guidance for handling and marking of such documents. This ensures that potentially sensitive information is not made publicly available through ADAMS. The RIS may be located on the NRC Web site at: <http://www.nrc.gov/reading-rm/doc-collections/gen-comm/reg-issues/2005/>. Pursuant to NRC's RIS 2005-31, the enclosed materials license will not be made publicly available.

NRC expects licensees to conduct their programs with meticulous attention to detail and a high standard of compliance. Because of the serious consequences to employees and the public that can result from failure to comply with NRC requirements, you must conduct your radiation safety program according to the conditions of your NRC license, representations made in your license application, and NRC regulations. In particular, note that you must:

1. Operate by NRC regulations 10 CFR Part 19, "Notices, Instructions and Reports to Workers: Inspection and Investigations," 10 CFR Part 20, "Standards for Protection Against Radiation," and other applicable regulations.
2. Notify NRC in writing of any change in mailing address.
3. Request and obtain a license amendment before you:
  - a. Change Radiation Safety Officers;
  - b. Order byproduct material in excess of the amount, radionuclide or form authorized on the license;
  - c. Add or change the areas or address(es) of use identified in the license application or on the license; or

- d. Change the name or ownership of your organization.

NRC will periodically inspect your radiation safety program. Failure to conduct your program according to NRC regulations, license conditions, and representations made in your license application and supplemental correspondence with NRC may result in enforcement action against you. This could include issuance of a notice of violation; imposition of a civil penalty; or an order suspending, modifying, or revoking your license as specified in the NRC Enforcement Policy. The NRC Enforcement Policy is available on the following internet address:  
<http://www.nrc.gov/reading-rm/doc-collections/enforcement/>.

An electronic version of the NRC's regulations is available on the NRC Web site at [www.nrc.gov](http://www.nrc.gov). Additional information regarding use of radioactive materials may be obtained on the NRC Web site at <http://www.nrc.gov/materials/miau/mat-toolkits.html>. This site also provides the link to the toolbox for updated information on the revised regulations for naturally-occurring and accelerator-produced radioactive materials (NARM).

In accordance with 10 CFR 2.390 of the NRC's "Rules of Practice," a copy of this letter will be available electronically for public inspection in the NRC Public Document Room or from the NRC's document system (ADAMS). ADAMS is accessible from the NRC Web site at <http://www.nrc.gov/reading-rm/adams.html>.

Thank you for your cooperation.

Sincerely,



Lizette Roldán-Otero, Ph.D., Health Physicist  
Nuclear Materials Safety Branch B

Docket: 030-06388  
License: 42-00090-03  
Control: 574770

Enclosure: As stated

# Attachment B

# Facility Map

RADIATION SURVEY FOR:  
GILLETTE SCHLUMBERGER OFS FACILITY  
1507 Energy Street  
Gillette, WY 82716



Not To Scale

Radiation Storage Pit   
Property Fence 

Delineations between  
survey areas 

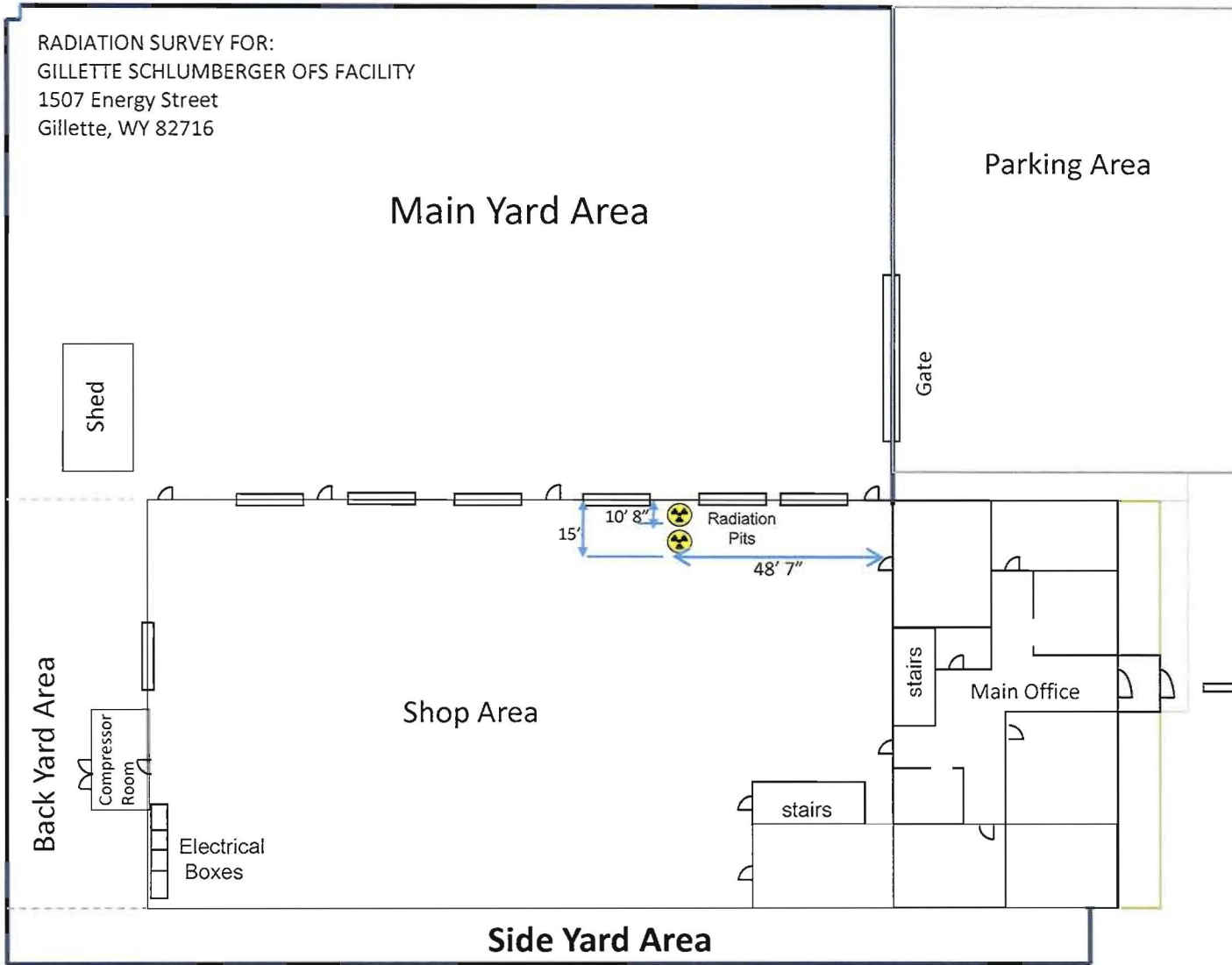

ENERGY STREET

RADIATION SURVEY FOR:  
GILLETTE SCHLUMBERGER OFS FACILITY  
1507 Energy Street  
Gillette, WY 82716



# Shop Grid Survey

All Readings are in  $\mu\text{R/hr}$

Survey performed : 9-Mar-2011

Survey meter make: Ludlum model 3

Survey meter s/n: 213975

Probe Model: 44-2

Probe Serial Number: PR224735

Survey meter calibration date: 16-Mar-2010



Not To Scale

5	5	4	5	6	5	5	5	5	5	5	5	5	5	6	7	5	
5	5	5	6	6	5	5	5	5	5	6	6	5	6	6	5	7	6
5	5	5	5	5	5	5	5	5	5	6	6	6	6	6	5	7	5
6	5	5	5	5	5	5	5	5	5	5	5	5	5	5	5	5	6
5	6	5	6	5	5	5	6	6	5	6	5	5	6	5	5	6	
5	7	6	5	5	5	5	5	5	5	5	6	6	6	7			
5	6	5	5	5	5	5	6	5	5	5	6	5	5	6			

59' 8"

173' 2"

RADIATION SURVEY FOR:  
GILLETTE SCHLUMBERGER OFS FACILITY  
1507 Energy Street  
Gillette, WY 82716

# Main Office Level 1

All Readings are in  $\mu\text{R/hr}$

Survey performed : 9-Mar-2011

Survey meter make: Ludlum model 3

Survey meter s/n: 213975

Probe Model: 44-2

Probe Serial Number: PR224735

Survey meter calibration date: 16-Mar-2010

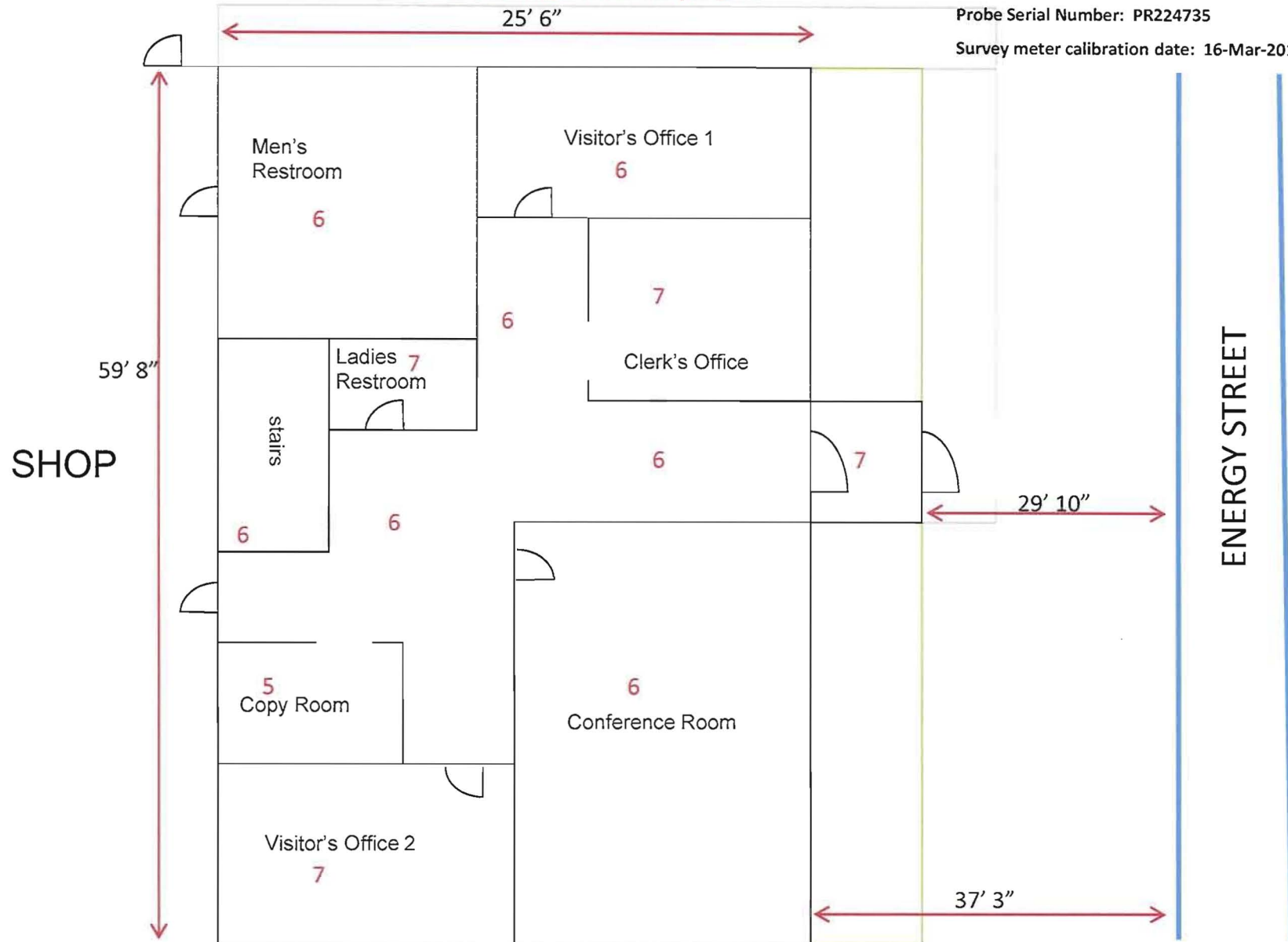



RADIATION SURVEY FOR:  
GILLETTE SCHLUMBERGER OFS FACILITY  
1507 Energy Street  
Gillette, WY 82716

# Level 2 Office

All Readings are in  $\mu\text{R}/\text{hr}$

Survey performed : 9-Mar-2011

Survey meter make: Ludlum model 3

Survey meter s/n: 213975

Probe Model: 44-2

Probe Serial Number: PR224735

Survey meter calibration date: 16-Mar-2010

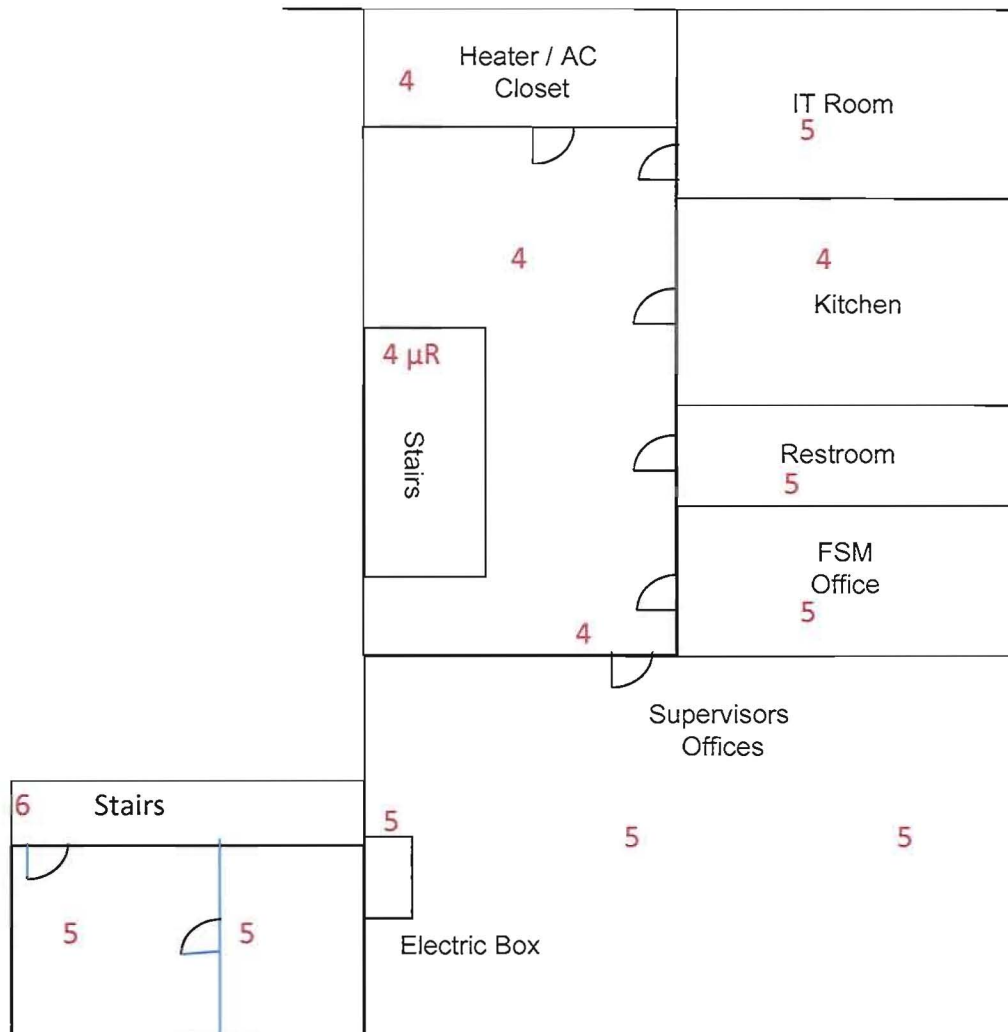

ENERGY STREET

575688

RADIATION SURVEY FOR:  
 GILLETTE SCHLUMBERGER OFS SHOP  
 1507 Energy Street  
 Gillette, WY 82716

# PARKING AREA SURVEY

All Readings are in  $\mu\text{R/hr}$



Survey performed : 10-Mar-2011  
 All values are expressed in  $\mu\text{R/hr}$ .  
 Survey meter make: Ludlum model 3  
 Survey meter s/n: 213975  
 Probe Model: 44-2  
 Probe Serial Number: PR224735  
 Survey meter calibration date: 16-Mar-2010

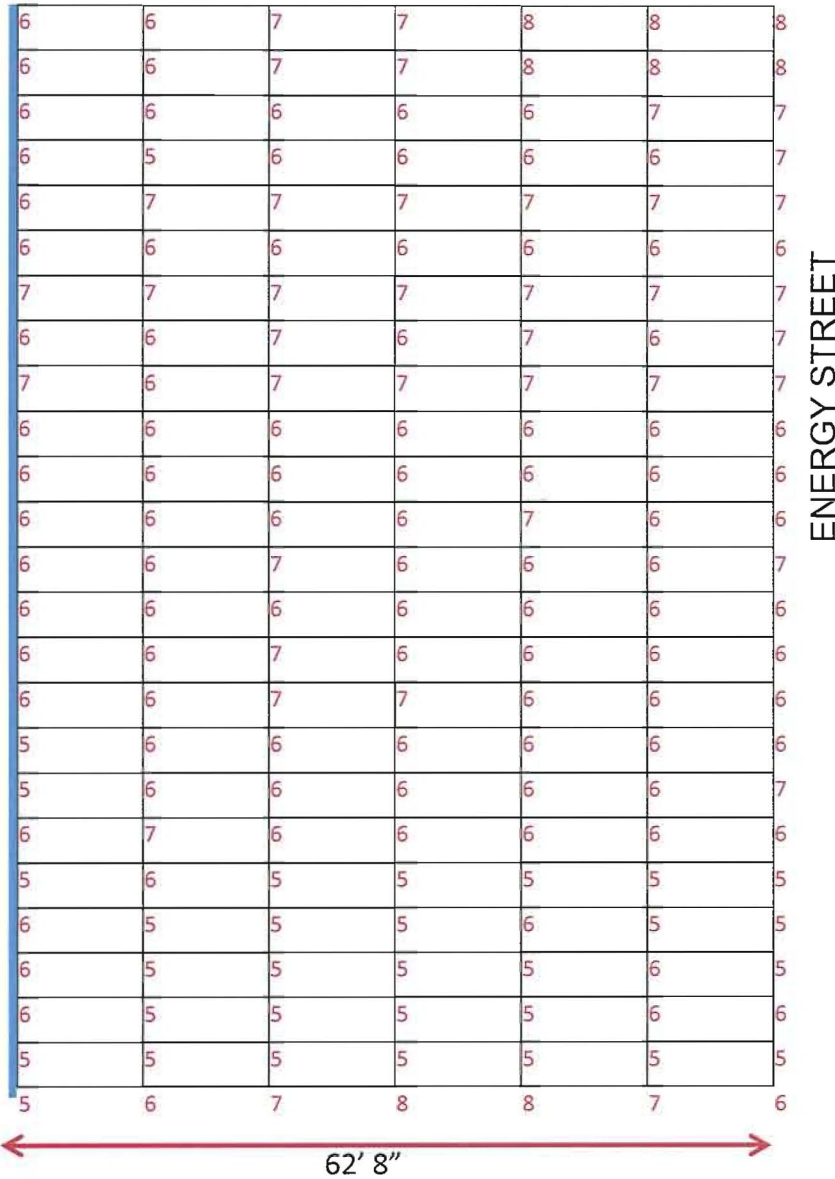

RADIATION SURVEY FOR:  
 GILLETTE SCHLUMBERGER OFS SHOP  
 1507 Energy Street  
 Gillette, WY 82716

# MAIN YARD AREA SURVEY

All Readings are in  $\mu\text{R/hr}$

Survey performed : 11-Mar-2011  
 Survey meter make: Ludlum model 3  
 Survey meter s/n: 213975  
 Probe Model: 44-2  
 Probe Serial Number: PR224735  
 Survey meter calibration date: 16-Mar-2010

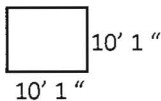

10	9	9	9	8	8	8	9	9	7	6	7	6	5	6	6	8	7	7	9	7	7	6	7	6	7	8	
10	10	8	8	8	8	8	8	8	7	7	7	6	5	7	7	6	7	7	9	7	7	6	7	6	5	8	
9	10	11	10	10	8	9	9	9	7	7	7	7	6	5	7	9	5	7	7	9	7	8	6	6	9	5	7
9	10	13	11	11	9	9	10	8	7	7	6	7	7	7	7	9	7	7	8	10	7	9	6	8	7	6	7
9	11	14	12	12	10	9	11	10	8	9	6	8	6	8	7	8	6	8	8	10	7	8	6	7	6	6	7
10	11	13	13	13	11	10	11	10	9	9	8	8	6	9	7	7	7	9	9	9	7	7	6	7	6	9	6
10	10	10	11	11	11	11	11	10	10	9	9	9	7	9	7	7	9	9	10	8	7	8	7	7	9	7	7
9	9	7	10	10	10	11	11	11	10	10	9	10	8	8	7	7	8	10	9	8	6	8	8	6	9	7	7
7	8	7	9	9	10	10	11	11	10	10	11	10	9	7	7	7	8	8	9	8	7	8	8	7	6	6	7
7	7	8	9	9	10	10	11	10	11	9	10	9	10	7	7	7	8	8	9	8	8	8	7	8	6	6	6
7	7	8	9	9	10	10	11	10	10	9	10	8	9	8	8	7	8	8	9	8	7	9	7	8	6	6	6
7	8	9	10	10	9	10	10	10	9	9	11	7	8	7	7	7	7	8	9	8	7	9	8	8	7	6	6
7	9	9	11	11	9	9	10	10	9	8	10	7	7	7	7	7	7	8	9	7	7	9	9	7	6	6	7
8	11	11	10	10	10	10	10	8	8	8	9	7	7	7	7	7	9	9	7	7	9	7	8	7	6	6	6
8	11	11	11	10	9	9	9	7	6	7	8	7	7	9	7	7	7	8	8	7	8	9	7	9	7	6	6
8	10	11	11	11	9	9	10	5	6	6	8	8	6	9	7	7	7	7	8	7	8	8	8	9	7	7	6
8	10	10	10	11	10	8	9	5	5	6	7	8	6	7	8	7	7	7	8	7	9	7	10	8	9	7	6
8	9	9	7	10	10	7	8	5	5	6	6	7	6	7	8	7	7	7	7	9	7	10	7	8	7	7	6
7	9	9	7	7	10	6	6	5	5	6	6	6	6	6	8	7	7	7	8	7	9	7	9	7	7	8	6
7	8	9	6	7	9	6	6	5	5	6	6	6	6	7	6	7	7	7	10	7	8	7	7	7	7	9	5
8	7	8	6	6	7	6	5																				
8	8	7	6	6	7	6	5	Shed																			
9	8	8	6	6	7	6	5																				
10	8	8	6	6	6	7	6																				
9	8	8	6	6	6	7	6																				

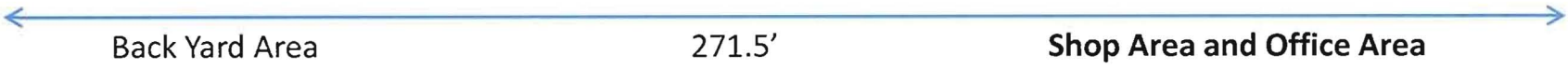

RADIATION SURVEY FOR:  
 GILLETTE SCHLUMBERGER OFS SHOP  
 1507 Energy Street  
 Gillette, WY 82716

# SIDE YARD SURVEY

All Readings are in  $\mu\text{R/hr}$



Survey performed : 10-Mar-2011  
 Survey meter make: Ludlum model 3  
 Survey meter s/n: 213975  
 Probe Model: 44-2  
 Probe Serial Number: PR224735  
 Survey meter calibration date: 16-Mar-2010

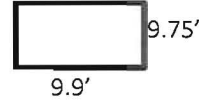

South Side of Building

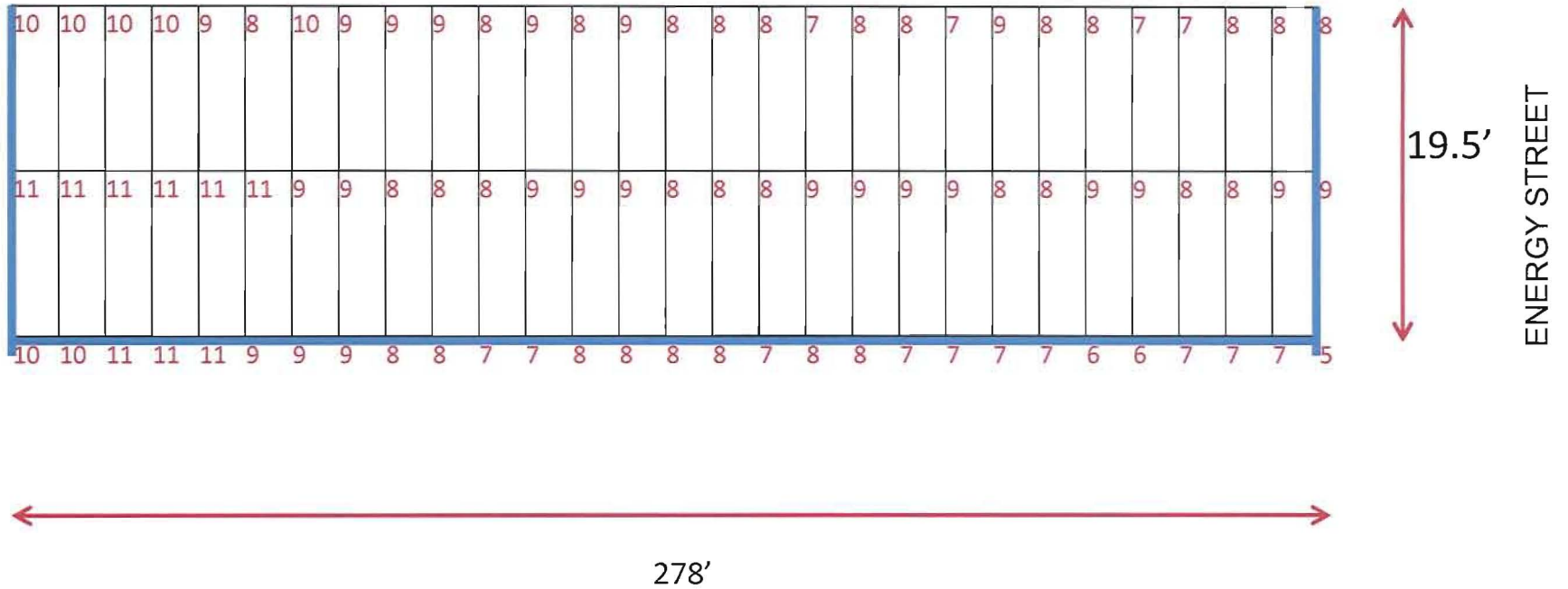

RADIATION SURVEY FOR:  
 GILLETTE SCHLUMBERGER OFS SHOP  
 1507 Energy Street  
 Gillette, WY 82716

# BACK YARD SURVEY

All Readings are in  $\mu\text{R/hr}$

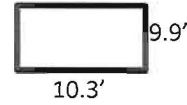

Survey performed : 10-Mar-2011  
 Survey meter make: Ludlum model 3  
 Survey meter s/n: 213975  
 Probe Model: 44-2  
 Probe Serial Number: PR224735  
 Survey meter calibration date: 16-Mar-2010

## MAIN YARD

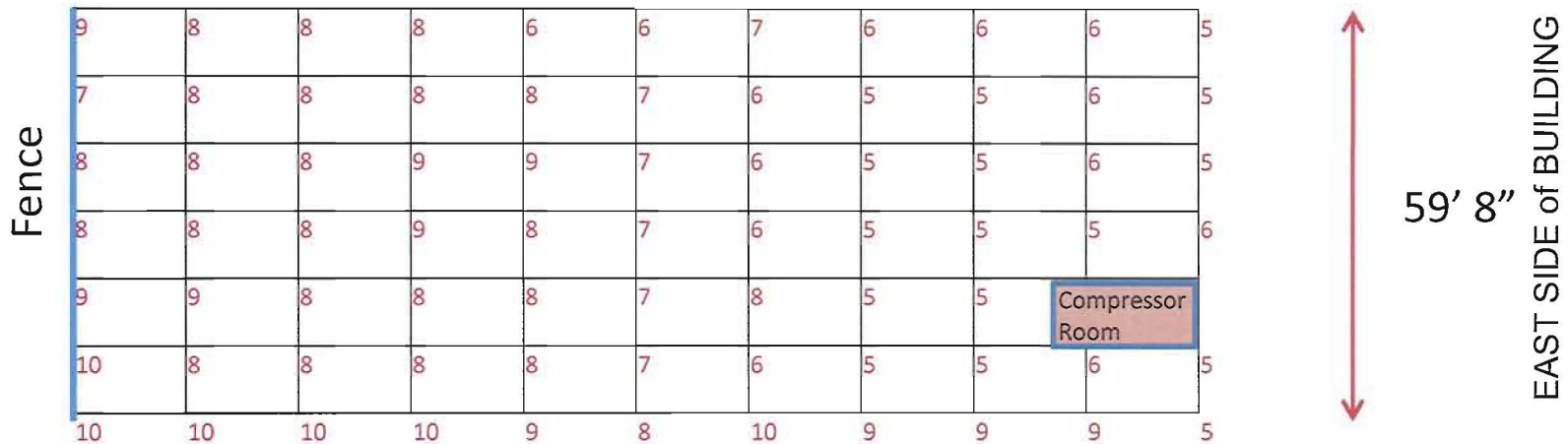

## SIDE YARD

103'

RADIATION SURVEY FOR:  
GILLETTE SCHLUMBERGER OFS FACILITY  
1507 Energy Street  
Gillette, WY 82716

No readings were observed to be above normal background radiation level.

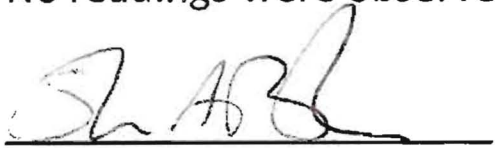
A handwritten signature in black ink, appearing to read 'Shawnee A Burdick', is written over a horizontal line.

Shawnee A Burdick

AUG - 2 2011

DATE

This is to acknowledge the receipt of your letter/application dated 7/27/11, and to inform you that the initial processing, which includes an administrative review, has been performed.

- There were no administrative omissions. Your application will be assigned to a technical reviewer. Please note that the technical review may identify additional omissions or require additional information.
- Please provide to this office within 30 days of your receipt of this card:

---

The action you requested is normally processed within 90 days.

- A copy of your action has been forwarded to our License Fee & Accounts Receivable Branch, who will contact you separately if there is a fee issue involved.

Your action has been assigned **Mail Control Number** 575688.  
When calling to inquire about this action, please refer to this mail control number.  
You may call me at 817-860-8103.

Sincerely,



Licensing Assistant



BETWEEN:

Accounts Receivable/Payable  
and  
Regional Licensing Branches

[ FOR ARPB USE ]  
INFORMATION FROM LTS

Program Code: 03120  
Status Code: Pending Amendment  
Fee Category: 3P  
Exp. Date:  
Fee Comments:  
Decom Fin Assur Req: N

### License Fee Worksheet - License Fee Transmittal

#### A. REGION

##### 1. APPLICATION ATTACHED

Applicant/Licensee: SCHLUMBERGER TECHNOLOGY CORP.  
Received Date: 07/29/2011  
Docket Number: 3032023  
Mail Control Number: 575688  
License Number: 42-27055-01  
Action Type: Amendment

##### 2. FEE ATTACHED

Amount: \_\_\_\_\_

Check No.: \_\_\_\_\_

##### 3. COMMENTS

Signed: Cecilia Duran

Date: 7-29-2011

#### B. LICENSE FEE MANAGEMENT BRANCH (Check when milestone 03 is entered / / )

1. Fee Category and Amount: \_\_\_\_\_

2. Correct Fee Paid. Application may be processed for:

Amendment: \_\_\_\_\_

Renewal: \_\_\_\_\_

License: \_\_\_\_\_

3. OTHER \_\_\_\_\_  
\_\_\_\_\_

Signed: \_\_\_\_\_

Date: \_\_\_\_\_



From: (281) 285-7460  
Tom Wood  
Schlumberger Technology Corp.  
300 Schlumberger Drive, MD-121

Origin ID: SGRA



J11201104290225

Sugar Land, TX 77478

SHIP TO: (817) 860-8197

BILL SENDER

Ms Lizette Roldan-Otero  
NRC - Region IV  
612 E LAMAR BLVD STE 400

ARLINGTON, TX 76011

Ship Date: 28JUL11  
ActWgt: 1.0 LB  
CAD: 100343370/INET3180

Delivery Address Bar Code



Ref #  
Invoice #  
PO #  
Dept #



TRK# 7950 2058 7912  
0201

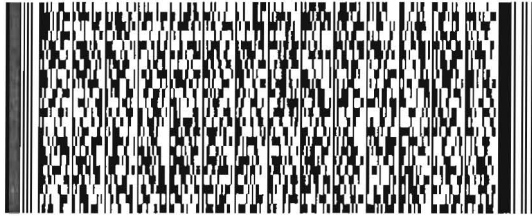

A1 FWHA

76011  
TX-US  
DFW

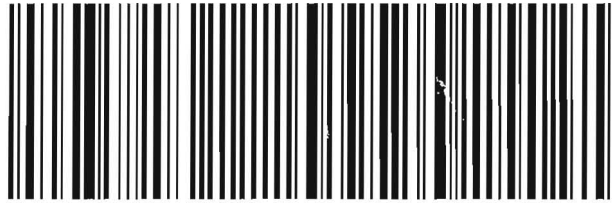

50FG2IF565IF5F4

h 575688

**After printing this label.**

1. Use the 'Print' button on this page to print your label to your laser or inkjet printer.
2. Fold the printed page along the horizontal line.
3. Place label in shipping pouch and affix it to your shipment so that the barcode portion of the label can be read and scanned.

**Warning:** Use only the printed original label for shipping. Using a photocopy of this label for shipping purposes is fraudulent and could result in additional billing charges, along with the cancellation of your FedEx account number.

Use of this system constitutes your agreement to the service conditions in the current FedEx Service Guide, available on fedex.com. FedEx will not be responsible for any claim in excess of \$100 per package, whether the result of loss, damage, delay, non-delivery, misdelivery, or misinformation, unless you declare a higher value, pay an additional charge, document your actual loss and file a timely claim. Limitations found in the current FedEx Service Guide apply. Your right to recover from FedEx for any loss including intrinsic value of the package, loss of sales, income interest, profit, attorney's fees, costs, and other forms of damage whether direct, incidental, consequential, or special is limited to the greater of \$100 or the authorized declared value. Recovery cannot exceed actual documented loss. Maximum for items of extraordinary value is \$500, e.g. jewelry, precious metals, negotiable instruments and other items listed in our ServiceGuide. Written claims must be filed within strict time limits, see current FedEx Service Guide.