

RSA Laboratories
 A Division of Radiation Safety Associates
Radiochemistry Analysis Data Sheet

Page 1 of 1

Report No. N/A
 Customer Samp No. N/A

Customer: Chemtura
 Location: Hood Vent Stacks on Roof
 Roof Surface

RSA Lab Sample No. N/A
 Date Collected: 4/9/2011
 Date Counted: 4/9/2011

Project: Lab Decommissioning
 Samp. Description: Survey Wipes
 Matrix: Wipes

C-14 LLD dpm= 44.57

RSA ID#	CUST. ID#	Location	C-14 CPM	dpm/100 cm sq
	BG	BACKGROUND	43.60	
1		Roof Vent 1215 Hood 2	16.70	18.90
2		Roof Vent 1216 Hood 4	10.00	11.50
3		Roof Vent 1217 Hood 6	0.00	0.00
4		Roof Vent 1218 Hood 8	15.00	16.60
5		Roof Vent 1221 Hood 17	0.00	0.00
6		Roof Vent 1222 Hood 20	15.00	17.60
7		Roof Vent 1222 Hood 20A	14.50	16.30
8		Roof Vent 1223 Hood 24	10.90	12.20
9		Roof Vent 1223 Hood 26	4.20	4.70
10		Roof Vent 1224 Hood 28	10.00	11.10
11		Roof Vent 1201 Hood 78	13.20	14.80
12		Roof Vent 1201 Hood 76	18.10	20.00
13		Roof Vent 1202 Hood A	3.30	3.70
14		Roof Vent 1202 Hood B	2.10	2.30
15		Roof Vent 1202 Hood C	13.50	14.80
16		Roof Vent 1203 Hood 68	13.20	14.70
17		Roof Vent 1203 Hood 65	0.80	0.90
18		Roof Vent 1204 Hood 62	23.20	25.50
19		Roof Vent 1204 Hood 53	26.40	30.20
20		Roof Vent 1205 Hood 50	6.00	6.90
21		Roof Vent 1206 Hood 51	29.00	33.10
22		Roof Vent 1206 Hood 48	43.60	4.00
23		Roof Vent 1207 Hood 45 **	1623.70	1792.50
C-14		QC C-14	124758.90	134918.20
24		Roof Vent 1207 Hood 39	40.10	45.60
25		Roof Vent 1208 Hood 41	19.30	21.60
26		Roof Vent 1209 Hood 35	14.10	15.60
27		Roof Vent 1210 Hood 33	5.00	5.50
28		Roof Near 1207 Hood 45	24.10	26.70
29		Roof Near 1207 Hood 45	5.20	5.70
30		Roof Near 1207 Hood 45	0.00	0.00
31		Roof Near 1207 Hood 45	5.00	5.40
BL		QC Blank	12.20	13.20

** The Hood 45 interior, ducting, blower and discharge stack were removed and disposed as radioactive waste.

NOTE

The wipe results on pages 1-3 (with the exception of the last entry on p. 3) were taken in the ventilation ducts at the top of each fume hood. These were very dirty, so a wipe was taken before cleaning (labeled "Pre") and after cleaning (labeled "Post"). Recall that 8' hoods have 2 vent ducts, so these are labeled "Left" and "Right."

The last wipe result on p. 3 and the wipe results on p. 4 (numbered S-226 through S-241) are the flexible ducts in several rooms that were not connected to any component at the time of the decommissioning. See Figure 7 in the report to see examples.

Wipe results on page 5 are for the hallway that connects all of the laboratories in the main lab wing.

RSA Laboratories
A Division of Radiation Safety Associates
Radiochemistry Analysis Data Sheet

Page 1 of 3

Report No. *N/A*Customer: **Chemtura**Customer Samp No. *N/A*Location: **Hood vents**RSA Lab Sample No. *N/A*Project: **Lab Decommissioning**Date Collected: **03/02/2011 - 3/09/2011**Samp. Description: **Survey Wipes**Date Counted: **03/02/2011 - 3/09/2011**Matrix: **Wipes****C-14 LLD dpm= 40.47**

RSA ID#	CUST. ID#	Location	C-14 CPM	dpm/100 cm sq
	BG	BACKGROUND	35.30	
1		1215 Hood 2 Vent Left Post	15.70	20.10
2		1215 Hood 2 Vent Right Post	14.20	17.00
3		1216 Hood 4 Left Pre	31.80	42.00
4		1216 Hood 4 Right Pre	34.50	42.40
5		1216 Hood 4 Left Post	37.00	44.40
6		1216 Hood 4 Right Post	31.70	37.90
7		1217 Hood 6 Left Pre	21.80	26.30
8		1217 Hood 6 Right Pre	23.90	30.60
9		1217 Hood 6 Left Post	23.30	29.30
10		1217 Hood 6 Right Post	26.40	33.60
11		1218 Hood 8 Left Pre	27.50	33.50
12		1218 Hood 8 Right Pre	26.20	32.80
13		1218 Hood 8 Left Post	20.20	24.70
14		1218 Hood 8 Right Post	29.00	35.40
15		1222 Hood 20 Left Pre	6.70	8.00
16		1222 Hood 20 Right Pre	125.40	152.30
17		1222 Hood 20 Left Post	158.10	198.10
18		1222 Hood 20 Right Post	135.00	172.30
19		1222 Hood 20A Pre	4.20	5.60
20		1222 Hood 20A Post	24.10	30.40
21		1223 Hood 28 Pre	28.40	35.30
22		1223 Hood 28 Post	35.80	42.80
23		1223 Hood 26 Pre	30.10	37.50
C-14		QC C-14	125713.60	135891.90
24		1223 Hood 26 Post	37.30	48.20
25		1224 Hood 28 Left Pre	19.90	24.50
26		1224 Hood 28 Right Pre	30.00	37.40
27		1224 Hood 28 Left Post	7.30	20.30
28		1224 Hood 28 Right Post	27.00	33.70
29		1201 Hood 76 Pre	26.50	33.30
30		1201 Hood 76 Post	13.70	16.70
31		1201 Hood 78 Pre	44.20	60.30
32		1201 Hood 78 Post	31.10	37.80
BL		QC Blank	8.70	9.40
BG		Background	42.70	0.00

RSA Laboratories
A Division of Radiation Safety Associates
Radiochemistry Analysis Data Sheet

Page 2 of 3

RSA ID#	CUST. ID#	LOCATION		C-14 CPM	dpm/100 cm sq
1		1210 Right Pre		17.30	21.80
2		1210 Right Post		48.10	59.10
3		1210 Left Pre		35.00	46.60
4		1210 Left Post		38.60	48.20
5		1206 Hood 51 Pre		246.30	291.20
6		1206 Hood 51 Post		224.30	278.10
7		1206 Hood 48 Pre		17.20	20.30
8		1221 Hood 48 Post		57.30	72.40
9		1221 Hood 17 Left Pre		12.70	15.80
10		1221 Hood 17 Left Post		32.10	39.90
11		1221 Hood 17 Right Pre		5.00	60.00
12		1221 Hood 17		19.60	24.70
C-14		QC C-14		124941.70	135262.20
BL		QC Blank		14.80	16.10
BL		Blank		12.60	13.70
1		1202 Hood B Pre		97.50	124.20
2		1202 Hood B Post		91.40	115.50
3		1202 Hood C Pre		18.50	22.00
4		1202 Hood C Post		25.20	31.20
5		1203 Hood 68 Pre		37.90	49.50
6		1203 Hood 68 Post		24.50	29.90
7		1203 Hood 65 Pre		33.50	44.50
8		1203 Hood 65 Post		36.70	45.40
9		1204 Hood 62 Pre		66.90	87.80
10		1204 Hood 62 Post		41.10	48.00
11		1205 Hood 53 Pre		157.10	192.00
12		1205 Hood 53 Post		176.30	210.40
13		1205 Hood 53 Left Pre		48.90	60.10
14		1205 Hood 53 Left Post		58.10	67.50
15		1205 Hood 50 Right Pre		31.50	38.60
16		1205 Hood 50 Right Post		42.70	52.40
17		1207 Hood 39 Pre		45.90	57.50
18		1207 Hood 39 Post		68.60	83.30
19		1207 Hood 45 Pre		774.80	985.80
20		1207 Hood 45 Post		809.70	985.20
21		1208 Hood 41 Left Pre		54.30	67.30
22		1208 Hood 41 Left Post		74.30	88.40
23		1208 Hood 41 Right Pre		87.60	108.50
C-14		QC C-14		124756.80	134945.10
24		1208 Hood 41 Right Post		129.90	158.60
25		1209 Hood 35 Left Pre		45.90	55.40
26		1209 Hood 35 Left Post		55.20	64.10
27		1209 Hood 35 Right Pre		185.40	236.70
28		1209 Hood 35 Right Post		146.30	175.70
BL		QC Blank		6.50	7.10
BG		Background		35.30	0.00
1		Room 1201 S226		17.30	19.10

RSA Laboratories
A Division of Radiation Safety Associates
Radiochemistry Analysis Data Sheet
Page 3 of 3

RSA ID#	CUST. ID#	LOCATION		C-14 CPM	dpm/100 cm sq
2		Room 1204 S227		5.30	6.00
3		Room 1215 S228		14.10	16
4		Room 1215 S229		18.70	21.00
5		Room 1219 S230		8.00	8.90
6		Room 1219 S231		6.10	6.80
7		Room 1219 S232		9.30	10.20
8		Room 1219 S233		1.30	1.40
9		Room 1219 S234		0.00	0.00
10		Room 1219 S235		16.40	18.70
11		Room 1219 S236		12.50	15.30
12		Room 1219 S237		15.40	17.10
13		Room 1219 S238		13.60	16.00
14		Room 1219 S239		4.50	5.10
15		Room 1220 S240		10.90	12.00
16		Room 1221 S241		8.40	9.20
C-14		QC C-14		114152.20	133683.30
BL		Blank		19.80	21.50

RSA Laboratories
 A Division of Radiation Safety Associates
Radiochemistry Analysis Data Sheet

Page 1 of 1

Report No. **N/A**

Customer: **Chemtura**

Customer Samp No. **N/A**

Location: **Hallway Floor**

RSA Lab Sample No. **N/A**

Project: **Lab Decommissioning**

Date Collected: **5/24/2011**

Samp. Description: **Survey Wipe**

Date Counted: **5/24/2011**

Matrix: **Wipes**

C-14 LLD dpm= 39.35

RSA ID#	CUST. ID#	Location	C-14 CPM	dpm/100 cm sq
BG		BACKGROUND	42.60	
1		Hallway Floor Outside 1201	26.70	15.00
2		Hallway Floor Outside 1223	27.50	13.00
3		Hallway Floor Outside 1203	18.90	20.70
4		Hallway Floor Outside 1221	22.00	18.70
5		Hallway Floor Outside 1206	10.80	12.50
6		Hallway Floor Outside 1219	16.00	7.40
7		Hallway Floor Outside 1208	6.40	2.80
8		Hallway Floor Outside 1217	27.20	28.30
9		Hallway Floor Outside 1210	27.70	19.70
10		Hallway Floor Outside 1215	20.10	24.50
11		QC Blank	23.30	16.20
12		QC C-14	130524.30	137292.80
			15.70	17.30

Drawers and Cabinets—Scoping Survey

Each drawer and cabinet was numbered for easy identification. There are a total of more than 1700 of them in these laboratories.

Scan surveys were made in virtually 100% of drawers and under-bench cabinets concentrating on under-hood cabinets and drawers in proximity to identified contaminated areas.

Standard wipe surveys (100 cm²) were taken in 18% of drawers and cabinets (322 wipes, 1725 drawers and cabinets). The results of these surveys are contained in this attachment.

RSA Laboratories
 A Division of Radiation Safety Associates
Radiochemistry Analysis Data Sheet

Page 1 of 3

Report No. **Report 3**

Customer: **Chemtura**

Customer Samp No. **N/A**

Location: **Drawers**

RSA Lab Sample No. **N/A**

Project: **Lab Decommissioning**

Date Collected: **5/3/2011**

Samp. Description: **Survey Wip**

Date Counted: **5/3/2011**

Matrix: **Wipes**

C-14 LLD dpm= 37.47

RSA ID#	CUST. ID#	Location	C-14 CPM	dpm/100 cm sq
BG		BACKGROUND		
1		Room 1201 Drawer 957	0.00	0.00
2		Room 1201 Drawer 959	0.00	0.00
3		Room 1201 Drawer 967	6.30	7.09
4		Room 1201 Drawer 978	22.21	2.48
5		Room 1201 Drawer 984	0.00	0.00
6		Room 1201 Drawer 991	0.00	0.00
7		Room 1201 Drawer 994	5.30	5.85
8		Room 1201 Drawer 1001	4.25	4.76
9		Room 1201 Drawer 1006	6.32	7.02
10		Room 1201 Drawer 1015	0.20	0.23
11		Room 1201 Drawer 1018	2.24	2.48
12		Room 1201 Drawer 1032	0.00	0.00
13		Room 1202 Drawer 1037	7.34	8.22
14		Room 1202 Drawer 1040	0.00	0.00
15		Room 1202 Drawer 1049	0.20	0.23
16		Room 1202 Drawer 1051	0.00	0.00
17		Room 1202 Drawer 1060	7.34	8.10
18		Room 1202 Drawer 1067	5.30	5.86
19		Room 1202 Drawer 1071	0.00	0.00
20		Room 1202 Drawer 1077	0.00	0.00
21		Room 1202 Drawer 1089	2.24	2.48
22		Room 1202 Drawer 1093	1.22	1.35
23		Room 1203 Drawer 1099	1.22	1.38
C-14		QC, C-14	108989.00	122834.00
24		Room 1203 Drawer 1104	11.42	12.71
25		Room 1203 Drawer 1111	2.21	2.49
26		Room 1203 Drawer 1118	1.22	1.36
27		Room 1203 Drawer 1129	0.00	0.00
28		Room 1203 Drawer 1134	0.00	0.00
29		Room 1203 Drawer 1137	0.00	0.00
30		Room 1203 Drawer 1143	0.20	0.23
31		Room 1203 Drawer 1151	0.20	0.23
32		Room 1203 Drawer 1160	0.00	0.00
33		Room 1203 Drawer 1169	0.00	0.00
34		Room 1203 Drawer 1175	7.34	8.11

RSA Laboratories
 A Division of Radiation Safety Associates
Radiochemistry Analysis Data Sheet

Page 2 of 3

RSA ID#	CUST. ID#	LOCATION	0 CPM	0 DPM	C-14 CPM	dpm/100 cm sq
35		Room 1203 Drawer 1177	0.00	0	0.00	0.00
36		Room 1203 Drawer 1186	0.00	0.00	0.00	0.00
37		Room 1203 Drawer 1194	0.00	0.00	5.30	5.86
38		Room 1203 Drawer 1158	0.00	0.00	2.24	2.48
39		Room 1204 Drawer 1164	0.00	0.00	0.00	0.00
40		Room 1204 Drawer 1168	0.00	0.00	2.24	2.51
41		Room 1204 Drawer 1172	0.00	0.00	1.22	1.36
42		Room 1204 Drawer 1182	0.00	0.00	0.00	0.00
43		Room 1204 Drawer 1193	0.00	0.00	0.00	0.00
44		Room 1204 Drawer 1188	0.00	0.00	0.00	0.00
45		Room 1204 Drawer 1201	0.00	0.00	34.87	39.38
46		Room 1204 Drawer 1211	0.00	0.00	0.00	0.00
BL		QC, Blank	0.00	0.00	5.30	5.88
47		Room 1204 Drawer 1217	0.00	0.00	8.36	9.40
48		Room 1204 Drawer 1230	0.00	0.00	0.00	0.00
49		Room 1204 Drawer 1239	0.00	0.00	44.05	49.31
50		Room 1204 Drawer 1241	0.00	0.00	8.36	9.27
51		Room 1204 Drawer 1249	0.00	0.00	0.00	0.00
52		Room 1204 Drawer 1250	0.00	0.00	6.32	6.98
53		Room 1204 Drawer 1258	0.00	0.00	0.00	0.00
54		Room 1204 Drawer 1264	0.00	0.00	4.28	4.74
55		Room 1209 Drawer 1266	0.00	0.00	5.30	5.88
56		Room 1209 Drawer 1289	0.00	0.00	3.26	3.64
57		Room 1209 Drawer 1287	0.00	0.00	0.00	0.00
58		Room 1209 Drawer 1302	0.00	0.00	0.20	0.23
59		Room 1209 Drawer 1306	0.00	0.00	0.00	0.00
60		Room 1209 Drawer 1309	0.00	0.00	0.00	0.00
61		Room 1209 Drawer 1316	0.00	0.00	6.32	7.02
62		Room 1209 Drawer 1327	0.00	0.00	2.24	2.49
63		Room 1209 Drawer 1337	0.00	0.00	0.00	0.00
64		Room 1209 Drawer 1342	0.00	0.00	8.36	9.26
65		Room 1209 Drawer 1350	0.00	0.00	0.20	0.23
66		Room 1209 Drawer 1356	0.00	0.00	2.24	2.48
67		Room 1209 Drawer 1358	0.00	0.00	4.28	4.77
68		Room 1209 Drawer 1368	0.00	0.00	1.22	1.36
69		Room 1209 Drawer 1376	0.00	0.00	6.32	6.99
C-14		QC, C-14	0.00	0.00	111102.00	122993.00
70		Room 1209 Drawer 1380	0.00	0.00	0.00	0.00
71		Room 1209 Drawer 1382	0.00	0.00	5.30	5.88
72		Room 1217 Drawer 1384	0.00	0.00	5.30	5.90
73		Room 1217 Drawer 1394	0.00	0.00	7.34	8.19
74		Room 1217 Drawer 1404	0.00	0.00	3.26	3.65
75		Room 1217 Drawer 1420	0.00	0.00	3.26	3.64
76		Room 1217 Drawer 1425	0.00	0.00	2.24	2.51
77		Room 1217 Drawer 1432	0.00	0.00	7.34	8.20
78		Room 1217 Drawer 1440	0.00	0.00	7.34	8.18
79		Room 1217 Drawer 1442	0.00	0.00	0.00	0.00

RSA Laboratories
 A Division of Radiation Safety Associates
Radiochemistry Analysis Data Sheet

Page 3 of 3

RSA ID#	CUST. ID#	LOCATION			C-14 CPM	dpm/100 cm sq
80		Room 1217 Drawer 1448			0.00	0.00
81		Room 1217 Drawer 1455			0.00	0.00
82		Room 1217 Drawer 1466			5.30	5.92
83		Room 1217 Drawer 1473			0.00	0.00
84		Room 1217 Drawer 1475			0.00	0.00
85		Room 1217 Drawer 1484			0.00	0.00
86		Room 1217 Drawer 1492			6.32	6.98
87		Room 1217 Drawer 1495			2.24	2.50
88		Room 1217 Drawer 1497			0.00	0.00
89		Room 1222 Drawer 1502			4.28	4.80
90		Room 1222 Drawer 1503			0.00	0.00
91		Room 1222 Drawer 1513			0.00	0.00
92		Room 1222 Drawer 1516			0.00	0.00
BL		QC, Blank			4.28	4.74
93		Room 1222 Drawer 1526			0.00	0.00
94		Room 1222 Drawer 1527			5.30	5.90
95		Room 1222 Drawer 1535			0.20	0.23
96		Room 1222 Drawer 1544			0.00	0.00
97		Room 1222 Drawer 1556			0.00	0.00
98		Room 1222 Drawer 1564			1.22	1.37
99		Room 1222 Drawer 1569			0.00	0.00
100		Room 1222 Drawer 1573			15.50	17.25
101		Room 1222 Drawer 1574			8.36	9.38
102		Room 1223 Drawer 1582			0.00	0.00
103		Room 1223 Drawer 1588			0.00	0.00
104		Room 1223 Drawer 1597			0.00	0.00
105		Room 1223 Drawer 1602			10.40	11.64
106		Room 1223 Drawer 1615			2.24	2.49
107		Room 1223 Drawer 1621			0.00	0.00
108		Room 1223 Drawer 1624			0.00	0.00
109		Room 1223 Drawer 1632			0.00	0.00
110		Room 1223 Drawer 1642			0.20	0.23
111		Room 1223 Drawer 1643			10.40	11.65
112		Room 1223 Drawer 1651			1.22	1.36
113		Room 1223 Drawer 1658			4.28	4.77
114		Room 1224 Drawer 1664			5.30	5.92
115		Room 1224 Drawer 1671			0.00	0.00
C-14		QC, C-14			105022.00	122095.00
116		Room 1224 Drawer 1678			0.00	0.00
117		Room 1224 Drawer 1689			0.00	0.00
118		Room 1224 Drawer 1699			0.00	0.00
119		Room 1224 Drawer 1701			1.22	1.36
120		Room 1224 Drawer 1705			0.00	0.00
121		Room 1224 Drawer 1712			0.00	0.00
122		Room 1224 Drawer 1722			3.26	3.74
123		Room 1224 Drawer 1726			0.00	0.00

RSA Laboratories
 A Division of Radiation Safety Associates
Radiochemistry Analysis Data Sheet

Page 1 of 2

Report No. N/A

Customer: Chemtura

Customer Samp No. N/A

Location: Drawers 1215,16,18,20, 21

RSA Lab Sample No. N/A

Project: Lab Decommissioning

Date Collected: 3/14/2011

Samp. Description: Survey Wip

Date Counted: 3/14/2011

Matrix: Wipes

C-14 LLD dpm= 38.26

RSA ID#	CUST. ID#	Location	C-14 CPM	dpm/100 cm sq
BG		BACKGROUND	31.20	
1		Room 1215 Drawer 462	10.10	11.20
2		Room 1215 Drawer 468	3.90	4.30
3		Room 1215 Drawer 470	5.50	6.60
4		Room 1215 Drawer 473	21.10	23.30
5		Room 1215 Drawer 482	19.30	21.40
6		Room 1215 Drawer 486	156.90	174.80
7		Room 1215 Drawer 493	13.00	14.30
8		Room 1215 Drawer 497	20.20	22.50
9		Room 1215 Drawer 498	20.60	23.20
10		Room 1215 Drawer 504	7.00	7.70
11		Room 1215 Drawer 508	9.70	10.90
12		Room 1215 Drawer 514	4.70	5.20
13		Room 1215 Drawer 516	21.30	23.50
14		Room 1215 Drawer 519	19.60	21.50
15		Room 1215 Drawer 524	41.20	45.80
16		Room 1215 Drawer 532	8.50	9.60
17		Room 1215 Drawer 535	16.30	18.50
18		Room 1215 Drawer 547	26.90	29.60
19		Room 1215 Drawer 553-554	11.00	12.10
20		Room 1215 Drawer 555	750.40	839.10
21		Room 1215 Drawer 568	19.10	21.20
22		Room 1215 Drawer 571	22.10	25.30
23		Room 1215 Drawer 572-573	15.00	17.80
C-14		QC C-14	121914.10	134741.40
24		Room 1215 Drawer 574-575	1.70	20.00
26		Room 1216 Drawer 576-577	0.40	0.40
27		Room 1216 Drawer 578-579	16.50	20.00
28		Room 1216 Drawer 580	10.00	11.00
29		Room 1216 Drawer 593	2.10	2.30
30		Room 1216 Drawer 600	12.30	13.50
31		Room 1216 Drawer 607	92.30	101.00
32		Room 1216 Drawer 610	28.00	30.60
33		Room 1216 Drawer 619	16.20	17.70
34		Room 1216 Drawer 627	15.00	16.40
35		Room 1216 Drawer 638	9.10	9.90

RSA Laboratories
 A Division of Radiation Safety Associates
Radiochemistry Analysis Data Sheet

RSA ID#	CUST. ID#	LOCATION	C-14 CPM	dpm/100 cm sq
36		Room 1216 Drawer 641	2.90	3.30
37		Room 1216 Drawer 648	10.70	11.70
38		Room 1216 Drawer 651-652	21.20	25.30
39		Room 1216 Drawer 656	7.20	7.80
40		Room 1216 Drawer 671	15.60	17.00
41		Room 1216 Drawer 679	9.10	9.90
42		Room 1216 Drawer 686	15.90	17.30
45		Room 1220 Drawer 806	10.00	10.80
46		Room 1220 Drawer 809	4.00	4.40
BL		QC Blank	20.10	21.90
47		Room 1220 Drawer 816	17.50	19.00
48		Room 1220 Drawer 819	11.50	12.50
49		Room 1220 Drawer 827	18.10	19.70
50		Room 1220 Drawer 826	7.40	8.10
52		Room 1221 Drawer 831	25.00	27.30
53		Room 1221 Drawer 838	11.50	12.50
54		Room 1221 Drawer 847	28.70	31.00
55		Room 1221 Drawer 854	5.80	6.40
56		Room 1221 Drawer 859	0.70	0.80
57		Room 1221 Drawer 867	8.70	9.70
58		Room 1221 Drawer 876	79.60	88.10
59		Room 1221 Drawer 880	17.70	19.40
60		Room 1221 Drawer 891	10.40	11.70
61		Room 1221 Drawer 893	26.70	30.30
62		Room 1221 Drawer 902	19.20	21.70
63		Room 1221 Drawer 904	8.40	9.30
64		Room 1221 Drawer 918	36.10	41.90
65		Room 1221 Drawer 919-920	25.90	29.60
66		Room 1221 Drawer 932	17.10	19.40
67		Room 1221 Drawer 938-939	15.80	18.30
68		Room 1221 Drawer 940-941	4.40	5.40
		Post Decon		
20R		Room 1215 Drawer 555 Re-Wipe	75.00	80.90

RSA Laboratories
 A Division of Radiation Safety Associates
Radiochemistry Analysis Data Sheet

Page 1 of 3

Report No. N/A

Customer: Chemtura

Customer Samp No. N/A

Location: Drawers 1205, 06, 07, 08, 10

RSA Lab Sample No. N/A

Project: Lab Decommissioning

Date Collected: 3/10/2011

Samp. Description: Survey Wipes

Date Counted: 3/10/2011

Matrix: Wipes

C-14 LLD dpm= 39.35

RSA ID#	CUST. ID#	Location	C-14 CPM	dpm/100 cm sq
BG		BACKGROUND	33.20	
1		Lab 1205 Drawer 1	18.60	21.70
2		Lab 1205 Drawer 12	13.50	15.80
3		Lab 1205 Drawer 24	25.30	28.70
4		Lab 1205 Drawer 31	15.70	1.00
5		Lab 1205 Drawer 33	24.00	27.60
6		Lab 1205 Drawer 65	7.00	8.20
7		Lab 1205 Drawer 56 48	17.10	19.50
8		Lab 1205 Drawer 56	14.20	16.60
9		Lab 1205 Drawer 43	17.30	19.60
10		Lab 1205 Drawer 41	24.10	28.70
11		Lab 1205 Drawer 69	6.40	7.60
12		Lab 1205 Drawer 71	7.70	9.10
13		Lab 1205 Drawer 93-94	25.40	31.70
14		Lab 1205 Drawer 84	272.40	315.80
15		Lab 1205 Drawer 100	24.10	27.50
16		Lab 1205 Drawer 117	20.20	24.30
17		Lab 1205 Drawer 118	11.80	13.70
19		Lab 1206 Drawer 120	15.00	17.20
20		Lab 1206 Drawer 122	182.20	210.40
21		Lab 1206 Drawer 125	35.40	41.30
22		Lab 1206 Drawer 129	9.10	10.60
23		Lab 1206 Drawer 133	0.00	0.00
C-14		QC C-14	125309.90	135660.80
24		Lab 1206 Drawer 137	16.60	20.50
25		Lab 1206 Drawer 168	13.00	15.00
26		Lab 1206 Drawer 160	15.40	17.90
27		Lab 1206 Drawer 157	25.50	29.50
28		Lab 1206 Drawer 154	13.70	15.70
29		Lab 1206 Drawer 163	21.20	25.10
30		Lab 1206 Drawer 146	29.10	34.30
31		Lab 1206 Drawer 171	34.20	39.00
32		Lab 1206 Drawer 177	35.40	41.30
33		Lab 1206 Drawer 186	26.00	29.70
34		Lab 1206 Drawer 189	14.40	16.60
35		Lab 1206 Drawer 191	11.90	13.50

RSA Laboratories
 A Division of Radiation Safety Associates
Radiochemistry Analysis Data Sheet

Page 2 of 3

RSA ID#	CUST. ID#	LOCATION			C-14 CPM	dpm/100 cm sq
36		Lab 1206 Drawer 197			21.00	24.30
37		Lab 1206 Drawer 220			15.30	17.60
38		Lab 1206 Drawer 222			2.50	3.00
39		Lab 1206 Drawer 223			13.10	15.30
40		Lab 1206 Drawer 217			16.80	19.50
41		Lab 1206 Drawer 207			55.10	63.20
42		Lab 1206 Drawer 204			177.90	206.20
43		Lab 1206 Drawer 198-199			40.30	46.30
44		Lab 1206 Drawer 200-201			32.90	37.70
46		Lab 1207 Drawer 224-225			154.40	184.20
BL		QC Blank			19.50	21.30
47		Lab 1207 Drawer 226-227			18.70	22.00
48		Lab 1207 Drawer 229			54.30	63.20
49		Lab 1207 Drawer 242			3.70	4.10
50		Lab 1207 Drawer 298-299			56.20	64.60
51		Lab 1207 Drawer 244			25.80	30.20
52		Lab 1207 Drawer 250			45.00	52.90
53		Lab 1207 Drawer 253			73.10	83.00
54		Lab 1207 Drawer 260			73.10	82.90
55		Lab 1207 Drawer 268			67.40	76.80
56		Lab 1207 Drawer 270			166.90	190.90
57		Lab 1207 Drawer 274			39.30	45.50
58		Lab 1207 Drawer 281			36.80	42.00
59		Lab 1207 Drawer 283			47.40	53.80
60		Lab 1207 Drawer 287			42.70	49.00
61		Lab 1207 Drawer 297			25.70	29.50
62		Lab 1207 Drawer 301			28.90	33.20
63		Lab 1207 Drawer 309			16.60	19.20
64		Lab 1207 Drawer 317			6.20	7.10
65		Lab 1207 Drawer 321-322			19.20	22.20
66		Lab 1207 Drawer 323-324			43.40	52.50
68		Lab 1208 Drawer 325-326			48.70	57.00
69		Lab 1208 Drawer 327.328			20.50	24.50
C-14		QC C-14			117614.30	133485.70
70		Lab 1208 Drawer 332			22.10	25.10
71		Lab 1208 Drawer 340			20.30	23.40
72		Lab 1208 Drawer 341			1.00	1.20
73		Lab 1208 Drawer 349			30.80	35.60
74		Lab 1208 Drawer 356			19.50	22.50
75		Lab 1208 Drawer 364			48.60	55.20
76		Lab 1208 Drawer 369			0.70	0.80
77		Lab 1208 Drawer 372			23.40	27.00
78		Lab 1208 Drawer 378			21.70	25.60
79		Lab 1208 Drawer 390			6.80	7.70
80		Lab 1208 Drawer 394			56.30	63.70
81		Lab 1208 Drawer 401-402			16.30	18.40
82		Lab 1208 Drawer 407			44.80	51.70

RSA Laboratories

A Division of Radiation Safety Associates

Radiochemistry Analysis Data Sheet

Page 3 of 3

RSA ID#	CUST. ID#	LOCATION		C-14 CPM	dpm/100 cm sq
83		Lab 1208 Drawer 421		37.70	43.40
84		Lab 1208 Drawer 424		29.10	34
85		Lab 1208 Drawer 430		66.30	75.10
86		Lab 1208 Drawer 434		16.50	18.70
87		Lab 1208 Drawer 433		35.80	40.60
89		Lab 1210 Drawer 440-441		19.40	22.30
90		Lab 1210 Drawer 442-443		5.90	7.00
91		Lab 1210 Drawer 445		12.80	14.60
92		Lab 1210 Drawer 449		11.60	13.10
BL		QC Blank		15.50	16.90
93		Lab 1210 Drawer 454		14.30	16.10
94		Lab 1210 Drawer 460		18.00	20.50
		POST DECON			
14R		Lab 1205 Drawer 84 Re-Wipe		13.70	14.80
42R		Lab 1206 Drawer 204 Re-Wipe		6.40	6.90

Radiochemistry Analysis Data Sheet

Page 1 of 1

Report No. N/A

Customer: Chemtura

Customer Samp No. N/A

Location: Drawers 1218

RSA Lab Sample No. N/A

Project: Lab Decommissioning

Date Collected: 3/14/2011

Samp. Description: Survey Wipes

Date Counted: 3/14/2011

Matrix: Wipes

C-14 LLD dpm= 38.87

RSA ID#	CUST. ID#	Location		C-14 CPM	dpm/100 cm sq
BG		BACKGROUND		32.30	
1		Room 1218 Drawer 691-692		12.60	14.10
2		Room 1218 Drawer 693-694		13.50	15.10
3		Room 1218 Drawer 697		0.00	0.00
4		Room 1218 Drawer 704		9.90	10.90
5		Room 1218 Drawer 707		0.00	0.00
6		Room 1218 Drawer 715		13.00	14.20
7		Room 1218 Drawer 725		14.80	16.10
8		Room 1218 Drawer 735		13.50	14.70
9		Room 1218 Drawer 740		12.20	13.30
10		Room 1218 Drawer 747		6.50	7.10
11		Room 1218 Drawer 755		14.40	15.80
12		Room 1218 Drawer 762		13.60	14.90
13		Room 1218 Drawer 766-767		10.30	11.40
14		Room 1218 Drawer 776		18.00	19.60
15		Room 1218 Drawer 786		41.30	45.00
16		Room 1218 Drawer 793		10.30	11.20
17		Room 1218 Drawer 803		6.50	7.00
C-14		QC C-14		124706.80	134876.40
BL		QC Blank		8.70	9.50

Jay R. Dockendorff
Laboratory Director

Drawers and Cabinets—Scoping Survey

Each drawer and cabinet was numbered for easy identification. There are a total of more than 1700 of them in these laboratories.

Scan surveys were made in virtually 100% of drawers and under-bench cabinets concentrating on under-hood cabinets and drawers in proximity to identified contaminated areas.

Standard wipe surveys (100 cm²) were taken in 18% of drawers and cabinets (322 wipes, 1725 drawers and cabinets). The results of these surveys are contained in this attachment.

Attachment GG

Survey Unit 1 Final Status Survey Results

Contents

Page

2	Floor plan showing FSS random-start sample points
3	Drawing of a 8-foot fume hood
4	Room 1215 wipe locations
5	Room 1216 wipe locations
6	Room 1217 wipe locations
7	Room 1218 wipe locations
8	Room 1219 wipe locations
9-10	Wipe results
11	Room 1215 direct measurement locations
12	Room 1215 direct measurement results
13	Room 1216 direct measurement locations
14	Room 1216 direct measurement results
15	Room 1217 direct measurement locations
16	Room 1217 direct measurement results
17	Room 1218 direct measurement locations
18	Room 1218 direct measurement results
19	Room 1219 direct measurement locations
20	Room 1219 direct measurement results

Survey Unit 1 Final Status Survey
 Rooms 1215-1219

Attachment GG

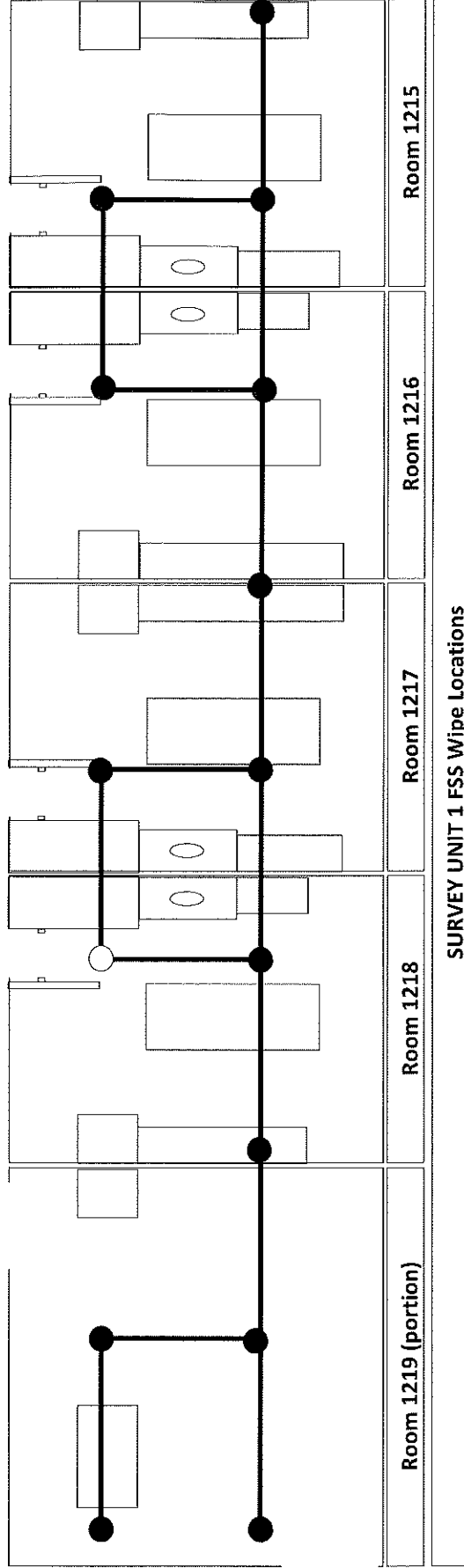

○ = Random start point

RADIATION SAFETY ASSOCIATES

Rooms 1215-1219

19 Pendleton Drive
 Hebron, CT 06248
 (860) 228-0487

8 Foot fume hood

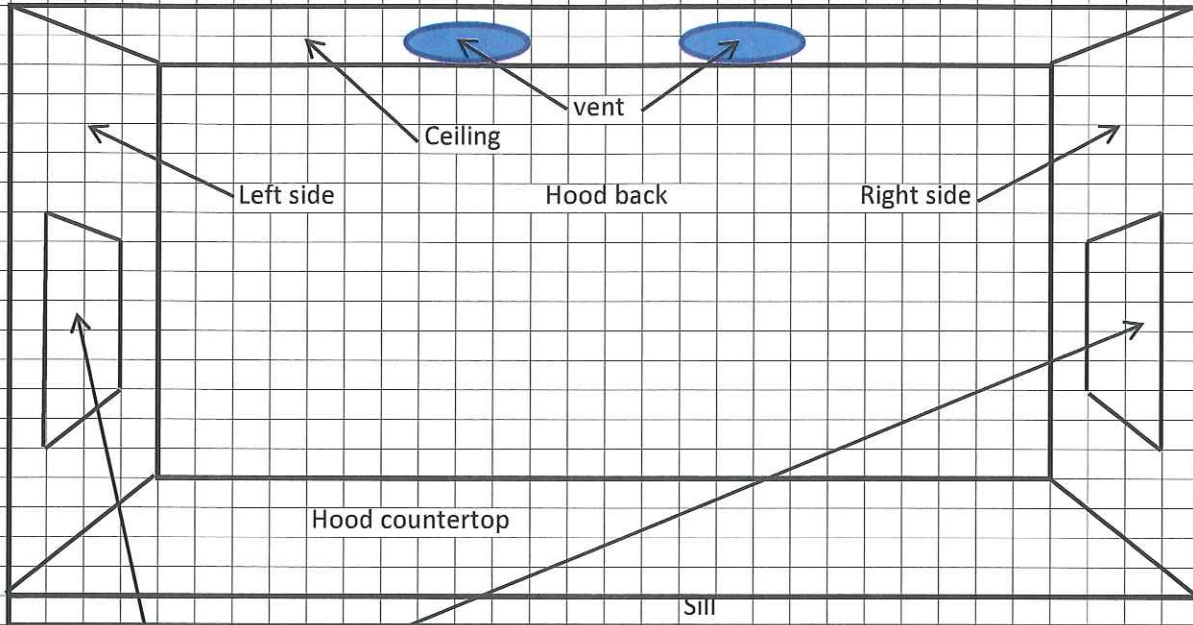

Transite hood side view

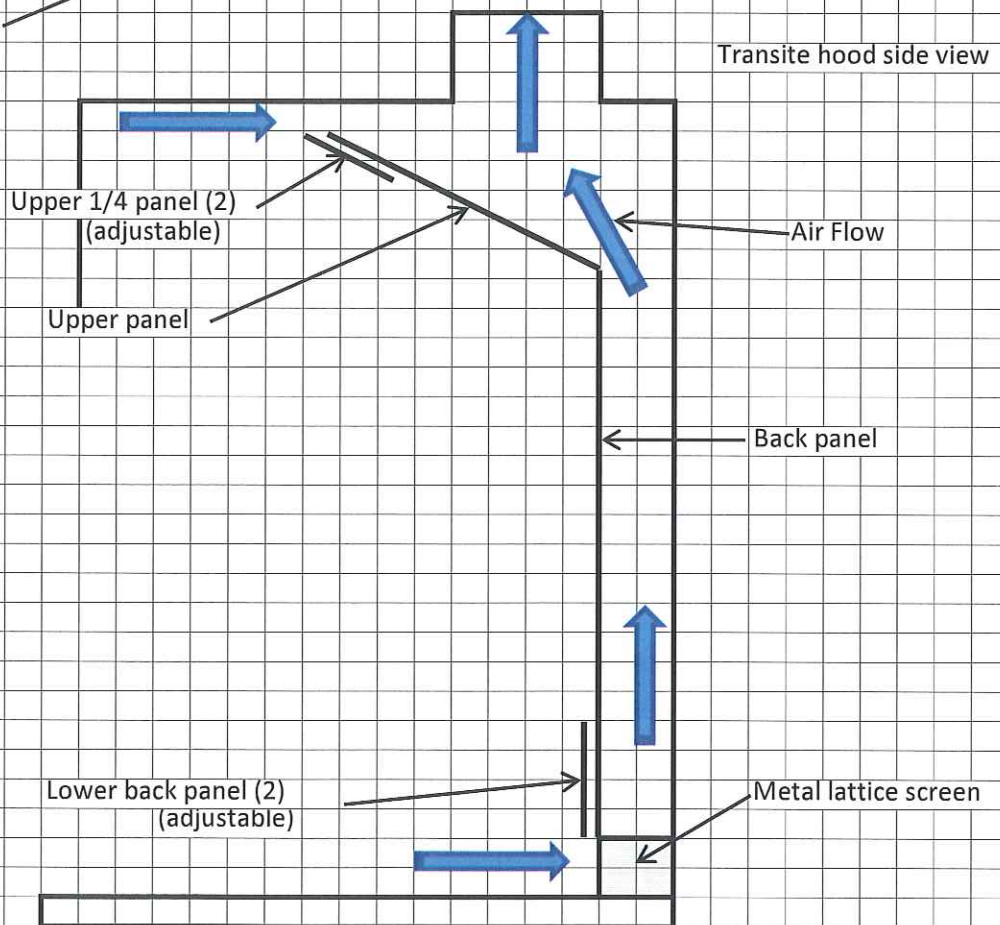

The following are removable

- 1 Upper 1/4 panel
- 2 Upper panel
- 3 Back panel
- 4 Lower Back panel
- 5 Side panel
- 6 Metal lattice screen

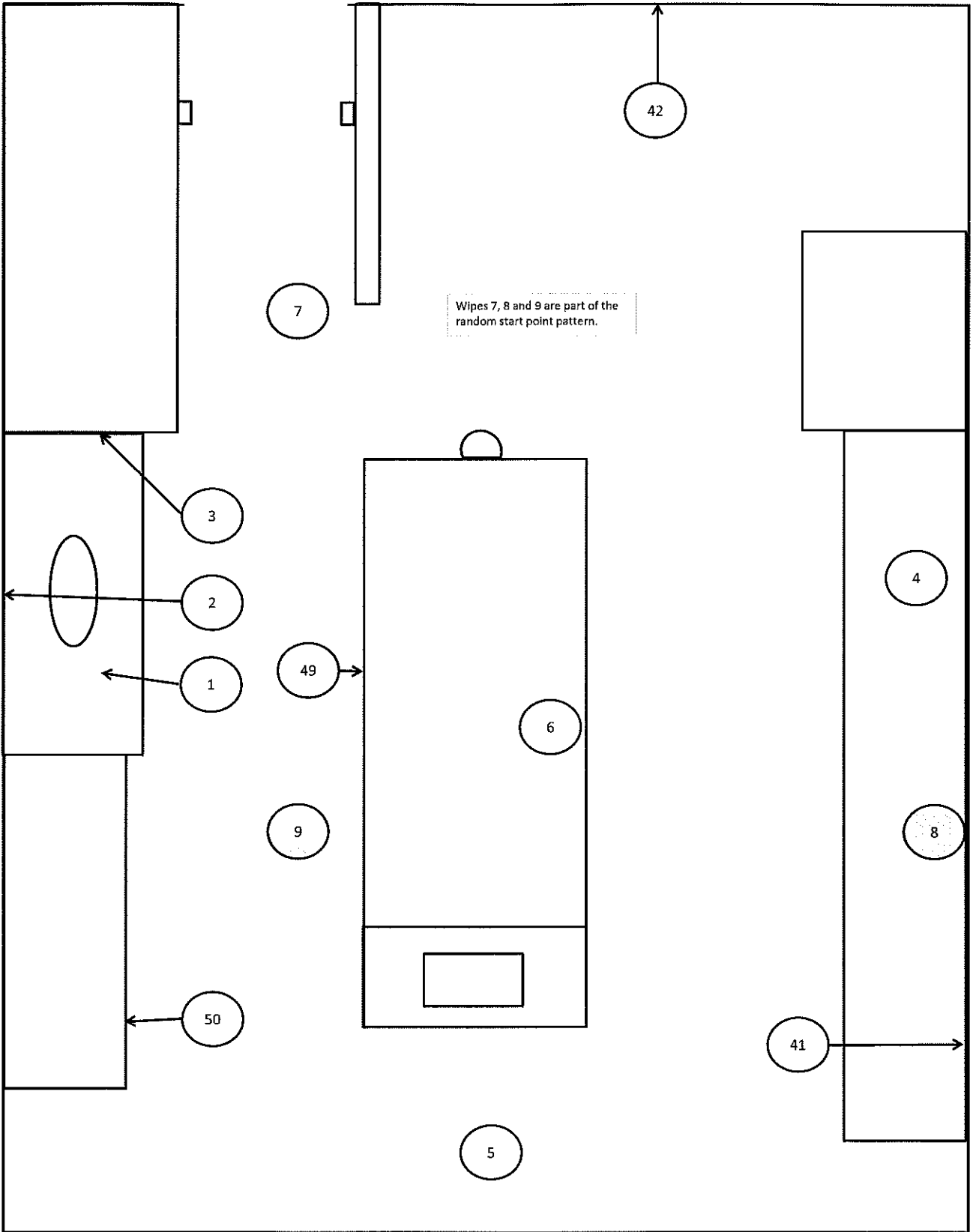

Room 1215 FSS Wipe Locations

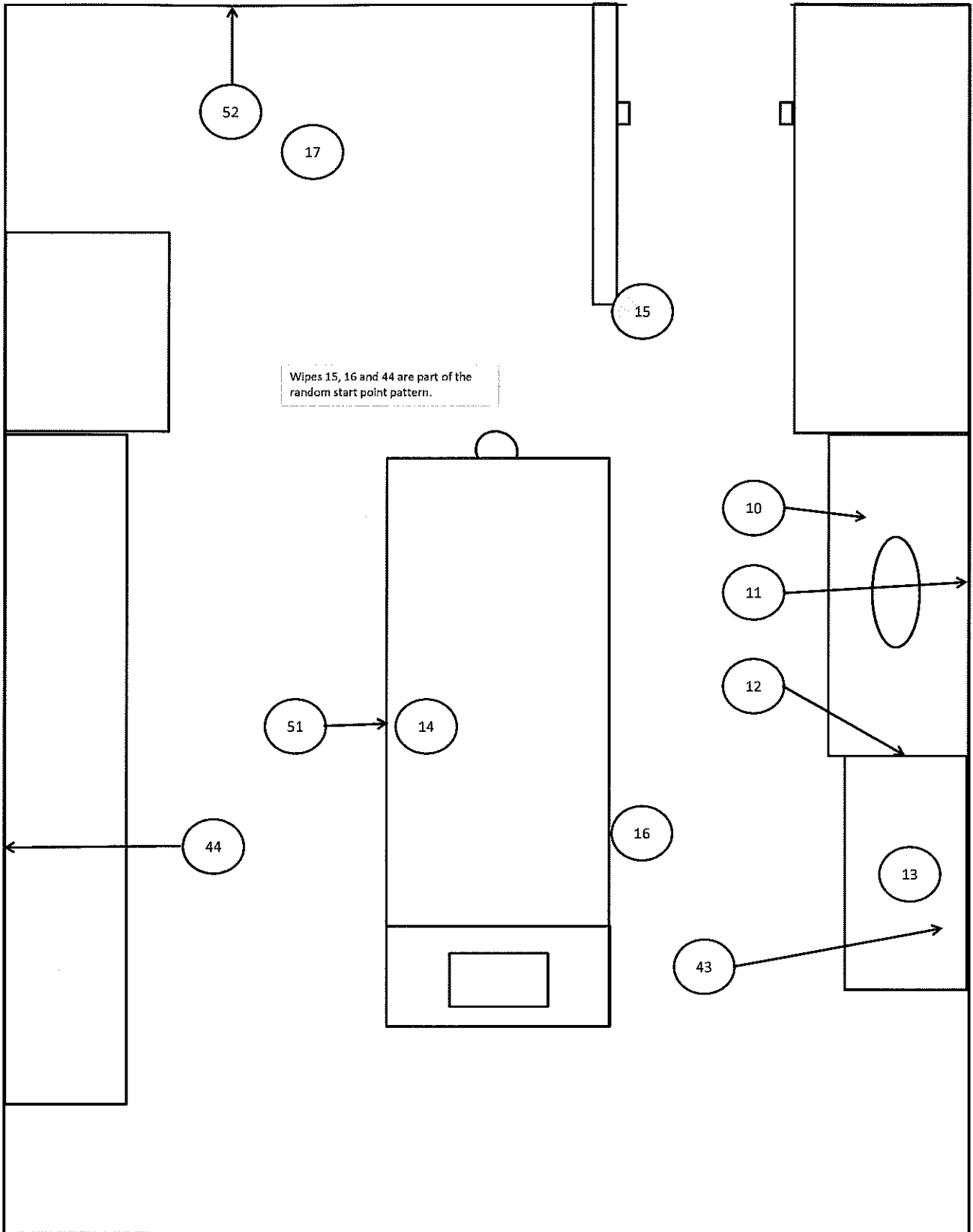

Room 1216 FSS Wipe Locations

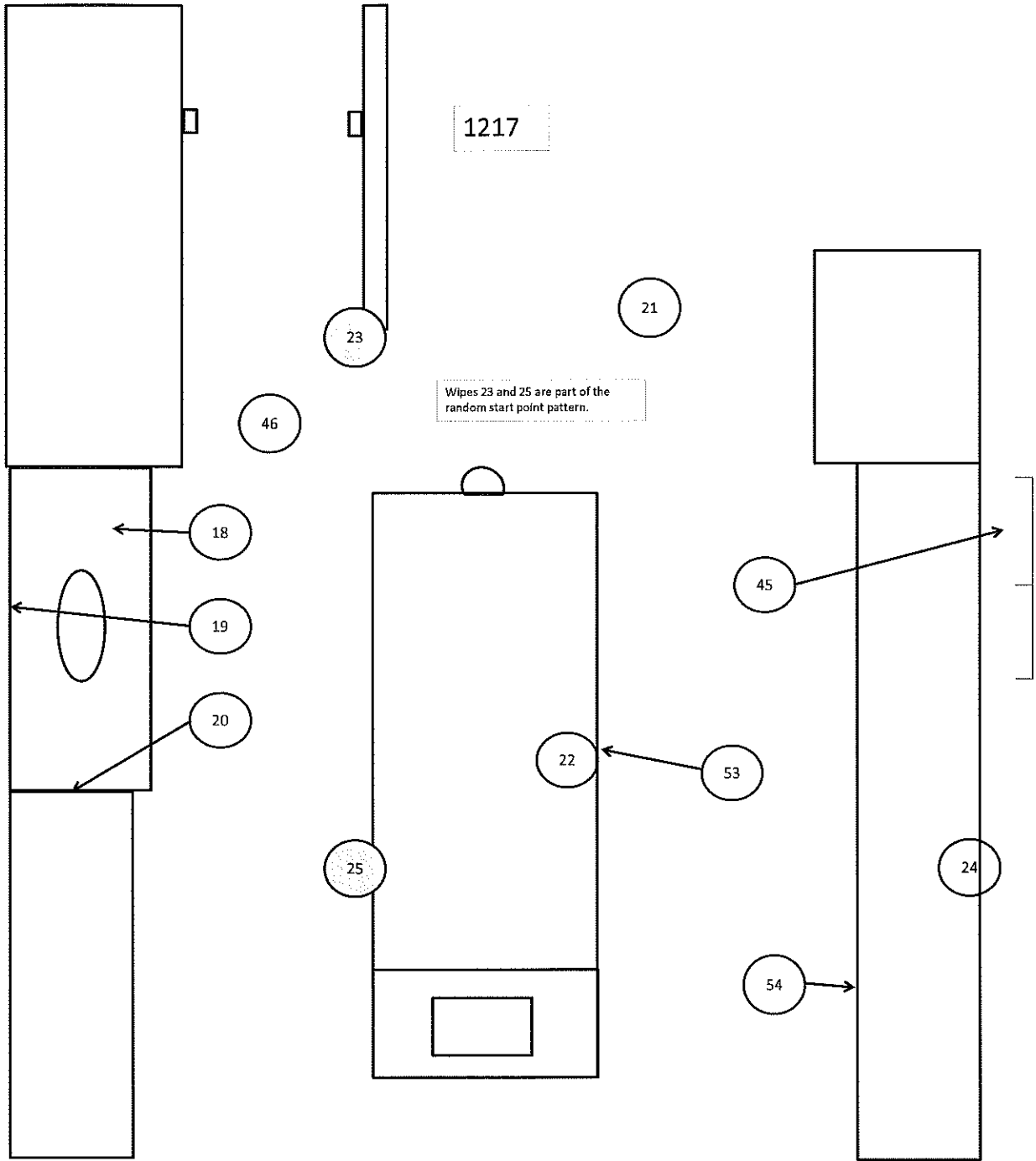

Room 1217 FSS Wipe Locations

Survey Unit 1 Final Status Survey
Rooms 1215-1219

Attachment GG

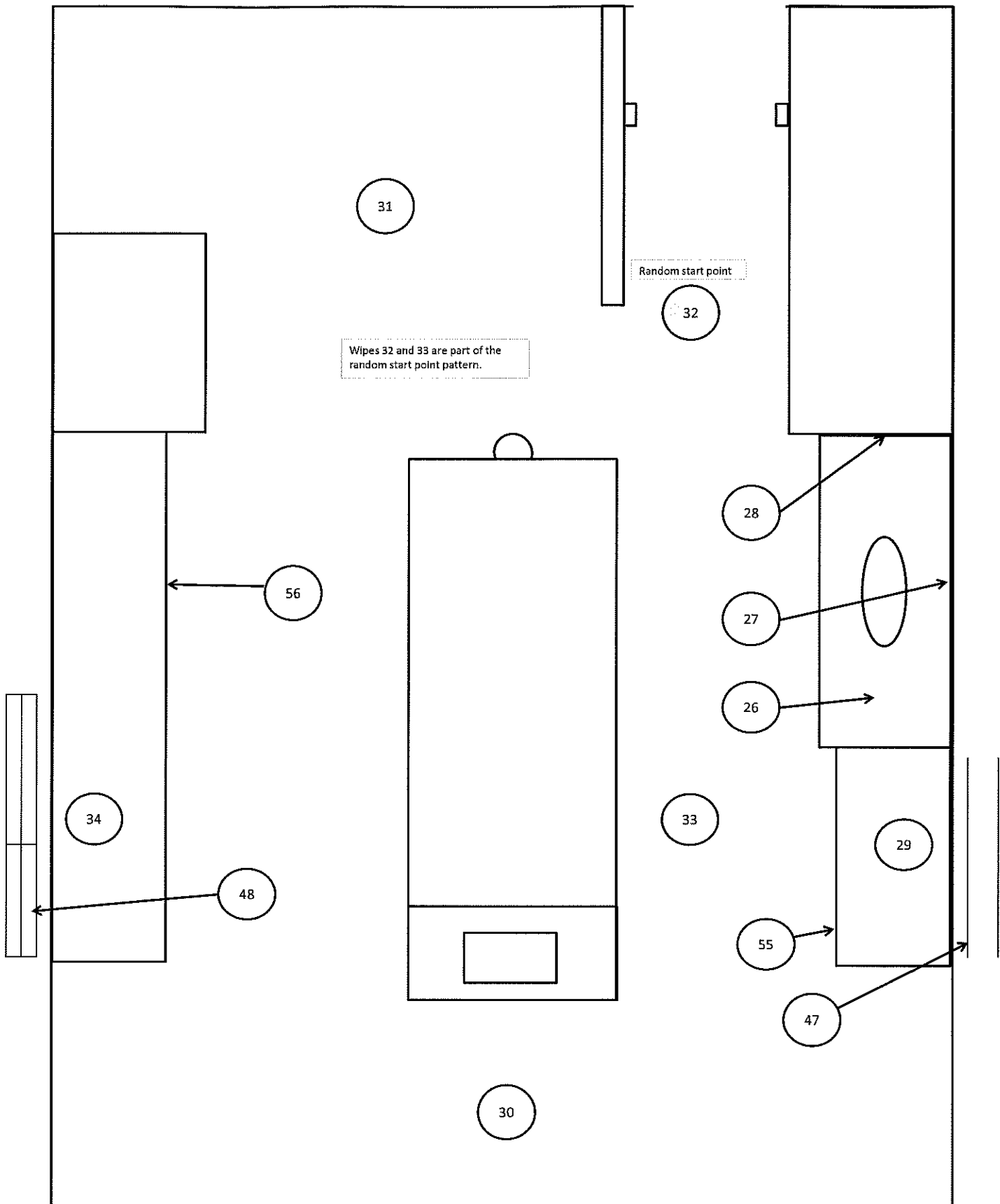

Room 1218 FSS Wipe Locations

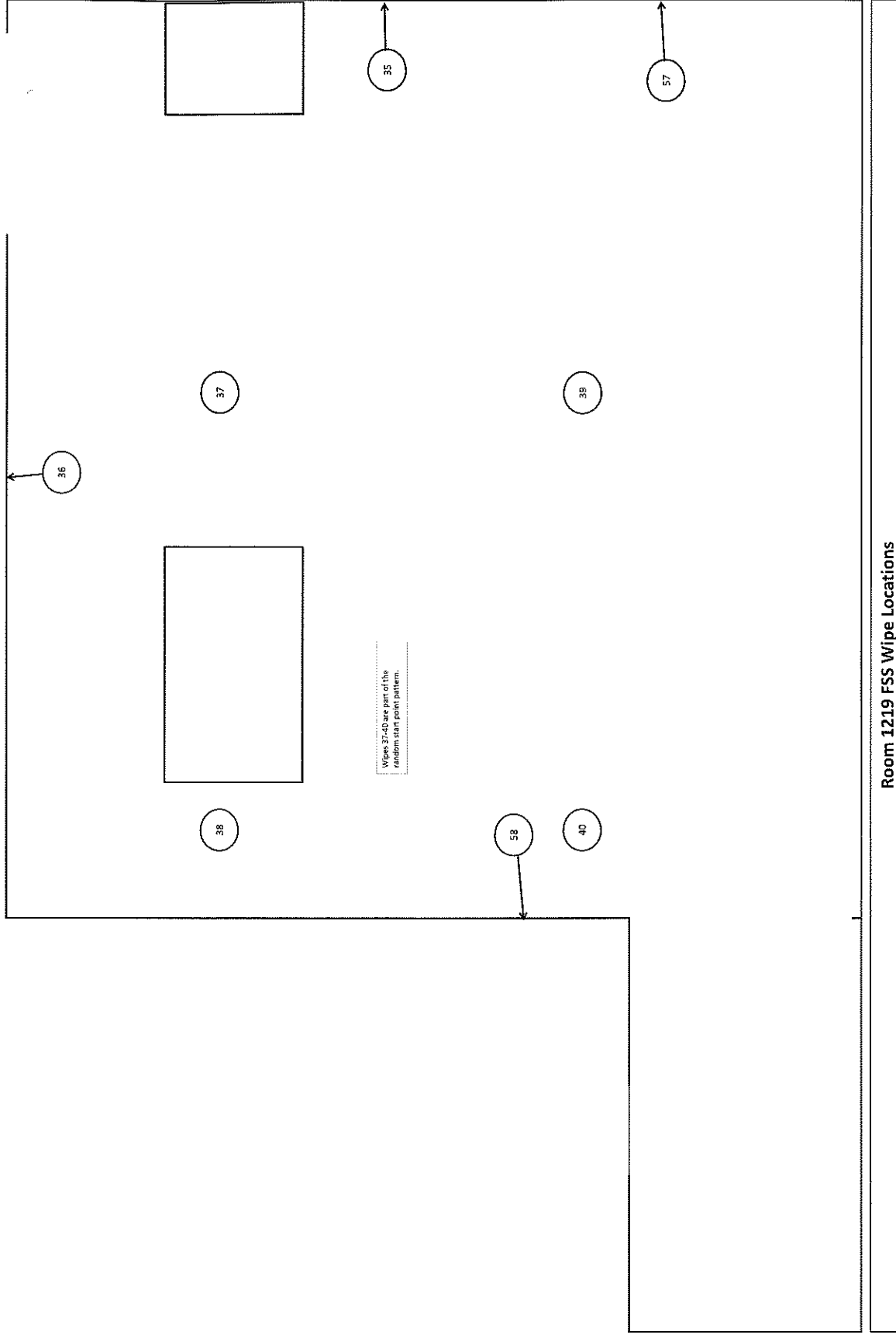

Survey Unit 1 Final Status Survey
RSA Laboratories
A Division of Radiation Safety Associates
Radiochemistry Analysis Data Sheet

Attachment GG

Page 1 of 2

Report No. N/A

Customer: Chemtura

Customer Samp No. N/A

Location: Survey Unit 1 Wipes

RSA Lab Sample No. N/A

Project: Lab Decommissioning

Date Collected: 5/3/2011

Samp. Description: FS Survey Wipes

Date Counted: 5/3/2011

Matrix: Wipes

Area: 100 cm sq

C-14 LLD dpm= 37.07

RSA ID#	CUST. ID#	Location	C-14 CPM	C-14 DPM
BG		BACKGROUND	29.10	
1		Room 1215 Hood Counter	0.00	0.00
2		Room 1215 Hood Back	13.20	14.40
3		Room 1215 Hood Right Side	14.60	15.90
4		Room 1215 Counter	6.80	7.40
5		Room 1215 Floor	15.50	16.80
6		Room 1215 Countertop	21.90	23.70
7		Room 1215 FS Gridpoint 2	24.50	26.60
8		Room 1215 FS Gridpoint 10	18.80	20.50
9		Room 1215 FS Gridpoint 11	8.40	9.20
10		Room 1216 Hood Counter	21.30	23.20
11		Room 1216 Hood Back	9.90	10.80
12		Room 1216 Hood Right Side	12.60	13.60
13		Room 1216 Countertop	19.50	21.20
14		Room 1216 Countertop	18.80	20.40
15		Room 1216 FS Gridpoint 3	10.90	11.80
16		Room 1216 FS Gridpoint 12	9.60	10.40
17		Room 1216 Floor	7.50	8.20
18		Room 1217 Hood Counter	13.30	14.40
19		Room 1217 Hood Back	9.90	10.70
20		Room 1217 Hood Left Side	6.70	7.30
21		Room 1217 Floor	15.80	17.20
22		Room 1217 Countertop	19.20	20.90
23		Room 1217 FS Grid Point 5	17.40	18.90
C-14		QC C-14	116920.50	126318.60
24		Room 1217 FS Grid Point 13	17.50	19.00
25		Room 1217 FS Grid Point 14	11.10	12.00
26		Room 1218 Hood Counter	9.70	10.60
27		Room 1218 Hood Back	9.60	10.40
28		Room 1218 Hood Left Side	16.90	18.40
29		Room 1218 Counter	10.10	11.00
30		Room 1218 Floor	15.70	17.10
31		Room 1218Floor	9.70	10.60
32		Room 1218 FS Grid Point 6	33.30	36.20
33		Room 1218 FS Grid Point 15	16.80	18.30
34		Room 1218 FS Grid Point 16	9.40	10.20

Radiochemistry Analysis Data Sheet

RSA ID#	CUST. ID#	LOCATION			C-14 CPM	C-14 DPM		0 DPM
35		Room 1219 Wall			26.10	28.40		
36		Room 1219 Wall			6.30	6.80		
37		Room 1219 FS Grid Point 8			10.00	10.90		
38		Room 1219 FS Grid Point 9			20.30	22.10		
39		Room 1219 FS Grid Point 17			14.50	15.70		
40		Room 1219 FS Grid Point 18			21.70	23.60		
41		Room 1215 Wall			6.50	7.00		
42		Room 1215 Wall			19.30	20.90		
43		Room 1216 Shelf			0.60	0.70		
44		Room 1216 Wall			11.70	12.70		
45		Room 1217 Cabinet			8.50	9.20		
46		Room 1217 Wall			11.80	12.80		
BL		QC Blank			10.50	11.40		
47		Room 1218 Shelf			17.90	19.70		
48		Room 1218 Cabinet			18.30	20.00		
49		Room 1215 Drawer 537			16.10	17.70		
50		Room 1215 Drawer 551			13.50	14.80		
51		Room 1216 Drawer 636			34.30	37.30		
52		Room 1216 Wall			12.40	13.50		
53		Room 1217 Drawer			16.90	18.40		
54		Room 1217 Drawer			13.30	14.60		
55		Room 1218 Drawer 709			6.30	6.90		
56		Room 1218 Drawer 802			5.50	5.90		
57		Room 1219 Wall			9.70	10.60		
58		Room 1219 Wall			11.20	12.20		

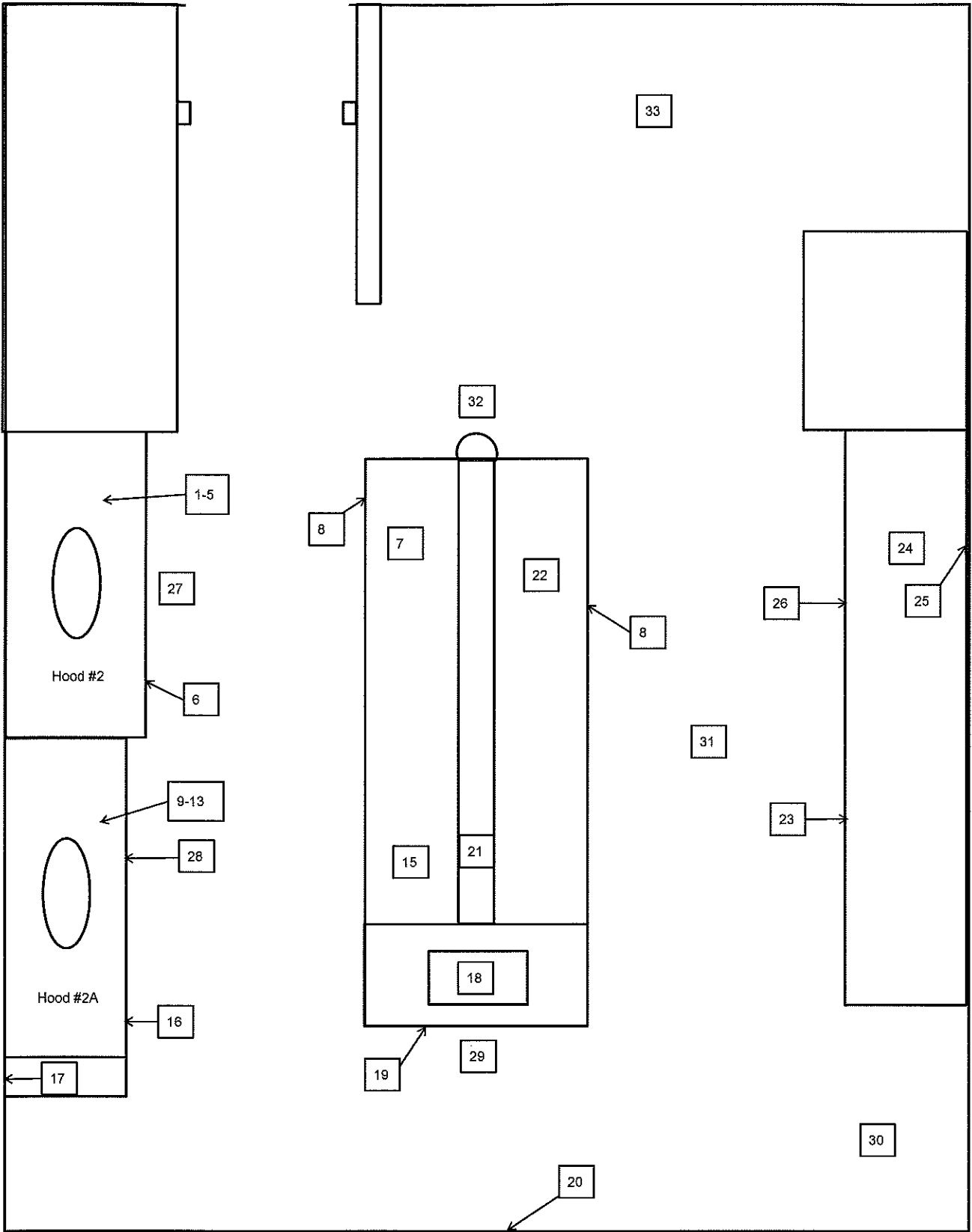

Room 1215 FSS Direct Measurement Locations

**Survey Unit 1 Final Status Survey
Rooms 1215-1219**

Attachment GG

Chemtura Corporation, Middlebury, CT

Direct Measurements -- Room 1215

Date: 4/29/2011

Meter #1: Ludlum 2224-1 s/n 129459 w/43-68 s/n 111315

MDA: 914 dpm/100 cm²

C-14 efficiency (%): 7.2

Background (5 min. count): 2730 **Beta cpm:** 546

#	Location	Gross Beta (2 min. count)	Gross Beta cpm	Beta dpm/100 cm sq
1	hood #2 - base	1142	571	347
2	hood #2 - left wall	1094	547	14
3	hood #2 - right wall	1114	557	153
4	hood #2 - back wall	1148	574	389
5	hood #2 - ceiling	1114	557	153
6	hood #2 - cabinet	1120	560	194
7	counter opp. hood #2	1061	530.5	-215
8	drawer #530, opp. hood #2	1052	526	-278
9	hood #2A - base	1125	562.5	229
10	hood #2A - left wall	1074	537	-125
11	hood #2A - right wall	1019	509.5	-507
12	hood #2A - back wall	1009	504.5	-576
13	hood #2A - ceiling	1018	509	-514
14	hood #2A - cabinet	1095	547.5	21
15	counter opp. hood #2A	1090	545	-14
16	drawer #560, below hood #2A	1072	536	-139
17	wall adj. hood #2A	1080	540	-83
18	sink	1350	675	1792
19	sink cabinet	1123	561.5	215
20	radiator opp. sink	1052	526	-278
21	counter shelf - left	1089	544.5	-21
22	counter - right	1053	526.5	-271
23	wall counter - cabinet	1091	545.5	-7
24	wall counter - left - near vent	1057	528.5	-243
25	wall counter wall - near vent	1145	572.5	368
26	drawer #473	1156	578	444

* Decontaminated with no effect. Sink left in place. Meets State DCGL and ALARA goal.

MDA: 309 dpm/100 cm²

C-14 efficiency (%): 4.7

Background (5 min. count): 2450 **Beta cpm:** 490

#	Location	Gross Beta (2 min. count)	Gross Beta cpm	Beta dpm/100 cm sq
27	floor - hood 2	958	479	-55
28	floor - hood 2A	1129	564.5	373
29	floor - sink	924	462	-140
30	floor - refrigerator (gone)	967	483.5	-33
31	floor - center aisle	1207	603.5	568
32	floor - eyewash	1042	521	155
33	floor - desk area	924	462	-140

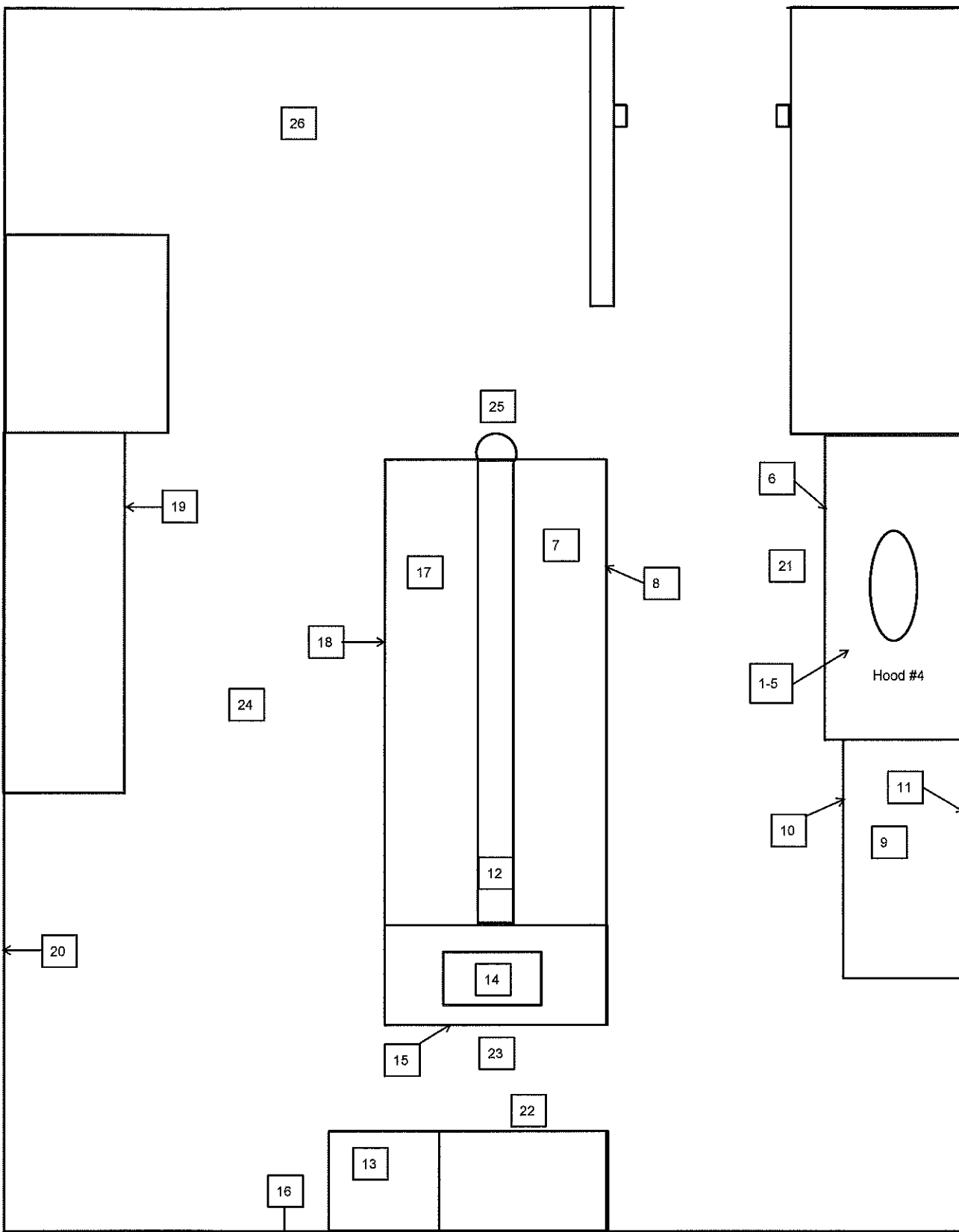

Room 1216 FSS Direct Measurement Locations

**Survey Unit 1 Final Status Survey
Rooms 1215-1219**

Attachment GG

Chemtura Corporation, Middlebury, CT

Direct Measurements -- Room 1216

Date: 4/29/2011

Meter #1: Ludlum 2224-1 s/n 129459 w/43-68 s/n 111315

MDA: 914 dpm/100 cm²

C-14 efficiency (%): 7.2

Background (5 min. count): 2730 **Beta cpm:** 546

#	Location	Gross Beta (2 min. count)	Gross Beta cpm	Beta dpm/100 cm sq
1	hood #4 - base	1063	531.5	-201
2	hood #4 - left wall	1211	605.5	826
3	hood #4 - right wall	1079	539.5	-90
4	hood #4 - back wall	1202	601	764
5	hood #4 - ceiling	1114	557	153
6	hood #4 - cabinet	1115	557.5	160
7	counter opp. hood #4	1098	549	42
8	drawer #614, opp. hood #4	1110	555	125
9	prep area adj. hood #4	1054	527	-264
10	drawer #580, below prep area	1088	544	-28
11	wall adj. hood #4	1093	546.5	7
12	counter shelf - left	1162	581	486
13	LSC table	1033	516.5	-410
14	sink	1086	543	-42
15	sink cabinet	1072	536	-139
16	radiator adj. LSC	1111	555.5	132
17	counter - left	1117	558.5	174
18	drawer #639	1060	530	-222
19	wall counter - cabinet	1069	534.5	-160
20	wall adj. sink	1083	541.5	-63

Meter #2: Ludlum 2224 s/n 119815 w/43-37 s/n 160827

MDA: 1053 dpm/100 cm²

C-14 efficiency (%): 4.7

Background (5 min. count): 2450 **Beta cpm:** 490

#	Location	Gross Beta (2 min. count)	Gross Beta cpm	Beta dpm/100 cm sq
21	floor - hood #4	973	486.5	-18
22	floor - LSC	1654	827	1687
23	floor - sink	1990	995	2528
24	floor - center aisle	1509	754.5	1324
25	floor - eyewash	1031	515.5	128
26	floor - desk area	1380	690	1001

* Floor tile removed

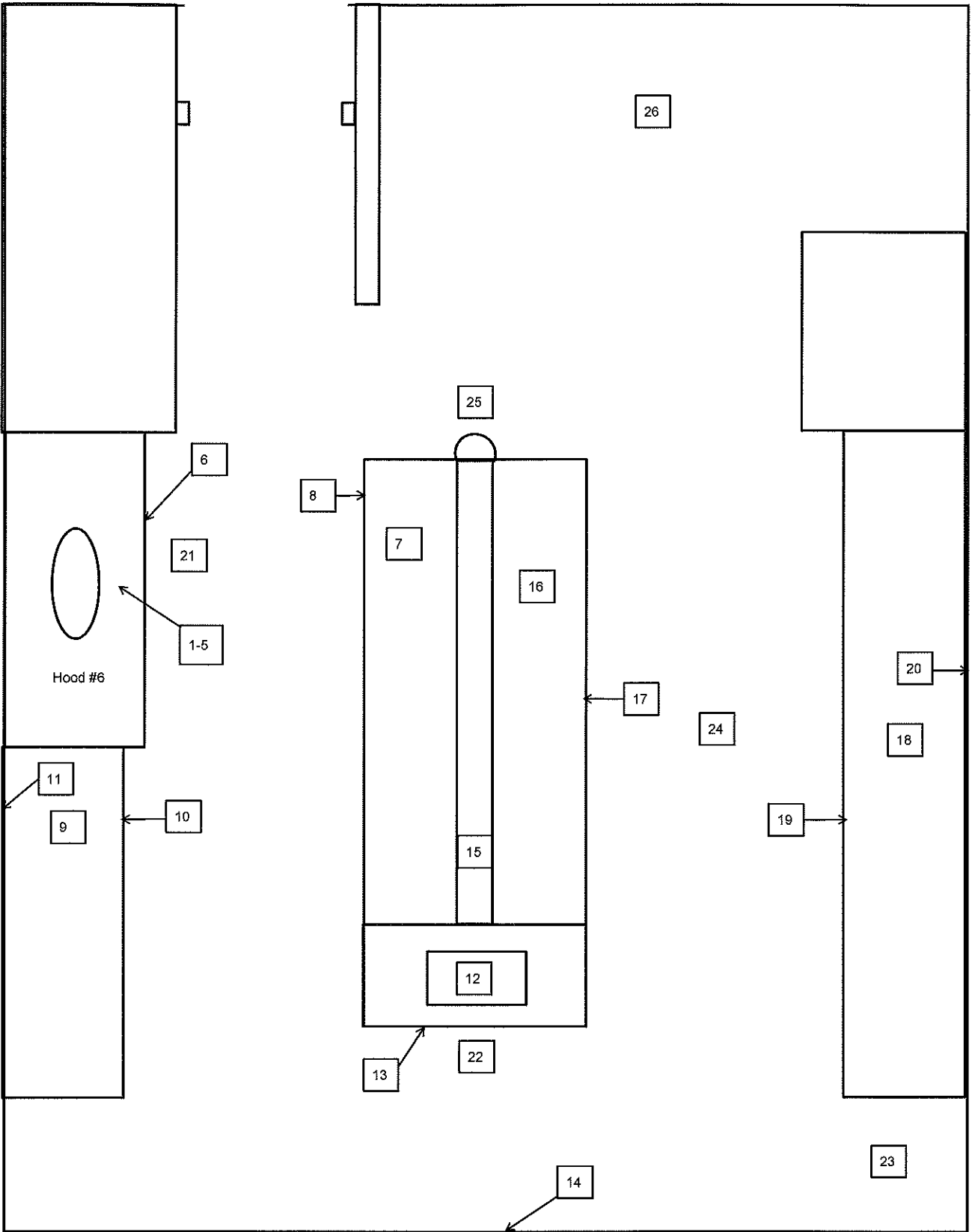

Room 1217 FSS Direct Measurement Locations

**Survey Unit 1 Final Status Survey
Rooms 1215-1219**

Attachment GG

Chemtura Corporation, Middlebury, CT

Direct Measurements -- Room 1217

Date: 4/29/2011

Meter #1: Ludlum 2224-1 s/n 129459 w/43-68 s/n 111315

MDA: 914 dpm/100 cm²

C-14 efficiency (%): 7.2

Background (5 min. count): 2730 **Beta cpm:** 546

#	Location	Gross Beta (2 min. count)	Gross Beta cpm	Beta dpm/100 cm sq
1	hood #6 - base	1098	549	42
2	hood #6 - left wall	1063	531.5	-201
3	hood #6 - right wall	1096	548	28
4	hood #6 - back wall	1190	595	681
5	hood #6 - ceiling	1117	558.5	174
6	hood #6 - cabinet	1157	578.5	451
7	counter opp. hood #6	1071	535.5	-146
8	drawer opp. hood #6, top thin	1074	537	-125
9	counter adj. hood #6	1054	527	-264
10	drawer adj. hood #6, top thin	1110	555	125
11	wall adj. hood #6	1072	536	-139
12	sink	1106	553	97
13	sink cabinet	1172	586	556
14	radiator opp. sink	1151	575.5	410
15	counter shelf - left	1067	533.5	-174
16	counter - right	1041	520.5	-354
17	drawer - center counter	1038	519	-375
18	wall counter - center	1080	540	-83
19	wall counter - right cabinet	1156	578	444
20	wall counter - wall	1140	570	333

Meter #2: Ludlum 2224 s/n 119815 w/43-37 s/n 160827

MDA: 309 dpm/100 cm²

C-14 efficiency (%): 4.7

Background (5 min. count): 2450 **Beta cpm:** 490

#	Location	Gross Beta (2 min. count)	Gross Beta cpm	Beta dpm/100 cm sq
21	floor - hood #6	960	480	-50
22	floor - sink	849	424.5	-328
23	floor - refrigerator (removed)	942	471	-95
24	floor - center aisle	996	498	40
25	floor - eyewash	974	487	-15
26	floor - desk area	957	478.5	-58

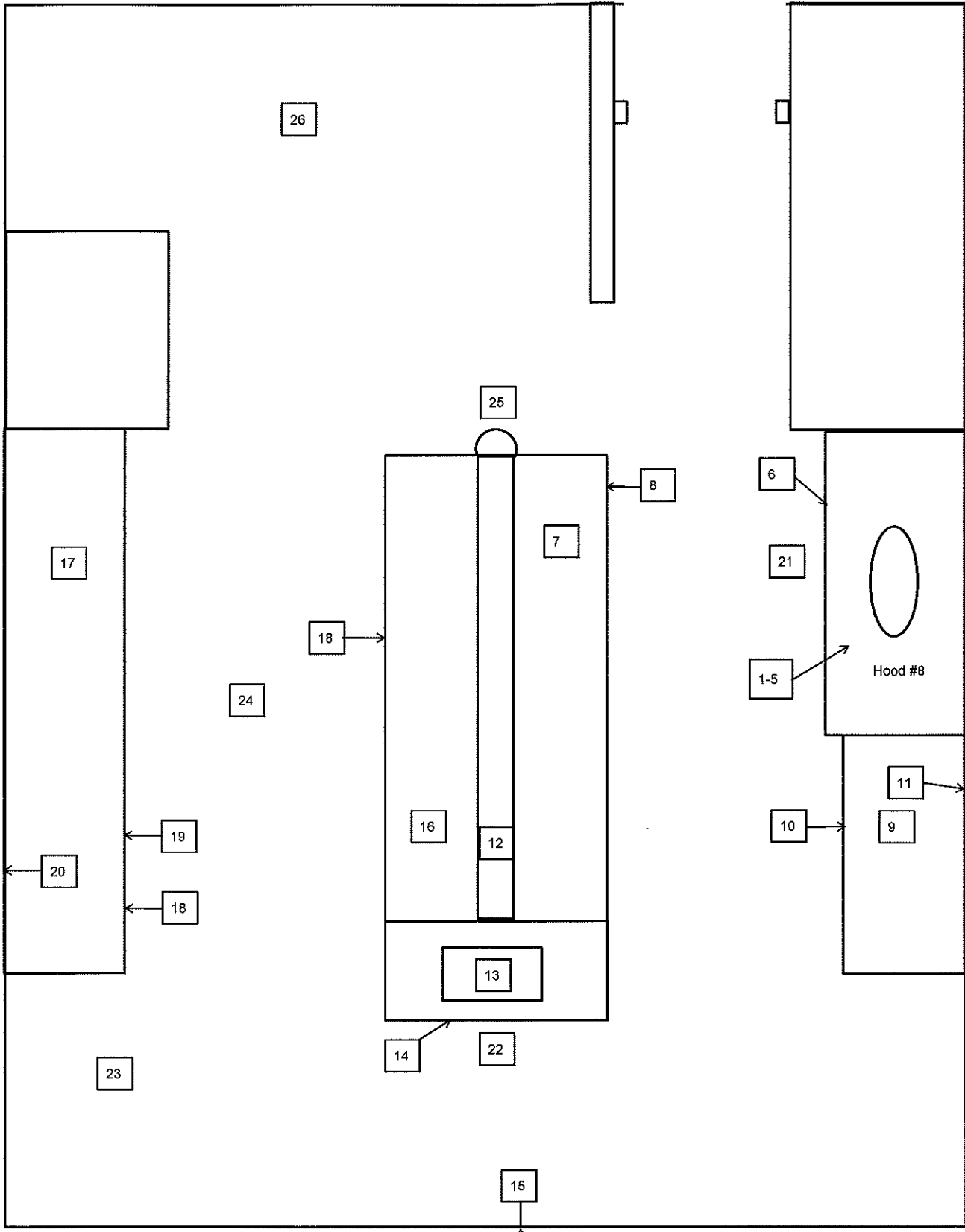

Room 1218 Direct Measurement Locations

**Survey Unit 1 Final Status Survey
Rooms 1215-1219**

Attachment GG

Chemtura Corporation, Middlebury, CT

Direct Measurements -- Room 1218

Date: 4/29/2011

Meter #1: Ludlum 2224-1 s/n 129459 w/43-68 s/n 111315

MDA: 914 dpm/100 cm²

C-14 efficiency (%): 7.2

Background (5 min. count): 2730 **Beta cpm:** 546

#	Location	Gross Beta (2 min. count)	Gross Beta cpm	Beta dpm
1	hood #8 - base	1108	554	111
2	hood #8 - left wall	1208	604	806
3	hood #8 - right wall	1053	526.5	-271
4	hood #8 - back wall	1054	527	-264
5	hood #8 - ceiling	1090	545	-14
6	hood #8 - cabinet	1083	541.5	-63
7	counter opp. hood #8	1050	525	-292
8	drawer #737 opp. hood #8	1090	545	-14
9	counter adj. hood #8	1030	515	-431
10	drawer #698 adj. hood	994	497	-681
11	wall adj. hood #8	1009	504.5	-576
12	counter shelf - left	1081	540.5	-76
13	sink	1131	565.5	271
14	sink cabinet	1136	568	306
15	radiator opp. sink	1153	576.5	424
16	counter - right	1121	560.5	201
17	wall counter - left	1077	538.5	-104
18	drawer #768	1026	513	-458
19	wall counter - left cabinet	1135	567.5	299
20	wall counter - wall	1031	515.5	-424

Meter #2: Ludlum 2224 s/n 119815 w/43-37 s/n 160827

MDA: 309 dpm/100 cm²

C-14 efficiency (%): 4.7

Background (5 min. count): 2450 **Beta cpm:** 490

#	Location	Gross Beta (2 min. count)	Gross Beta cpm	Beta dpm
21	floor - hood #8	882	441	-245
22	floor - sink	874	437	-265
23	floor - refrigerator (removed)	1754	877	1937
24	floor - center aisle	1078	539	245
25	floor - eyewash	1195	597.5	538
26	floor - desk area	1151	575.5	428

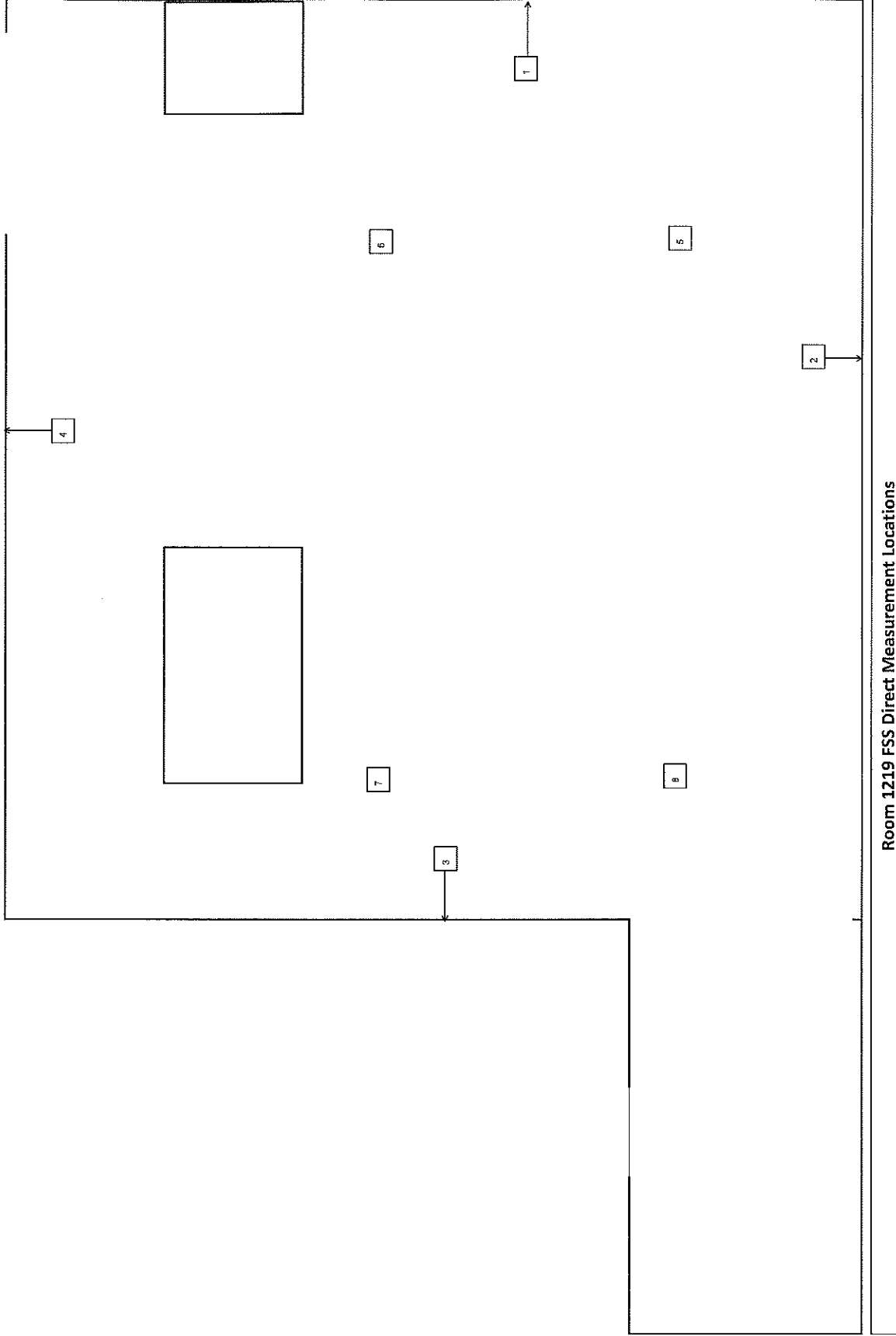

Chemtura Corporation, Middlebury, CT

Direct Measurements -- Room 1219

Date: 4/29/2011

Meter #1: Ludlum 2224-1 s/n 129459 w/43-68 s/n 111315

MDA: 914 dpm/100 cm²

C-14 efficiency (%): 7.2

Background (5 min. count): 2730 **Beta cpm:** 546

#	Location	Gross Beta (2 min. count)	Gross Beta cpm	Beta dpm
1	wall - vents	1070	535	-153
2	wall - radiator	1099	549.5	49
3	wall - nitrogen tank	1081	540.5	-76
4	wall - centrifuge (removed)	968	484	-861

Meter #2: Ludlum 2224 s/n 119815 w/43-37 s/n 160827

MDA: 309 dpm/100 cm²

C-14 efficiency (%): 4.7

Background (5 min. count): 2450 **Beta cpm:** 490

#	Location	Gross Beta (2 min. count)	Gross Beta cpm	Beta dpm
5	floor - rear left	964	482	-40
6	floor - front left	945	472.5	-88
7	floor - front right	806	403	-436
8	floor - rear right	1000	500	50