

Location: Building 511 - 1st Floor RWP# N/A Survey # WRAMC-FG-01 Survey Type: Scoping pg. 1 of 1

Smear (DPM/100 cm ²)			Direct Count (CPM/Direct Frisk)		
No.	α	β	No.	α	β
1	2	285	26		
2	1	280	27		
3	0	836	28		
4	0	280	29		
5	2	253	30		
6	5	230	31		
7	2	203	32		
8	0	237	33		
9	1	229	34		
10	2	295	35		
11	5	354	36		
12	4	391	37		
13	1	473	38		
14	0	229	40		
16			41		
17			42		
18			43		
19			44		
20			45		
21			46		
22			47		
23			48		
24			49		
25			50		

circle one
 SU01-11
 SU01-10
 SU01-09
 SU01-07
 SU01-08
 SU01-09
 SU01-04
 SU01-05
 SU01-02
 SU01-15
 SU01-01
 SU01-06
 SU01-14
 SU01-12
 SU01-13

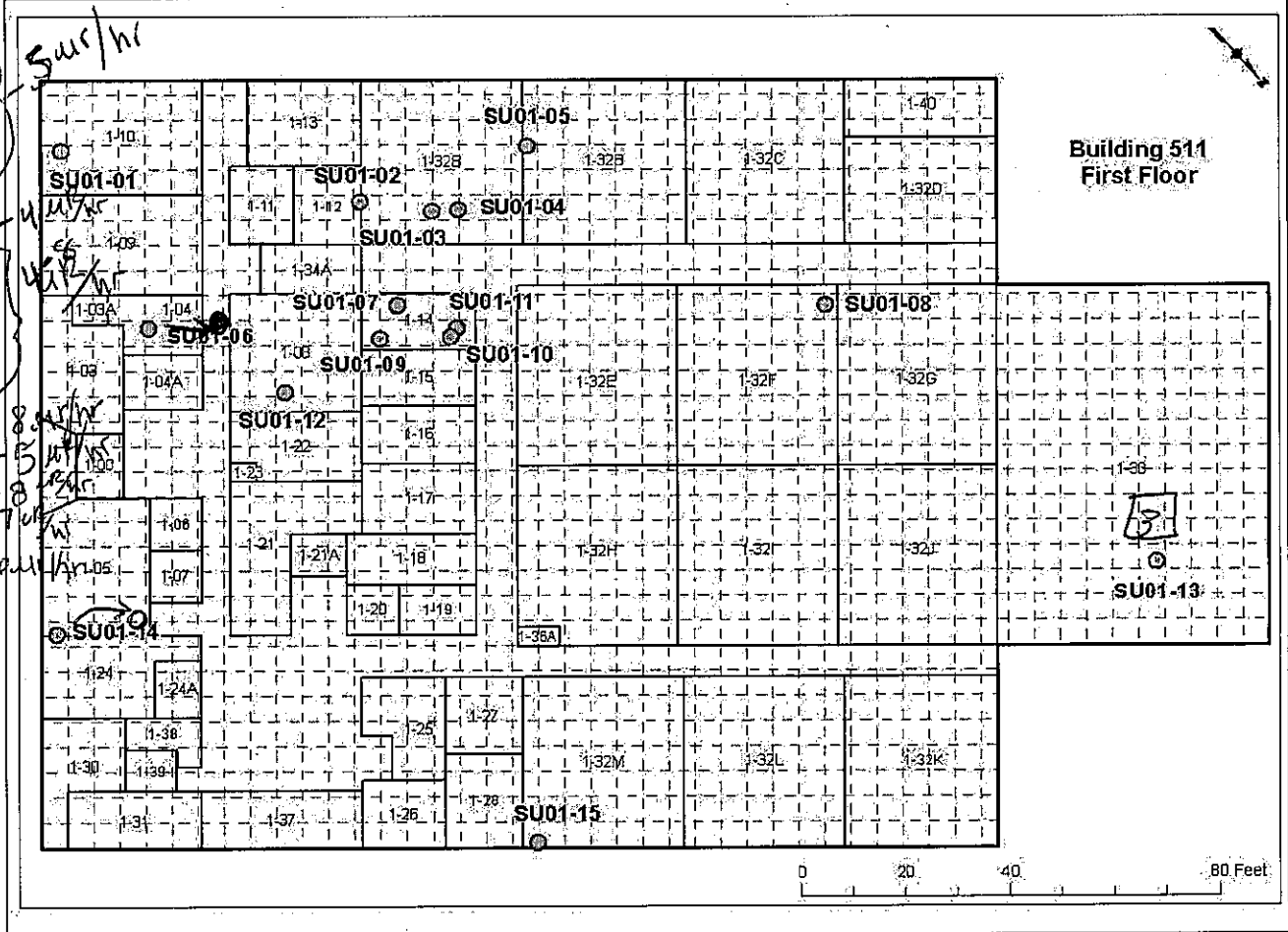

Comments	Surveyed By:	Date:	Instrument	Serial #	α Eff.	β Eff.	α Bkg.	β Bkg.	γ Bkg.	Cal. Due	Key
	A. Williams	11/17	2360	184906							■ A/S Location
	M. Borsa	11/17	43-68	PR116721							*.* Boundary
		11/17	19	167164							○ Smear
											□ Dose Rate <i>HR</i> /hr
	Reviewed By:	Date:									* Direct Reading CPM/direct frisk
OP-001				CARRERA SERVICE, INC.							△ Grab Sample

Location: Building 511 - 2nd Floor RWP# Survey # Survey Type: Scoping pg. 1 of 1
 Site: WRAMC, Forest Glen Annex N/A WRAMC-FG-01

Smear (DPM/100 cm ²)			Direct Count (CPM/Direct Frisk)		
No.	α	β	No.	α	β
1			26	1	242
2			27	1	254
3			28	1	280
4			29	3	245
5			30	0	290
6			31		
7			32		
8			33		
9			34		
10			35		
11			36		
12			37		
13			38		
14			39		
15			40		
16	2	237	41		
17	2	273	42		
18	1	219	43		
19	3	262	44		
20	3	288	45		
21	2	275	46		
22	2	238	47		
23	2	313	48		
24	2	320	49		
25	1	252	50		

circle one

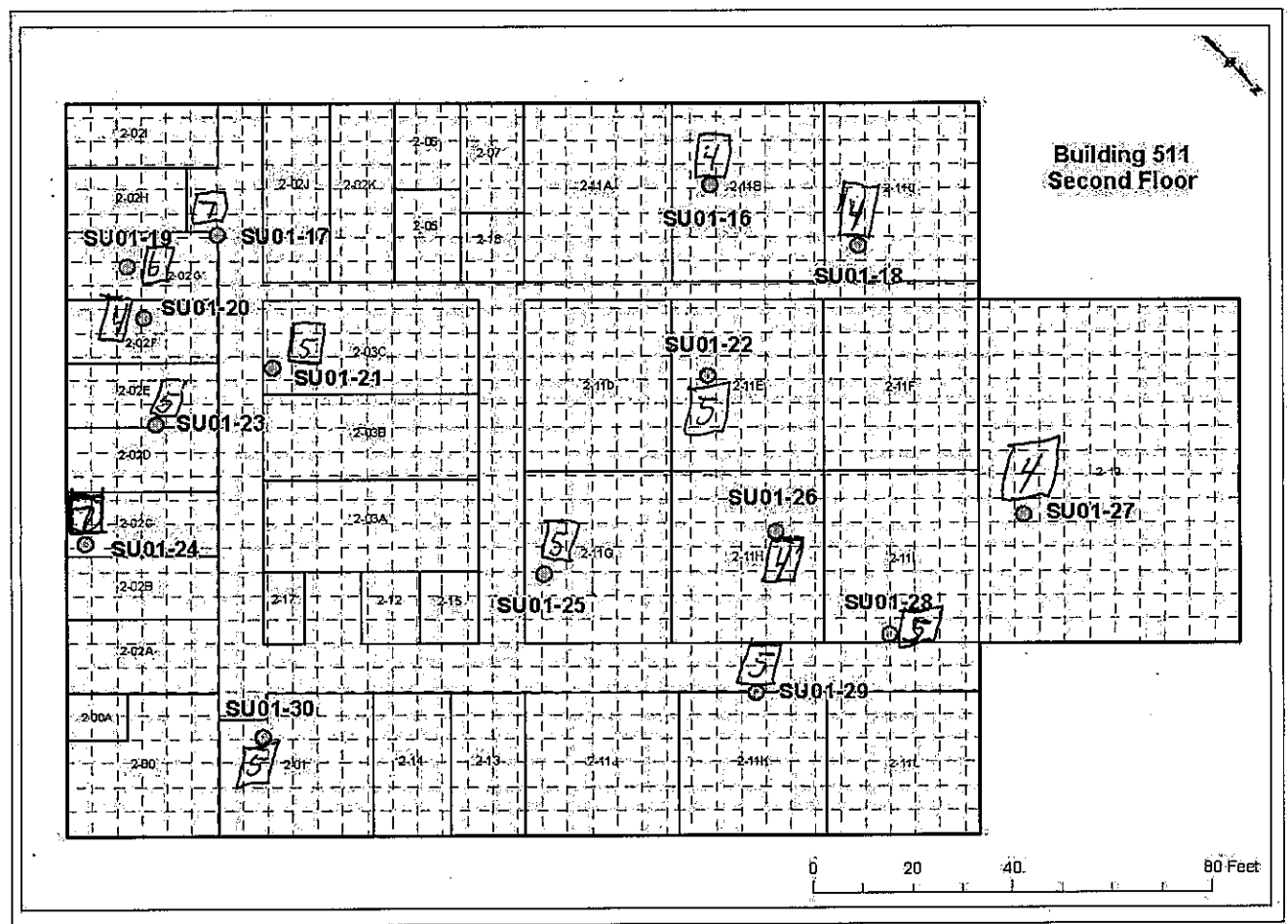

Comments	Surveyed By:	Date:	Instrument	Serial #	α Eff.	β Eff.	α Bkg.	β Bkg.	γ Bkg.	Cal. Due	Key
30 in Cage wash	A. Williams	11/17	2360	184900							■ A/S Location
	M. Barsa	11/17	43-68	116721							*- Boundary
		11/17	19	167164							○ Smear
											□ Dose Rate <i>μR</i> /hr
	Reviewed By:	Date:									• Direct Reading CPM/direct frisk
OP-001											△ Grab Sample

Bases Noted



Building 511 First Floor

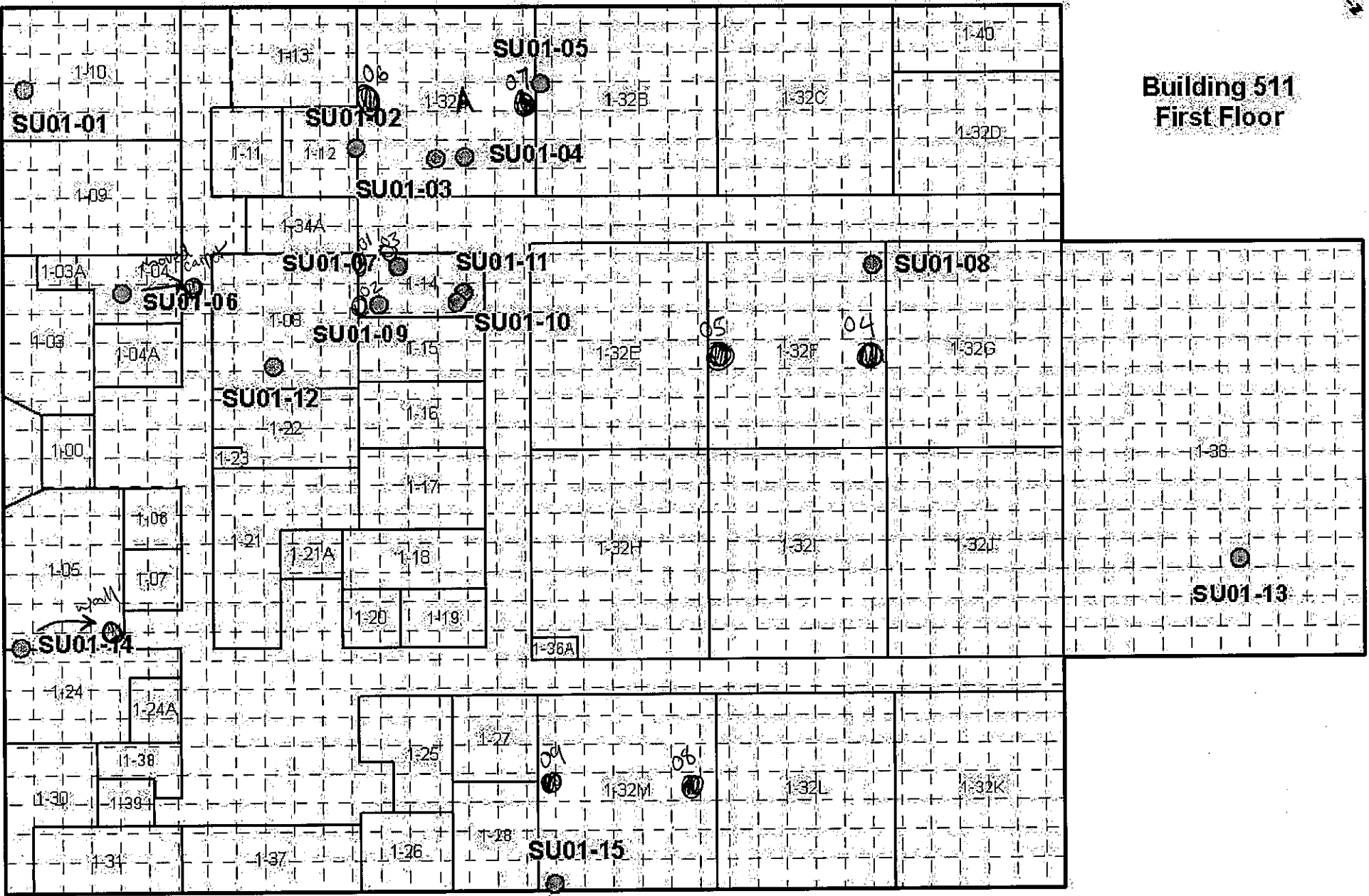



Building 511 Second Floor

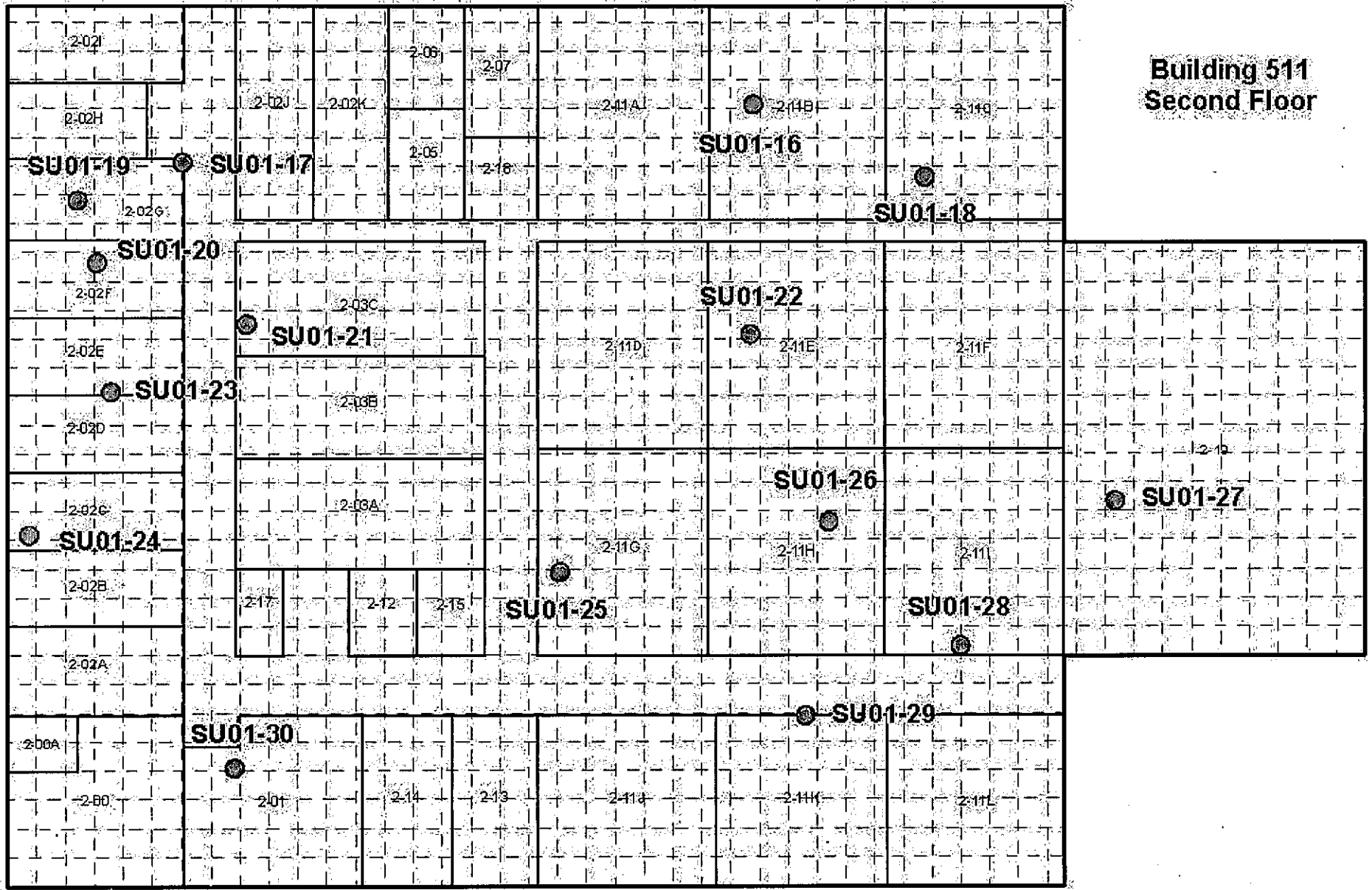

Location: Building 512 RWP# Survey # Survey Type: Scoping
 Site: WRAMC, Forest Glen Annex N/A WRAMC-FG-02 pg. 1 of 2

Smear (DPM/100 cm ²)						circle one
Direct Count (CPM/Direct Frisk)						
No.	α	β	No.	α	β	
1			26			2) B
2			27			51 0/344
3			28			52 4/357
4			29			53 1/357
5			30			54 2/318
6			31	1	265	55 0/330
7			32	8	415	56 1/333
8			33	3	336	57 2/382
9			34	4	312	58 2/287
10			35	1	386	59 2/325
11			36	1	326	60 2/306
12			37	1	300	UT
13			38	2	304	51 5/382
14			39	1	332	52 2/358
15			40	2	338	53 2/387
16			41	1	332	54 1/381
17			42	1	322	55 6/414
18			43	2	373	56 2/405
19			44	4	414	57 4/351
20			45	0	310	58 2/289
21			46	2	292	59 3/459
22			47	0	297	60 1/361
23			48	3	343	
24			49	4	353	
25			50	2	300	

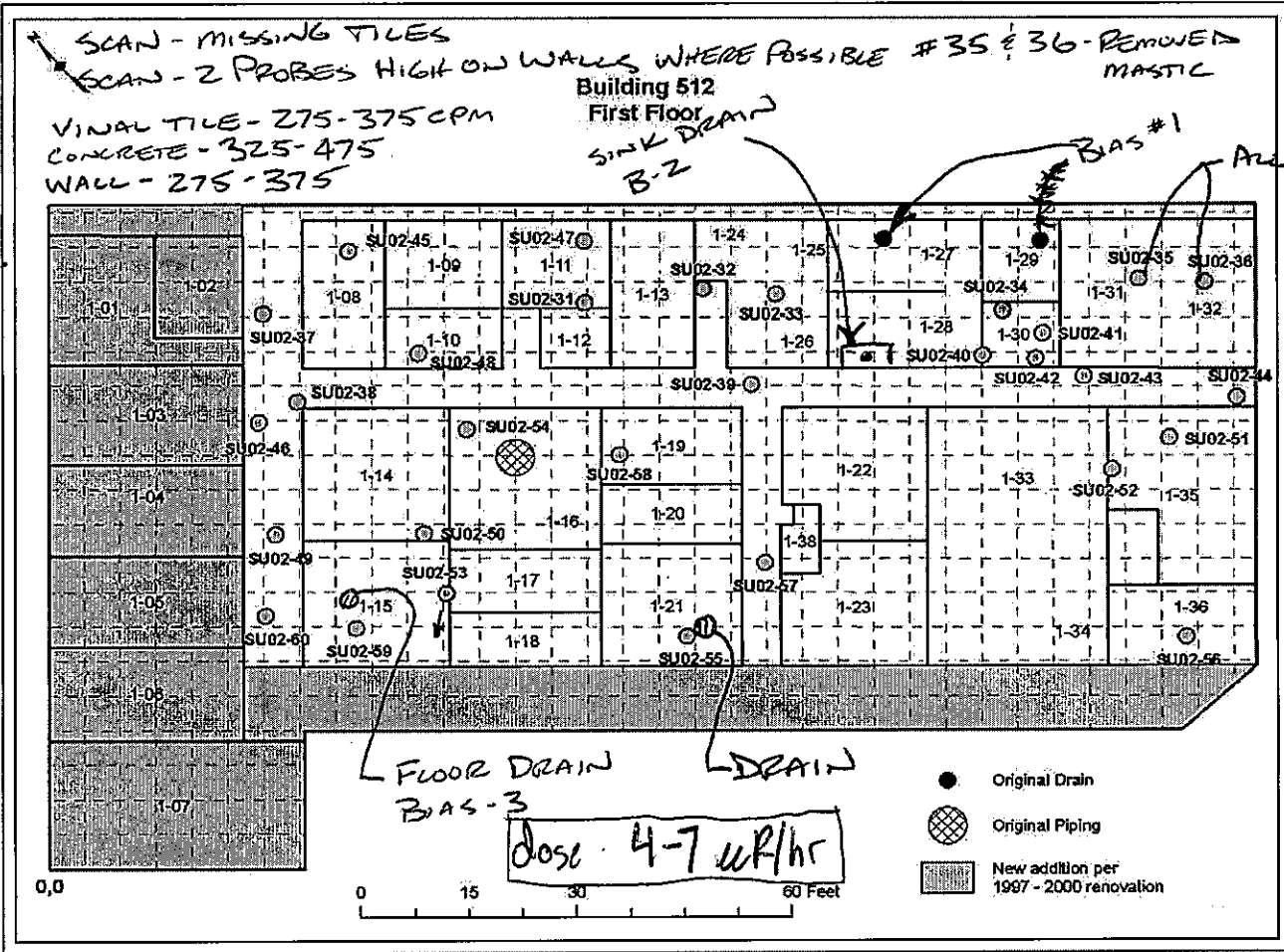

BIAS #1 DRAIN IN 1-29 2/315 BIAS #2 SINK DRAIN & 3 / B 321 BIAS 3 - 2/317

Comments	Surveyed By:	Date:	Instrument	Serial #	α Eff.	β Eff.	α Bkg.	β Bkg.	γ Bkg.	Cal. Due	Key
* All 2mi+ CTS.	K. KOSKO	11/17	2360	225241							■ A/S Location
53 moved COOLER	A. CRAIG	11/17	43-68	160790							*.* Boundary
FLOOR SCAN w/43-37	K. KOSKO	11/17	43-37	066273							○ Smear
		11/17	19	167164							□ Dose Rate /hr
											* Direct Reading CPM/direct frisk
	Reviewed By:	Date:									△ Grab Sample

Location: Gillette Building-1st Floor RWP# N/A Survey # WRAMC-FG-03 Survey Type: Scoping pg. 1 of 1

Smear (DPM/100 cm ²)			Direct Count (CPM/Direct Frisk)		
No.	α	β	No.	α	β
50			75	4	255
51			76		
52			77		
53			78	1	301
54			79		
55			80		
56			81		
57			82		
58			83	6	292
59			84		
60			85	4	346
61	3	222	86		
62			87	1	360
63			88	0	286
64	0	248	89		
65			90	1	280
66	2	511	91		
67	4	353	92		
68			93		
69			94		
70	12	765	95		
71			96		
72	2	258	97		
73	2	261	98		
74			99		

circle one
1/312

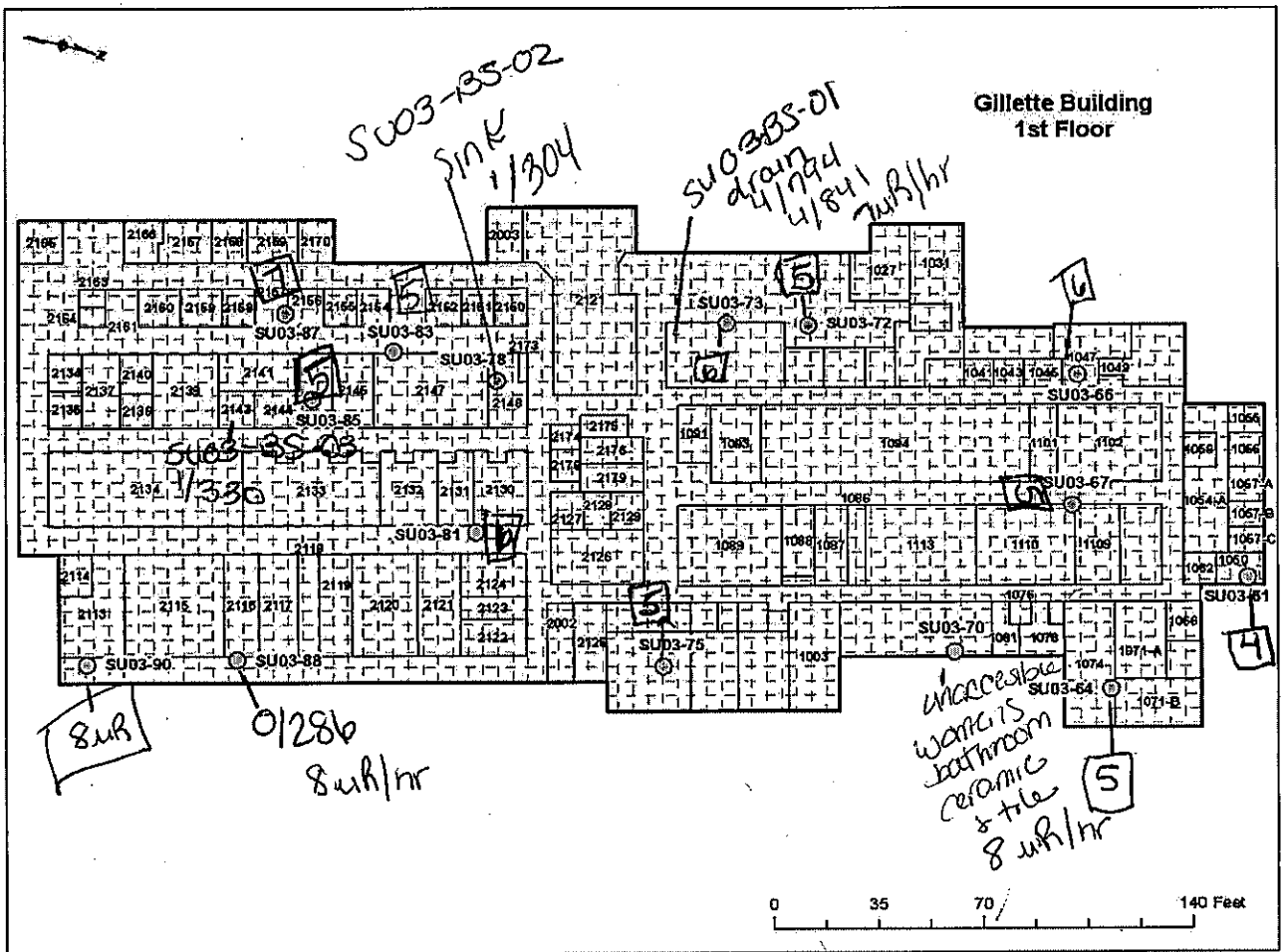

Comments	Surveyed By:	Date:	Instrument	Serial #	α Eff.	β Eff.	α Bkg.	β Bkg.	γ Bkg.	Cal. Due	Key
	M. Balsa	11/18	2360	184906							■ A/S Location
	A. Williams	11/18	43-68	160790							*.* Boundary
		11/18	19	167164							○ Smear
											□ Dose Rate ____/hr
	Reviewed By:	Date:									* Direct Reading CPM/direct frisk
											△ Grab Sample



Gillette Building 1st Floor

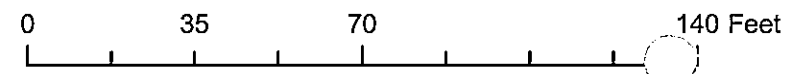
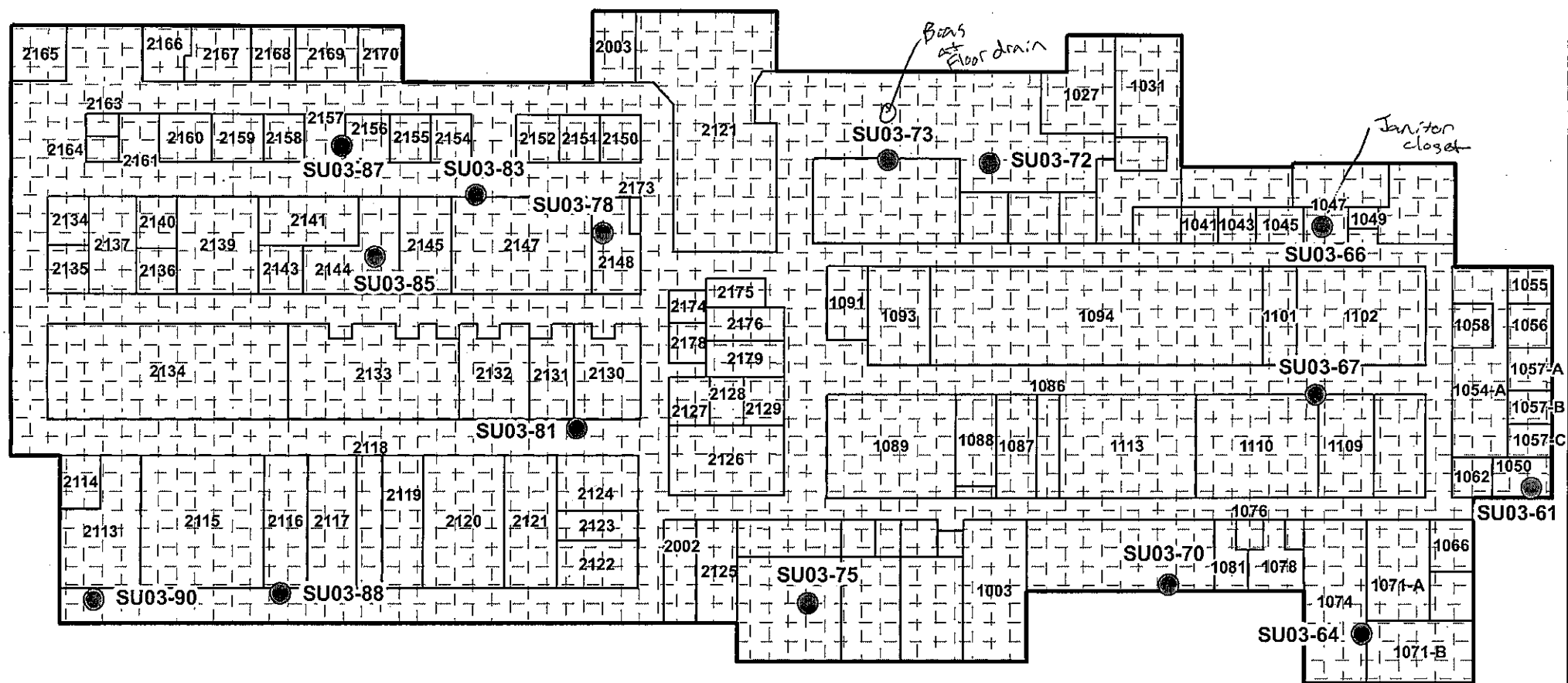

Location: Gillette Building-2nd Floor WRAMC, Forest Glen Annex RWP# N/A Survey # WRAMC-FG- 63 Survey Type: Scoping pg. 1 of 1

Smear (DPM/100 cm ²)						circle one
Direct Count (CPM/Direct Frisk)						
No.	α	β	No.	α	β	
50			75			
51			76			1/296
52			77			1/341
53			78			
54			79			1/329
55			80			1/314
56			81			
57			82			0/312
58			83			
59			84			0/296
60			85			
61			86			2/305
62			87			
63			88			
64			89			3/335
65			90			
66			91			
67			92			
68			93			
69			94			
70			95			
71			96			
72			97			
73			98			
74			99			

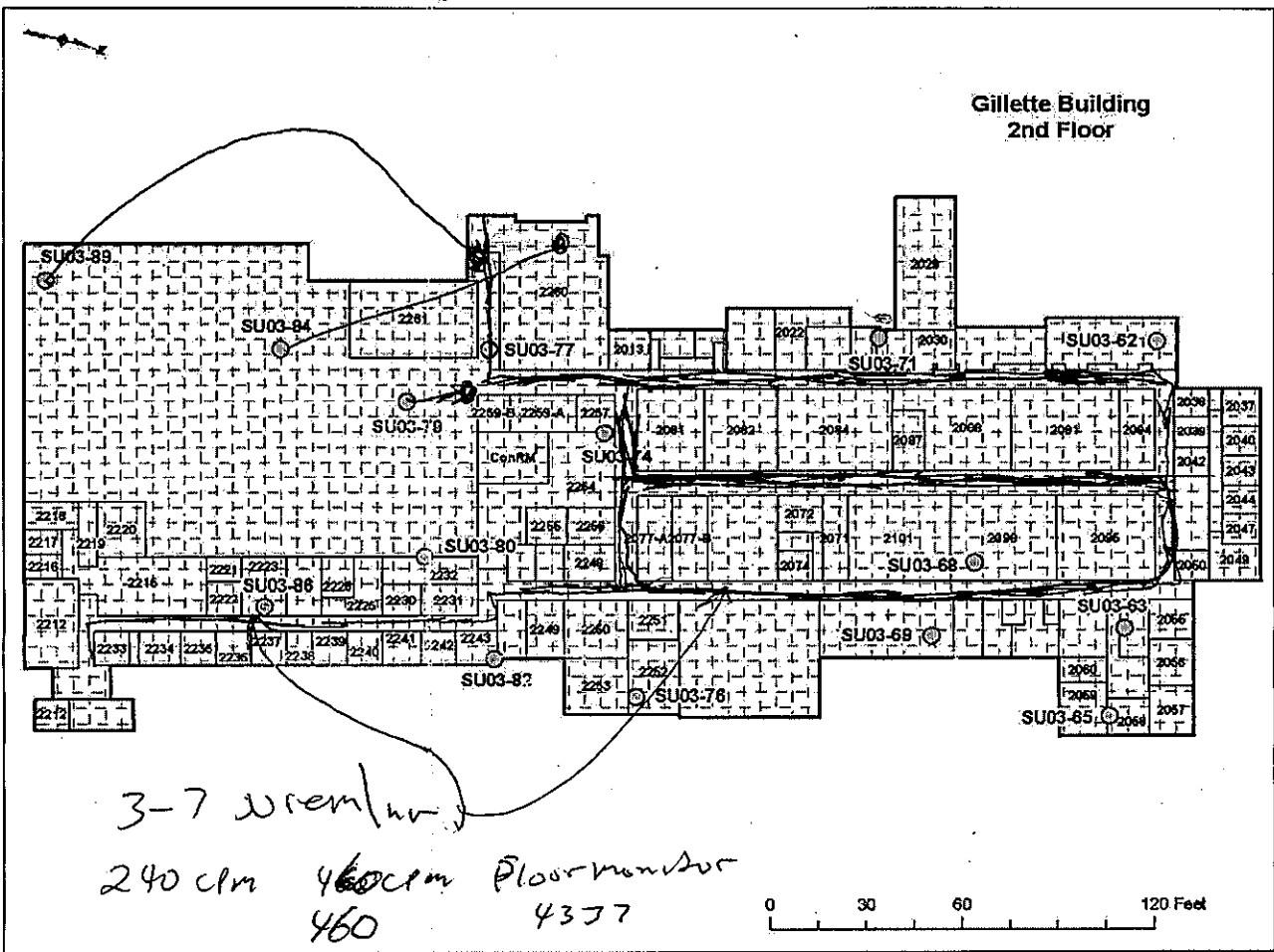

Comments	Surveyed By:	Date:	Instrument	Serial #	α Eff.	β Eff.	α Bkg.	β Bkg.	γ Bkg.	Cal. Due	Key
VINYL Floor	K. Kosko	11/18/09	2360	225241							
Carpet	A. CRAIG	11/18/09	2360	160740							■ A/S Location
		11/18/09	43-68	167164							*.* Boundary
Floor scan w/43-37	K. Kosko	11/18/09	43-37	066273							○ Smear
		11/18/09	2360	145474							□ Dose Rate <i>ur</i> /hr
	Reviewed By:	Date:									* Direct Reading CPM/direct frisk
											△ Grab Sample