

OEL-ELB-90 LIGHTING BOARD 6 FRONT VIEW (COL R,A7 EL 629)

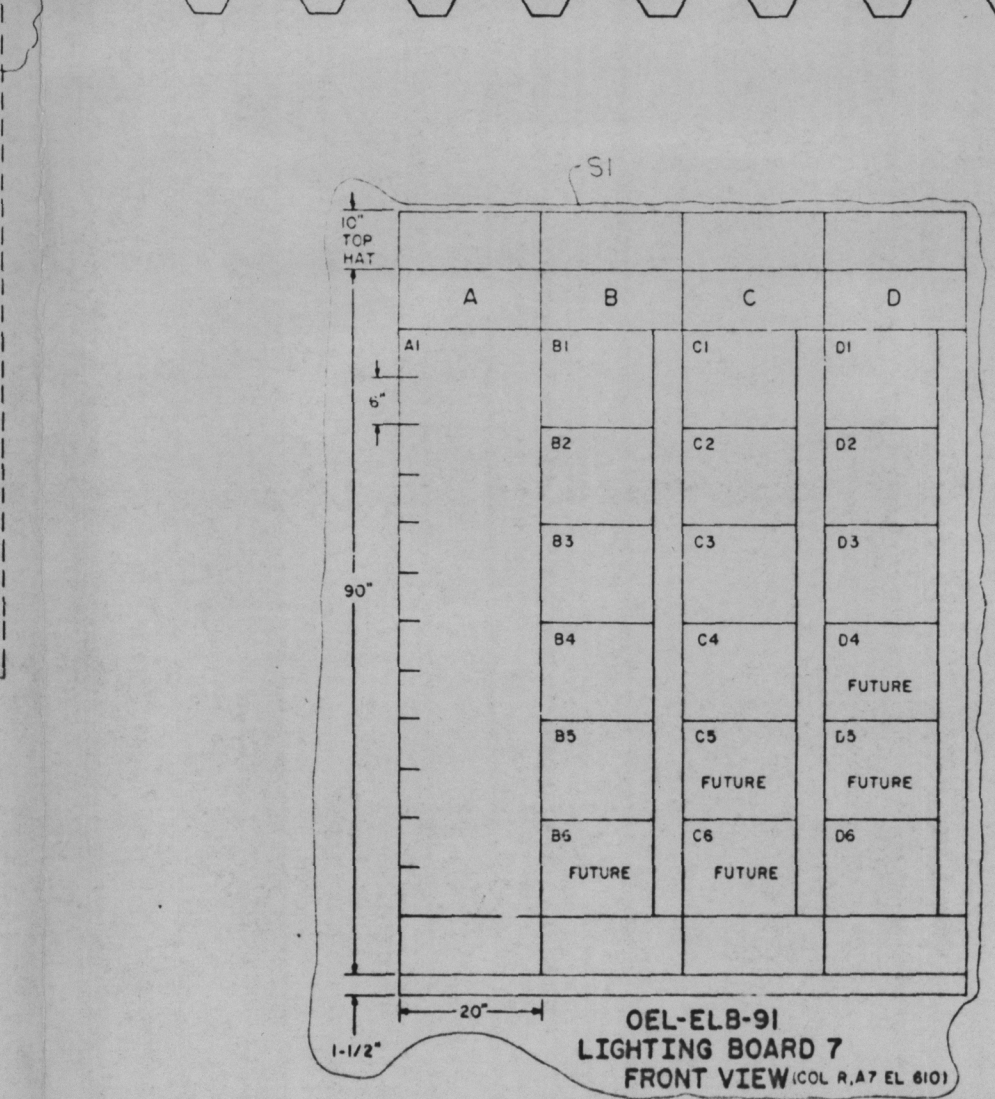
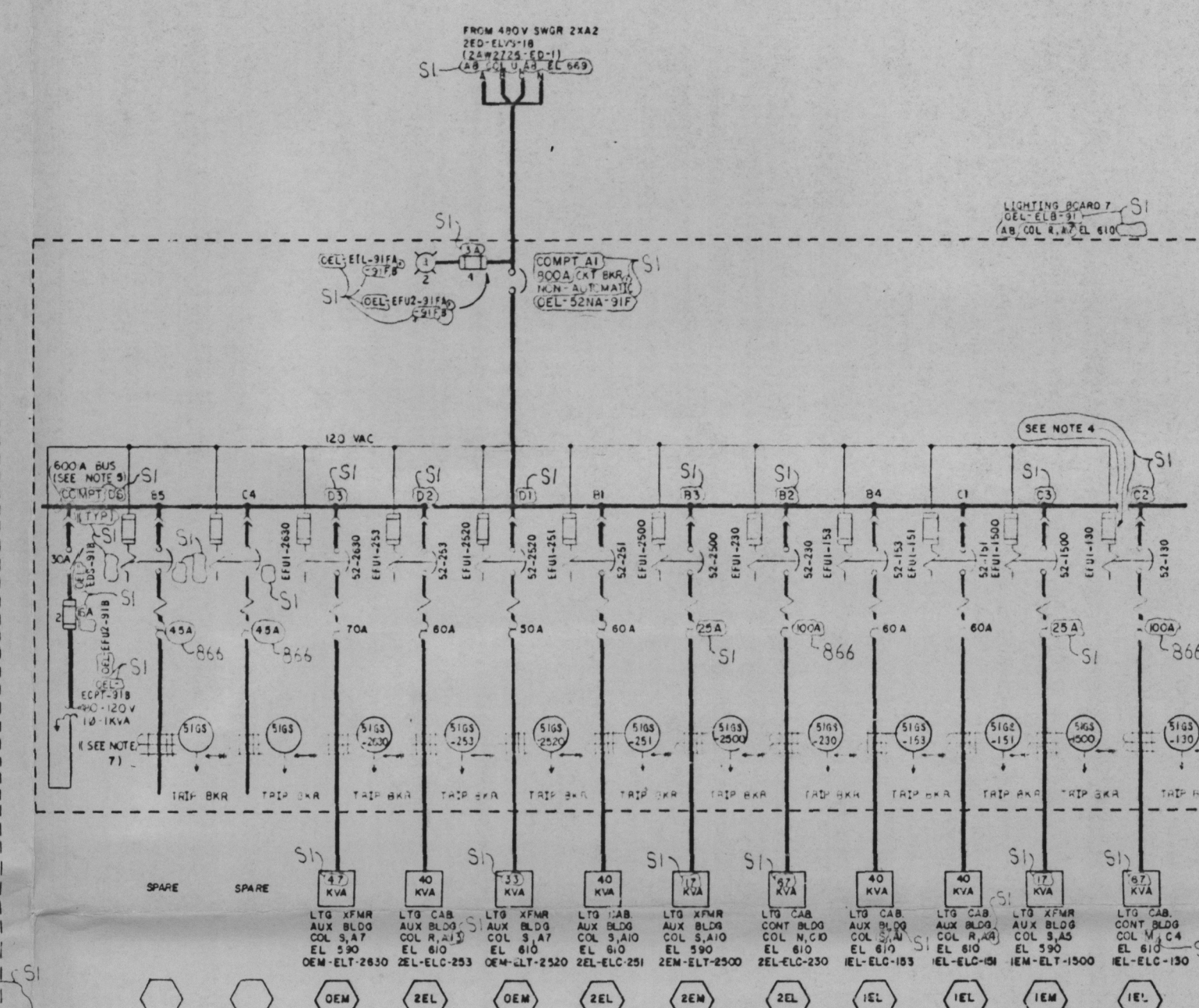

OEL-ELB-91 LIGHTING BOARD 7 FRONT VIEW (COL R,A7 EL 610)

DWG NO.	TITLE
2A0739-01	PLANT AC AUX SWGR SYS SINGLE LINE
2A0739-02	480V SWGR SYS SINGLE LINE
2A0739-03	480V SWGR SYS (RED-ELV-18) SL
2A0739-04	480V SWGR SYS (RED-ELV-18) SL
2A0739-05	NOR AC LTG SWGR WIRING DIAG
2A0739-06	480V MCC COMPARTMENT TYPICALS

- NOTES:
- LIGHTING BOARDS (MCC) ARE PROVIDED ON TVA CONTRACT 7643-86242 WITH 500/277V.
 - ALL WOLDED CASE CIRCUIT BREAKERS ARE 3-POLE, 600V, THERMAL-MAGNETIC WITH AN INTERRUPTING RATING OF NOT LESS THAN 15,000 RMS SYMMETRICAL AT 480 VOLTS. ALL CIRCUIT BREAKERS ARE 100A FRAME, ITC SE SERIES WITH SHUNT TRIP, EXCEPT AS NOTED. THE PICK-UP VOLTAGE OF THE SHUNT TRIP COIL IS 55% OF THE RATED VOLTAGE.
 - UNITS FOR LOAD BREAKERS AND THEIR ASSOCIATED DEVICES ARE FORMED BY PREFIXING THE DESIGNATIONS SHOWN ON THE DWG WITH THE UNIT AND SYS DESIGNATION SHOWN IN THE HEXAGON SYMBOL, EXCEPT AS NOTED. THE LIGHTING BOARD COMPARTMENT UNIT DESIGNATION (S) FORMED AS FOLLOWS USING THE COMPARTMENT NO. (X) AND THE BOARD NO. (Y): OEL-ELB-YXXX.
 - ALL SHUNT TRIP COIL FUSES ARE 5A, GOULD/SHAWMUT, AMP-TRAP, FORM 800, MEDJUE TYPE 2, A NO. AUXILIARY CONTACT IS PROVIDED ON THE BREAKER TO DISCONNECT THE SHUNT TRIP COIL VOLTAGE WHEN THE BREAKER IS OPEN.
 - THE BOARD BUS IS 3Ø, 4 WIRE, FULL NEUTRAL.
 - LC LOADS ARE ESTIMATED FOR MAXIMUM DEMAND FOR ACTL TOTAL DEMAND LOAD, SEE LIGHTING CIRCUIT BREAKER SCHEDULES.
 - GROUND FAULT PROTECTION (SIGS) IS ADJUSTABLE FROM 200 TO 1200 AMPS. TIME ADJUSTMENT IS PROVIDED FROM 5 TO 30 CYCLES. ALL SIGS RELAYS ARE SET AT 300 AMPS PICK UP AND AT 6 CYCLES.
 - VERTICAL BUS RATING IS 600 A.
 - FUSES IN THE POWER CIRCUITS ARE GOULD/SHAWMUT CLASS J CURRENT LIMITING (LIMITING) FUSES ARE REQUIRED TO PROVIDE REDUNDANT SHORT CIRCUIT PROTECTION FOR PRIMARY CONTAINMENT PENETRATIONS.
 - THIS EQUIPMENT IS NON-CLASS IIE LOCATED IN A CATEGORY III STRUCTURE.
 - THE LIGHTING BOARD FRONT VIEW IS CONTROLLED BY THIS SINGLE LINE COMPARTMENT TYPICAL SCHEMATICS AND WIRING DIAGRAMS ARE CONTROLLED BY THE MCC COMPARTMENTIZED CIRCUIT SCHEDULES.

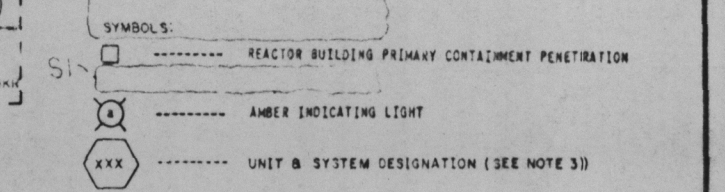

PRC APERTURE CARD

REV	NO	DATE	BY	CHKD	APP	DESCRIPTION
5	SI, 866	12-17-74	ADDED FRONT VIEWS, UPDATED COMPARTMENT ASSIGNMENTS, EST MAX DEMANDS, BKR TRIP RATINGS, & OTHER MINOR CHANGES SWAPPED BREAKERS.
4	SI, 134	4-10-74	INCORPORATED UNIT SYS GEN REV PER EON SH - VARIOUS ADDED LOADS AND INCREASED CAPACITIES PER EON 134.
3	SI, 21	1-17-75	SELECTED CURRENT LIMITING FUSES ON LIGHTING BOARD & CHG NOTE 6. CHANGED LIGHTING BOARD & POWER BOARD SWGR 2EM-ELT-1870 WIRING.
2	SI, 1	12-26-74	ADDED FUSES TO PENETRATION CKTS FOR REDUNDANT CKT PROTECTION, CHANGED GPF FROM INST TO TIME DELAY, REPLACED CONT VOLT CB WITH FUSED DISCONNECT SW.
1	12	8-10-74	CHANGED LTG SYS FROM 208/200V TO 480/277V GROUNDING WYE.

SIGN	E. R. BOURBON	INSP	
DRAWN	E. R. BOURBON	EMW	
CHKD	R. M. SLATER		
APPV	R. M. SLATER		

AUXILIARY BUILDING
UNITS 1 & 2

SINGLE LINE
480/277V LIGHTING BOARDS 6&7
OEL-ELB-90 & 91

BELLEFONTE NUCLEAR PLANT
TENNESSEE VALLEY AUTHORITY
DIVISION OF ENGINEERING DESIGN

SUBMITTED: [Signature]
RECOMMENDED: [Signature]
APPROVED: [Signature]

KNOXVILLE 2-19-74 88 E 2A0739-EL-2 R5

INSPECTED AND APPROVED FOR ISSUE
[Signature]
DESIGN PROJECT MANAGER