



UNITED STATES ENVIRONMENTAL PROTECTION AGENCY

REGION 6  
1445 ROSS AVENUE, SUITE 1200  
DALLAS, TX 75202-2733

RULES AND DIRECTIVES  
BRANCH  
USNRC

2010 DEC 16 PM 12:12

DEC 06 2010

Ryan Whited, Chief  
Environmental Projects Branch 2  
Division of Site and Environmental Reviews  
Office of New Reactors  
U.S. Nuclear Regulatory Commission  
Washington, D.C. 20555-0001

RECEIVED

(2)

11/02/10  
75 FR 67406

Dear Mr. Whited:

In accordance with Section 309 of the Clean Air Act and the National Environmental Policy Act (NEPA), the U.S. Environmental Protection Agency (EPA), Region 6 office, has reviewed your Notification and Request for Consultation and Participation in the Scoping Process for the Environmental Review of the Victoria County Station Early Site Permit Application. Exelon Nuclear Texas Holdings, LLC, submitted an application to the Nuclear Regulatory Commission (NRC) for an early site permit for the Victoria County Station site which is located near Victoria, Texas. To comply with the National Environmental Policy Act (NEPA), NRC will prepare an Environmental Impact Statement (EIS) for the proposed Early Site Permit and proposed Nuclear Power Plant.

We have completed our review of the brief project description and would like to take this opportunity to submit basic recommendations on the scope of the EIS you are preparing. EPA has prepared guidance for new nuclear power plants and Environmental Impact Statement contents and environmental analysis and suggests it be considered in the development of the Draft EIS. This guidance can be found at: <http://www.epa.gov/compliance/resouce/policies/nepa/309-review-guidance-for-new-nuclear-power-plant-eis-pg.pdf>. We have enclosed environmental analysis and information from our NEPAssist database to assist you in the scoping and EIS preparation process. For a clearer understanding of the project being proposed, we request a meeting with your staff soon after the scoping process is completed to discuss any issues identified and to afford EPA regional staff an opportunity to be briefed on the action proposed and the potential environmental impacts.

Our comments are based upon the Council on Environmental Quality regulations 40 CFR (Parts 1500-1508) and our authority under Section 309 of the Clean Air Act. We appreciate the opportunity to comment. Please send our office five copies of the Draft EIS at the same time that you send copies to the Office of Federal Activities for filing. If you have any questions, please contact Mike Jansky of my staff at (214) 665-7451.

Sincerely yours,

Rhonda M. Smith  
Chief, Office of Compliance  
and Coordination 6ENXP

Enclosure

SUNSI Review Complete  
Template = ADM-013

E-RIDJ = ADM-03  
Add: T. Terry (TLT2)

- NEPAssist Home
- National Environmental Policy Act
- Office of Federal Activities
- NEPAssist Support
- Contact Us

### NEPAssist GISST Report

The GISST gives NEPAssist users several options to calculate various physical, environmental, and demographic data for a user-defined area. It creates scores for each dataset, giving it the power to be used as a comparative analysis tool. Medium-high and high scores are highlighted in yellow in the results table. Medium, medium-low, and low scores are highlighted in blue in the results table. Additional information can be found in the [GISST User's Manual](#) and the [TEAP Report](#)

#### Map



Results for 0 mile(s) from study area  
Study area type: polygon

Enter a new buffer distance in miles for the selected study area.  
Please be patient. Queries of large areas can take a minute or two.

Score key:

	1 - Low
	2 - Medium Low
	3 - Medium
	4 - Medium High
	5 - High

**HUC-Related**

Factor	Value	Score
Surface Water Use		5
Storet Exceedences		2
Rainfall		3
Unified Watershed Assessment		1
Average Flow		3
Aquifer Geology		4

**Air**

Factor	Value	Score
Number of Regulated Facilities	0	1
Road Density (miles/sq mi)	.49	1
Nonattainment		1

**Socioeconomic**

Factor	Value	Score
Population Density (persons/sq mi)	0	
% Children Under 1	0	1
% Children Under 7	0	1
% 55 and Older	40	5
% Unemployed	0	1
% Economically Stressed	0	1
% Without High School Degree	25	2
Educational Attainment		3
Age of Housing Unit		3
% Low/No Ability to Speak English	0	1
% Linguistically Isolated	0	1
% Foreign Born	0	1

**Other Water-Related**

Factor	Value	Score
--------	-------	-------

**Other Water-Related**

Factor	Value	Score
Distance to Water (feet)	0	5
Stream Density (miles / sq mi)	1.31	3
Channel/Canal Density (miles / sq mi)	0	1
% Surface Water	1.83	1
% 100 Year Flood	14.75	1
% 500 Year Flood	14.75	1
Aquifer		1
Groundwater Probability		1
Soil Permeability		1

**Toxicity**

Factor	Value	Score
TRI Releases to Air (lbs)	0	1
TRI Releases to Water (lbs)	0	1
TRI Releases to Land (lbs)	0	1
TRI Toxicity Releases to Air (lbs)	0	1
TRI Toxicity Releases to Water (lbs)	0	1

**Land Cover**

Factor	Value	Score
% Wildlife	37.36	3
% Agriculture	59.85	5
% Wetlands	9.87	1
Area Perimeter Ratio	133.55	5
Land Use Ranking		4



NEPAAssist

http://r6gis1.r06.epa.gov/NEPAVE/analysis\_gisst.aspx  
 Last updated on Wednesday, December 01, 2010

You are here: [EPA Home](#) [NEPAAssist Home](#)

**Map**

Area of digitized polygon 18.49 sq mi

**Facility**

- [Within 100 meters of a hospital?](#) no
- [Within 1000 meters of a hospital?](#) no
- [Within 100 meters of a TRI facility?](#) no
- [Within 1000 meters of a TRI facility?](#) no
- [Within 100 meters of a regulated facility?](#) no
- [Within 1000 meters of a regulated facility?](#) no
- [Within 100 meters of an airport?](#) no

**Water**

- [Within 100 meters of a Wild and Scenic River?](#) no
- [Within an area over a Sole Source Aquifer?](#) no
- [Within the 100 year flood plain?](#) yes
- [Within the 500 year flood plain?](#) yes
- Within 400 meters of an NWI wetland? [click here](#)  
*May take several minutes*
- [Within an NLCD wetland?](#) yes
- [Within 1000 meters of an NLCD wetland?](#) yes

**Ecology**

- [Within a federal/state park or wildlife area?](#) no
- [Within 1000 meters of a federal/state park or wildlife area?](#) no
- [Within a critical habitat area?](#) no
- [Within 1000 meters of a critical habitat area?](#) no
- [Within 100 meters of a REAP Composite area that is within the Top 10% highest scores?](#) yes
- [Within 100 meters of a REAP Diversity area that is within the Top 10% highest scores?](#) yes
- [Within 100 meters of a REAP Sustainability area that is within the Top 10% highest scores?](#) yes
- [Within 100 meters of a REAP Rarity area that is within the Top 10% highest scores?](#) yes

**Other**

- [Within 100 meters of a place on the National Historic Register?](#) no
- [Within 1000 meters of a place on the National Historic Register?](#) no
- [Within 100 meters of a school?](#) no
- [Within 1000 meters of a school?](#) no
- [Within a nonattainment area?](#) no
- [Within a previous nonattainment, maintenance, or EAC area?](#) yes

**NatureServe data**

Within an area with known rare, endangered, or at-risk species? [click here](#)

<a href="#">Download XML</a>	<a href="#">Environmental Justice Analysis</a>
<a href="#">GISST Analysis</a>	<a href="#">Texas Grid Analysis</a>

Region 6

Area of digitized polygon	<b>18.49 sq mi</b>
Within 100 meters of a hospital?	no
Within 1000 meters of a hospital?	no
Within 100 meters of a TRI facility?	no
Within 1000 meters of a TRI facility?	no
Within 100 meters of a regulated facility?	no
Within 1000 meters of a regulated facility?	no
Within 100 meters of an airport?	no
Within 100 meters of a Wild and Scenic River?	no
Within an area over a Sole Source Aquifer?	no
Within the 100 year flood plain?	<b>yes</b>
Within the 500 year flood plain?	<b>yes</b>
Within 400 meters of an NWI wetland?	ondemand
Within an NLCD wetland?	<b>yes</b>
Within 1000 meters of an NLCD wetland?	<b>yes</b>
Within a federal/state park or wildlife area?	no
Within 1000 meters of a federal/state park or wildlife area?	no
Within a critical habitat area?	no
Within 1000 meters of a critical habitat area?	no
Within 100 meters of a REAP Composite area that is within the Top 10% highest scores?	<b>yes</b>
Within 100 meters of a REAP Diversity area that is within the Top 10% highest scores?	<b>yes</b>
Within 100 meters of a REAP Sustainability area that is within the Top 10% highest scores?	<b>yes</b>
Within 100 meters of a REAP Rarity area that is within the Top 10% highest scores?	<b>yes</b>
Within 100 meters of a place on the National Historic Register?	no
Within 1000 meters of a place on the National Historic Register?	no
Within 100 meters of a school?	no
Within 1000 meters of a school?	no
Within a nonattainment area?	no
Within a previous nonattainment, maintenance, or EAC area?	<b>yes</b>

EJView

Detailed Regional Analysis

GISST Analysis

Texas Grid Analysis



Statistics represent residential population, by Census Block Group, within a 0 mile buffer around feature of interest

Enter a number:   County and State Comparison

**Overview**

Total Persons:	139	Land Area:	97.9%	Households in Area:	52
Population Density:	7.69 /sq mi	Water Area:	2.1%	Housing Units in Area:	59
Percent Minority:	21.1%	Persons Below Poverty Level:	4 (2.9%)	Households on Public Assistance:	1
Percent Urban:	0%	Housing Units Built <1970:	53%	Housing Units Built <1950:	24%

**Race and Age\***

Race Breakdown	Persons (%)	Age Breakdown	Persons (%)
White:	123 (88.2%)	Child 5 years or less:	10 (7.4%)
African-American:	0 (0.0%)	Minors 17 years and younger:	32 (23.2%)
Hispanic-Origin:	27 (19.4%)	Adults 18 years and older:	107 (76.8%)
Asian/Pacific Islander:	0 (0.0%)	Seniors 65 years and older:	27 (19.8%)
American Indian:	0 (0.0%)	<i>This space intentionally left blank</i>	
Other Race:	14 (10.1%)		
Multiracial:	2 (1.7%)		

(\* Columns that add up to 100% are highlighted)

**Gender**

Gender Breakdown	Persons (%)
Males:	66 (47.2%)
Females:	73 (52.8%)

**Education**

Education Level (Persons 25 & older)	Persons (%)
Less than 9th grade:	9 (9.3%)
9th -12th grade:	15 (16.6%)
High School Diploma:	28 (30.3%)
Some College/2 yr:	30 (32.9%)
B.S./B.A. or more:	10 (10.8%)

**Language**

<b>Ability to Speak English</b>	<b>Persons (%)</b>
Population Age 5 and Over:	131
Speak only English:	105 (80.4%)
Non-English at Home:	26 (19.7%)
Speak English very well:	17 (12.6%)
Speak English well:	4 (3.4%)
Speak English not well:	4 (3.1%)
Speak English not at all:	1 (0.5%)
Speak English less than well:	5 (3.7%)

**Language Spoken**

<b>Language Spoken</b>	<b>Persons (%)</b>
Speak only English:	157 (84.9%)
Spanish or Spanish Creole:	26 (14.0%)
German:	2 (1.1%)
Non-English Speaking:	28 (15.1%)

**Place of Birth for the Foreign-Born**

<b>Country</b>	<b>Persons</b>
Foreign-Born Population:	3
Europe:	1 (25%)
Americas:	2 (75%)
United Kingdom:	1 (25%)
Mexico:	2 (75%)





EJView

You are here: [EPA Home](#) [Compliance and Enforcement](#) [Environmental Justice](#) [EJView](#)

Statistics represent residential population, by Census Block Group, within a 0 mile buffer around feature of interest

Social
Economic
Health
Environmental

Enter a new buffer value (max. 10 miles)

Income

Income Breakdown	Households (%)
Less than \$15,000:	4 (7.9%)
\$15,000 - \$25,000:	9 (18.2%)
\$25,000 - \$50,000:	19 (36.3%)
\$50,000 - \$75,000:	12 (24.1%)
Greater than \$75,000:	10 (19.5%)

Tenure

Tenure Breakdown	Households (%)
Occupied Housing Units:	52 (100.0%)
Owner Occupied:	42 (81.2%)
Renter Occupied	10 (18.8%)



Statistics represent residential population, by Census Block Group, within a 0 mile buffer around feature of

Enter a new buffer value (max. 10 miles)

### Health Statistics

Health Service Area for *Victoria (Victoria), TX - Lavaca, TX*

The health data statistics for this feature of the Environmental Justice Assessment are provided by the National Center for Health Statistics (NCHS) Centers for Disease Control (CDC) [EXIT Disclaimer](#), the official source for vital statistics. Currently, this information has not been released for all ethnic groups by NCHS. When the health statistics are released, they will be provided in this feature broken down by geographic area and ethnicity. This information will be made available as soon as the data have been quality assured and released by NCHS in their entirety.

Since 1960, NCHS has received several legislative mandates and authorities, and it works closely with other federal agencies, as well as researchers and academic institutions, to provide health information. NCHS data systems include data on vital events, as well as information on health status, lifestyle and exposure to unhealthy influences, the onset and diagnosis of illness and disability, and the use of health care. This information is used by policymakers in Congress and the Administration, by medical researchers, and by others in the health community.

Additional information is available from the National Center for Health Statistics (NCHS) [EXIT Disclaimer](#) website.

Statistic\Disease †	Heart Disease	All Cancers	Chronic Obstructive Pulmonary Disease	Pneumonia and Influenza	Liver Disease
White Male Rate *	196.8	156.4	24	14.7	11.9
White Male Significance **	3	3	3	3	3
Black Male Rate *	291.8	235.1	26.7	8.6	0
Black Male Significance **	3	3	3	2	1
White Female Rate *	94.8	100.9	9.1	7.8	5.7
White Female Significance **	2	2	1	2	3
Black Female Rate *	190.7	137.5	10.5	13.4	1.9
Black Female Significance **	3	3	3	3	2

SOURCE: U.S. Department of Health and Human Services, Centers for Disease Control and Prevention, National Center for Health Statistics, Atlas of United States Mortality (1997) [EXIT Disclaimer](#)

† Rates based on deaths during 1988-92 in the United States due to the diseases listed.

\* **Rate:** The age-adjusted death rate due to cause per 100,000 population.

\*\* **Significance:** A description of whether the death rate of the group, due to cause, varies significantly from the U.S. death rate.

**2002 NATA Risk Estimates**

	Cancer Risk (Persons per Million)	Neurological Hazard Risk	Respiratory Hazard Risk
VICTORIA, TX	21.39 (69.3 Percentile)	.04 (69.6 Percentile)	1.06 (54.4 Percentile)
Texas	30.32 (51.9 Percentile)	.05 (32.6 Percentile)	2.95 (51.9 Percentile)

SOURCE: EPA Office of Air and Radiation (<http://www.epa.gov/ttn/atw/nata2002/>)  
 NOTES: Values are derived from 2002 National-Scale Air Toxics Assessment (NATA) Cancer Risk Estimates and Non-Cancer Hazard Index Scores.

**2007 Asthma Prevalence By State**

	White Non-Hispanic Persons	Black Non-Hispanic Persons	Multi-Racial Non-Hispanic Persons	Other Race Non-Hispanic Persons	Hispanic Persons
Texas					
Lifetime	14.6%	14.8%	26.7%	14.7%	9%
Current	9.5%	9.8%	24.1%	9.8%	5.1%

SOURCE: Centers for Disease Control and Prevention.  
 2007 Behavioral Risk Factor Surveillance System (BRFSS)  
 ( <http://www.cdc.gov/asthma/brfss/07/brfssdata.htm> )

**2008 Mortality Rates**

	Deaths per 1000
VICTORIA, TX	8.67
Texas	6.7

SOURCE: US Census Bureau <http://www.census.gov/popest/estimates.php>  
 NOTES: Mortality rates are calculated using 7/1/2007 to 7/1/2008 deaths and estimated populations from the file, "County Population Estimates and Estimated Components of Change, April 1, 2000 to July 1, 2008".

**Life expectancy at birth in 1999**

	Male and Female	Male	Female
Victoria, Texas	76.7	74.1	79.1

SOURCE: U.S. Census Bureau & National Center for Health Statistics

**All Cancers Mortality Rates**

	1950 - 1994		1970 - 1994							
	White Male Age 0 - 19	White Female Age 0 - 19	All White Male	All White Female	All Black Male	All Black Female	White Male Age 0 - 19	White Female Age 0 - 19	Black Male Age 0 - 19	Black Female Age 0 - 19
VICTORIA, TX	4.2057	4.3403	208.5386	124.49	320.8622	145.8848				
Texas	6.3979	4.9306	202.3985	124.0559	281.631	152.5508	5.1574	3.9533	4.6641	3.8813

SOURCE: National Cancer Institute Cancer Mortality Maps & Graphs  
<http://www3.cancer.gov/atlasplus/index.html>

NOTES: Mortality rates (number per 100,000) are extracted from the state and county mortality tables.

**Childhood Leukemia Mortality Rates**

	1950 - 1994		1970 - 1994							
	White Male Age 0 - 19	White Female Age 0 - 19	All White Male	All White Female	All Black Male	All Black Female	White Male Age 0 - 19	White Female Age 0 - 19	Black Male Age 0 - 19	Black Female Age 0 - 19
VICTORIA, TX	1.3746	1.5014	7.1592	7.2189	3.5693	4.5437				
Texas	2.7268	2.1183	8.8257	5.1716	7.9426	4.756	2.1337	1.6062	1.5403	1.2759

SOURCE: National Cancer Institute Cancer Mortality Maps & Graphs  
<http://www3.cancer.gov/atlasplus/index.html>

NOTES: Mortality rates (number per 100,000) are extracted from the state and county Leukemia mortality tables.

**Adult Lymphoma Mortality Rates**

	1950 - 1994		1970 - 1994							
	White Male Age 20 - 49 Age 50 - 74 Age 75+	White Female Age 20 - 49 Age 50 - 74 Age 75+	All White Male	All White Female	All Black Male	All Black Female	White Male Age 20 - 49 Age 50 - 74 Age 75+	White Female Age 20 - 49 Age 50 - 74 Age 75+	Black Male Age 20 - 49 Age 50 - 74 Age 75+	Black Female Age 20 - 49 Age 50 - 74 Age 75+
VICTORIA, TX	1.8167 11.7545 63.8292	1.6436 10.4803 41.2394	6.0924	4.284	7.6659	0				
Texas	2.1119 15.831 46.9516	1.1539 10.9469 35.1214	6.6943	4.4643	4.9254	2.9445	2.2281 17.3147 55.8517	1.1283 11.7975 40.3662	2.1257 13.7257 29.875	1.032 8.89 17.4908

SOURCE: National Cancer Institute Cancer Mortality Maps & Graphs

<http://www3.cancer.gov/atlasplus/index.html>

NOTES: Mortality rates (number per 100,000) are extracted from the state and county Non-Hodgkin's Lymphoma mortality tables.

**Lung Cancers Mortality Rates**

	1950 - 1994		1970 - 1994							
	White Male Age 0 - 19	White Female Age 0 - 19	All White Male	All White Female	All Black Male	All Black Female	White Male Age 0 - 19	White Female Age 0 - 19	Black Male Age 0 - 19	Black Female Age 0 - 19
VICTORIA, TX	0	0	79.9161	23.9395	143.5451	41.509				
Texas	.038	.0234	70.8042	23.6421	95.1353	22.2225	.0289	.0189	.0411	.0112

SOURCE: National Cancer Institute Cancer Mortality Maps & Graphs

<http://www3.cancer.gov/atlasplus/index.html>

NOTES: Mortality rates (number per 100,000) are extracted from the state and county mortality tables.



EJView

You are here: [EPA Home](#) [Compliance and Enforcement](#) [Environmental Justice](#) EJView

Statistics represent residential population, by Census Block Group, within a 0 mile buffer around feature of interest

- Social
- Economic
- Health
- Environmental

Enter a new buffer value (max. 10 miles)  Go

**National Emission Inventory (NEI)  
Non-Point Source Air Emissions(tons)**

	Carbon Monoxide	Ammonia	Nitrogen Oxides	Particulates (size < 10 micrometers)	Particulates (size < 2.5 micrometers)	Sulfur Dioxide	Volatile Organic Compounds
VICTORIA, TX	2812.84	1260.1	1025.9	12076.87	1699.97	320.97	2867.45
TEXAS	476661.36	383669.04	274452.98	2307864.31	309413.99	109215.22	684146.22

SOURCE: 1999 National Emission Inventory(NEI) Criteria Pollutants.  
(<http://www.epa.gov/ttn/chief/net/1999inventory.html>)

**Regulated Facilities:**

**RCRAInfo Query**

County List      State List

(Dbl-Click to select)

**TRI Explorer Query**

County List      State List

(Dbl-Click to select)

**Brownfields Properties:**

**Environmental Conditions:**

**Drinking Water Source/Sewage Disposal**

Housing Units	Water			Sewer		
	Systems	Wells	Other	Public	Septic	Other

SOURCE: U.S. Census Bureau, 1990 Census of Population and Housing

**Safe Drinking Water Reports by County**

SDWIS Report for VICTORIA, TX

**Fish Advisory Reports**

Fish Advisory Report for TEXAS

**Air Data Reports**

AirData Reports for TEXAS

- NEPAAssist Home
- National Environmental Policy Act
- Office of Federal Activities
- NEPAAssist Support
- Contact Us

### NEPAAssist NatureServe Report

This information is provided by [NatureServe](#) and its network of natural heritage member programs, a leading source of information about rare and endangered species, and threatened ecosystems. For more detail about the data and how the queries work, and links to related information resources, please review the report on ["How to Interpret the Data"](#).

**Please note: As an EPA employee, you may receive more detailed information in the following NatureServe Reports than you are permitted to share in communications with outside stakeholders in accordance with the NatureServe data usage agreement with EPA. Read the references to data distribution in the [terms and conditions](#) carefully. Also refer to the Data Distribution Restriction Section on the NatureServe entry page which provides acceptable types of statements that can be included in correspondence to outside stakeholders.**

Hide Map



Results for 0 meters from study area

Study area type: polygon

Total area of study area plus buffer: 47.9 sq km / 18.49 sq mi

Enter a new buffer distance and units for the selected study area.  
Please be patient. Queries of large areas can take a minute or two.



**Results for 0 meters from study area****Study area type: polygon****Total area of study area plus buffer: 47.9 sq km / 18.49 sq mi**

Enter a new buffer distance and units for the selected study area.  
Please be patient. Queries of large areas can take a minute or two.

0	meters	<b>Submit Query</b>
---	--------	---------------------

**Hide Area Size Reference**

Size of Queried Area	Information Detail Returned
Polygon larger than or equal to 36 sq. km (¼ quad)	Exact species
Polygon smaller than 36 sq. km (¼ quad) and larger than or equal to 10 sq. km (¼ of ¼ quad)	Major taxonomic group
Polygon smaller than 10 sq. km (¼ of ¼ quad) and larger than or equal to 2.6 sq. km (1 sq. mile)	Known presence
Polygon smaller than 2.6 sq. km (1 sq. mile)	Data not available

Name		Taxonomy		Conservation Status	
Common Name	Scientific Name	Species Group (Broad)	Species Group (Fine)	NatureServe Global Status	Other Status
<u>Indianola Beakrush</u>	<i>Rhynchospora indianolensis</i>	Plants, Vascular	Sedge Family	<u>G3Q</u>	

There were no excluded areas found in the query area.



<http://r6gis1.r06.epa.gov/GISSTtools/Analysis/reportTXGRID.aspx>

Last updated on Wednesday, December 01, 2010

## NEPAssist

You are here: [EPA Home](#)   [NEPAssist Home](#)

### NEPAssist Texas Grid Report

The Texas GRID ("TexasGrid") contains grid cells for the State of Texas. Each grid cell is 250 meters x 250 meters (62,500 square meters) in size and contains pre-calculated scores for various physical, environmental, and demographic data considered of importance to Texas. Medium-high and high scores are highlighted in yellow in the results table. Medium, medium-low, and low scores are highlighted in blue in the results table. Additional information can be found in the [GISST User's Manual](#) and the [TEAP Report](#)

#### Map

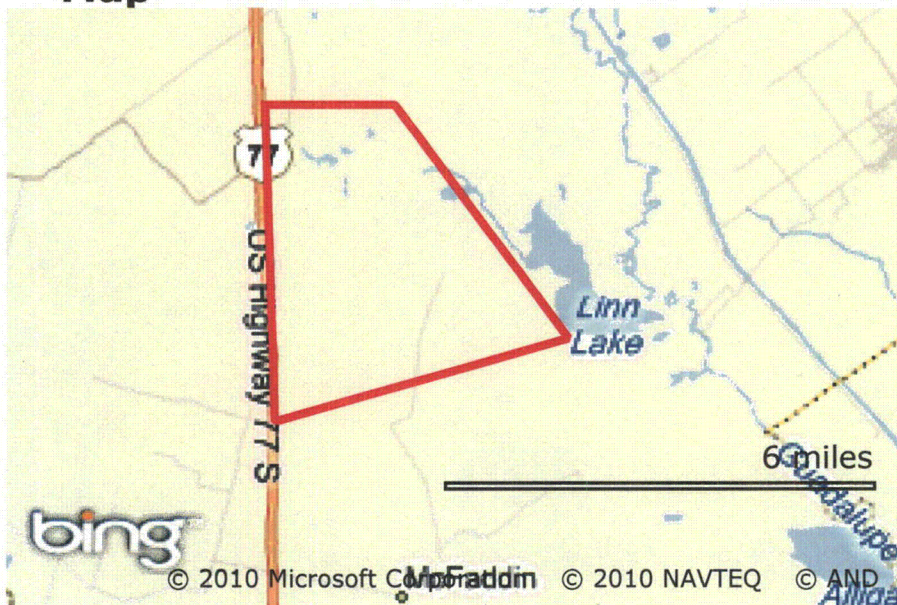

Enter a new buffer distance in miles for the selected study area.  
Please be patient. Queries of large areas can take a minute or two.



Score key:

1	Low
2	Medium Low
3	Medium
4	Medium High
5	High

**Texas Grid Analysis Results**

Factor		Score	Min	Max	Standard Deviation
Stream Density	Y Y	2	1	5	1.65
Impaired Water	Y Y	1	1	1	0
Flood Zone	Y Y	1	1	5	.27
Nonattainment	Y Y	1	1	1	0
Facilities	Y Y	1	1	1	0
Managed Lands	Y Y	1	1	1	0
<b>Agricultural Lands</b>	Y Y	<b>4</b>	<b>1</b>	<b>5</b>	<b>1.59</b>
Wetlands	Y Y	1	1	5	1.23
Wildlife	Y	3	1	5	1.76
Federal Species	Y	1	1	1	0
State Species	Y	1	1	1	0
Economically Stressed	Y Y	1	1	1	0
Population	Y Y	0	0	1	.41
Significant Streams	Y	1	1	1	0
TEAPCOMP	Y	3	1	4	.91
TEAPDIVE	Y	2	1	4	.95
TEAPSUST	Y	3	1	4	.91
TEAPRARE	Y	2	1	4	1.06

Overall	Sum	Average
Without TEAP	19	1.4
With TEAP	23	1.6