

17

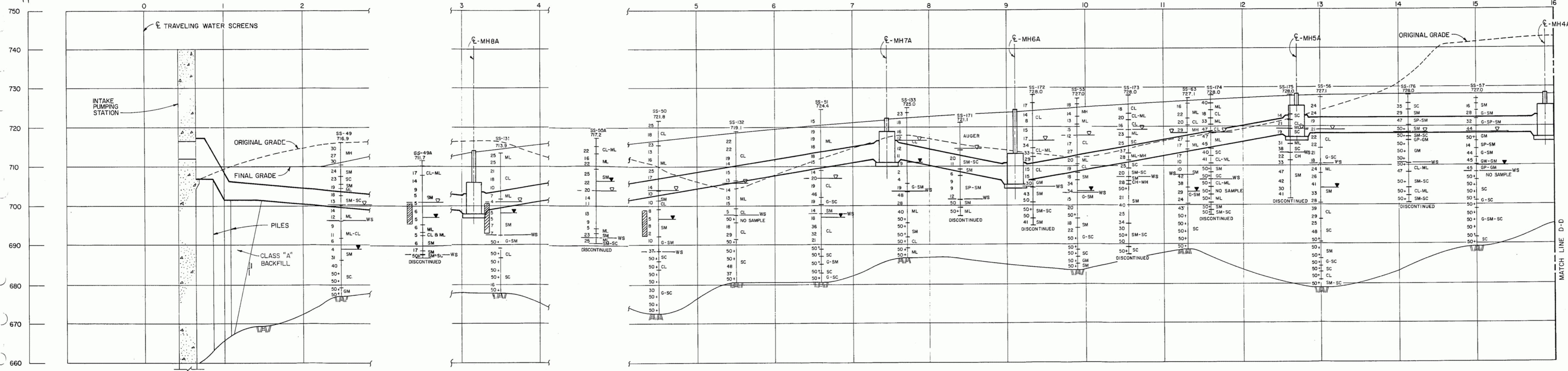

F-F

- ▽ DESIGN WATER TABLE
- WATER TABLE (24 HR)
- MH SOIL CLASSIFICATION
- 13 BLOW COUNT
- ▨ POTENTIALLY LIQUEFIABLE SOIL (SEE NOTE)
- WS WEATHERED SHALE

NOTE: LIQUEFACTION BASED ON TOP OF GROUND ACCELERATION OF 0.22g AND SEED-IDDRISS (1981) CORRELATION FOR SANDS.

Added by Amendment 50

WATTS BAR NUCLEAR PLANT  
FINAL SAFETY  
ANALYSIS REPORT

CATEGORY I ELECTRICAL CONDUITS  
SECTION F-F SHEET 1 OF 2  
FIGURE 2.5-554