

CALVERT CLIFFS POWER PLANT FUTURE HEAVY HAUL ROAD AREA SEDIMENT CONTROL AND DEMOLITION PLANS

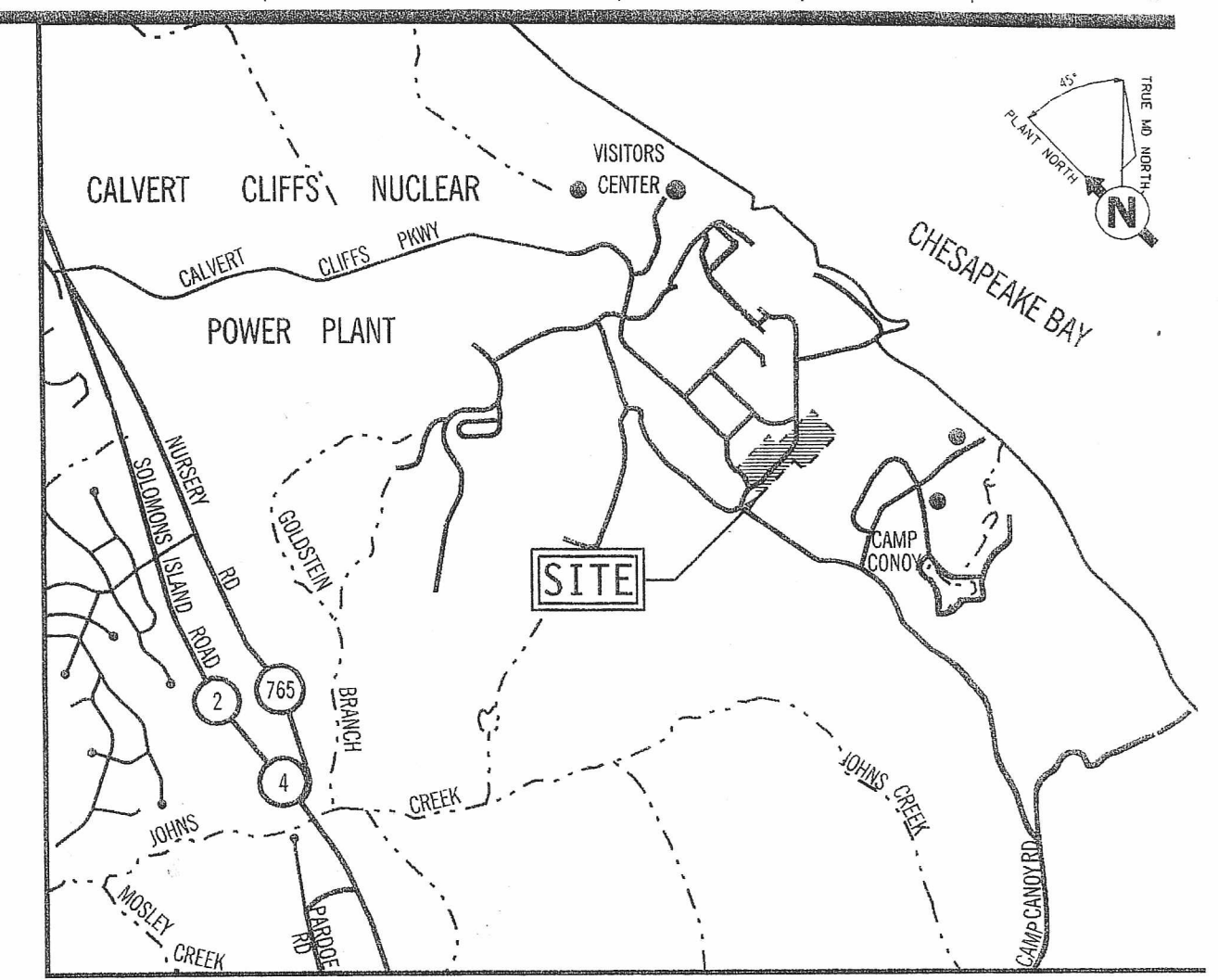

VICINITY MAP
SCALE: 1"=2000'
ADC MAP: 16617

SITE WORK SPECIFICATIONS

1. EARTHWORK
 - A. GENERAL:
 1. FILLING MAY BE ACCOMPLISHED AFTER DEMOLITION, CLEARING AND GRUBBING IS COMPLETED AND UNSUITABLE SOILS HAVE BEEN REMOVED.
 2. NO FILL IS TO BE PLACED ON FROZEN GROUND.
 3. ALL SLOPES SHALL BE STABILIZED IMMEDIATELY AFTER COMPLETION OF GRADING SAID SLOPES.
 4. ALL FILL SLOPES SHALL BE STABILIZED IMMEDIATELY AFTER COMPLETION OF GRADING SAID SLOPES.
 - B. SITE CONSTRUCTION STATED ON THESE PLANS SHALL BE IN ACCORDANCE WITH THE MARYLAND DEPARTMENT OF TRANSPORTATION, STATE HIGHWAY ADMINISTRATION STANDARD SPECIFICATIONS FOR CONSTRUCTION AND MATERIALS DATED 2008, AS AMENDED. THE CONSTRUCTION SHALL ALSO BE GOVERNED BY THE STATE OF MARYLAND DEPARTMENT OF ENVIRONMENT PERMITS, U.S. ARMY CORPS OF ENGINEER PERMITS, AND THE MARYLAND STATE HIGHWAY AND COUNTY ROAD, GRADING AND BUILDING PERMITS, WHERE APPLICABLE.
 - C. BACKFILL AND FILL:
 1. USE SATISFACTORY ONSITE SOIL MATERIAL, APPROVED FOR USE BY THE OWNER OR THEIR REPRESENTATIVE.
 2. GENERAL: PLACE ACCEPTABLE SOIL MATERIAL IN LAYERS TO REQUIRED SUBGRADE ELEVATIONS FOR EACH AREA CLASSIFICATION LISTED BELOW.
 - a. UNDER EXCAVATION AND BACKFILL, USE SATISFACTORY EXCAVATED OR BORROW MATERIAL.
 - b. UNDER GRASSED AREAS, USE SATISFACTORY EXCAVATED OR BORROW MATERIAL.
 - D. GRADING:
 1. GENERAL: UNIFORMLY GRADE AREAS WITHIN LIMITS OF GRADING. SMOOTH FINISHED SURFACES WITHIN SPECIFIED TOLERANCES, COMPACT WITH UNIFORM LEVELS OR SLOPES BETWEEN SUCH POINTS AND EXISTING GRADES. GRADE SMOOTH AND EVEN, FREE OF HOLES, COMPACTED AS SPECIFIED, AND TO REQUIRED ELEVATION. PROVIDE FINAL GRADES WITHIN A TOLERANCE OF 1/2" WITH POSITIVE DRAINAGE.
 - E. FIELD QUALITY CONTROL:
 1. QUALITY CONTROL TESTING DURING CONSTRUCTION: THE OWNER MAY RETAIN A TESTING SERVICE TO INSPECT AND APPROVE THE SITEWORK CONSTRUCTION.
 2. IF, IN THE OPINION OF THE OWNER OR OWNER'S REPRESENTATIVE, BASED ON TESTING, MATERIALS AND/OR PLACEMENT OF MATERIALS ARE SUBSTANDARD, THE CONTRACTOR IS TO PROVIDE NEW MATERIALS, CONSTRUCTED AND TESTED, AT NO ADDITIONAL EXPENSE TO THE OWNER.
 - F. MAINTENANCE:
 1. PROTECTION OF GRADED AREAS:
 - a. PROTECT NEWLY GRADED AREAS FROM TRAFFIC AND EROSION. KEEP FREE OF TRASH AND DEBRIS.
 - b. REPAIR AND REESTABLISH GRADES IN SETTLED ERODED, AND RUINED AREAS TO SPECIFIED TOLERANCES.

SITE WORK SPECIFICATIONS (CONT'D)

- G. DISPOSAL OF EXCESS AND WASTE MATERIALS (IF REQUIRED):
 1. REMOVE EXCESS EXCAVATED MATERIAL, TRASH, DEBRIS AND WASTE MATERIALS AND DISPOSE OF IT OFF OWNER'S PROPERTY IN A MANNER CONSISTENT WITH LOCAL, STATE AND FEDERAL AGENCIES.
- H. DRAINAGE:
 1. THE CONTRACTOR SHALL PROVIDE ALL NECESSARY TEMPORARY DRAINAGE AND KEEP THE SAME OPERATING UNTIL PERMANENT DRAINAGE HAS BEEN COMPLETED. IF WATER IS ENCOUNTERED IN EXCAVATIONS AND UTILITY CONSTRUCTION, THE CONTRACTOR SHALL PROVIDE AND MAINTAIN PUMPS OF SUFFICIENT CAPACITY TO REMOVE THE WATER.
- I. SEEDING, PERMANENT AND TEMPORARY SEEDING:
 - A. SEED PREPARATION: APPLY 100 POUNDS PER 1000 SQUARE FEET OF PULVERIZED SOLIDIFIED LIMESTONE AND 15 POUNDS PER 1000 SQUARE FEET OF 10-10-10 OR EQUIVALENT FERTILIZER, HARROW OR DISC ON THE CONTOUR INTO THE SOIL TO A DEPTH OF 3 TO 4 INCHES, CONTINUE TILLAGE UNTIL A REASONABLE FILE SEEDBED HAS BEEN PREPARED.
 - B. APPLICATION SHALL BE IN ACCORDANCE WITH THE MOSHA STANDARD SPECIFICATIONS FOR CONSTRUCTION AND MATERIALS, SECTION 920.04.02 SEED MIXES (a) SEED MIX NO. 1
 - 85% TALL FESCUE (CERTIFIED SEED ONLY)
 - 10% KENTUCKY BLUEGRASS (CERTIFIED SEED ONLY)
 - 5% PERENNIAL RYE GRASS (CERTIFIED SEED ONLY)
 ** KENTUCKY 31 FESCUE SHALL NOT BE ACCEPTABLE **
 - C. THE REGULATIONS, COMAR 08.05.01.06, APPLICATION FOR APPROVAL OF EROSION AND SEDIMENT CONTROL PLANS (BIV), REQUIRE THE APPLICANT TO SUBMIT (IV) DETAILS OF TEMPORARY AND PERMANENT STABILIZATION MEASURE INCLUDING PLACEMENT OF THE FOLLOWING STATEMENT ON THE PLAN, FOLLOWING INITIAL SOIL DISTURBANCES OR REDISTURBANCE, PERMANENT OR TEMPORARY STABILIZATION SHALL BE COMPLETED WITHIN:
 1. SEVEN (7) CALENDAR DAYS TO THE SURFACE OF ALL PERIMETER CONTROLS, DICES, SMALES, DITCHES, PERIMETER SLOPES, AND ALL SLOPES GREATER THAN 3 HORIZONTAL TO 1 VERTICAL (3:1) AND;
 2. FOURTEEN (14) DAYS FOR ALL OTHER DISTURBED OR GRADED AREAS ON THE PROJECT SITE.
 - D. THESE REQUIREMENTS DO NOT APPLY TO THOSE AREAS ON WHICH ACTUAL CONSTRUCTION ACTIVITIES ARE CURRENTLY BEING PERFORMED. INTERIOR AREAS OF A SURFACE MINE SITE, WHERE THE STABILIZATION MATERIAL WOULD CONTAMINATE THE RECOVERABLE RESOURCE, MAINTENANCE OF EROSION AND SEDIMENT CONTROL PRACTICES SHALL BE PERFORMED AS NECESSARY TO ENSURE THAT THE DISTURBED AREAS CONTINUOUSLY MEET THE APPROPRIATE REQUIREMENTS OF THE 1994 STANDARDS OR ITS LATEST REVISION, AND THAT RUNOFF FROM THESE AREAS DOES NOT ADVERSELY IMPACT DOWNSTREAM PROPERTIES.
- J. SEDIMENT AND EROSION CONTROL:
 1. SEDIMENT AND EROSION CONTROL MEASURES ARE TO BE INSTALLED PER THE "MARYLAND STANDARDS AND SPECIFICATIONS FOR SOIL EROSION AND SEDIMENT CONTROL" MARYLAND DEPARTMENT OF THE ENVIRONMENT (1994) AS CURRENTLY AMENDED AND AS DETAILS STATED FOR THESE PLANS.
 2. SOIL TESTS:
 - NO SITE SOIL BORINGS FOR EARTHWORK OPERATIONS PERFORMED FOR THE PREPARATION OF THESE PLANS.

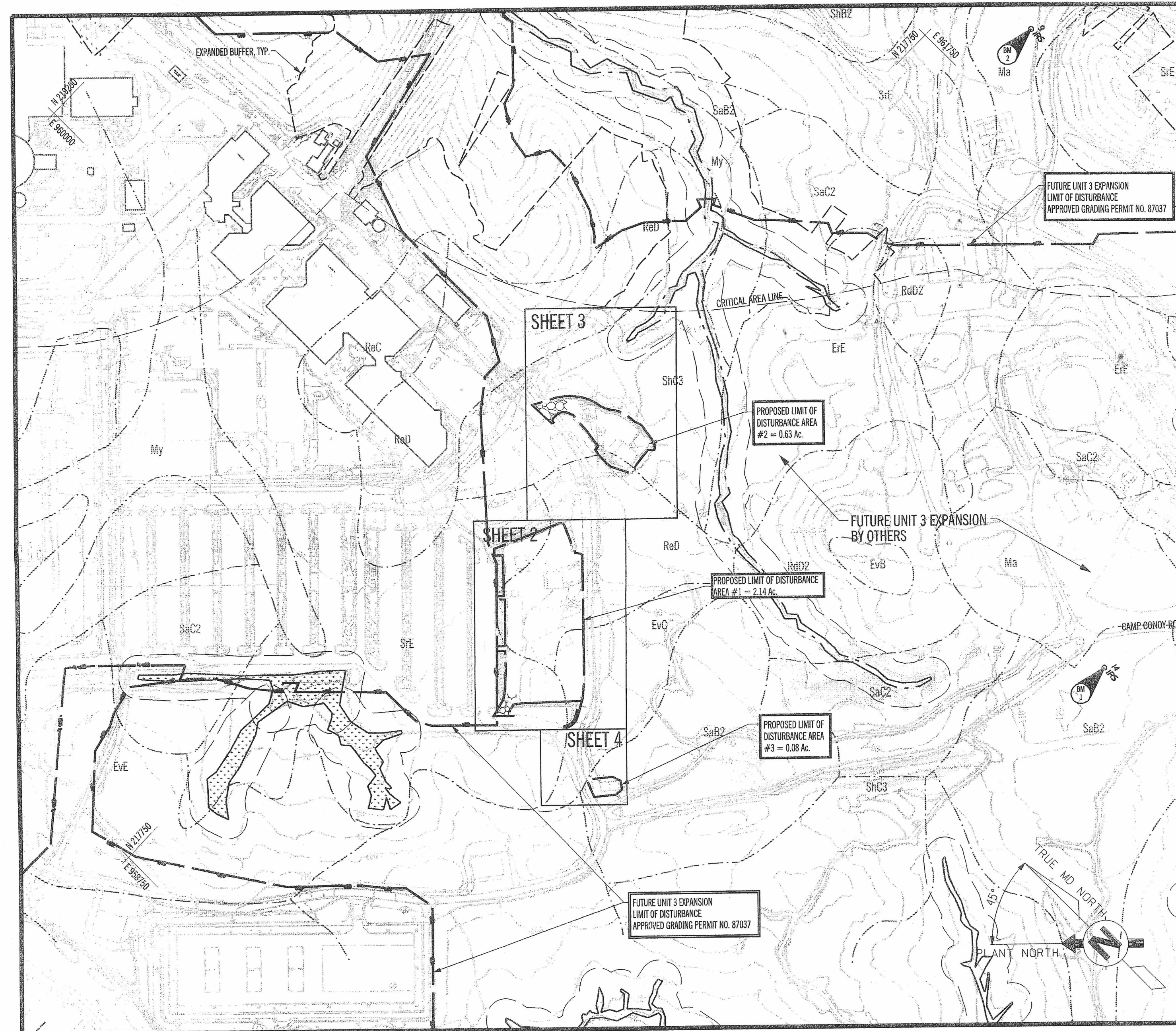

SITE PLAN NOTES

1. IT IS THE RESPONSIBILITY OF THE CONTRACTOR TO MEET ALL OF THE REQUIREMENTS OF THE FEDERAL, STATE, AND LOCAL AUTHORITIES, HEALTH DEPARTMENT AND UTILITY COMPANIES, IN ADDITION TO THE INFORMATION STATED ON THESE PLANS.
2. ALL WORK SHALL BE IN CONFORMANCE WITH MOSHA STANDARD SPECIFICATIONS FOR CONSTRUCTION AND MATERIALS AS CURRENTLY AMENDED.
3. IN CASE OF CONFLICT BETWEEN ANY PART OF THESE PLANS AND SPECIFICATIONS, OR IF ANY ERRORS OR OMISSIONS ARE DISCOVERED IN THE LINES, GRADES, AND DIMENSIONS, THE CONTRACTOR SHALL NOTIFY THE SITE CONSULTANT IMMEDIATELY AND SHALL REQUEST A WRITTEN DETERMINATION PRIOR TO PROCEEDING WITH THE WORK INVOLVED. IF THE WORK PROCEEDS WITH THE KNOWLEDGE OF ERROR OR OMISSION, AND WITHOUT WRITTEN DETERMINATION, SUCH WORK WILL BE CONSIDERED NOT IN COMPLIANCE WITH THESE PLANS AND SPECIFICATIONS.
4. PRIOR TO CONSTRUCTION, CONTACT THE ENFORCEMENT DIVISION, DEPARTMENT OF ENVIRONMENT AND STORMWATER MANAGEMENT ADMINISTRATION 1800 WASHINGTON BLVD. BALTIMORE, MARYLAND 21220 PHONE: (410) 569-9220
5. NOTIFY THE CALVERT COUNTY DEPARTMENT OF INSPECTIONS AND PERMITS, (410) 535-2155, THE CALVERT COUNTY SOIL CONSERVATION DISTRICT, (410) 535-1521, AND MISS UTILITY, (800) 257-7777, 48 HOURS PRIOR TO THE START OF ANY WORK ON THIS SITE.
6. A. OWNER'S / DEVELOPER: CALVERT CLIFFS 3 NUCLEAR PROJECT, LLC. SITE 1600P, 100 CONSTELLATION WAY BALTIMORE, MD 21202 ATTN: ED MILLER (443) 569-9220
B. CONSULTANT: GREENHORNE & O'MARA 6110 FROST PLACE LAUREL, MD 20707 (410) 266-0066 ATTN: MATTHEW KELLY, P.E.
7. AS CONSTRUCTION PROCEEDS, ADDITIONAL MEASURES MAY BE EMPLOYED WITH THE ENGINEER'S APPROVAL, IF CONDITIONS WARRANT, TO ENSURE EFFECTIVE STORMWATER DRAINAGE AND EROSION AND SEDIMENT CONTROL ON SITE.
8. SEDIMENT CONTROL MEASURES AND PROPOSED TREE LINE REPRESENTS LIMIT OF WORK UNLESS OTHERWISE STATED.
9. A. EXISTING ELEVATIONS SHOWN HEREON ARE FROM MAPS COMPILED BY PHOTOGRAMMETRIC METHODS FROM AERIAL PHOTOGRAPHY BY COLLINS/OLIFF & ASSOCIATES, INC. DATED JANUARY 7, 2007. GRID BASED ON MARYLAND STATE PLATE COORDINATE SYSTEM, NAD 1927. HORIZONTAL DATUM BASED ON NAD 1929. EXISTING UTILITIES SHOWN ARE TAKEN FROM FIELD RUN SURVEY BY COLLINS/OLIFF & ASSOCIATES, INC. DATED JULY 2008.
B. ALL ELEVATIONS SHOWN HEREON ARE IN REFERENCE TO BENCH MARKS AND MUST BE FIELD VERIFIED BY THE GENERAL CONTRACTOR PRIOR TO CONSTRUCTION.
10. THERE ARE NO FLOODPLAIN IMPACTS.
11. IT SHALL BE DISTINCTLY UNDERSTOOD THAT FAILURE TO MENTION SPECIFICALLY ANY WORK WHICH WOULD NATURALLY BE REQUIRED TO COMPLETE THIS PROJECT SHALL NOT RELIEVE THE CONTRACTOR OF HIS RESPONSIBILITY TO COMPLETE SUCH WORK.
12. ARCHAEOLOGICAL AND HISTORICAL RESOURCES: IF ARCHAEOLOGICAL MATERIALS ARE DISCOVERED DURING SITE WORK, THE CONTRACTOR OR DEVELOPER WILL CEASE WORK IN THE AFFECTED AREA AND CONTACT THE OWNER IMMEDIATELY. ALL PERSONNEL PERFORMING EARTH DISTURBANCE ACTIVITIES SHALL RECEIVE ARCHAEOLOGICAL AND HISTORIC RESOURCES TRAINING PRIOR TO STARTING WORK.
13. NON-TIDAL WETLANDS SHOWN ARE BASED ON INFORMATION PROVIDED BY COLLINS/OLIFF & ASSOCIATES, INC. DATED APRIL 2008.
14. PROPERTY LINE INFORMATION SHOWN IS BASED ON INFORMATION PROVIDED BY COLLINS/OLIFF & ASSOCIATES, INC.
15. FOR HAZARDOUS MATERIAL GENERAL NOTES, SEE SHEET 4.

LEGEND

[Symbol]	STEEP SLOPES 15%+
[Symbol]	PROPERTY LINE
[Symbol]	EXISTING 10' CONTOUR
[Symbol]	EXISTING TREE LINE
[Symbol]	NON-TIDAL WETLANDS W/ BUFFER
[Symbol]	CRITICAL AREA LINE
[Symbol]	EXPANDED BUFFER LINE
[Symbol]	SOIL TYPES

SOILS TABLE

SOIL MAP SYMBOL	SOIL NAME	HYDROIC SOIL	SLOPES > 15%	HYDROLOGIC SOILS GROUP
Bb2	Beltville Silt Loam	No	Yes	C
Co	Coastal Beaches	Yes	Yes	
E/E	Enfield Land	No	Yes	
E/B	Evesboro Loamy Sand	No	Yes	A
E/C	Evesboro Loamy Sand	No	Yes	A
Ma	Made Land	No	Yes	
Mn2	Matapeake Silt Loam	No	Yes	B
MnC2	Matapeake Silt Loam	Yes	Yes	B
My	Mixed Alluvial Land	No	Yes	D
Rd2	Rumford Loamy Sand	No	Yes	B
Rd	Rumford Evesboro	No	Yes	B
	Gravelly Loamy Sands			
SaB2	Sassafras	No	Yes	B
SaC2	Sassafras	No	Yes	B
ShB2	Sassafras	No	Yes	B
ShC3	Sassafras	No	Yes	B
ShD3	Sassafras	No	Yes	B
S/E	Sassafras or Westphalia	No	Yes	B
W	Water	-	-	-
WoA	Woodtown Fine Sandy Loam	No	Yes	C

OWNER'S / DEVELOPER'S CERTIFICATION

WE HEREBY CERTIFY THAT WE HAVE REVIEWED THESE EROSION AND SEDIMENT CONTROL PLANS AND THAT ALL CLEARING, GRADING, CONSTRUCTION AND DEVELOPMENT WILL BE PERFORMED PURSUANT TO THESE PLANS AND THAT RESPONSIBLE PERSONNEL INVOLVED IN THE CONSTRUCTION OF THIS PROJECT WILL HAVE A CERTIFICATE OF ATTENDANCE AT A DEPARTMENT OF THE ENVIRONMENT APPROVED TRAINING PROGRAM FOR THE CONTROL OF SEDIMENT AND EROSION BEFORE BEGINNING THE PROJECT.

SIGNATURE: *[Signature]* DATE: 10/14/10
NAME: EDWARD JARMAS TITLE: GENERAL MANAGER

CALVERT CLIFFS 3 NUCLEAR PROJECT, LLC
STE 1600P, 100 CONSTELLATION WAY
BALTIMORE, MD 21202
ATTN: ED MILLER
(443) 569-9220

SURVEYOR'S / ENGINEER'S CERTIFICATION

I HEREBY CERTIFY THAT THIS PLAN FOR EROSION AND SEDIMENT CONTROL MEETS THE REQUIREMENTS, STANDARDS, AND SPECIFICATIONS OF THE CALVERT SOIL CONSERVATION DISTRICT, AND THAT ALL PROPOSED GRADING AND OTHER WORK MEET THE REQUIREMENTS OF THE APPROPRIATE CALVERT COUNTY GRADING AND EROSION & SEDIMENT CONTROL ORDINANCES.

SIGNATURE: *[Signature]* DATE: 2/28/10
NAME: P.E. LICENSE NO. 24836
MATTHEW B. KELLY GREENHORNE & O'MARA
NAME (PRINT) NAME OF FIRM

6110 FROST PLACE, LAUREL, MARYLAND 20707
ADDRESS

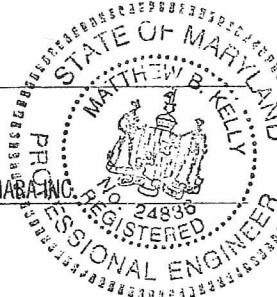

NUM.	DESCRIPTION	NORTHING	EASTING	ELEVATION
1	IRS	216255.47	960900.95	116.44
2	IRS	217562.12	961956.87	35.81

OVERALL PLAN

SCALE: 1" = 200'

**THIS PLAN FOR
SEDIMENT CONTROL FOR
BUILDING DEMOLITION ONLY**

FOR SEQUENCE OF CONSTRUCTION, SEE SHEET 4.

- ### SHEET INDEX
- 1 COVER SHEET
 - 2-3 SEDIMENT CONTROL AND DEMOLITION PLAN
 - 4 SEDIMENT AND EROSION CONTROL NOTES & DETAILS

THERE SHALL BE NO DISTURBANCE TO WETLANDS OR BUFFERS DURING CONSTRUCTION/ DEMOLITION

OWNER/DEVELOPER:
CALVERT CLIFFS 3 NUCLEAR PROJECT, LLC
100 CONSTELLATION WAY
BALTIMORE, MD 21202
ATTN: ED MILLER
(410) 569-9220

I HEREBY CERTIFY THAT THESE DOCUMENTS WERE PREPARED OR APPROVED BY ME, AND THAT I AM A DULY LICENSED PROFESSIONAL ENGINEER UNDER THE LAWS OF THE STATE OF MARYLAND, LICENSE NO. 24836, EXPIRATION DATE: 2/28/2012

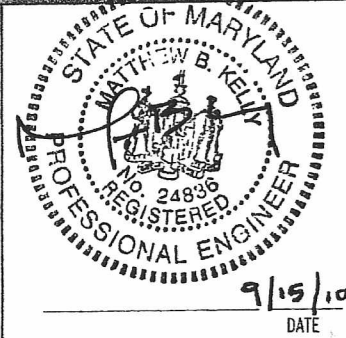

No.	REVISION	DATE	BY
1	ISSUE FOR PERMIT	9/13/10	C&O

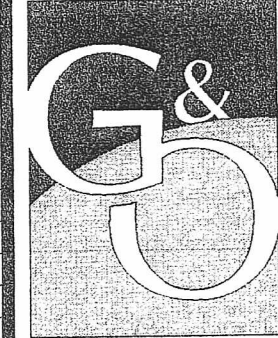

GREENHORNE & O'MARA
CONSULTING ENGINEERS
6110 FROST PLACE, LAUREL, MARYLAND 20707
PHONE: (410) 266-0066 FAX: (410) 266-0067
www.g-and-o.com
FLORIDA • KANSAS • MARYLAND • NORTH CAROLINA • PENNSYLVANIA • VIRGINIA • WEST VIRGINIA

COVER SHEET
SEDIMENT CONTROL AND DEMOLITION
FOR
CALVERT CLIFFS UNIT 3 EXPANSION
FUTURE HEAVY HAUL ROAD AREA
TAX MAP 35; PARCEL 9
1ST DISTRICT, 3RD ASSESSMENT AREA
CALVERT COUNTY, MD

BDA DESIGN	SCALE	1" = 200'
BDA DRAWN	SHEET	1 OF 4
MBK CHECKED		
DATE	SEPT. 2010	094701
		PROJ No.
		FILE No.