FIGURES



- Phase I Properties**
- Remediated
- Phase II Properties**
- Scheduled for remediation
- Burial Pits
 - Retention Ponds

Figure 1-1
FMSS and Surrounding Properties



0 600 1200 Feet

Note: The location and status of the vicinity properties shown on this map are for general reference only. The USACE is not responsible for the accuracy of the information shown on this map. If you have specific questions about a particular property, please contact the USACE Public Information Center at 100 West Street, Newark, New Jersey 07102. USACE, 100 West Street, Newark, New Jersey 07102. USACE, 100 West Street, Newark, New Jersey 07102.

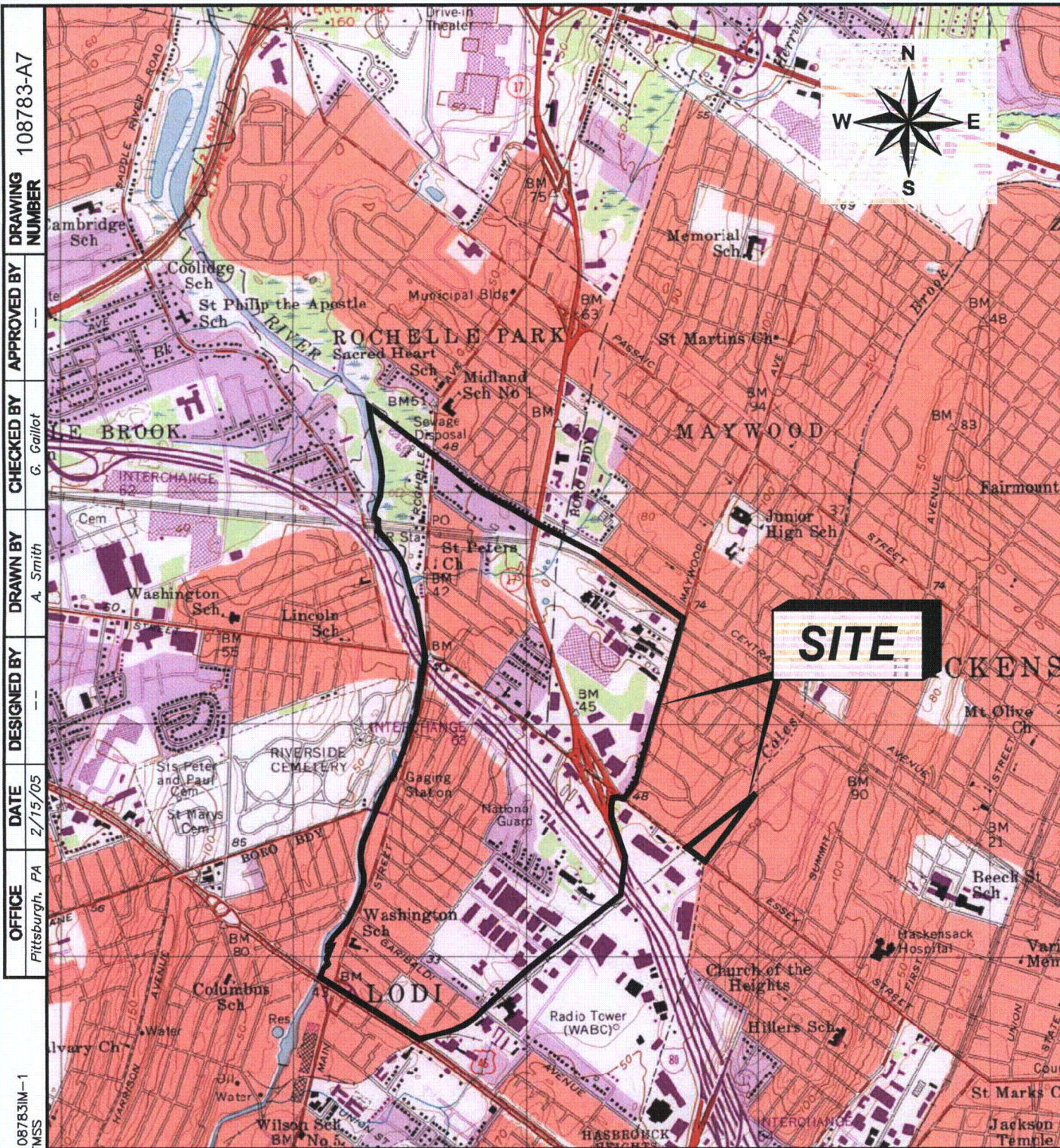

SCALE

0 2000 4000 FEET

REFERENCE:

7.5 MIN USGS TOPOGRAPHIC MAP OF
HACKENSACK, NJ QUADRANGLE. DATED: 1997

FIGURE 1-2
SITE LOCATION MAP
MAYWOOD SUPERFUND SITE, NEW JERSEY



US Army Corps
of Engineers

FUSRAP

Maywood Superfund Site



Shaw Environmental, Inc.

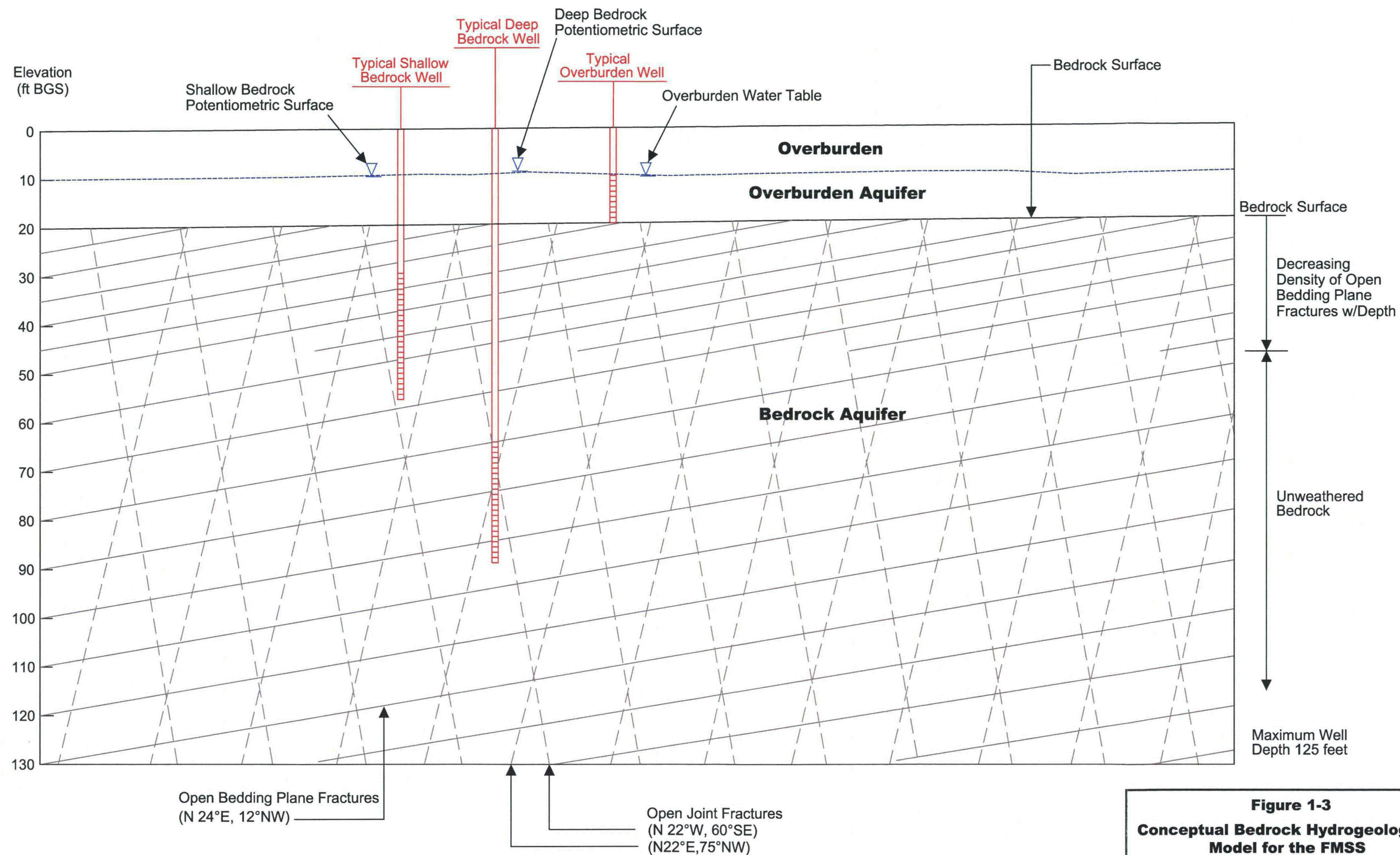
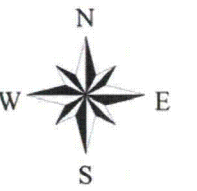
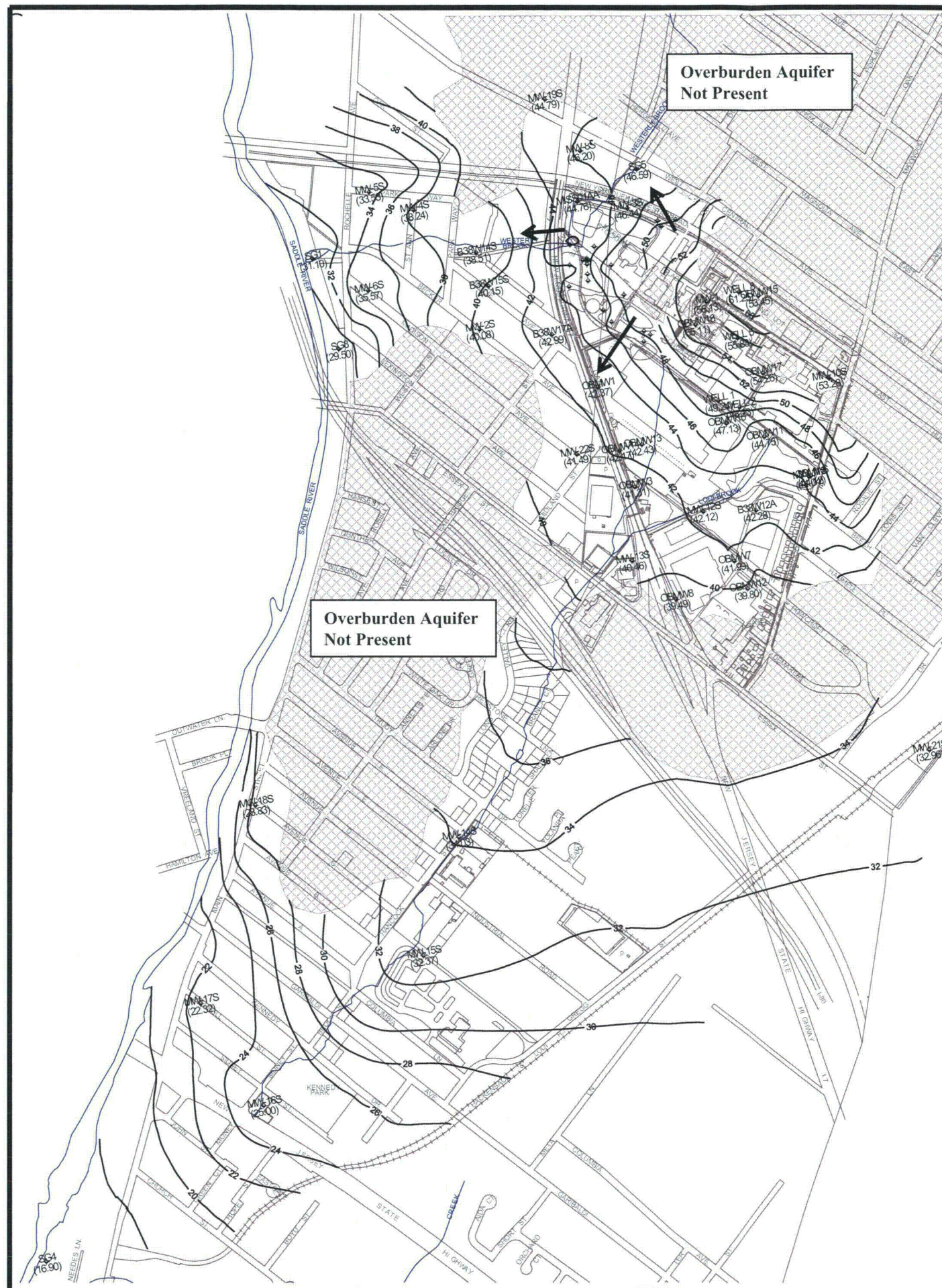

Figure 1-3
Conceptual Bedrock Hydrogeological Model for the FMSS



Legend:

- MW-15S (32.37) Overburden Monitoring Well
- Zone of 0 ft. Saturated Thickness (i.e., overburden aquifer not present).
- Equipotential Contour in feet above Mean Sea Level (MSL). Contour Interval = 2 feet.
- Groundwater Flow Direction

Note: Figure 1-5 initially appeared as Figure 3-19a of the GWRI – November 2004

Horizontal Scale in feet
0 500 1000 1500

Note: The location and status of the vicinity properties shown on this map are for general reference only. The USACE is reviewing historical archives to confirm the accuracy of the property locations and status depicted on the map. If you have specific questions about a particular property, please contact the USACE Public Information Center at 75A West Pleasant Avenue, Maywood, New Jersey or call 201-943-7466. Or, visit the FUSRAP Maywood Chemical Company Superfund Site website at <www.fusrapmaywood.com>.

Figure 1-5
Overburden, Groundwater Surface Elevation
Map of FMSS
(July 2001 Synoptic Event)

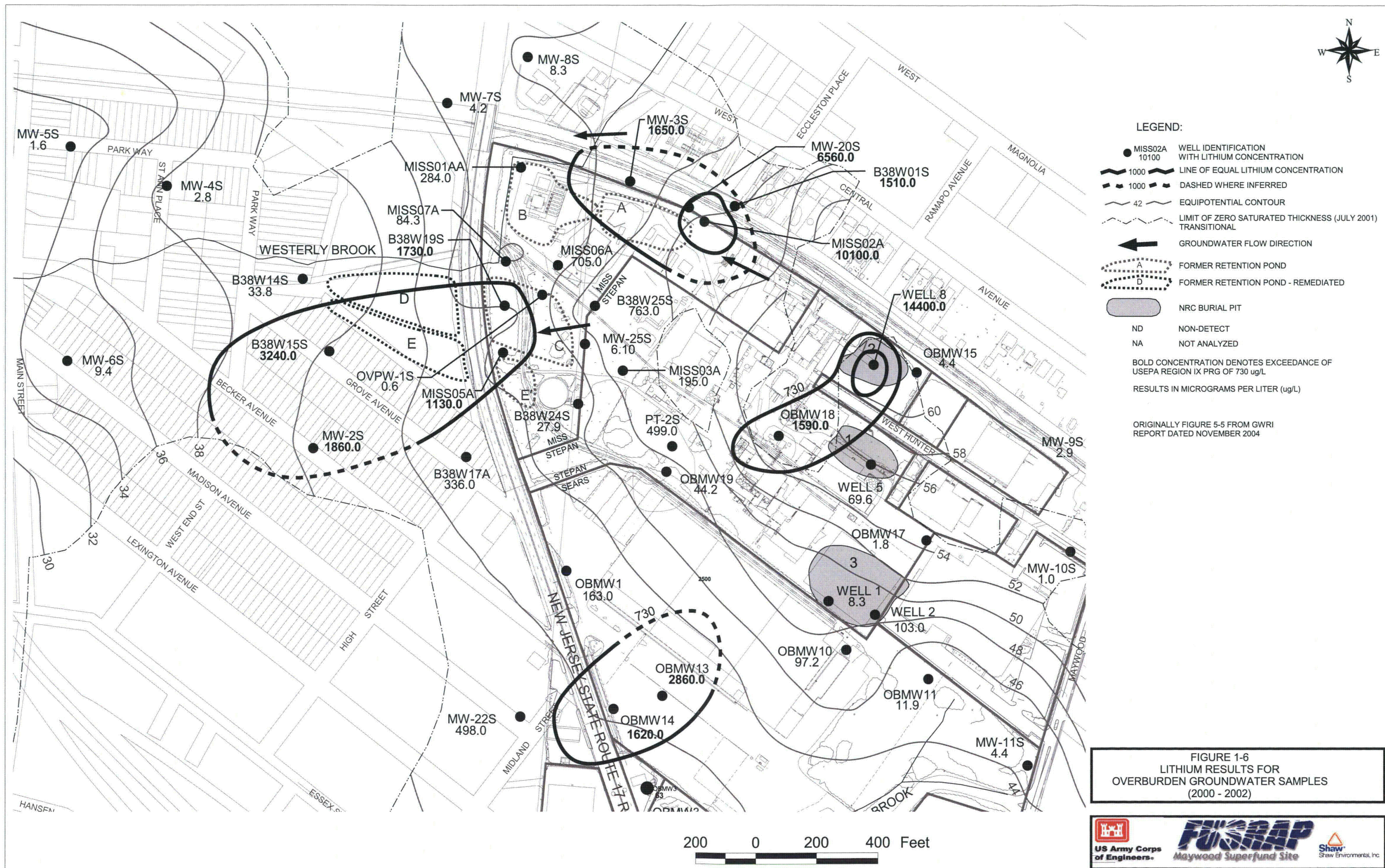

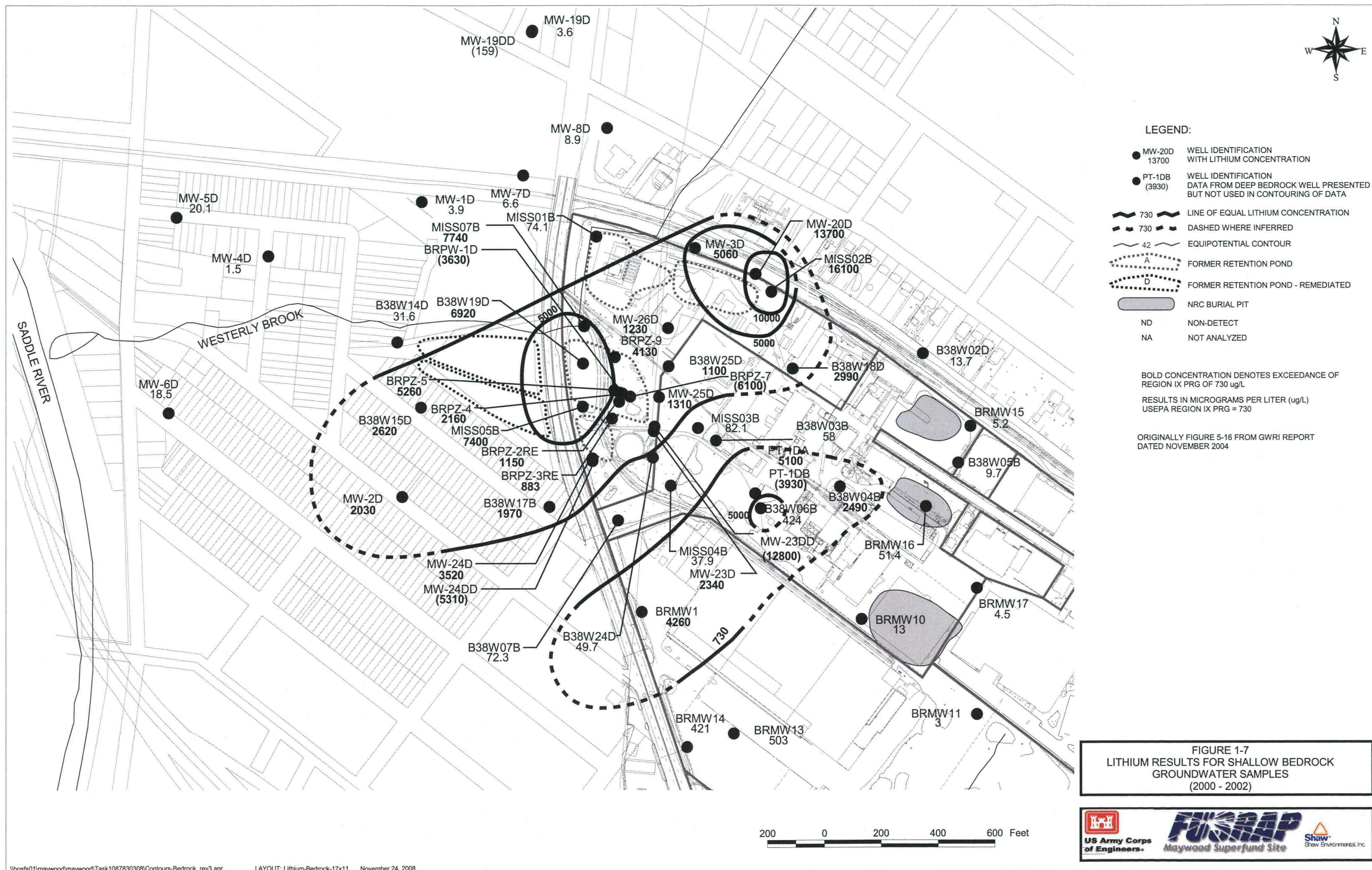

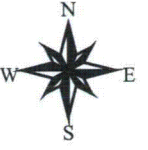

LEGEND:

- MW-27D 5 ug/L BEDROCK WELL IDENTIFICATION WITH BENZENE CONCENTRATION
- A FORMER RETENTION POND
- D FORMER RETENTION POND - REMEDIATED
- ND NON-DETECT
- RESULTS IN MICROGRAMS PER LITER (ug/L)
- 10 LINE OF EQUAL BENZENE CONCENTRATION
- 10 DASHED WHERE INFERRED
- 47 LINE OF EQUAL HYDRAULIC HEAD (JUNE 2003)
- POTENTIAL SOURCE AREA

BOLDED CONCENTRATIONS DENOTE EXCEEDANCE OF BENZENE GROUNDWATER STANDARD OF 1 ug/L (NJ GWQC)

ORIGINALLY FIGURE 5-17 FROM GWRI REPORT DATED NOVEMBER 2004

NON-FUSRAP PLUME; NOT ADDRESSED IN THIS GWFS

Note: The location and status of the vicinity properties shown on this map are for general reference only. The USACE is reviewing historical archives to confirm the accuracy of the property locations and status depicted on the map. If you have specific questions about a particular property, please contact the USACE Public Information Center at 75A West Pleasant Avenue, Maywood, New Jersey or call 201-843-7466. Or, visit the FUSRAP Maywood Chemical Company Superfund Site website at www.fusrapmaywood.com.

FIGURE 1-9
BENZENE RESULTS FOR SHALLOW
BEDROCK GROUNDWATER SAMPLES
SUPPLEMENTAL INVESTIGATION

100 0 100 200 Feet



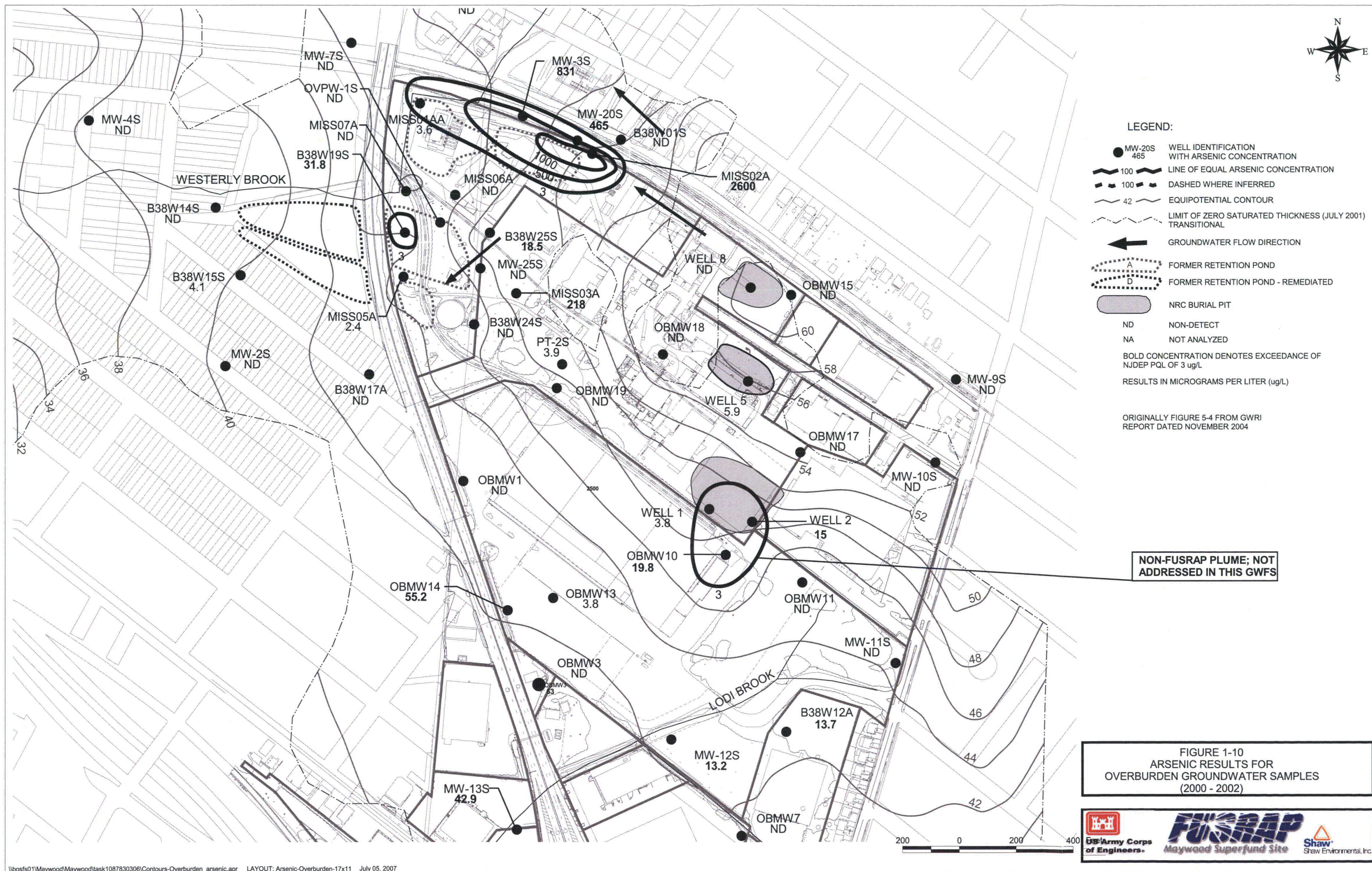

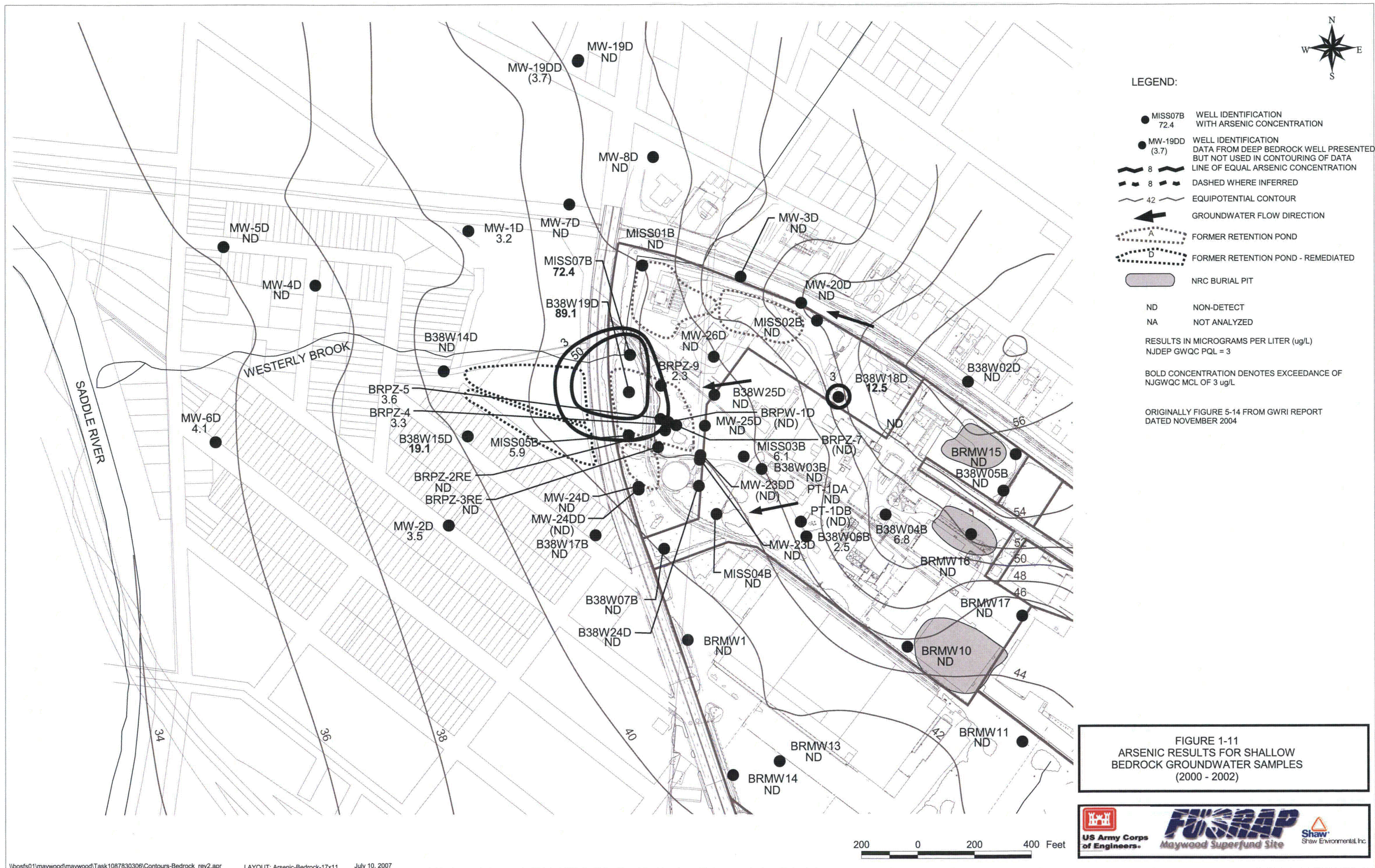

108783-A11
DRAWING
NUMBER

APPROVED BY

CHECKED BY
G. Caillot

DRAWN BY
B. Snyder

DESIGNED BY

DATE
5/5/05

OFFICE
Pittsburgh, PA

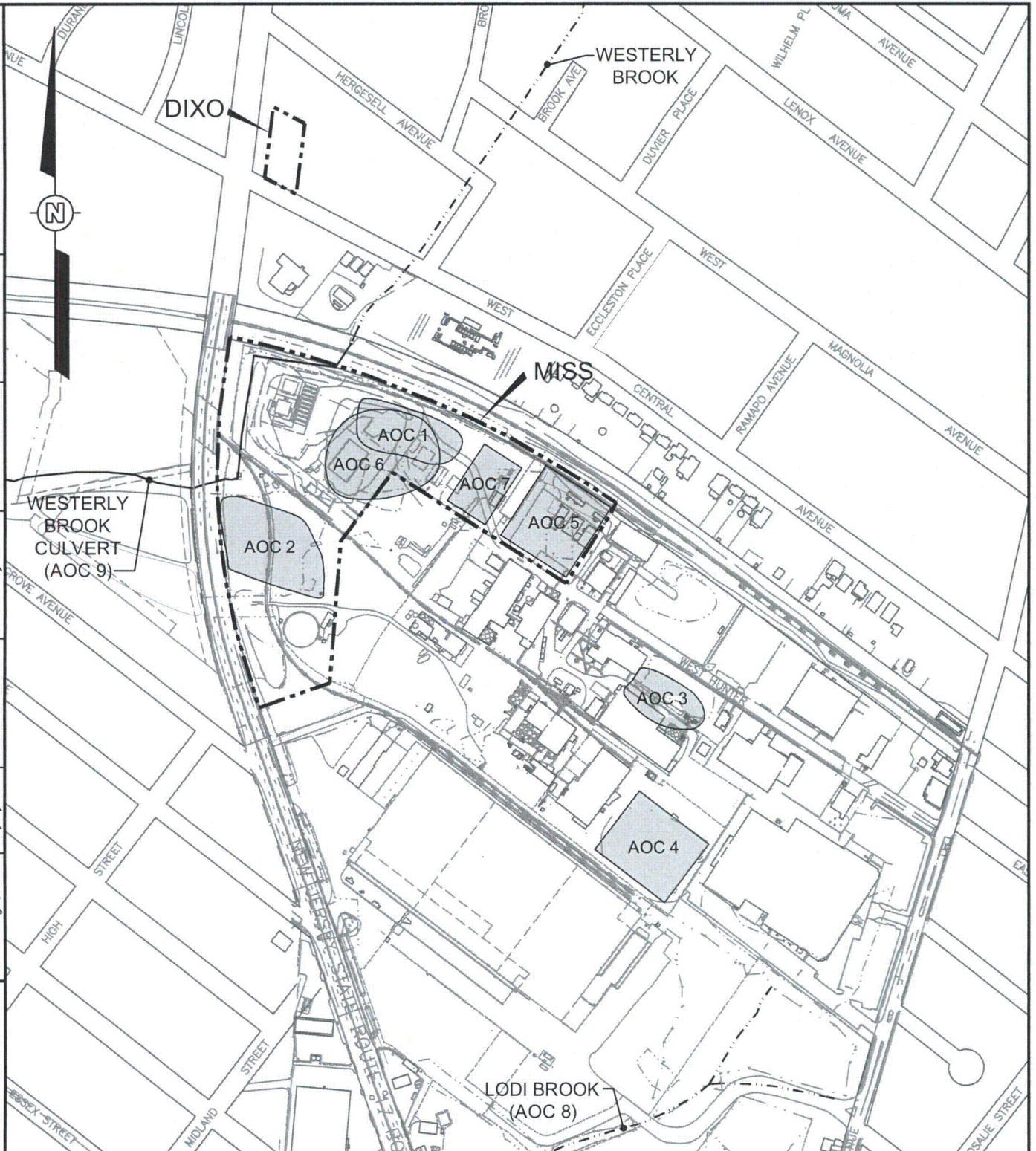

AREAS OF CONCERN:

- AOC 1 - FORMER RETENTION POND A
- AOC 2 - FORMER RETENTION POND C
- AOC 3 - NRC BURIAL PIT 1
- AOC 4 - NRC BURIAL PIT 3
- AOC 5 - WELL B38W18D (FORMER THORIUM MANUFACTURING)
- AOC 6 - PROBABLE BENZENE SOURCE AREA (BEDROCK)
- AOC 7 - PROBABLE BENZENE SOURCE AREA (OVERBURDEN)
- AOC 8 - LODI BROOK
- AOC 9 - WESTERLY BROOK

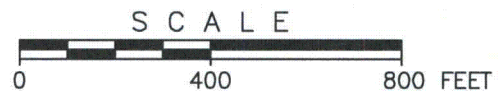

FIGURE 1-12
GROUNDWATER AREAS OF CONCERN (AOCs)
MAYWOOD SUPERFUND SITE, NEW JERSEY



US Army Corps
of Engineers

FUSRAP
Maywood Superfund Site



Shaw Environmental, Inc.



OFFICE	DATE	DESIGNED BY	DRAWN BY	CHECKED BY	APPROVED BY	DRAWING NUMBER
Pittsburgh, PA	8/2/05	---	G. Jones	G. Gallot	---	108783-A13



Conceptual Cross-Section of Soil Remediation
"Not to Scale"

Legend:



Groundwater table

Notes:

(1.) To be removed under the Soils and Buildings ROD.

(2.) To be removed under the Groundwater ROD. Some soil will be removed from below the groundwater table in localized areas.

FIGURE 4-2
 CONCEPTUAL DIAGRAM OF MISS SOIL
 REMEDIATION
 MAYWOOD SUPERFUND SITE, NEW JERSEY



US Army Corps
 of Engineers

FUSRAP
 Maywood Superfund Site



Shaw Environmental, Inc.

DRAWING NUMBER 108783-A3

APPROVED BY

CHECKED BY G. Gallot

DRAWN BY A. Smith

DESIGNED BY

DATE 1/24/05

OFFICE Pittsburgh, PA

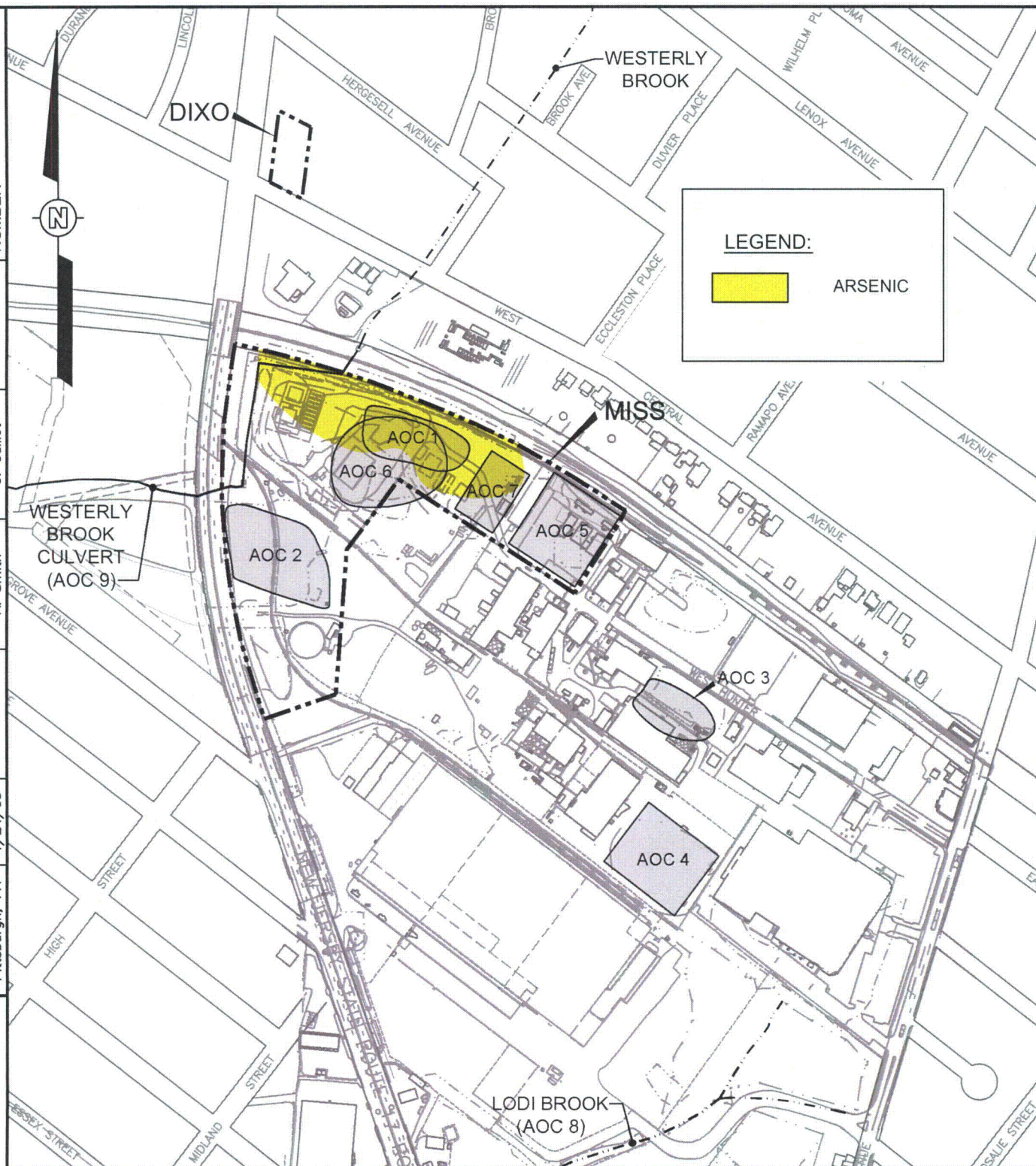

AREAS OF CONCERN:

- AOC 1 - FORMER RETENTION POND A
- AOC 2 - FORMER RETENTION POND C
- AOC 3 - NRC BURIAL PIT 1
- AOC 4 - NRC BURIAL PIT 3
- AOC 5 - WELL B38W18D (FORMER THORIUM MANUFACTURING)
- AOC 6 - PROBABLE BENZENE SOURCE AREA (BEDROCK)
- AOC 7 - PROBABLE BENZENE SOURCE AREA (OVERBURDEN)
- AOC 8 - LODI BROOK
- AOC 9 - WESTERLY BROOK

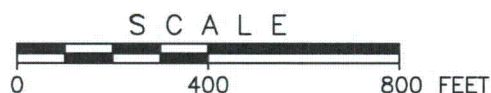
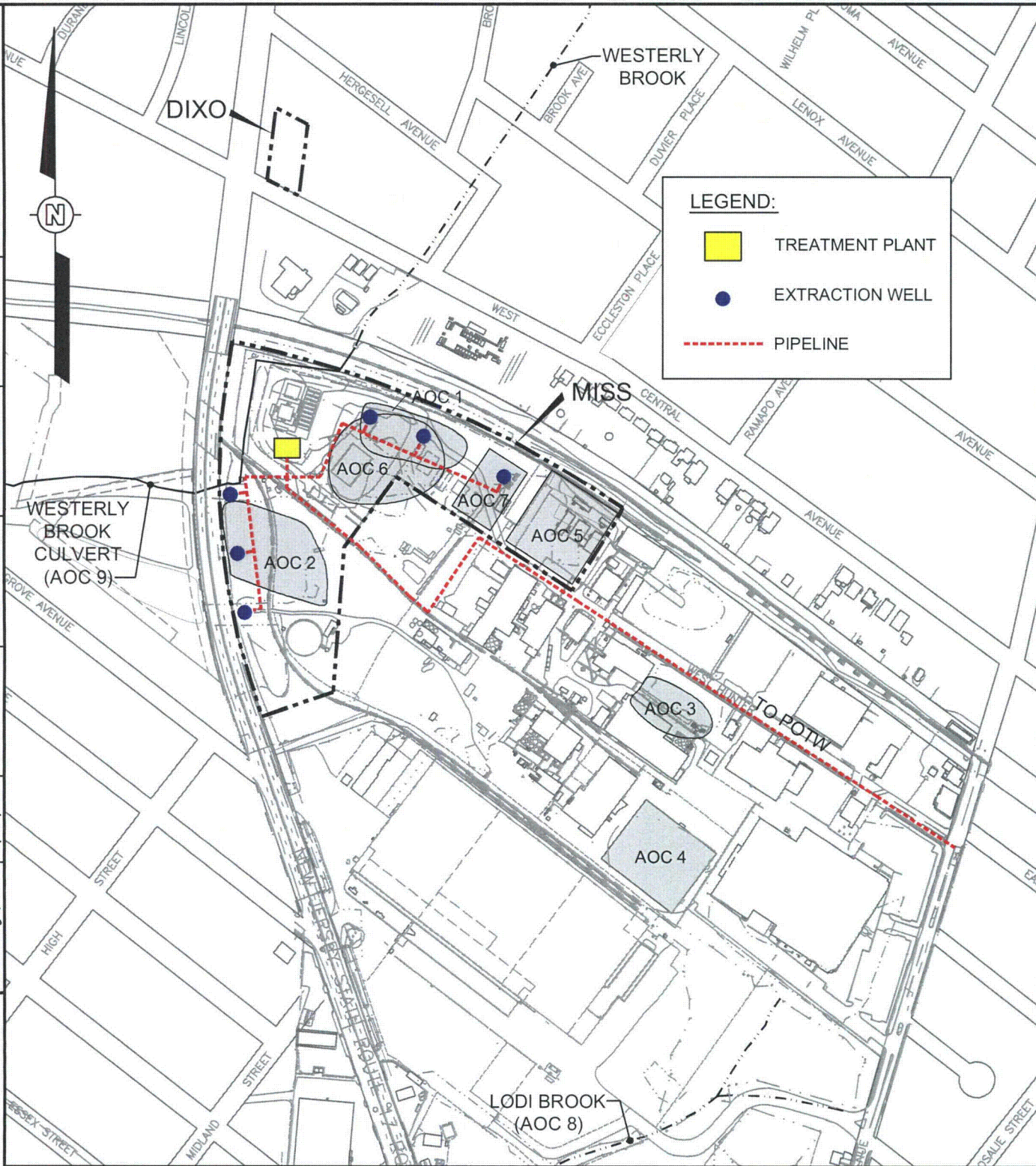

FIGURE 4-3
ALTERNATIVE 3 - ARSENIC
IN-SITU TREATMENT AREA, OVERBURDEN
MAYWOOD SUPERFUND SITE, NEW JERSEY



OFFICE	DATE	DESIGNED BY	DRAWN BY	CHECKED BY	APPROVED BY	DRAWING NUMBER
Pittsburgh, PA	1/24/05	---	A. Smith	G. Caillot	---	108783-A6



AREAS OF CONCERN:

- AOC 1 - FORMER RETENTION POND A
- AOC 2 - FORMER RETENTION POND C
- AOC 3 - NRC BURIAL PIT 1
- AOC 4 - NRC BURIAL PIT 3
- AOC 5 - WELL B38W18D (FORMER THORIUM MANUFACTURING)
- AOC 6 - PROBABLE BENZENE SOURCE AREA (BEDROCK)
- AOC 7 - PROBABLE BENZENE SOURCE AREA (OVERBURDEN)
- AOC 8 - LODI BROOK
- AOC 9 - WESTERLY BROOK

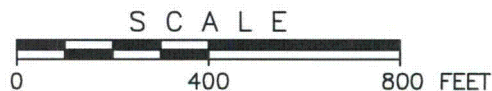

FIGURE 4-4
ALTERNATIVE 4 - CONCEPTUAL GROUNDWATER TREATMENT PLANT & EXTRACTION WELL LOCATIONS
 MAYWOOD SUPERFUND SITE, NEW JERSEY



US Army Corps
of Engineers

FUSRAP
 Maywood Superfund Site



Shaw Environmental, Inc.

OFFICE	DATE	DESIGNED BY	DRAWN BY	CHECKED BY	APPROVED BY	DRAWING NUMBER
Pittsburgh, PA	1/24/05	--	A. Smith	G. Caillot	--	108783-A5



AREAS OF CONCERN:

- AOC 1 - FORMER RETENTION POND A
- AOC 2 - FORMER RETENTION POND C
- AOC 3 - NRC BURIAL PIT 1
- AOC 4 - NRC BURIAL PIT 3
- AOC 5 - WELL B38W18D (FORMER THORIUM MANUFACTURING)
- AOC 6 - PROBABLE BENZENE SOURCE AREA (BEDROCK)
- AOC 7 - PROBABLE BENZENE SOURCE AREA (OVERBURDEN)
- AOC 8 - LODI BROOK
- AOC 9 - WESTERLY BROOK

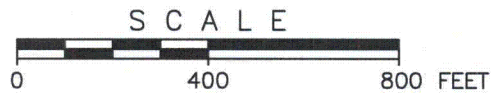

FIGURE 4-5
ALTERNATIVE 4 - GROUNDWATER EXTRACTION
CAPTURE ZONE
MAYWOOD SUPERFUND SITE, NEW JERSEY



US Army Corps
of Engineers

FUSRAP
Maywood Superfund Site



Shaw Environmental, Inc.

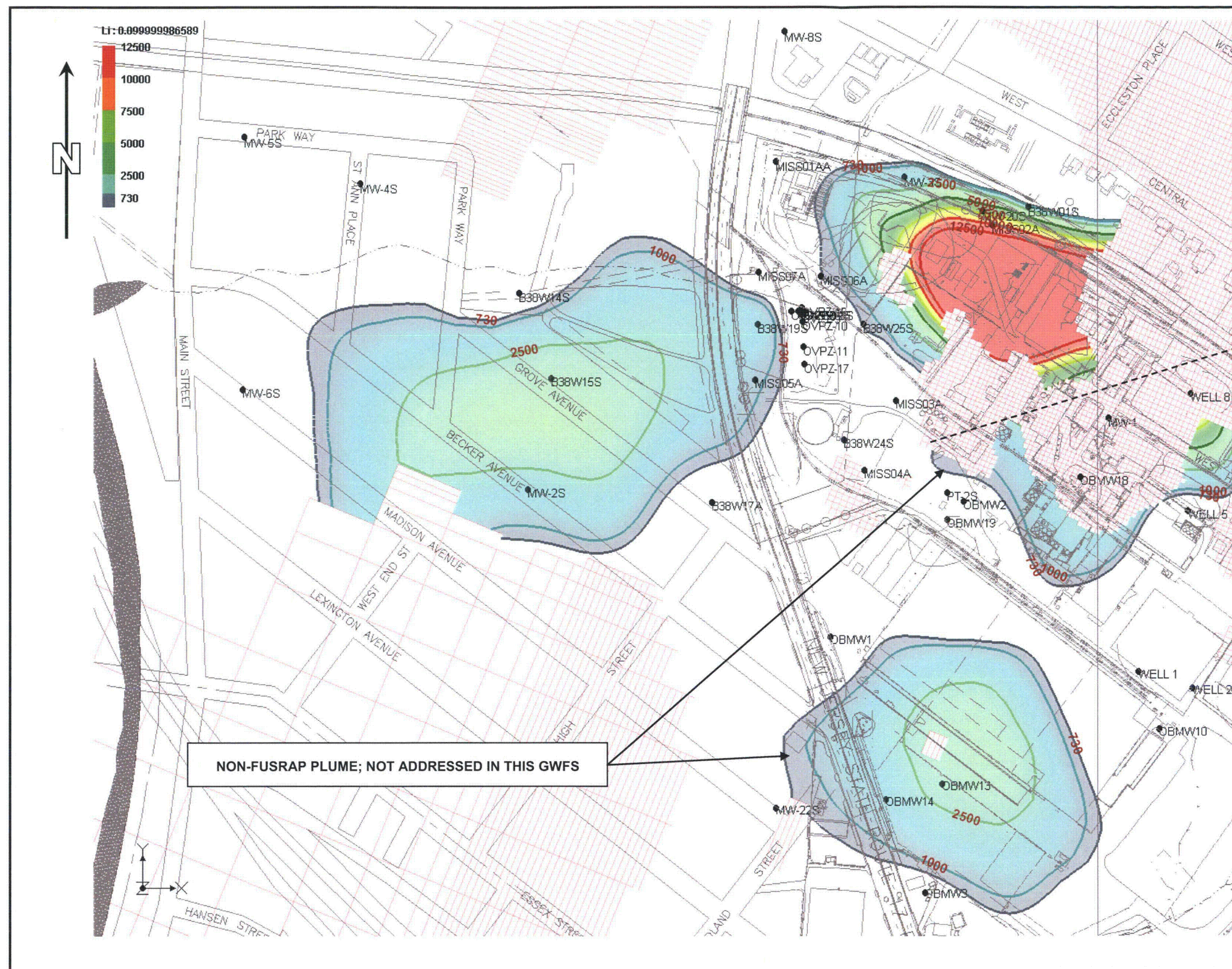

NOTES:

1. THE OVERBURDEN AQUIFER IS NOT PRESENT IN AREAS WITH MODEL GRID.
2. LITHIUM CONCENTRATIONS ARE DISPLAYED IN UNITS OF MICROGRAMS PER LITER (UG/L).
3. THE RISK-BASED ACTION LEVEL FOR LITHIUM IS 730 UG/L.
4. YEAR ZERO LITHIUM CONCENTRATIONS ARE BASED ON GROUNDWATER MONITORING RESULTS OBTAINED BETWEEN 2000 AND 2002.

SCALE
1 INCH = 300 FEET

FIGURE 5-1A
ALTERNATIVES 1 AND 2 – MODEL YEAR 0
LITHIUM PLUME, OVERBURDEN
MAYWOOD SUPERFUND SITE, NEW JERSEY



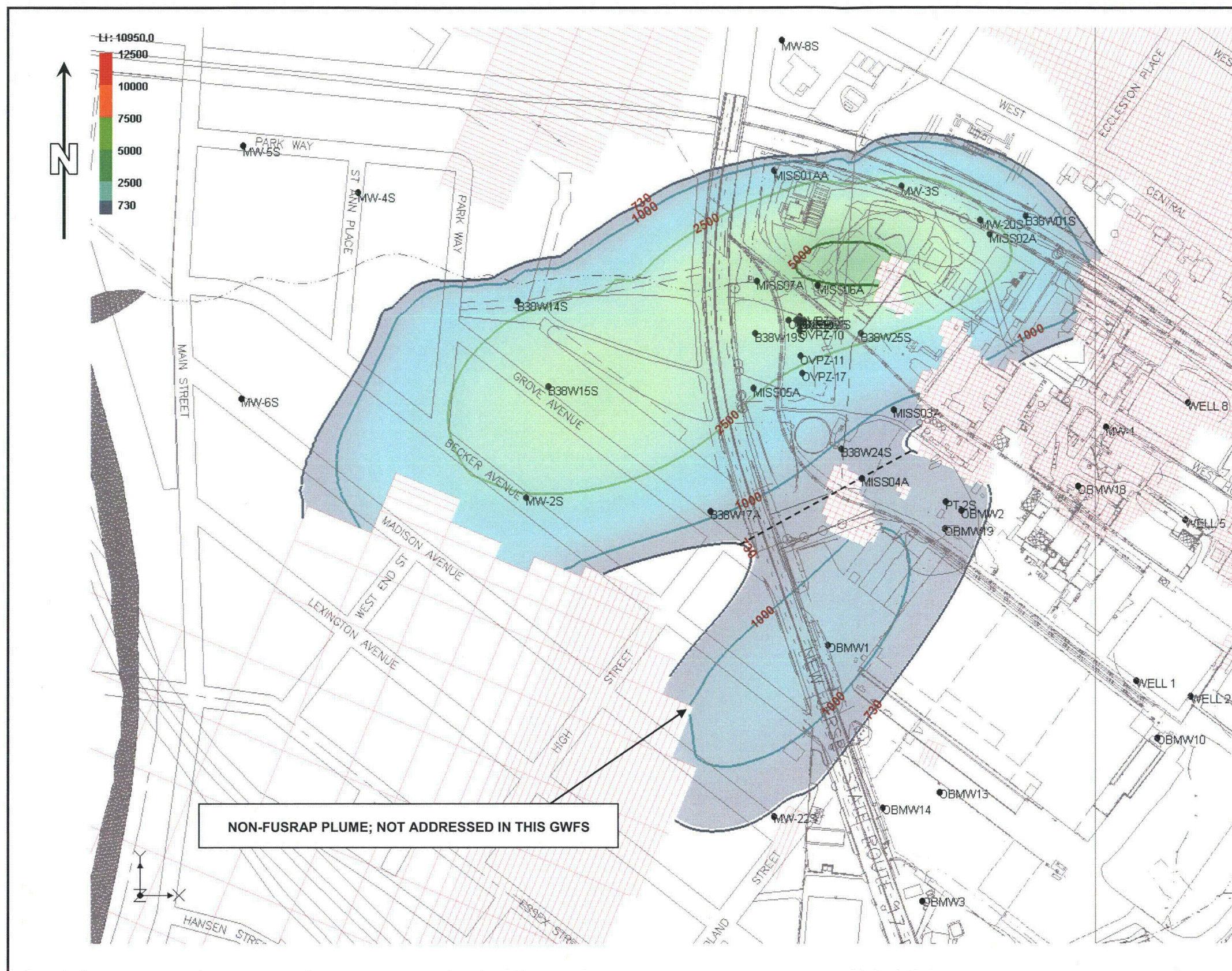

NOTES:

1. THE OVERBURDEN AQUIFER IS NOT PRESENT IN AREAS WITH MODEL GRID.
2. LITHIUM CONCENTRATIONS ARE DISPLAYED IN UNITS OF MICROGRAMS PER LITER (UG/L).
3. THE RISK-BASED ACTION LEVEL FOR LITHIUM IS 730 UG/L.

SCALE
1 INCH = 300 FEET

FIGURE 5-1B
ALTERNATIVES 1 AND 2 – MODEL YEAR 30
LITHIUM PLUME, OVERBURDEN
MAYWOOD SUPERFUND SITE, NEW JERSEY



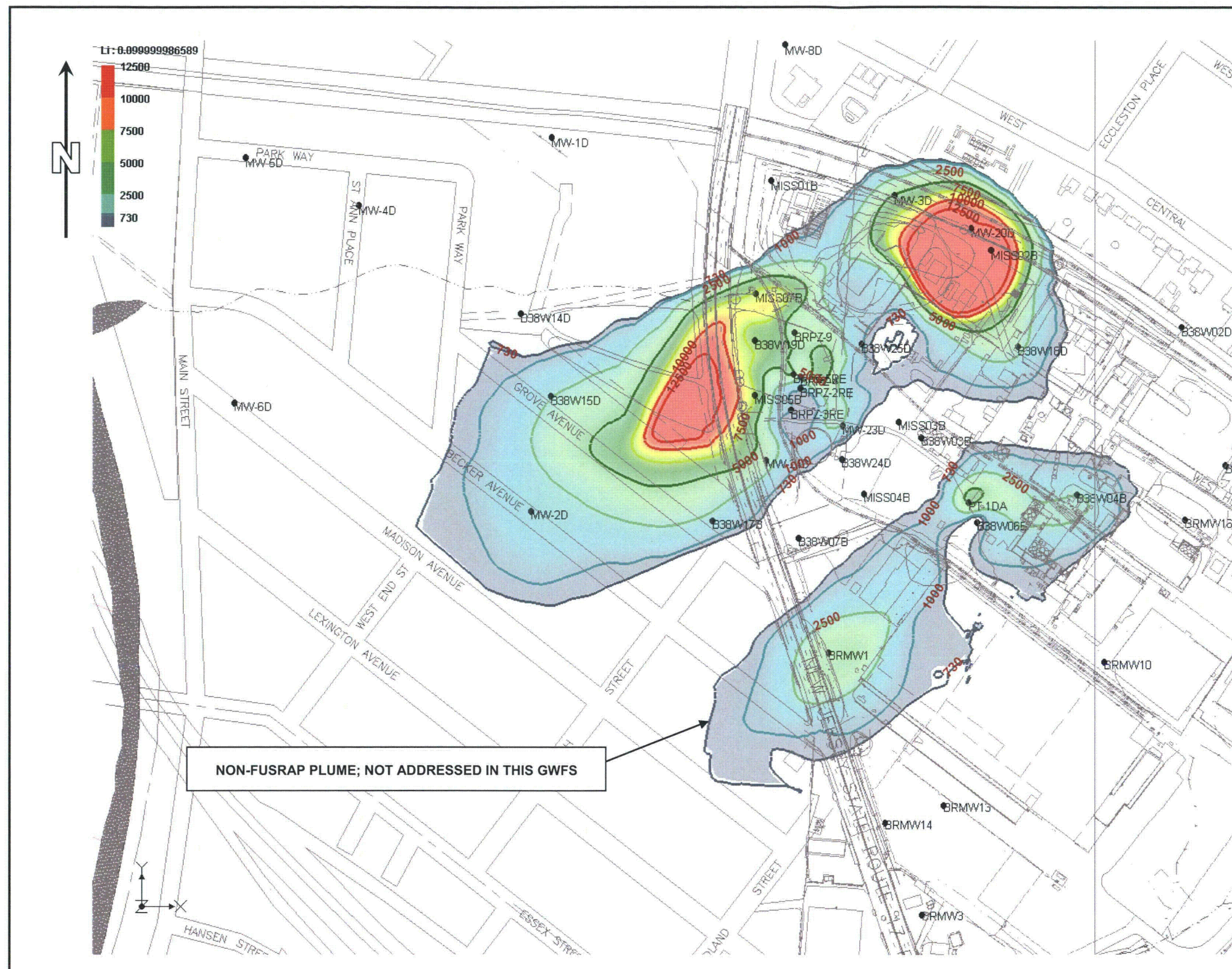

NOTES:

1. LITHIUM CONCENTRATIONS ARE DISPLAYED IN UNITS OF MICROGRAMS PER LITER (UG/L).
2. THE RISK-BASED ACTION LEVEL FOR LITHIUM IS 730 UG/L.
3. YEAR ZERO LITHIUM CONCENTRATIONS ARE BASED ON GROUNDWATER MONITORING RESULTS OBTAINED BETWEEN 2000 AND 2002.

SCALE
1 INCH = 300 FEET

FIGURE 5-2A
ALTERNATIVES 1 AND 2 – MODEL YEAR 0
LITHIUM PLUME, SHALLOW BEDROCK
MAYWOOD SUPERFUND SITE, NEW JERSEY



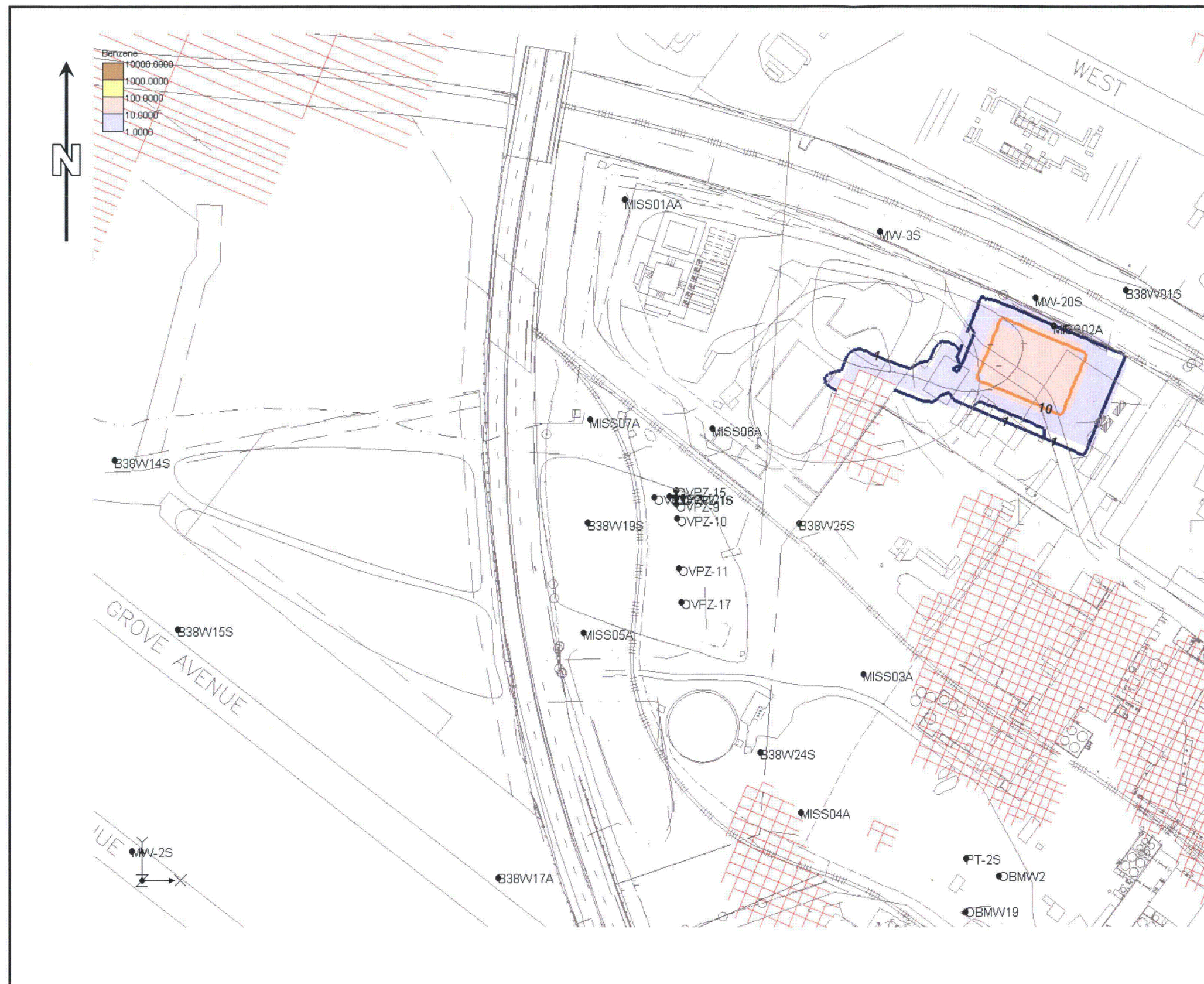

NOTES:

1. THE OVERBURDEN AQUIFER IS NOT PRESENT IN AREAS WITH MODEL GRID.
2. BENZENE CONCENTRATIONS ARE DISPLAYED IN UNITS OF MICROGRAMS PER LITER (UG/L).
3. THE REGULATORY LIMIT FOR BENZENE IS 1 UG/L.
4. YEAR ZERO BENZENE CONCENTRATIONS ARE BASED ON GROUNDWATER MONITORING RESULTS OBTAINED BETWEEN 2000 AND 2002.

FIGURE 5-3A
ALTERNATIVES 1 AND 2 – MODEL YEAR 0
BENZENE PLUME, OVERBURDEN
MAYWOOD SUPERFUND SITE, NEW JERSEY



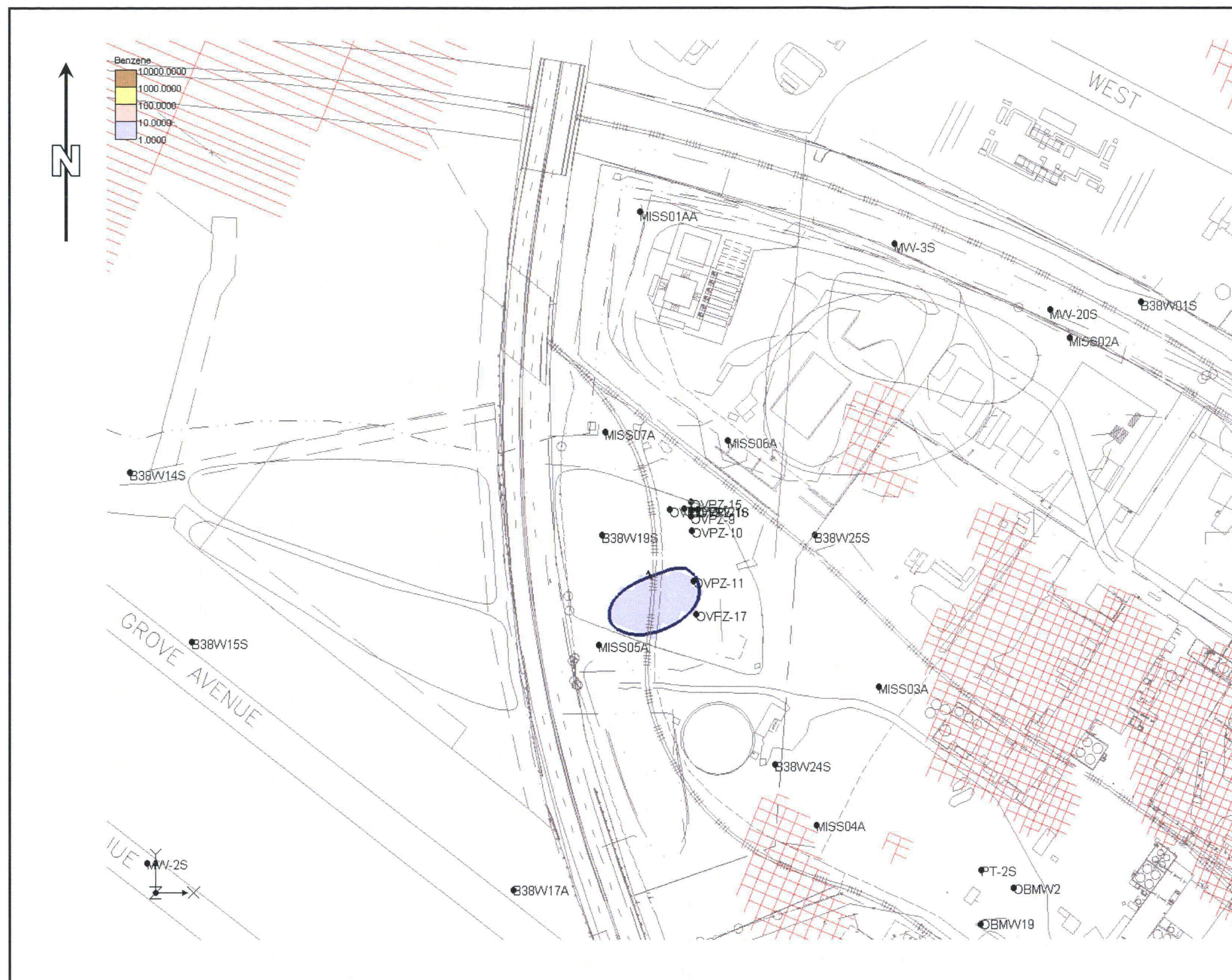

NOTES:

1. THE OVERBURDEN AQUIFER IS NOT PRESENT IN AREAS WITH MODEL GRID.
2. BENZENE CONCENTRATIONS ARE DISPLAYED IN UNITS OF MICROGRAMS PER LITER (UG/L).
3. THE REGULATORY LIMIT FOR BENZENE IS 1 UG/L.

FIGURE 5-3B
ALTERNATIVES 1 AND 2 – MODEL YEAR 6
BENZENE PLUME, OVERBURDEN
MAYWOOD SUPERFUND SITE, NEW JERSEY





NOTES:

1. BENZENE CONCENTRATIONS ARE DISPLAYED IN UNITS OF MICROGRAMS PER LITER (UG/L).
2. THE REGULATORY LIMIT FOR BENZENE IS 1 UG/L.
3. YEAR ZERO BENZENE CONCENTRATIONS ARE BASED ON GROUNDWATER MONITORING RESULTS OBTAINED BETWEEN 2000 AND 2002.

SCALE
1 INCH = 150 FEET

FIGURE 5-4A
ALTERNATIVES 1 AND 2 - MODEL YEAR 0
BENZENE PLUME, SHALLOW BEDROCK
MAYWOOD SUPERFUND SITE, NEW JERSEY



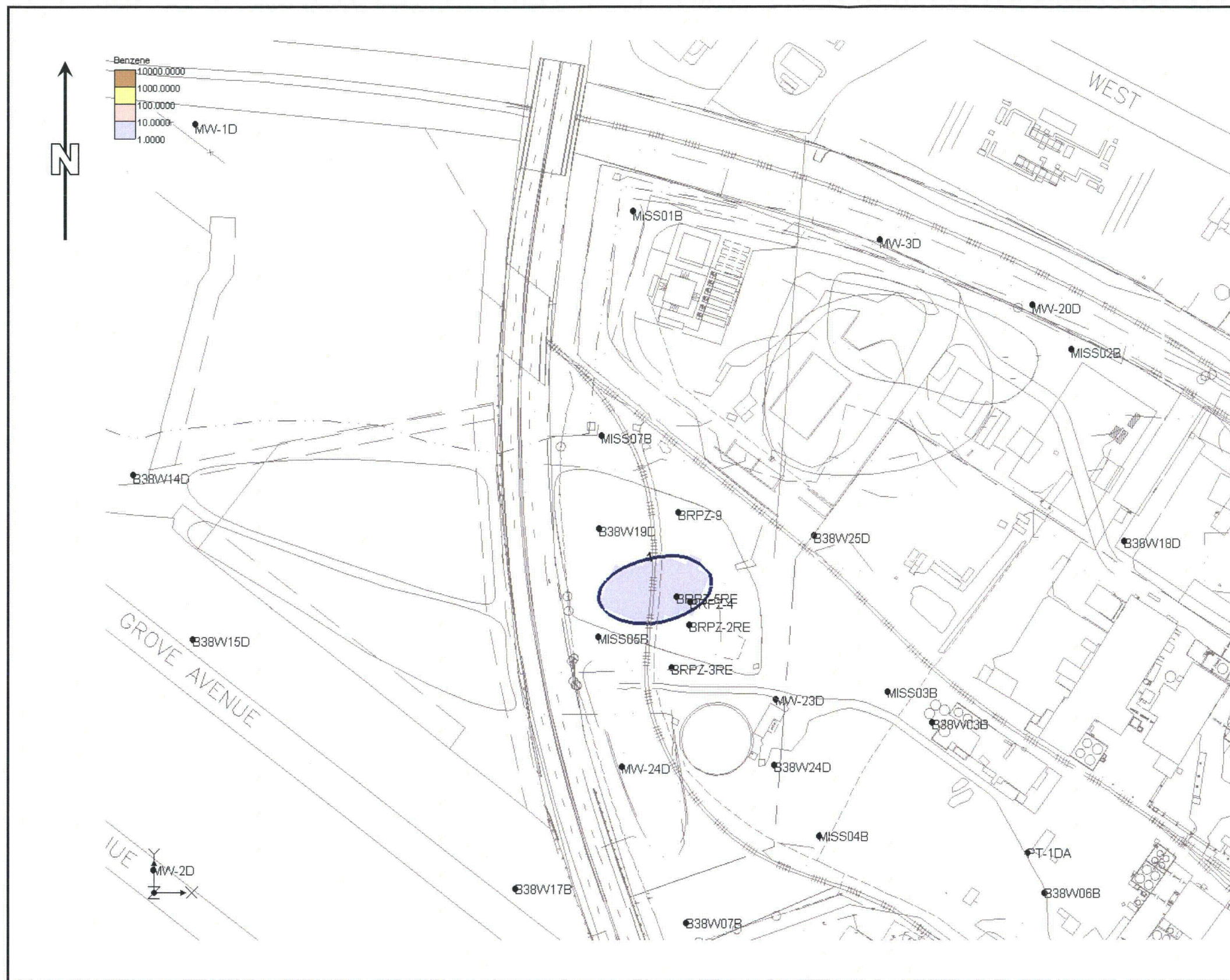

NOTES:

1. BENZENE CONCENTRATIONS ARE DISPLAYED IN UNITS OF MICROGRAMS PER LITER (UG/L).
2. THE REGULATORY LIMIT FOR BENZENE IS 1 UG/L.

SCALE
1 INCH = 150 FEET

FIGURE 5-4B
ALTERNATIVES 1 AND 2 – MODEL YEAR 9
BENZENE PLUME, SHALLOW BEDROCK
MAYWOOD SUPERFUND SITE, NEW JERSEY



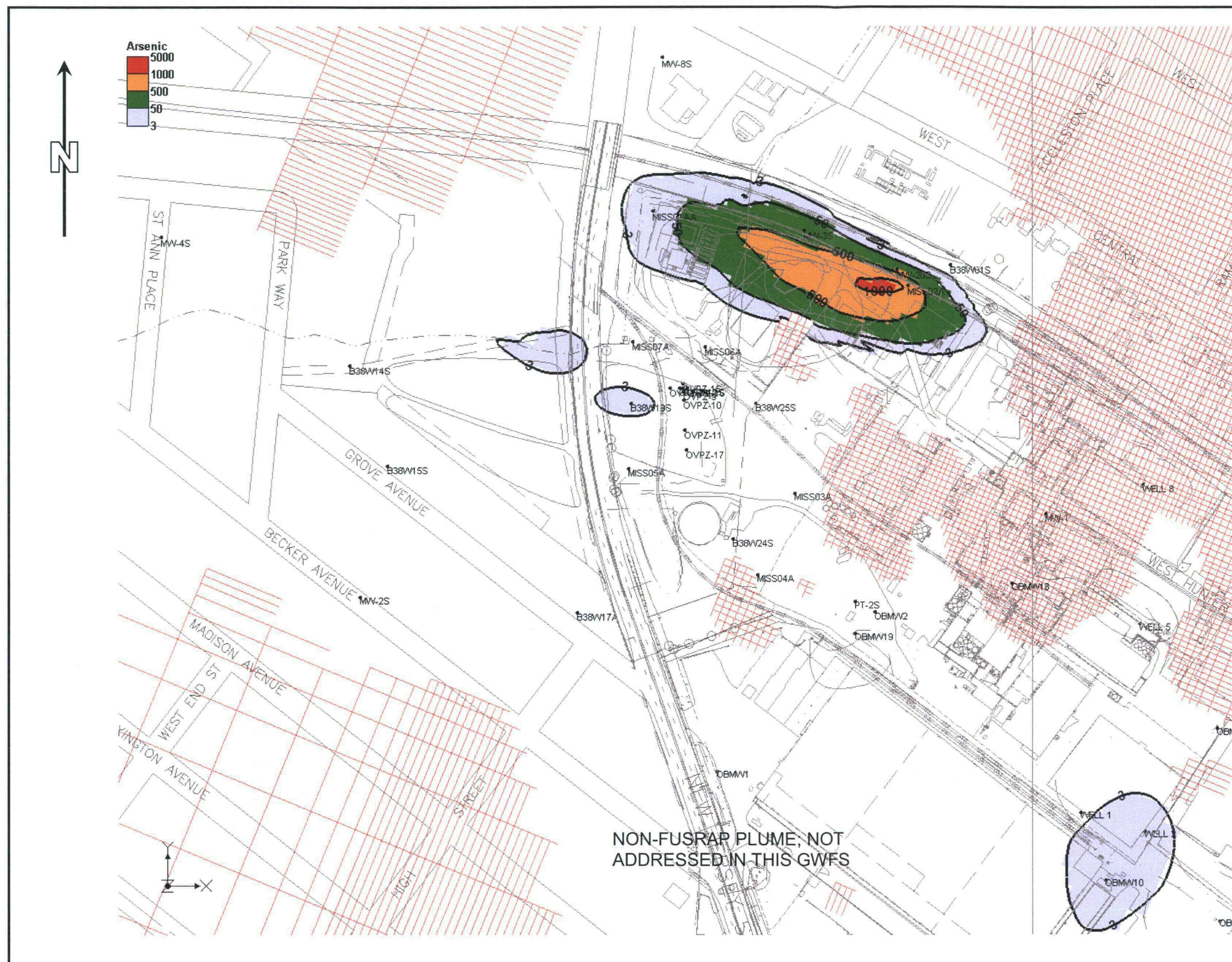

NOTES:

1. THE OVERBURDEN AQUIFER IS NOT PRESENT IN AREAS WITH MODEL GRID.
2. ARSENIC CONCENTRATIONS ARE DISPLAYED IN UNITS OF MICROGRAMS PER LITER (UG/L).
3. THE REGULATORY LIMIT FOR ARSENIC IS 3 UG/L.

SCALE
1 INCH = 250 FEET

FIGURE 5-5B
ALTERNATIVES 1 AND 2 – MODEL YEAR 30
ARSENIC PLUME, OVERBURDEN
MAYWOOD SUPERFUND SITE, NEW JERSEY





NOTES:

1. THE OVERBURDEN AQUIFER IS NOT PRESENT IN AREAS WITH MODEL GRID.
2. ARSENIC CONCENTRATIONS ARE DISPLAYED IN UNITS OF MICROGRAMS PER LITER (UG/L).
3. THE REGULATORY LIMIT FOR ARSENIC IS 3 UG/L.
4. YEAR ZERO ARSENIC CONCENTRATIONS ARE BASED ON GROUNDWATER MONITORING RESULTS OBTAINED BETWEEN 2000 AND 2002.

SCALE
1 INCH = 250 FEET

FIGURE 5-6A
ALTERNATIVES 1 AND 2 – MODEL YEAR 0
ARSENIC PLUME, SHALLOW BEDROCK
MAYWOOD SUPERFUND SITE, NEW JERSEY





NOTES:

1. ARSENIC CONCENTRATIONS ARE DISPLAYED IN UNITS OF MICROGRAMS PER LITER (UG/L).
2. THE REGULATORY LIMIT FOR ARSENIC IS 3 UG/L.

SCALE
1 INCH = 250 FEET

FIGURE 5-6B
ALTERNATIVES 1 AND 2 – MODEL YEAR 30
ARSENIC PLUME, SHALLOW BEDROCK
MAYWOOD SUPERFUND SITE, NEW JERSEY



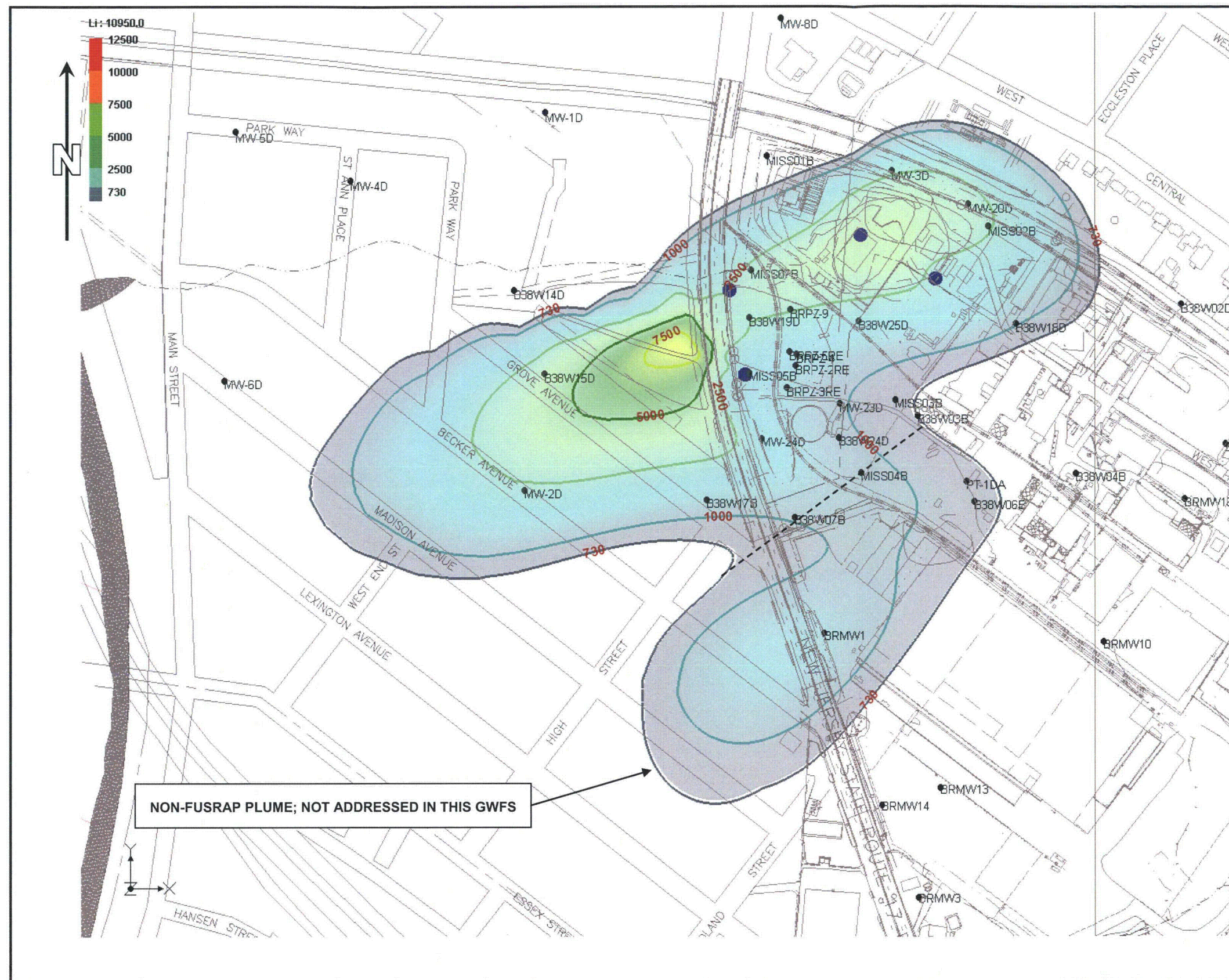

NOTES:

1. LITHIUM CONCENTRATIONS ARE DISPLAYED IN UNITS OF MICROGRAMS PER LITER (UG/L).
2. THE RISK-BASED ACTION LEVEL FOR LITHIUM IS 730 UG/L.

LEGEND:

- EXTRACTION WELL

SCALE
1 INCH = 300 FEET

FIGURE 5-8

ALTERNATIVE 4 – MODELED LITHIUM
SHALLOW BEDROCK PLUME AFTER 30
YEARS OF GROUNDWATER EXTRACTION
MAYWOOD SUPERFUND SITE, NEW JERSEY



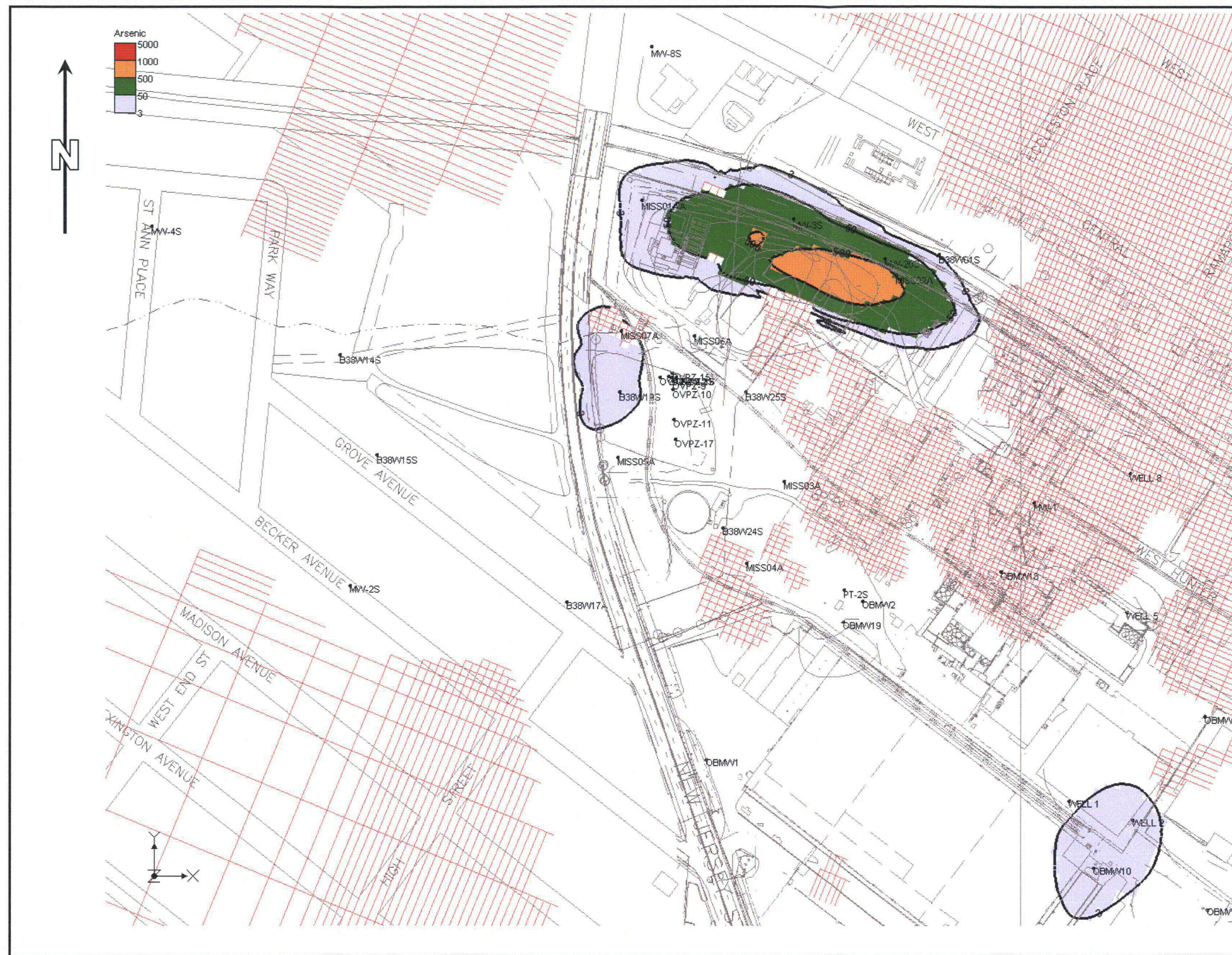

NOTES:

1. THE OVERBURDEN AQUIFER IS NOT PRESENT AREAS WITH MODEL GRID.
2. ARSENIC CONCENTRATIONS ARE DISPLAYED IN UNITS OF MICROGRAMS PER LITER (UG/L).
3. THE REGULATORY LIMIT FOR ARSENIC IS 3 UG/L.

SCALE
1 INCH = 250 FEET

FIGURE 5-9
ALTERNATIVE 4 – MODELED ARSENIC
OVERBURDEN PLUME AFTER 30 YEARS OF
GROUNDWATER EXTRACTION
MAYWOOD SUPERFUND SITE, NEW JERSEY



