

# SEGMENT D

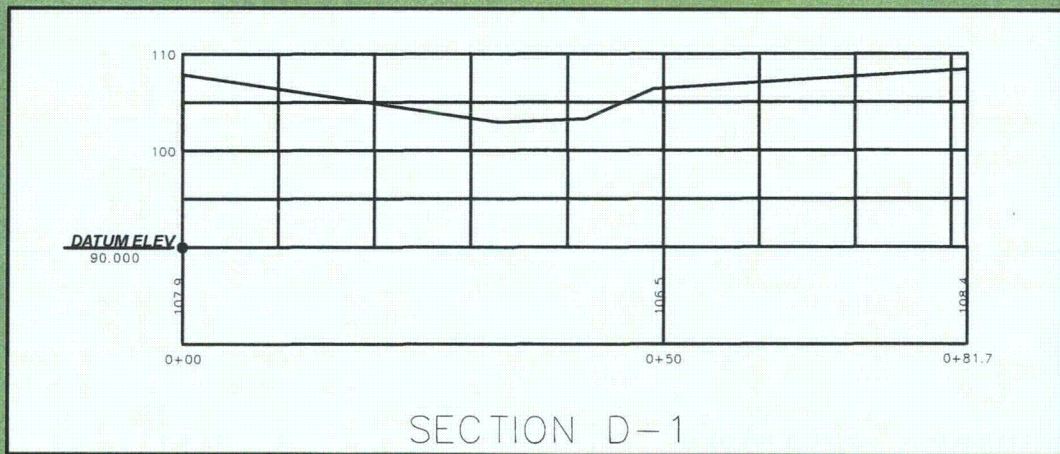

SECTION D-1

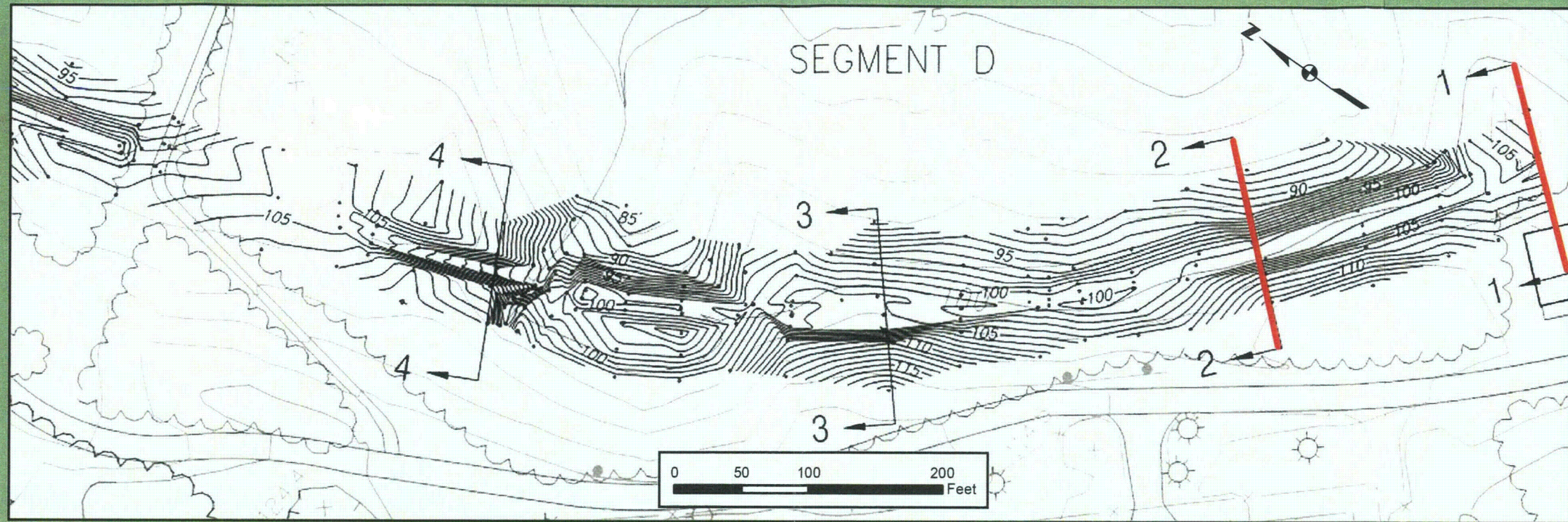
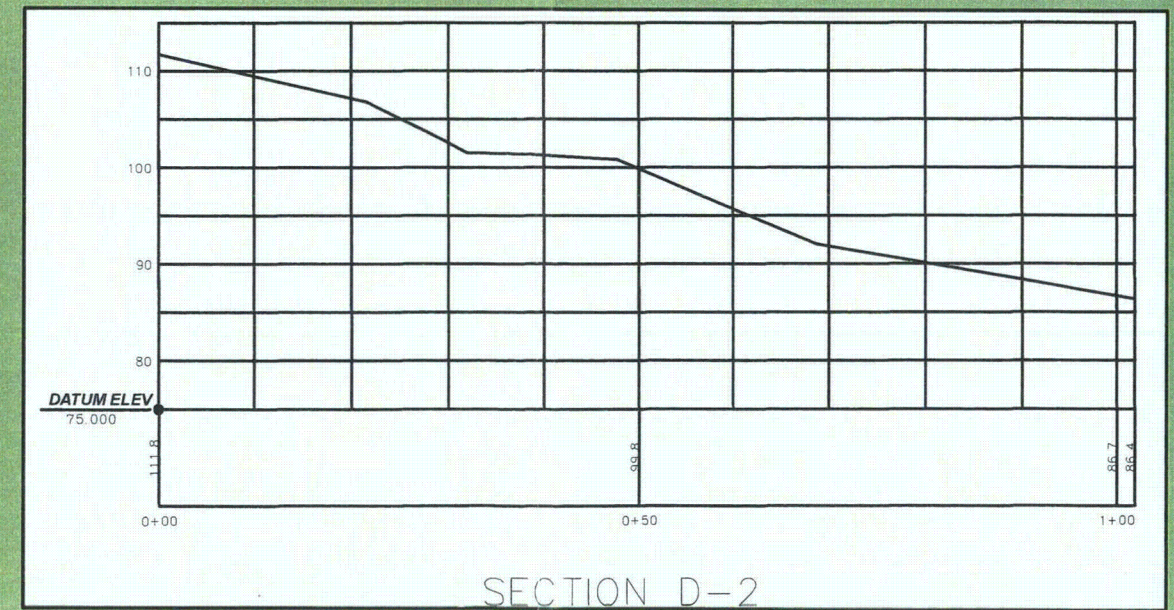

SECTION D-2

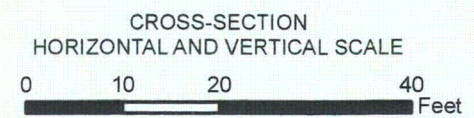

## APPENDIX B-4a SEGMENT A PLAN VIEW AND CROSS-SECTIONS SECTIONS D-1 AND D-2

**gai** CONSULTANTS  
CALVERT CLIFFS 3 NUCLEAR PROJECT (CC3)  
BALTIMORE AND DRUM POINT RAILROAD (BDPRR)  
DOCUMENTATION

BY: DJP DATE: 12/16/2009

CHECKED: HLC APPROVED: JNT



# SEGMENT D

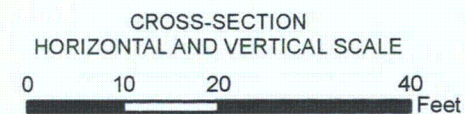
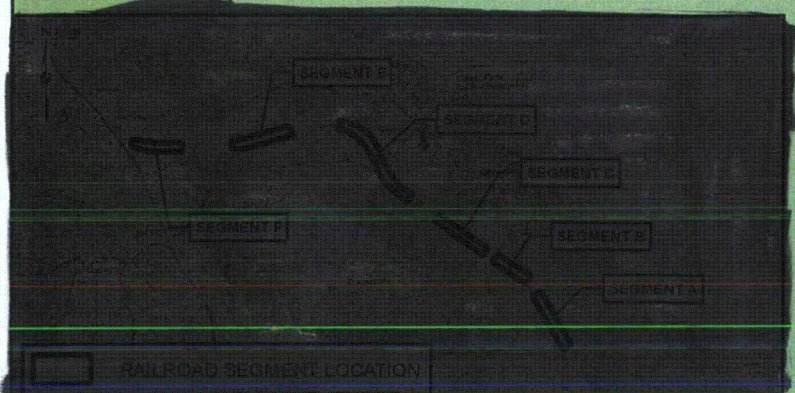
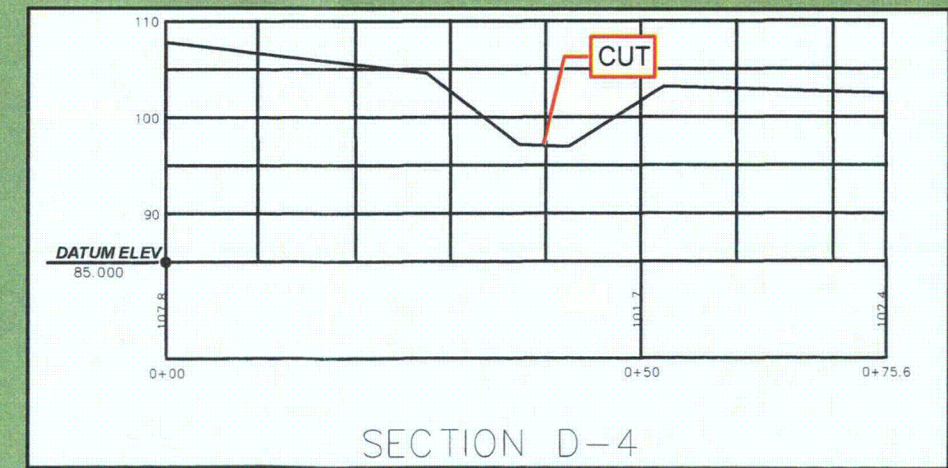
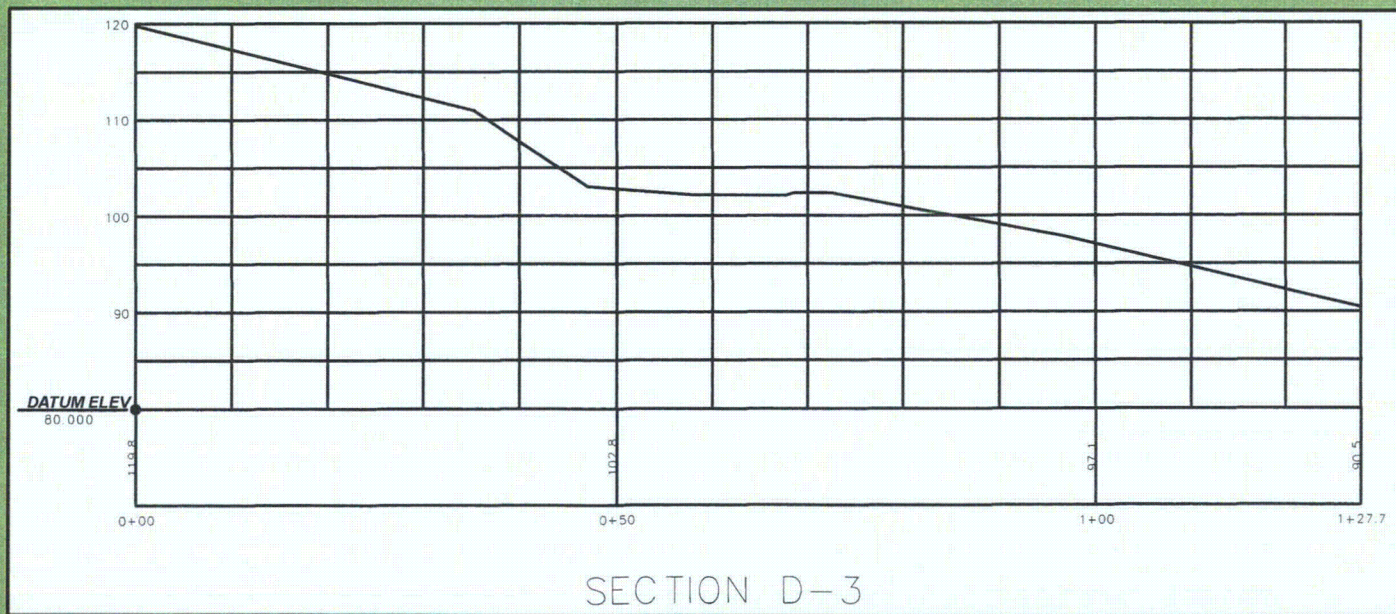
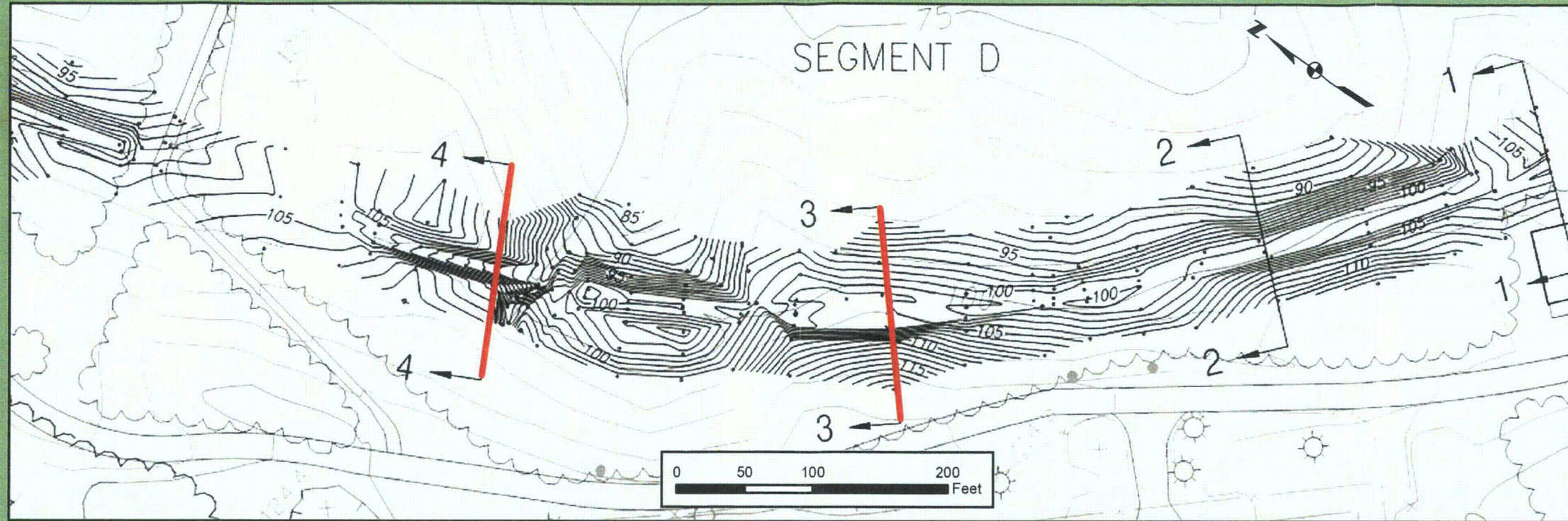

## APPENDIX B-4b SEGMENT A PLAN VIEW AND CROSS-SECTIONS SECTIONS D-3 AND D-4

**CALVERT CLIFFS 3 NUCLEAR PROJECT (CC3)  
BALTIMORE AND DRUM POINT RAILROAD (BDPRR)  
DOCUMENTATION**

BY: DJP DATE: 12/16/2009

CHECKED: HLC APPROVED: JNT



# SEGMENT D

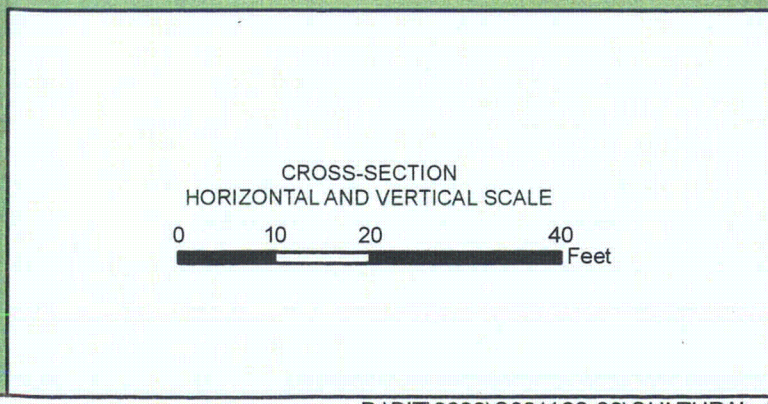
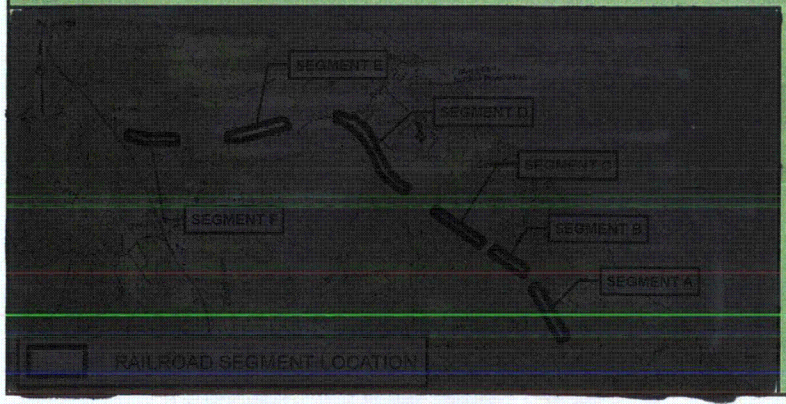
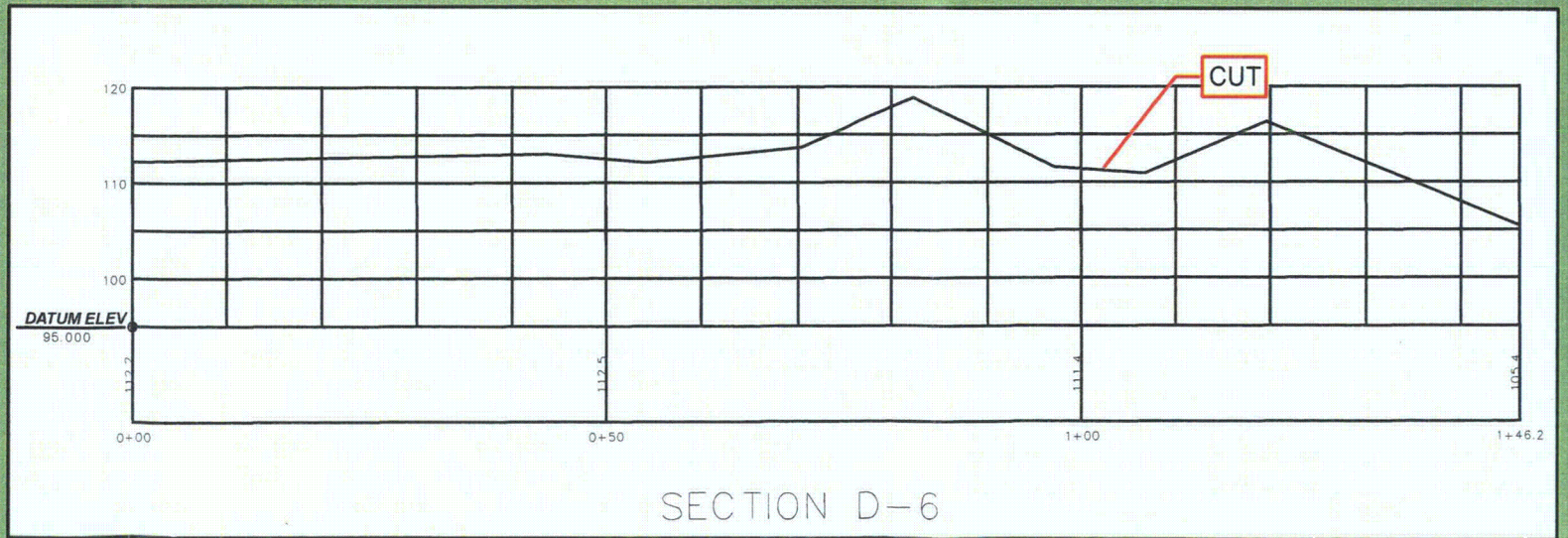
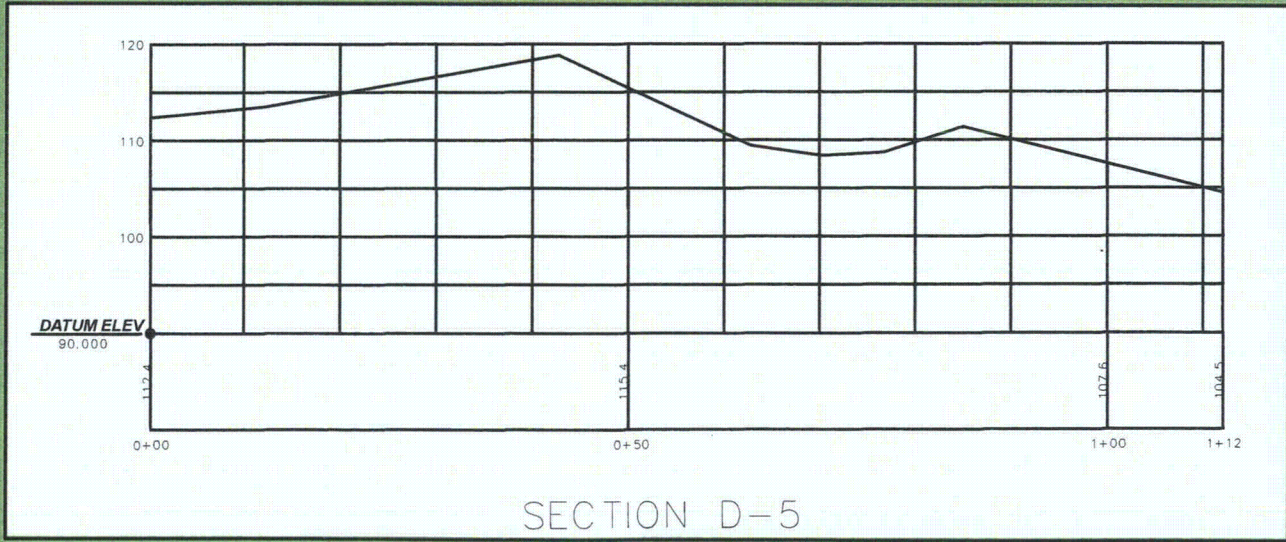
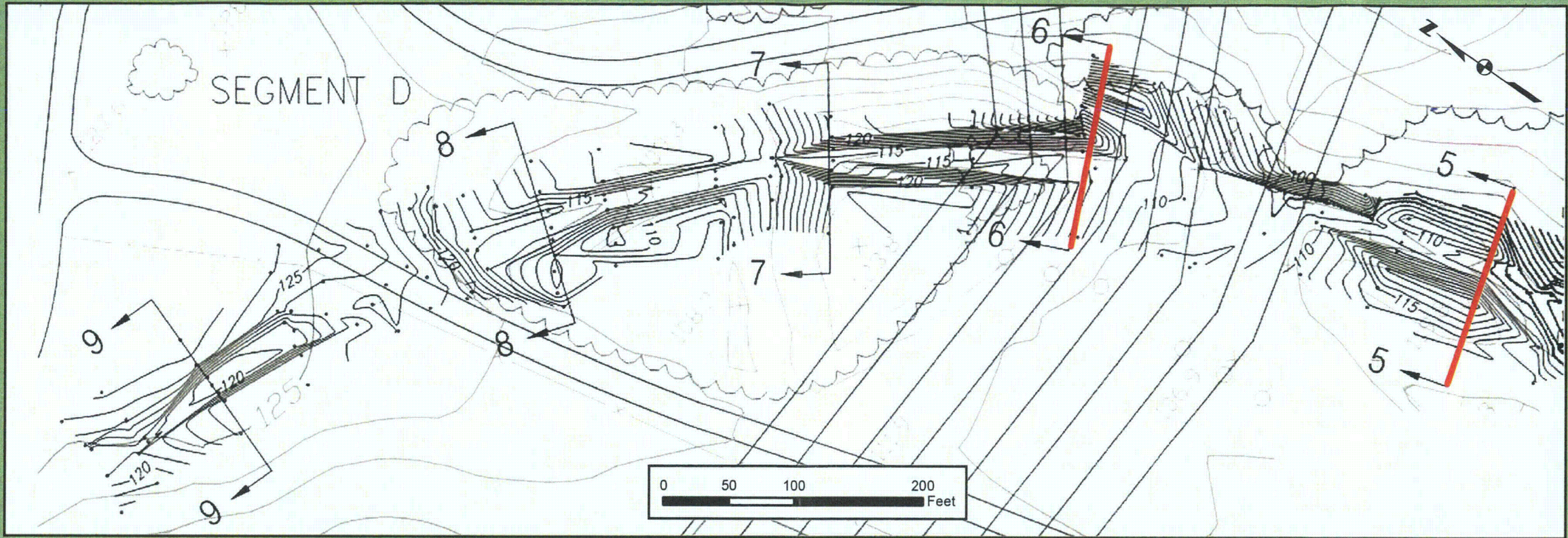

APPENDIX B-4c  
 SEGMENT A PLAN VIEW AND CROSS-SECTIONS  
 SECTIONS D-5 AND D-6

**gai consultants**  
 CALVERT CLIFFS 3 NUCLEAR PROJECT (CC3)  
 BALTIMORE AND DRUM POINT RAILROAD (BDPRR)  
 DOCUMENTATION

BY: DJP                      DATE: 12/16/2009  
 CHECKED: HLC              APPROVED: JNT



# SEGMENT D

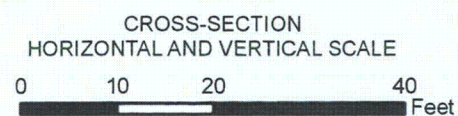
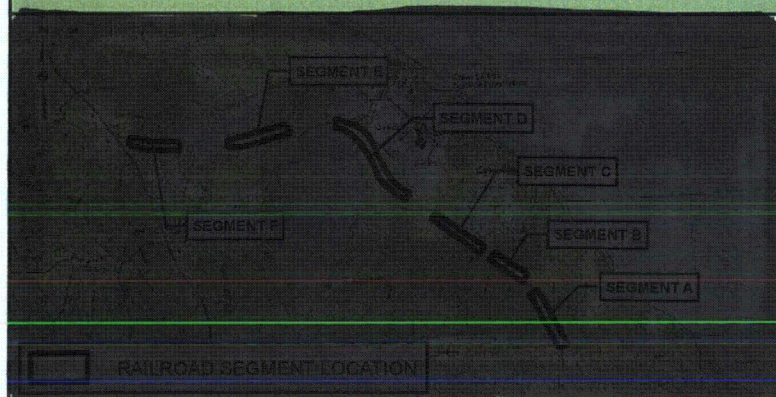
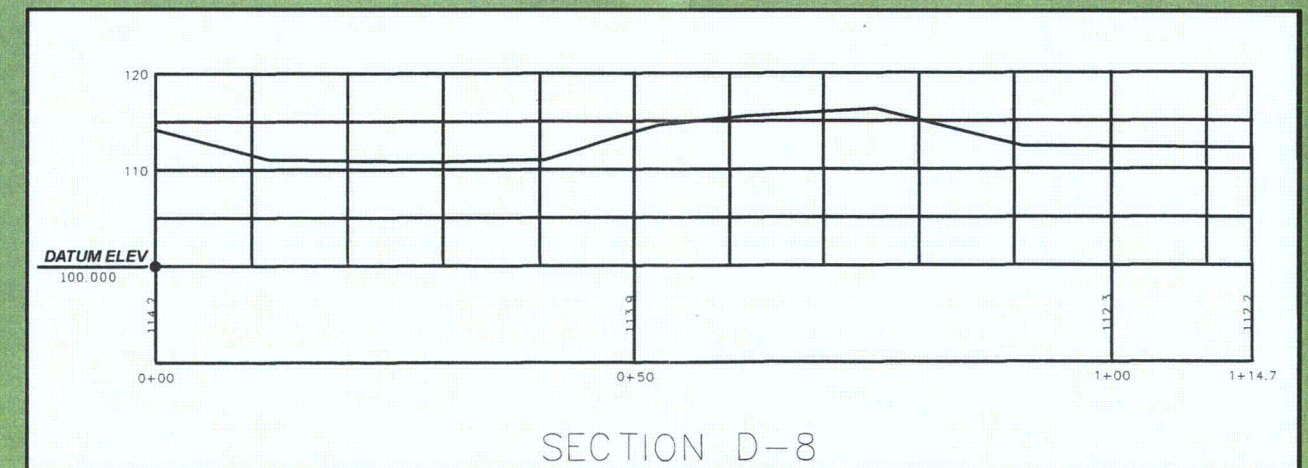
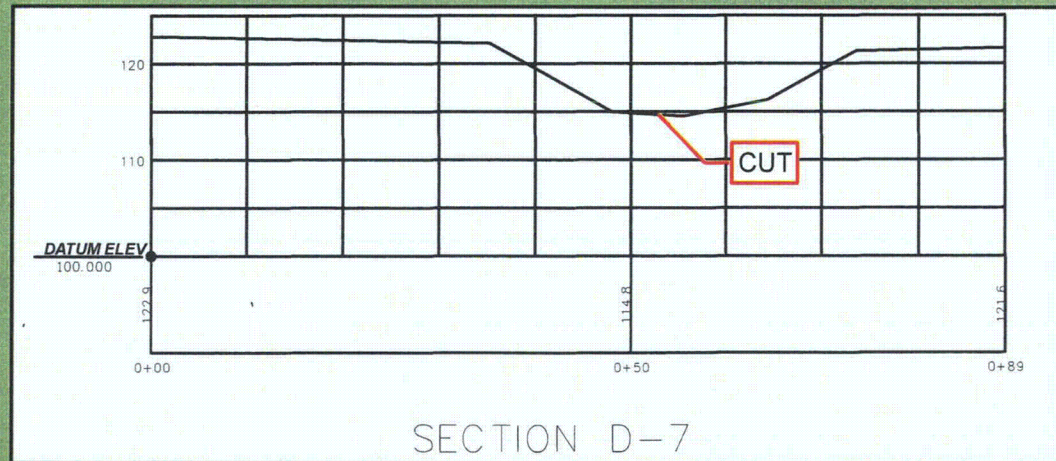
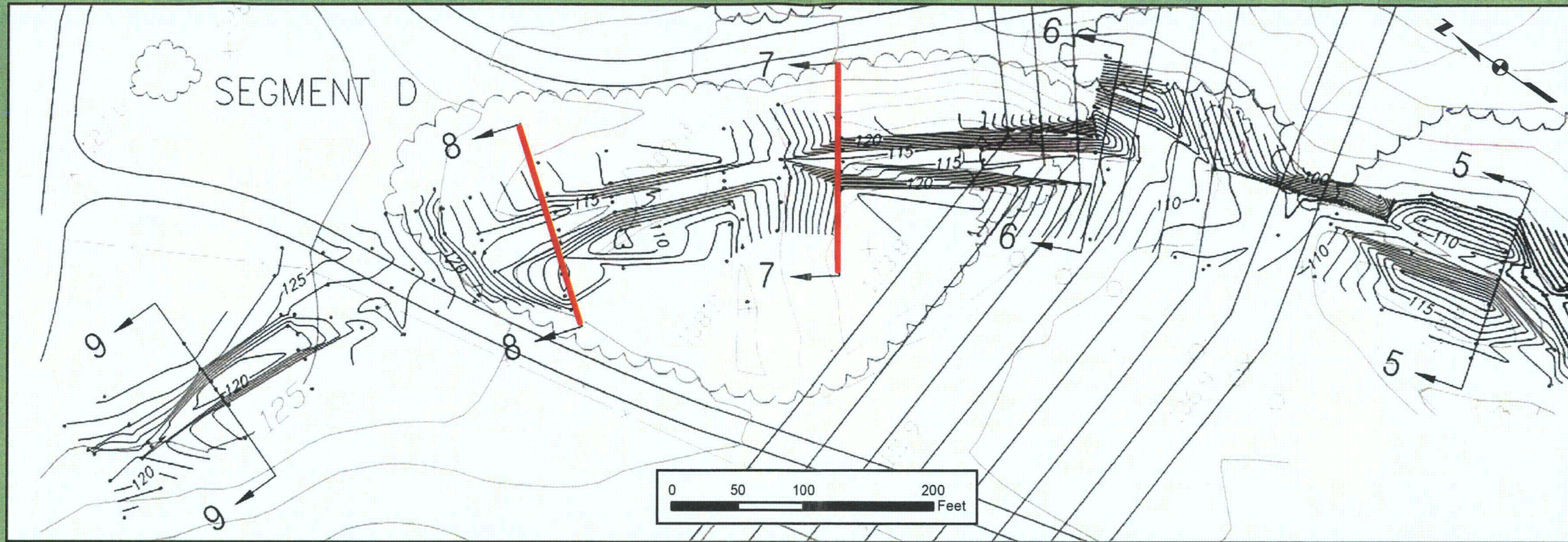

## APPENDIX B-4d SEGMENT A PLAN VIEW AND CROSS-SECTIONS SECTIONS D-7 AND D-8

 CALVERT CLIFFS 3 NUCLEAR PROJECT (CC3)  
BALTIMORE AND DRUM POINT RAILROAD (BDPRR)  
DOCUMENTATION

BY: DJP DATE: 12/16/2009

CHECKED: HLC APPROVED: JNT



# SEGMENT D

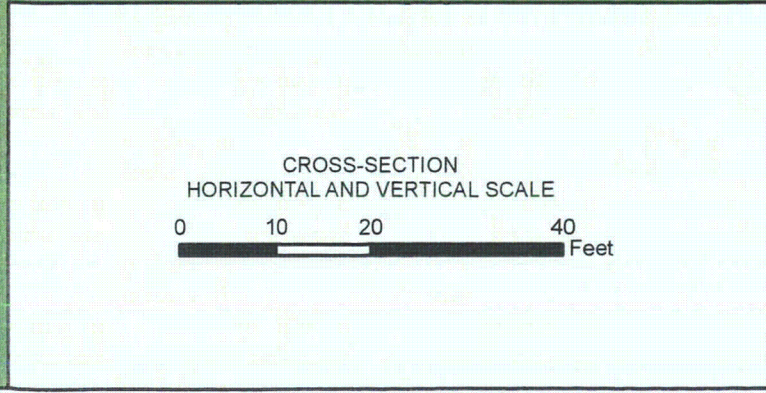
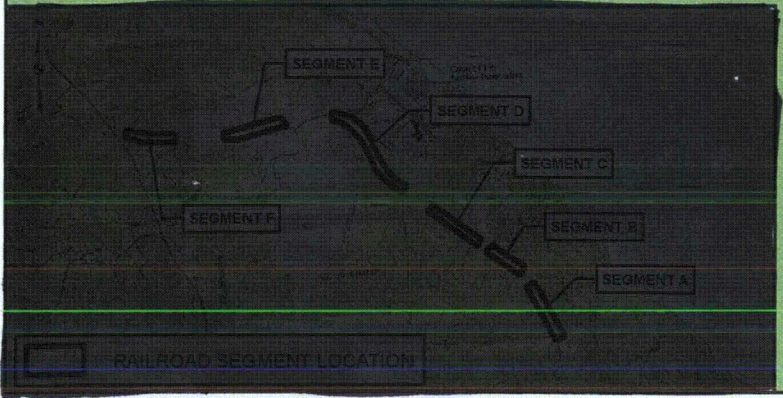
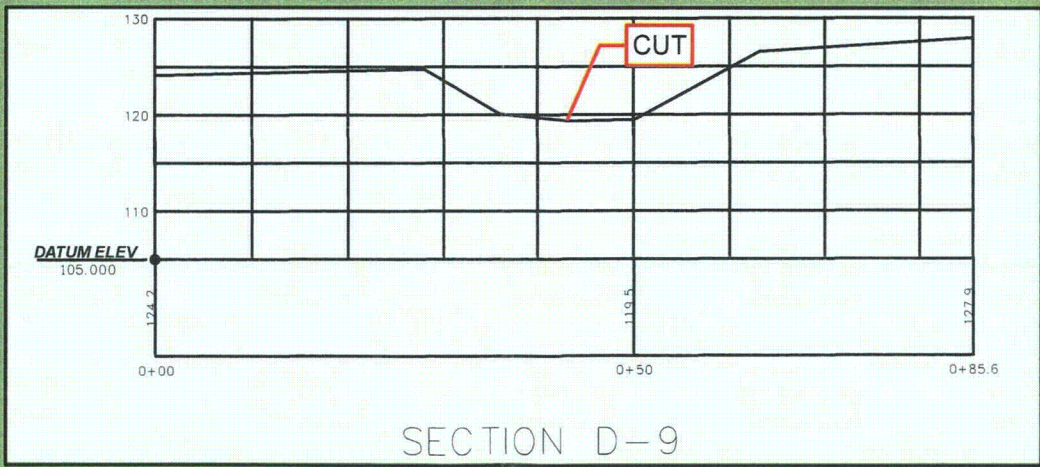
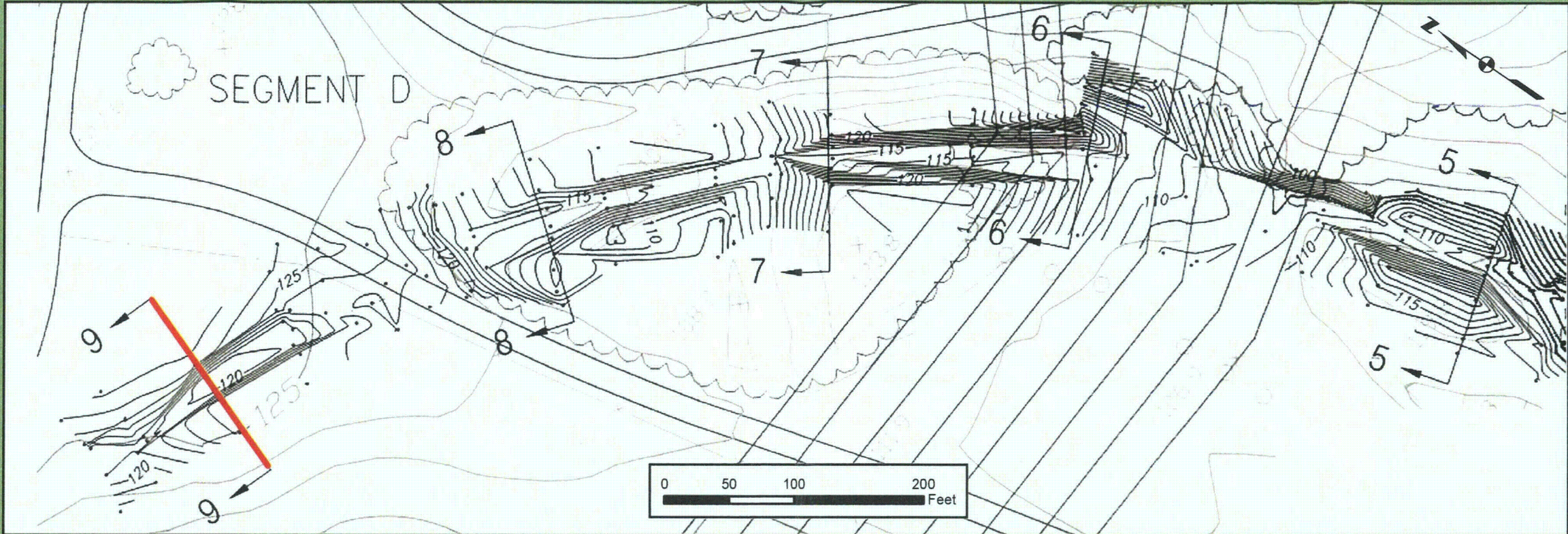

APPENDIX B-4e  
SEGMENT A PLAN VIEW AND CROSS-SECTIONS  
SECTION D-9

 CALVERT CLIFFS 3 NUCLEAR PROJECT (CC3)  
BALTIMORE AND DRUM POINT RAILROAD (BDPRR)  
DOCUMENTATION

BY: DJP DATE: 12/16/2009  
CHECKED: HLC APPROVED: JNT



# SEGMENT E

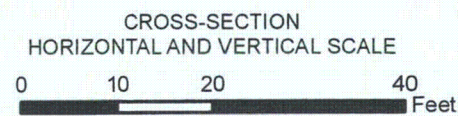
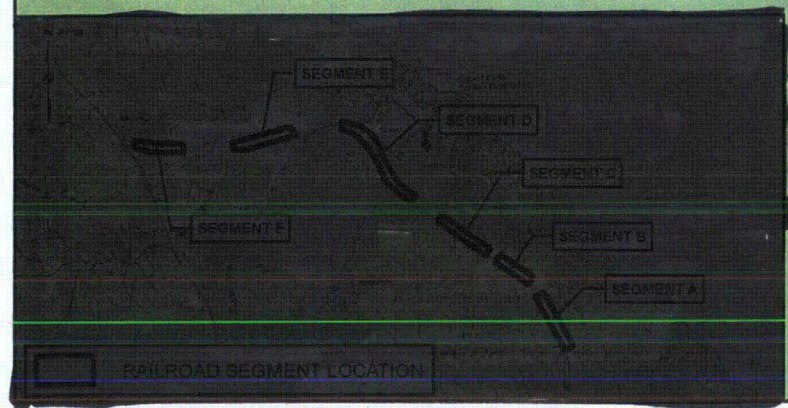
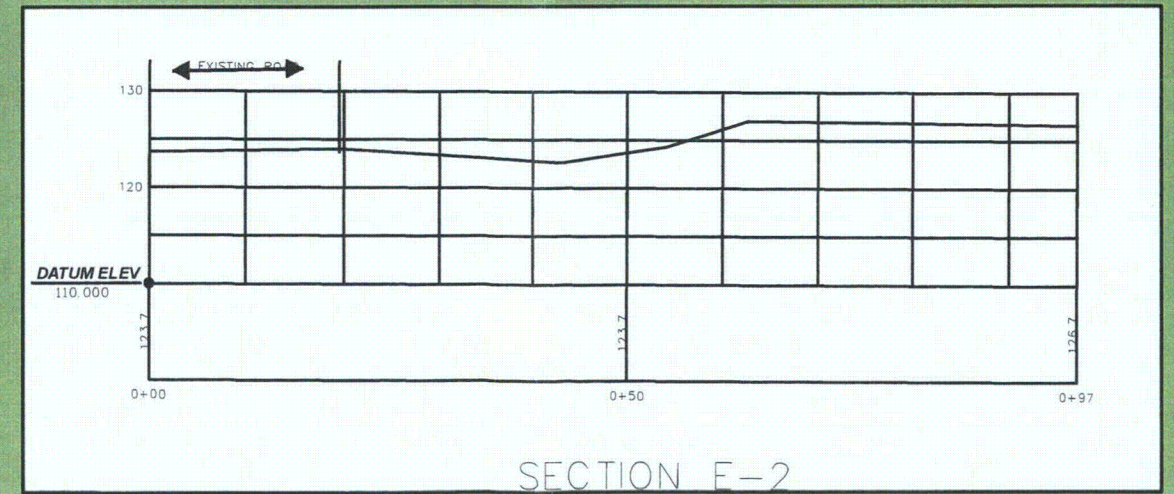
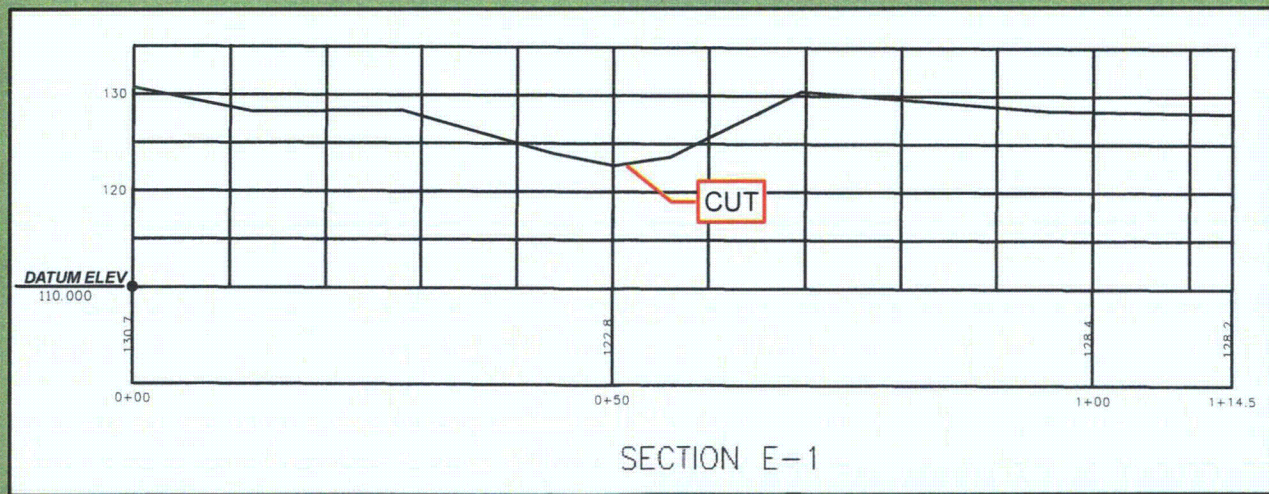
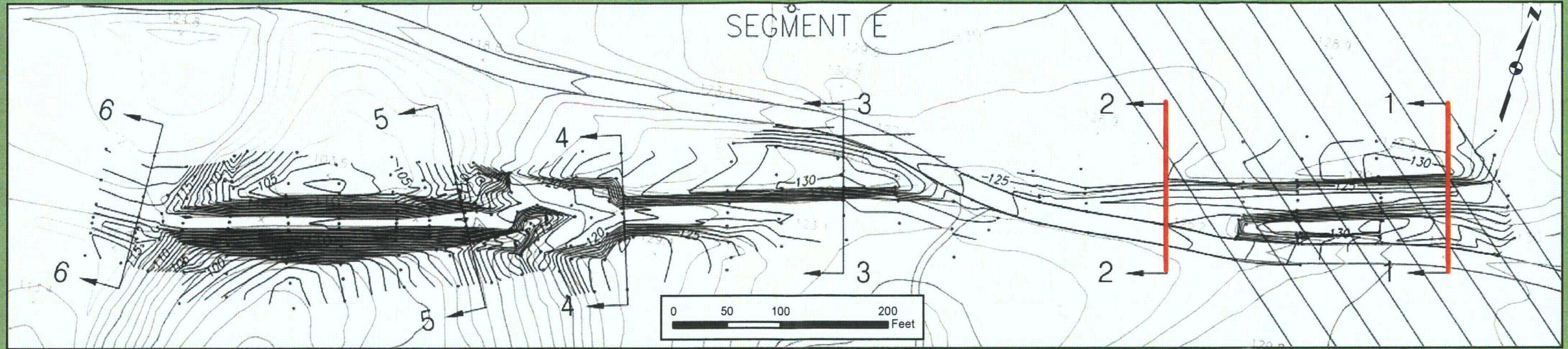

## APPENDIX B-5a SEGMENT A PLAN VIEW AND CROSS-SECTIONS SECTIONS E-1 AND E-2

 CALVERT CLIFFS 3 NUCLEAR PROJECT (CC3)  
BALTIMORE AND DRUM POINT RAILROAD (BDPRR)  
DOCUMENTATION

BY: DJP DATE: 12/16/2009

CHECKED: HLC APPROVED: JNT



# SEGMENT E

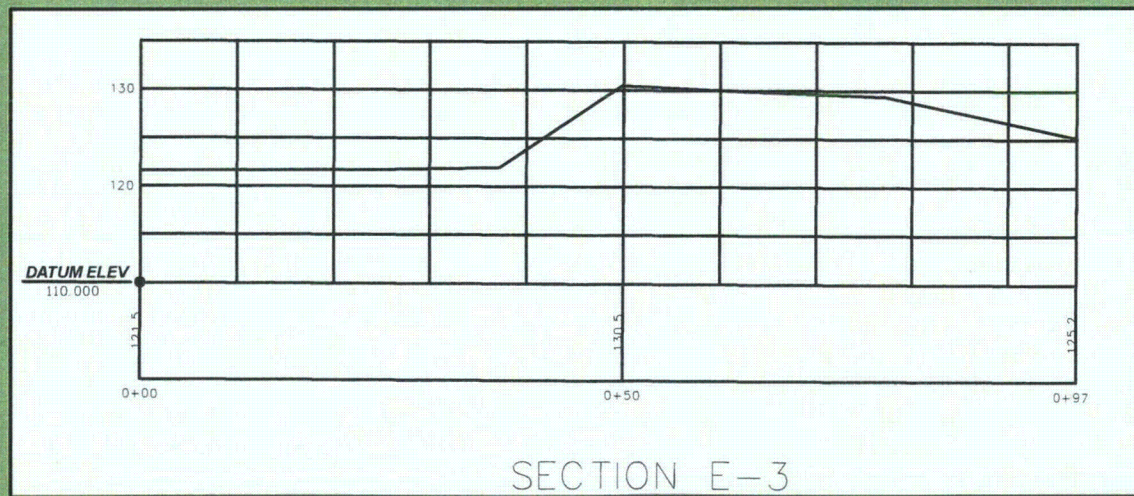
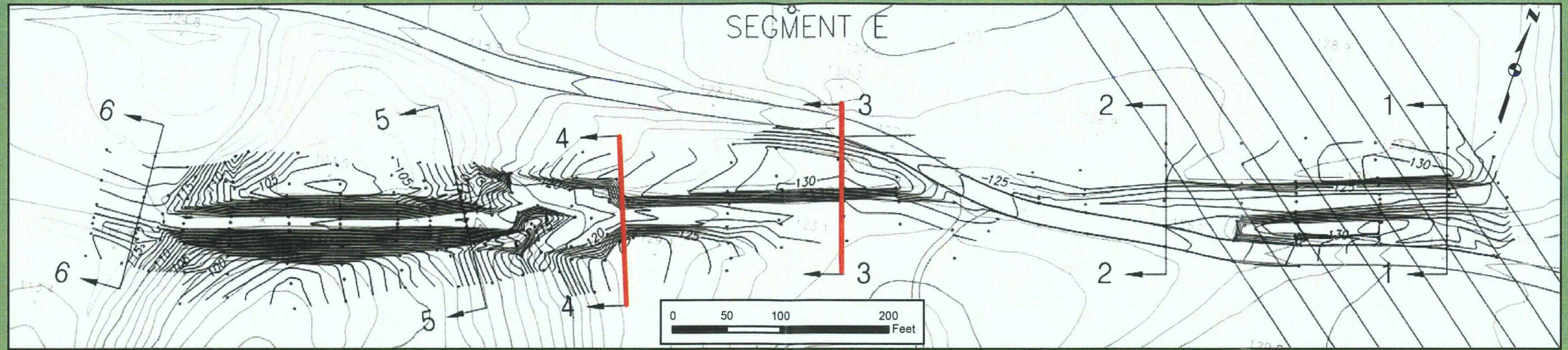

SECTION E-3

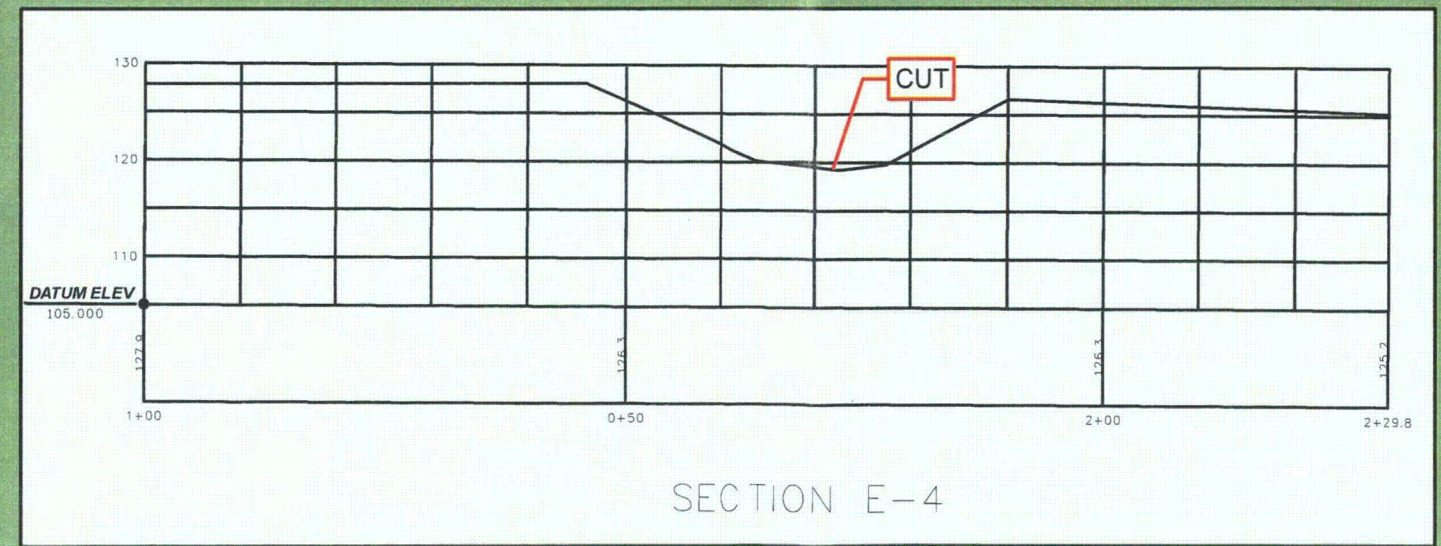

SECTION E-4

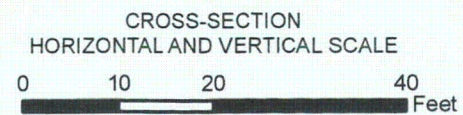
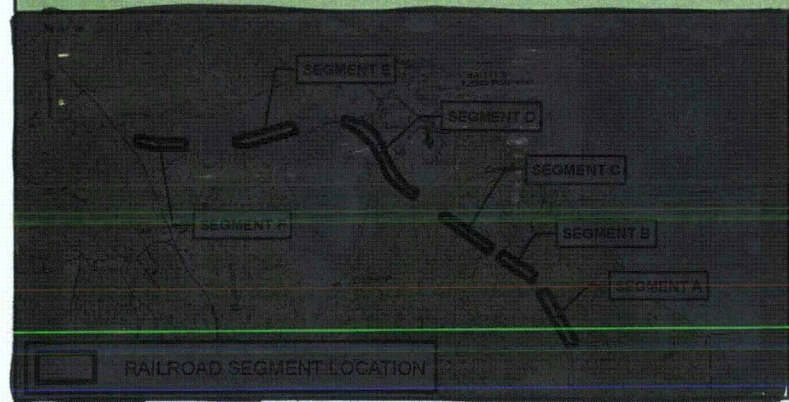

## APPENDIX B-5b SEGMENT A PLAN VIEW AND CROSS-SECTIONS SECTIONS E-3 and E-4

**gai consultants** CALVERT CLIFFS 3 NUCLEAR PROJECT (CC3)  
BALTIMORE AND DRUM POINT RAILROAD (BDPRR)  
DOCUMENTATION

BY: DJP DATE: 12/16/2009

CHECKED: HLC APPROVED: JNT



# SEGMENT E

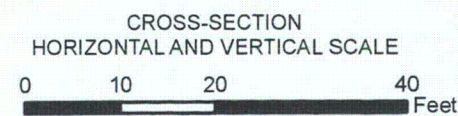
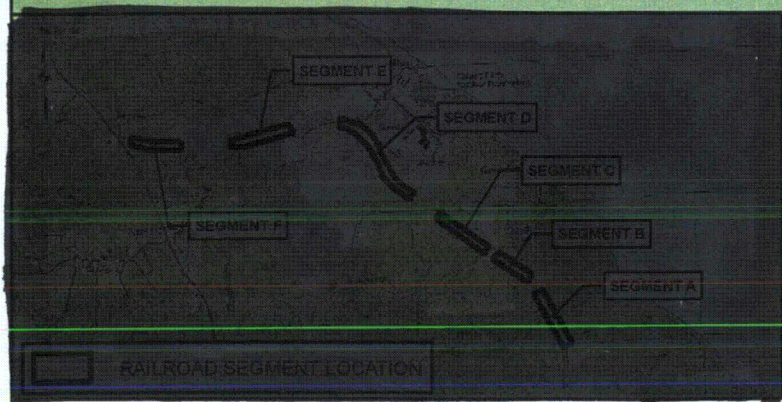
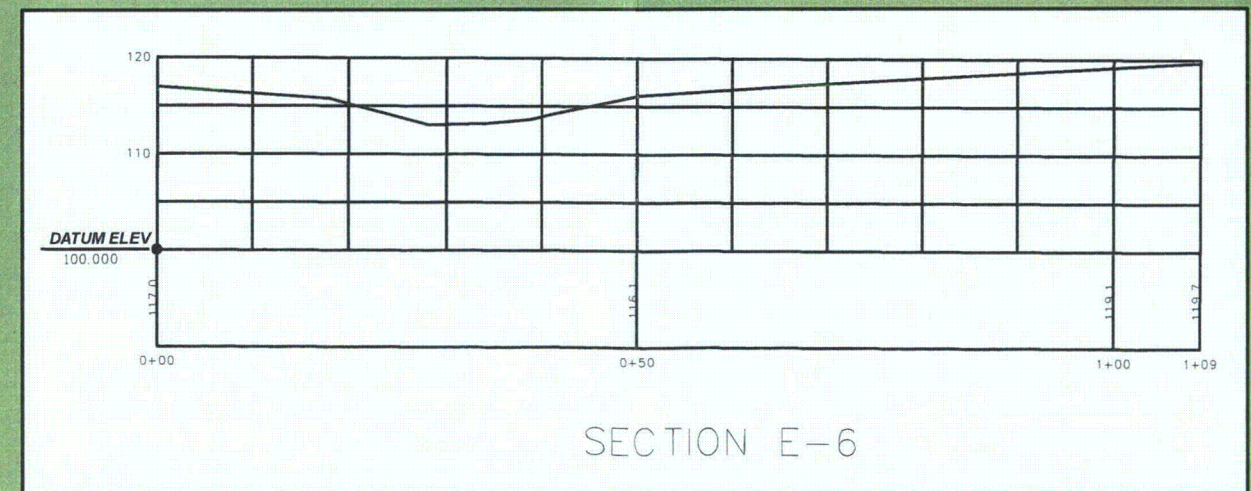
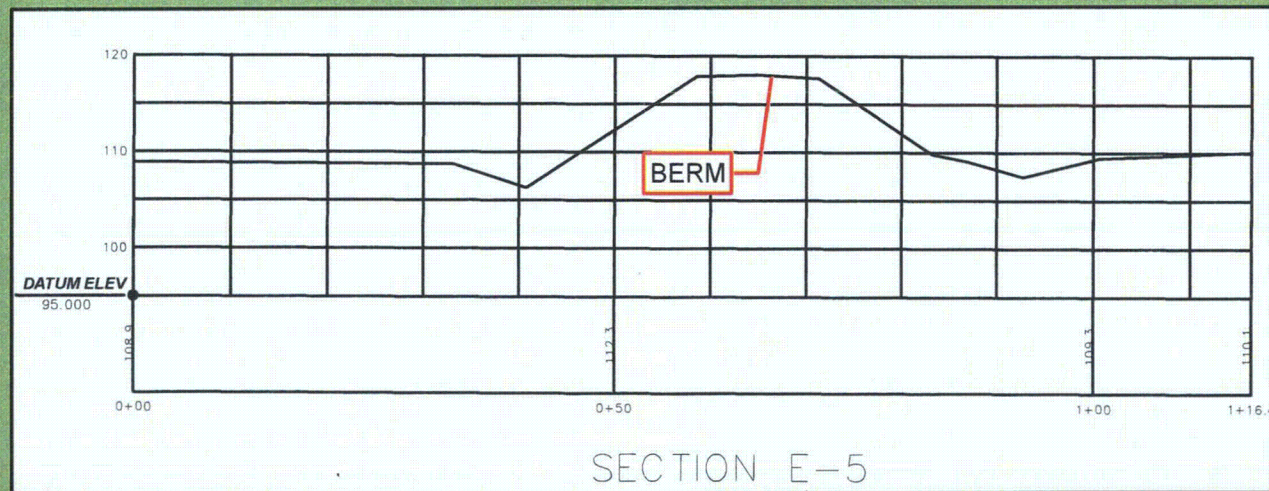
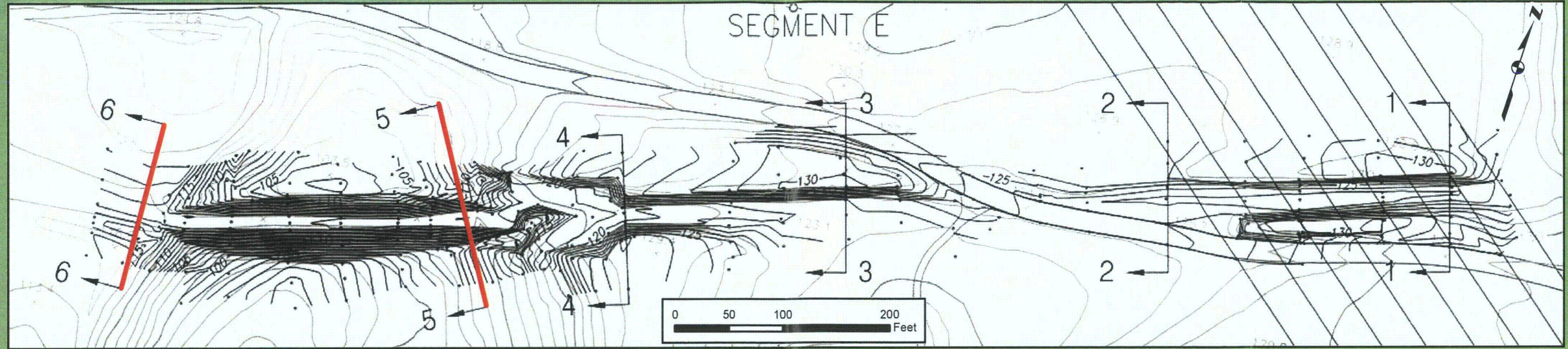

## APPENDIX B-5c SEGMENT A PLAN VIEW AND CROSS-SECTIONS SECTIONS E-5 AND E-6

 CALVERT CLIFFS 3 NUCLEAR PROJECT (CC3)  
BALTIMORE AND DRUM POINT RAILROAD (BDPRR)  
DOCUMENTATION

BY: DJP DATE: 12/16/2009

CHECKED: HLC APPROVED: JNT



# SEGMENT F

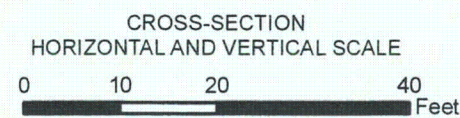
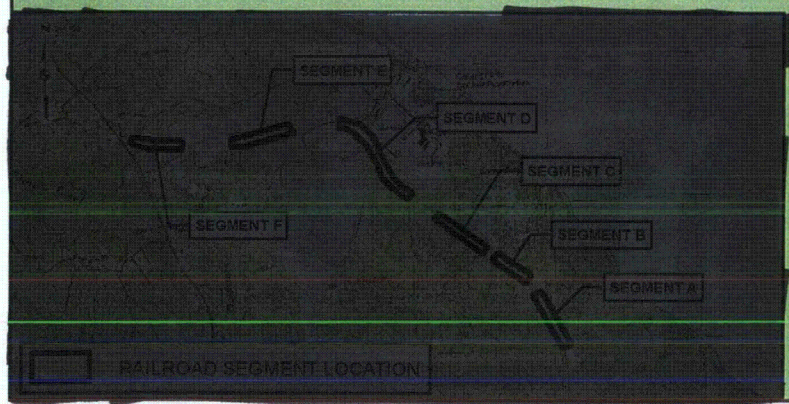
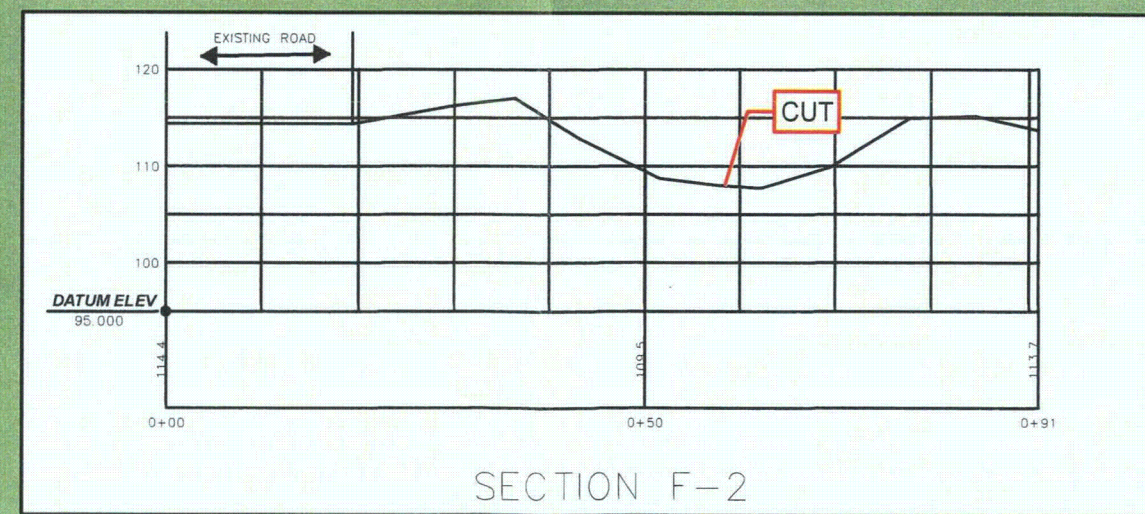
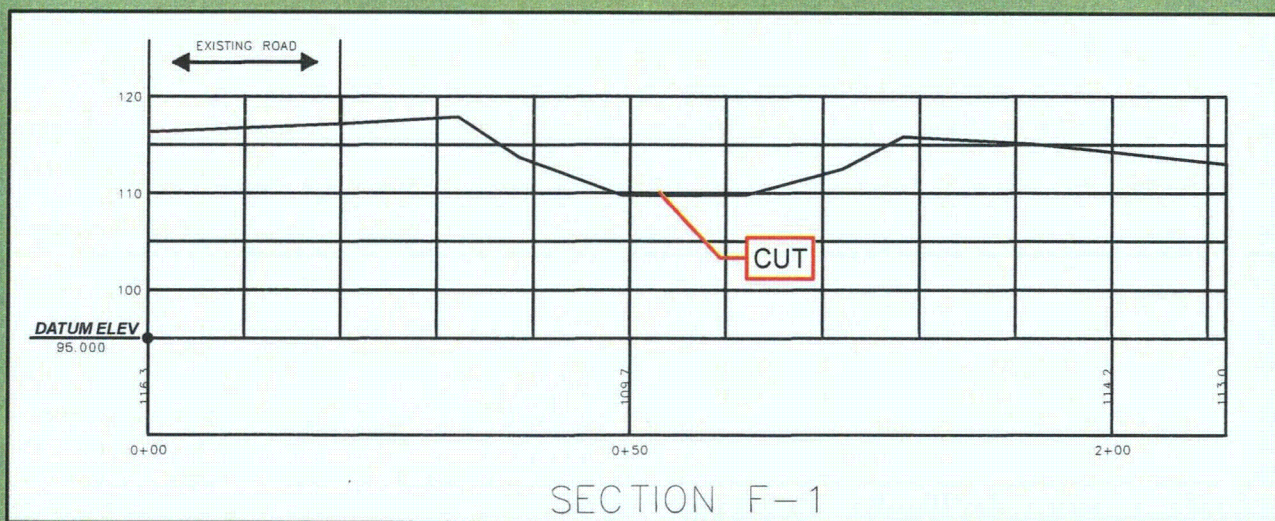
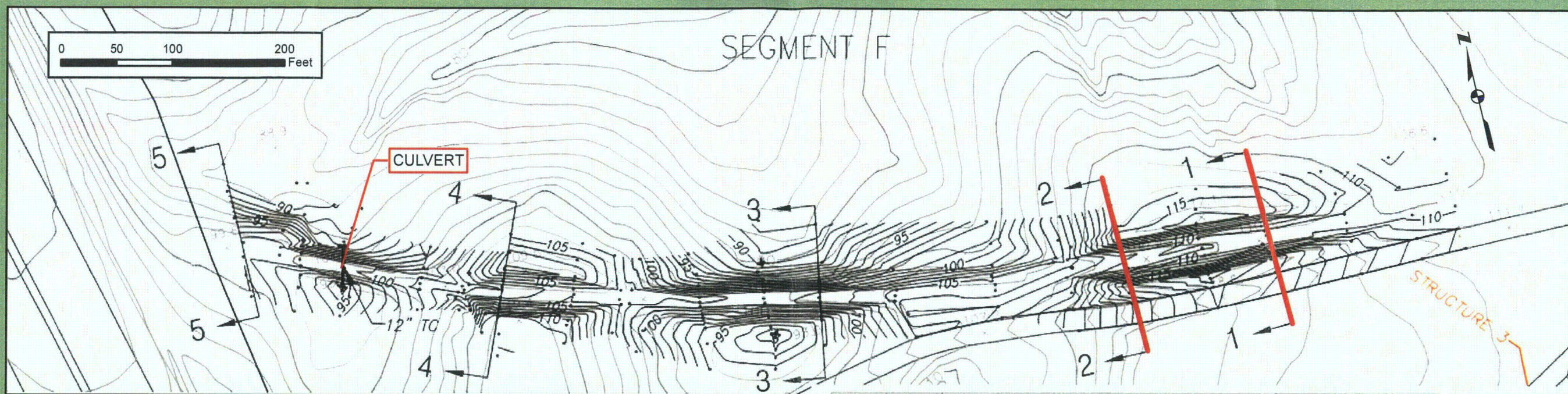

## APPENDIX B-6a SEGMENT A PLAN VIEW AND CROSS-SECTIONS SECTIONS F-1 AND F-2

 CALVERT CLIFFS 3 NUCLEAR PROJECT (CC3)  
BALTIMORE AND DRUM POINT RAILROAD (BDPRR)  
DOCUMENTATION

BY: DJP DATE: 12/16/2009

CHECKED: HLC APPROVED: JNT



# SEGMENT F

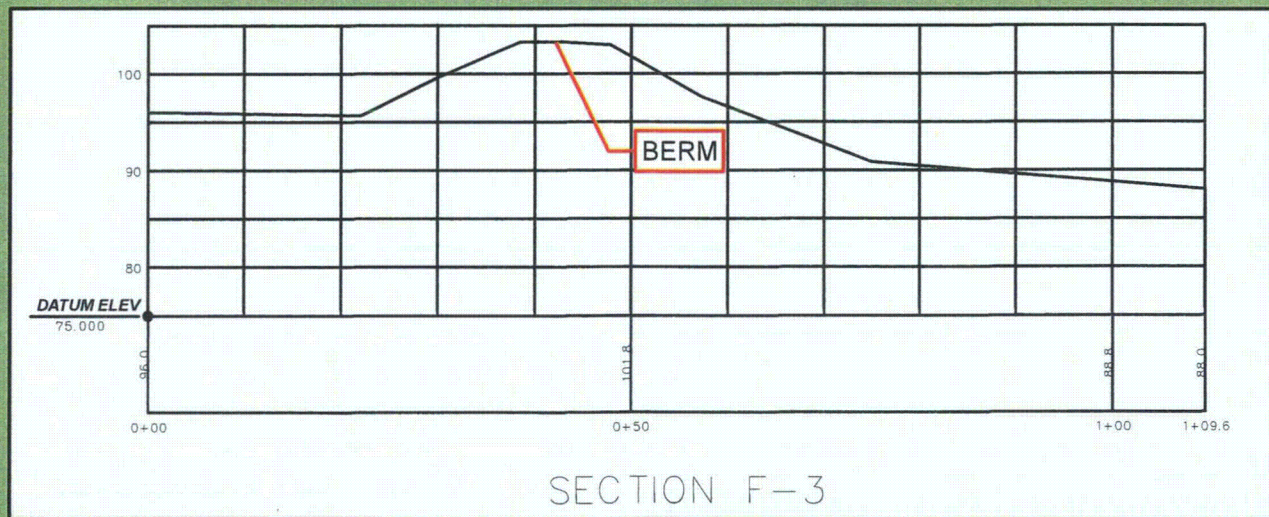
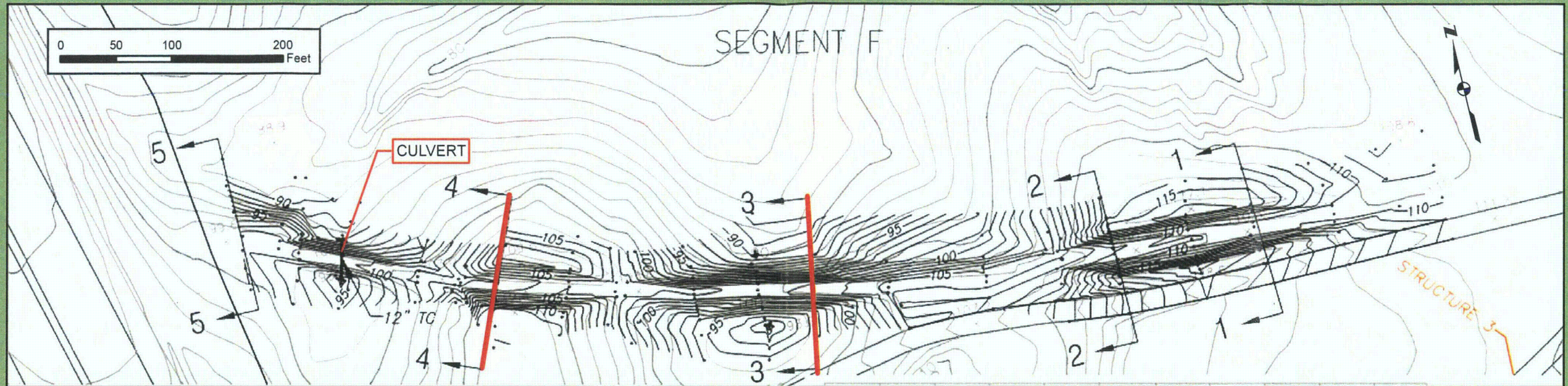

SECTION F-3

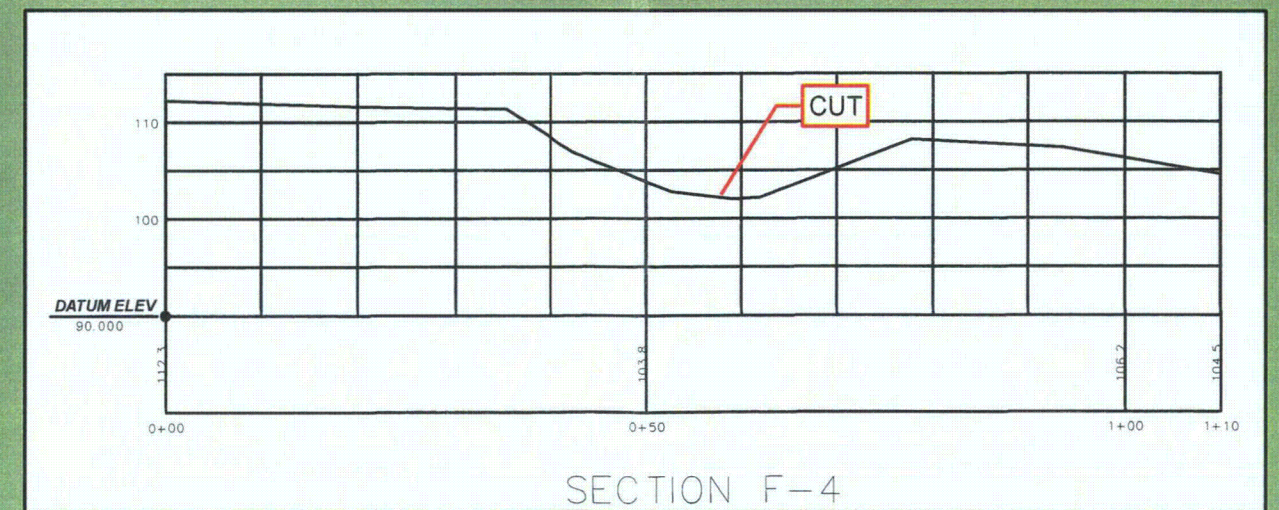

SECTION F-4

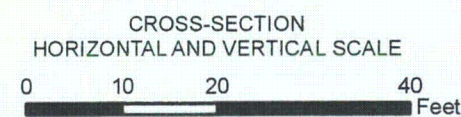
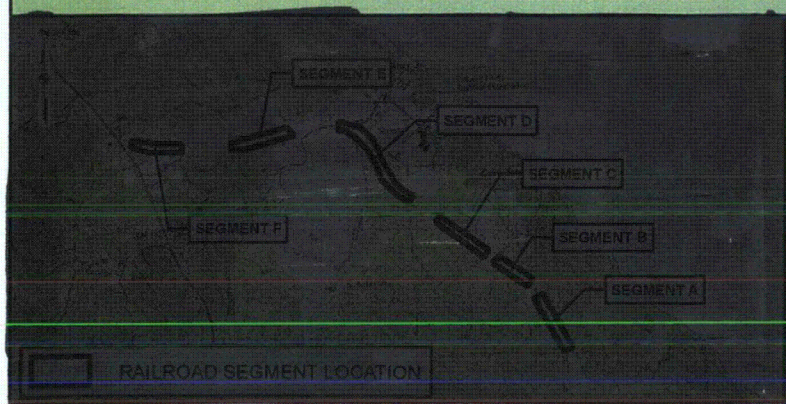

## APPENDIX B-6b SEGMENT A PLAN VIEW AND CROSS-SECTIONS SECTIONS F-3 AND F-4

 CALVERT CLIFFS 3 NUCLEAR PROJECT (CC3)  
BALTIMORE AND DRUM POINT RAILROAD (BDPRR)  
DOCUMENTATION

BY: DJP DATE: 12/16/2009

CHECKED: HLC APPROVED: JNT



# SEGMENT F

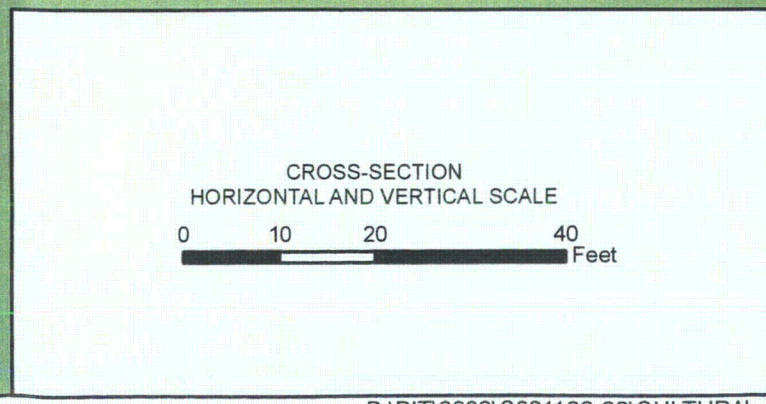
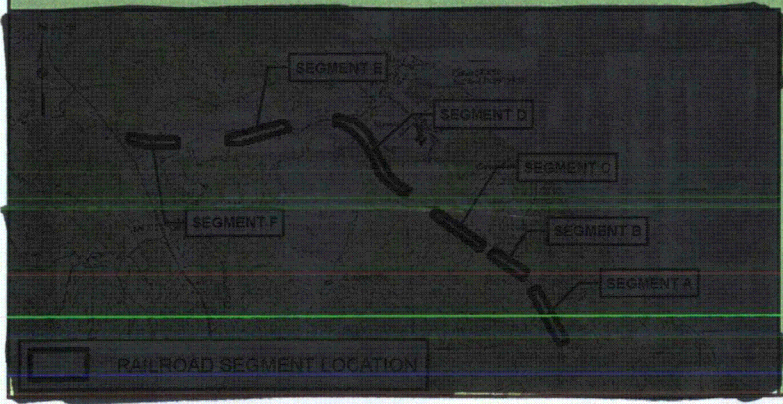
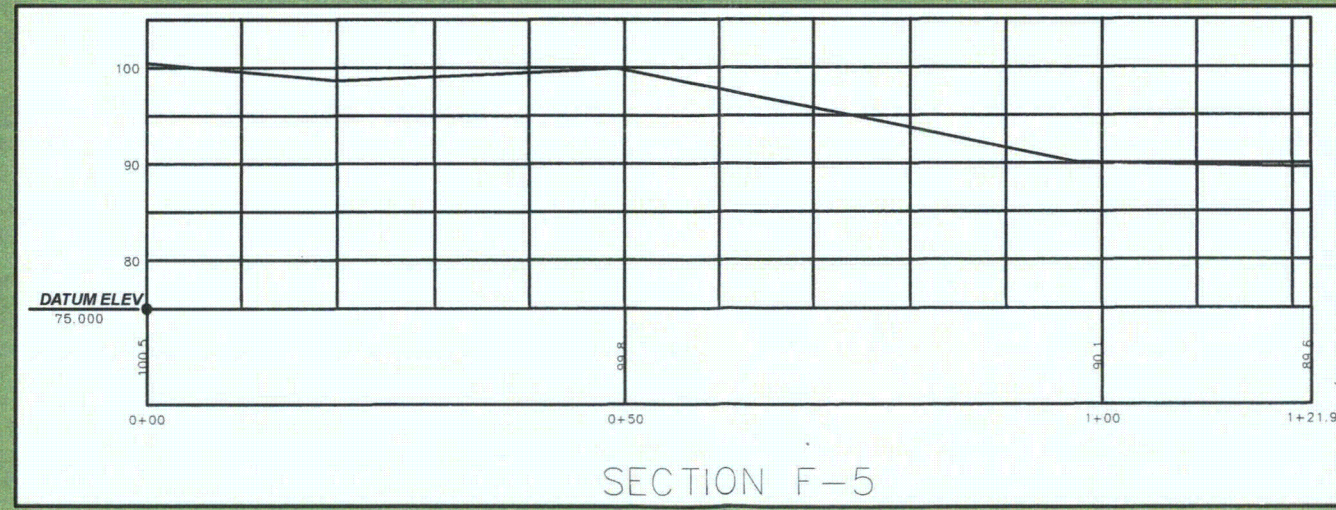
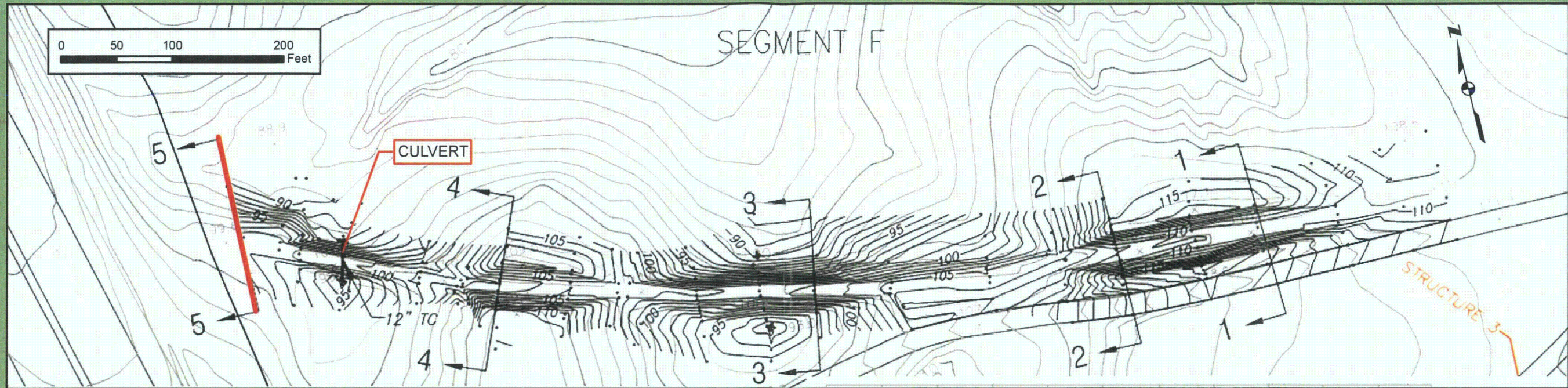

<b>APPENDIX B-6c</b> <b>SEGMENT A PLAN VIEW AND CROSS-SECTIONS</b> <b>SECTION F-5</b>	
 <b>CALVERT CLIFFS 3 NUCLEAR PROJECT (CC3)</b> <b>BALTIMORE AND DRUM POINT RAILROAD (BDPRR)</b> <b>DOCUMENTATION</b>	
BY: DJP	DATE: 12/16/2009
CHECKED: HLC	APPROVED: JNT



Corner Reference Maps on all Appendix C Figures are withheld per section 34 of the National Historic Preservation Act and Title 36 of the Code of Federal Regulations Part 800.11(c)



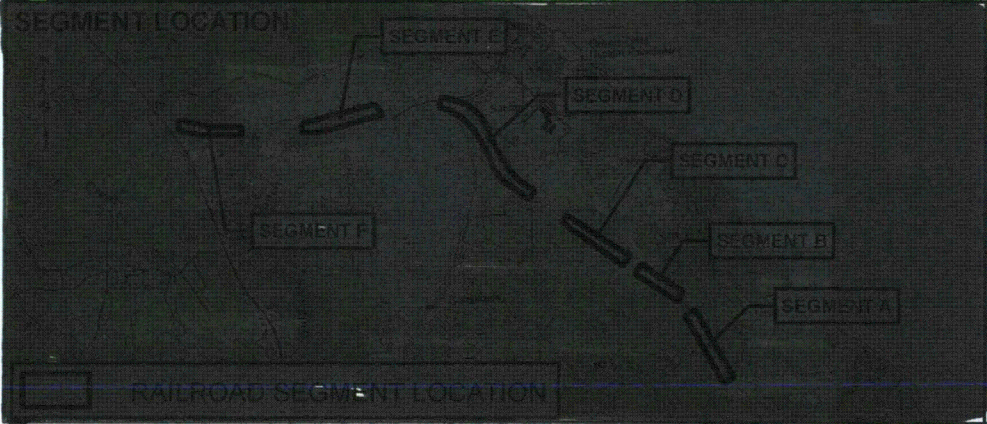
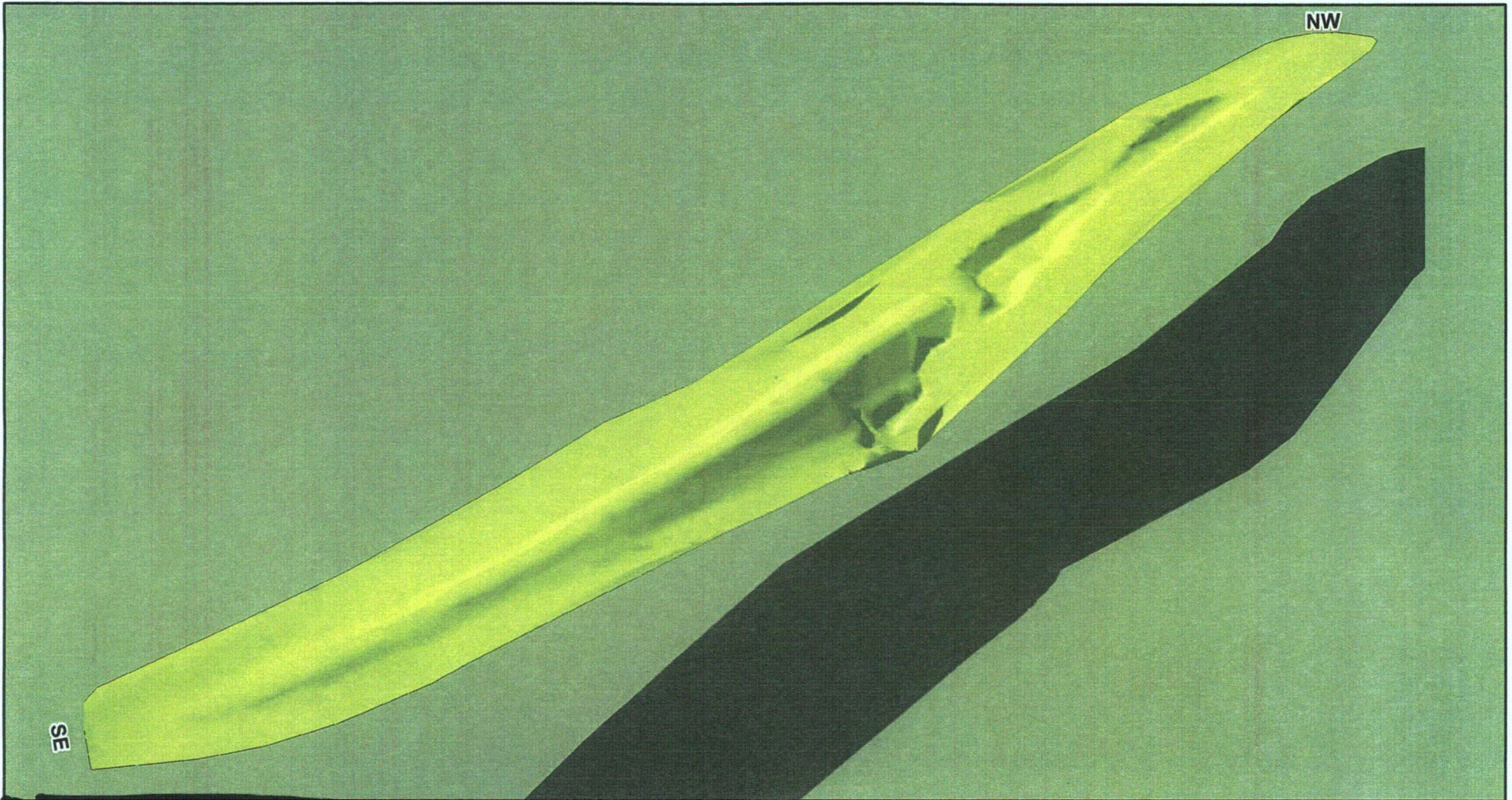

APPENDIX C-1  
 SEGMENT A 3-D RENDERING, FACING SOUTHWEST  
 GENERATED BY GOOGLE™ SKETCHUP



CALVERT CLIFFS 3 NUCLEAR PROJECT (CC3)  
 BALTIMORE AND DRUM POINT RAILROAD (BDPRR)  
 DOCUMENTATION

DRAWN BY: AJW  
 CHECKED: HLC

DATE: 12/17/2009  
 APPROVED: JNT



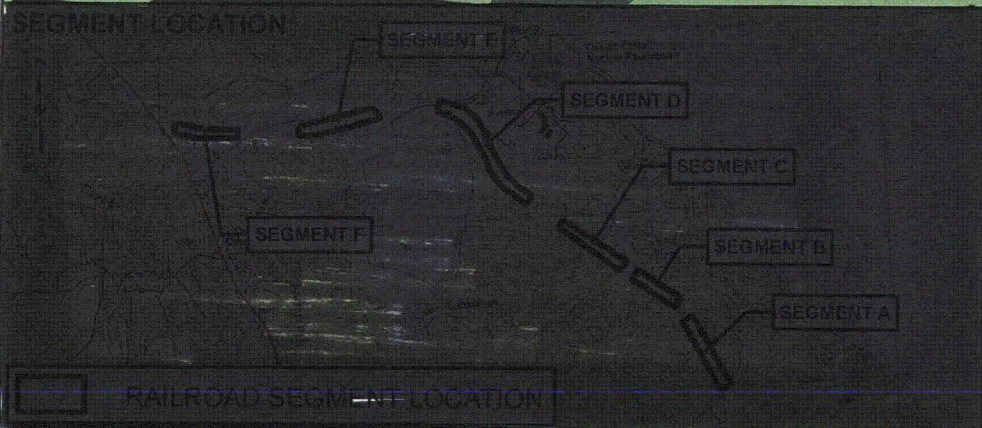

APPENDIX C-2  
 SEGMENT B 3-D RENDERING, FACING SOUTHWEST  
 GENERATED BY GOOGLE™ SKETCHUP



CALVERT CLIFFS 3 NUCLEAR PROJECT (CC3)  
 BALTIMORE AND DRUM POINT RAILROAD (BDPRR)  
 DOCUMENTATION

DRAWN BY: AJW  
 CHECKED: HLC

DATE: 12/17/2009  
 APPROVED: JNT



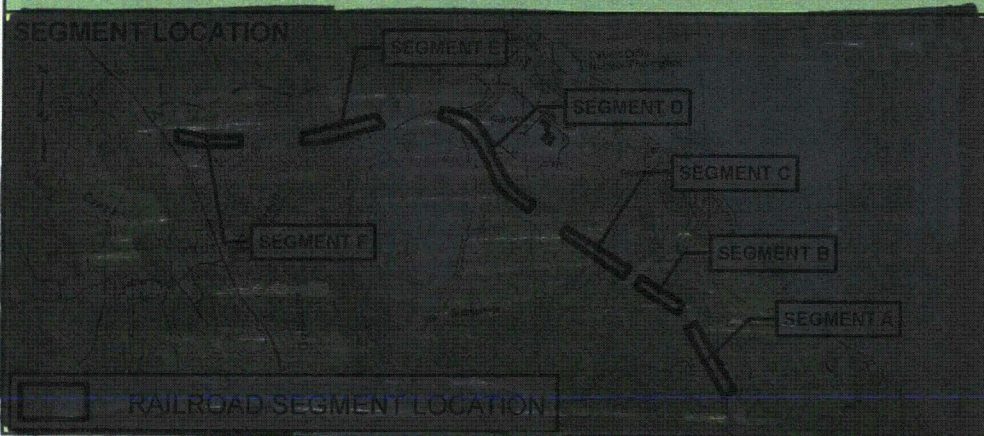
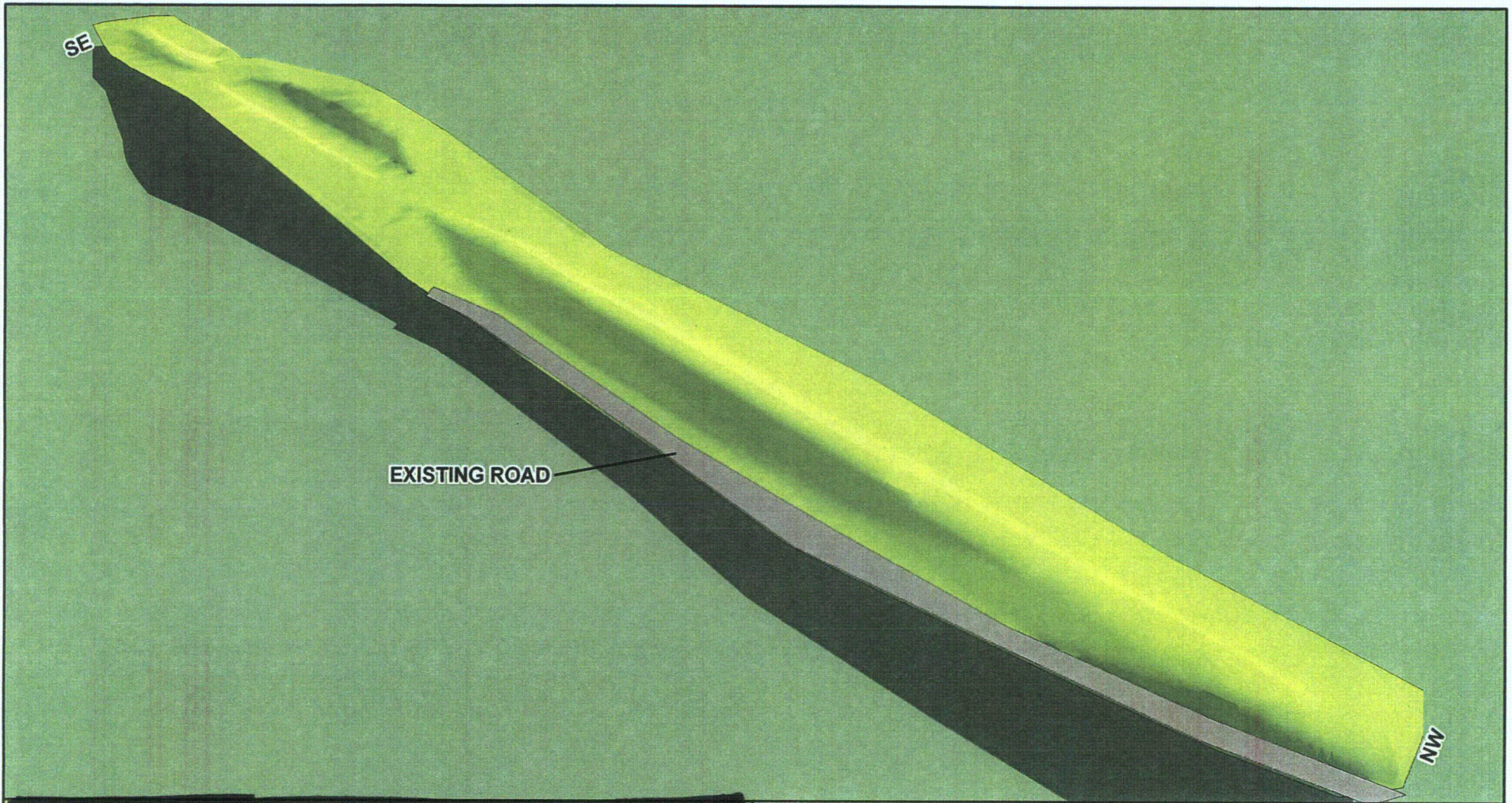

APPENDIX C-3  
 SEGMENT C 3-D RENDERING, FACING SOUTHWEST  
 GENERATED BY GOOGLE™ SKETCHUP



CALVERT CLIFFS 3 NUCLEAR PROJECT (CC3)  
 BALTIMORE AND DRUM POINT RAILROAD (BDPRR)  
 DOCUMENTATION

DRAWN BY: AJW  
 CHECKED: HLC

DATE: 12/17/2009  
 APPROVED: JNT



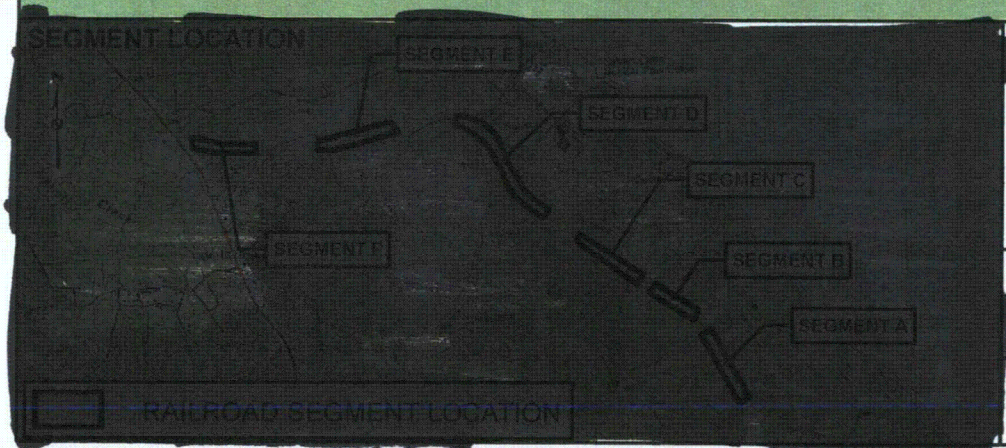
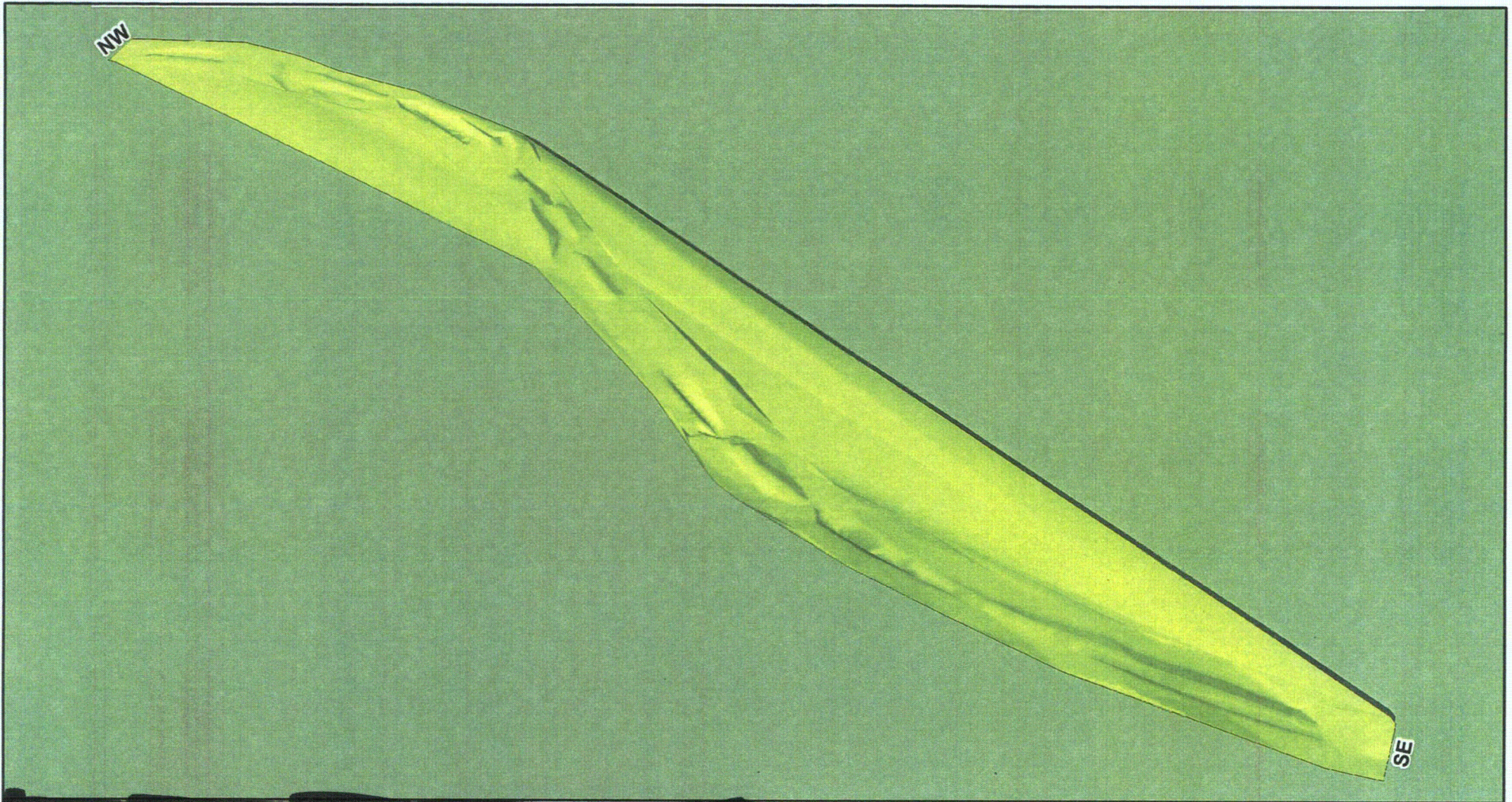

APPENDIX C-4  
 SEGMENT D 3-D RENDERING, FACING EAST  
 GENERATED BY GOOGLE™ SKETCHUP



CALVERT CLIFFS 3 NUCLEAR PROJECT (CC3)  
 BALTIMORE AND DRUM POINT RAILROAD (BDPRR)  
 DOCUMENTATION

DRAWN BY: AJW  
 CHECKED: HLC

DATE: 12/17/2009  
 APPROVED: JNT



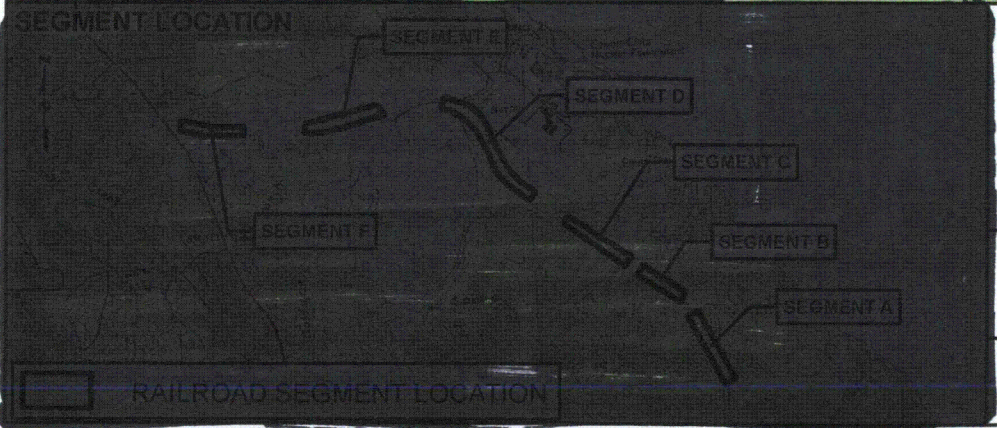
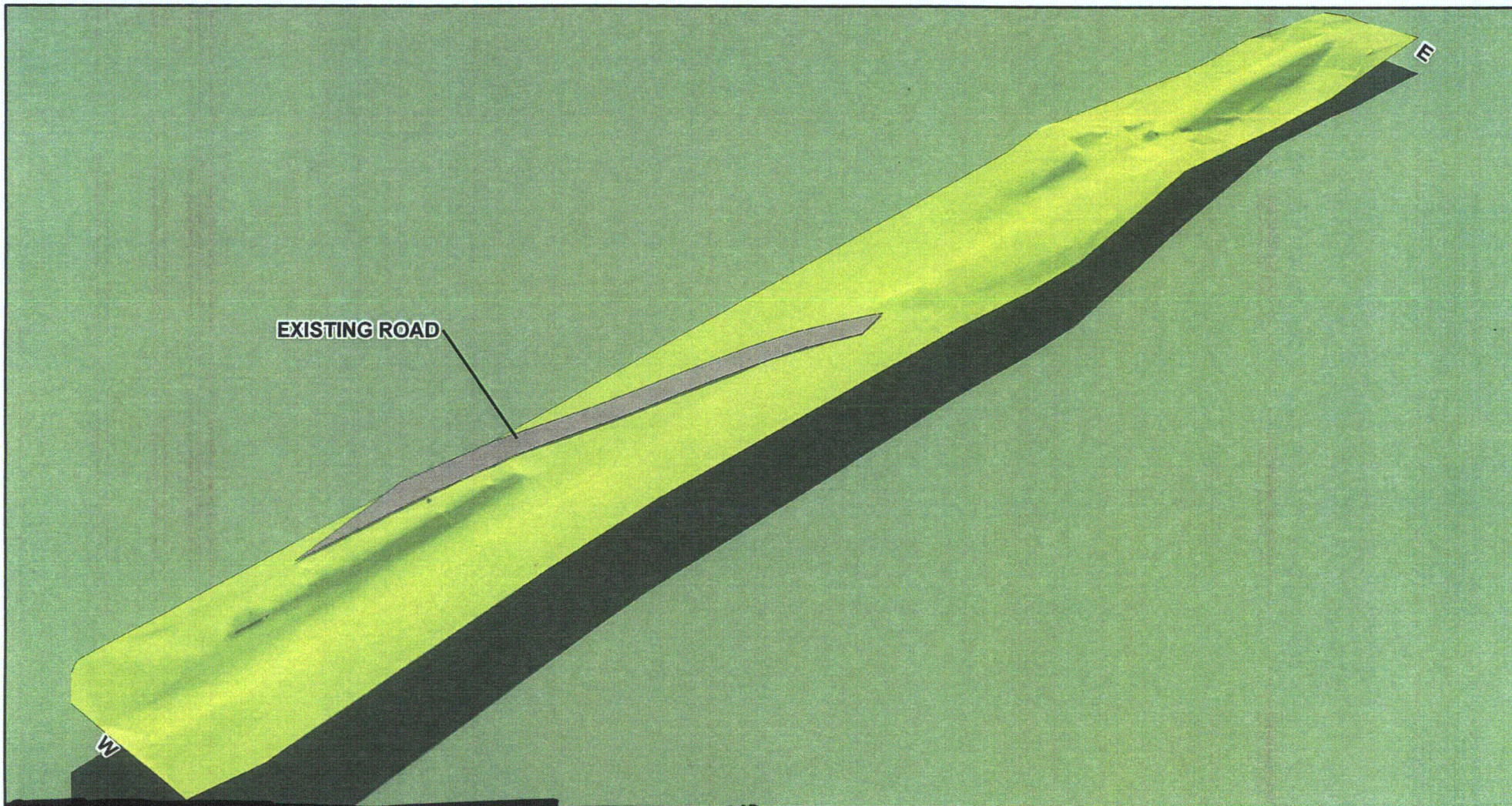

APPENDIX C-5  
 SEGMENT E 3-D RENDERING, FACING NORTH  
 GENERATED BY GOOGLE™ SKETCHUP



CALVERT CLIFFS 3 NUCLEAR PROJECT (CC3)  
 BALTIMORE AND DRUM POINT RAILROAD (BDPRR)  
 DOCUMENTATION

DRAWN BY: AJW  
 CHECKED: HLC

DATE: 12/17/2009  
 APPROVED: JNT



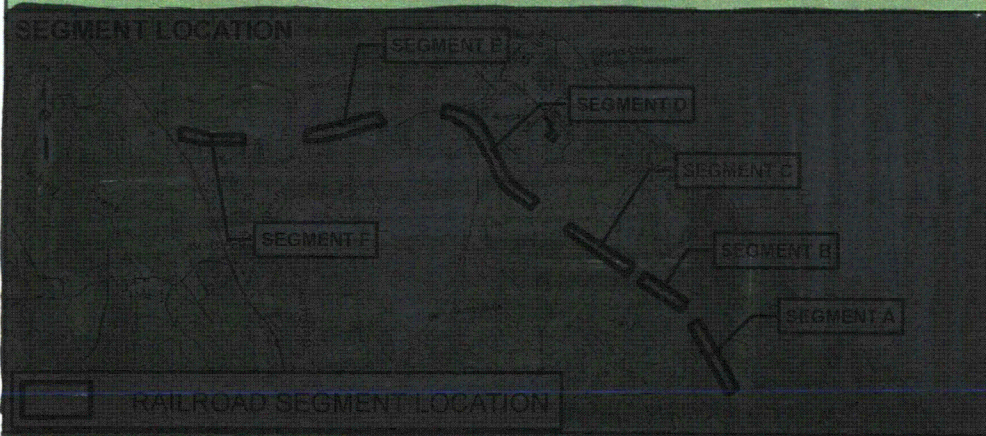
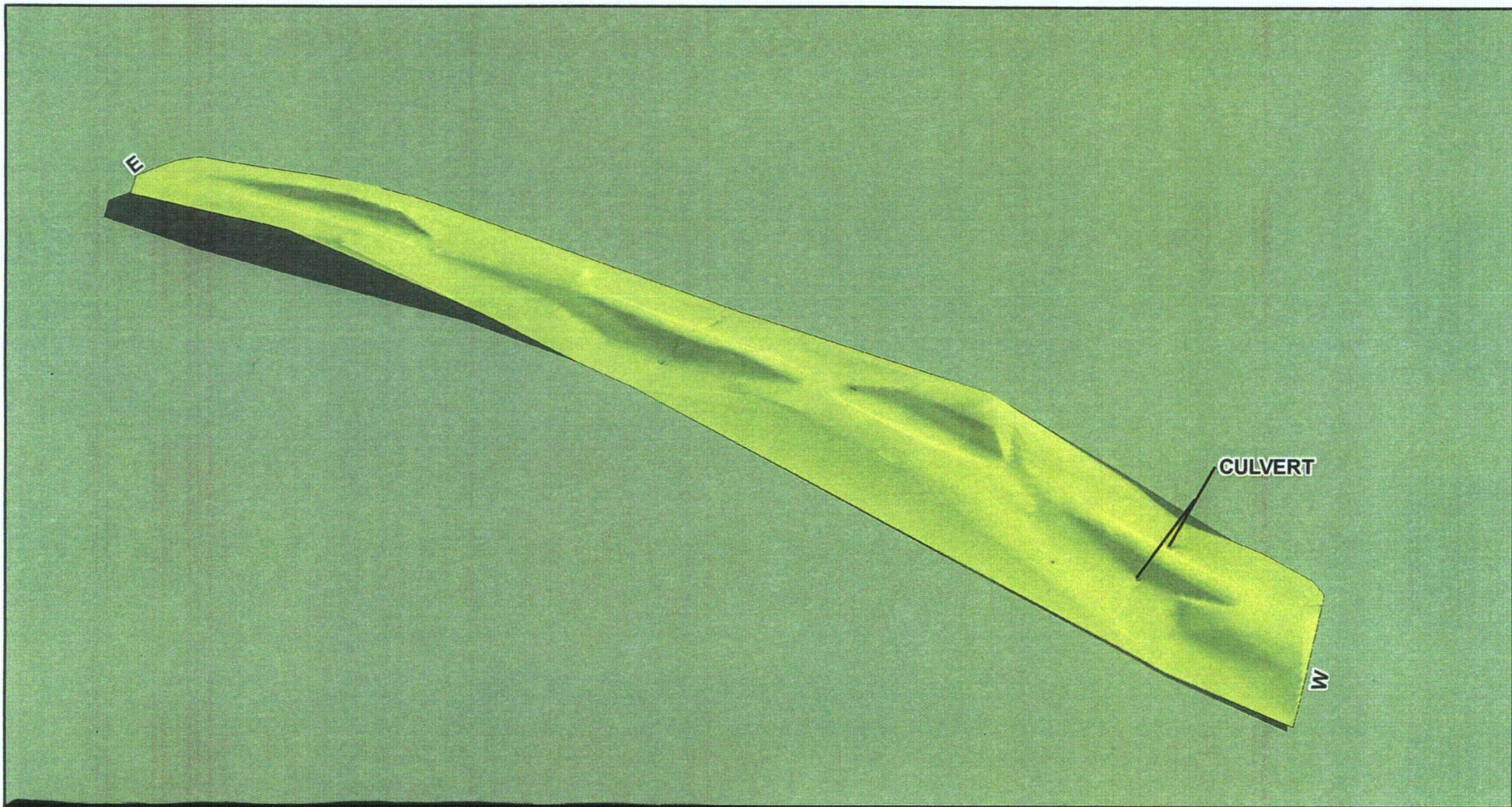

APPENDIX C-6  
SEGMENT F 3-D RENDERING, FACING SOUTHEAST  
GENERATED BY GOOGLE™ SKETCHUP



CALVERT CLIFFS 3 NUCLEAR PROJECT (CC3)  
BALTIMORE AND DRUM POINT RAILROAD (BDPRR)  
DOCUMENTATION

DRAWN BY: AJW  
CHECKED: HLC

DATE: 12/17/2009  
APPROVED: JNT



A copy of the CCNPP – Baltimore & Dunn Point Railroad Mitigation  
Topographical Survey Data Collection 3D Renderings CD  
is available in the Public Document Room at located at NRC Headquarters in Rockville,  
Maryland, and is open to the public from 7:45 a.m. until 4:15 p.m. EST except Federal holidays.  
A copy can also be requested by emailing [pdr.resource@nrc.gov](mailto:pdr.resource@nrc.gov), by Phone at 1-301-415-4737  
or 1-800-397-4209 (8am-4pm except Federal holidays) or by Facsimile at 301-415-3548