

TABLE OF CONTENTS

2.2	Uses of Adjacent Lands and Waters	2.2-1
2.2.1	Land Use	2.2-1
2.2.1.1	Planned Land Uses and Developments	2.2-3
2.2.2	Water Use	2.2-3
2.2.2.1	Surface Water	2.2-3
2.2.2.2	Groundwater	2.2-4

FIGURES

Figure 2.2-1 Land Ownership

Figure 2.2-2 BLM Grazing Allotments

Figure 2.2-3 Nuclear Fuel Cycle Facilities and Mines within 50 Miles

Figure 2.2-4 Groundwater Use Permits

Figure 2.2-5a BLM Battle Spring Draw Well No. 4451

Figure 2.2-5b BLM Battle Spring Well No. 4777

Figure 2.2-5c BLM East Eagle Nest Draw Well

Figure 2.2-6 Domestic and Stock Wells within Five Miles of the Project Area

TABLES

Table 2.2-1 Hunting Statistics for Hunt Areas that Include the Permit Area

Table 2.2-2 Groundwater Rights

Table 2.2-3 Cancelled and Abandoned Wells

Table 2.2-4 Domestic and Stock Wells within Five Miles of the Permit Area

2.2 Uses of Adjacent Lands and Waters

The study area for land and water use is comprised of the Permit Area plus the area within two miles of the Permit Area, except for information on nuclear fuel cycle facilities for which the study area is expanded to 50 miles from the Permit Area. The land and water uses within the study area are described below to provide the background information necessary to assess the potential impacts of the Project. Land and water use data support evaluation of the potential impacts from all aspects of the ISR operation, including radiation exposure calculations, cost-benefit analyses, and determination of air emissions.

2.2.1 Land Use

The land within the Permit Area is entirely publicly owned. Three-thousand-five-hundred-eighty acres (85 percent) are federal land, managed by BLM through the Rawlins and Lander Field Offices. Six-hundred-forty acres (15 percent) are state lands managed by the Wyoming Office of State Lands and Investments. Within the two-mile perimeter study area, 27,486 acres (96 percent) are federally owned; 983 acres (three percent) are state owned; and 307 acres (one percent) are privately owned (**Figure 2.2-1**). The current primary land use in the study area is rangeland for cattle and sheep, but the area is also used for dispersed recreation, such as hunting, off-highway vehicle (OHV) use, and antler collecting. There are no population centers within two miles of the Permit Area; the closest residence is in Bairoil, about 15 miles from the Project. There are no maintained roads within the study area, but a power line is present.

Rangeland and Agriculture

There is no crop production within the Permit Area or within two miles of the Permit Area; the only agricultural production is related to grazing. The study area includes portions of three grazing allotments: Stewart Creek, Cyclone Rim, and Green Mountain (**Figure 2.2-2**). These allotments provide forage for cattle that are generally sold as food sources, as well as a small number of horses and sheep. Grazing rights are assigned by section, so all sections that are at least partly within two miles of the Permit Area are included in the grazing allotment study area.

The Stewart Creek and Cyclone Rim allotments are managed by the BLM Rawlins Field Office, and cover 22,101 acres within the study area. Together, these two allotments provide 3,027 animal unit months (AUMs) of summer and winter grazing (Calton, M. Range Specialist. BLM Rawlins Field Office. Personal communication. July, 2007.). The Green Mountain allotment is managed by the BLM Lander Field Office, and includes 9,339 acres within the study area. This acreage provides 635 AUMs of summer grazing.

An AUM is an animal unit month, the common unit of measure defined as “the amount of forage to sustain one mature cow or the equivalent, based on an average daily forage consumption of 26 pounds of dry matter per day” (BLM, 2004a). The total AUMs for the study area is 3,662, which would provide year-round forage for the equivalent of 305 cows. For a 1,000-pound cow, the average meat yield is 550 pounds (National Sustainable Agriculture Information Service, 2007). Therefore, the annual potential total meat production associated with the Permit Area is roughly 168,000 pounds if all the cattle are slaughtered. However, because the cattle generally include cow-calf pairs, some of the cows and calves are generally kept for breeding.

In 2000, one AUM for cattle was worth \$33.27. At these values, the BLM calculated that cattle production would produce \$65.07 per AUM of total economic impact, which includes both direct and secondary returns (BLM, 2004a). Using these figures, livestock production on rangeland within the grazing allotments of the Permit Area has a potential value of about \$238,000 per year based on the current AUMs of the study area.

Hunting

WGFD hunting areas for antelope, deer, elk, and mountain lion include the Permit Area. Hunting seasons run from September through December, but hunting occurs primarily in October and November. Hunter days for the hunt areas in the general region of the Project are shown in **Table 2.2-1**; these hunt areas are primarily not within two miles of the Permit Area.

Infrastructure

Currently, the only transportation corridors within the study area proper are two-track roads (**Figure 1.3-1**). These are accessible year-round by four-wheel-drive vehicles. Most are indistinct, difficult to delineate, or do not have obvious end points. These tracks are not maintained, have no drainage, and are sometimes impassible during the winter months. County Road 23 North (Wamsutter-Crooks Gap Road) is about five miles west of the Permit Area, and the BLM 3215 (Sooner Road) is about five miles east. A power transmission line runs in a north-south direction near the western boundary of the Permit Area.

Nuclear Fuel Cycle Facilities, Uranium Mills, Mines, and ISR Projects

There are no nuclear fuel cycle facilities within 50 miles of the Lost Creek Permit Area (NRC, 2007). However, there are several conventional uranium mills and mines and ISR projects within 50 miles of the Permit Area; the locations are shown on **Figure 2.2-3**. Other than Kennecott Uranium Company’s Sweetwater Mill (NRC License No. SUA-1350; WDEQ Permit No. 481), which is currently on stand-by, and the PRI Gas Hills

Project (NRC License No. SUA-1511-Amendment; WDEQ Permit No. 603), which is a new ISR project not yet in operation, all of the operations shown in **Figure 2.2-3** are in decommissioning or reclamation or have been reclaimed by the operator or the WDEQ Abandoned Mine Lands Division. The closest facility to the Project is the Sweetwater Mill, which is located about five miles south-southwest of the center of the Project, with about two miles separating the permit boundaries.

2.2.1.1 Planned Land Uses and Developments

Both Carbon and Sweetwater Counties are experiencing considerable natural resource development, much of which is related to oil and gas exploration and production. Based on publicly available information, no projects are currently planned within the study area (Simons, D. Planning and Environmental Coordinator, BLM Rawlins Field Office. Personal communication. 2007; Murray, C. Planning and Environmental Coordinator, BLM Lander Field Office. Personal communication. 2007). Although specific locations and plans have generally not been publicly disclosed, uranium exploration in the general vicinity has recently increased in response to the current uranium market.

2.2.2 Water Use

Water-use permits with legal descriptions inside and within two miles of the Permit Area were queried in 2007 using the Wyoming State Engineer's Office (WSEO) Water Rights Database (WSEO, 2006). In this vicinity, water is used for livestock and wildlife watering as well as for purposes related to mining (monitoring, pump testing, and dewatering). Currently, water is not used for domestic or irrigation purposes within two miles of the Permit Area.

2.2.2.1 Surface Water

The WSEO Database query results indicate that surface-water-use permits do not exist inside or within two miles of the Permit Area. As noted in the following section, there are four BLM stock ponds within two miles of the Permit Area (**Figure 2.2-4**). The water-use permits for these ponds are associated with the wells that supply the ponds, i.e., they are not associated with any surface-water-use permits. Also, as noted in **Section 2.7.1.1**, the Crooked Well Reservoir is located in the Permit Area. However, it is a small off-channel detention pond, less than one-quarter acre in size, and there is no water-use permit associated with it.

2.2.2.2 Groundwater

Water-use permits with legal descriptions inside and within two miles of the Permit Area were queried using the WSEO Water Rights Database (WSEO, 2006). The majority of the groundwater-use permits filed in the vicinity of the Permit Area are for monitoring or miscellaneous mining-related purposes, and do not represent consumptive use of groundwater. Many of those permits are associated with the Kennecott Sweetwater Mine, which is in reclamation. Because this mine was an open-pit operation, the dewatering and monitoring associated with it were at much shallower depths than those proposed for ISR at Lost Creek. Dewatering in advance of mining at the Sweetwater Mine was completed in 1983.

All non-mining and mining groundwater-use permits inside and within two miles of the Permit Area are presented in **Table 2.2-2**. Descriptions of the groundwater-use permits include, but are not limited to, location, uses, priority dates, status, yield, total depth, and static water depth.

The water-use permits unrelated to mining are those of the BLM. In 1968 and 1980, the BLM Rawlins District was granted three permits (13834, 55112, and 55113). Each of these permits is associated with a well that supplies a stock pond (or tank). These wells and associated stock ponds are located outside of the Permit Area, but within the study area (**Figure 2.2-4**). In addition, there is a fourth BLM well, supplying a stock pond, for which no water-use permit was found.

Permit 13834 is for Battle Spring Draw Well No. 4451, which pumps water into a stock tank east of the Permit Area (Township 25 North, Range 92 West, Section 21, Northwest Quarter, Northeast Quarter, Northeast Quarter). In 1968, a uranium exploration hole was drilled at this location; when water was encountered, plastic casing was installed and the well was developed. The well depth is 900 feet, with a static water level of 104 feet. A yield of 19 gpm is permitted. The screened interval is unknown, but given the well depth, it may be significantly deeper than the sands targeted by LC ISR, LLC under this permit. In November 2007, this well did not appear to have been used in some time and the associated pond consisted of an in-channel berm designed to pond natural runoff during spring snowmelt or rare summer flow events. However, in April 2009, the well had apparently been recently put back into use, with a solar-powered pump feeding a stock tank, with overflow routed to the in-channel stock pond (**Figure 2.2-5a**).

Boundary Well No. 4775 (Permit 55112) and Battle Spring Well No. 4777 (Permit 55113) were drilled as stock wells in 1981 to a depth of approximately 280 feet and 220 feet, respectively. These wells are shallower than the sands targeted by LC ISR, LLC under this permit. A water use of 25 gpm is permitted at each of these wells. According to aerial photographs, Boundary Well No. 4775 is located northeast of the Permit Area, in

Township 25 North, Range 92 West, Section 10, Southeast Quarter, Northeast Quarter, Southwest Quarter. Battle Spring Well No. 4777 is situated southeast of the Permit Area, in Township 25 North, Range 92 West, Section 30, Southeast Quarter, Northwest Quarter. The condition of the windmill on Boundary Well No. 4775 is not known, and the windmill on the Battle Spring Well No. 4777 was not in working order in June 2007 (**Figure 2.2-5b**).

In June and July of 2007, LC ISR, LLC contacted BLM to identify the status of these groundwater-use permits. These groundwater-use permits are still considered active (BLM, 2007). In addition to these wells, BLM identified another active stock well, the East Eagle Nest Draw Well.

The East Eagle Nest Draw Well is located north of the Permit Area, in the Northwest Quarter of the Northwest Quarter of the Northwest Quarter of Section 13, Township 25 North and Range 93 West. From mid-May through mid-September, an electric submersible pump in the well is used to pump water into a livestock watering pond at an average rate of five gpm for six to eight hours each day (**Figure 2.2-5c**). This total depth of this well is 370 feet, with a static water level of 269 feet.

Throughout the phases of the Project, LC ISR, LLC will correspond with BLM to ensure that the stock reservoirs and wells are not impacted in a manner that restricts their intended use.

At this time, LC ISR, LLC has several water supply wells and over 100 monitor wells permitted and bonded by the State Engineer and WDEQ to LC ISR, LLC and its affiliates (Ur-E and NFU Wyoming, LLC). Installation of these wells is on-going. Currently, the Project consumes a negligible amount of groundwater for well development, monitoring, testing, and miscellaneous purposes related to uranium exploration. Projected water use once ISR begins is discussed in **Sections 3.1.1** (water supply) and **3.2.7.3** (ISR water balance), and the impacts of that use are discussed in **Section 7.1.5.2**.

A list and description of the queried cancelled and abandoned drill holes and wells within a two-mile radius of the Permit Area are displayed in **Table 2.2-3**. Abandonment information for historic drill holes is included in **Section 2.6**. Drill hole abandonment is discussed in detail in **Section 3.2.2** of this report. Well abandonment is discussed in **Section 6.3.2** of this report.

In November 2008, NRC requested a list of the domestic and stock wells within five miles of the Permit Area (Request for Additional Information (RAI) 2.7.2 #4). In response to that RAI in December 2008, LC ISR, LLC provided the map and list of those wells (**Figure 2.2-6** and **Table 2.2-4**). Of these fifteen wells, all are stock wells except for the supply well for Kennecott Uranium Company's Sweetwater Mill.

Figure 2.2-5a BLM Battle Spring Draw Well No. 4451



Battle Spring Draw Well No. 4551. November 2007.
(Same as Figure D6-19.)



Battle Spring Draw Well No. 4551. April 2009.



Pipeline from Battle Spring Draw Well No. 4551 to dirt 'tank'.
April 2009.



Pipeline outlet from Battle Spring Draw Well No. 4551 to dirt 'tank'.
April 2009.



Dirt 'tank' at pipeline outlet from Battle Spring Draw Well No. 4551.
April 2009.

Figure 2.2-5b BLM Battle Spring Well No. 4777



(June 13, 2007)

Figure 2.2-5c BLM East Eagle Nest Draw Well



(June 13, 2007)

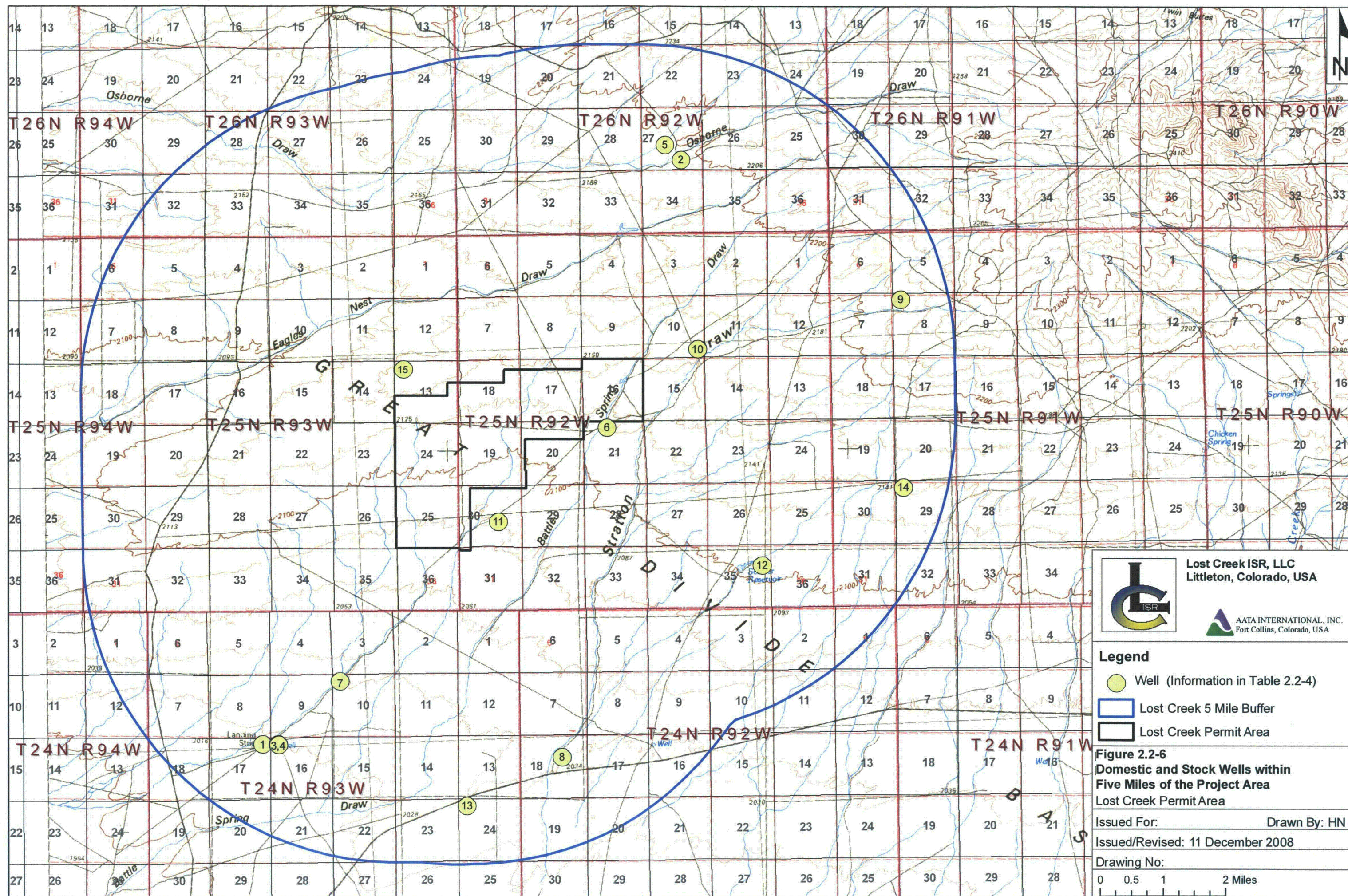

Table 2.2-2 Groundwater Use Permits General Disclaimer

The data contained herein are provided AS IS and IN NO EVENT SHALL the State of Wyoming, its agencies or representatives, be LIABLE for any DAMAGES including, without limitation, damages resulting from lost data or profits or revenue the costs of recovering such data, the cost of substitute data, computer repair or replacement costs, claims by third parties for similar costs, or any special, direct or indirect, incidental, punitive or consequential damages of any kind whatsoever, arising out of the use of these data. The accuracy or reliability of the data IS NOT GUARANTEED or WARRANTED in any way and the State of Wyoming, its agencies or representatives, EXPRESSLY DISCLAIM LIABILITY, whether expressed or implied, or of any kind whatsoever, including, without limitation, liability for QUALITY, PERFORMANCE, MERCHANTABILITY AND FITNESS FOR THE PARTICULAR PURPOSE arising from the use of the data, NEITHER the State of Wyoming, NOR its agencies or representatives, including the State Engineer's Office, REPRESENT or ENDORSE the ACCURACY or RELIABILITY OF ANY INFORMATION contained in the database, as some of the data are provided by permit applicants and may not have been verified by the State of Wyoming, its agencies or representatives. The State of Wyoming, its agencies and representatives RESERVE THE RIGHT, at their sole discretion, WITHOUT OBLIGATION, to MODIFY, ADD OR REMOVE all or portions of the data, at any time, WITH OR WITHOUT NOTICE. This includes the correction of errors or omissions within the database. All data or information provided by the Wyoming State Engineer's Office shall be used and relied upon only at the USER'S SOLE RISK, and the user agrees to indemnify and hold harmless the State of Wyoming, its agencies or representatives, including the Wyoming State Engineer's Office, and its officials, officers, and employees, from any liability arising out of the use or distribution of these data.

Definitions

- **Adjudicated:** A priority assigned to an appropriation and a decree or certificate issued publicly recognizing the defined water right and conveying property-right status on the appropriation.
- **Good Standing Incomplete:** All legally required notices have not been received and the permit has not expired.
- **Unadjudicated:** A water right permit before it has been publicly recognized by proof of inspection and advertisement.

* Wyoming State Engineer's Office (WSEO). 2006. Documents. Available from: <http://seo.state.wy.us/docs.aspx>. Accessed on 11 December 2008.

Table 2.2-2 Groundwater Use Permits (Page 1 of 8)

Last Revised December 2008

ID ¹	Well or Use Point	Permit Number	Applicant ²	Township	Range	Section	% of the ³	Uses	Priority	Status	Permit Facility Name	Yield ⁴	Well Depth (ft)	Static Well Depth (ft)
1	Well	P9742W	Kennecott Uranium Company	24 N	94 W	34	NENE	Stock, Industrial	7/15/1971	Adjudicated	J E S No. 1	25 gpm	170	104
1a	Use Point	P9742W	Kennecott Uranium Company	24 N	92 W	5	INP	Stock, Industrial	7/15/1971	Adjudicated	J E S No. 1			
1b	Use Point	P9742W	Kennecott Uranium Company	24 N	92 W	6	INP	Stock, Industrial	7/15/1971	Adjudicated	J E S No. 1			
1c	Use Point	P9742W	Kennecott Uranium Company	24 N	92 W	7	INP	Stock, Industrial	7/15/1971	Adjudicated	J E S No. 1			
1d	Use Point	P9742W	Kennecott Uranium Company	24 N	93 W	1	INP	Stock, Industrial	7/15/1971	Adjudicated	J E S No. 1			
1e	Use Point	P9742W	Kennecott Uranium Company	24 N	93 W	2	INP	Stock, Industrial	7/15/1971	Adjudicated	J E S No. 1			
1f	Use Point	P9742W	Kennecott Uranium Company	24 N	93 W	3	INP	Stock, Industrial	7/15/1971	Adjudicated	J E S No. 1			
1g	Use Point	P9742W	Kennecott Uranium Company	24 N	93 W	11	INP	Stock, Industrial	7/15/1971	Adjudicated	J E S No. 1			
1h	Use Point	P9742W	Kennecott Uranium Company	24 N	93 W	12	INP	Stock, Industrial	7/15/1971	Adjudicated	J E S No. 1			
1i	Use Point	P9742W	Kennecott Uranium Company	25 N	93 W	1	INP	Stock, Industrial	7/15/1971	Adjudicated	J E S No. 1			
1j	Use Point	P9742W	Kennecott Uranium Company	25 N	93 W	2	INP	Stock, Industrial	7/15/1971	Adjudicated	J E S No. 1			
1k	Use Point	P9742W	Kennecott Uranium Company	25 N	93 W	3	INP	Stock, Industrial	7/15/1971	Adjudicated	J E S No. 1			
1l	Use Point	P9742W	Kennecott Uranium Company	25 N	93 W	10	INP	Stock, Industrial	7/15/1971	Adjudicated	J E S No. 1			
1m	Use Point	P9742W	Kennecott Uranium Company	25 N	93 W	11	INP	Stock, Industrial	7/15/1971	Adjudicated	J E S No. 1			
1n	Use Point	P9742W	Kennecott Uranium Company	25 N	93 W	12	INP	Stock, Industrial	7/15/1971	Adjudicated	J E S No. 1			
1o	Use Point	P9742W	Kennecott Uranium Company	25 N	93 W	13	INP	Stock, Industrial	7/15/1971	Adjudicated	J E S No. 1			
1p	Use Point	P9742W	Kennecott Uranium Company	25 N	93 W	14	INP	Stock, Industrial	7/15/1971	Adjudicated	J E S No. 1			
1q	Use Point	P9742W	Kennecott Uranium Company	25 N	93 W	15	INP	Stock, Industrial	7/15/1971	Adjudicated	J E S No. 1			
1r	Use Point	P9742W	Kennecott Uranium Company	25 N	93 W	22	INP	Stock, Industrial	7/15/1971	Adjudicated	J E S No. 1			
1s	Use Point	P9742W	Kennecott Uranium Company	25 N	93 W	23	INP	Stock, Industrial	7/15/1971	Adjudicated	J E S No. 1			
1t	Use Point	P9742W	Kennecott Uranium Company	25 N	93 W	24	INP	Stock, Industrial	7/15/1971	Adjudicated	J E S No. 1			
1u	Use Point	P9742W	Kennecott Uranium Company	25 N	93 W	25	INP	Stock, Industrial	7/15/1971	Adjudicated	J E S No. 1			
1v	Use Point	P9742W	Kennecott Uranium Company	25 N	93 W	26	INP	Stock, Industrial	7/15/1971	Adjudicated	J E S No. 1			
1w	Use Point	P9742W	Kennecott Uranium Company	25 N	93 W	27	INP	Stock, Industrial	7/15/1971	Adjudicated	J E S No. 1			
1x	Use Point	P9742W	Kennecott Uranium Company	25 N	93 W	34	INP	Stock, Industrial	7/15/1971	Adjudicated	J E S No. 1			
1y	Use Point	P9742W	Kennecott Uranium Company	25 N	93 W	35	INP	Stock, Industrial	7/15/1971	Adjudicated	J E S No. 1			
1z	Use Point	P9742W	Kennecott Uranium Company	25 N	93 W	36	INP	Stock, Industrial	7/15/1971	Adjudicated	J E S No. 1			
2	Well	P13834P	USDI BLM, Rawlins District	25 N	92 W	21	NENW	Stock	9/21/1968	Good Standing	Battle Spring Draw Well No. 4451	19 gpm	900	104
2a	Use Point	P13834P	USDI BLM, Rawlins District	25 N	92 W	21	NENW	Stock	9/21/1968	Good Standing	Battle Spring Draw Well No. 4451			
3	Well	P47137W	Kennecott Uranium Company	24 N	93 W	10	NWNW	Reservoir Supply, Stock, Miscellaneous	12/7/1977	Unadjudicated	Blue No. 5	INP	INP	INP
3a	Use Point	P47137W	Kennecott Uranium Company	24 N	93 W	3	SWSW	Reservoir Supply, Stock, Miscellaneous	12/7/1977	Unadjudicated	Blue No. 5			
3b	Use Point	P47137W	Kennecott Uranium Company	24 N	93 W	3	SESW	Reservoir Supply, Stock, Miscellaneous	12/7/1977	Unadjudicated	Blue No. 5			
4	Well	P48386W	Kennecott Uranium Company	24 N	93 W	3	SWNE	Monitoring, Dewatering, Miscellaneous	5/31/1979	Unadjudicated	24-93W-3AC-M-1	0 gpm	450	135.8
5	Well	P54883W	Kennecott Uranium Company – WSBLC	24 N	93 W	16	NWNE	Dewatering, Industrial, Miscellaneous	11/24/1980	Good Standing	DW31	190 gpm	600	152
5a	Use Point	P54883W	Kennecott Uranium Company – WSBLC	24 N	93 W	11	SWSW	Dewatering, Industrial, Miscellaneous	11/24/1980	Good Standing	DW 31			
5b	Use Point	P54883W	Kennecott Uranium Company – WSBLC	24 N	93 W	11	SESW	Dewatering, Industrial, Miscellaneous	11/24/1980	Good Standing	DW 31			
6	Well	P54884W	Kennecott Uranium Company – WSBLC	24 N	93 W	16	NENE	Dewatering, Industrial, Miscellaneous	11/24/1980	Unadjudicated	DW 32	200 gpm	600	147

Table 2.2-2 Groundwater Use Permits (Page 2 of 8)

ID ¹	Well or Use Point	Permit Number	Applicant ²	Township	Range	Section	¼ of the ¼ ³	Uses	Priority	Status	Permit Facility Name	Yield ⁴	Well Depth (ft)	Static Well Depth (ft)
6a	Use Point	P54884W	Kennecott Uranium Company – WSBLC	24 N	93 W	11	SWSW	Dewatering, Industrial, Miscellaneous	11/24/1980	Unadjudicated	DW 32			
6b	Use Point	P54884W	Kennecott Uranium Company – WSBLC	24 N	93 W	11	SESW	Dewatering, Industrial, Miscellaneous	11/24/1980	Unadjudicated	DW 32			
7	Well	P54885W	Kennecott Uranium Company – WSBLC	24 N	93 W	16	NENE	Dewatering, Industrial, Miscellaneous	11/24/1980	Unadjudicated	DW 33	190 gpm	560	141
7a	Use Point	P54885W	Kennecott Uranium Company – WSBLC	24 N	93 W	11	SWSW	Dewatering, Industrial, Miscellaneous	11/24/1980	Unadjudicated	DW 33			
7b	Use Point	P54885W	Kennecott Uranium Company – WSBLC	24 N	93 W	11	SESW	Dewatering, Industrial, Miscellaneous	11/24/1980	Unadjudicated	DW 33			
8	Well	P54886W	Kennecott Uranium Company – WSBLC	24 N	93 W	16	NENE	Dewatering, Industrial, Miscellaneous	11/24/1980	Good Standing	DW 34	200 gpm	450	140
8a	Use Point	P54886W	Kennecott Uranium Company – WSBLC	24 N	93 W	11	SWSW	Dewatering, Industrial, Miscellaneous	11/24/1980	Good Standing	DW 34			
8b	Use Point	P54886W	Kennecott Uranium Company – WSBLC	24 N	93 W	11	SESW	Dewatering, Industrial, Miscellaneous	11/24/1980	Good Standing	DW 34			
9	Well	P54891W	USDI BLM – Kennecott Uranium Company	24 N	93 W	15	NWNW	Dewatering, Industrial, Miscellaneous	11/24/1980	Good Standing	DW 39	200 gpm	600	169
9a	Use Point	P54891W	USDI BLM – Kennecott Uranium Company	24 N	93 W	11	SWSW	Dewatering, Industrial, Miscellaneous	11/24/1980	Good Standing	DW 39			
9b	Use Point	P54891W	USDI BLM – Kennecott Uranium Company	24 N	93 W	11	SESW	Dewatering, Industrial, Miscellaneous	11/24/1980	Good Standing	DW 39			
10	Well	P54892W	USDI BLM – Kennecott Uranium Company	24 N	93 W	15	NWNW	Dewatering, Industrial, Miscellaneous	11/24/1980	Good Standing	DW 40	200 gpm	600	155
10a	Use Point	P54892W	USDI BLM – Kennecott Uranium Company	24 N	93 W	11	SWSW	Dewatering, Industrial, Miscellaneous	11/24/1980	Good Standing	DW 40			
10b	Use Point	P54892W	USDI BLM – Kennecott Uranium Company	24 N	93 W	11	SESW	Dewatering, Industrial, Miscellaneous	11/24/1980	Good Standing	DW 40			
11	Well	P54893W	Kennecott Uranium Company – WSBLC	24 N	93 W	16	NENE	Dewatering, Industrial, Miscellaneous	11/24/1980	Good Standing	DW 41	190 gpm	600	157
11a	Use Point	P54893W	Minerals Exploration Company – WSBLC	24 N	93 W	11	SWSW	Dewatering, Industrial, Miscellaneous	11/24/1980	Good Standing	DW 41			
11b	Use Point	P54893W	Minerals Exploration Company – WSBLC	24 N	93 W	11	SESW	Dewatering, Industrial, Miscellaneous	11/24/1980	Good Standing	DW 41			
12	Well	P54894W	Kennecott Uranium Company – WSBLC	24 N	93 W	16	NENE	Dewatering, Industrial, Miscellaneous	11/24/1980	Good Standing	DW 42	200 gpm	600	166
12a	Use Point	P54894W	Minerals Exploration Company – WSBLC	24 N	93 W	11	SWSW	Dewatering, Industrial, Miscellaneous	11/24/1980	Good Standing	DW 42			
12b	Use Point	P54894W	Minerals Exploration Company – WSBLC	24 N	93 W	11	SESW	Dewatering, Industrial, Miscellaneous	11/24/1980	Good Standing	DW 42			
13	Well	P55112W	USDI BLM, Rawlins District	25 N	92 W	10	SESE	Stock	12/24/1980	Good Standing	Boundary	5 gpm	280	155
13a	Use Point	P55112W	USDI BLM, Rawlins District	25 N	92 W	10	SESE	Stock	12/24/1980	Good Standing	Boundary			
14	Well	P55113W	USDI BLM, Rawlins District	25 N	92 W	30	NWSE	Stock	12/24/1980	Good Standing	Battle Springs	5 gpm	220	109
14a	Use Point	P55113W	USDI BLM, Rawlins District	25 N	92 W	30	NWSE	Stock	12/24/1980	Good Standing	Battle Springs			
15	Well	P63128W	USDI, BLM – Kennecott Uranium Company	24 N	93 W	11	SWSW	Monitoring	1/28/1983	Good Standing	TMW-14	0 gpm	INP	INP
15a	Use Point	P63128W	USDI, BLM – Kennecott Uranium Company	24 N	93 W	11	SWSW	Monitoring	1/28/1983	Good Standing	TMW-14			

Table 2.2-2 Groundwater Use Permits (Page 3 of 8)

ID ¹	Well or Use Point	Permit Number	Applicant ²	Township	Range	Section	% of the ¼ ³	Uses	Priority	Status	Permit Facility Name	Yield ⁴	Well Depth (ft)	Static Well Depth (ft)
16	Well	P147594W	Kennecott Uranium Company	24 N	93 W	1	SWNE	Monitoring	10/22/2002	Good Standing	TMW-90	INP	55	36.13
17	Well	P147595W	Kennecott Uranium Company	24 N	93 W	1	SENW	Monitoring	10/22/2002	Good Standing	TMW-91	INP	110	100.17
18	Well	P169906W	Ur-Energy USA Inc. – WSBLC	25 N	92 W	24	NENW	Miscellaneous	9/12/2005	Good Standing Incomplete	LCIW	LCS	LCS	LCS
18a	Use Point	P169906W	Ur-Energy USA Inc. – WSBLC	25 N	92 W	16	NENE	Miscellaneous	9/12/2005	Good Standing Incomplete	LCIW			
18b	Use Point	P169906W	Ur-Energy USA Inc. – WSBLC	25 N	92 W	16	NWNE	Miscellaneous	9/12/2005	Good Standing Incomplete	LCIW			
18c	Use Point	P169906W	Ur-Energy USA Inc. – WSBLC	25 N	92 W	16	SWNE	Miscellaneous	9/12/2005	Good Standing Incomplete	LCIW			
18d	Use Point	P169906W	Ur-Energy USA Inc. – WSBLC	25 N	92 W	16	SENE	Miscellaneous	9/12/2005	Good Standing Incomplete	LCIW			
18e	Use Point	P169906W	Ur-Energy USA Inc. – WSBLC	25 N	92 W	16	NENW	Miscellaneous	9/12/2005	Good Standing Incomplete	LCIW			
18f	Use Point	P169906W	Ur-Energy USA Inc. – WSBLC	25 N	92 W	16	NWNW	Miscellaneous	9/12/2005	Good Standing Incomplete	LCIW			
18g	Use Point	P169906W	Ur-Energy USA Inc. – WSBLC	25 N	92 W	16	SWNW	Miscellaneous	9/12/2005	Good Standing Incomplete	LCIW			
18h	Use Point	P169906W	Ur-Energy USA Inc. – WSBLC	25 N	92 W	16	SENW	Miscellaneous	9/12/2005	Good Standing Incomplete	LCIW			
18i	Use Point	P169906W	Ur-Energy USA Inc. – WSBLC	25 N	92 W	16	NESW	Miscellaneous	9/12/2005	Good Standing Incomplete	LCIW			
18j	Use Point	P169906W	Ur-Energy USA Inc. – WSBLC	25 N	92 W	16	NWSW	Miscellaneous	9/12/2005	Good Standing Incomplete	LCIW			
18k	Use Point	P169906W	Ur-Energy USA Inc. – WSBLC	25 N	92 W	16	SWSW	Miscellaneous	9/12/2005	Good Standing Incomplete	LCIW			
18l	Use Point	P169906W	Ur-Energy USA Inc. – WSBLC	25 N	92 W	16	SESW	Miscellaneous	9/12/2005	Good Standing Incomplete	LCIW			
18m	Use Point	P169906W	Ur-Energy USA Inc. – WSBLC	25 N	92 W	16	NESE	Miscellaneous	9/12/2005	Good Standing Incomplete	LCIW			
18n	Use Point	P169906W	Ur-Energy USA Inc. – WSBLC	25 N	92 W	16	NWSE	Miscellaneous	9/12/2005	Good Standing Incomplete	LCIW			
18o	Use Point	P169906W	Ur-Energy USA Inc. – WSBLC	25 N	92 W	16	SWSE	Miscellaneous	9/12/2005	Good Standing Incomplete	LCIW			
18p	Use Point	P169906W	Ur-Energy USA Inc. – WSBLC	25 N	92 W	16	SESE	Miscellaneous	9/12/2005	Good Standing Incomplete	LCIW			
18q	Use Point	P169906W	Ur-Energy USA Inc. – WSBLC	25 N	92 W	17	NENE	Miscellaneous	9/12/2005	Good Standing Incomplete	LCIW			
18r	Use Point	P169906W	Ur-Energy USA Inc. – WSBLC	25 N	92 W	17	NWNE	Miscellaneous	9/12/2005	Good Standing Incomplete	LCIW			
18s	Use Point	P169906W	Ur-Energy USA Inc. – WSBLC	25 N	92 W	17	SWNE	Miscellaneous	9/12/2005	Good Standing Incomplete	LCIW			
18t	Use Point	P169906W	Ur-Energy USA Inc. – WSBLC	25 N	92 W	17	SENE	Miscellaneous	9/12/2005	Good Standing Incomplete	LCIW			
18u	Use Point	P169906W	Ur-Energy USA Inc. – WSBLC	25 N	92 W	17	NENW	Miscellaneous	9/12/2005	Good Standing Incomplete	LCIW			
18v	Use Point	P169906W	Ur-Energy USA Inc. – WSBLC	25 N	92 W	17	NWNW	Miscellaneous	9/12/2005	Good Standing Incomplete	LCIW			
18w	Use Point	P169906W	Ur-Energy USA Inc. – WSBLC	25 N	92 W	17	SWNW	Miscellaneous	9/12/2005	Good Standing Incomplete	LCIW			
18x	Use Point	P169906W	Ur-Energy USA Inc. – WSBLC	25 N	92 W	17	SENW	Miscellaneous	9/12/2005	Good Standing Incomplete	LCIW			
18y	Use Point	P169906W	Ur-Energy USA Inc. – WSBLC	25 N	92 W	17	NESW	Miscellaneous	9/12/2005	Good Standing Incomplete	LCIW			
18z	Use Point	P169906W	Ur-Energy USA Inc. – WSBLC	25 N	92 W	17	NWSW	Miscellaneous	9/12/2005	Good Standing Incomplete	LCIW			
18aa	Use Point	P169906W	Ur-Energy USA Inc. – WSBLC	25 N	92 W	17	SWSW	Miscellaneous	9/12/2005	Good Standing Incomplete	LCIW			
18ab	Use Point	P169906W	Ur-Energy USA Inc. – WSBLC	25 N	92 W	17	SESW	Miscellaneous	9/12/2005	Good Standing Incomplete	LCIW			
18ac	Use Point	P169906W	Ur-Energy USA Inc. – WSBLC	25 N	92 W	17	NESE	Miscellaneous	9/12/2005	Good Standing Incomplete	LCIW			
18ad	Use Point	P169906W	Ur-Energy USA Inc. – WSBLC	25 N	92 W	17	NWSE	Miscellaneous	9/12/2005	Good Standing Incomplete	LCIW			
18ae	Use Point	P169906W	Ur-Energy USA Inc. – WSBLC	25 N	92 W	17	SWSE	Miscellaneous	9/12/2005	Good Standing Incomplete	LCIW			
18af	Use Point	P169906W	Ur-Energy USA Inc. – WSBLC	25 N	92 W	17	SESE	Miscellaneous	9/12/2005	Good Standing Incomplete	LCIW			
18ag	Use Point	P169906W	Ur-Energy USA Inc. – WSBLC	25 N	92 W	18	NENE	Miscellaneous	9/12/2005	Good Standing Incomplete	LCIW			
18ah	Use Point	P169906W	Ur-Energy USA Inc. – WSBLC	25 N	92 W	18	NWNE	Miscellaneous	9/12/2005	Good Standing Incomplete	LCIW			
18ai	Use Point	P169906W	Ur-Energy USA Inc. – WSBLC	25 N	92 W	18	SWNE	Miscellaneous	9/12/2005	Good Standing Incomplete	LCIW			
18aj	Use Point	P169906W	Ur-Energy USA Inc. – WSBLC	25 N	92 W	18	SENE	Miscellaneous	9/12/2005	Good Standing Incomplete	LCIW			
18ak	Use Point	P169906W	Ur-Energy USA Inc. – WSBLC	25 N	92 W	18	NENW	Miscellaneous	9/12/2005	Good Standing Incomplete	LCIW			
18al	Use Point	P169906W	Ur-Energy USA Inc. – WSBLC	25 N	92 W	18	NWNW	Miscellaneous	9/12/2005	Good Standing Incomplete	LCIW			
18am	Use Point	P169906W	Ur-Energy USA Inc. – WSBLC	25 N	92 W	18	SWNW	Miscellaneous	9/12/2005	Good Standing Incomplete	LCIW			
18an	Use Point	P169906W	Ur-Energy USA Inc. – WSBLC	25 N	92 W	18	SENW	Miscellaneous	9/12/2005	Good Standing Incomplete	LCIW			
18ao	Use Point	P169906W	Ur-Energy USA Inc. – WSBLC	25 N	92 W	18	NESW	Miscellaneous	9/12/2005	Good Standing Incomplete	LCIW			
18ap	Use Point	P169906W	Ur-Energy USA Inc. – WSBLC	25 N	92 W	18	NWSW	Miscellaneous	9/12/2005	Good Standing Incomplete	LCIW			
18aq	Use Point	P169906W	Ur-Energy USA Inc. – WSBLC	25 N	92 W	18	SWSW	Miscellaneous	9/12/2005	Good Standing Incomplete	LCIW			
18ar	Use Point	P169906W	Ur-Energy USA Inc. – WSBLC	25 N	92 W	18	SESW	Miscellaneous	9/12/2005	Good Standing Incomplete	LCIW			
18as	Use Point	P169906W	Ur-Energy USA Inc. – WSBLC	25 N	92 W	18	NESE	Miscellaneous	9/12/2005	Good Standing Incomplete	LCIW			

Table 2.2-2 Groundwater Use Permits (Page 4 of 8)

ID ¹	Well or Use Point	Permit Number	Applicant ²	Township	Range	Section	% of the ¼ ³	Uses	Priority	Status	Permit Facility Name	Yield ⁴	Well Depth (ft)	Static Well Depth (ft)
18at	Use Point	P169906W	Ur-Energy USA Inc. -- WSBLC	25 N	92 W	18	NWSE	Miscellaneous	9/12/2005	Good Standing Incomplete	LCIW			
18au	Use Point	P169906W	Ur-Energy USA Inc. -- WSBLC	25 N	92 W	18	SWSE	Miscellaneous	9/12/2005	Good Standing Incomplete	LCIW			
18av	Use Point	P169906W	Ur-Energy USA Inc. -- WSBLC	25 N	92 W	18	SESE	Miscellaneous	9/12/2005	Good Standing Incomplete	LCIW			
18aw	Use Point	P169906W	Ur-Energy USA Inc. -- WSBLC	25 N	92 W	19	NENE	Miscellaneous	9/12/2005	Good Standing Incomplete	LCIW			
18ax	Use Point	P169906W	Ur-Energy USA Inc. -- WSBLC	25 N	92 W	19	NWNE	Miscellaneous	9/12/2005	Good Standing Incomplete	LCIW			
18ay	Use Point	P169906W	Ur-Energy USA Inc. -- WSBLC	25 N	92 W	19	SWNE	Miscellaneous	9/12/2005	Good Standing Incomplete	LCIW			
18az	Use Point	P169906W	Ur-Energy USA Inc. -- WSBLC	25 N	92 W	19	SENE	Miscellaneous	9/12/2005	Good Standing Incomplete	LCIW			
18ba	Use Point	P169906W	Ur-Energy USA Inc. -- WSBLC	25 N	92 W	19	NENW	Miscellaneous	9/12/2005	Good Standing Incomplete	LCIW			
18bb	Use Point	P169906W	Ur-Energy USA Inc. -- WSBLC	25 N	92 W	19	NWNW	Miscellaneous	9/12/2005	Good Standing Incomplete	LCIW			
18bc	Use Point	P169906W	Ur-Energy USA Inc. -- WSBLC	25 N	92 W	19	SWNW	Miscellaneous	9/12/2005	Good Standing Incomplete	LCIW			
18bd	Use Point	P169906W	Ur-Energy USA Inc. -- WSBLC	25 N	92 W	19	SENW	Miscellaneous	9/12/2005	Good Standing Incomplete	LCIW			
18be	Use Point	P169906W	Ur-Energy USA Inc. -- WSBLC	25 N	92 W	19	NESW	Miscellaneous	9/12/2005	Good Standing Incomplete	LCIW			
18bf	Use Point	P169906W	Ur-Energy USA Inc. -- WSBLC	25 N	92 W	19	NWSW	Miscellaneous	9/12/2005	Good Standing Incomplete	LCIW			
18bg	Use Point	P169906W	Ur-Energy USA Inc. -- WSBLC	25 N	92 W	19	SWSW	Miscellaneous	9/12/2005	Good Standing Incomplete	LCIW			
18bh	Use Point	P169906W	Ur-Energy USA Inc. -- WSBLC	25 N	92 W	19	SESW	Miscellaneous	9/12/2005	Good Standing Incomplete	LCIW			
18bi	Use Point	P169906W	Ur-Energy USA Inc. -- WSBLC	25 N	92 W	20	NENE	Miscellaneous	9/12/2005	Good Standing Incomplete	LCIW			
18bj	Use Point	P169906W	Ur-Energy USA Inc. -- WSBLC	25 N	92 W	20	NWNE	Miscellaneous	9/12/2005	Good Standing Incomplete	LCIW			
18bk	Use Point	P169906W	Ur-Energy USA Inc. -- WSBLC	25 N	92 W	20	SWNE	Miscellaneous	9/12/2005	Good Standing Incomplete	LCIW			
18bl	Use Point	P169906W	Ur-Energy USA Inc. -- WSBLC	25 N	92 W	20	SENE	Miscellaneous	9/12/2005	Good Standing Incomplete	LCIW			
18bm	Use Point	P169906W	Ur-Energy USA Inc. -- WSBLC	25 N	92 W	20	NENW	Miscellaneous	9/12/2005	Good Standing Incomplete	LCIW			
18bn	Use Point	P169906W	Ur-Energy USA Inc. -- WSBLC	25 N	92 W	20	NWNW	Miscellaneous	9/12/2005	Good Standing Incomplete	LCIW			
18bo	Use Point	P169906W	Ur-Energy USA Inc. -- WSBLC	25 N	92 W	20	SWNW	Miscellaneous	9/12/2005	Good Standing Incomplete	LCIW			
18bp	Use Point	P169906W	Ur-Energy USA Inc. -- WSBLC	25 N	92 W	20	SENW	Miscellaneous	9/12/2005	Good Standing Incomplete	LCIW			
18bq	Use Point	P169906W	Ur-Energy USA Inc. -- WSBLC	25 N	92 W	30	NENW	Miscellaneous	9/12/2005	Good Standing Incomplete	LCIW			
18br	Use Point	P169906W	Ur-Energy USA Inc. -- WSBLC	25 N	92 W	30	NWNW	Miscellaneous	9/12/2005	Good Standing Incomplete	LCIW			
18bs	Use Point	P169906W	Ur-Energy USA Inc. -- WSBLC	25 N	92 W	30	SWNW	Miscellaneous	9/12/2005	Good Standing Incomplete	LCIW			
18bt	Use Point	P169906W	Ur-Energy USA Inc. -- WSBLC	25 N	92 W	30	SENW	Miscellaneous	9/12/2005	Good Standing Incomplete	LCIW			
18bu	Use Point	P169906W	Ur-Energy USA Inc. -- WSBLC	25 N	92 W	30	NESW	Miscellaneous	9/12/2005	Good Standing Incomplete	LCIW			
18bv	Use Point	P169906W	Ur-Energy USA Inc. -- WSBLC	25 N	92 W	30	NWSW	Miscellaneous	9/12/2005	Good Standing Incomplete	LCIW			
18bw	Use Point	P169906W	Ur-Energy USA Inc. -- WSBLC	25 N	92 W	30	SWSW	Miscellaneous	9/12/2005	Good Standing Incomplete	LCIW			
18bx	Use Point	P169906W	Ur-Energy USA Inc. -- WSBLC	25 N	92 W	30	SESW	Miscellaneous	9/12/2005	Good Standing Incomplete	LCIW			
18by	Use Point	P169906W	Ur-Energy USA Inc. -- WSBLC	25 N	93 W	13	NWSE	Miscellaneous	9/12/2005	Good Standing Incomplete	LCIW			
18bz	Use Point	P169906W	Ur-Energy USA Inc. -- WSBLC	25 N	93 W	13	SWSE	Miscellaneous	9/12/2005	Good Standing Incomplete	LCIW			
18ca	Use Point	P169906W	Ur-Energy USA Inc. -- WSBLC	25 N	93 W	13	SESE	Miscellaneous	9/12/2005	Good Standing Incomplete	LCIW			
18cb	Use Point	P169906W	Ur-Energy USA Inc. -- WSBLC	25 N	93 W	13	SWSW	Miscellaneous	9/12/2005	Good Standing Incomplete	LCIW			
18cc	Use Point	P169906W	Ur-Energy USA Inc. -- WSBLC	25 N	93 W	13	SESW	Miscellaneous	9/12/2005	Good Standing Incomplete	LCIW			
18cd	Use Point	P169906W	Ur-Energy USA Inc. -- WSBLC	25 N	93 W	13	NESE	Miscellaneous	9/12/2005	Good Standing Incomplete	LCIW			
18ce	Use Point	P169906W	Ur-Energy USA Inc. -- WSBLC	25 N	93 W	13	SENW	Miscellaneous	9/12/2005	Good Standing Incomplete	LCIW			
18cf	Use Point	P169906W	Ur-Energy USA Inc. -- WSBLC	25 N	93 W	13	NESW	Miscellaneous	9/12/2005	Good Standing Incomplete	LCIW			
18cg	Use Point	P169906W	Ur-Energy USA Inc. -- WSBLC	25 N	93 W	13	NWSW	Miscellaneous	9/12/2005	Good Standing Incomplete	LCIW			
18ch	Use Point	P169906W	Ur-Energy USA Inc. -- WSBLC	25 N	93 W	13	NENW	Miscellaneous	9/12/2005	Good Standing Incomplete	LCIW			
18ci	Use Point	P169906W	Ur-Energy USA Inc. -- WSBLC	25 N	93 W	13	NWNW	Miscellaneous	9/12/2005	Good Standing Incomplete	LCIW			
18cj	Use Point	P169906W	Ur-Energy USA Inc. -- WSBLC	25 N	93 W	13	SWNW	Miscellaneous	9/12/2005	Good Standing Incomplete	LCIW			
18ck	Use Point	P169906W	Ur-Energy USA Inc. -- WSBLC	25 N	93 W	13	NWNE	Miscellaneous	9/12/2005	Good Standing Incomplete	LCIW			
18cl	Use Point	P169906W	Ur-Energy USA Inc. -- WSBLC	25 N	93 W	13	SWNE	Miscellaneous	9/12/2005	Good Standing Incomplete	LCIW			
18cm	Use Point	P169906W	Ur-Energy USA Inc. -- WSBLC	25 N	93 W	13	SENE	Miscellaneous	9/12/2005	Good Standing Incomplete	LCIW			
18cn	Use Point	P169906W	Ur-Energy USA Inc. -- WSBLC	25 N	93 W	13	NENE	Miscellaneous	9/12/2005	Good Standing Incomplete	LCIW			
18co	Use Point	P169906W	Ur-Energy USA Inc. -- WSBLC	25 N	93 W	24	SESE	Miscellaneous	9/12/2005	Good Standing Incomplete	LCIW			

Table 2.2-2 Groundwater Use Permits (Page 5 of 8)

ID ¹	Well or Use Point	Permit Number	Applicant ²	Township	Range	Section	¼ of the ¼ ³	Uses	Priority	Status	Permit Facility Name	Yield ⁴	Well Depth (ft)	Static Well Depth (ft)
18cp	Use Point	P169906W	Ur-Energy USA Inc. – WSBLC	25 N	93 W	24	NESE	Miscellaneous	9/12/2005	Good Standing Incomplete	LCIW			
18cq	Use Point	P169906W	Ur-Energy USA Inc. – WSBLC	25 N	93 W	24	NWSE	Miscellaneous	9/12/2005	Good Standing Incomplete	LCIW			
18cr	Use Point	P169906W	Ur-Energy USA Inc. – WSBLC	25 N	93 W	24	SWSE	Miscellaneous	9/12/2005	Good Standing Incomplete	LCIW			
18cs	Use Point	P169906W	Ur-Energy USA Inc. – WSBLC	25 N	93 W	24	NWSW	Miscellaneous	9/12/2005	Good Standing Incomplete	LCIW			
18ct	Use Point	P169906W	Ur-Energy USA Inc. – WSBLC	25 N	93 W	24	SWSW	Miscellaneous	9/12/2005	Good Standing Incomplete	LCIW			
18cu	Use Point	P169906W	Ur-Energy USA Inc. – WSBLC	25 N	93 W	24	SESW	Miscellaneous	9/12/2005	Good Standing Incomplete	LCIW			
18cv	Use Point	P169906W	Ur-Energy USA Inc. – WSBLC	25 N	93 W	24	SWNW	Miscellaneous	9/12/2005	Good Standing Incomplete	LCIW			
18cw	Use Point	P169906W	Ur-Energy USA Inc. – WSBLC	25 N	93 W	24	SENW	Miscellaneous	9/12/2005	Good Standing Incomplete	LCIW			
18cx	Use Point	P169906W	Ur-Energy USA Inc. – WSBLC	25 N	93 W	24	NESW	Miscellaneous	9/12/2005	Good Standing Incomplete	LCIW			
18cy	Use Point	P169906W	Ur-Energy USA Inc. – WSBLC	25 N	93 W	24	SENE	Miscellaneous	9/12/2005	Good Standing Incomplete	LCIW			
18cz	Use Point	P169906W	Ur-Energy USA Inc. – WSBLC	25 N	93 W	24	NENW	Miscellaneous	9/12/2005	Good Standing Incomplete	LCIW			
18da	Use Point	P169906W	Ur-Energy USA Inc. – WSBLC	25 N	93 W	24	NWNW	Miscellaneous	9/12/2005	Good Standing Incomplete	LCIW			
18db	Use Point	P169906W	Ur-Energy USA Inc. – WSBLC	25 N	93 W	24	NENE	Miscellaneous	9/12/2005	Good Standing Incomplete	LCIW			
18dc	Use Point	P169906W	Ur-Energy USA Inc. – WSBLC	25 N	93 W	24	NWNE	Miscellaneous	9/12/2005	Good Standing Incomplete	LCIW			
18dd	Use Point	P169906W	Ur-Energy USA Inc. – WSBLC	25 N	93 W	24	SWNE	Miscellaneous	9/12/2005	Good Standing Incomplete	LCIW			
18de	Use Point	P169906W	Ur-Energy USA Inc. – WSBLC	25 N	93 W	25	SWSE	Miscellaneous	9/12/2005	Good Standing Incomplete	LCIW			
18df	Use Point	P169906W	Ur-Energy USA Inc. – WSBLC	25 N	93 W	25	SESE	Miscellaneous	9/12/2005	Good Standing Incomplete	LCIW			
18dg	Use Point	P169906W	Ur-Energy USA Inc. – WSBLC	25 N	93 W	25	SESW	Miscellaneous	9/12/2005	Good Standing Incomplete	LCIW			
18dh	Use Point	P169906W	Ur-Energy USA Inc. – WSBLC	25 N	93 W	25	NESE	Miscellaneous	9/12/2005	Good Standing Incomplete	LCIW			
18di	Use Point	P169906W	Ur-Energy USA Inc. – WSBLC	25 N	93 W	25	NWSE	Miscellaneous	9/12/2005	Good Standing Incomplete	LCIW			
18dj	Use Point	P169906W	Ur-Energy USA Inc. – WSBLC	25 N	93 W	25	NESW	Miscellaneous	9/12/2005	Good Standing Incomplete	LCIW			
18dk	Use Point	P169906W	Ur-Energy USA Inc. – WSBLC	25 N	93 W	25	NWSW	Miscellaneous	9/12/2005	Good Standing Incomplete	LCIW			
18dl	Use Point	P169906W	Ur-Energy USA Inc. – WSBLC	25 N	93 W	25	SWSW	Miscellaneous	9/12/2005	Good Standing Incomplete	LCIW			
18dm	Use Point	P169906W	Ur-Energy USA Inc. – WSBLC	25 N	93 W	25	NWNW	Miscellaneous	9/12/2005	Good Standing Incomplete	LCIW			
18dn	Use Point	P169906W	Ur-Energy USA Inc. – WSBLC	25 N	93 W	25	SWNW	Miscellaneous	9/12/2005	Good Standing Incomplete	LCIW			
18do	Use Point	P169906W	Ur-Energy USA Inc. – WSBLC	25 N	93 W	25	SENW	Miscellaneous	9/12/2005	Good Standing Incomplete	LCIW			
18dp	Use Point	P169906W	Ur-Energy USA Inc. – WSBLC	25 N	93 W	25	SWNE	Miscellaneous	9/12/2005	Good Standing Incomplete	LCIW			
18dq	Use Point	P169906W	Ur-Energy USA Inc. – WSBLC	25 N	93 W	25	SENE	Miscellaneous	9/12/2005	Good Standing Incomplete	LCIW			
18dr	Use Point	P169906W	Ur-Energy USA Inc. – WSBLC	25 N	93 W	25	NENW	Miscellaneous	9/12/2005	Good Standing Incomplete	LCIW			
18ds	Use Point	P169906W	Ur-Energy USA Inc. – WSBLC	25 N	93 W	25	NENE	Miscellaneous	9/12/2005	Good Standing Incomplete	LCIW			
18dt	Use Point	P169906W	Ur-Energy USA Inc. – WSBLC	25 N	93 W	25	NWNE	Miscellaneous	9/12/2005	Good Standing Incomplete	LCIW			
18du	Use Point	P169906W	Ur-Energy USA Inc. – WSBLC	25 N	93 W	36	NWNW	Miscellaneous	9/12/2005	Good Standing Incomplete	LCIW			
18dv	Use Point	P169906W	Ur-Energy USA Inc. – WSBLC	25 N	93 W	36	NENW	Miscellaneous	9/12/2005	Good Standing Incomplete	LCIW			
18dw	Use Point	P169906W	Ur-Energy USA Inc. – WSBLC	25 N	93 W	36	NWNE	Miscellaneous	9/12/2005	Good Standing Incomplete	LCIW			
18dx	Use Point	P169906W	Ur-Energy USA Inc. – WSBLC	25 N	93 W	36	NENE	Miscellaneous	9/12/2005	Good Standing Incomplete	LCIW			
19	Well	P175260W	NFU Wyoming LLC and BLM	25 N	92 W	20	NWNW	Monitoring, Test Well	6/9/2006	Good Standing Incomplete	LC15M	LCS	350	160.8
20	Well	P175260W	NFU Wyoming LLC and BLM	25 N	92 W	20	NWNW	Monitoring, Test Well	6/9/2006	Good Standing Incomplete	LC16M	LCS	472	178.14
21	Well	P175260W	NFU Wyoming LLC and BLM	25 N	92 W	20	NWNW	Monitoring, Test Well	6/9/2006	Good Standing Incomplete	LC17M	LCS	575	185.26
22	Well	P175260W	NFU Wyoming LLC and BLM	25 N	92 W	20	NWNW	Monitoring, Test Well	6/9/2006	Good Standing Incomplete	LC29M	LCS	171	153.95
23	Well	P175261W	NFU Wyoming LLC and BLM	25 N	92 W	18	SESE	Monitoring, Test Well	6/9/2006	Good Standing Incomplete	LC18M	LCS	350	168.04
24	Well	P175261W	NFU Wyoming LLC and BLM	25 N	92 W	18	SESE	Monitoring, Test Well	6/9/2006	Good Standing Incomplete	LC19M	LCS	463	180.08
25	Well	P175261W	NFU Wyoming LLC and BLM	25 N	92 W	18	SESE	Monitoring, Test Well	6/9/2006	Good Standing Incomplete	LC20M	LCS	543	202.36
26	Well	P175262W	NFU Wyoming LLC and BLM	25 N	93 W	24	SWNE	Monitoring, Test Well	6/9/2006	Good Standing Incomplete	LC21M	LCS	410	198.2
27	Well	P175262W	NFU Wyoming LLC and BLM	25 N	93 W	24	SWNE	Monitoring, Test Well	6/9/2006	Good Standing Incomplete	LC22M	LCS	592	206.73
28	Well	P175262W	NFU Wyoming LLC and BLM	25 N	93 W	24	SWNE	Monitoring, Test Well	6/9/2006	Good Standing Incomplete	LC23M	LCS	634	220.75
29	Well	P175262W	NFU Wyoming LLC and BLM	25 N	93 W	24	SWNE	Monitoring, Test Well	6/9/2006	Good Standing Incomplete	LC30M	LCS	236	198.91
30	Well	P175263W	NFU Wyoming LLC and BLM	25 N	92 W	17	SWSW	Monitoring	6/9/2006	Good Standing Incomplete	LC24M	LCS	542	192.11
31	Well	P175264W	NFU Wyoming LLC and BLM	25 N	92 W	19	NENE	Monitoring	6/9/2006	Good Standing Incomplete	LC25M	LCS	380	167.05

Table 2.2-2 Groundwater Use Permits (Page 6 of 8)

ID ¹	Well or Use Point	Permit Number	Applicant ²	Township	Range	Section	¼ of the ¼ ³	Uses	Priority	Status	Permit Facility Name	Yield ⁴	Well Depth (ft)	Static Well Depth (ft)
32	Well	P175265W	NFU Wyoming LLC and BLM	25 N	92 W	20	NENE	Monitoring	6/9/2006	Good Standing Incomplete	LC26M	LCS	436	171.1
33	Well	P175266W	NFU Wyoming LLC and BLM	25 N	92 W	16	SENE	Monitoring	6/9/2006	Good Standing Incomplete	LC27M	LCS	477	189.8
34	Well	P175267W	NFU Wyoming LLC and BLM	25 N	93 W	25	SWSW	Monitoring	6/9/2006	Good Standing Incomplete	LC28M	LCS	563	154.45
35	Well	P175268W	NFU Wyoming LLC and BLM	25 N	93 W	25	SWSW	Monitoring	6/9/2006	Good Standing Incomplete	LC31M	LCS	191	144.01
36	Well	P179826W	Lost Creek ISR LLC	25 N	92 W	17	NWSE	Miscellaneous	2/28/2007	Good Standing Incomplete	LC 32W	LCS	LCS	LCS
37	Well	P179827W	Lost Creek ISR LLC	25 N	92 W	20	NENE	Miscellaneous	2/28/2007	Good Standing Incomplete	LC 33W	LCS	LCS	LCS
38	Well	P179856W	NFU Wyoming LLC	25 N	92 W	19	NENE	Monitoring	3/1/2007	Good Standing Incomplete	HJT 101	LCS	LCS	LCS
39	Well	P179857W	NFU Wyoming LLC	25 N	92 W	19	NENE	Monitoring	3/1/2007	Good Standing Incomplete	HJT 102	LCS	LCS	LCS
40	Well	P179858W	NFU Wyoming LLC	25 N	92 W	19	NENE	Monitoring	3/1/2007	Good Standing Incomplete	HJT 103	LCS	LCS	LCS
41	Well	P179859W	NFU Wyoming LLC	25 N	92 W	20	NWNW	Monitoring	3/1/2007	Good Standing Incomplete	HJT 104	LCS	460	169.51
42	Well	P179860W	NFU Wyoming LLC	25 N	92 W	20	NWNW	Monitoring	3/1/2007	Good Standing Incomplete	HJT 105	LCS	LCS	LCS
43	Well	P179861W	NFU Wyoming LLC	25 N	92 W	20	NWNW	Monitoring	3/1/2007	Good Standing Incomplete	HJT 106	LCS	LCS	LCS
44	Well	P179862W	NFU Wyoming LLC	25 N	92 W	20	NENE	Monitoring	3/1/2007	Good Standing Incomplete	HJT 107	LCS	LCS	LCS
45	Well	P179863W	NFU Wyoming LLC	25 N	92 W	19	NENE	Monitoring	3/1/2007	Good Standing Incomplete	HJMV-101	LCS	LCS	LCS
46	Well	P179864W	NFU Wyoming LLC	25 N	92 W	19	NENE	Monitoring	3/1/2007	Good Standing Incomplete	HJMP-101	LCS	LCS	LCS
47	Well	P179865W	NFU Wyoming LLC	25 N	92 W	19	NENE	Monitoring	3/1/2007	Good Standing Incomplete	HJMO-101	LCS	LCS	LCS
48	Well	P179866W	NFU Wyoming LLC	25 N	92 W	19	NENE	Monitoring	3/1/2007	Good Standing Incomplete	HJMV-102	LCS	LCS	LCS
49	Well	P179867W	NFU Wyoming LLC	25 N	92 W	19	NENE	Monitoring	3/1/2007	Good Standing Incomplete	HJMP-102	LCS	LCS	LCS
50	Well	P179868W	NFU Wyoming LLC	25 N	92 W	19	NENE	Monitoring	3/1/2007	Good Standing Incomplete	HJMO-102	LCS	LCS	LCS
51	Well	P179869W	NFU Wyoming LLC	25 N	92 W	18	SESE	Monitoring	3/1/2007	Good Standing Incomplete	HJMV-103	LCS	LCS	LCS
52	Well	P179870W	NFU Wyoming LLC	25 N	92 W	18	SESE	Monitoring	3/1/2007	Good Standing Incomplete	HJMP-103	LCS	LCS	LCS
53	Well	P179871W	NFU Wyoming LLC	25 N	92 W	18	SESE	Monitoring	3/1/2007	Good Standing Incomplete	HJMO-103	LCS	LCS	LCS
54	Well	P179872W	NFU Wyoming LLC	25 N	92 W	19	NENE	Monitoring	3/1/2007	Good Standing Incomplete	HJMV-104	LCS	LCS	LCS
55	Well	P179873W	NFU Wyoming LLC	25 N	92 W	19	NENE	Monitoring	3/1/2007	Good Standing Incomplete	HJMP-104	LCS	430	171.81
56	Well	P179874W	NFU Wyoming LLC	25 N	92 W	19	NENE	Monitoring	3/1/2007	Good Standing Incomplete	HJMO-104	LCS	LCS	LCS
57	Well	P179875W	NFU Wyoming LLC	25 N	92 W	19	NENE	Monitoring	3/1/2007	Good Standing Incomplete	HJMV-105	LCS	LCS	LCS
58	Well	P179876W	NFU Wyoming LLC	25 N	92 W	19	NENE	Monitoring	3/1/2007	Good Standing Incomplete	HJMP-105	LCS	LCS	LCS
59	Well	P179877W	NFU Wyoming LLC	25 N	92 W	19	NENE	Monitoring	3/1/2007	Good Standing Incomplete	HJMO-105	LCS	LCS	LCS
60	Well	P179878W	NFU Wyoming LLC	25 N	92 W	18	SESE	Monitoring	3/1/2007	Good Standing Incomplete	HJMV-106	LCS	LCS	LCS
61	Well	P179879W	NFU Wyoming LLC	25 N	92 W	18	SESE	Monitoring	3/1/2007	Good Standing Incomplete	HJMP-106	LCS	LCS	LCS
62	Well	P179880W	NFU Wyoming LLC	25 N	92 W	18	SESE	Monitoring	3/1/2007	Good Standing Incomplete	HJMO-106	LCS	LCS	LCS
63	Well	P179881W	NFU Wyoming LLC	25 N	92 W	19	NENE	Monitoring	3/1/2007	Good Standing Incomplete	HJMV-107	LCS	LCS	LCS
64	Well	P179882W	NFU Wyoming LLC	25 N	92 W	19	NENE	Monitoring	3/1/2007	Good Standing Incomplete	HJMP-107	LCS	464	183.61
65	Well	P179883W	NFU Wyoming LLC	25 N	92 W	19	NENE	Monitoring	3/1/2007	Good Standing Incomplete	HJMO-107	LCS	LCS	LCS
66	Well	P179884W	NFU Wyoming LLC	25 N	92 W	18	SESE	Monitoring	3/1/2007	Good Standing Incomplete	HJMV-108	LCS	LCS	LCS
67	Well	P179885W	NFU Wyoming LLC	25 N	92 W	18	SESE	Monitoring	3/1/2007	Good Standing Incomplete	HJMP-108	LCS	LCS	LCS
68	Well	P179886W	NFU Wyoming LLC	25 N	92 W	18	SESE	Monitoring	3/1/2007	Good Standing Incomplete	HJMO-108	LCS	LCS	LCS
69	Well	P179887W	NFU Wyoming LLC	25 N	92 W	20	NWNW	Monitoring	3/1/2007	Good Standing Incomplete	HJMV-109	LCS	LCS	LCS
70	Well	P179888W	NFU Wyoming LLC	25 N	92 W	20	NWNW	Monitoring	3/1/2007	Good Standing Incomplete	HJMP-109	LCS	LCS	LCS
71	Well	P179889W	NFU Wyoming LLC	25 N	92 W	20	NWNW	Monitoring	3/1/2007	Good Standing Incomplete	HJMO-109	LCS	LCS	LCS
72	Well	P179890W	NFU Wyoming LLC	25 N	92 W	20	NWNW	Monitoring	3/1/2007	Good Standing Incomplete	HJMV-110	LCS	LCS	LCS
73	Well	P179891W	NFU Wyoming LLC	25 N	92 W	20	NWNW	Monitoring	3/1/2007	Good Standing Incomplete	HJMP-110	LCS	476	174.89
74	Well	P179892W	NFU Wyoming LLC	25 N	92 W	20	NWNW	Monitoring	3/1/2007	Good Standing Incomplete	HJMO-110	LCS	LCS	LCS
75	Well	P179893W	NFU Wyoming LLC	25 N	92 W	17	SWSW	Monitoring	3/1/2007	Good Standing Incomplete	HJMV-111	LCS	LCS	LCS
76	Well	P179894W	NFU Wyoming LLC	25 N	92 W	17	SWSW	Monitoring	3/1/2007	Good Standing Incomplete	HJMP-111	LCS	440	176.94
77	Well	P179895W	NFU Wyoming LLC	25 N	92 W	17	SWSW	Monitoring	3/1/2007	Good Standing Incomplete	HJMO-111	LCS	LCS	LCS
78	Well	P179896W	NFU Wyoming LLC	25 N	92 W	20	NWNW	Monitoring	3/1/2007	Good Standing Incomplete	HJMV-112	LCS	LCS	LCS
79	Well	P179897W	NFU Wyoming LLC	25 N	92 W	20	NWNW	Monitoring	3/1/2007	Good Standing Incomplete	HJMP-112	LCS	LCS	LCS

Table 2.2-2 Groundwater Use Permits (Page 7 of 8)



ID ¹	Well or Use Point	Permit Number	Applicant ²	Township	Range	Section	% of the % ³	Uses	Priority	Status	Permit Facility Name	Yield ⁴	Well Depth (ft)	Static Well Depth (ft)
80	Well	P179898W	NFU Wyoming LLC	25 N	92 W	20	NWNW	Monitoring	3/1/2007	Good Standing Incomplete	HJMO-112	LCS	LCS	LCS
81	Well	P179899W	NFU Wyoming LLC	25 N	92 W	20	NWNW	Monitoring	3/1/2007	Good Standing Incomplete	HJMV-113	LCS	LCS	LCS
82	Well	P179900W	NFU Wyoming LLC	25 N	92 W	20	NWNW	Monitoring	3/1/2007	Good Standing Incomplete	HJMP-113	LCS	LCS	LCS
83	Well	P179901W	NFU Wyoming LLC	25 N	92 W	20	NWNW	Monitoring	3/1/2007	Good Standing Incomplete	HJMO-113	LCS	LCS	LCS
84	Well	P179902W	NFU Wyoming LLC	25 N	92 W	20	NENW	Monitoring	3/1/2007	Good Standing Incomplete	HJMV-114	LCS	LCS	LCS
85	Well	P179903W	NFU Wyoming LLC	25 N	92 W	20	NENE	Monitoring	3/1/2007	Good Standing Incomplete	HJMP-114	LCS	LCS	LCS
86	Well	P179904W	NFU Wyoming LLC	25 N	92 W	20	NENW	Monitoring	3/1/2007	Good Standing Incomplete	HJMO-114	LCS	LCS	LCS
87	Well	P179905W	NFU Wyoming LLC	25 N	92 W	20	NWNW	Monitoring	3/1/2007	Good Standing Incomplete	UKMU-101	LCS	LCS	LCS
88	Well	P179906W	NFU Wyoming LLC	25 N	92 W	20	NWNW	Monitoring	3/1/2007	Good Standing Incomplete	UKMP-101	LCS	575	192.13
89	Well	P179907W	NFU Wyoming LLC	25 N	92 W	20	NWNW	Monitoring	3/1/2007	Good Standing Incomplete	UKMO-101	LCS	LCS	LCS
90	Well	P179908W	NFU Wyoming LLC	25 N	92 W	17	SWSW	Monitoring	3/1/2007	Good Standing Incomplete	UKMU-102	LCS	LCS	LCS
91	Well	P179909W	NFU Wyoming LLC	25 N	92 W	17	SWSW	Monitoring	3/1/2007	Good Standing Incomplete	UKMP-102	LCS	498	190.68
92	Well	P179910W	NFU Wyoming LLC	25 N	92 W	17	SWSW	Monitoring	3/1/2007	Good Standing Incomplete	UKMO-102	LCS	LCS	LCS
93	Well	P179911W	NFU Wyoming LLC	25 N	92 W	17	SWSW	Monitoring	3/1/2007	Good Standing Incomplete	UKMU-103	LCS	LCS	LCS
94	Well	P179912W	NFU Wyoming LLC	25 N	92 W	17	SWSW	Monitoring	3/1/2007	Good Standing Incomplete	UKMP-103	LCS	LCS	LCS
95	Well	P179913W	NFU Wyoming LLC	25 N	92 W	17	SWSW	Monitoring	3/1/2007	Good Standing Incomplete	UKMP-103	LCS	LCS	LCS
96	Well	41/1/163W	Ur-Energy USA Inc.	25 N	92 W	19	SWNE	Monitoring	7/3/2008	Unadjudicated	SWNE19M	LCS	LCS	LCS
97	Well	41/1/284W	Lost Creek ISR LLC	25 N	93 W	13	NWSE	Monitoring	9/26/2008	Unadjudicated	MB-03	LCS	LCS	LCS
98	Well	41/10/162W	Ur-Energy USA Inc.	25 N	92 W	19	NWNE	Monitoring	7/3/2008	Unadjudicated	NWNE19M	LCS	LCS	LCS
99	Well	41/10/163W	Ur-Energy USA Inc.	25 N	92 W	20	NWNW	Monitoring	7/3/2008	Unadjudicated	NWNW20PW	LCS	LCS	LCS
100	Well	41/10/283W	Lost Creek ISR LLC	25 N	93 W	13	NWSE	Monitoring	9/26/2008	Unadjudicated	MB-02	LCS	LCS	LCS
101	Well	41/2/162W	Ur-Energy USA Inc.	25 N	92 W	18	SESW	Monitoring	7/3/2008	Unadjudicated	SESW18M	LCS	LCS	LCS
102	Well	41/2/163W	Ur-Energy USA Inc.	25 N	92 W	19	NENW	Monitoring	7/3/2008	Unadjudicated	NENW19M	LCS	LCS	LCS
103	Well	41/2/284W	Lost Creek ISR LLC	25 N	93 W	13	NWSE	Monitoring	9/26/2008	Unadjudicated	MB-04	LCS	LCS	LCS
104	Well	41/3/162W	Ur-Energy USA Inc.	25 N	92 W	18	SWSE	Monitoring	7/3/2008	Unadjudicated	SWSE18M	LCS	LCS	LCS
105	Well	41/3/163W	Ur-Energy USA Inc.	25 N	92 W	19	NWNE	Monitoring	7/3/2008	Unadjudicated	NWNE19MU	LCS	LCS	LCS
106	Well	41/3/213W	NFU Wyoming LLC	25 N	93 W	25	SWSW	Miscellaneous	7/29/2008	Unadjudicated	LC 28M	LCS	LCS	LCS
107	Well	41/3/284W	Lost Creek ISR LLC	25 N	93 W	25	SWSW	Monitoring	9/26/2008	Unadjudicated	MB-05	LCS	LCS	LCS
108	Well	41/4/162W	Ur-Energy USA Inc.	25 N	92 W	18	SESE	Monitoring	7/3/2008	Unadjudicated	SESE18M	LCS	LCS	LCS
109	Well	41/4/163W	Ur-Energy USA Inc.	25 N	92 W	19	NWNE	Monitoring	7/3/2008	Unadjudicated	NWNE19MO	LCS	LCS	LCS
110	Well	41/4/284W	Lost Creek ISR LLC	25 N	93 W	25	SWSW	Monitoring	9/26/2008	Unadjudicated	MB-06	LCS	LCS	LCS
111	Well	41/5/162W	Ur-Energy USA Inc.	25 N	92 W	17	SWSW	Monitoring	7/3/2008	Unadjudicated	SWSW17M	LCS	LCS	LCS
112	Well	41/5/163W	Ur-Energy USA Inc.	25 N	92 W	19	NWNE	Monitoring	7/3/2008	Unadjudicated	NWNE19MP	LCS	LCS	LCS
113	Well	41/5/284W	Lost Creek ISR LLC	25 N	92 W	16	SENE	Monitoring	9/26/2008	Unadjudicated	MB-07	LCS	LCS	LCS
114	Well	41/5/294W	Lost Creek ISR LLC	25 N	93 W	25	SWSW	Monitoring	10/9/2008	Unadjudicated	Deep Well No. 1	LCS	LCS	LCS
115	Well	41/5/35W	Lost Creek ISR LLC	25 N	92 W	17	NWSE	Miscellaneous	4/8/2008	Unadjudicated	ENL LC 32W	LCS	LCS	LCS
116	Well	41/6/162W	Ur-Energy USA Inc.	25 N	92 W	17	SESW	Monitoring	7/3/2008	Unadjudicated	SESW17M	LCS	LCS	LCS
117	Well	41/6/163W	Ur-Energy USA Inc.	25 N	92 W	20	NENW	Monitoring	7/3/2008	Unadjudicated	NENW20MU	LCS	LCS	LCS
118	Well	41/6/284W	Lost Creek ISR LLC	25 N	92 W	16	SENE	Monitoring	9/26/2008	Unadjudicated	MB-08	LCS	LCS	LCS
119	Well	41/6/35W	Lost Creek ISR LLC	25 N	92 W	20	NENE	Miscellaneous	4/8/2008	Unadjudicated	ENL LC 33W	LCS	LCS	LCS
120	Well	41/7/162W	Ur-Energy USA Inc.	25 N	92 W	20	NENW	Monitoring	7/3/2008	Unadjudicated	NENW20M	LCS	LCS	LCS
121	Well	41/7/163W	Ur-Energy USA Inc.	25 N	92 W	20	NENW	Monitoring	7/3/2008	Unadjudicated	NENW20MO	LCS	LCS	LCS
122	Well	41/7/284W	Lost Creek ISR LLC	25 N	92 W	16	SENE	Monitoring	9/26/2008	Unadjudicated	MB-09	LCS	LCS	LCS
123	Well	41/7/2W	Lost Creek ISR LLC	25 N	93 W	24	NENW	Miscellaneous	3/19/2008	Unadjudicated	ENL LC1W	LCS	LCS	LCS
124	Well	41/8/162W	Ur-Energy USA Inc.	25 N	92 W	20	NWNW	Monitoring	7/3/2008	Unadjudicated	NWNW20M	LCS	LCS	LCS
125	Well	41/8/163W	Ur-Energy USA Inc.	25 N	92 W	20	NENW	Monitoring	7/3/2008	Unadjudicated	NENW20MP	LCS	LCS	LCS
126	Well	41/8/284W	Lost Creek ISR LLC	25 N	92 W	18	SESE	Monitoring	9/26/2008	Unadjudicated	MB-10	LCS	LCS	LCS
127	Well	41/8/2W	Lost Creek ISR LLC	25 N	92 W	18	SWNE	Miscellaneous	3/19/2008	Unadjudicated	LC229W	LCS	LCS	LCS

Table 2.2-2 Groundwater Use Permits (Page 8 of 8)

ID ¹	Well or Use Point	Permit Number	Applicant ²	Township	Range	Section	¼ of the ³	Uses	Priority	Status	Permit Facility Name	Yield ⁴	Well Depth (ft)	Static Well Depth (ft)
128	Well	41/9/162W	Ur-Energy USA Inc.	25 N	92 W	19	NENE	Monitoring	7/3/2008	Unadjudicated	NENE19M	LCS	LCS	LCS
129	Well	41/9/163W	Ur-Energy USA Inc.	25 N	92 W	18	SESE	Monitoring	7/3/2008	Unadjudicated	SESE18PW	LCS	LCS	LCS
130	Well	41/9/283W	Lost Creek ISR LLC	25 N	93 W	13	NWSE	Monitoring	9/26/2008	Unadjudicated	MB-01	LCS	LCS	LCS
131	Well	⁵	USDI BLM, Rawlins District	25 N	93 W	13	NWNW	Stock			East Eagle Nest Draw Well	5 gpm	370	269

* WSEO, 2006

¹ Each number represents a well. A number followed by a letter(s) is a point of use related to the well.

-  = Well within two miles of the Permit Area.
-  = Well more than two miles from the Permit Area. However, points of use related to the well are within two miles of the Permit Area.B309
-  = Point of use within two miles of the Permit Area.

² USDI BLM = United States Department of Interior's Bureau of Land Management; WSBLC = Wyoming State Board of Land Commissioners

³ INP = Information not provided by the online WSEO database.

⁴ LCS = Part of the on-going Lost Creek Project study. Information will be provided when it becomes available.

Table 2.2-3 Abandoned and Cancelled Wells General Disclaimer

The data contained herein are provided AS IS and IN NO EVENT SHALL the State of Wyoming, its agencies or representatives, be LIABLE for any DAMAGES including, without limitation, damages resulting from lost data or profits or revenue the costs of recovering such data, the cost of substitute data, computer repair or replacement costs, claims by third parties for similar costs, or any special, direct or indirect, incidental, punitive or consequential damages of any kind whatsoever, arising out of the use of these data. The accuracy or reliability of the data IS NOT GUARANTEED or WARRANTED in any way and the State of Wyoming, its agencies or representatives, EXPRESSLY DISCLAIM LIABILITY, whether expressed or implied, or of any kind whatsoever, including, without limitation, liability for QUALITY, PERFORMANCE, MERCHANTABILITY AND FITNESS FOR THE PARTICULAR PURPOSE arising from the use of the data, NEITHER the State of Wyoming, NOR its agencies or representatives, including the State Engineer's Office, REPRESENT or ENDORSE the ACCURACY or RELIABILITY OF ANY INFORMATION contained in the database, as some of the data are provided by permit applicants and may not have been verified by the State of Wyoming, its agencies or representatives. The State of Wyoming, its agencies and representatives RESERVE THE RIGHT, at their sole discretion, WITHOUT OBLIGATION, to MODIFY, ADD OR REMOVE all or portions of the data, at any time, WITH OR WITHOUT NOTICE. This includes the correction of errors or omissions within the database. All data or information provided by the Wyoming State Engineer's Office shall be used and relied upon only at the USER'S SOLE RISK, and the user agrees to indemnify and hold harmless the State of Wyoming, its agencies or representatives, including the Wyoming State Engineer's Office, and its officials, officers, and employees, from any liability arising out of the use or distribution of these data.

Definitions

- **Abandoned:** The loss of a water right based on the non-use of that water right when water was available for a period of five consecutive years, or the voluntary relinquishment of an adjudicated water right.
- **Cancelled:**
 - A temporary use permit issued for a limited time, after which the permit is cancelled; or
 - A permit or certificate that has been issued by the state engineer or the board of control, in which the provisions of the permit or certificate were found willfully violated.

* Wyoming State Engineer's Office (WSEO). 2006. Documents. Available from: <http://seo.state.wy.us/docs.aspx>. Accessed on 11 December 2008.

Table 2.2-3 Abandoned and Cancelled Wells (Page 1 of 4)

Last Revised December 2008

ID ¹	Well or Use Point	Permit Number	Applicant ²	Township	Range	Section	¼ of the ¼	Uses	Priority	Status	Permit Facility Name	Yield ³	Well Depth (ft)	Static Well Depth (ft)
1	Well	P35721W	USDI, BLM -- Texasgulf Inc.	25 N	93 W	14	SWSE	Stock, Miscellaneous	28102	Abandoned	TE 24	25 gpm		
1a	Use Point	P35721W	USDI, BLM -- Texasgulf Inc.	25 N	93 W	12	SESE	Stock, Miscellaneous	28102	Abandoned	TE 24			
1b	Use Point	P35721W	USDI, BLM -- Texasgulf Inc.	25 N	93 W	12	NESE	Stock, Miscellaneous	28102	Abandoned	TE 24			
1c	Use Point	P35721W	USDI, BLM -- Texasgulf Inc.	25 N	93 W	12	NWSE	Stock, Miscellaneous	28102	Abandoned	TE 24			
1d	Use Point	P35721W	USDI, BLM -- Texasgulf Inc.	25 N	93 W	12	SWSE	Stock, Miscellaneous	28102	Abandoned	TE 24			
1e	Use Point	P35721W	USDI, BLM -- Texasgulf Inc.	25 N	93 W	13	SWSE	Stock, Miscellaneous	28102	Abandoned	TE 24			
1f	Use Point	P35721W	USDI, BLM -- Texasgulf Inc.	25 N	93 W	13	SESE	Stock, Miscellaneous	28102	Abandoned	TE 24			
1g	Use Point	P35721W	USDI, BLM -- Texasgulf Inc.	25 N	93 W	13	SESW	Stock, Miscellaneous	28102	Abandoned	TE 24			
1h	Use Point	P35721W	USDI, BLM -- Texasgulf Inc.	25 N	93 W	13	NESE	Stock, Miscellaneous	28102	Abandoned	TE 24			
1i	Use Point	P35721W	USDI, BLM -- Texasgulf Inc.	25 N	93 W	13	NWSE	Stock, Miscellaneous	28102	Abandoned	TE 24			
1j	Use Point	P35721W	USDI, BLM -- Texasgulf Inc.	25 N	93 W	13	NESW	Stock, Miscellaneous	28102	Abandoned	TE 24			
1k	Use Point	P35721W	USDI, BLM -- Texasgulf Inc.	25 N	93 W	13	NWSW	Stock, Miscellaneous	28102	Abandoned	TE 24			
1l	Use Point	P35721W	USDI, BLM -- Texasgulf Inc.	25 N	93 W	13	SWSW	Stock, Miscellaneous	28102	Abandoned	TE 24			
1m	Use Point	P35721W	USDI, BLM -- Texasgulf Inc.	25 N	93 W	13	NWNE	Stock, Miscellaneous	28102	Abandoned	TE 24			
1n	Use Point	P35721W	USDI, BLM -- Texasgulf Inc.	25 N	93 W	13	SWNE	Stock, Miscellaneous	28102	Abandoned	TE 24			
1o	Use Point	P35721W	USDI, BLM -- Texasgulf Inc.	25 N	93 W	13	SENE	Stock, Miscellaneous	28102	Abandoned	TE 24			
1p	Use Point	P35721W	USDI, BLM -- Texasgulf Inc.	25 N	93 W	13	NENE	Stock, Miscellaneous	28102	Abandoned	TE 24			
1q	Use Point	P35721W	USDI, BLM -- Texasgulf Inc.	25 N	93 W	14	SWSE	Stock, Miscellaneous	28102	Abandoned	TE 24			
1r	Use Point	P35721W	USDI, BLM -- Texasgulf Inc.	25 N	93 W	14	SESE	Stock, Miscellaneous	28102	Abandoned	TE 24			
1s	Use Point	P35721W	USDI, BLM -- Texasgulf Inc.	25 N	93 W	14	SESW	Stock, Miscellaneous	28102	Abandoned	TE 24			
1t	Use Point	P35721W	USDI, BLM -- Texasgulf Inc.	25 N	93 W	14	NESE	Stock, Miscellaneous	28102	Abandoned	TE 24			
1u	Use Point	P35721W	USDI, BLM -- Texasgulf Inc.	25 N	93 W	14	NWSE	Stock, Miscellaneous	28102	Abandoned	TE 24			
1v	Use Point	P35721W	USDI, BLM -- Texasgulf Inc.	25 N	93 W	14	NESW	Stock, Miscellaneous	28102	Abandoned	TE 24			
1w	Use Point	P35721W	USDI, BLM -- Texasgulf Inc.	25 N	93 W	14	NWSW	Stock, Miscellaneous	28102	Abandoned	TE 24			
1x	Use Point	P35721W	USDI, BLM -- Texasgulf Inc.	25 N	93 W	14	SWSW	Stock, Miscellaneous	28102	Abandoned	TE 24			
1y	Use Point	P35721W	USDI, BLM -- Texasgulf Inc.	25 N	93 W	23	SWNW	Stock, Miscellaneous	28102	Abandoned	TE 24			
1z	Use Point	P35721W	USDI, BLM -- Texasgulf Inc.	25 N	93 W	23	SENW	Stock, Miscellaneous	28102	Abandoned	TE 24			
1aa	Use Point	P35721W	USDI, BLM -- Texasgulf Inc.	25 N	93 W	23	SENE	Stock, Miscellaneous	28102	Abandoned	TE 24			
1ab	Use Point	P35721W	USDI, BLM -- Texasgulf Inc.	25 N	93 W	23	NENW	Stock, Miscellaneous	28102	Abandoned	TE 24			
1ac	Use Point	P35721W	USDI, BLM -- Texasgulf Inc.	25 N	93 W	23	NWNW	Stock, Miscellaneous	28102	Abandoned	TE 24			
1ad	Use Point	P35721W	USDI, BLM -- Texasgulf Inc.	25 N	93 W	23	NENE	Stock, Miscellaneous	28102	Abandoned	TE 24			
1ae	Use Point	P35721W	USDI, BLM -- Texasgulf Inc.	25 N	93 W	23	NWNE	Stock, Miscellaneous	28102	Abandoned	TE 24			
1af	Use Point	P35721W	USDI, BLM -- Texasgulf Inc.	25 N	93 W	23	SWNE	Stock, Miscellaneous	28102	Abandoned	TE 24			
1ag	Use Point	P35721W	USDI, BLM -- Texasgulf Inc.	25 N	93 W	24	NWNW	Stock, Miscellaneous	28102	Abandoned	TE 24			
1ah	Use Point	P35721W	USDI, BLM -- Texasgulf Inc.	25 N	93 W	24	SWNW	Stock, Miscellaneous	28102	Abandoned	TE 24			
1ai	Use Point	P35721W	USDI, BLM -- Texasgulf Inc.	25 N	93 W	24	SENW	Stock, Miscellaneous	28102	Abandoned	TE 24			
1aj	Use Point	P35721W	USDI, BLM -- Texasgulf Inc.	25 N	93 W	24	SWNE	Stock, Miscellaneous	28102	Abandoned	TE 24			
1ak	Use Point	P35721W	USDI, BLM -- Texasgulf Inc.	25 N	93 W	24	SENE	Stock, Miscellaneous	28102	Abandoned	TE 24			
1al	Use Point	P35721W	USDI, BLM -- Texasgulf Inc.	25 N	93 W	24	NENW	Stock, Miscellaneous	28102	Abandoned	TE 24			
1am	Use Point	P35721W	USDI, BLM -- Texasgulf Inc.	25 N	93 W	24	NENE	Stock, Miscellaneous	28102	Abandoned	TE 24			
1an	Use Point	P35721W	USDI, BLM -- Texasgulf Inc.	25 N	93 W	24	NWNE	Stock, Miscellaneous	28102	Abandoned	TE 24			
2	Well	P37637W	USDI, BLM -- Texasgulf Inc.	25 N	93 W	24	NENW	Miscellaneous	28250	Cancelled	TE 38	25 gpm	380	220
2a	Use Point	P37637W	USDI, BLM -- Texasgulf Inc.	25 N	93 W	12	SWSE	Miscellaneous	28250	Cancelled	TE 38			
2b	Use Point	P37637W	USDI, BLM -- Texasgulf Inc.	25 N	93 W	12	SESE	Miscellaneous	28250	Cancelled	TE 38			
2c	Use Point	P37637W	USDI, BLM -- Texasgulf Inc.	25 N	93 W	12	NESE	Miscellaneous	28250	Cancelled	TE 38			

Table 2.2-3 Abandoned and Cancelled Wells (Page 2 of 4)

ID ¹	Well or Use Point	Permit Number	Applicant ²	Township	Range	Section	% of the %	Uses	Priority	Status	Permit Facility Name	Yield ³	Well Depth (ft)	Static Well Depth (ft)
2d	Use Point	P37637W	USDI, BLM -- Texasgulf Inc.	25 N	93 W	12	NWSE	Miscellaneous	28250	Cancelled	TE 38			
2e	Use Point	P37637W	USDI, BLM -- Texasgulf Inc.	25 N	93 W	13	NWSE	Miscellaneous	28250	Cancelled	TE 38			
2f	Use Point	P37637W	USDI, BLM -- Texasgulf Inc.	25 N	93 W	13	SWSE	Miscellaneous	28250	Cancelled	TE 38			
2g	Use Point	P37637W	USDI, BLM -- Texasgulf Inc.	25 N	93 W	13	SESE	Miscellaneous	28250	Cancelled	TE 38			
2h	Use Point	P37637W	USDI, BLM -- Texasgulf Inc.	25 N	93 W	13	SWSW	Miscellaneous	28250	Cancelled	TE 38			
2i	Use Point	P37637W	USDI, BLM -- Texasgulf Inc.	25 N	93 W	13	SESW	Miscellaneous	28250	Cancelled	TE 38			
2j	Use Point	P37637W	USDI, BLM -- Texasgulf Inc.	25 N	93 W	13	NESE	Miscellaneous	28250	Cancelled	TE 38			
2k	Use Point	P37637W	USDI, BLM -- Texasgulf Inc.	25 N	93 W	13	SENE	Miscellaneous	28250	Cancelled	TE 38			
2l	Use Point	P37637W	USDI, BLM -- Texasgulf Inc.	25 N	93 W	13	NESW	Miscellaneous	28250	Cancelled	TE 38			
2m	Use Point	P37637W	USDI, BLM -- Texasgulf Inc.	25 N	93 W	13	NWSW	Miscellaneous	28250	Cancelled	TE 38			
2n	Use Point	P37637W	USDI, BLM -- Texasgulf Inc.	25 N	93 W	13	NENE	Miscellaneous	28250	Cancelled	TE 38			
2o	Use Point	P37637W	USDI, BLM -- Texasgulf Inc.	25 N	93 W	13	NWNE	Miscellaneous	28250	Cancelled	TE 38			
2p	Use Point	P37637W	USDI, BLM -- Texasgulf Inc.	25 N	93 W	13	SWNE	Miscellaneous	28250	Cancelled	TE 38			
2q	Use Point	P37637W	USDI, BLM -- Texasgulf Inc.	25 N	93 W	14	NWSE	Miscellaneous	28250	Cancelled	TE 38			
2r	Use Point	P37637W	USDI, BLM -- Texasgulf Inc.	25 N	93 W	14	SWSE	Miscellaneous	28250	Cancelled	TE 38			
2s	Use Point	P37637W	USDI, BLM -- Texasgulf Inc.	25 N	93 W	14	SESE	Miscellaneous	28250	Cancelled	TE 38			
2t	Use Point	P37637W	USDI, BLM -- Texasgulf Inc.	25 N	93 W	14	SWSW	Miscellaneous	28250	Cancelled	TE 38			
2u	Use Point	P37637W	USDI, BLM -- Texasgulf Inc.	25 N	93 W	14	SESW	Miscellaneous	28250	Cancelled	TE 38			
2v	Use Point	P37637W	USDI, BLM -- Texasgulf Inc.	25 N	93 W	14	NESE	Miscellaneous	28250	Cancelled	TE 38			
2w	Use Point	P37637W	USDI, BLM -- Texasgulf Inc.	25 N	93 W	14	NESW	Miscellaneous	28250	Cancelled	TE 38			
2x	Use Point	P37637W	USDI, BLM -- Texasgulf Inc.	25 N	93 W	14	NWSW	Miscellaneous	28250	Cancelled	TE 38			
2y	Use Point	P37637W	USDI, BLM -- Texasgulf Inc.	25 N	93 W	23	SENV	Miscellaneous	28250	Cancelled	TE 38			
2z	Use Point	P37637W	USDI, BLM -- Texasgulf Inc.	25 N	93 W	23	NENW	Miscellaneous	28250	Cancelled	TE 38			
2aa	Use Point	P37637W	USDI, BLM -- Texasgulf Inc.	25 N	93 W	23	NWNW	Miscellaneous	28250	Cancelled	TE 38			
2ab	Use Point	P37637W	USDI, BLM -- Texasgulf Inc.	25 N	93 W	23	SWNW	Miscellaneous	28250	Cancelled	TE 38			
2ac	Use Point	P37637W	USDI, BLM -- Texasgulf Inc.	25 N	93 W	23	NWNE	Miscellaneous	28250	Cancelled	TE 38			
2ad	Use Point	P37637W	USDI, BLM -- Texasgulf Inc.	25 N	93 W	23	SWNE	Miscellaneous	28250	Cancelled	TE 38			
2ae	Use Point	P37637W	USDI, BLM -- Texasgulf Inc.	25 N	93 W	23	SENE	Miscellaneous	28250	Cancelled	TE 38			
2af	Use Point	P37637W	USDI, BLM -- Texasgulf Inc.	25 N	93 W	23	NENE	Miscellaneous	28250	Cancelled	TE 38			
2ag	Use Point	P37637W	USDI, BLM -- Texasgulf Inc.	25 N	93 W	24	SENV	Miscellaneous	28250	Cancelled	TE 38			
2ah	Use Point	P37637W	USDI, BLM -- Texasgulf Inc.	25 N	93 W	24	NWNW	Miscellaneous	28250	Cancelled	TE 38			
2ai	Use Point	P37637W	USDI, BLM -- Texasgulf Inc.	25 N	93 W	24	SWNW	Miscellaneous	28250	Cancelled	TE 38			
2aj	Use Point	P37637W	USDI, BLM -- Texasgulf Inc.	25 N	93 W	24	SWNE	Miscellaneous	28250	Cancelled	TE 38			
2ak	Use Point	P37637W	USDI, BLM -- Texasgulf Inc.	25 N	93 W	24	SENE	Miscellaneous	28250	Cancelled	TE 38			
2al	Use Point	P37637W	USDI, BLM -- Texasgulf Inc.	25 N	93 W	24	NENW	Miscellaneous	28250	Cancelled	TE 38			
2am	Use Point	P37637W	USDI, BLM -- Texasgulf Inc.	25 N	93 W	24	NENE	Miscellaneous	28250	Cancelled	TE 38			
2an	Use Point	P37637W	USDI, BLM -- Texasgulf Inc.	25 N	93 W	24	NWNE	Miscellaneous	28250	Cancelled	TE 38			
3	Well	P39744W	USDI, BLM -- Apexco Inc.	25 N	93 W	22	SWNE	Miscellaneous	8/26/1977	Cancelled	Battle Springs No. 1	25 gpm	640	60
3a	Use Point	P39744W	USDI, BLM -- Apexco Inc.	25 N	93 W	22	SWNE	Miscellaneous	8/26/1977	Cancelled	Battle Springs No. 1			
4	Well	P54887W	Minerals Exploration Company -- WSBLC	24 N	93 W	15	SWNW	Dewatering, Industrial, Miscellaneous	11/24/1980	Cancelled	DW 35	INP	INP	INP
4a	Use Point	P54887W	Minerals Exploration Company -- WSBLC	24 N	93 W	11	SWSW	Dewatering, Industrial, Miscellaneous	11/24/1980	Cancelled	DW 35			
4b	Use Point	P54887W	Minerals Exploration Company -- WSBLC	24 N	93 W	11	SESW	Dewatering, Industrial, Miscellaneous	11/24/1980	Cancelled	DW 35			

Table 2.2-3 Abandoned and Cancelled Wells (Page 3 of 4)

ID ¹	Well or Use Point	Permit Number	Applicant ²	Township	Range	Section	¼ of the ¼	Uses	Priority	Status	Permit Facility Name	Yield ³	Well Depth (ft)	Static Well Depth (ft)
5	Well	P54888W	Minerals Exploration Company – WSBLC	24 N	93 W	15	SWNW	Dewatering, Industrial, Miscellaneous	11/24/1980	Cancelled	DW 36	INP	INP	INP
5a	Use Point	P54888W	Minerals Exploration Company – WSBLC	24 N	93 W	11	SWSW	Dewatering, Industrial, Miscellaneous	11/24/1980	Cancelled	DW 36			
5b	Use Point	P54888W	Minerals Exploration Company – WSBLC	24 N	93 W	11	SESW	Dewatering, Industrial, Miscellaneous	11/24/1980	Cancelled	DW 36			
6	Well	P54889W	Minerals Exploration Company – WSBLC	24 N	93 W	15	NWNW	Dewatering, Industrial, Miscellaneous	11/24/1980	Cancelled	DW 37	INP	INP	INP
6a	Use Point	P54889W	Minerals Exploration Company – WSBLC	24 N	93 W	11	SWSW	Dewatering, Industrial, Miscellaneous	11/24/1980	Cancelled	DW 37			
6b	Use Point	P54889W	Minerals Exploration Company – WSBLC	24 N	93 W	11	SESW	Dewatering, Industrial, Miscellaneous	11/24/1980	Cancelled	DW 37			
7	Well	P54890W	Minerals Exploration Company – WSBLC	24 N	93 W	15	NWNW	Dewatering, Industrial, Miscellaneous	11/24/1980	Cancelled	DW 38	INP	INP	INP
7a	Use Point	P54890W	Minerals Exploration Company – WSBLC	24 N	93 W	11	SWSW	Dewatering, Industrial, Miscellaneous	11/24/1980	Cancelled	DW 38			
7b	Use Point	P54890W	Minerals Exploration Company – WSBLC	24 N	93 W	11	SESW	Dewatering, Industrial, Miscellaneous	11/24/1980	Cancelled	DW 38			
8	Well	P61528W	Texasgulf Inc.	25 N	92 W	20	NWNW	Monitoring	30113	Abandoned	M25 92 20 1S	0 gpm	355	155.8
8a	Use Point	P61528W	Texasgulf Inc.	25 N	92 W	20	NWNW	Monitoring	30113	Abandoned	M25 92 20 1S			
9	Well	P61529W	Texasgulf Inc.	25 N	92 W	20	NWNW	Monitoring	30113	Abandoned	M25 92 20 1M	0 gpm	440	173.8
9a	Use Point	P61529W	Texasgulf Inc.	25 N	92 W	20	NWNW	Monitoring	30113	Abandoned	M25 92 20 1M			
10	Well	P61530W	Texasgulf Inc.	25 N	92 W	20	NWNW	Monitoring	30113	Abandoned	M25 92 20 1D	0 gpm	534	181.2
10a	Use Point	P61530W	Texasgulf Inc.	25 N	92 W	20	NWNW	Monitoring	30113	Abandoned	M25 92 20 1D			
11	Well	P61531W	Texasgulf Inc.	25 N	92 W	19	NENE	Monitoring	30113	Abandoned	M25 92 19 3M	0 gpm	460	176.5
11a	Use Point	P61531W	Texasgulf Inc.	25 N	92 W	19	NENE	Monitoring	30113	Abandoned	M25 92 19 3M			
12	Well	P61532W	Texasgulf Inc.	25 N	92 W	19	NENE	Monitoring	30113	Abandoned	M25 92 19 2M	0 gpm	460	175.9
12a	Use Point	P61532W	Texasgulf Inc.	25 N	92 W	19	NENE	Monitoring	30113	Abandoned	M25 92 19 2M			
13	Well	P61533W	Texasgulf Inc.	25 N	92 W	19	NENE	Monitoring	30113	Abandoned	M25 92 19 1M	0 gpm	460	174.4
13a	Use Point	P61533W	Texasgulf Inc.	25 N	92 W	19	NENE	Monitoring	30113	Abandoned	M25 92 19 1M			
14	Well	P61534W	Texasgulf Inc.	25 N	92 W	18	SESE	Monitoring	30113	Abandoned	M25 19 18 1M	0 gpm	465	166.7
14a	Use Point	P61534W	Texasgulf Inc.	25 N	92 W	18	SWSE	Monitoring	30113	Abandoned	M25 19 18 1M			
15	Well	P61535W	Texasgulf Inc.	25 N	92 W	18	SESE	Monitoring	30113	Abandoned	M25 19 18 1S	0 gpm	355	159.5
15a	Use Point	P61535W	Texasgulf Inc.	25 N	92 W	18	SESE	Monitoring	30113	Abandoned	M25 19 18 1S			
16	Well	P61536W	Texasgulf Inc.	25 N	92 W	18	SESE	Monitoring	30113	Abandoned	M25 92 18 1D	0 gpm	615	195.7
16a	Use Point	P61536W	Texasgulf Inc.	25 N	92 W	18	SESE	Monitoring	30113	Abandoned	M25 92 18 1D			
17	Well	P61537W	Texasgulf Inc.	25 N	92 W	17	SESW	Monitoring	30113	Abandoned	M25 92 17 1S	0 gpm	340	170.53
17a	Use Point	P61537W	Texasgulf Inc.	25 N	92 W	17	SESW	Monitoring	30113	Abandoned	M25 92 17 1S			
18	Well	P61538W	Texasgulf Inc.	25 N	92 W	17	SESW	Monitoring	30113	Abandoned	M25 92 17 1M	0 gpm	480	182.7
18a	Use Point	P61538W	Texasgulf Inc.	25 N	92 W	17	SESW	Monitoring	30113	Abandoned	M25 92 17 1M			
19	Well	P61539W	Texasgulf Inc.	25 N	92 W	17	SESW	Monitoring	30113	Abandoned	M25 92 17 1D	0 gpm	529	204.5
19a	Use Point	P61539W	Texasgulf Inc.	25 N	92 W	17	SESW	Monitoring	30113	Abandoned	M25 92 17 1D			
20	Well	P68449W	USDI, BLM – Texasgulf Inc.	25 N	93 W	24	NENW	Miscellaneous	30904	Cancelled	TE 38	25 gpm	380	220
20a	Use Point	P68449W	USDI, BLM – Texasgulf Inc.	25 N	93 W	12	SESE	Miscellaneous	30904	Cancelled	TE 38			
20b	Use Point	P68449W	USDI, BLM – Texasgulf Inc.	25 N	93 W	12	NESE	Miscellaneous	30904	Cancelled	TE 38			
20c	Use Point	P68449W	USDI, BLM – Texasgulf Inc.	25 N	93 W	12	NWSE	Miscellaneous	30904	Cancelled	TE 38			

Table 2.2-3 Abandoned and Cancelled Wells (Page 4 of 4)

ID ¹	Well or Use Point	Permit Number	Applicant ²	Township	Range	Section	¼ of the ¼	Uses	Priority	Status	Permit Facility Name	Yield ³	Well Depth (ft)	Static Well Depth (ft)
20d	Use Point	P68449W	USDI, BLM -- Texasgulf Inc.	25 N	93 W	12	SWSE	Miscellaneous	30904	Cancelled	TE 38			
20e	Use Point	P68449W	USDI, BLM -- Texasgulf Inc.	25 N	93 W	13	SWSE	Miscellaneous	30904	Cancelled	TE 38			
20f	Use Point	P68449W	USDI, BLM -- Texasgulf Inc.	25 N	93 W	13	SESE	Miscellaneous	30904	Cancelled	TE 38			
20g	Use Point	P68449W	USDI, BLM -- Texasgulf Inc.	25 N	93 W	13	SESW	Miscellaneous	30904	Cancelled	TE 38			
20h	Use Point	P68449W	USDI, BLM -- Texasgulf Inc.	25 N	93 W	13	NESE	Miscellaneous	30904	Cancelled	TE 38			
20i	Use Point	P68449W	USDI, BLM -- Texasgulf Inc.	25 N	93 W	13	NWSE	Miscellaneous	30904	Cancelled	TE 38			
20j	Use Point	P68449W	USDI, BLM -- Texasgulf Inc.	25 N	93 W	13	NESW	Miscellaneous	30904	Cancelled	TE 38			
20k	Use Point	P68449W	USDI, BLM -- Texasgulf Inc.	25 N	93 W	13	NWSW	Miscellaneous	30904	Cancelled	TE 38			
20l	Use Point	P68449W	USDI, BLM -- Texasgulf Inc.	25 N	93 W	13	SWSW	Miscellaneous	30904	Cancelled	TE 38			
20m	Use Point	P68449W	USDI, BLM -- Texasgulf Inc.	25 N	93 W	13	NWNE	Miscellaneous	30904	Cancelled	TE 38			
20n	Use Point	P68449W	USDI, BLM -- Texasgulf Inc.	25 N	93 W	13	SWNE	Miscellaneous	30904	Cancelled	TE 38			
20o	Use Point	P68449W	USDI, BLM -- Texasgulf Inc.	25 N	93 W	13	SENE	Miscellaneous	30904	Cancelled	TE 38			
20p	Use Point	P68449W	USDI, BLM -- Texasgulf Inc.	25 N	93 W	13	NENE	Miscellaneous	30904	Cancelled	TE 38			
20q	Use Point	P68449W	USDI, BLM -- Texasgulf Inc.	25 N	93 W	14	NWSE	Miscellaneous	30904	Cancelled	TE 38			
20r	Use Point	P68449W	USDI, BLM -- Texasgulf Inc.	25 N	93 W	14	SWSE	Miscellaneous	30904	Cancelled	TE 38			
20s	Use Point	P68449W	USDI, BLM -- Texasgulf Inc.	25 N	93 W	14	SESE	Miscellaneous	30904	Cancelled	TE 38			
20t	Use Point	P68449W	USDI, BLM -- Texasgulf Inc.	25 N	93 W	14	SWSW	Miscellaneous	30904	Cancelled	TE 38			
20u	Use Point	P68449W	USDI, BLM -- Texasgulf Inc.	25 N	93 W	14	SESW	Miscellaneous	30904	Cancelled	TE 38			
20v	Use Point	P68449W	USDI, BLM -- Texasgulf Inc.	25 N	93 W	14	NESE	Miscellaneous	30904	Cancelled	TE 38			
20w	Use Point	P68449W	USDI, BLM -- Texasgulf Inc.	25 N	93 W	14	NESW	Miscellaneous	30904	Cancelled	TE 38			
20x	Use Point	P68449W	USDI, BLM -- Texasgulf Inc.	25 N	93 W	14	NWSW	Miscellaneous	30904	Cancelled	TE 38			
20y	Use Point	P68449W	USDI, BLM -- Texasgulf Inc.	25 N	93 W	23	SWNW	Miscellaneous	30904	Cancelled	TE 38			
20z	Use Point	P68449W	USDI, BLM -- Texasgulf Inc.	25 N	93 W	23	SENW	Miscellaneous	30904	Cancelled	TE 38			
20aa	Use Point	P68449W	USDI, BLM -- Texasgulf Inc.	25 N	93 W	23	SENE	Miscellaneous	30904	Cancelled	TE 38			
20ab	Use Point	P68449W	USDI, BLM -- Texasgulf Inc.	25 N	93 W	23	NENW	Miscellaneous	30904	Cancelled	TE 38			
20ac	Use Point	P68449W	USDI, BLM -- Texasgulf Inc.	25 N	93 W	23	NWNW	Miscellaneous	30904	Cancelled	TE 38			
20ad	Use Point	P68449W	USDI, BLM -- Texasgulf Inc.	25 N	93 W	23	NENE	Miscellaneous	30904	Cancelled	TE 38			
20ae	Use Point	P68449W	USDI, BLM -- Texasgulf Inc.	25 N	93 W	23	NVNE	Miscellaneous	30904	Cancelled	TE 38			
20af	Use Point	P68449W	USDI, BLM -- Texasgulf Inc.	25 N	93 W	23	SWNE	Miscellaneous	30904	Cancelled	TE 38			
20ag	Use Point	P68449W	USDI, BLM -- Texasgulf Inc.	25 N	93 W	24	NWNW	Miscellaneous	30904	Cancelled	TE 38			
20ah	Use Point	P68449W	USDI, BLM -- Texasgulf Inc.	25 N	93 W	24	SWNW	Miscellaneous	30904	Cancelled	TE 38			
20ai	Use Point	P68449W	USDI, BLM -- Texasgulf Inc.	25 N	93 W	24	SENW	Miscellaneous	30904	Cancelled	TE 38			
20aj	Use Point	P68449W	USDI, BLM -- Texasgulf Inc.	25 N	93 W	24	SENE	Miscellaneous	30904	Cancelled	TE 38			
20ak	Use Point	P68449W	USDI, BLM -- Texasgulf Inc.	25 N	93 W	24	NENW	Miscellaneous	30904	Cancelled	TE 38			
20al	Use Point	P68449W	USDI, BLM -- Texasgulf Inc.	25 N	93 W	24	NENE	Miscellaneous	30904	Cancelled	TE 38			
20am	Use Point	P68449W	USDI, BLM -- Texasgulf Inc.	25 N	93 W	24	NWNE	Miscellaneous	30904	Cancelled	TE 38			
20an	Use Point	P68449W	USDI, BLM -- Texasgulf Inc.	25 N	93 W	24	SWNE	Miscellaneous	30904	Cancelled	TE 38			

* WSEO, 2006

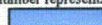
¹ Each number represents a well. A number followed by a letter(s) is a point of use related to the well.
 = Well within two miles of the Permit Area.

 = Point of use within two miles of the Permit Area.
² USDI BLM = United States Department of Interior's Bureau of Land Management; WSLC = Wyoming State Board of Land Commissioners³ INP = Information not provided by the online WSEO database.

Table 2.2-4

Potentially Active Domestic and Stock Wells within a Five-Mile Radius of the Lost Creek Permit Area General Disclaimer

The data contained herein are provided AS IS and IN NO EVENT SHALL the State of Wyoming, its agencies or representatives, be LIABLE for any DAMAGES including, without limitation, damages resulting from lost data or profits or revenue the costs of recovering such data, the cost of substitute data, computer repair or replacement costs, claims by third parties for similar costs, or any special, direct or indirect, incidental, punitive or consequential damages of any kind whatsoever, arising out of the use of these data. The accuracy or reliability of the data IS NOT GUARANTEED or WARRANTED in any way and the State of Wyoming, its agencies or representatives, EXPRESSLY DISCLAIM LIABILITY, whether expressed or implied, or of any kind whatsoever, including, without limitation, liability for QUALITY, PERFORMANCE, MERCHANTABILITY AND FITNESS FOR THE PARTICULAR PURPOSE arising from the use of the data, NEITHER the State of Wyoming, NOR its agencies or representatives, including the State Engineer's Office, REPRESENT or ENDORSE the ACCURACY or RELIABILITY OF ANY INFORMATION contained in the database, as some of the data are provided by permit applicants and may not have been verified by the State of Wyoming, its agencies or representatives. The State of Wyoming, its agencies and representatives RESERVE THE RIGHT, at their sole discretion, WITHOUT OBLIGATION, to MODIFY, ADD OR REMOVE all or portions of the data, at any time, WITH OR WITHOUT NOTICE. This includes the correction of errors or omissions within the database. All data or information provided by the Wyoming State Engineer's Office shall be used and relied upon only at the USER'S SOLE RISK, and the user agrees to indemnify and hold harmless the State of Wyoming, its agencies or representatives, including the Wyoming State Engineer's Office, and its officials, officers, and employees, from any liability arising out of the use or distribution of these data.

Definitions

- **Abandoned:** The loss of a water right based on the non-use of that water right when water was available for a period of five consecutive years, or the voluntary relinquishment of an adjudicated water right.
- **Cancelled:**
 - A temporary use permit issued for a limited time, after which the permit is cancelled; or
 - A permit or certificate that has been issued by the state engineer or the board of control, in which the provisions of the permit or certificate were found willfully violated.
- **Good Standing Incomplete:** All legally required notices have not been received and the permit has not expired.
- **Unadjudicated:** A water right permit before it has been publicly recognized by proof of inspection and advertisement.

* Wyoming State Engineer's Office (WSEO). 2006. Documents. Available from: <http://seo.state.wy.us/docs.aspx>. Accessed on 11 December 2008.

Table 2.2-4 Potentially Active Domestic and Stock Wells within a Five-Mile Radius of the Lost Creek Permit Area

Last Revised December 2008

Map ID	Permit Number	Applicant	Township	Range	Section	¼ of the ¼	Uses	Priority	Status	Permit Facility Name	Yield (gpm)	Well Depth (feet)	Static Depth (feet)	Top of Main Water-Bearing Zone	Bottom of Main Water-Bearing Zone	Well Log	Chemical Analysis
1	P6572W	Kennecott Uranium Company	24 N	93 W	17	NENE	Domestic	9/17/1970	Good Standing	DB No. 1	9	216	60	140	216	Yes	Yes
2	P8444P	Sun Land/Cattle Co.	26 N	92 W	27	SWSE	Stock	12/31/1946	Good Standing	Osborne No. 1	10	280	250	Unknown	Unknown	No	No
3	P8461P	Sun Land/Cattle Co. and Wyoming Board of Land Commissioners	24 N	93 W	16	NWNW	Stock	12/31/1919	Good Standing	Jawbone School Sec No. 1	25	600	-1	Unknown	Unknown	No	No
4	P8462P	Sun Land/Cattle Co. and Wyoming Board of Land Commissioners	24 N	93 W	16	NWNW	Stock	6/25/1919	Good Standing	Jamborn S Sec No. 2	30	600	60	Unknown	Unknown	No	No
5	P10696P	BLM - Rawlins District	26 N	92 W	27	NESW	Stock	1/10/1942	Good Standing	Osbourne Draw Well No. 123	5	237	-1	Unknown	Unknown	No	No
6	P13834P	BLM - Rawlins District	25 N	92 W	21	NENW	Stock	9/21/1968	Good Standing	Battle Spring Draw Well No. 4451	19	900	104	Unknown	Unknown	No	No
7	P47137W	Kennecott Uranium Company	24 N	93 W	10	NWNW	Reservoir Supply, Stock, Miscellaneous	12/7/1977	Unadjudicated	Blue No. 5						No	
8	P55108W	BLM - Rawlins District	24 N	92 W	18	SWNE	Stock	12/24/1980	Good Standing	Stratton Draw	5	220	138	150	200	Yes	No
9	P55111W	BLM - Rawlins District	25 N	91 W	8	NWNW	Stock	12/24/1980	Good Standing	Road Crossing	5	300	199	220	300	Yes	No
10	P55112W	BLM - Rawlins District	25 N	92 W	10	SESE	Stock	12/24/1980	Good Standing	Boundary	5	280	155	220	280	Yes	No
11	P55113W	BLM - Rawlins District	25 N	92 W	30	NWSE	Stock	12/24/1980	Good Standing	Battle Springs	5	220	109	184	220	Yes	No
12	P55114W	BLM - Rawlins District	25 N	92 W	35	SENE	Stock	12/24/1980	Good Standing	Sooner	5	320	237	250	320	Yes	No
13	P63765W	BLM - Rawlins District	24 N	93 W	24	NWNW	Stock	4/1/1983	Good Standing	Mineral X Pipeline	20	380	140	100	380	Yes	No
14	P183470W	BLM - Rawlins District and Ur-Energy USA, Inc.	25 N	91 W	29	NWNW	Stock	8/27/2007	Good Standing Incomplete	Driller's Well						No	
15	¹	BLM - Rawlins District	25 N	93 W	13	NWNW	Stock			East Eagle Nest Draw Well	5	370	269				
	P35721W	BLM and Texasgulf Inc.	25 N	93 W	14	SWSE	Stock, Miscellaneous	12/8/1978	Abandoned	TE 24							No
	P37683W	BLM - Rawlins District	24 N	93 W	24	NWNW	Stock	5/4/1977	Cancelled	24 93 24 1W							No
	37/9/261W	Stratton Sheep Co. and Wyoming Board of Land Commissioners	24 N	93 W	18	NWNW	Stock	1/27/2005	Rejected	DW 31 Water Well							No

* WSEO, 2006

¹ This well does not currently have an associated WSEO permit number.

= Abandoned, Cancelled, or Rejected Status