

285-

Extraction Well Location

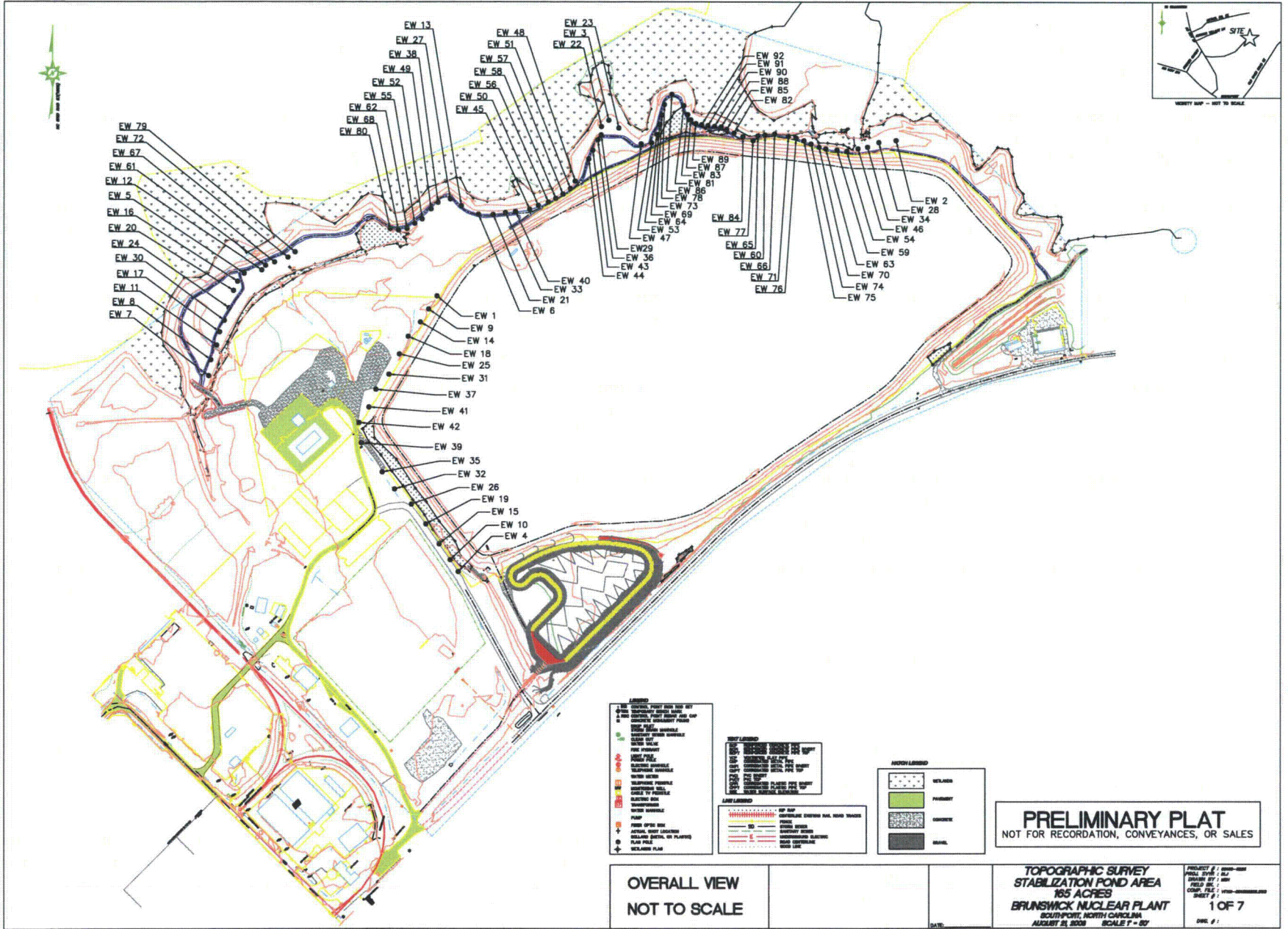

- EW 79
- EW 72
- EW 67
- EW 61
- EW 12
- EW 5
- EW 16
- EW 20
- EW 24
- EW 30
- EW 17
- EW 11
- EW 8
- EW 7

- EW 13
- EW 27
- EW 38
- EW 48
- EW 51
- EW 52
- EW 55
- EW 62
- EW 68
- EW 80
- EW 48
- EW 57
- EW 58
- EW 56
- EW 50
- EW 45
- EW 23
- EW 3
- EW 22

- EW 92
- EW 91
- EW 90
- EW 88
- EW 85
- EW 82

- EW 89
- EW 87
- EW 83
- EW 81
- EW 86
- EW 78
- EW 73
- EW 69
- EW 64
- EW 53
- EW 47
- EW 29
- EW 36
- EW 43
- EW 44
- EW 84
- EW 77
- EW 65
- EW 60
- EW 66
- EW 71
- EW 76

- EW 2
- EW 28
- EW 34
- EW 46
- EW 54
- EW 59
- EW 63
- EW 70
- EW 74
- EW 75

- EW 1
- EW 9
- EW 14
- EW 18
- EW 25
- EW 31
- EW 37
- EW 41
- EW 42
- EW 39
- EW 35
- EW 32
- EW 26
- EW 19
- EW 15
- EW 10
- EW 4

LEGEND

1. ALL EXISTING POINTS AND LINE DATA FROM PREVIOUS SURVEYS SHALL BE SHOWN AND IDENTIFIED BY THE SURVEY NUMBER AND DATE OF SURVEY.

2. ALL NEW POINTS AND LINE DATA SHALL BE SHOWN AND IDENTIFIED BY THE SURVEY NUMBER AND DATE OF SURVEY.

3. ALL EXISTING AND NEW POINTS SHALL BE SHOWN AND IDENTIFIED BY THE SURVEY NUMBER AND DATE OF SURVEY.

4. ALL EXISTING AND NEW LINE DATA SHALL BE SHOWN AND IDENTIFIED BY THE SURVEY NUMBER AND DATE OF SURVEY.

5. ALL EXISTING AND NEW POINTS AND LINE DATA SHALL BE SHOWN AND IDENTIFIED BY THE SURVEY NUMBER AND DATE OF SURVEY.

POINT LEGEND

1. ALL EXISTING POINTS SHALL BE SHOWN AND IDENTIFIED BY THE SURVEY NUMBER AND DATE OF SURVEY.

2. ALL NEW POINTS SHALL BE SHOWN AND IDENTIFIED BY THE SURVEY NUMBER AND DATE OF SURVEY.

3. ALL EXISTING AND NEW POINTS SHALL BE SHOWN AND IDENTIFIED BY THE SURVEY NUMBER AND DATE OF SURVEY.

4. ALL EXISTING AND NEW POINTS SHALL BE SHOWN AND IDENTIFIED BY THE SURVEY NUMBER AND DATE OF SURVEY.

5. ALL EXISTING AND NEW POINTS SHALL BE SHOWN AND IDENTIFIED BY THE SURVEY NUMBER AND DATE OF SURVEY.

AREA LEGEND

1. ALL EXISTING AREAS SHALL BE SHOWN AND IDENTIFIED BY THE SURVEY NUMBER AND DATE OF SURVEY.

2. ALL NEW AREAS SHALL BE SHOWN AND IDENTIFIED BY THE SURVEY NUMBER AND DATE OF SURVEY.

3. ALL EXISTING AND NEW AREAS SHALL BE SHOWN AND IDENTIFIED BY THE SURVEY NUMBER AND DATE OF SURVEY.

4. ALL EXISTING AND NEW AREAS SHALL BE SHOWN AND IDENTIFIED BY THE SURVEY NUMBER AND DATE OF SURVEY.

5. ALL EXISTING AND NEW AREAS SHALL BE SHOWN AND IDENTIFIED BY THE SURVEY NUMBER AND DATE OF SURVEY.

PRELIMINARY PLAT
 NOT FOR RECORDATION, CONVEYANCES, OR SALES

OVERALL VIEW
 NOT TO SCALE

TOPOGRAPHIC SURVEY
STABILIZATION POND AREA
165 ACRES
BRUNSWICK NUCLEAR PLANT
 SOUTHPORT, NORTH CAROLINA
 AUGUST 21, 2008 SCALE 1" = 60'

PROJECT # : 08-001
 FIELD BOOK # : 001
 FIELD NO. : 100-000000
 COMP. FILE : 100-000000
 SHEET # : 1 OF 7
 DATE : 08/21/08