

TAX MAP
 LOWER ALLOWAYS CREEK
 TOWNSHIP
 SCALE 1" = 400' SALEM CO., N.J.
 SKINNER & COMPTON, ENGINEERS
 JUNE 8, 1962 REVISED DEC. 1, 1972
 MAR. 7, 1978
 MAY 16, 1988

SHEET 8

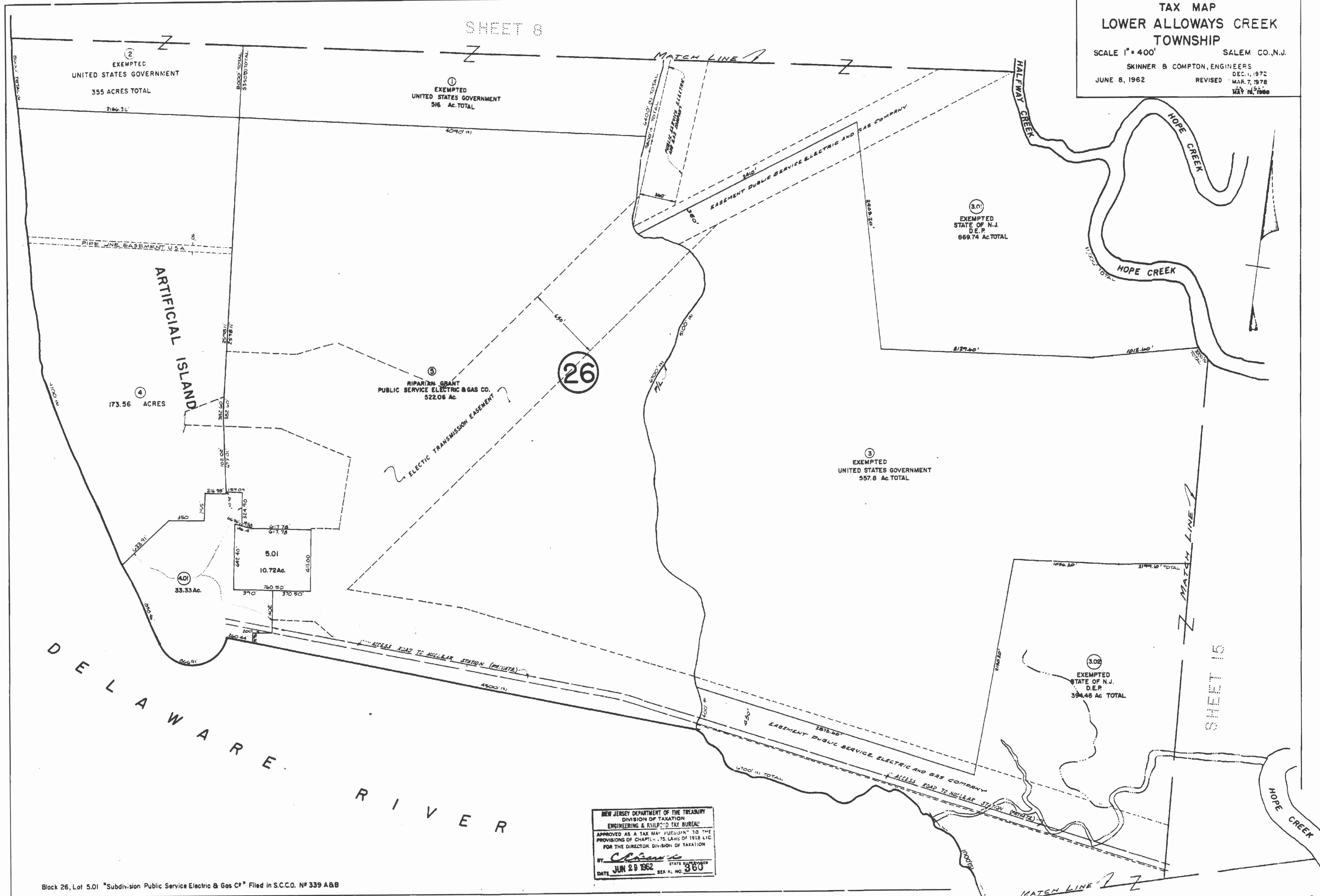

NEW JERSEY DEPARTMENT OF THE TREASURY
 DIVISION OF TAXATION
 ENGINEERING & SURVEYING TAX BUREAU
 APPROVED AS A TAX MAP PURSUANT TO THE
 PROVISIONS OF CHAPTER 175, LAWS OF 1919, L.I.C.
 FOR THE DIRECTOR, DIVISION OF TAXATION
 BY: *Chapman*
 DATE: JUN 28 1962 STATE SURVEYOR
 SEALED NO. 369

Block 26, Lot 5.01 "Subdivision Public Service Electric & Gas Co." Filed in S.C.C.O. N# 339 ABB

SHEET 21

D-02