

Bjornsen, Alan

From: Kock, Andrea *FSME*
Sent: Monday, October 12, 2009 6:18 PM
To: Fetter, Allen
Cc: Hatchett, Gregory; Flanders, Scott; Park, James; Bjornsen, Alan
Subject: Write up for Lost creek groundwater section
Attachments: comments onLC Groundwater 101209.doc

Allen: This write up is awesome- clear, thorough. and justified conclusions. Wow.

One minor addition to the no action alternative and addition of the paragraph from Jim on the history of excursions, etc and we should be ready to go.

I can't thank you enough for your efforts. NRO is lucky to have you and we miss you in FSME

scott and greg- thank you again for loaning allen to us. His experience and technical knowledge were invaluable and greatly needed to be able to justify our conclusions.

From: Fetter, Allen
Sent: Thursday, October 08, 2009 11:38 AM
To: Park, James; Bjornsen, Alan
Cc: Kock, Andrea
Subject: Updated hydrology text and additional figure - Lost Creek Chapters 3 & 4

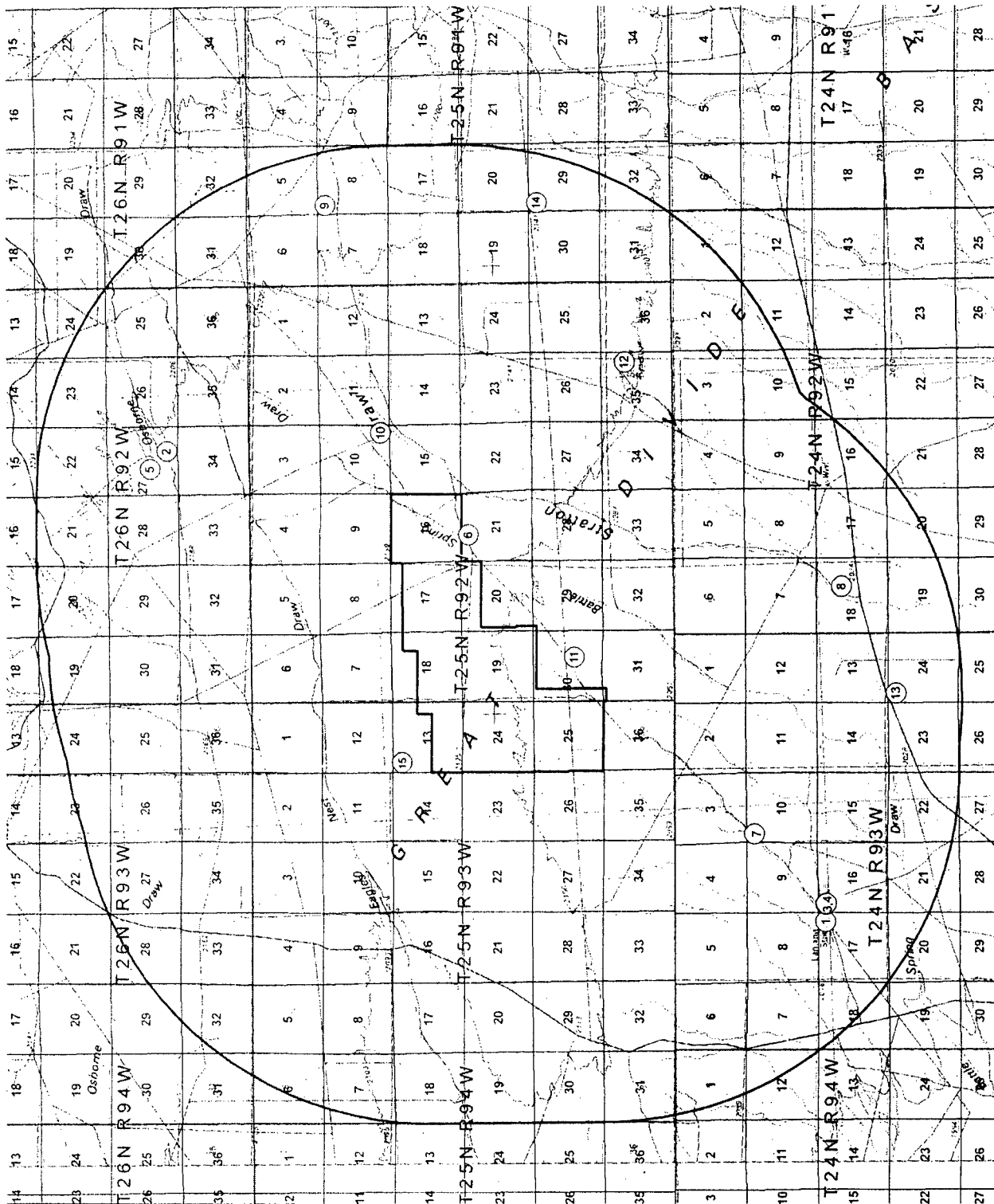

Figure 3.8: Domestic and Stock Wells within Five Miles of the Lost Creek Project Area (LCI, 2008c)