

Fetter, Allen

FSME

From: Saxton, John
Sent: Wednesday, October 07, 2009 10:51 AM
To: Fetter, Allen
Subject: RE: Lost Creek Info

Allen,

The references were proper, i.e., to the March 31, 2008 submittal

the accession numbers are
ML081060504 (TR report)
ML081060505 (Attachment 2.7-1)

From: Fetter, Allen
Sent: Wednesday, October 07, 2009 10:34 AM
To: Saxton, John
Subject: RE: Lost Creek Info

John,

The figure was provided in response to RAIs. Do you have the ADAMS ML number for it?

-Allen

From: Saxton, John
Sent: Wednesday, October 07, 2009 10:20 AM
To: Fetter, Allen
Subject: Lost Creek Info

Allen

Statements that the dip is 3 degrees to the west are found:
Section 2.5, Page 5, Attachment 2.7-1
Section 2.6.1.2, page 2.6-2 of the TR
Section 2.6.2.2, page 2.6-4 of the TR
and Table 2.6-1

Also attached is a word doc with the Map as requested.
The figure was titled "Domestic and Stock Wells within Five Miles of the Project Area" and dated 12/11/08
(no figure number)

John

D/46

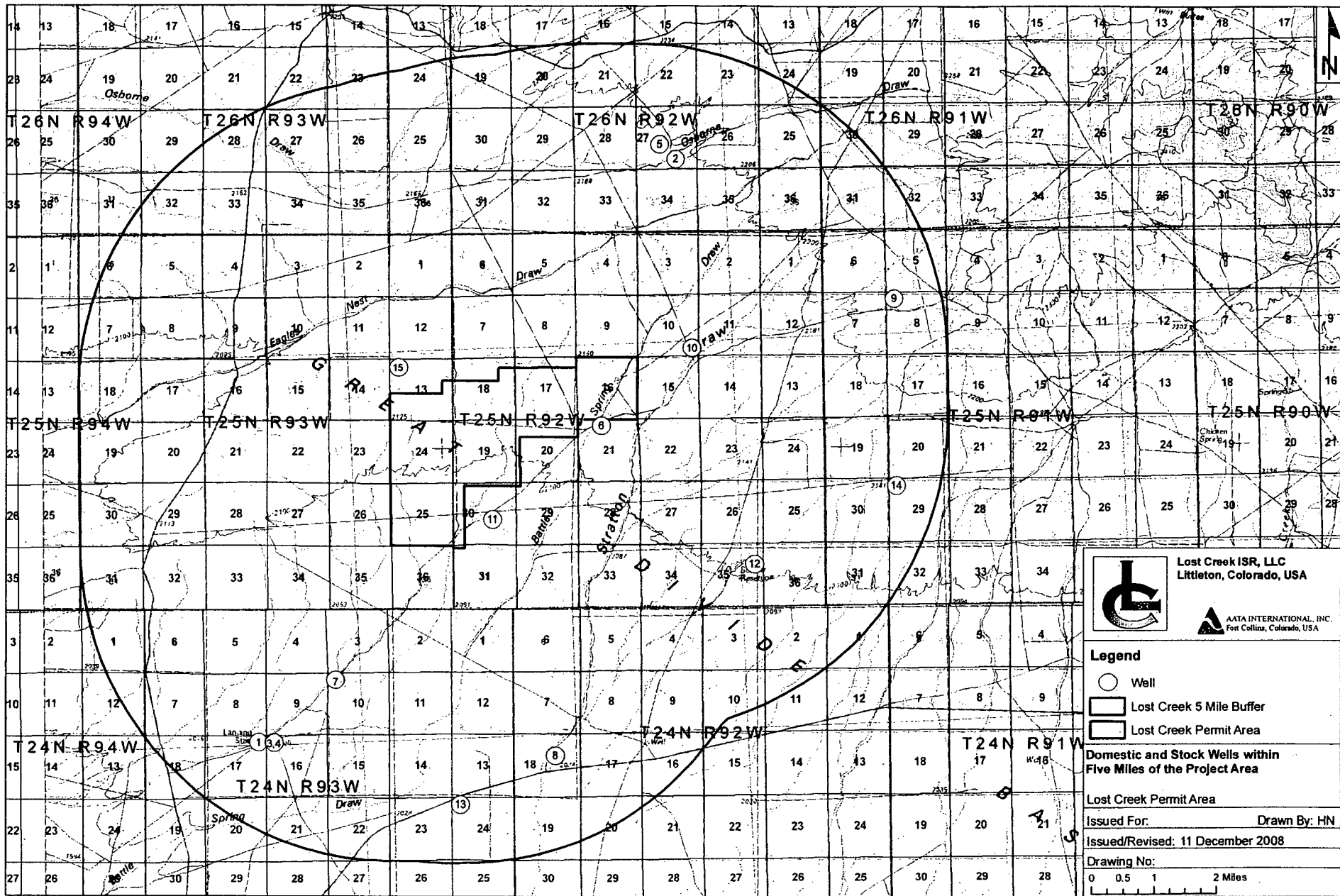

Lost Creek ISR, LLC
Littleton, Colorado, USA



AATA INTERNATIONAL, INC.
Fort Collins, Colorado, USA

Legend

- Well
- Lost Creek 5 Mile Buffer
- Lost Creek Permit Area

Domestic and Stock Wells within
Five Miles of the Project Area

Lost Creek Permit Area

Issued For: _____ Drawn By: HN

Issued/Revised: 11 December 2008

Drawing No:

