

R 76 W

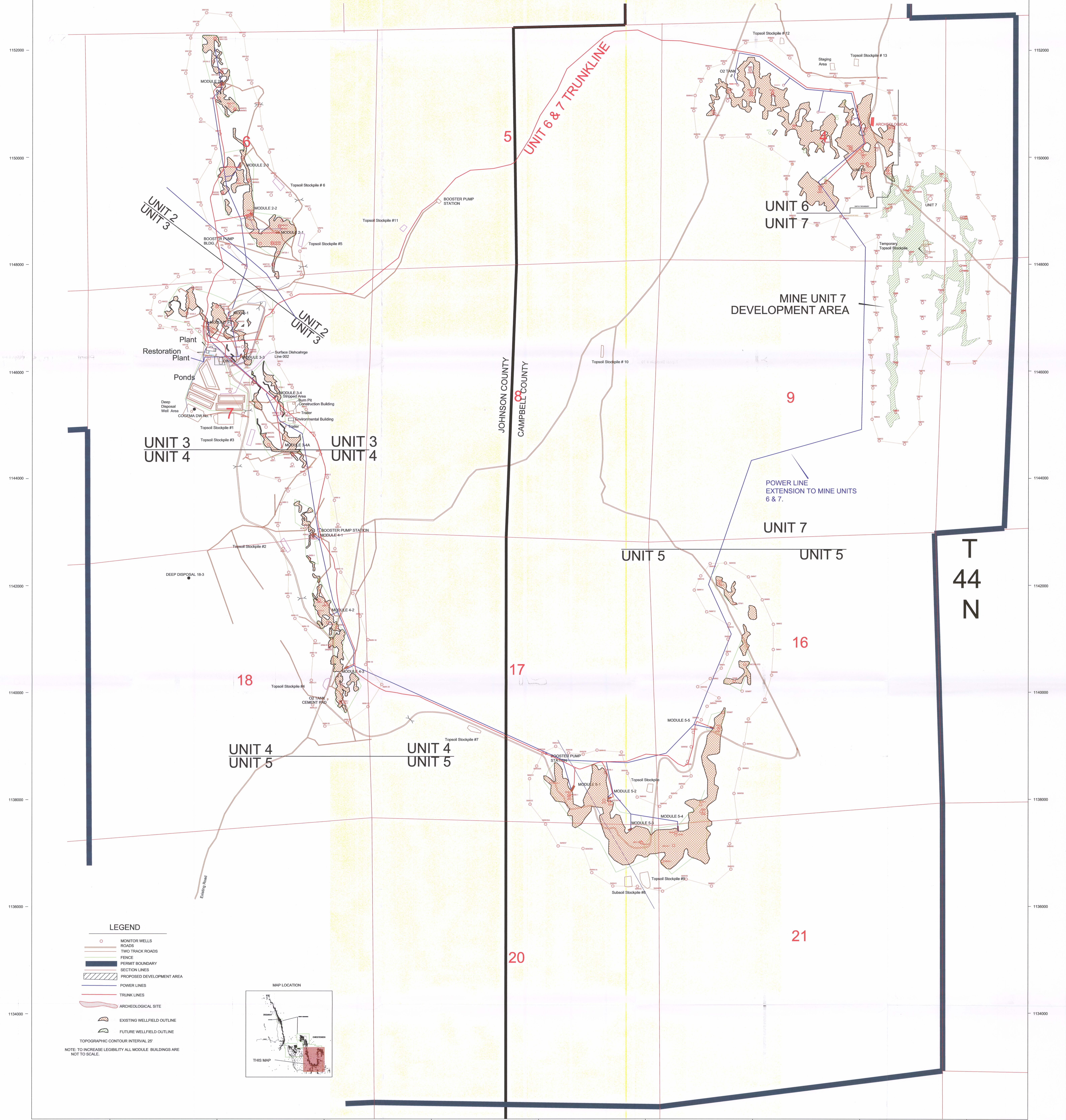

UNIT 2
UNIT 3

5
UNIT 6 & 7 TRUNKLINE

UNIT 6
UNIT 7

MINE UNIT 7
DEVELOPMENT AREA

UNIT 3
UNIT 4

UNIT 3
UNIT 4

UNIT 7

UNIT 5

UNIT 5

T
44
N

UNIT 4
UNIT 5

UNIT 4
UNIT 5

21

20

LEGEND

- MONITOR WELLS
 - ROADS
 - TWO TRACK ROADS
 - FENCE
 - PERMIT BOUNDARY
 - SECTION LINES
 - PROPOSED DEVELOPMENT AREA
 - POWER LINES
 - TRUNK LINES
 - ARCHEOLOGICAL SITE
 - EXISTING WELLFIELD OUTLINE
 - FUTURE WELLFIELD OUTLINE
- TOPOGRAPHIC CONTOUR INTERVAL 25'
- NOTE: TO INCREASE LEGIBILITY ALL MODULE BUILDINGS ARE NOT TO SCALE.

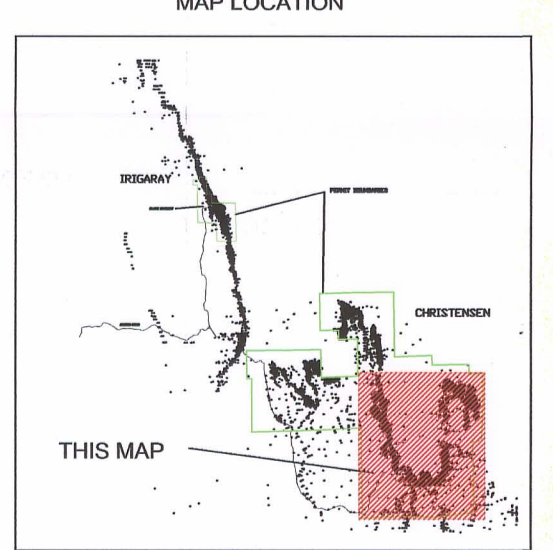

AREVA **COGEMA**
Mining, Inc.
Christensen Project

Area Facilities Location Map
Permit to Mine # 478

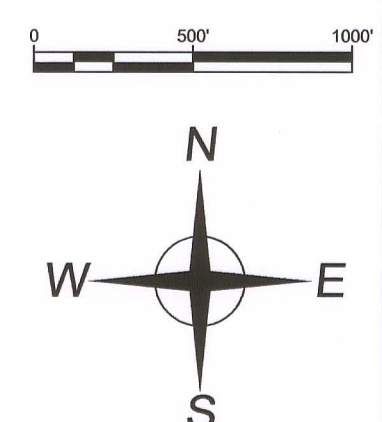

Geology: Enviro: L. Arbogast
Drafting: RMO
Date: 8-12-2009
Revision:

State: Wyoming County: Johnson/Campbell
Scale: 1"=600'
Drawing ID: CR Site 2009.dwg

D-03