

R 76 W

T45N R77W T45N R76W

T44N R77W T44N R76W

CAMPBELL COUNTY
JOHNSON HORSE CREEK

MINE UNIT 7
DEVELOPMENT AREA

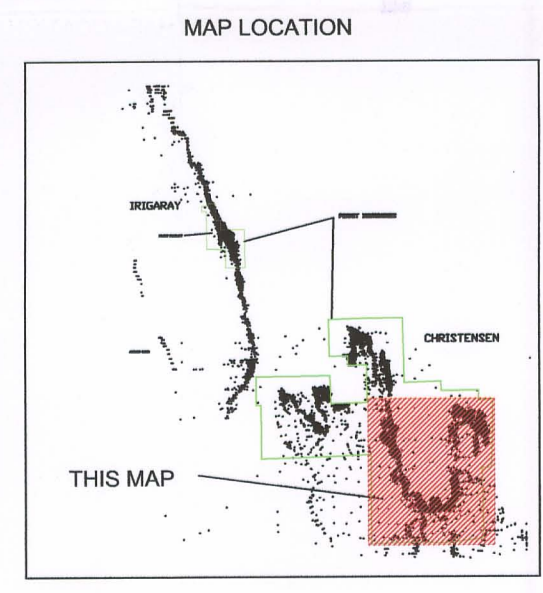
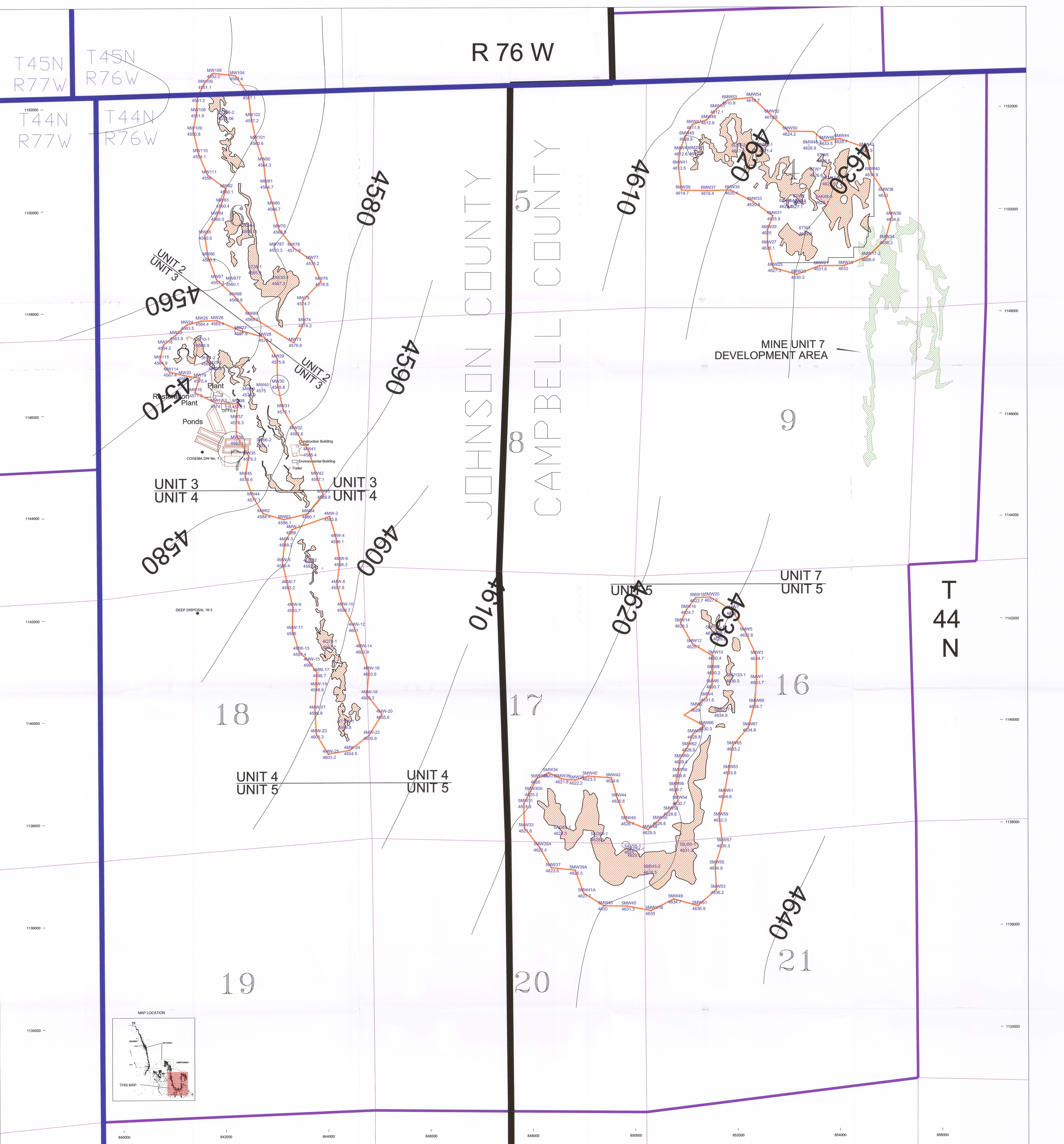

LEGEND

- PERMIT BOUNDARY
- SECTION LINES
- Well #
- Well
- Piezometric Elevation
- 10' Piezometric Contours

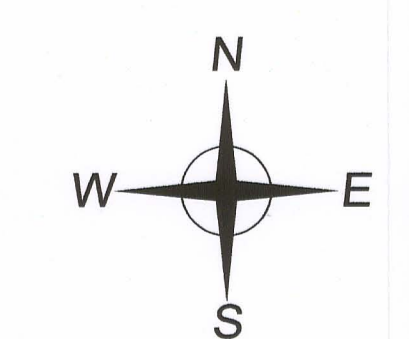

AREVA **COGEMA**
Mining, Inc.
Christensen Project

Ore Zone Piezometric Map
of Mine Units 2 through 6
Permit to Mine No. 478
Piezometric Levels Taken June 2009

Geology: Enwilo, L. Arbogast
Drafting: RMO
Date: 7-14-2009
Revision:
State: Wyoming County: Johnson
Scale: 1"=600'
Drawing ID: CR Ore Zone.dwg

D-04