

**LEGEND**

- C - CONDUIT
- CAS - CONDUIT TO CABINET AS
- CC - CONDUIT TO CABINET C
- CCM - CONDUIT TO CABINET CM
- CDU - COMBINED DRAIN, UNDERGROUND
- CDX - CONDUIT TO CABINET DX
- CI - CAST IRON
- CIT - CONDUIT TO CABINET IT
- CLD - CONCRETE LINED DITCH
- CM - CONDUIT TO CABINET M
- CMP - CORRUGATED METAL PIPE
- CRS - CONDUIT RIGID STEEL
- CULP - CULVERT PIPE
- CW - CHILLED WATER OR CONDUIT TO CAB
- CWDU - COOLING WATER DRAIN, UNDERGROUND
- CWE - COOLING WATER EMERGENCY
- CWEDU - COOLING WATER EMERGENCY DRAIN UNDERGROUND
- CWER - COOLING WATER EMERGENCY RETURN
- CWS - COOLING WATER SUPPLY
- CWSR - COOLING WATER SUPPLY RETURN
- CWSU - COOLING WATER SUPPLY UNDERGROUND
- DD - DIESEL OIL
- DPW - DISPOSAL PIT WASTE
- DWC - DOMESTIC WATER COLD
- DWCU - DOMESTIC WATER COLD UNDERGROUND
- DWW - DISPOSAL WELL WASTE
- FO - FUEL OIL
- FW - FIRE WATER
- FWUJ - FIRE WATER TEST DRAIN, UNDERGROUND
- FWU - FIRE WATER, UNDERGROUND (HEADER)
- GW - GROUNDWATER
- HPS - HIGH PRESSURE STEAM
- HEX - HEXANE
- LPG - LIQUEFIED PETROLEUM GAS
- LPS - LOW PRESSURE STEAM
- NG - NATURAL GAS
- PA - PLANT AIR
- PV - VALVE
- PVL - VALVE
- PW - PROCESS WATER
- RCP - REINFORCED CONCRETE PIPE
- RW - RAINWATER
- RWU - RAIN WATER, UNDERGROUND
- SDR - DRISCO PIPE
- SDU - STORM DRAIN, UNDERGROUND
- SS - SANITARY SEWER
- SSU - SANITARY SEWER, UNDERGROUND
- VCP - VITRIFIED CLAY PIPE
- YSD - STORM DRAIN

- UTILITY LOCATION, TYPE, OR EXTENTS UNKNOWN
- PLUG
- RISER TO SURFACE
- ⊗ FIRE HYDRANT
- MANHOLE
- AREA INLET
- UNDERGROUND UTILITY LINE
- ⊙ LIGHT POLE
- FENCE
- UNPAVED DRIVING SURFACE
- PAVED OR CONCRETE SURFACE
- HYDRAULIC BARRIER
- COLLECTION SUMP

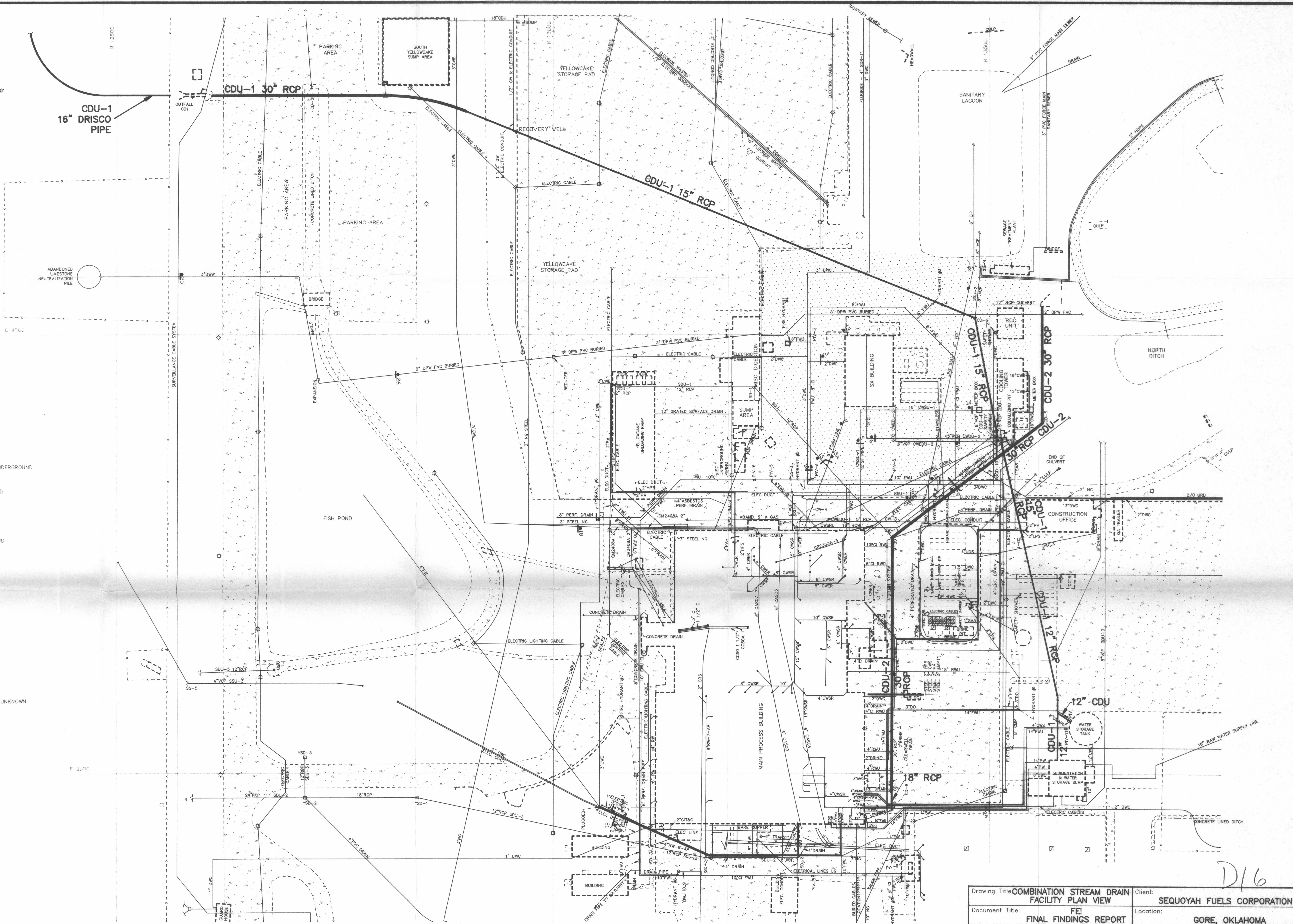

Drawing Title: <b>COMBINATION STREAM DRAIN FACILITY PLAN VIEW</b>		Client: <b>SEQUOYAH FUELS CORPORATION</b>	
Document Title: <b>FEI FINAL FINDINGS REPORT</b>		Location: <b>GORE, OKLAHOMA</b>	
<b>ROBERTS/SCHORNICK &amp; ASSOCIATES, INC.</b> Environmental Consultants 3700 West Robinson, Suite 200 Norman, Oklahoma 73072 (405) 881-3900		DATE: <b>JULY, 1991</b>	PREPARED BY: <b>SFC</b>
		SCALE: <b>1" = 50'</b>	CHECKED BY: <b>RSA</b>
PROJECT NO: <b>90067N48</b>		DRAWING No: <b>16</b>	

D16