

**Waterbury Hospital Health Center,  
64 Robbins Street  
Waterbury CT 06721**

March 12, 2009

*Br1*

Nuclear Regulatory Commission  
Region I  
Nuclear Materials Safety Branch  
Division of Radiation Safety and Safeguards  
475 Allendale Road  
King of Prussia, PA 19406-1415

*030 01251*

REFERENCE: License # 06-02406-01 Amendment

To Whom It May Concern:

Due to financial considerations, we cannot expand our room 0305 as indicated in our previous amendment request. Therefore we request the re-establishment of room 0305, without modification, as a nuclear cardiology stress lab.

After receipt of this amendment, we will submit an additional request to remove 0317, 0319, and 0321 from our license.

We regret any inconvenience this has caused, and thank you for your prompt attention to this matter.

Sincerely,

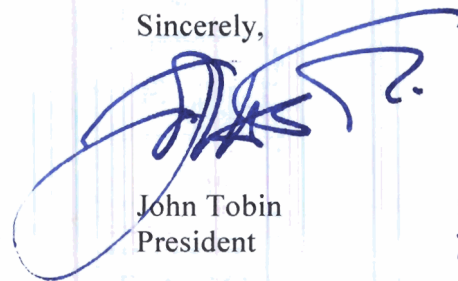

John Tobin  
President

2009 MAR 16 PM 12:24

RECEIVED  
REGION 1

Enc: Cardiology Diagram

*143545*

NMSS/RGN1 MATERIALS-002

01AmdRe-commissionRm0305

1. Changes needed to the NRC license:

A. Original Room 0305 to be re-commissioned as the nuclear cardiology stress lab as shown.

## Cardiology Facility with This Amendment

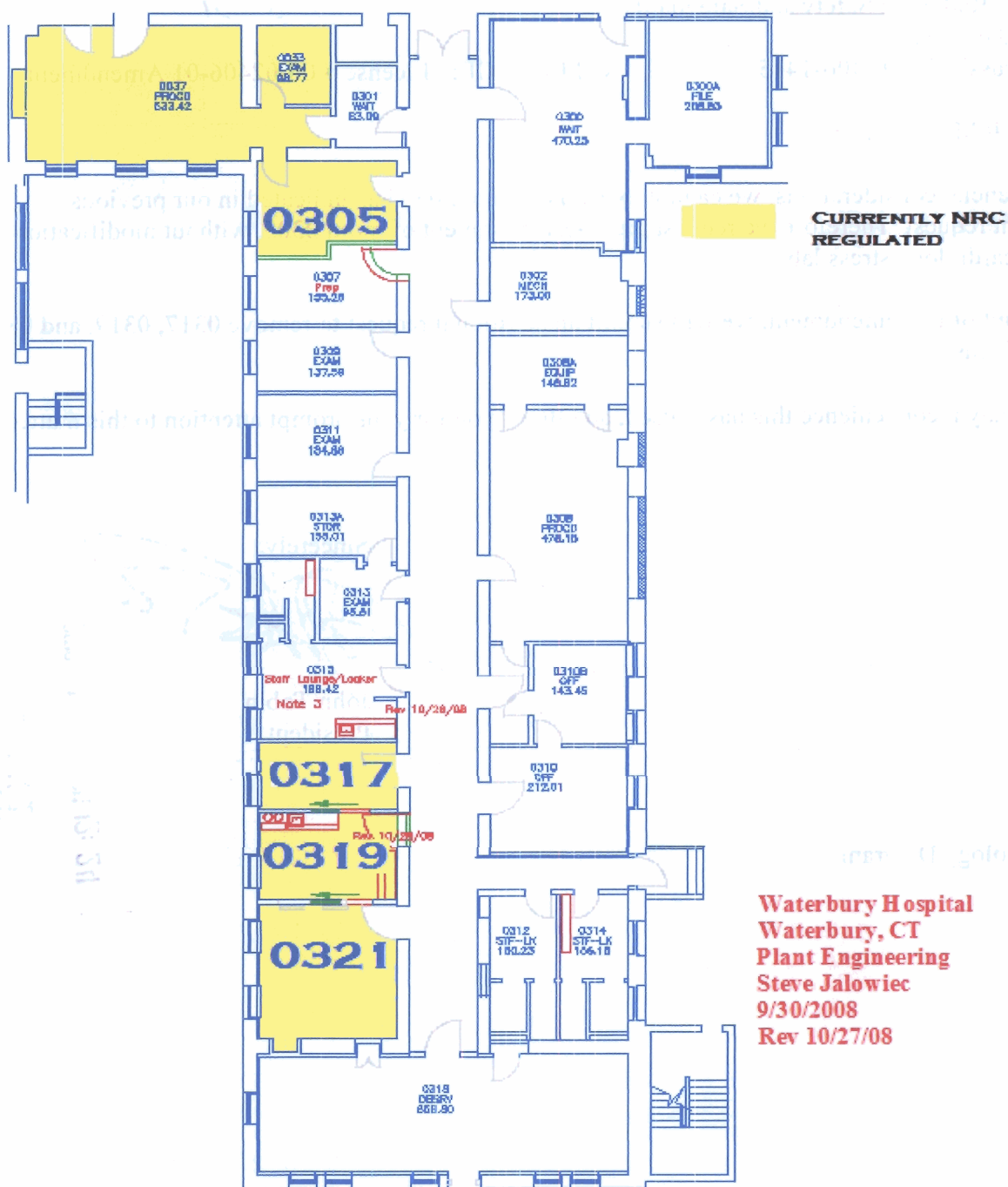

Waterbury Hospital  
Waterbury, CT  
Plant Engineering  
Steve Jalowiec  
9/30/2008  
Rev 10/27/08

This is to acknowledge the receipt of your letter/application dated

3/12/2009, and to inform you that the initial processing which includes an administrative review has been performed.

☒ AMEND. 06-02406-01  
There were no administrative omissions. Your application was assigned to a technical reviewer. Please note that the technical review may identify additional omissions or require additional information.

☐ Please provide to this office within 30 days of your receipt of this card

A copy of your action has been forwarded to our License Fee & Accounts Receivable Branch, who will contact you separately if there is a fee issue involved.

Your action has been assigned **Mail Control Number** 143545.  
When calling to inquire about this action, please refer to this control number.  
You may call us on (610) 337-5398, or 337-5260.

