

POTENTIAL SETTLEMENT BASED ON 1.5 E CRITERIA (INCHES)
 (0.7)
 (3.4) POTENTIAL SETTLEMENT BASED ON 5% E CRITERIA (INCHES)

- ▽ DESIGN WATER TABLE
- ▬ WATER TABLE (24 HR)
- MH SOIL CLASSIFICATION
- 13 BLOW COUNT
- ▨ POTENTIALLY LIQUEFIABLE SOIL (SEE NOTE 1)
- WS WEATHERED SHALE

NOTE:
 1. LIQUEFACTION BASED ON TOP OF GROUND ACCELERATION OF 0.40 AND SEED - IDRISS (1971) CORRELATION FOR SANDS.

2. POTENTIAL SETTLEMENT WAS NOT CALCULATED BECAUSE THE SOILING WAS AUGURED DOWN BELOW THE ELEVATION OF THE PIPE.

Added by Amendment 50

WATTS BAR NUCLEAR PLANT FINAL SAFETY ANALYSIS REPORT
ERCW PIPELINE SECTION A-A SHEET 1 OF 4 FIGURE 2.5-571

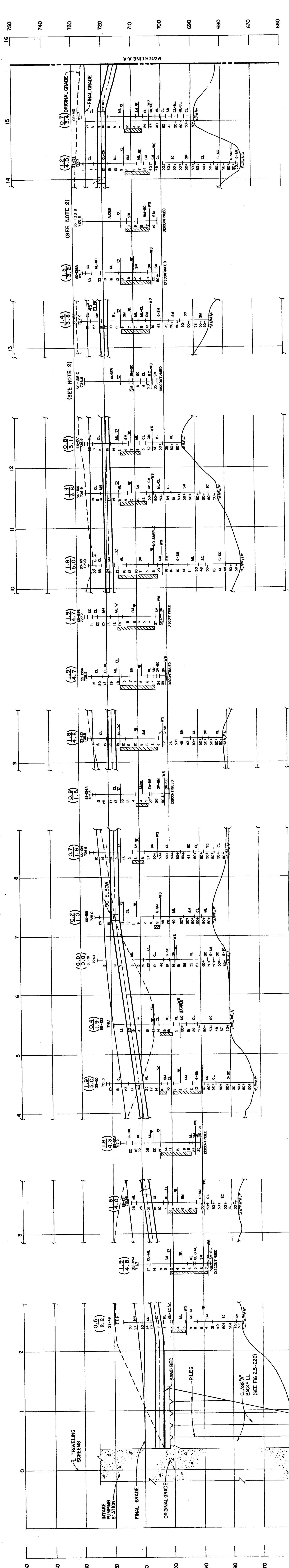

A - A