



**LOURDES**  
HEALTH SYSTEM

*Our Lady  
of Lourdes  
Medical Center*

**OUR LADY OF LOURDES  
MEDICAL CENTER**  
1600 Haddon Avenue  
Camden, NJ 08103  
(856) 757-3500  
Fax (856) 757-3611

October 21, 2008

Br. 1

**CORPORATE OFFICE**  
1600 Haddon Avenue  
Camden, NJ 08103  
(856) 757-3500  
Fax (856) 757-3611

**U.S. Nuclear Regulatory Commission  
Region 1  
Attention: Medical Licensing Section  
475 Allendale Road  
King of Prussia, PA 19406-1415**

**LOURDES MEDICAL  
CENTER OF  
BERLINGTON COUNTY**  
218 A Street Road  
Willingboro, NJ 08046  
(609) 835-2000  
Fax (609) 835-3061

**RE: License No. 29-06431-01** 03002488

Dear Sir/Madame,

**LOURDES HOMEHEALTH  
SERVICES**  
900 Haddon Avenue  
Suite 316  
Collingswood, NJ 08108  
(856) 869-0900  
Fax (856) 869-0311

This letter is being written as notification that there will be a new area of use for cardiac imaging here at the medical center. Enclosed please find the architect drawing of the new area. This area will be located on the basement level of the North side. A closeout survey of the old area will be performed prior to release of this area for non-radioactive use and the results kept on file in the Nuclear Medicine Department.

**LOURDES HEALTH  
FOUNDATION**  
1600 Haddon Avenue  
Camden, NJ 08103  
(856) 757-3301  
Fax (856) 757-3745

If you have any questions, or require any additional information, please do not hesitate to contact me.

P.O. Box 2520  
Willingboro, NJ 08046  
(609) 835-3050  
Fax (856) 757-3745

Sincerely,

[www.lourdesnet.org](http://www.lourdesnet.org)

**Mark Bateman  
Chief Executive Officer  
Our Lady of Lourdes Medical Center**

Cc: Michael P. Nunno, Radiation Safety Officer

RECEIVED  
REGION 1  
2008 OCT 23 PM 12:26

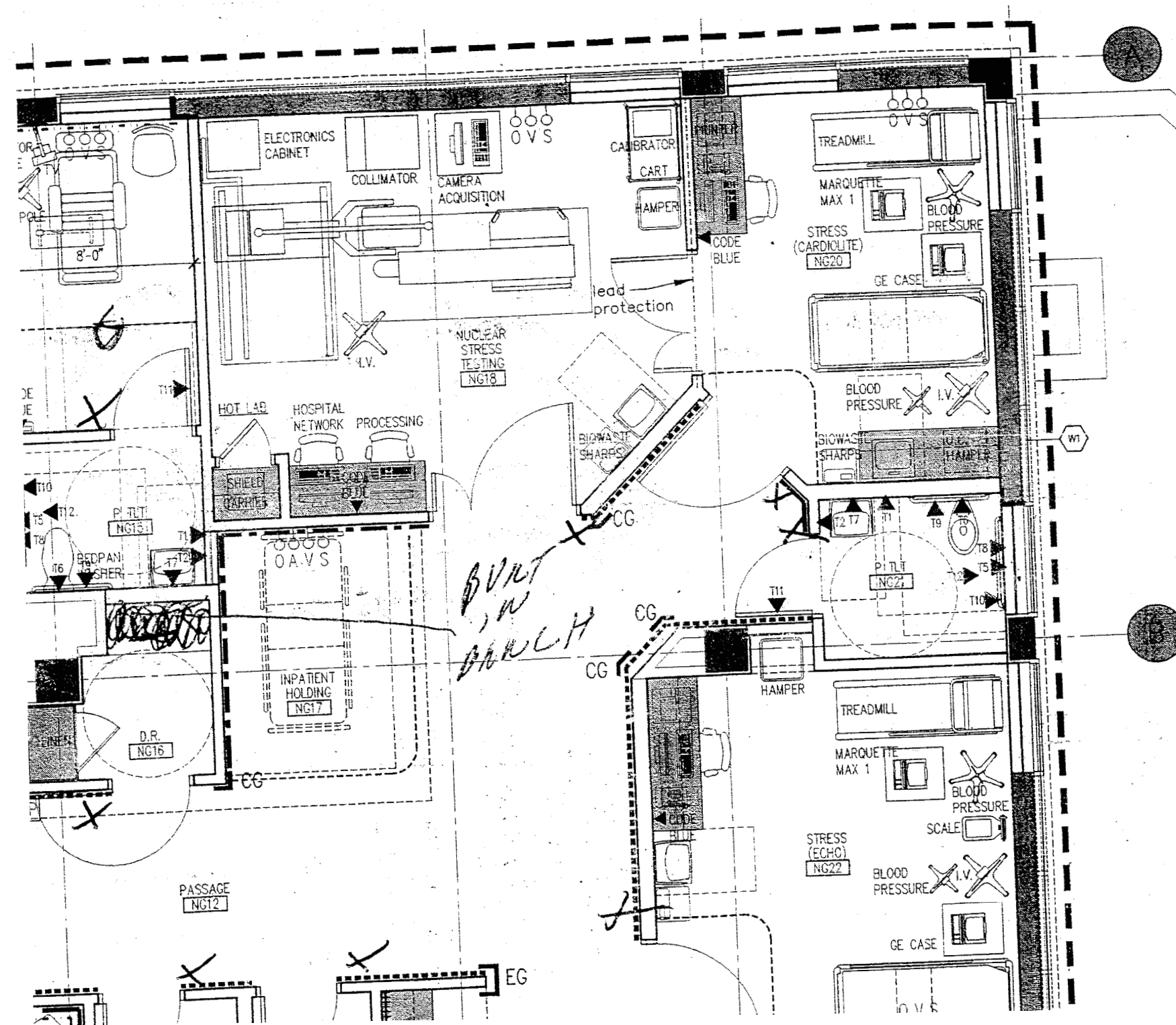

This is to acknowledge the receipt of your letter/application dated

10/21/08, and to inform you that the initial processing which includes an administrative review has been performed.

☒ Notification (29-06431-01)  
There were no administrative omissions. Your application was assigned to a technical reviewer. Please note that the technical review may identify additional omissions or require additional information.

☐ Please provide to this office within 30 days of your receipt of this card

A copy of your action has been forwarded to our License Fee & Accounts Receivable Branch, who will contact you separately if there is a fee issue involved.

Your action has been assigned **Mail Control Number** 142940.  
When calling to inquire about this action, please refer to this control number.  
You may call us on (610) 337-5398, or 337-5260.