



C E N T R A

Alan B. Pearson
Regional Cancer Center

1701 Thomson Drive
Lynchburg, Virginia 24501

PHONE: 434.200.4522
WEB: www.centrahealth.com

September 29, 2008

6-8

U.S. NRC Region 1
475 Allendale Road
King of Prussia, PA19406-1415

Attn: Ms Sandy Gabriel

RECEIVED
REGION 1
OCT - 6 PM 1:05

03003309

- Subject:**
- 1) Request for Addition of an Authorized User for NRC License #45-022070-07 01 RLT
 - 2) Add areas of use in The Cardiology Group-Farmville office
 - 3) Addition of new location for The Cardiology Group-Moneta

Dear Ms. Gabriel,

We would like to request approval for a new physician to be listed as an authorized user on our NRC license (#45-02207-01). Her name is Dr. Melanie Helene Hodge. Please add her to our license as an Authorized User for 10 CFR Part 35.100, Part 35.200, and Part 35.300 Oral administration of sodium iodide I-131 requiring a written directive in quantities less than or equal to 1.22 gigabecquerels (33 millicuries). Dr. Hodge is certified by The American Board of Radiology. She has provided us with a preceptor attestation letter and forms documenting her training, work experience, and an I-131 therapy log (see attached). Dr. Hodge received unanimous approval by the Radiation Safety Committee.

We would like to request two additional areas of use in The Cardiology Group-Farmville office. The room labeled "Echo" will be used for injections of the isotope during the treadmill portion of the exam (see diagram #10). Adjacent to the Echo room is a physician's office and hallways. The room labeled "Exam Room #2" will be used when necessary for injections of isotope for the resting images. Adjacent to Exam Room #2 is a Conference Room, an entry in the Staff Lounge, and hallway areas.

Lastly, we would like to request an additional location of use for The Cardiology Group in Moneta, VA (see diagram #14) on our license #45-02207-01. Centra is opening a new satellite cardiology office located at 1039 Mayberry Crossing Drive, Suite C, Moneta, VA 24121. The official name of the office is The Cardiology Group-Moneta. This office will perform diagnostic nuclear cardiology procedures. We would like to request authorization to use radionuclides that are found in 10 CFR 35.200. This department has one gamma

142796
NRCSS/RGN MATER. ALS-002



camera. All isotopes are delivered to the department in unit doses. There is a hotlab that is housed in the Nuclear Medicine Suite. There is 1/16th inch lead in the wall between the hotlab and the restroom in the Nuclear Medicine Suite. This hotlab will be locked at all times and have limited access. The door will be posted in accordance with 10 CFR 20.1902(e). The walls of the Nuclear Medicine room are lined with 1/16th inch lead (see diagram #14). Small lead pigs will be used to shield specific sources in the work area. There will be a storage cabinet in the hotlab. The workspace above the cabinet will be lined with absorbent pads. Sources will be stored for decay in lead lined containers. Adjacent to the Nuclear Suite are exam rooms, a janitor's closet, public restrooms and the stress treadmill testing room. The injections given for the stress portion of the cardiac protocol will be given in the room labeled "Stress Treadmill". The injections given for the resting portion of the cardiac protocol will be given in the Nuclear Medicine Suite, the Stress Treadmill room, or the Digital X-ray room. Adjacent to the Stress Treadmill room are Exam Room #1, an Ultrasound Room, and the Digital X-ray room. Adjacent to the Digital X-ray room are the Nurses Station and the Stress Treadmill room. Check sources for the dose calibrator and a flood source for the camera will be purchased and shipped to this facility once we receive this amendment to our license.

The new satellite cardiology office is solely owned by Centra. There was no merger or transfer of stock or assets. There are no changes to personnel or duties that relate to the licensed program. Our surveillance program including all surveys, wipe test, and quality control measures will remain the same. Our program will continue to abide by the same constraints, conditions, and requirements.

If you have any questions or need further information please call Dana Duffield or Brian Hames at (434) 200-4010. Thank you for your assistance in this matter.

Sincerely,

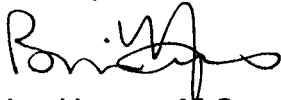
A handwritten signature in black ink, appearing to read "Brian Hames", with a stylized flourish at the end.

Brian Hames, M.S.
Director of Physics
Radiation Safety Officer

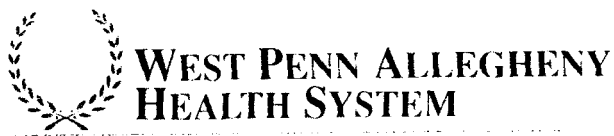

320 EAST NORTH AVENUE, PITTSBURGH, PA 15212
412-359-3131

September 18, 2008

Dear Madam or Sir:

I attest that Dr. Melanie H. Hodge has satisfactorily completed the requirements in 10 CFR 35.290 (a)(1), and has achieved a level of competency sufficient to function independently as an authorized user for the medical uses authorized under 10 CFR 35.100 and 35.200.

I attest that Dr. Hodge has satisfactorily completed the 80 hours of classroom and laboratory training, as required by 10 CFR 35.392(c)(1), and the supervised work and clinical case experience required in 35.392(c)(2).

I attest that Dr. Hodge has satisfactorily completed the required clinical case experience required in 35.390(b)(1)(ii)G for administration of oral NaI-131 requiring a written directive in quantities less than or equal to 1.22 gigabecquerels (33 millicuries).

I attest that Dr. Hodge has satisfactorily achieved a level of competency to function independently as an authorized user for the administration of oral NaI-131 requiring a written directive in quantities less than or equal to 1.22 gigabecquerels (33 millicuries).

Please feel free to contact me at (412) 359-8762 or snayak@wpahs.org if you require any additional information.

Sincerely,

A handwritten signature in black ink that reads "Shanteri U. Nayak". The signature is written in a cursive style.

Shanteri U. Nayak, M.D.
Division of Nuclear Medicine
Allegheny General Hospital
NRC License No. 37-01317-01

SN/lwf

The American Board of Radiology

Organized through the cooperation of the
American College of Radiology, the American Roentgen Ray Society,
the American Radium Society, the Radiological Society of North America,
the Section on Radiology of the American Medical Association,
the American Society for Therapeutic Radiology and Oncology, the Association of
University Radiologists, and American Association of Physicists in Medicine
Hereby certifies that

Melanie Helene Hodge, MD

Has pursued an accepted course of graduate study
and clinical work, has met certain standards and qualifications and
has passed the examinations conducted under the authority of

The American Board of Radiology

On this sixth day of June, 2007

Thereby demonstrating to the satisfaction of the Board
that she is qualified to practice the specialty of

Diagnostic Radiology

AM Eligible



Certificate No. 53992

Ray O. Anderson, MD
President

Lith Eichen
Secretary-Treasurer

R.P. Hatten, MD
Executive Director

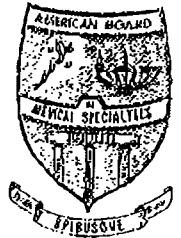

Valid through 2017

Form A

American Board of Radiology – Program Director Attestation

COMPLIANCE WITH NRC TRAINING AND EXPERIENCE REQUIREMENTS

More information can be found at the following link:

http://www.nrc.gov/readingrm/disp_collections/cfr/cfr035-part035-0290.html

Melanie Helene Hodge MD
Resident Name

DIAGNOSTIC RADIOLOGY 420 412 1176
Program Program #

- | | YES | NO |
|---|-------------------------------------|--------------------------|
| By the time of the ABR oral examination, this applicant will have successfully completed the hours of training and experience as outlined in 10 CFR 35.290 and 35.392..... | <input checked="" type="checkbox"/> | <input type="checkbox"/> |
| This applicant has taken part in ≥ 3 cases of oral administration of I-131 therapy (≤ 33mCi)..... | <input checked="" type="checkbox"/> | <input type="checkbox"/> |
| The resident's logbook of these therapy experiences (date, dose, and preceptor) is attached..... | <input checked="" type="checkbox"/> | <input type="checkbox"/> |
| The work and experience cited above for § 35.290 was obtained under the supervision of an Authorized User (AU) who meets the requirements under relevant sections of § 35.290 or equivalent Agreement State requirements..... | <input checked="" type="checkbox"/> | <input type="checkbox"/> |
| The work and experience cited above for § 35.392 was obtained under the supervision of an Authorized User (AU) who meets the requirements under § 35.390, 35.392 or 35.394 or equivalent Agreement State requirements..... | <input checked="" type="checkbox"/> | <input type="checkbox"/> |

MELANIE B. FURUI, M.D.
Residency Program Director
(Print Name)

[Signature]
Program Director
(Signature)

4/23/07
Date

*forwarded to
520-790-3200
on 4/24/07*

Form B

I-131 Therapy Experience

Melanie Helene Hodge, MD
Resident Name

DIAGNOSTIC RADIOLOGY - 420 412 117
Program & Number

<u>Date</u>	<u>Dose Administered</u>	<u>Preceptor (AU) Print & Sign Name</u>
1. <u>5/10/06</u>	<u>12 mCi I¹³¹</u>	<u>Akash Sharma, MD</u> Print Name <u>Akash Sharma</u> Sign Name
2. <u>5/12/06</u>	<u>10.87 mCi I¹³¹</u>	<u>Akash Sharma, MD</u> Print Name <u>Akash Sharma</u> Sign Name
3. <u>1/19/07</u>	<u>23.0 mCi I¹³¹</u>	<u>Akash, Sharma, MD</u> Print Name <u>Akash Sharma</u> Sign Name
4. <u>1/16/07</u>	<u>17 mCi I¹³¹</u>	<u>Shanteri Umesh Nayak, MD</u> Print Name <u>Shanteri U. Nayak</u> Sign Name

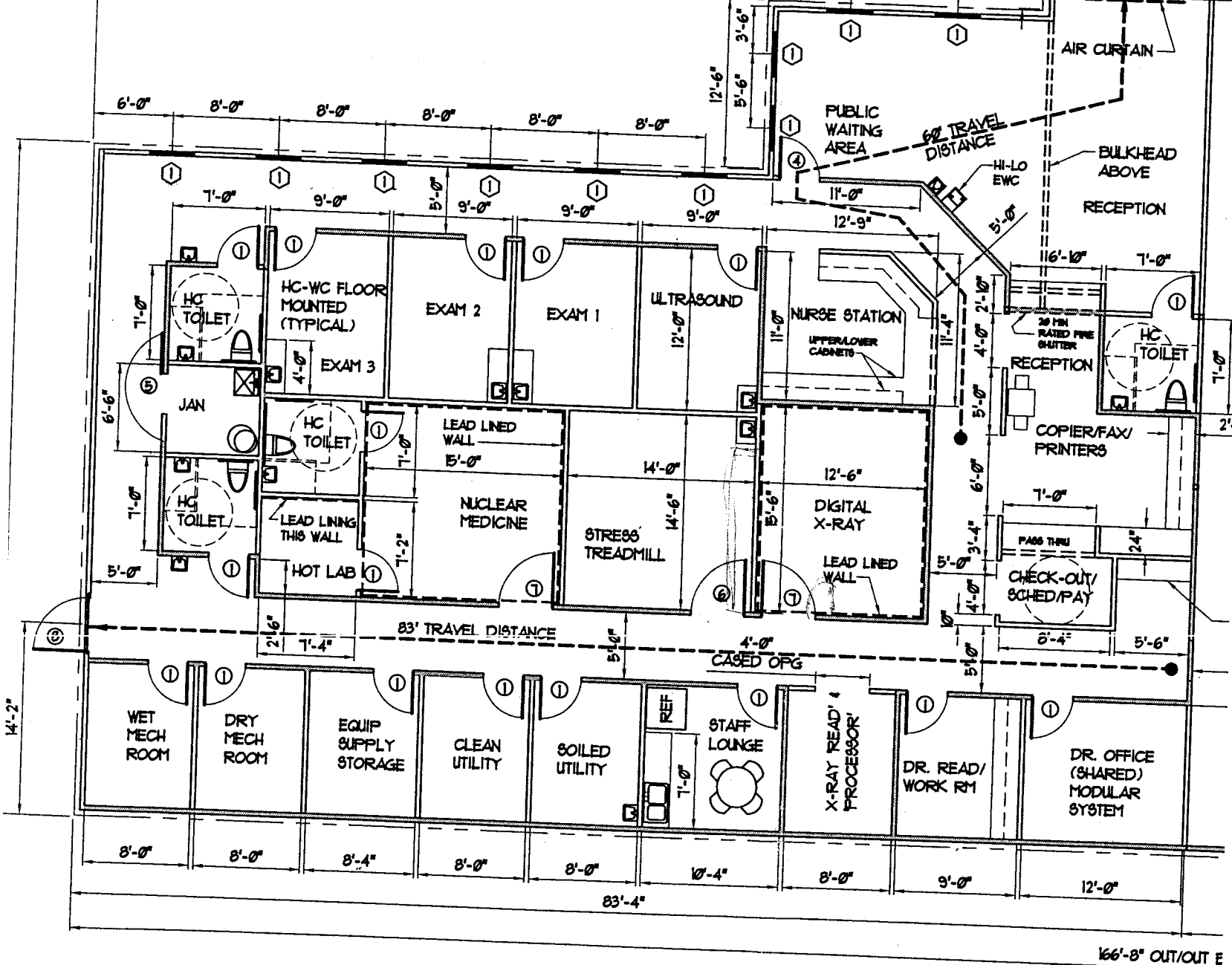

FLOOR PLAN

SCALE: 1/8" = 1'-0"

The Cardiology Group - Moneta
Diagram #14.

Cardiology Group of Farmville

The Cardiology Group Farmville Office

Diagram # 10

000076

