

R 76 W

CAMPBELL COUNTY

T 44 N

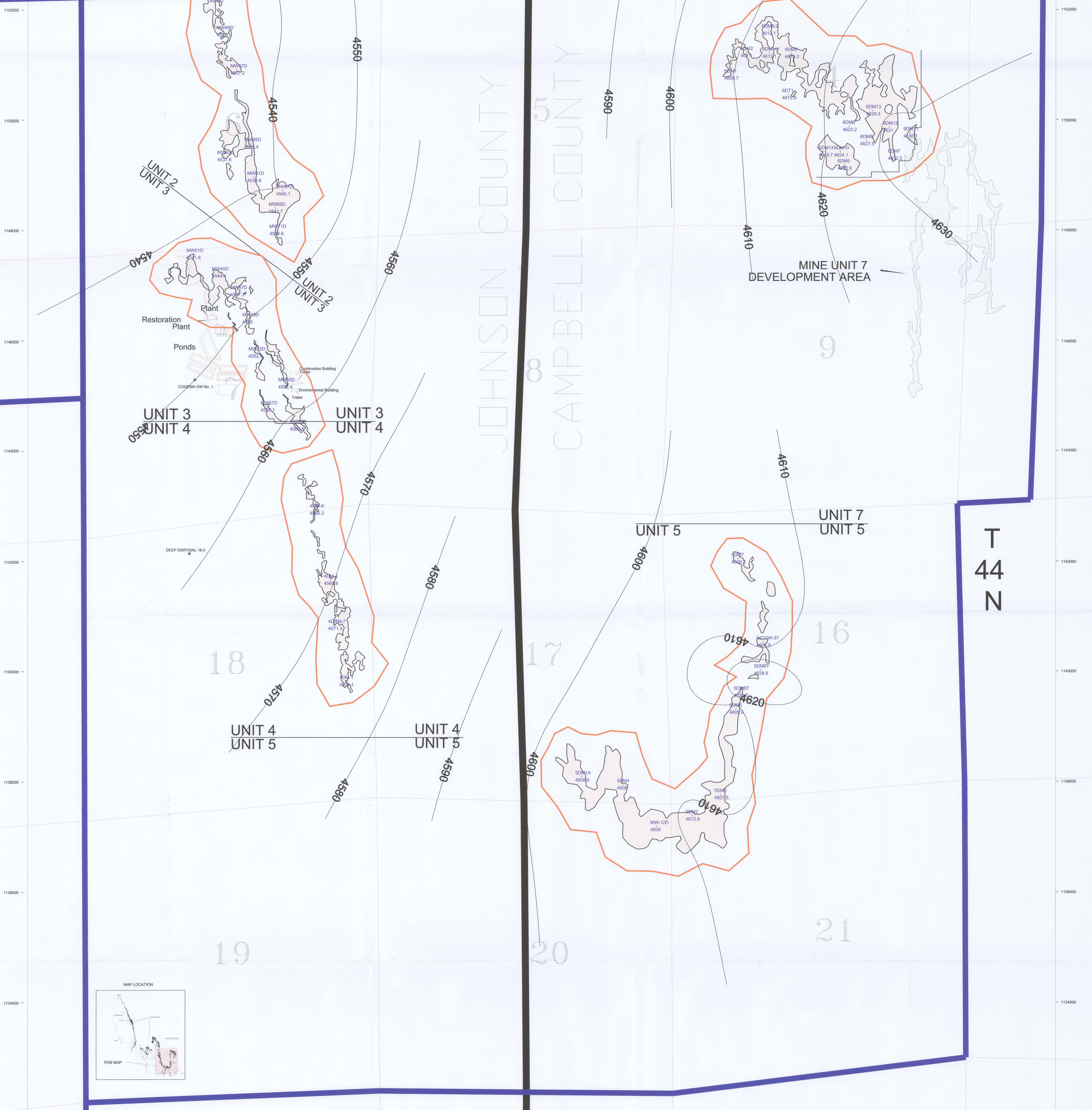

UNIT 2
UNIT 3

UNIT 2
UNIT 3

UNIT 3
UNIT 4

UNIT 3
UNIT 4

UNIT 4
UNIT 5

UNIT 4
UNIT 5

UNIT 4
UNIT 5

UNIT 4
UNIT 5

UNIT 4
UNIT 5

UNIT 4
UNIT 5

UNIT 4
UNIT 5

MINE UNIT 7
DEVELOPMENT AREA

UNIT 5

UNIT 7
UNIT 5

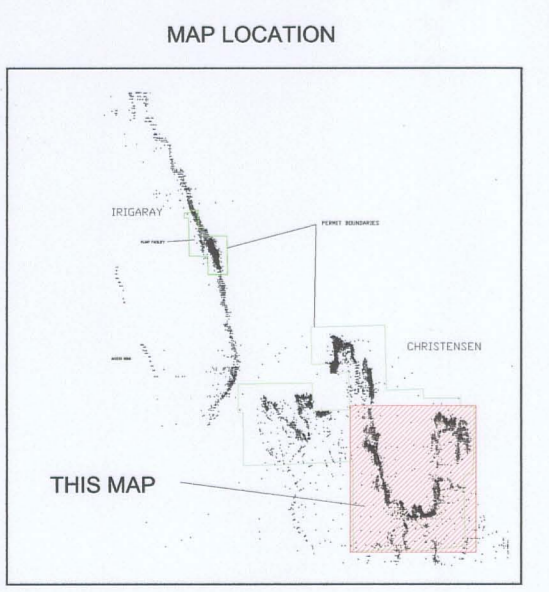

LEGEND

- PERMIT BOUNDARY
- SECTION LINES
- Well #
- Well Piezometric Elevation
- 10' Piezometric Contours

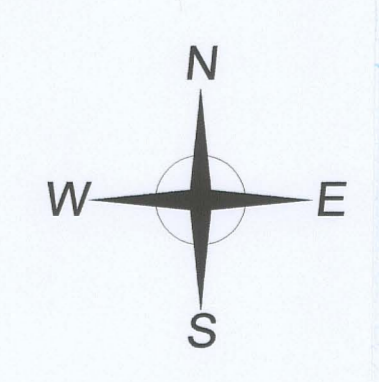
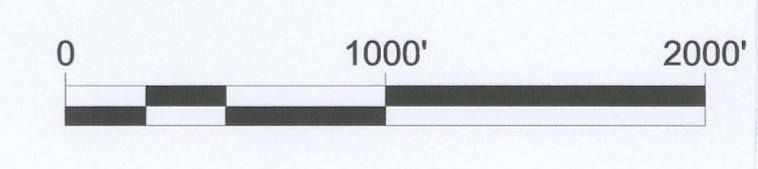

AREVA **COGEMA**
Mining, Inc.
Christensen Project

Deep Zone Piezometric Map
of Mine Units 2 through 6
Permit to Mine No. 478
Piezometric Levels Taken June 2008

Geology:
Erwin L. Arbogast
Drafting: RMO
Date: 8-11-2008
Revision:

State: Wyoming County: Johnson
Scale: 1"=600'
Drawing ID: CR-Deep Zone.dwg

D-06