

645 Barclay Circle
Rochester Hills MI 48307
248-844-1010 x 204 Phone
248-844-9089 Fax
248-396-5336 Cellular

**Cardiology &
Vascular Assoc. PC**

Fax

To: US NRC	From: Joe Mueller, RSO
Fax: 630-515-1078	Pages: 6 + cover
Phone:	Date: 05/16/2008
Re: NRC Lic. # 21-3217701	CC:

Urgent For Review Please Comment Please Reply Please Recycle

This facsimile transmission contains information, which is confidential and/or privileged. This information is intended for use only by the addressee indicated above. If you are not the intended recipient, please be advised that any disclosure, copying, distribution, or use of the contents of this information is strictly prohibited, and that any misdirected or improperly received information must be returned to this company immediately. Your cooperation in phoning us of erroneous receipt is requested.

Thank you



Sincerely,

Joe Mueller, RSO



Cardiology and Vascular Associates, P.C.

Russell Steinman, M.D., F.A.C.C.
Rajendra Prasad, M.D.
Kirit C. Patel, M.D., F.A.C.C.
Divakar Pai, M.D., F.A.C.C.
Joe H. Yun, M.D., F.A.C.C.
Nishit Choksi, M.D., F.A.C.C.
Abdul Hasan, M.D., F.A.C.C.
Farouk Salah, M.D., F.A.C.C.
Sharath Chandra, M.D., F.A.C.C.
Michele DeGregorio, M.D., F.A.C.C.
Zakwan Makjoub, M.D., F.A.C.C.
Patrick D. Poole, M.D., F.A.C.C.
Randall Reher, M.D., F.A.C.C.
Abdul Halabi, M.D., F.A.C.C.
 www.cava.cc

May 15, 2008

United States Nuclear Regulatory Commission
 Region III, Materials Licensing
 2443 Warrenville Road, Ste 210
 Lisle, IL 60532-43521

Re: Amendment to NRC License No. 21-32177-01

Dear Madam or Sir:

We are requesting the following action as amendment to our Materials License 21-32177-01. The date of the transfer and termination is July 1, 2008.

TRANSFER OF CONTROL / LICENSE TERMINATION

We wish to request a "Transfer of Control" of the Materials License 21-32424-01, presently issued to Cardiovascular Consultants of Michigan, P.C. to our Materials License 21-32177-01. This should be followed by the termination of Materials License 21-32424-01. The reason for this simultaneous request is to prevent any disruption of clinical practice or patient care.

In support of this request we have enclosed the documentation required by Appendix G of NUREG-1558, Volume 9, Revision 2.

ADD LOCATION OF USE

We wish to add the following location of use presently under Materials License 21-32323-01; known as Cardiovascular Consultants of Michigan, P.C. We have enclosed a diagram of this facility for your review.

1695 W. 12 Mile Rd., Suite 245
 Berkley, MI 48072
 Phone (248) 582-1480
 Fax (248) 582-1484

43344 Woodward Ave.
 Bloomfield Hills, MI 48302
 Phone (248) 333-1170
 Fax (248) 333-1175

43097 Woodward Ave., Suite 202
 Bloomfield Hills, MI 48302
 Phone (248) 332-9432
 Fax (248) 332-9489

6770 Dixie Highway, Suite 103
 Clarkston, MI 48346
 Phone (248) 625-5550
 Fax (248) 922-1551

1261 S. Lapeer Rd., Suite 101
 Lake Orion, MI 48360
 Phone (248) 693-9522
 Fax (248) 693-7523

645 Barclay Circle
 Rochester Hills, MI 48307
 Phone (248) 844-1010
 Fax (248) 844-9089

1135 W. University, Suite 440
 Rochester Hills, MI 48307
 Phone (248) 608-3496
 Fax (248) 608-3973

67200 Van Dyke, Suite 203
 Washington, MI 48095
 Phone (586) 752-7575
 Fax (586) 752-0740

4000 Highland Rd., Suite 109
 Waterford, MI 48328
 Phone (248) 738-9500
 Fax (248) 738-9502

2300 Haggerty Rd., Suite 1030
 West Bloomfield, MI 48382
 Phone (248) 669-4207
 Fax (248) 669-4274

44555 Woodward Avenue
 Suite 202
 Pontiac, Michigan 48341

If you have any questions or require additional information, please contact our Medical Nuclear Physicist, Michelle Kritzman, M.S., DABR of Medical Physics Consultants, Inc. 800.321.2207.

Sincerely,

James Aluis, Exec. Director
 Cardiology and Vascular Asso.

John F. Cotant, M.D.
 Cardiovascular consultants of MI, P.C.

Consultation
 Surgical Cardio Clearance
 Stress Testing
 Nuclear Cardiology
 Heart Failure Clinic

Echocardiography
 Vascular Studies
 Cardio Catheterization
 Peripheral Vascular
 Interventions

Interventional Cardiology
 Coronary Angioplasty
 Atherectomy-Rotational
 Directional and Extraction
 Coronary Stents

Arrhythmia Management
 Pacemakers
 Implantable Defibrillators
 Holter monitoring
 Ablation

Heart Disease Prevention Center
 Lipid Management
 Nutrition Counseling
 Risk Factor



Cardiology and Vascular Associates, P.C.

TRANSFER OF CONTROL page (3)

44555 Woodward Avenue
Suite 202
Pontiac, Michigan 48341

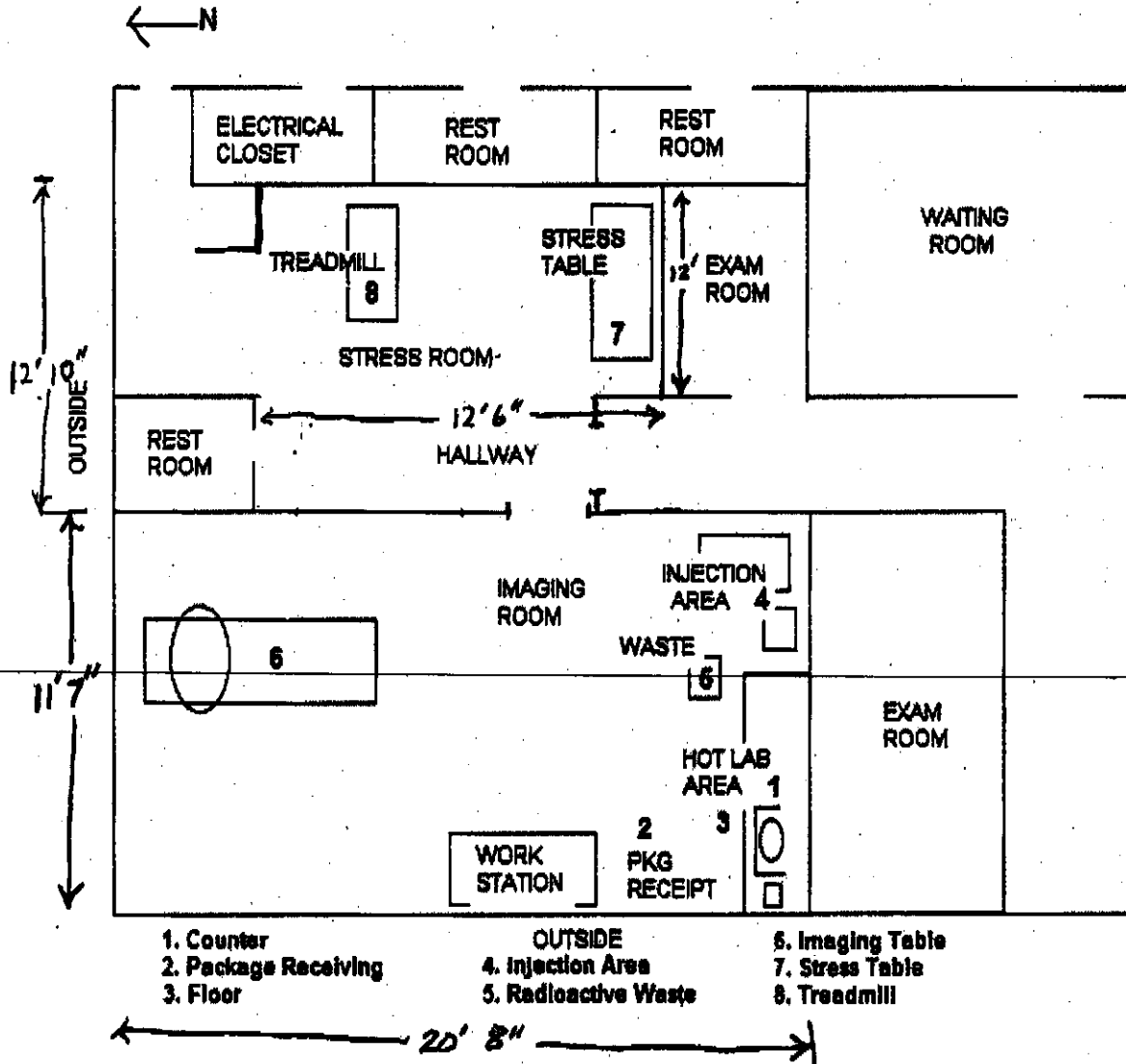

Directly above the department is medical office; gastroenterology
Directly below the department is medical office; plastic surgery & vascular surgery



Cardiology and Vascular Associates, P.C.

TRANSFER OF CONTROL PER INFORMATION APPENDIX G, NUREG-1556, VOL. 9, REV. 1

1. License No. 21-32424-01
Current name: Cardiovascular Consultant of Michigan, P.C.

The new name will be: *Cardiology and Vascular Associates*

The license contact name is Joseph Mueller, RSO 248.844.1010 x204

Transfer of all assets will be made due to sale of practice. Cardiology and Vascular Associates will obtain possession of the nuclear medicine camera, all radiation safety equipment and all sealed sources for the following location: 44555 Woodward Avenue Suite 202, Pontiac MI 48341. Cardiovascular Consultants of Michigan, P.C. will terminate its license. Sealed Source Inventory as of 4-29-2008 attached.

2. The current RSO and approved users for Materials License 21-32177-01 issued to Cardiology and Vascular Associates will be responsible for this address of use.
3. Cardiovascular Consultant of Michigan, P.C. will no longer operate once the transfer is complete. All nuclear medicine activities will be under Cardiology and Vascular Associates Materials License number 21-32177-01. Only diagnostic Nuclear Medicine studies will be performed under 35.200 at this address of use.
4. All required records regarding the use and possession of licensed materials will be current at the time of the transfer. The status of compliance will be maintained before, during and after the merger. All of the previous radioactive material records are maintained on site. New records regarding licensed material will be reviewed and shared as necessary for the Radiation Safety Officer of Cardiology and Vascular Associates.
5. All required documents and records are currently kept in accordance with the NRC regulations. These include, but are not limited to the annual calibration of survey instruments, semi-annual leak testing of non-exempt sealed radioactive sources, sealed source inventory, radiation monitoring and personnel exposure monitoring reports.
6. We confirm that the areas of storage, preparation, handling, and administration of radioactive materials are surveyed for acceptable radiation levels as well as for removable contamination. If contamination of these areas is detected during these surveys, decontamination is undertaken and completed at that time. The unsealed radionuclides in use at this location are all short-lived (i.e. half lives less than 65 days, most less than 10 days) and in unit doses. Therefore, radioactive contamination is highly unlikely at this facility. If contamination were present, it would be discovered prior to the transfer and decontaminated ALARA.



Cardiology and Vascular Associates, P.C.

TRANSFER OF CONTROL Page (2)

7. All activities conducted previously under 21-32424-01 will be conducted under the Radiation Protection Program, statements and conditions of Materials License 21-32177-01 issued to Cardiology and Vascular Associates.

Cardiology and Vascular Associates accepts full responsibility for the noted areas of use. This facility is exempt from providing financial assurance for decommissioning because of the type of radioactive materials used (i.e. short-lived, unsealed sources in small quantities only). Routine radiation monitoring of the facility ensures that contamination will not be transferred during any subsequent change of ownership.

All parties involved with the transfer are aware and agree to the planned transfer of ownership.

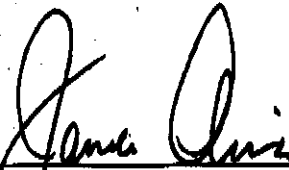

James Aluis, Executive Director
Cardiology and Vascular Associates
21-32177-01

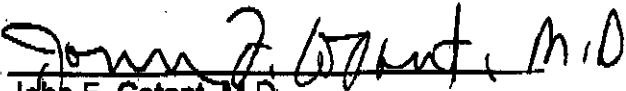

John F. Cotant, M.D.
Cardiovascular consultants of Michigan, P.C.
21-32424-01

Medical Physics Consultants, Inc.

Sealed Source Inventory

Licensee: Cardiovascular Consultants of Michigan

Date: 04/29/08

Performed by:

Laura Luna

Nuclide	Type	Calibration		Location	M/N	S/N
		Activity	Date			
Ba-133	Vial	264.7 uCi	01/01/03	Hot Lab	IPL	934-96-1
Current Activity: 186.40uCi						
Cs-137	Disk	10 uCi	09/02/07	Meter		1835
Current Activity: 9.849uCi						
Cs-137	Vial	203.8 uCi	12/01/02	Hot Lab	IPL	934-92-17
Current Activity: 179.85uCi						
Cs-137	Rod	0.5 uCi	12/01/02	Hot Lab	IPL	956-54-2
Current Activity: 0.441uCi						
Cs-137	Disk	10 uCi	09/02/07	Meter		1833
Current Activity: 9.849uCi						
Co-57	Flood	10 mCi	05/01/06	Imaging	NES 8496-10M	1155-033
Current Activity: 1.558mCi						

SEALED SOURCE AMBIENT EXPOSURE SURVEY

Meter:

Max Reading: 0.0 mR/hr

RADIATION SAFETY OFFICER: _____