



WESTERN NUCLEAR, INC.

2801 YOUNGFIELD, SUITE 340, GOLDEN, COLORADO 80401
TELEPHONE (303) 274-1767 FAX (303) 274-1762

April 29, 2008

Keith I. McConnell, Deputy Director
Division of Waste Management and Environmental Protection
Office of Federal and State Materials and Environmental Management Programs
U.S. Nuclear Regulatory Commission
Mailstop T8F5
Washington, DC 20555-0001

RE: Western Nuclear, Inc. Split Rock Mill; Addendum to As-Built Report for Reclamation of Groundwater Corrective Action Ponds, License SUA-56

Dear Mr. McConnell:

Please find enclosed for Nuclear Regulatory Commission (NRC) review the Quality Compliance Report verifying the rock mulch thickness for the former groundwater corrective action program (CAP) ponds. This submittal consists of a table of rock mulch thickness measurements and a figure depicting the location of those measurements. This information supersedes the rock mulch thickness data submitted in Appendix D of the subject as-built report that was submitted to the NRC by letter dated July 10, 2007. Additional rock has been placed on the CAP ponds area in response to NRC staff observations made during a site visit on September 19, 2007 regarding potentially insufficient rock mulch thickness at select locations. All thickness measurements met or exceeded the required 0.33 ft (4 inches).

If the NRC has any questions regarding this submittal please contact me or our technical consultant, Roslyn Stern (970-206-4223) at your convenience.

Sincerely,

Lawrence J. Corte

Enclosures

cc:

Brad DeWaard, WNI – Wyoming
Steve Hall, Stoller – Grand Junction
Harley Shaver, Esq.
Scott Surovchak, DOE
Anne Thomas, WNI – Golden

**Western Nuclear, Inc.
Split Rock Mill Site**

Quality Compliance Report
Rock Mulch Thickness Measurement Log

CAP Pond: 4 inches (.33 ft.) required

Inspector: C Spurlock

report date: April 10, 2008

Date & Initial	Northing	Easting	Thickness* (ft.)	note:
4/7/2008	4800	6800	0.41	
4/7/2008	4800	7000	0.39	
4/19/2007	5000	6600	0.33	
4/19/2007	5000	6800	0.50	
4/7/2008	5000	7000	0.34	
4/7/2008	5000	7200	0.37	
4/7/2008	5200	6200	0.33	
4/19/2007	5200	6400	0.39	
4/19/2007	5200	6600	0.36	
4/19/2007	5200	6800	0.35	
4/19/2007	5200	7000	0.40	
4/7/2008	5200	7200	0.34	
4/7/2008	5200	7400	0.36	
4/7/2008	5400	6200	0.35	
4/19/2007	5400	6400	0.35	
4/19/2007	5400	6600	0.34	
4/19/2007	5400	6800	0.36	
4/19/2007	5400	7000	0.40	
4/7/2008	5400	7200	0.40	
4/7/2008	5400	7400	0.47	
4/7/2008	5600	6400	0.43	
4/19/2007	5600	6600	0.38	
4/19/2007	5600	6800	0.38	
4/7/2008	5600	7000	0.41	
4/7/2008	5600	7200	0.33	
4/7/2008	5800	6400	0.33	
4/7/2008	5800	6600	0.35	
4/7/2008	5800	6800	0.33	
4/7/2008	5800	7000	0.42	

*Indicates top of grade stake distance above borrow soil layer.

Exact rock elevation measurement impractical due to surface irregularities

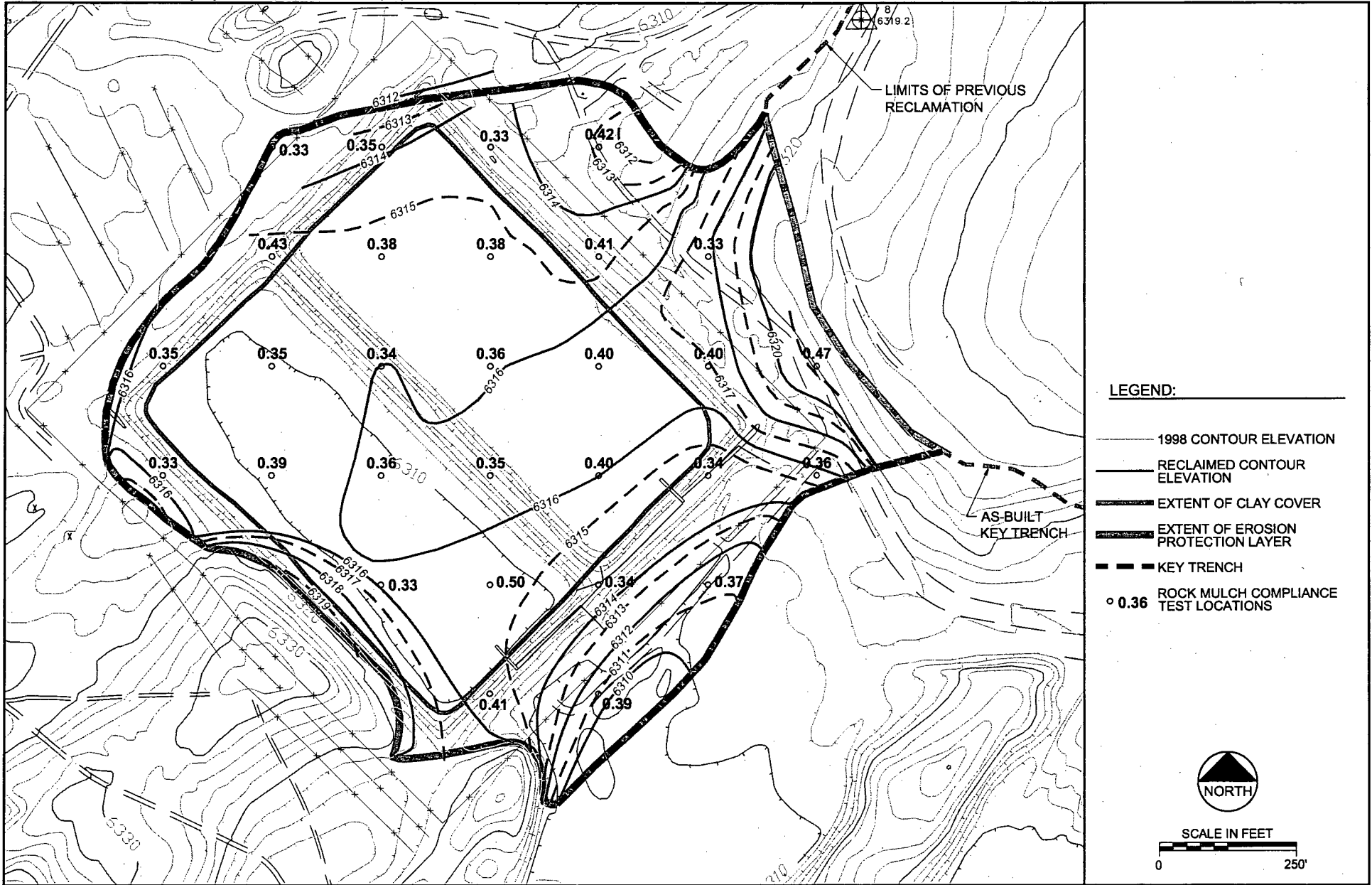

Figure 1
Rock Mulch Compliance
Test Locations