



ST. JOHN'S

ST. JOHN'S HOSPITAL
1235 EAST CHEROKEE STREET ■ SPRINGFIELD, MISSOURI 65804-2263
417-820-2000 ph.

04/23/2008

Materials Licensing
US NRC Region III
2443 Warrenville Road Suite 210
Lisle, IL 60532-4352

ATTN License reviewer:

This letter is a request a new location of use for 35.200 for cardiovascular clinical procedures to our NRC license number 24-00866-02.

Specifically we are planning to move the clinical cardiovascular activities currently listed under location of use 10F (St Johns Clinic Cardiology, 1900 S National Ave, Suite 1960A Springfield, MO) to a new location. This location will perform the same clinical activities with the same authorized users and same clinical staff as currently performed on our license.

This new location is on the same campus as the main hospital and is within short walking distance. It is also physically connected with the location of use 10C (St Johns Cancer Center) currently listed on our license. The new facility name and address are as follows.

St John's Clinic-Cardiology Ancillary Services
2115 S. Fremont Suite 4000
Springfield, MO 65804

I have submitted a floor plan of this new location which will utilize unit dose as is currently being done. They will maintain the same quality control and radiation safety procedures as they are currently performing. When designing the new suite I elected to shield (1/16 inch lead) location 4069 for radiation safety and camera cross talk purposes due to the short distances. Additionally I shielded (1/16 inch lead) location 4073 due to the high occupancy and short distances. All radioactive material stored and utilized in the hot lab room 4075 will be shielded utilizing lead lined storage and waste containers as well as a lead lined L-Block and lead bricks. Using these appropriate safety devices negates the need to lead line the walls of this location.

Both passages into the Nuclear Medicine suite as well as the door into the hot lab will contain security locks allowing the location to be properly secured when not occupied by trained staff.

RECEIVED APR 25 2008

After we have moved the current activities out of the 1900 S National, Suite 1960A location, I will perform the required close out survey and submit the request to remove this location from our license.

This amendment request is time sensitive since the plan is to move to the new location in early to mid June.

If you have any questions regarding this request, please contact me at 417-820-7704.

Sincerely,

A handwritten signature in black ink that reads "Nick Lannutti". The signature is written in a cursive style with a long horizontal flourish extending to the right.

Nick Lannutti., MS
Radiation Safety Officer
Department of Nuclear Medicine
St Johns Hospital-Springfield

Enclosure: Map of the new Nuclear Cardiology suite

St Johns Clinic - Cardiology Anomaly Services
2115 S Fremont Suite 4000
Springfield MO 65804

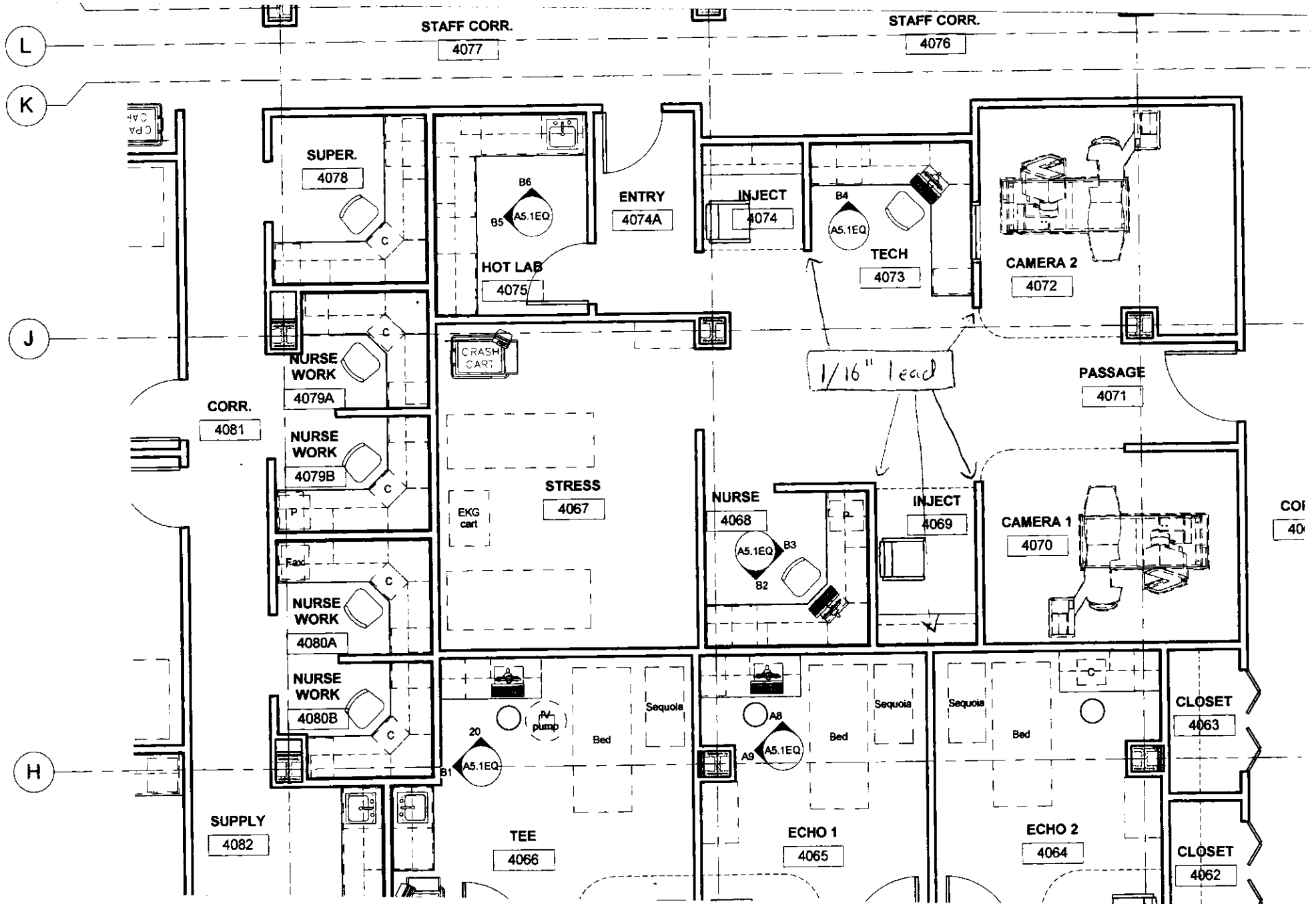

FedEx

Express

FZ 0
RT 595 D
04.25 9628

The WC

FedEx. US Airbill

Express Tracking Number 8596 9115 9628

1 From This portion can be removed for Recipient's records.

Date 4-24-08 FedEx Tracking Number 859691159628

Sender's Name Nick Lanzetta Phone 417 853 2000

Company ST JOHN'S REGIONAL HEALTH

Address 1235 E CHROME ST
City SPRINGFIELD State MO ZIP 65714-2203

2 Your Internal Billing Reference

3 To

Recipient's Name Materials Licensing Phone 301 415 7000

Company US NRC Region III

Recipient's Address 2443 Warrenville Rd Suite 210
City Lisle State IL ZIP 60532-4352

Recipient's Copy

4a Express Package Service

FedEx Priority Overnight
Next business morning. Friday shipments will be delivered on Monday unless SATURDAY Delivery is selected.

FedEx St
Next business Saturday Del

FedEx 2Day
Second business day. Thursday shipments will be delivered on Monday unless SATURDAY Delivery is selected.

FedEx E
Third business day.

4b Express Freight Service

FedEx 1Day Freight*
Next business day. Friday shipments will be delivered on Monday unless SATURDAY Delivery is selected.

FedEx
Second business day.

5 Packaging

FedEx Envelope* FedEx Pak*
Includes FedEx Small Pak, FedEx Large Pak, and Flat Pak.

6 Special Handling

SATURDAY Delivery
Not available for FedEx Standard Overnight, FedEx First Overnight, FedEx Express Saver, or FedEx 3Day Freight.

HAZ
Not a FedEx

Does this shipment contain dangerous goods? See box next to be checked.

No Yes Yes
Shipper's Declaration. Check not req.

Dangerous goods (including dry ice) cannot be shipped in FedEx.

7 Payment Bill to: Sender Recipient

Total Packages Total Wt

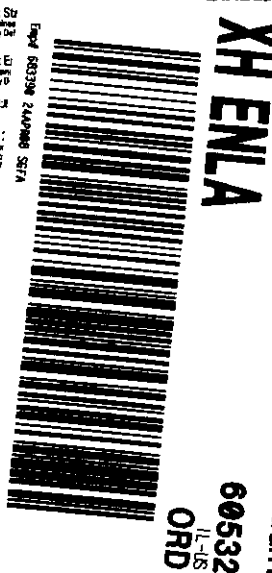

FedEx
8596 9115 9628
STANDARD OVERNIGHT
FRI - 25 APR A2



8 NEW Residential Delivery Signature Options If you require a signature:

No Signature Required
Packages may be left without obtaining a signature for delivery.

Direct Signature
Requires all recipient's address may sign for delivery. Fee applies.

Indirect Signature
If no one is available at recipient's address, anyone at a neighboring address may sign for delivery. Fee applies.

519