



4-21-08

United States Nuclear Regulatory Commission  
Region III, Materials Licensing  
2443 Warrenville Road Suite 210  
Lisle, IL 60532-4352

RE: Delete an Authorized User and new department diagram.  
**NRC License No. 21-20250-01**  
**Facility Name - Cheboygan Memorial Hospital**

Dear Sir/Madam:

The purpose of this letter is to notify you of the changes to our current NRC license.

**Item #1.** Please delete the following physician to our current NRC license.

**Daniel Schultz, D.O.          Group 35.100 and 35.200**

**Item #2.** Please find the enclosed diagram for the remodeling of our facility.

- Please note the north direction and room dimensions listed on the enclosed area diagram.
- The door to the hot lab will be under lock and / or key at all times. Only nuclear medicine technologists and the RSO will have access to the keys and/or combination to the hot lab.
- Please note that the camera room is in a different location within the hospital. The stress lab will move into the current Nuclear Medicine department. Upon receiving your approval for the new area, we will relocate the camera room and the stress lab. Additionally, we will perform the close-out of the current stress lab.
- Please note there are no room numbers throughout the department.

Thank you for your cooperation. If you have any questions or require additional information, please contact our medical physics consultant, Kevin B. Miller at 734-662-3197.

Sincerely,

  
Beth Ann Daugherty, RN, BSN, MPH  
Senior Vice President / COO

RECEIVED APR 23 2008

# CHEBOYGAN MEMORIAL HOSPITAL

748 South Main Street

Cheboygan, MI 49172

NRC License No. 21-20250-01

## Camera Room and Control Room

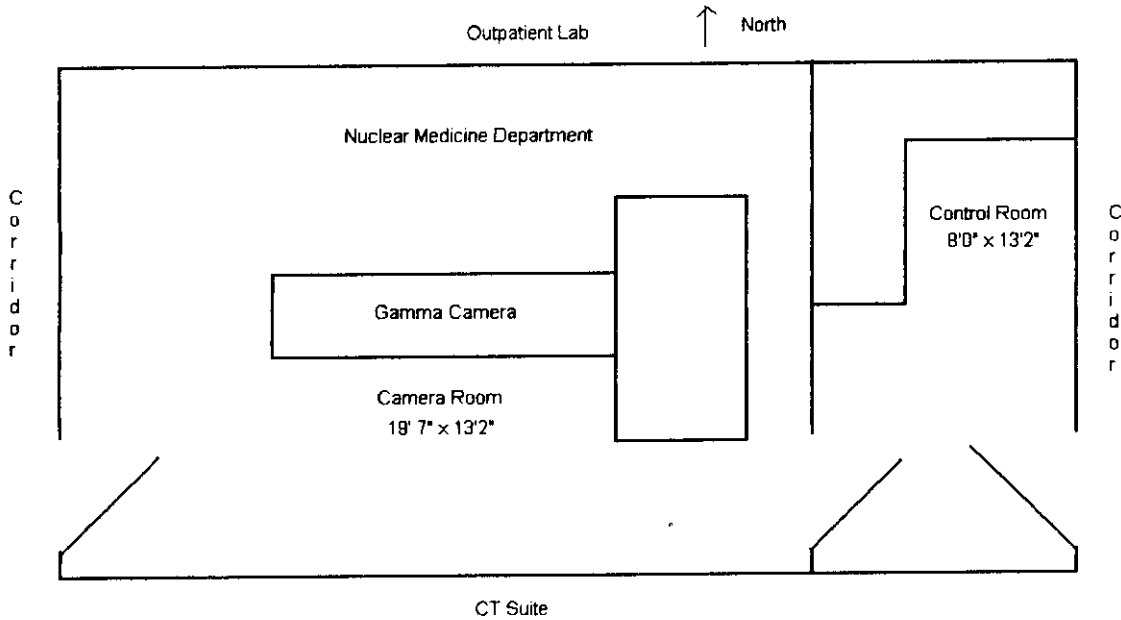

Directly below the nuclear medicine department is cement slab.

Directly above the nuclear medicine department are inpatient rooms.

## Stress Lab and Hot Lab

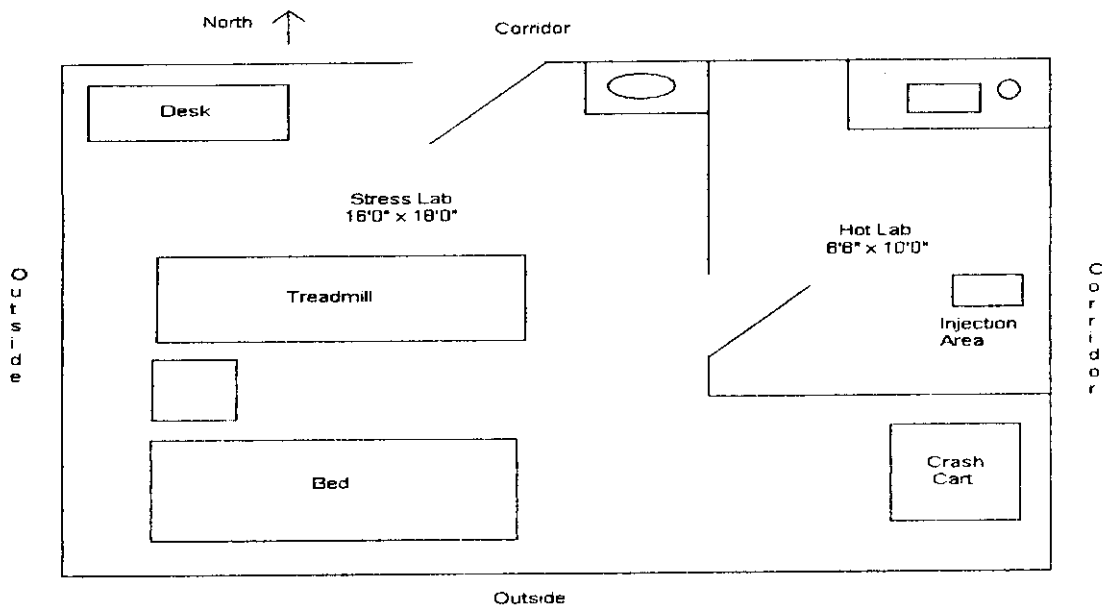

Directly below the Stress Lab and Hot Lab is cement slab.

Directly above the Stress Lab and Hot Lab is the roof.

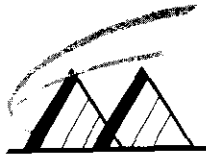

CHEBOYGAN MEMORIAL HOSPITAL  
748 South Main Street • PO Box 419  
Cheboygan, Michigan 49721

United States Nuclear Reg. Commission  
Region III  
Materials Licensing Branch  
2443 Warrenville Rd Suite 210  
Lisle, IL 60532-4352

FedEx  
1182  
0215 8336 6408 6750

WED - 23 APR A2  
PRIORITY OVERNIGHT

XH ENLA

60532  
IL-US  
ORD

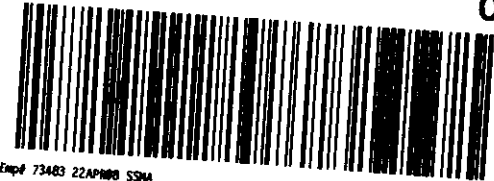

Exp# 73483 22APR08 SSMA

821  
1000

FedEx. USA Airbill  
Express

8336 6408 6750

1 From This portion can be removed for recipient's records.  
Date 4.22.08  
Sender's Name Kristy Smolinski  
Company CHEBOYGAN MEMORIAL HOSPITAL  
Address 748 S MAIN ST  
City CHEBOYGAN

FedEx Tracking Number 8336 6408 6750  
Phone 231 627-1253  
State MI Zip 49721

RECIPIENT: PEEL HERE

2 Your Internal Billing Reference

3 To Recipient's Name

Company United States Medical Regulatory  
Address REGION III - MATERIALS LICENSING  
Address 2443 WARENVILLE RD SUITE 210  
City Lisle  
State IL Zip 60532-4352



8336 6408 6750

0211701813

4 Express Package Service

FedEx Priority Overnight  
 FedEx Standard Overnight  
 FedEx 2Day  
 FedEx Express Saver

4b Express Freight Service

FedEx 1Day Freight\*  
 FedEx 2Day Freight  
 FedEx 3Day Freight

5 Packaging

FedEx Envelope\*  
 FedEx Pak\*  
 Other

6 Special Handling

Signature Required  
 Signature Required at FedEx Location  
 Signature Required at FedEx Location  
 Signature Required at FedEx Location

Payment Method:  Recipient  Third Party  Credit Card  Cash/Check

Total Packages: [Redacted] Total Weight: [Redacted]

Release Signatures: [Redacted]

Recipient's Copy

Package up to 50 lbs.  
Delivery commitment only to last business day.

Package over 50 lbs.  
Delivery commitment only to last business day.

Declared value limit \$500

Signature Required at FedEx Location

Signature Required at FedEx Location

Signature Required at FedEx Location

Signature Required at FedEx Location

Signature Required at FedEx Location

Signature Required at FedEx Location

Insert  
airbill  
here



Want more? Go to [fedex.com](http://fedex.com), or call 1.800.GoFedEx for international shipments. Call your local FedEx office if you are outside the U.S.

© 2005 FedEx 155476/155475 REV 9/05 RT

RT 595 D  
0

04.23  
6750

447