



*Midwest Health Professionals, P.C.*

*Ishiwaka B. Kayembe, M.D.*

Colleen Carol Casey  
Materials Licensing Branch  
United States Nuclear Regulatory Commission  
Region III  
2443 Warrenville Road STE 210  
Lisle, Illinois 60532-4352  
Fax: 630-515-1078

License Number: 24-32391-01  
Docket No. 030-35989

Dear Colleen Carol Casey,

Enclosed is the close out Survey performed by NC Systems as required by the NRC. I believe all required information has been included. In the event of any questions, please call me at 314-799-5648.

Robert M Sweeney, CNMT  
Midwest Health Professionals  
115200 St. Charles Rock Rd.  
Suite 106,  
Bridgeton, MO 63033  
Cell: 314-799-5648  
Fax: 314-902-9329

3472 Bridgeland  
Bridgeton, Missouri 63044  
Telephone (314) 209-9331  
Fax (314) 209-9329

1034 Brentwood Blvd  
University Club Tower, Suite 960  
St. Louis, Missouri 63117  
Telephone (314) 209-9331  
Fax (314) 209-9329

224 S. Woods Mill Road  
Suite 580 - South  
Chesterfield, Missouri 63017  
(314) 434-1404

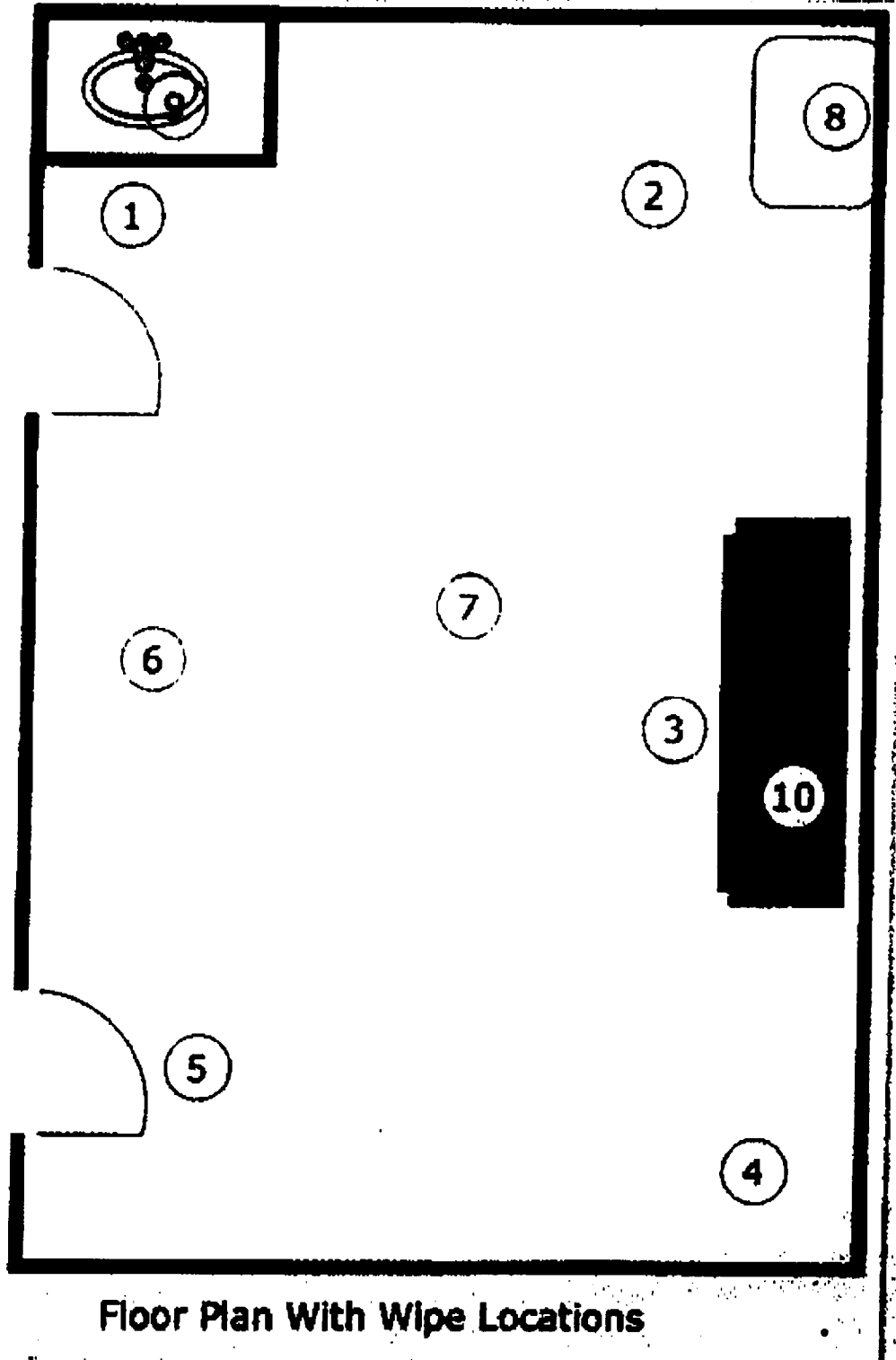

Floor Plan With Wipe Locations

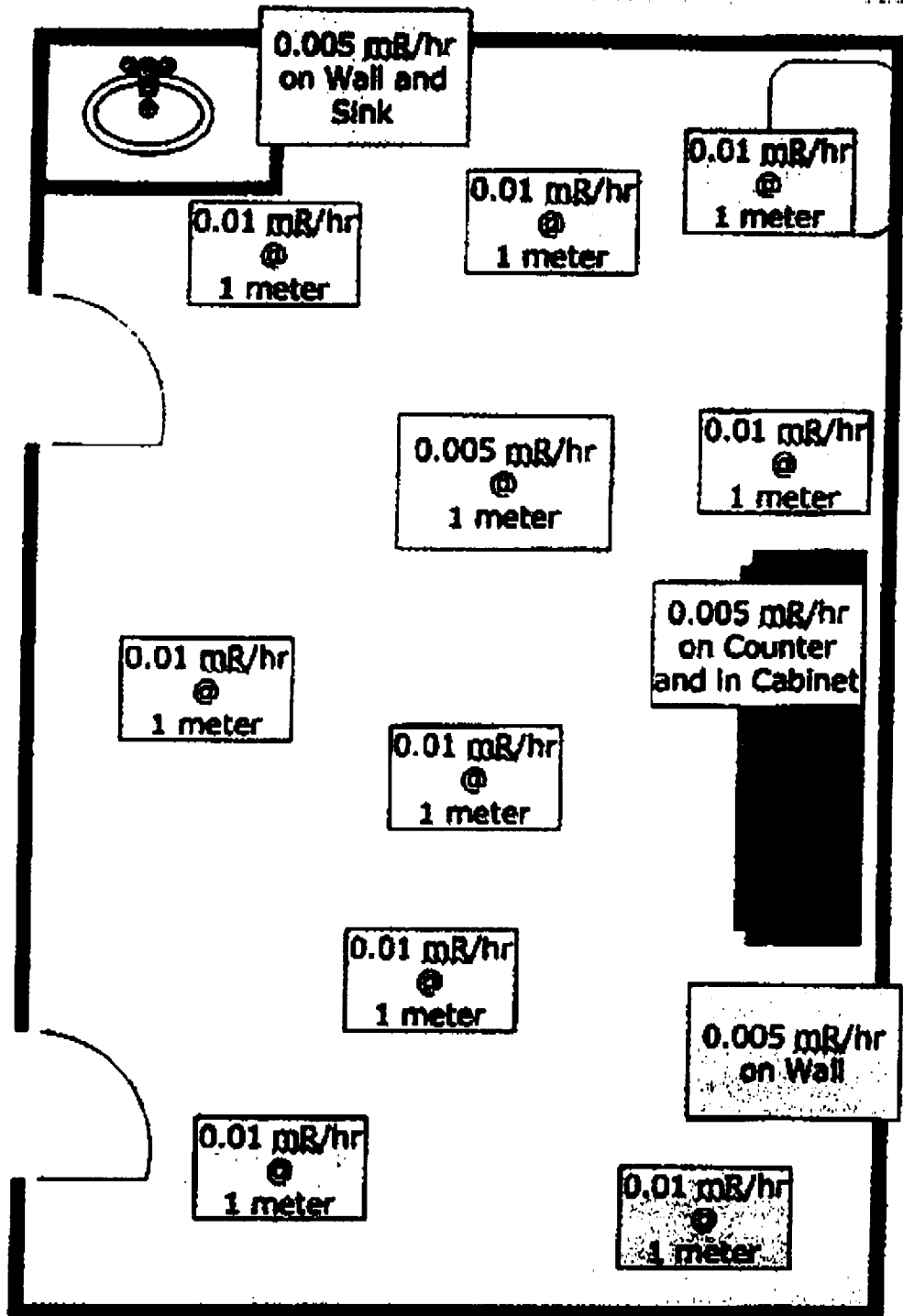

Floor Plan With Exposure Survey Results

Nuclear Cardiology Systems, Inc.  
National Laboratory  
5660 Airport Blvd., Suite 101  
Boulder, CO 80301

Wipe Results Report

Monday, February 11, 2008 11:39 AM

Area: WIPE

Unrestricted Area, RSO Trigger at 100% of Federal Guidelines, Well

Location: Bridgeton, MO Closeout Wipes of Camera and Hot Lab Room

| >LLD | >Trigger | Isotope     | Trigger  | LLD    | Background | Count Time | Activity |
|------|----------|-------------|----------|--------|------------|------------|----------|
| No   | No       | Wide Window | 2000 dpm | 62 dpm | 1877 dpm   | 60 sec.    | 0 dpm    |
| No   | No       | • Ba-133    | 200 dpm  | 35 dpm | 464 dpm    | 60 sec.    | -67 dpm  |
| No   | No       | • Co-57     | 2000 dpm | 8 dpm  | 91 dpm     | 60 sec.    | 2 dpm    |
| No   | No       | • Cs-137    | 200 dpm  | 27 dpm | 163 dpm    | 60 sec.    | 7 dpm    |
| No   | No       | • Tc-99m    | 2000 dpm | 9 dpm  | 79 dpm     | 60 sec.    | -4 dpm   |

Technologist: R.T. Reiman

Comments:

Midwest Health Professionals, P.C.  
3472 Bridgeland Drive  
Bridgeton, MO 63044  
License #: 24-32391-01

Site closeout wipe survey. This report contains ten wipes counted as one covering the floor, sink, counter top, and waste containers.

Date of Samples: 31 January, 2008

Taken by: R.T. Reiman

Signature: R.T. Reiman

Date: 2/11/08

A450 1.0.B

## Nuclear Medical Facility Move Closeout Survey

License Number: 2432391-01  
Control/Reference Number: 030-35989  
Licensee Name: Midwest Health Professionals, P.C.  
Closeout Address: 3472 Bridgeton, Drive  
City: Bridgeton State: MO Zip: 63044

New Address: 11520 St. Charles Rock Road, Suite 106  
City: Bridgeton State: MO Zip: 63044

Closeout Survey By: NC Systems, Inc, (Ron. Reiman)  
Date: 31 January, 2008  
Time: 10:13 AM to: 10:56 AM

### Instrumentation

#### Exposure Survey\*

Description: Ludlum 14C  
Serial Number: 188-339  
Calibration: 17 November, 2007  
Efficiency at 140 keV: 14%  
Background: less than or equal to 0.01 mR/hr  
Action/Trigger Level: 0.02 mR/hr

#### Analysis of Wipes

Description: Scintillation Well System  
Calibration: 11 February, 2008  
Efficiency at 140 keV: 71.46%  
Background at 140 keV: 97 dpm  
Action/Trigger Level for Tc-99m: 2000dpm

### Results

#### Exposure Survey

Measurements were made at one meter above the floor throughout the room and on the surface of the floor, sink, counter top, cabinet shelves, and waste containers. Representative measurements were also made on the surface of walls. All of the survey readings were less than or equal to 0.01 mR/hr.

#### Contamination Survey\*

Wipes were taken:

1. on the floor below the sink
2. on the floor to the right of the sink
3. on the floor in front of the counter
4. on the floor near the corner to the right of the counter

\*Floor plan showing locations and readings attached.

- 5. on the floor near the corner in front of the counter opposite the sink and on the same side as the door.
- 6. on the floor half way between wipe 1 and wipe 5 near the wall with the doors
- 7. on the floor in the center of the room
- 8. on the waste containers opposite the door and to the right of the sink
- 9. on the sink
- 10. on the counter top

**Conclusion**

No contamination was measured on any of the wipes.\*

**Review/Submission**



NCS - Health Physics Review

FEB 11 2008

Concerns noted with an \*

\*Wipe Results Report attached.