



SOUTHWEST REGIONAL

Medical Center

A New Direction in Health Care

NMSS1

November 13, 2007

U.S. Nuclear Regulatory Commission
Materials Licensing Branch
Region I
475 Allendale Road
King of Prussia, Pa. 19406

03008600

RE:Radioactive Material License No. 37-15121-01
Southwest Regional Medical Center

Gentlemen:

We are moving our hot lab and scan area. Attached is a diagram of the new area which, following some construction, is adjacent to the old area. We will perform a close out survey of the old area prior to releasing it for unrestricted use. We do not anticipate any residual activity as we use primarily Tc-99m. Our sealed sources have been recently leak tested and have never been shown to leak.

If you have any questions or require additional information, please do not hesitate to contact the undersigned.

Sincerely,

CEO, Southwest Regional Medical Center

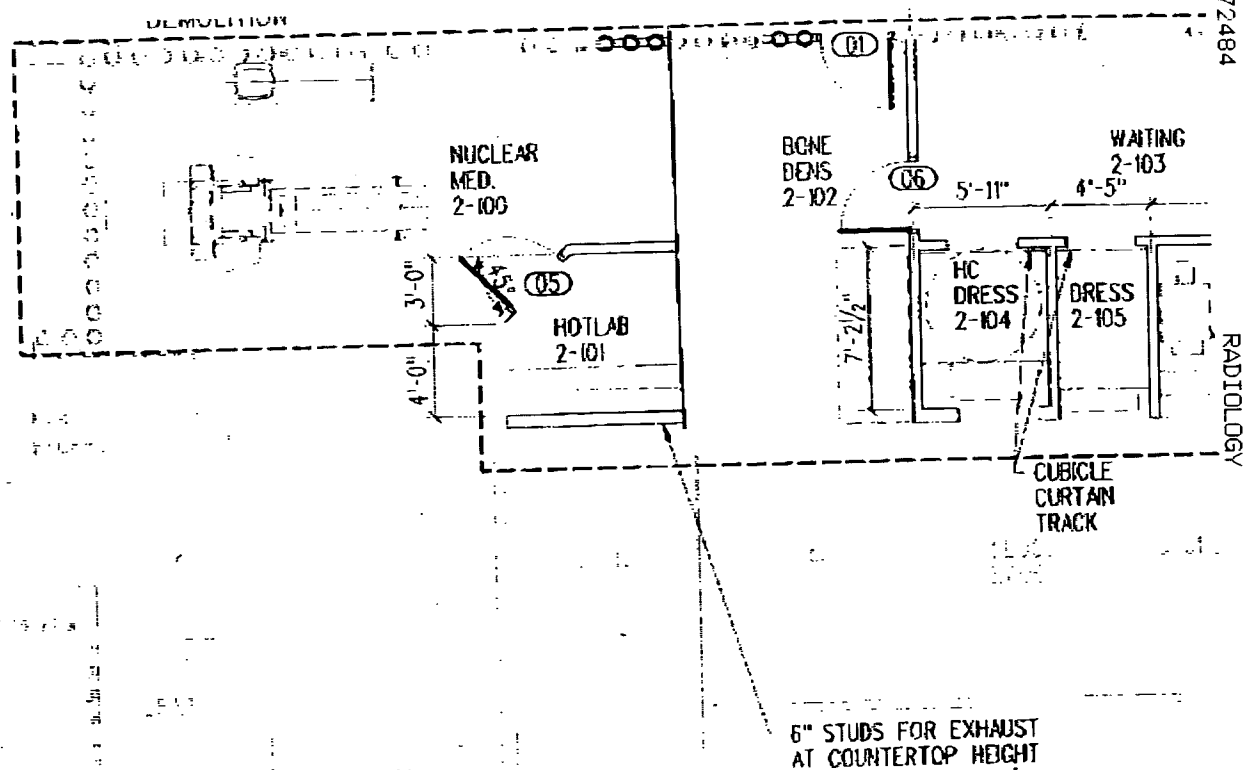

This is to acknowledge the receipt of your letter/application dated

11/13/2007, and to inform you that the initial processing which includes an administrative review has been performed.

☒ AMEND. 37-15121-01
There were no administrative omissions. Your application was assigned to a technical reviewer. Please note that the technical review may identify additional omissions or require additional information.

☐ Please provide to this office within 30 days of your receipt of this card

A copy of your action has been forwarded to our License Fee & Accounts Receivable Branch, who will contact you separately if there is a fee issue involved.

Your action has been assigned **Mail Control Number** 141309.
When calling to inquire about this action, please refer to this control number.
You may call us on (610) 337-5398, or 337-5260.