



6245 INKSTER ROAD • GARDEN CITY, MICHIGAN 48135-2599 • (734) 421-3300

IMAGING SERVICES DEPARTMENT  
FAX NUMBER 334-421-8874

Date 11/12/07

Number of Pages 6 Plus Cover

TO: Material Licensing

LOCATION: \_\_\_\_\_

FROM: Jim Williamson

LOCATION: GCN

Special Instructions: \_\_\_\_\_  
\_\_\_\_\_  
\_\_\_\_\_  
\_\_\_\_\_

\* If there are any problems with this transmission, please  
contact me at this number 734 458-3479.

jmh

**GARDEN  
+ CITY  
HOSPITAL**6245 INKSTER ROAD • GARDEN CITY, MICHIGAN 48135-4001 • (734) 458-3300

---

November 8, 2007

UNITED STATES NUCLEAR REGULATORY COMMISSION  
Region III, Materials Licensing Section  
2443 Warrenville Road  
Suite 210  
Lisle, IL 60532-4352

Re: Close-out surveys for NRC License No. 21-04072-01

Dear Sir/Madam:

Please amend our NRC license to reflect the close-out of the address of use:  
Cambridge Diagnostic Center  
27285 West Warren  
Dearborn Heights, MI 38127

The results of the close-out surveys are enclosed for your review.

Thank you for your cooperation with this matter. If you have any questions or require additional information please contact our physics consultant, Michelle Kritzman, at (734) 662-3197.

Sincerely,



Executive Management  
Garden City Osteopathic Hospital

Accredited by:



A NOT-FOR-PROFIT ORGANIZATION

AFFILIATED WITH:

MICHIGAN STATE UNIVERSITY  
COLLEGE OF OSTEOPATHIC MEDICINE

## Close-out Survey Information

**Close-out Location:**

CAMBRIDGE DIAGNOSTIC CENTER  
27285 W. Warren  
Dearborn Heights, MI 48127

**Date performed:** October 29, 2007

**Performed by:** Michelle Kritzman, M.S., Radiological Physicist

**Comments:** This location was used for 35.100 and 35.200 activities. The isotopes used for imaging were Tc-99m and I-131. The last day of use for Tc-99m was completed on 9/27/07. The last day of use for I-131 was 8/15/07.

**Instruments:**

Wipe tests analyzed on the following Well counter:

Instrument: CAPTUS 3000 S/N 900271  
Spectrum: Full Spectrum  
Efficiency Full Spectrum: 40%

Area survey performed with the following survey meter:

Manufacturer: Eberline  
Type: SWGM  
Model Number: E-520  
Serial Number: 714  
Probe Model: End Window  
Calibration Date: 8/16/2007

Battery check acceptable:	<u>YES</u>
Operational check acceptable:	<u>YES</u>
Constancy check acceptable:	<u>YES</u>
Check source value:	<u>1.0 mR/hr</u>

**Radionuclides Used:****Unsealed**

Tc-99m

I-131 (Capsule)

**Sealed**

Co-57

**Visual Check:** The area was checked to ensure that all radioactive waste had been removed. All sealed sources were transferred to Garden city Osteopathic Hospital. No evidence of radioactive material was noted.

**Radiation Level Survey:** No area within the research labs demonstrated radiation levels in excess of the background reading of 0.02 mR/hr.

**Removable Contamination:** No area within the laboratories demonstrated removable contamination in excess of 119 dpm's.

**Surveys, Wipes, and Diagrams are enclosed for review.**

**Conclusion:** No radioactive materials remain in this area. No removable contamination is present.

CAMBRIDGE DIAGNOSTIC CENTER  
27285 W. Warren  
Dearborn Heights, MI 48127

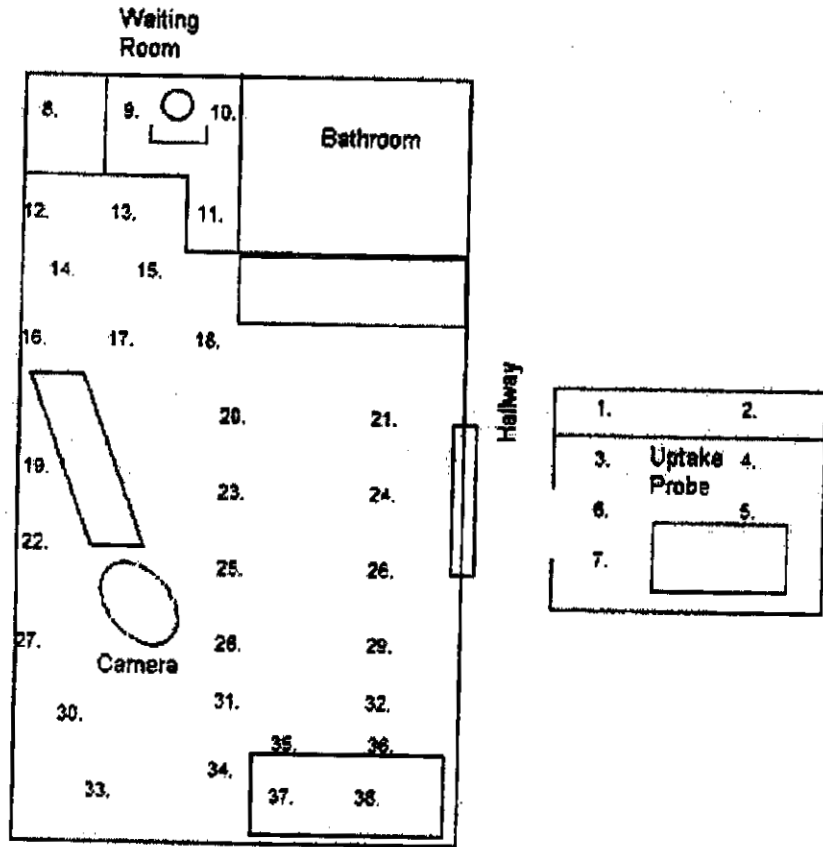

Garden City Osteopathic Hospital - Cambridge Diagnostic Center				
License # 21-4072-01				
Date: 10/29/2007		Performed By: M Krizman, M.S.		
Survey Meter: Eberline E-520		Check Value: 1 mR/hr		
		net cpm	net dpm	mR/h
1	Counter	0	0	0.02
2	Counter	0	0	0.02
3	Counter	27	67	0.02
4	Counter	0	0	0.02
5	floor	0	0	0.02
6	floor	9	22	0.02
7	floor	0	0	0.02
8	floor	31	77	0.02
9	floor	5	12	0.02
10	floor	1	2	0.02
11	floor	0	0	0.02
12	floor	0	0	0.02
13	floor	0	0	0.02
14	floor	48	119	0.02
15	floor	0	0	0.02
16	floor	0	0	0.02
17	floor	13	32	0.02
18	floor	17	42	0.02
19	floor	0	0	0.02
20	floor	0	0	0.02
21	floor	13	32	0.02
22	floor	0	0	0.02
23	floor	16	39	0.02
24	floor	0	0	0.02
25	floor	36	89	0.02
26	floor	0	0	0.02
27	floor	31	77	0.02
28	floor	0	0	0.02
29	floor	0	0	0.02
30	floor	33	82	0.02
31	floor	11	27	0.02
32	floor	23	57	0.02
33	floor	0	0	0.02
34	floor	0	0	0.02
35	floor	0	0	0.02
36	floor	9	22	0.02
37	floor	13	32	0.02
38	floor	0	0	0.02
39	floor	0	0	0.02
	Background	503		0.02

**ACTION LEVELS: 2000 dpm**                      Conversion factor 2.5 dpm/cpm

**COMMENTS: No evidence of removable contamination.**