



Dennis C. Besley, M.D.  
John D. Call, Jr., M.D.  
Harish R. Chandra, M.D.  
Lynn J. Cronin, M.D.  
Robert C. Davidson, M.D.  
Michael G. Dickinson, M.D.  
Dennis W. Dunning, M.D.  
Darryl A. Elmouchi, M.D.  
Bohuslav Finta, M.D.  
William A. Frauenheim, M.D.  
Timothy D. Fritz, M.D.

Andre J. Gauri, M.D.  
J. Robert Grove, M.D.  
David B. Johnson, M.D.  
John A. Key, D.O.  
Paul J. Kovack, D.O.  
David E. Langholz, M.D.  
William F. LaPenna, M.D.  
Michael A. Lojek, M.D.  
Richard F. McNamara, M.D.  
Roger D. Miller, M.D.  
J. Craig Mulligan, D.O.

Jihad A. Mustapha, M.D.  
Maurice J. Norman, M.D.  
Raymond A. Roder, M.D.  
Andrew M. Rosenblum, M.D.  
Matthew W. Sevensma, D.O.  
Helayne L. Sherman, M.D., Ph.D.  
Michael C. Vredenburg, D.O.  
Eric T. Walchak, D.O.  
Alan K. Woelfel, M.D.  
David Wohns, M.D.  
Kevin G. Woischleger, M.D.

October 11, 2007

UNITED STATES NUCLEAR REGULATORY COMMISSION  
Region III, Materials Licensing Section  
2443 Warrenville Road, Suite 210  
Lisle, IL 60532-4352

**Re: Closeout of location and removal of physician authorized user.  
License No. 21-26543-01, West Michigan Heart, P.C.**

1. Please remove the 1945 Boston SE, Suite G-1, Grand Rapids, MI location from our license. A close out of the location is enclosed for your review.
2. Remove Dr. LaPenna as authorized user. He is no longer at our facility.

**Please review the closeout as soon as possible. The building will be transferred to a new owner on October 30, 2007.**

Thank you for your cooperation in this matter. If you have any questions, please contact our consulting physicist, Dawn Edwards at 734-662-3197.

Sincerely,

Suzette Jaskie, CEO  
West Michigan Heart, PC  
(616)885-5000



**BRADFORD**

2900 Bradford St. NE  
Grand Rapids, MI 49525  
Phone (616) 885-5000  
Fax (616) 885-5020



**BUSINESS OFFICE**

P.O. Box 152057  
Grand Rapids, MI 49515-2057  
Phone (616) 752-5000  
Fax (616) 913-9025  
Toll Free Phone (866) 752-5002



**METROPOLITAN**

1945 Boston SE, Suite 201  
Grand Rapids, MI 49506  
Phone (616) 241-2333  
Fax (616) 452-6767



**HOLLAND**

904 S. Washington, Suite 120  
Holland, MI 49423  
Phone (616) 392-3824  
Fax (616) 392-3570



**GREENVILLE**

709 S. Greenville West Drive  
Greenville, MI 48838  
Phone (616) 754-3880  
Fax (616) 754-8941

**OTHER LOCATIONS**

Big Rapids, Canadian Lakes, Edmore, Fremont, Hastings, Ionia, Reed City, Sheridan, Zeeland

[www.wmheart.com](http://www.wmheart.com)

RECEIVED OCT 15 2007

Medical Physics Consultants, Inc.

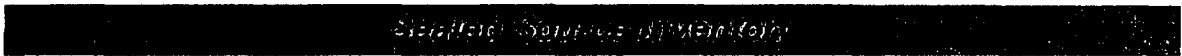

Licensee: West Michigan Heart (Metro Site)

Date: 07/30/07

Performed by: Dawn Edwards

Nuclide	Type	Calibration		Location	M/N	S/N
		Activity	Date			
Cs-137	Vial	222.4 uCi	11/01/01	Nuc Med		787-31-16
Ba-133	Vial	248.2 uCi	10/01/01	Nuc Med		787-12-15
Cs-137	Rod	0.5 uCi	10/01/01	Nuc Med		800-4
Cs-137	Spot	1 uCi		Meter		99-2499
Co-57	Flood	7.5 mCi	01/07/07	Nuc med	NES 8495	1227-103

SEALED SOURCE AMBIENT EXPOSURE SURVEY

Meter: Ludlum 14C

Max Reading: 0.02 mR/hr

RADIATION SAFETY OFFICER: \_\_\_\_\_

*[Handwritten Signature]* 10/11/07

Medical Physics Consultants, Inc.

**Sealed Source Leak Test**

Licensee: West Michigan Heart (Metro Site)

Date: 07/30/07

Performed by: Dawn Edwards

Nuclide	Type	Calibration Activity	Calibration Date	Location	M/N	S/N
Cs-137	Vial	222.4 uCi	11/01/01	Nuc Med		787-31-16
Ba-133	Vial	248.2 uCi	10/01/01	Nuc Med		787-12-15
Co-57	Flood	7.5 mCi	01/07/07	Nuc med	NES 8495	1227-103

Comment: The sources listed above were leak tested using a dry wipe technique and were found to have less than 0.005 uCi removable activity. The following Minimum Detectable Activities are based upon a background at the indicated value. Background was at or below these levels when the above tests were completed.

Well Counter: Captus 3000

<u>Nuclide</u>	MDA	Background
Cs-137	$2.0 \times 10^{-4}$ uCi	145 counts/1 min
Ba-133	$8.8 \times 10^{-5}$ uCi	204 counts/1 min
Co-57	$1.7 \times 10^{-5}$ uCi	53 counts/1 min

**RADIATION SAFETY OFFICER:** \_\_\_\_\_

### Close-out Survey

Nuclear Medicine Department  
1945 Boston SE Suite G-1  
Grand Rapids, MI

Date Performed: September 26, 2007

Performed By: Christine Bopp, Nuclear Medicine Technologist

Wipe tests were analyzed with a Capintec CRC 15W Well Counter

Surveys were performed using a Ludlum 14C survey meter. Range used was 0-0.2 mR/hr. The meter was last calibrated on 01/17/07.

#### Visual Check

The area was checked to ensure that all radioactive materials had been removed. Only Technetium-99m radiopharmaceuticals were used in this office. Sealed sources used for calibration were transferred to the 5900 Byron Center Avenue, Wyoming Michigan location. A copy of the most recent sealed source inventory and leak test is enclosed. This facility has not had any history of leaking sources.

#### Radiation Level Survey

No area within the office demonstrated radiation levels in excess of the background reading of 0.01 mR/hr.

Removable Contamination

1 minute counts

Background 0 dpm

Area Results in dpm

**Imaging Room:**

<b>Area</b>	<b>Result</b>
1	0 dpm
2	0 dpm
3	0 dpm
4	0 dpm
5	0 dpm
6	0 dpm
7	0 dpm
8	13 dpm
9	0 dpm
10	0 dpm

**Exam Room (Room 1):**

<b>Area</b>	<b>Result</b>
1	0 dpm
2	0 dpm
3	0 dpm
4	0 dpm
5	0 dpm
6	0 dpm
7	0 dpm
8	0 dpm
9	0 dpm
10	0 dpm

**Echo/ Stress Room (Room 2):**

<b>Area</b>	<b>Result</b>
1	0 dpm
2	0 dpm
3	0 dpm
4	0 dpm
5	0 dpm
6	0 dpm
7	0 dpm
8	0 dpm
9	2 dpm

**Nuclear Stress (Room 3):**

<b>Area</b>	<b>Result</b>
1	8 dpm
2	0 dpm
3	0 dpm
4	0 dpm
5	0 dpm
6	0 dpm
7	0 dpm
8	0 dpm
9	0 dpm
10	0 dpm

**Exam Room (Room 4):**

<b>Area</b>	<b>Result</b>
1	0 dpm
2	0 dpm
3	5 dpm
4	0 dpm
5	0 dpm
6	0 dpm
7	0 dpm
8	0 dpm
9	9 dpm

**Treadmill Room (Room 6):**

<b>Area</b>	<b>Result</b>
1	0 dpm
2	0 dpm
3	0 dpm
4	0 dpm
5	0 dpm
6	0 dpm
7	0 dpm
8	0 dpm
9	0 dpm

**Maximum removable contamination: 13 dpm**

Diagrams of the survey areas are enclosed.

Conclusion

No removable contamination is present.

West Michigan Heart  
1945 Boston SE Location  
Closeout Diagram – Imaging Room

Imaging Room  
Closeout Diagram

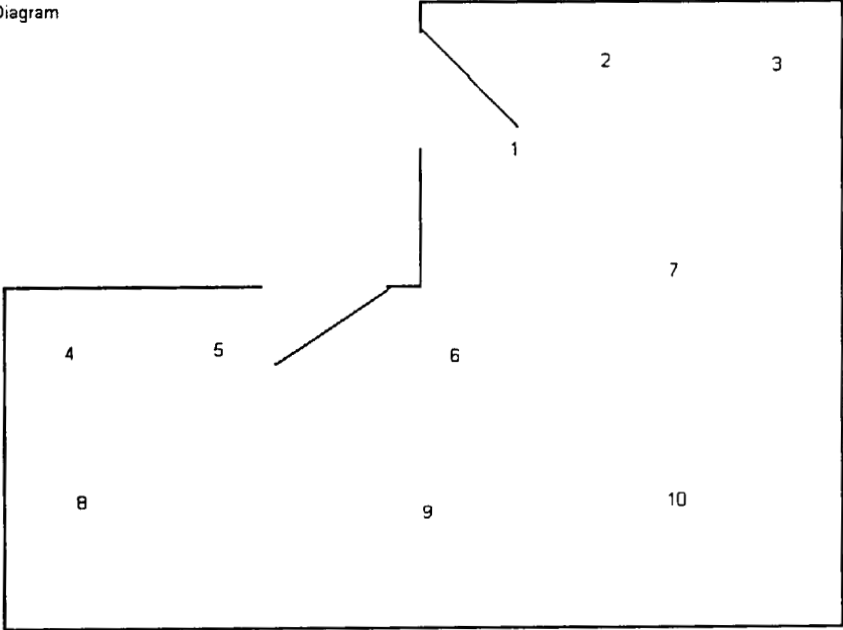



West Michigan Heart  
1945 Boston SE Location  
Closeout Diagram – Room 1

Room 1  
Closeout Diagram

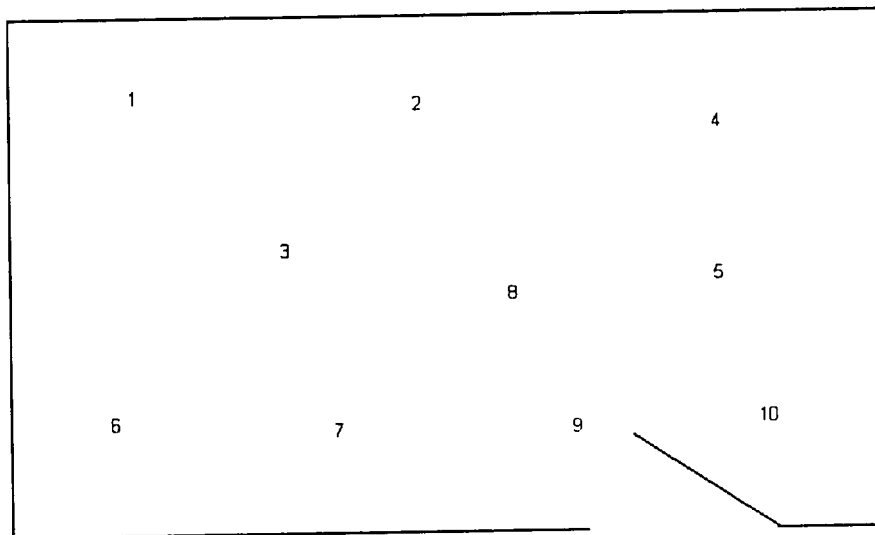

West Michigan Heart  
1945 Boston SE Location  
Closeout Diagram – Room 2

Room 2  
Closeout Diagram

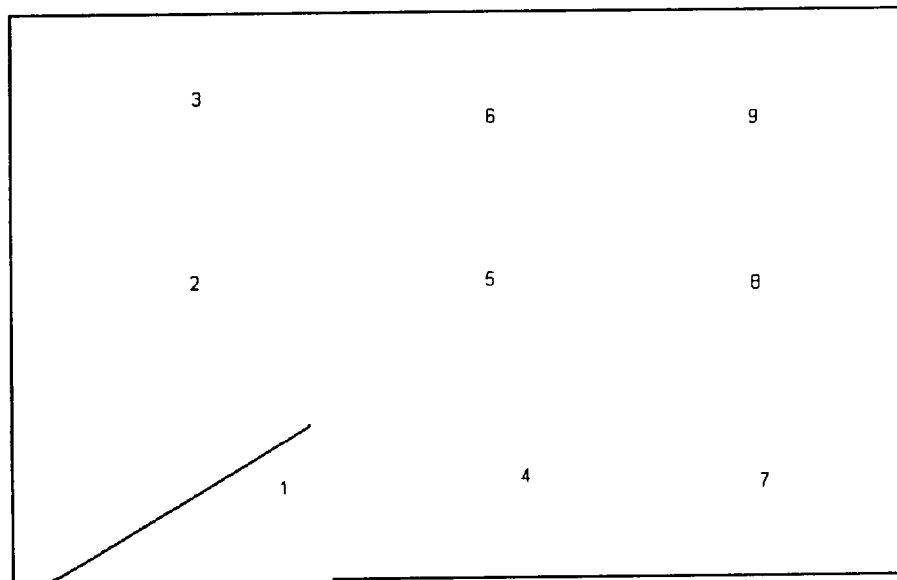

West Michigan Heart  
1945 Boston SE Location  
Closeout Diagram – Room 3

Room 3  
Closeout Diagram

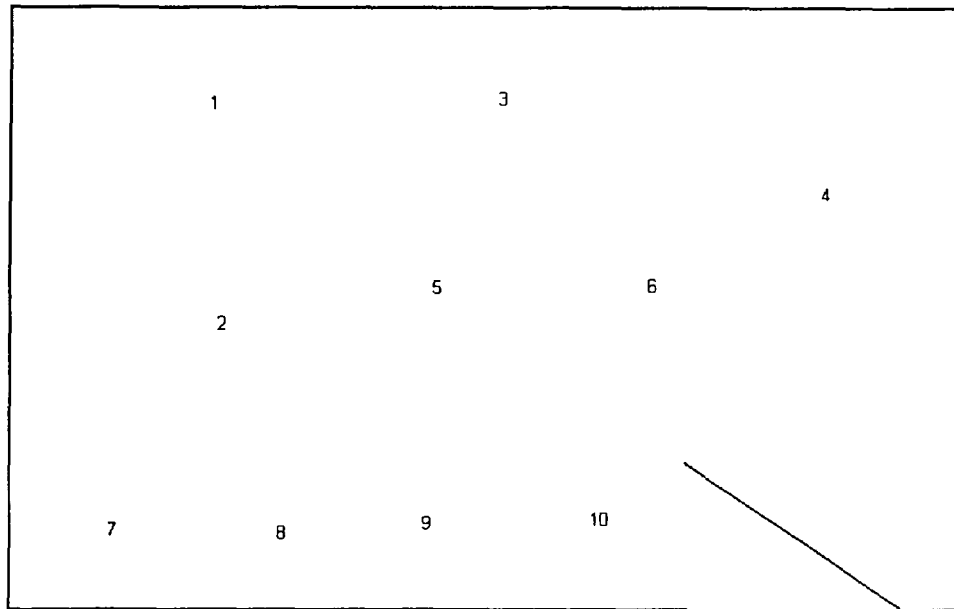

West Michigan Heart  
1945 Boston SE Location  
Closeout Diagram – Room 4

Room 4  
Closeout Diagram

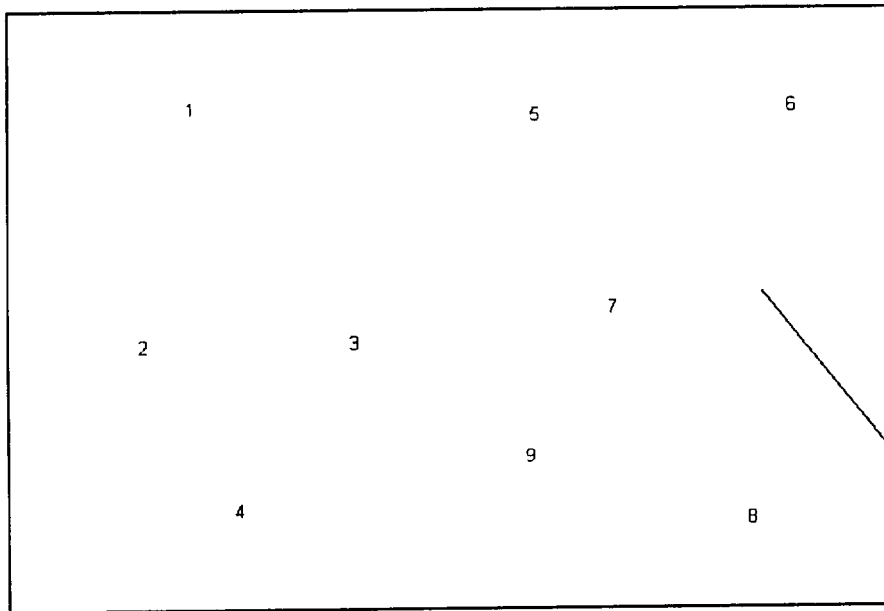

West Michigan Heart  
1945 Boston SE Location  
Closeout Diagram – Room 6

Room 6  
Closeout Diagram

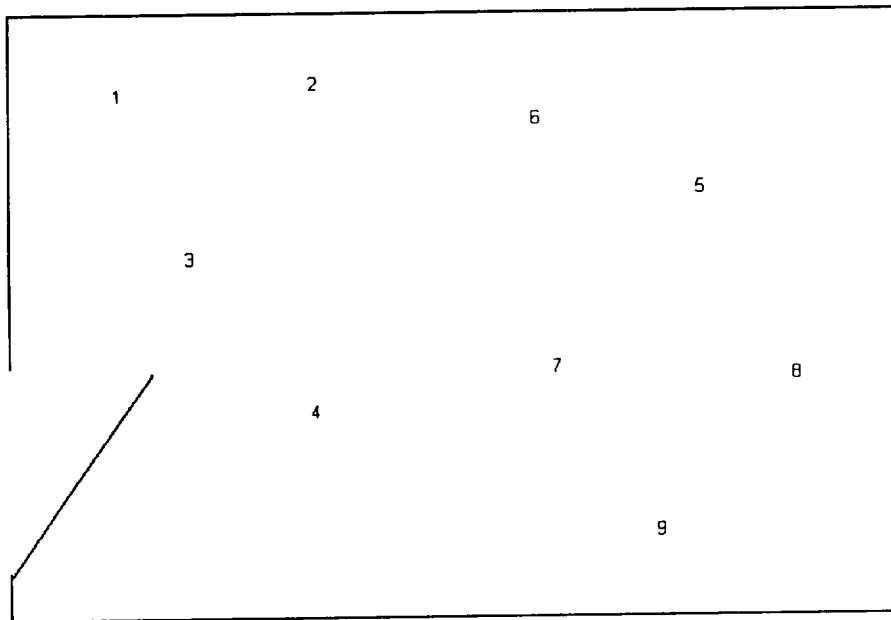

FedEx  
TRK# 8601 0915 7000  
0215

MON - 15 OCT A2  
STANDARD OVERNIGHT

XH-ENLA

ORD  
IL-US  
60532

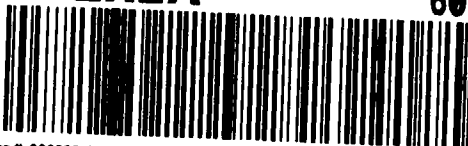

Emp# 028238 12OCT07 ORRA

28

FedEx. US Airbill  
Express

FedEx Tracking Number 8601 0915 7000

Recipient's Copy

1 From This portion can be removed for Recipient's records. 860109157000

Date 10/11/07 FedEx Tracking Number

Sender's Name Chris Bopp Phone 616-454-5551

Company WEST MICHIGAN HEART

Address 2900 BRADFORD ST NE

City GRAND RAPIDS State MI ZIP 49525

2 Your Internal Billing Reference

3 To United States Nuclear Regulatory Commission  
Name Regulatory Commission Office of  
Company Region III, Materials Licensing Section

Recipient's Address 2443 Warrenville Rd, Suite 210

To request a package be held at a specific FedEx location, print FedEx address here.

City Lisle State IL ZIP 60532-4352

0356858023



8601 0915 7000

4a Express Package Service  
 FedEx Priority Overnight  
 FedEx Standard Overnight  
 FedEx 2Day  
 FedEx Express Saver

4b Express Freight Service  
 FedEx 1Day Freight  
 FedEx 2Day Freight

5 Packaging  
 FedEx Envelope  
 FedEx Pak  
 FedEx Box  
 FedEx Tube  
 Other

6 Special Handling  
 SATURDAY Delivery  
 HOLD Warehouse at FedEx Location  
 HOLD Saturday at FedEx Location  
Does this shipment contain dangerous goods?  
 No  Yes  
Dangerous goods including dry ice cannot be shipped in FedEx packages.

7 Payment Method  
 Recipient  
 Third Party  
 Credit Card  
 Cash/Check

Total Packages Total Weight Total Charges  
Credit Card Auth.

8 NEW Residential Delivery Signature Options

No Signature Required  
 Direct Signature  
 Indirect Signature

519

Rev Date 11/05/04 Part #190279-01/04-2008 FedEx-PRINTED IN U.S.A.-SRS

fedex.com 1.800.GoFedEx 1.800.463.3339

RECIPIENT: PEEL HERE