

R 76 W

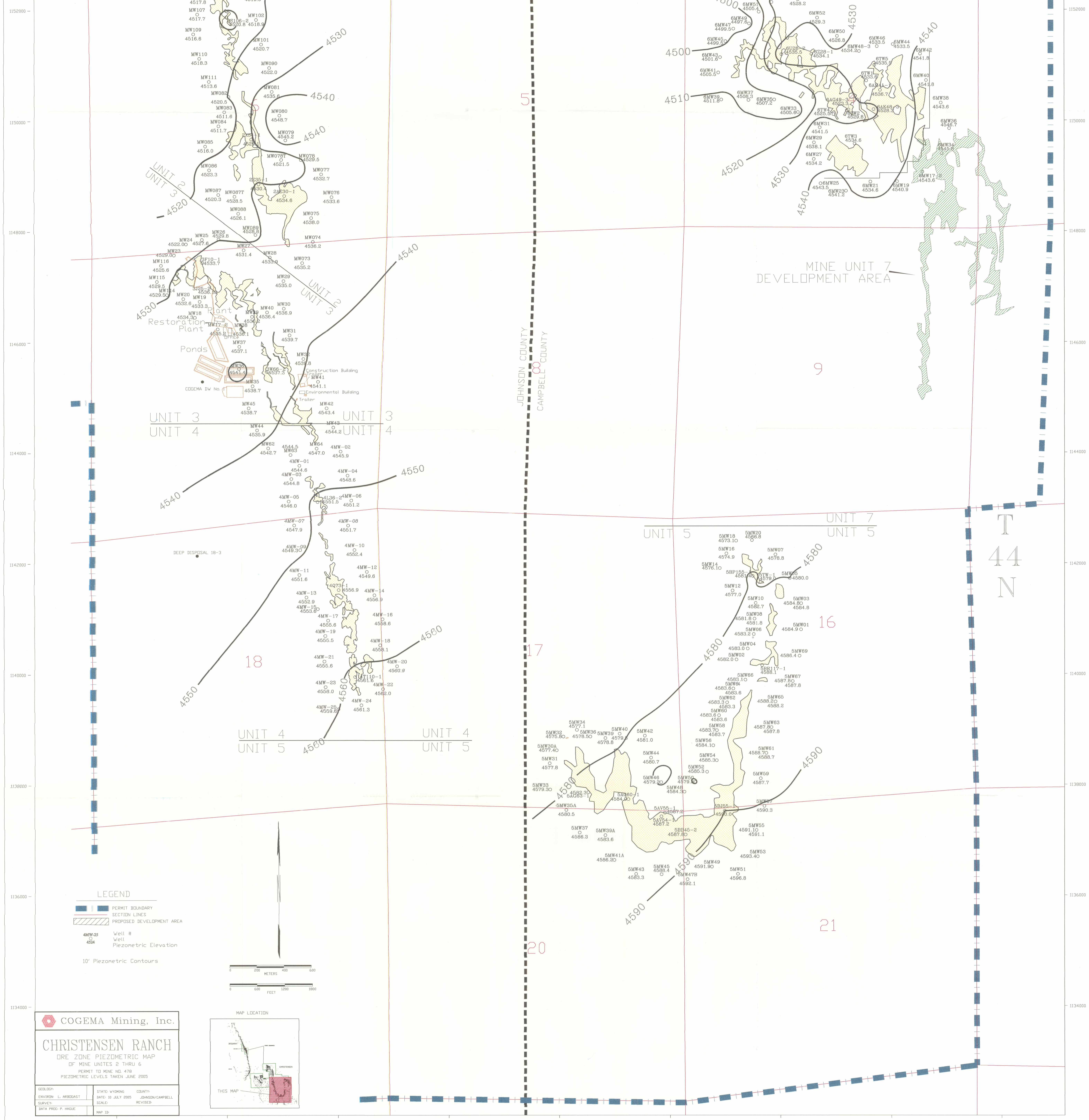

UNIT 2
UNIT 3

UNIT 3
UNIT 4

UNIT 3
UNIT 4

UNIT 3
UNIT 4

UNIT 4
UNIT 5

UNIT 4
UNIT 5

UNIT 5

UNIT 7
UNIT 5

T
44
N

JOHNSON COUNTY
CAMPBELL COUNTY

MINE UNIT 7
DEVELOPMENT AREA

- LEGEND**
- PERMIT BOUNDARY
 - SECTION LINES
 - PROPOSED DEVELOPMENT AREA
 - Well #
 - Piezometric Elevation
 - 10' Piezometric Contours

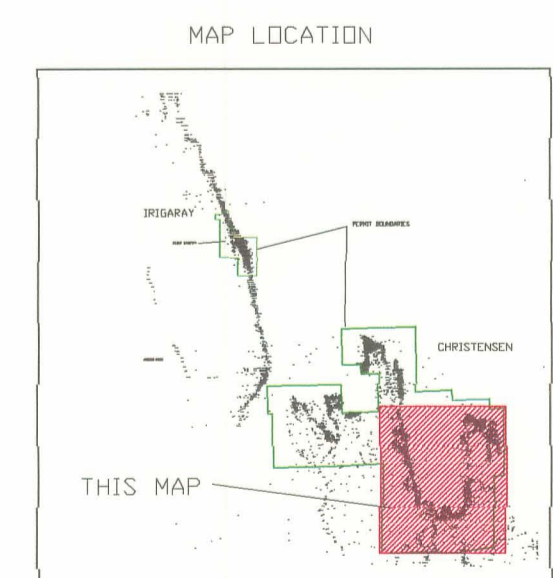
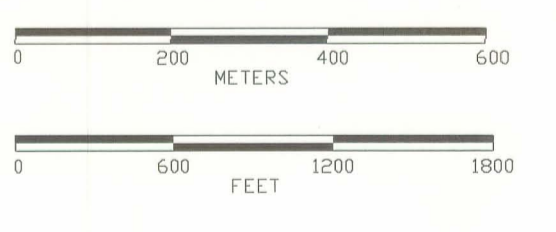

COGEMA Mining, Inc.

CHRISTENSEN RANCH
ORE ZONE PIEZOMETRIC MAP
OF MINE UNITS 2 THRU 6
PERMIT TO MINE NO. 479
PIEZOMETRIC LEVELS TAKEN JUNE 2005

GEOLGIST: ENVIKSON, L. ARNDGAST	DATE: 10 JULY 2005	COUNTY: JOHNSON/CAMPBELL
SURVEY: DATA PROD: P. HAGUE	SCALE: MAP ID:	REVISED:

D-07