



Gheorghe Marinescu, M.D.

BMB Medical Center  
2191 South Boulevard  
Auburn Hills, Mi. 48326

Phone Number (248)724-1420  
Fax Number (248)724-1422

FAX TRANSMISSIONAL FORM

To: Bill Reichhold

Date Sent: 6-13-2007

Fax: 630-515-1078

Number of Pages: 6

Message:

Please call if you need more information  
Thanks  
Lori Green

THE INFORMATION CONTAINED IN THIS FACSIMILE MESSAGE IS PRIVILEGED OR CONFIDENTIAL INFORMATION INTENDED ONLY FOR THE USE OF THE INDIVIDUAL OR ENTITY NAMED ABOVE. IF THE READER OF THIS MESSAGE IS NOT THE RECIPIENT, OR THE EMPLOYEE OR AGENT RESPONSIBLE TO DELIVER IT TO THE INTENDED RECIPIENT YOU ARE HEREBY NOTIFIED THAT ANY DISSEMINATION, DISTRIBUTION OR COPYING OF THIS COMMUNICATION IS NEITHER ALLOWED NOR INTENDED. IF YOU HAVE RECEIVED THIS COMMUNICATION IN ERROR, PLEASE NOTIFY US IMMEDIATELY BY TELEPHONE AT THE ABOVE NUMBER AND RETURN THE ORIGINAL MESSAGE TO US AT THE ABOVE ADDRESS VIA THE U.S. POSTAL SERVICE. THANK YOU.

THE INFORMATION IS FOR THE USE OF THE OFFICE OF GHEORGHE N. MARINESCU, M.D. AND IS NOT TO BE COPIED.

MICHIGAN INTERNAL MEDICINE AND CARDIOLOGY ASSOCIATES INC.

**New Text Document**

**To: BILL REICHHOLD**

- 1. Address of "new location" where the sealed sources and radioactive trash were transported to.**

**2191 South Boulevard  
Auburn Hill, MI 48326**

- 2. Lori Green actually performed the swipe/ mailed to Laura Luna who calculated and and put into print the close-out-survey.**
- 3. The Ludlum 14-C survey meter, serial 183225 was calibrated 5/9/2006 and again on 4/17/2007. Copies of both calibrations are being sent to you.**
- 4. The layout of the close-out-survey diagram and is the same as the sketch submitted with the license application. I drew the diagram of the layout as I was performing the close out swipes, so my dimensions are different. On our original facility diagram, we had planned to have two stress rooms, which did not happen. So one room was the stress room, one and exam room and the other was the Injection room. I relabeled the diagram, so the room names match up. I hope that helps.**

**LORI GREEN. Please feel free to call if you need anymore clarification of these items.**



**MEDICAL PHYSICS CONSULTANTS, INC.**

2309 Shelby Avenue • Ann Arbor, MI 48103 • (734) 662-3197 • Fax (734) 662-9224  
 70 E. 91st Street, Suite 106 • Indianapolis, IN 46240 • (317) 581-1911 • Fax (317) 581-1931  
 1780 E. Logan Avenue • Salt Lake City, UT 84108 • Office & Fax (801) 467-8774  
 N7375 Crystal Ridge Drive • Beaver Dam, WI 53916 • (920) 885-9870 • Fax (920) 885-9872

www.mpcphysics.com

**Facility:** Bloomfield Heart Imaging, LLC  
 2520 South Telegraph Road, Ste 205  
 Bloomfield Hills MI 48302

**Instrument:**

Manufacturer: Ludlum  
 Type: GM  
 Model #: 14C  
 Serial #: 183255  
 Probe Type: EW  
 Probe Serial #: 186272

**Calibration Geometry:** Probe perpendicular to source, cap on

**Calibration Source:** Cs-137 calibrated on 12/6/83 (+/- 3% NBS). Exposure Rate on 1/10/05: 27.78 mR/h at 1 meter. (NRC License No. 21-20153-01)

**Calibration Data:**

Scale	Exposure mR/h	Reading mR/h	Exposure mR/h	Reading mR/h	Correction Factor
X 0.1	0.06	0.065	0.13	0.125	1.0
X 1	0.6	0.65	1.3	1.25	1.0
X 10	6	6	13	13	1.0
X 100	60	60	130	130	1.0
X 1000	300	300	700	700	1.0

**Date Received:** 5/9/2006

**Date Calibrated:** 5/9/2006

**Check Source Reading:** 0.45 mR/h (source to end window, cap off)

**Battery Check:** bat. OK

**High Voltage:** 911 Volts

**Repairs:** None

**Comments:** All instrument readings are within +/- 10% for all scales used. Drift check was acceptable. Please note applicable scale correction factors in order to obtain accurate readings in mR/h.

Note: This instrument must be checked for proper operation with its dedicated check source prior to use. A reading as described above denotes proper operation.

**Calibrated by:**

Ryan Dzanbazoff



**Facility:** Bloomfield Heart Imaging, LLC  
 2191 South Boulevard, Suite 101  
 Auburn Hills MI 48326

**Instrument:**

Manufacturer:	Ludlum
Type:	GM
Model #:	14C
Serial #:	183255

Probe Type: EW  
 Probe Serial #: 186272

**Calibration Geometry:** Probe perpendicular to source, cap on

**Calibration Source:** Cs-137 calibrated on 12/6/83 (+/- 3% NBS). Exposure Rate on 1/10/05: 27.78 mR/h at 1 meter. (NRC License No. 21-20153-01)

**Calibration Data:**

Scale	Exposure	Reading	Exposure	Reading	Correction Factor
	mR/h	mR/h	mR/h	mR/h	
X 0.1	0.06	0.065	0.13	0.125	1.0
X 1	0.6	0.65	1.3	1.25	1.0
X 10	6	6.5	13	13	1.0
X 100	60	60	130	130	1.0
X 1000	300	300	700	700	1.0

**Date Received:** 4/16/2007

**Date Calibrated:** 4/17/2007

**Check Source Reading:** 0.45 mR/h (source to end window, cap off)

**Battery Check:** bat. Ok

**High Voltage:** 911 Volts

**Repairs:** None

**Comments:** All instrument readings are within +/- 10% for all scales used. Drift check was acceptable. Please note applicable scale correction factors in order to obtain accurate readings in mR/h.

Note: This instrument must be checked for proper operation with its dedicated check source prior to use. A reading as described above denotes proper operation.

**Calibrated by:**

Ryan Dzanbazoff

11385

2309 Shelby Avenue  
 Ann Arbor, MI 48103  
 (734) 662-9224 Fax  
 (734) 662-3197

70 E. 91<sup>st</sup> Street, Suite 106  
 Indianapolis, IN 46240  
 (317) 581-1931 Fax  
 (317) 581-1911

1780 E. Logan Avenue  
 Salt Lake City, UT 84108  
 (801) 467-3774 Office & Fax

N7375 Crystal Ridge Drive  
 Beaver Dam, WI 53916  
 (920) 885-9872 Fax  
 (920) 885-9870

### Medical Physics Consultants, Inc.

### Official Use Only - Security-Related Information

### Bloomfield Heart Imaging

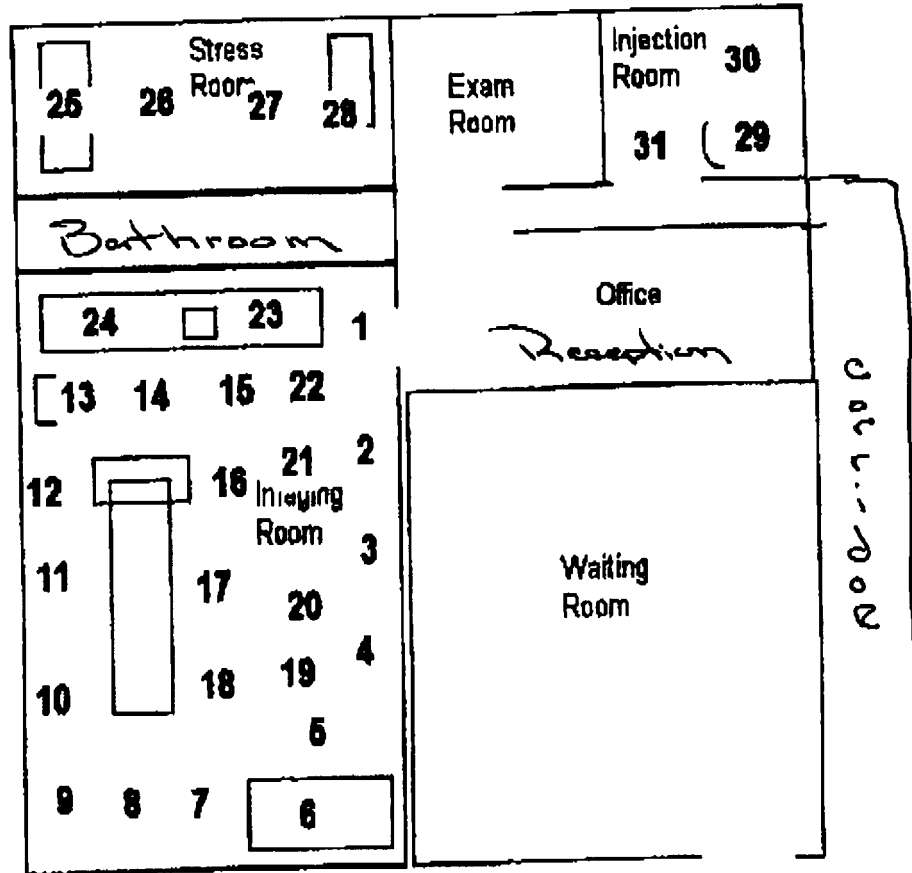

*Close-out  
Survey  
Sketch*

**Official Use Only - Security-Related Information**

Bloomfield Heart Imaging, LLC  
NRC License Application  
February, 2002

SKETCH FROM  
ORIGINAL APPLICATION.

**FACILITY DIAGRAM**

Item 9.1

**Bloomfield Heart Imaging**  
2520 S. Telegraph Road Suite 205  
Bloomfield Hills, Michigan 48302

