

APPENDIX D SURVEYOR INFORMATION



40000 Grand River Avenue • Suite 206 • Novi, MI 48375-2110
248.473.7880 • Fax 248.473.7890

January 31, 2007

Energy Solutions, LLC

143 West Street
New Milford, CT. 06776

Attn: **Gerry Toumey**

Re: Milletics and Associates, LLC, Surveying Services

Dear Sirs:

As requested, please find below my Seal for Licensed Land Surveyor, State of Michigan, Number 29249.

Also, the following is the link to the State of Michigan web site for license verification:

http://www.cis.state.mi.us/bcs_free/default.asp?profession=land

Copy this link into the address bar and hit go; type my name (first and last) or registration number into the form to verify my status.

If you have any questions, please call.

Sincerely,

Michael L. Milletics, P.S. No. 29249
Milletics and Associates, LLC

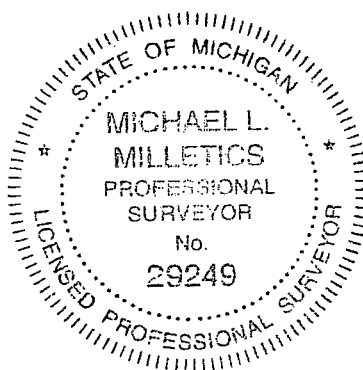

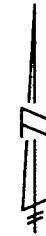
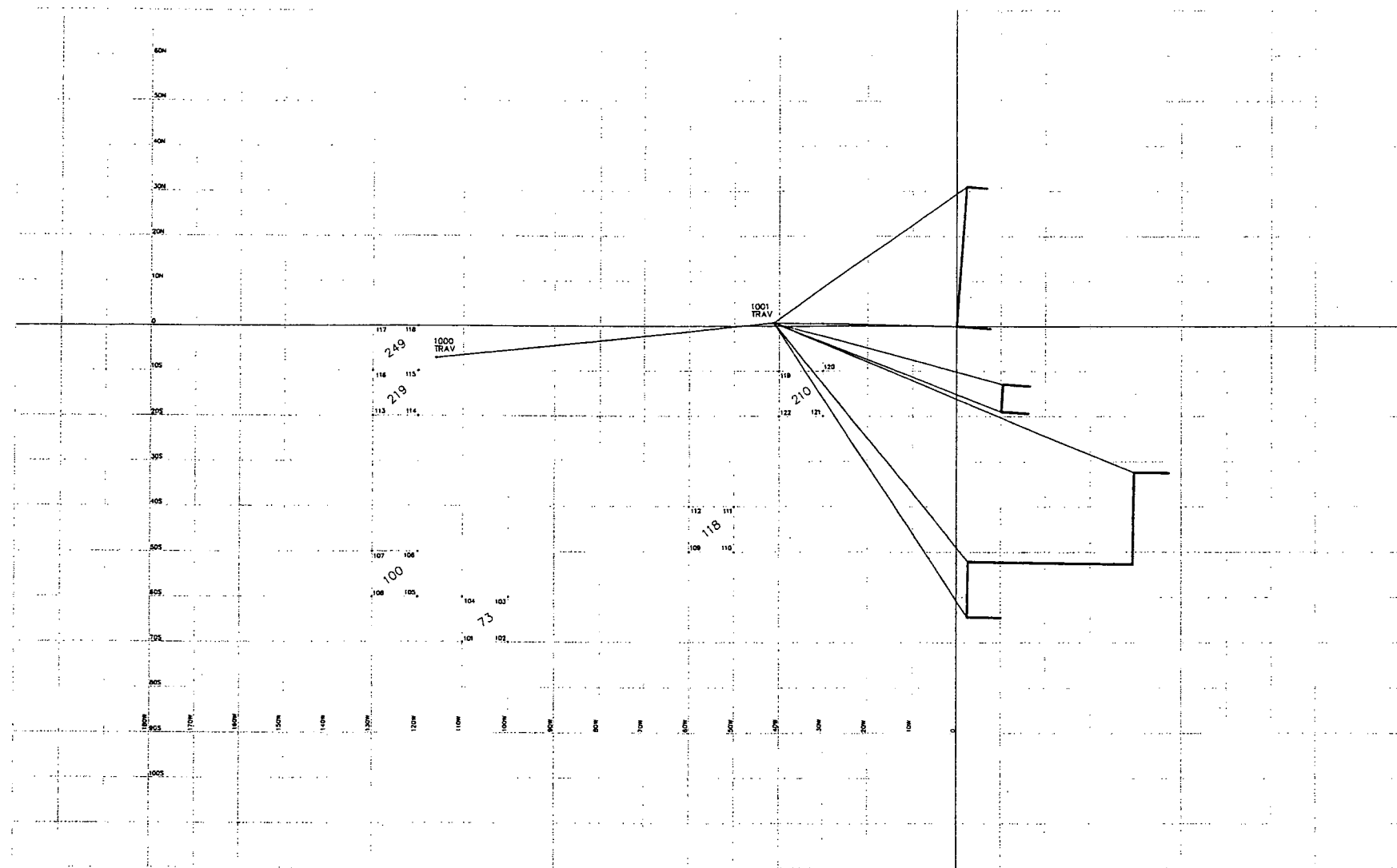

REVISIONS		DATE	
NO.	ITEM		

AAR PROJECT
SECTION 25, TOWN 1 SOUTH, RANGE 9 EAST
CITY OF LIVONIA
WAYNE COUNTY, MICHIGAN

SCALE: 1" = 50'
DATE: NOVEMBER 9, 2006
JOB NO.: 06-025
DWG FILE: 06-025
DRAWN BY: DSW
CHECK: MLM
SHEET: 1 OF 1

MILLETICS AND ASSOCIATES, L.L.C.
LAND SURVEYORS
40000 GRAND RIVER AVENUE • SUITE 206 • NOV, MI • 48375-2110
248.473.7880