

Daily Survey Journal

Page 1 of 1

Survey Area No.: OOL-16	Survey Area Name: 01	Survey Date: 7/25/06
Survey Unit No. and Name: YNPS-FSS-OOL-16-01-00 ⁰¹ 00 ^{OK} 8/29/06		
Supervisor: John McChesney		Crew: Steve Pennock, Mike Maxwell, Mike Sweet
Instruments Pre-op source Sat. <input checked="" type="checkbox"/> Pre-op source Sat. <input checked="" type="checkbox"/> Pre-op source Sat. <input checked="" type="checkbox"/> Sat. <input checked="" type="checkbox"/>		
Post-op source Sat. <input checked="" type="checkbox"/> Post-op source Sat. <input type="checkbox"/> Date Post-op source Sat. <input type="checkbox"/> Date		
TIME	NOTES FOR SURVEY DATE	
07:00	Briefed crew on area requirements.	
07:30	Mike Sweet in the area to GPS soil sample locations. Excavator is being moved out of the area.	
09:15	Mike Maxwell and Steve Pennock in the area to collect soil samples complete Scans.	
13:00	Mike Maxwell called and part of the northern scan area is inaccessable, advised To scan in the general area to a point that we confident that we have done 2 meters by 20 meters.	
14:10	OOL-16-01 is complete	

Completed by *J. McChesney* Date 7/26/06
 FSS Field Supervisor

Reviewed by *N. Tozzie* Date 8/24/06
 FSS Radiological Engineer

SCAN SURVEY

FSS SPA-3 Locations
OOL-16-01-xxx-F-SC

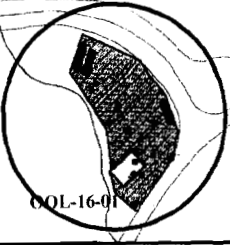

OOL-17-

BKGD = 7.61K
B ~ BKGD = 8.19K
#1

016-F-SC
#2

THESE SCAN LOCATIONS
MOVED TO

017-F-SC
B BKGD = 8.29K
#3

A BKGD = 7.69K
#4
014-F-SC

1m x 10m

MIKE MAXWELL
Mike Maxwell 07/25/06

E-600 # 02619 CAL. DUE. 9/13/06
SPA-3 # 2056 CAL. DUE. 9/09/06
EFF. 220 cpm/pci/gram Unshielded

STEVE PENNOCK
Steven J Pennock 07/25/06
E-600 # 02488 CAL. DUE. 09/07/06
SPA-3 # 51847 CAL. DUE 12/14/06
EFF. 253 cpm/pci/gram Unshielded

* ALL SCAN LOCATIONS SHOWED NO
REPRODUCABLE COUNTS OVER AREA BKGD.
PER PROBE SCANNED AREA 1m X 10m RUNS.
detector held 2 to 3 inches over surface,
BKGD. COUNTS TAKEN @ waist level

* A. E-600 # 02488 60 sec. BKGD. COUNT = 7.42 cpm
* B. E-600 # 02619 60 sec. BKGD. COUNT = 7.18 cpm

readings shown ALL in cpm.

A = INSTRUMENT E-600 # 02619 MM
B = INSTRUMENT E-600 # 02488 SJP

OOL-16-01

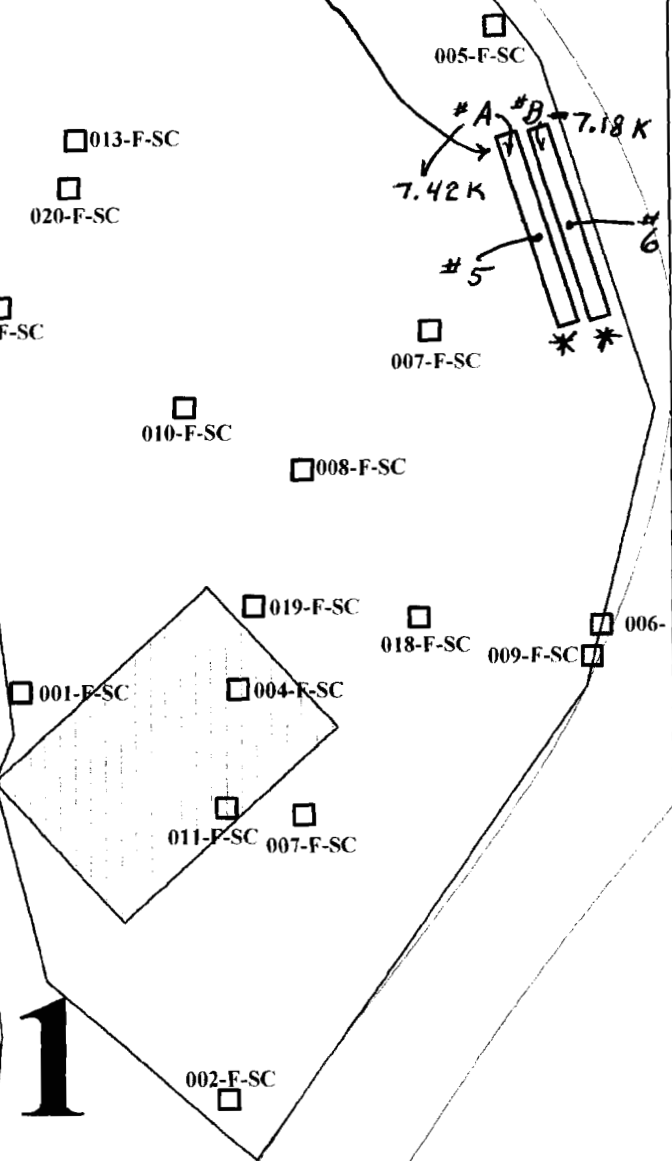

<p>Legend</p> <p>□ = Scan Location</p> <p>□ = Furlon House Footprint</p> <p>xxx = Scan Location ID</p>	<p>Map current as of July 13, 2006</p>	<p>Survey Area & Unit: OOL-16-01</p> <p>SPA-3 Scans</p> <p>Area size: 2342.4 m²</p>	<p>Yankee Atomic Power Company</p>	<p>Prepared by:</p>
	<p>Map Revision #: 0</p>	<p>FSS SPA-3 Scan Location Map</p>	<p>Date:</p>	

FSS Sample Locations
OOL-16-01-xxx-F (S) (RC)

07/25/06
M. MAX

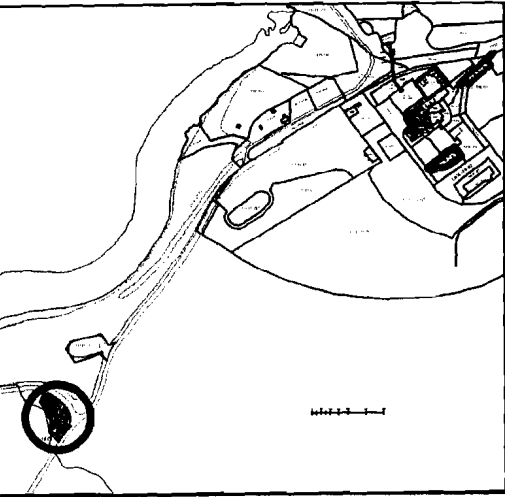

TOTAL . 20-3 done 19,04,11
17-MARNILLI

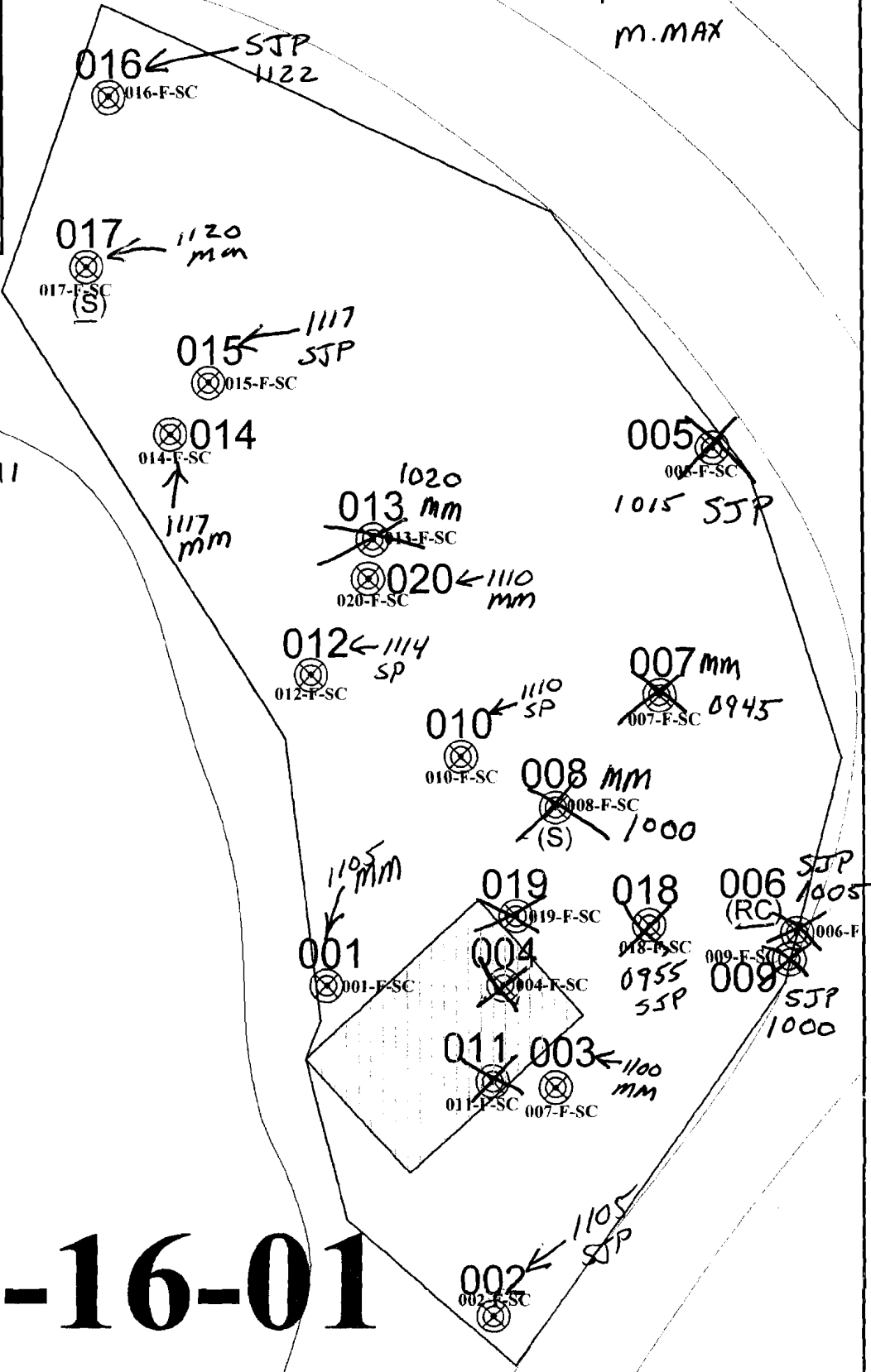

OOL-16-01

Legend = Sample Location = Furlon House Footprint xxx = Sample Location ID	Map current as of May 23, 2006	Survey Area & Unit: OOL-16-01 FSS Sample Locations Based on Random Start 20 sample locations Area size: 2342.4 m ²	Yankee Atomic Power Company	Reviewed by:
	Map Revision #: 0	FSS Sample Location Map	Date:	Date:

