



Environmental, Geotechnical and Materials Engineers

8989 Herrmann Drive, Suite 300
Columbia, MD 21045-4710
www.atcassociates.com
410-381-0232
Fax 410-381-0247

November 8, 2006

U.S. Nuclear Regulatory Commission
Nuclear Materials Safety Branch
Region I
King of Prussia, Pennsylvania 19406

NMSB3

Re: Addendum to License No. 19-19822-01 – Docket No. 030-19282

Attn: Licensing Assistance Team:

On November 20 2006, ATC Associates Inc. will be relocating from its Columbia, Maryland office, located at 8989 Herrmann Drive, Suite 300 to its new office location, located at 9231 Rumsey Road, Columbia, Maryland 21045-1924.

We are requesting that you please amend our license to reflect this change. Included with this letter is a copy of the floor plan detailing the location of the nuclear gauge storage area as well as where the radiation monitoring badges will be kept.

The RSO for the new location will continue to be Jeffrey A. Wieboldt,

Thank you for your help in this matter. Should you have any questions regarding this matter please feel free to contact our office.

Sincerely,

ATC Associates Inc.

Jeffrey A. Wieboldt
Branch Manager / RSO

Jonathan Cary
Operations Manager / Assistant RSO

Enclosures: Floor plan of new office location

RECEIVED
REGION 1
2006 NOV 13 AM 10:17

139716
NRC/RCM MATERIALS-002

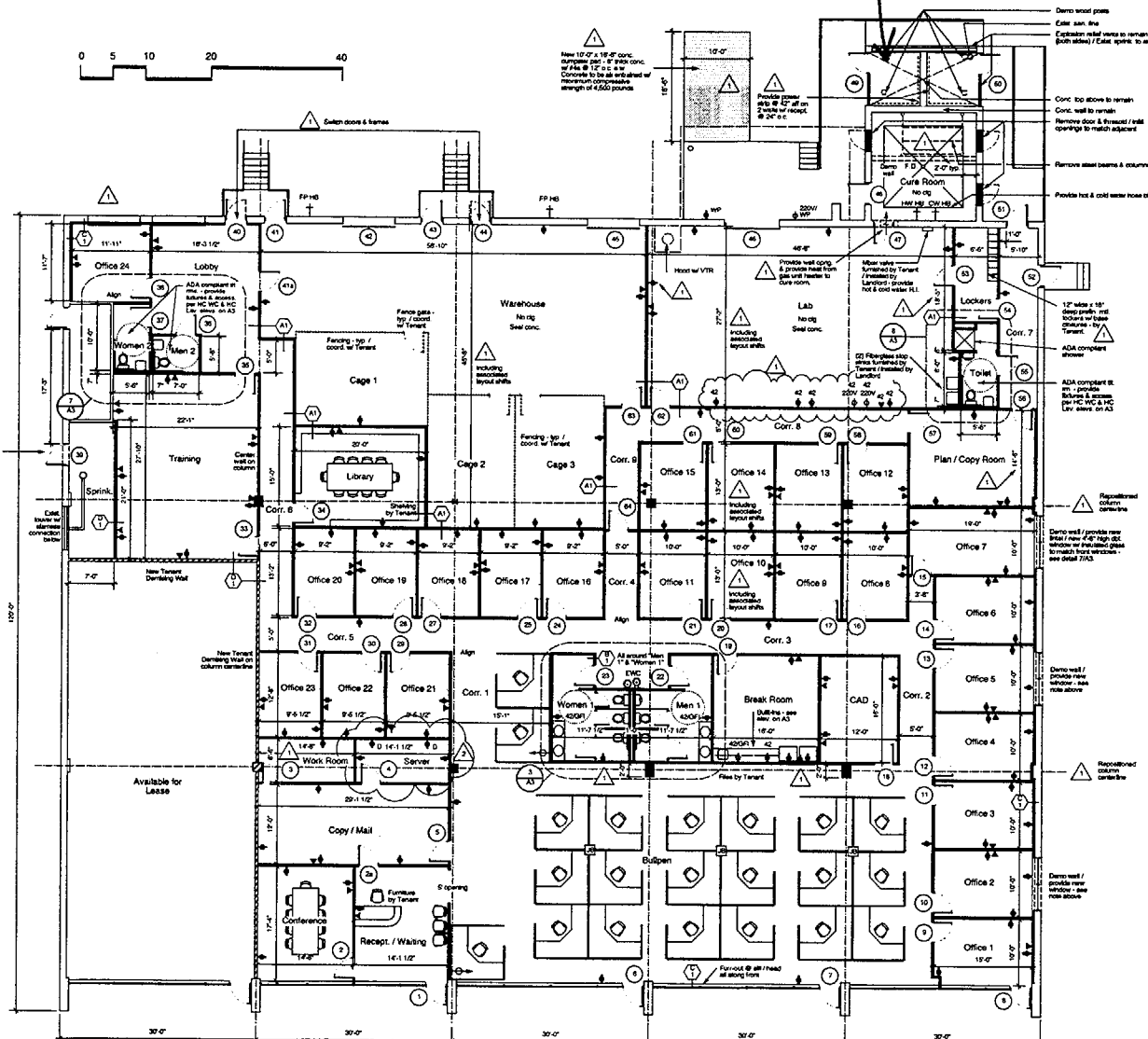
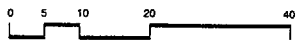

Demolish wall by 1" below slab / provide new base & 2x4 post and beam support and anchor to base plate & set primary support floor framing on supports above door - set frame 12" in from wall, keep 6" min. at set wall conc. from wall.

New 12" x 18" conc. composite slab on steel deck - 12" thick. 18" high. 2" concrete. Supports to be set and anchored for minimum of 2,000 pounds.

Demolish wood panel
Elev. see line
Elevations refer to section
Each side / Case space to remain
Conc. top above to remain
Conc. wall to remain
Remove door & threshold / install openings to match adjacent
Remove steel beams & columns
Provide hot & cold water hose bibbs

Registered column
Demolish wall / provide new steel wall over existing wall - see note above
Registered column
Registered column

Demolish wall / provide new window - see note above
Demolish wall / provide new window - see note above

NUKE
STORAGE
AREA

1 Floor Plan
Scale: 1/8" = 1'-0"

Note:
1 All furniture, workstations by Tenant.
2 Provide 1/4" in semi-enclosed space per NFPA 101.

Floor Plan Legend

- Existing Construction to Remain
- New Construction
- Demolition

Electrical Legend

- 42 Duplex receptacle
- 4200R GFI duplex receptacle @ hg. noted on
- WIP Waterproof duplex receptacle
- 220V 220 volt receptacle
- 220V 330 volt waterproof receptacle
- Contra phone / data jack
- Systems furniture base feed for power, phone, data
- Junction box @ cly. for furniture & recessed power pane

I certify that these documents were prepared or approved by me, and that I am a duly licensed architect under the laws of the State of Maryland.

License number: 15620
Expiration date: March 13, 2008

Code Analysis 2003 IBC

Use Group: Non-separated B & S-1
Construction Type: 1B
Sprinklered
Tenant Area: 16,420 SF

Floor Plan
1/8" = 1'-0"

Lloyd ARCHITECTS P.A.
12011 Oldfield Drive, Upper Marlboro, Maryland, 20774
410.351.1127

ATC
Equus Court
Oakland Ridge Industrial Center
9231 Rumsey Road
Columbia, Maryland

7 Jun 06
13 Jun 06
24 Aug 06
20 Oct 06

A1

This is to acknowledge the receipt of your letter/application dated

11/8/2006, and to inform you that the initial processing which includes an administrative review has been performed.

AMEND. 19-19822-01
There were no administrative omissions. Your application was assigned to a technical reviewer. Please note that the technical review may identify additional omissions or require additional information.

Please provide to this office within 30 days of your receipt of this card

A copy of your action has been forwarded to our License Fee & Accounts Receivable Branch, who will contact you separately if there is a fee issue involved.

Your action has been assigned **Mail Control Number** 139716.
When calling to inquire about this action, please refer to this control number.
You may call us on (610) 337-5398, or 337-5260.