

... - Revised LT boundary

From: "Miller, Lou -- MFG" <Lou.Miller@mfgenv.com>
To: "Stephen Cohen" <SJC7@nrc.gov>
Date: 08/01/2006 1:42 PM
Subject: Revised LT boundary
CC: "Corte, Lawrence J." <lcorte@phelpsdodge.com>, <HWSfish@aol.com>

Steve,

Attached is the figure showing the new proposed long-term boundary.

I also was able to get the information you wanted regarding the amount spent on groundwater investigations and remediation.

The total spent to date is approximately \$18 million of which \$7 million was for remediation and \$11 million for the investigation.

I will call to discuss.

Lou

<<BND-OPT-02.pdf>>

Mail Envelope Properties (44CF9287.39F : 15 : 54175)

Subject: Revised LT boundary
Creation Date 08/01/2006 1:42:16 PM
From: "Miller, Lou -- MFG" <Lou.Miller@mfgenv.com>
Created By: Lou.Miller@mfgenv.com

Recipients

nrc.gov

OWGWPO03.HQGWDO01
 SJC7 (Stephen Cohen)

aol.com

HWSfish CC

phelpsdodge.com

lcorte CC (Lawrence J. Corte)

Post Office

OWGWPO03.HQGWDO01

Route

nrc.gov

aol.com

phelpsdodge.com

Files	Size	Date & Time
TEXT.htm	1145	
BND-OPT-02.pdf	432048	
Mime.822	595178	

Options

Expiration Date: None
Priority: Standard
ReplyRequested: No
Return Notification: None

Concealed Subject: No
Security: Standard

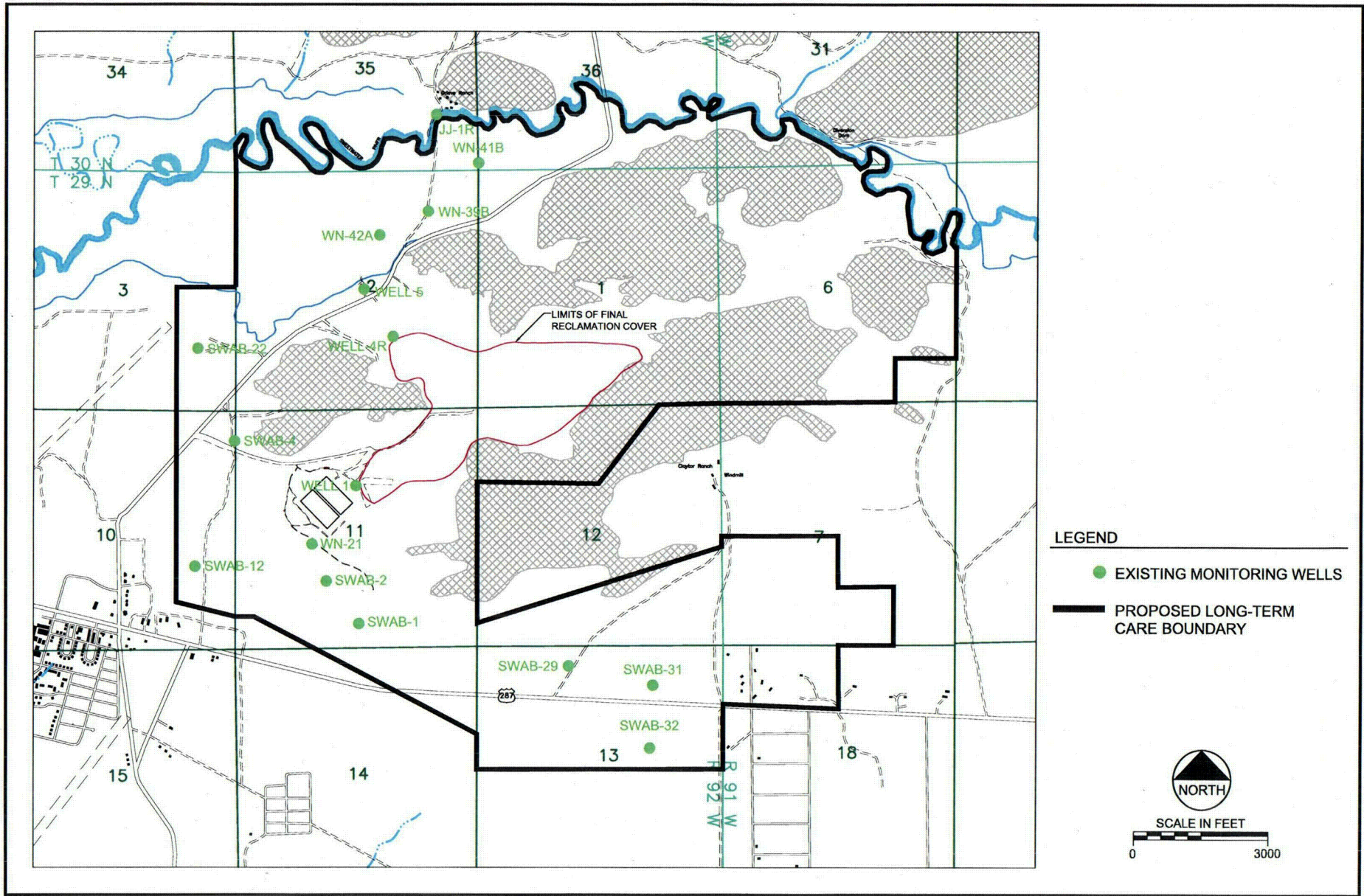

MFG, Inc.
consulting scientists and engineers

Date:	JULY 2006
Project:	003-347/2006
File:	BND-OPT-02.DWG