



Express Certified Mail – Return Receipt Requested

Union Carbide Corporation

ED 849866013 US

A Subsidiary of The Dow Chemical Company
PO Box 8361
3200/3300 Kanawha Turnpike
South Charleston, WV 25303
U.S.A

August 3, 2006

Mr. Dennis Lawyer
Nuclear Regulatory Commission - Region 1
475 Allendale Road
King of Prussia, Pennsylvania 19406-1415

Br 2.

**Subject: Union Carbide Corporation
South Charleston, West Virginia
Request for Facility Release**

*47-00260-02
03066652*

2006 AUG -4 PM 1:18

RECEIVED
REGION 1

Dear Mr. Lawyer,

Union Carbide Corporation (UCC), a wholly owned subsidiary of the Dow Chemical Company plans to change the utilization of its facility resources. Therefore, UCC requests that Building (B-747) and associated storage shed, previously used for radiation activities, be released for unrestricted use. UCC's intent is to demolish the facility as soon as practical, following your approval.

All radioactive materials have been removed from the building; and the building has been thoroughly wipe-tested and surveyed. The facility was wipe-tested and surveyed after all of the radioactive materials were removed. All wipe tests show removable contamination to be less than 50 dpm/100 cm². All survey results show that radiation levels in the building are not distinguishable from background levels. The details of the survey are shown in Attachments A and B.

Thank you for your anticipated prompt response. If you have any questions regarding this request, please contact the Radiation Safety Officer, Michael Boyd, at 304-747-7974.

Sincerely,

J. L. Blatt
Responsible Care Leader
West Virginia Operations

Attachments

139239
NMSS/RGNI MATERIALS-002

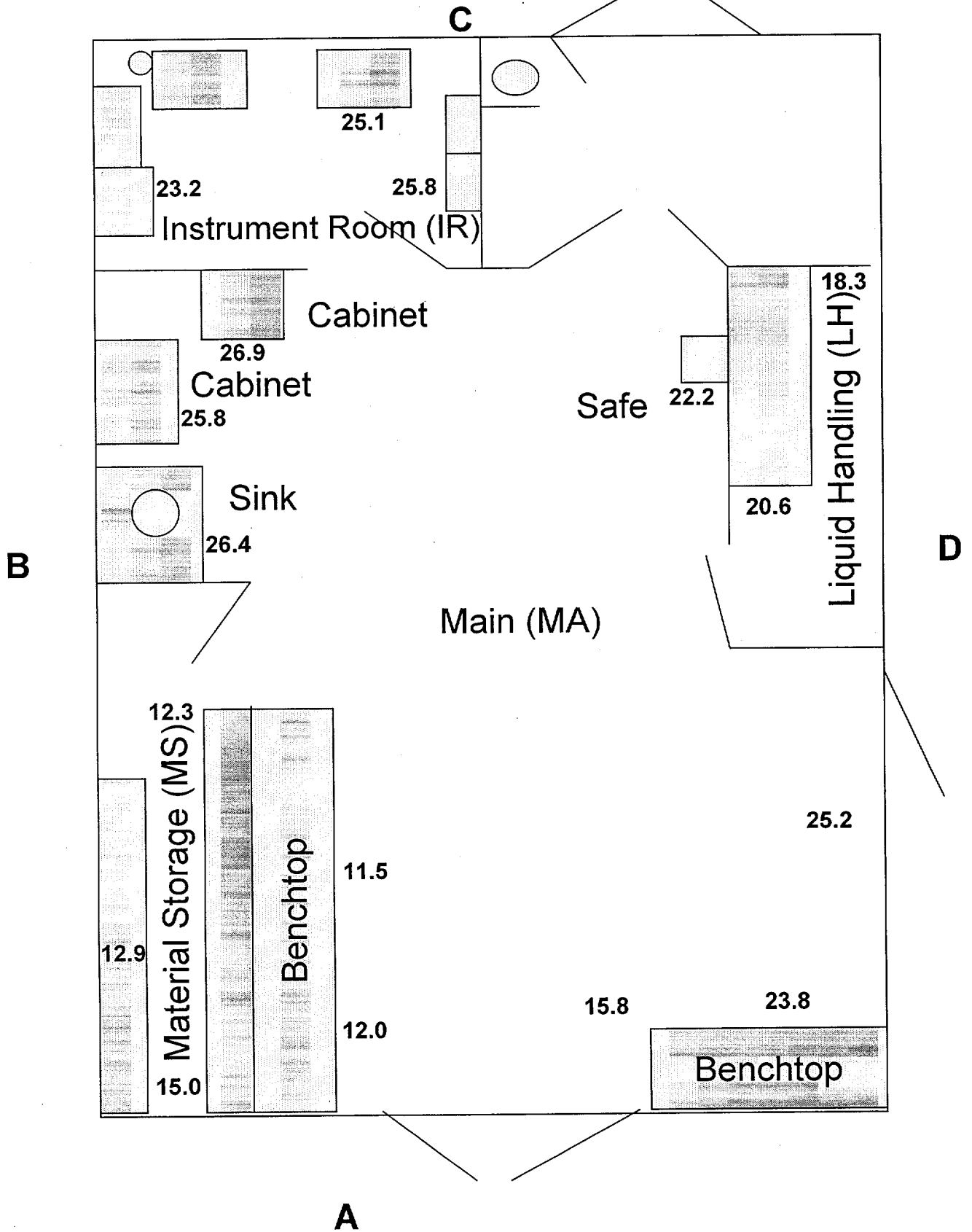

ATTACHMENT B

7/27/2006

B-747 Decommissioning Samples

| Bldg | Area | Equipment | Direction | Sample # | Description |
|------|------|-----------|-----------|----------|---|
| 747 | MA | BT | A | 11 | Left of Benchtop |
| 747 | MA | BT | A | 12 | Middle Benchtop |
| 747 | MA | DK | A | 13 | Interior Door Knob |
| 747 | MA | BT | A | 14 | Right Benchtop |
| 747 | MA | FL | A | 15 | Floor in Front of BT |
| 747 | MA | CA | A | 16 | Right Cabinet Door |
| 747 | MA | CA | A | 17 | Left Side, First Shelf of Cabinet |
| 747 | MA | DK | D | 18 | Interior Door Knob |
| 747 | MA | FL | D | 19 | Floor Mat (Center) |
| 747 | MA | SA | D | 20 | Safe - Shelf |
| 747 | MA | BT | B | 21 | Left of Benchtop |
| 747 | MA | BT | B | 22 | Middle of Benchtop |
| 747 | MA | BT | B | 23 | Right of Benchtop |
| 747 | MA | FL | B | 24 | Left Benchtop Floor Area |
| 747 | MA | FL | B | 25 | Middle Benchtop Floor Area |
| 747 | MA | FL | B | 26 | Right Benchtop Floor Area |
| 747 | MA | CA | B | 27 | Left Cabinet Over Benchtop |
| 747 | MA | CA | B | 28 | Middle Cabinet Over Benchtop |
| 747 | MA | CA | B | 29 | Right Cabinet Over Benchtop |
| 747 | MA | SK | B | 30 | Sink |
| 747 | MA | CAS2 | B | 31 | Cabinet Next to Sink - Shelf 2 |
| 747 | MA | CAS1 | B | 32 | Cabinet Next to Sink - Shelf 1 |
| 747 | MA | CAS3 | C | 33 | Cabinet Shelf 3 |
| 747 | MA | CAS5 | C | 34 | Cabinet Shelf 5 |
| 747 | IR | DT | B | 35 | Instrument Room Desk Top Left |
| 747 | IR | DT | B | 36 | Instrument Room Desk Top Right |
| 747 | IR | TT | B | 37 | Instrument Room Table Top Left |
| 747 | IR | TT | B | 38 | Instrument Room Table Top Right |
| 747 | IR | SMI | C | 39 | Instrument Room Skid-Mounted Instrument Top |
| 747 | IR | CDK | C | 40 | Instrument Room Computer Desk Keyboard |
| 747 | IR | WC1 | C | 41 | Instrument Room Wall Cabinet 1 |
| 747 | IR | WC2 | C | 42 | Instrument Room Wall Cabinet 2 |
| 747 | IR | TT-S1 | B | 43 | Instrument Room Table Top Shelf #1 |
| 747 | IR | TT-S3 | B | 44 | Instrument Room Table Top Shelf #3 |
| 747 | IR | PIC | C | 1N | PIC machine north sample tube-opening |
| 747 | IR | PIC | C | 1S | PIC machine south sample tube-opening |
| 747 | IR | PIC | C | 3C | PIC machine push-buttons/keyboard |
| 747 | LH | BT | B | 45 | Left of Benchtop |
| 747 | LH | BT | B | 46 | Middle |
| 747 | LH | BT | B | 47 | Right |
| 747 | LH | FL | B | 48 | Left |
| 747 | LH | FL | B | 49 | Middle |
| 747 | LH | FL | B | 50 | Right |
| 747 | LH | DK | D | 51 | Door Knob on exterior of room |
| 747 | LH | RS | B | 52 | Ring Stand |
| 747 | MS | SH | D | 53 | Left Shelf Bottom |
| 747 | MS | SH | D | 54 | Middle Shelf 2nd |
| 747 | MS | SH | D | 55 | Right Shelf 3rd |
| 747 | MS | SH | D | 56 | Left Shelf 3rd |
| 747 | MS | DT | B | 57 | Benchtop Left |
| 747 | MS | BT | B | 58 | Benchtop Right |
| 747 | MS | DK | B | 59 | Door Knob - outside room |
| 747 | MS | DK | B | 60 | Door Knob - inside room |
| 747 | MS | SK | B | 61 | Sink |
| 747 | MS | TD | C | 62 | Paper towel dispenser next to sink |

| | |
|-------------------------|---|
| BenchTop | BT |
| Shelf | S1, S2... Shelves numbered from ground up |
| Cabinet | CA |
| Safe | SA |
| Floor | FL |
| Door Knob | DK |
| Sink | SK |
| Desk Top | DT |
| Table Top | TT |
| Skid Mounted Instrument | SMI |
| Keyboard | CDK |
| Wall Cabinet | WC |
| Ring Stand | RS |
| PIC Machine | PIC |
| Paper Towel Dispenser | TD |

| | |
|------------------|----|
| Main Area | MA |
| Liquid Handling | LH |
| Material Storage | MS |
| Instrument Room | IR |

Orientation

C

B D

A

roadway

Samples taken on 07/27/2006 by BP

For questions regarding samples, please contact:
 Michael Boyd 304-747-7974 boydmb@dow.com
 (or)

CUSTOMER REQUEST DOW CHEMICAL U.S.A
H & ES ANALYTICAL CHEMISTRY LABORATORY

ES-AL NUMBER: 4724
 LS(172): 2388

| | | | | | |
|--|--------------------|--|----------------------------------|--|--|
| Date: 7/31/06 | Plant Code: | Cost Center: | Project/Task: | Date Needed By: | <input type="checkbox"/> Return Sample <input checked="" type="checkbox"/> Discard Sample |
| SAMPLE OF: <i>various wipe samples</i> | | | | | |
| SAMPLE NUMBER(S): <i>1-53</i> | | | | | |
| SAFETY HAZARDS | | | | | |
| <input type="checkbox"/> Toxic | | <input type="checkbox"/> Skin Irritant | | <input type="checkbox"/> Low Flash Point | |
| <input type="checkbox"/> Explosive | | <input type="checkbox"/> Spontaneous Flammable | | <input type="checkbox"/> Non-Hazardous | |
| <input type="checkbox"/> Lachrymator | | | | <input type="checkbox"/> Unusual Chemical Reactive | |
| NAME | DEPARTMENT | BUILDING | DOOR | PHONE | |
| <i>Michael Boyal</i> | | | | <i>304 - 747-7974</i> | |
| | | | | <i>304 - (Rm) 747-5924</i> | |
| | | | | | |
| RELATIVE ERROR SUFFICIENT, ETC. | | APPROXIMATE LEVEL, ETC. | | LOWER LIMIT, ETC. | |
| ANALYSIS REQUEST AND REASON FOR REQUEST. (PLANT OR PROJECT RELATED). INDICATE DOLLAR (\$) VALUE TO DOW. | | | | | |
| | | | | | |
| | | | | | |
| | | | | | |
| RESULTS: | | | | | |
| | | | | | |
| | | | | | |
| ALL WIPES BELOW DETECTION LIMIT OF 50 dpm/WIPE (2.3 x 10 ⁻⁵ μCi/wipe) INITIAL <i>LM</i> DATE <i>8/1/06</i> | | | | | |
| | | | | | |
| SIGNATURE: <i>Lindsay McAlley</i> | | PHONE: <i>989-638-8432</i> | | BUILDING: <i>1803</i> | |
| DATE FINISHED: <i>8/1/06</i> | HOURS: <i>5</i> | RESULTS PHONED: | REVIEWED BY: <i>SC Hansen</i> | | |

8-1-06

This is to acknowledge the receipt of your letter/application dated

8/3/2006, and to inform you that the initial processing which includes an administrative review has been performed.

Amendment 47-00260-02 There were no administrative omissions. Your application was assigned to a technical reviewer. Please note that the technical review may identify additional omissions or require additional information.

Please provide to this office within 30 days of your receipt of this card

A copy of your action has been forwarded to our License Fee & Accounts Receivable Branch, who will contact you separately if there is a fee issue involved.

Your action has been assigned **Mail Control Number** 139239.
When calling to inquire about this action, please refer to this control number.
You may call us on (610) 337-5398, or 337-5260.