

Requested by Mike Spera.

J. Deffer 5/3/06

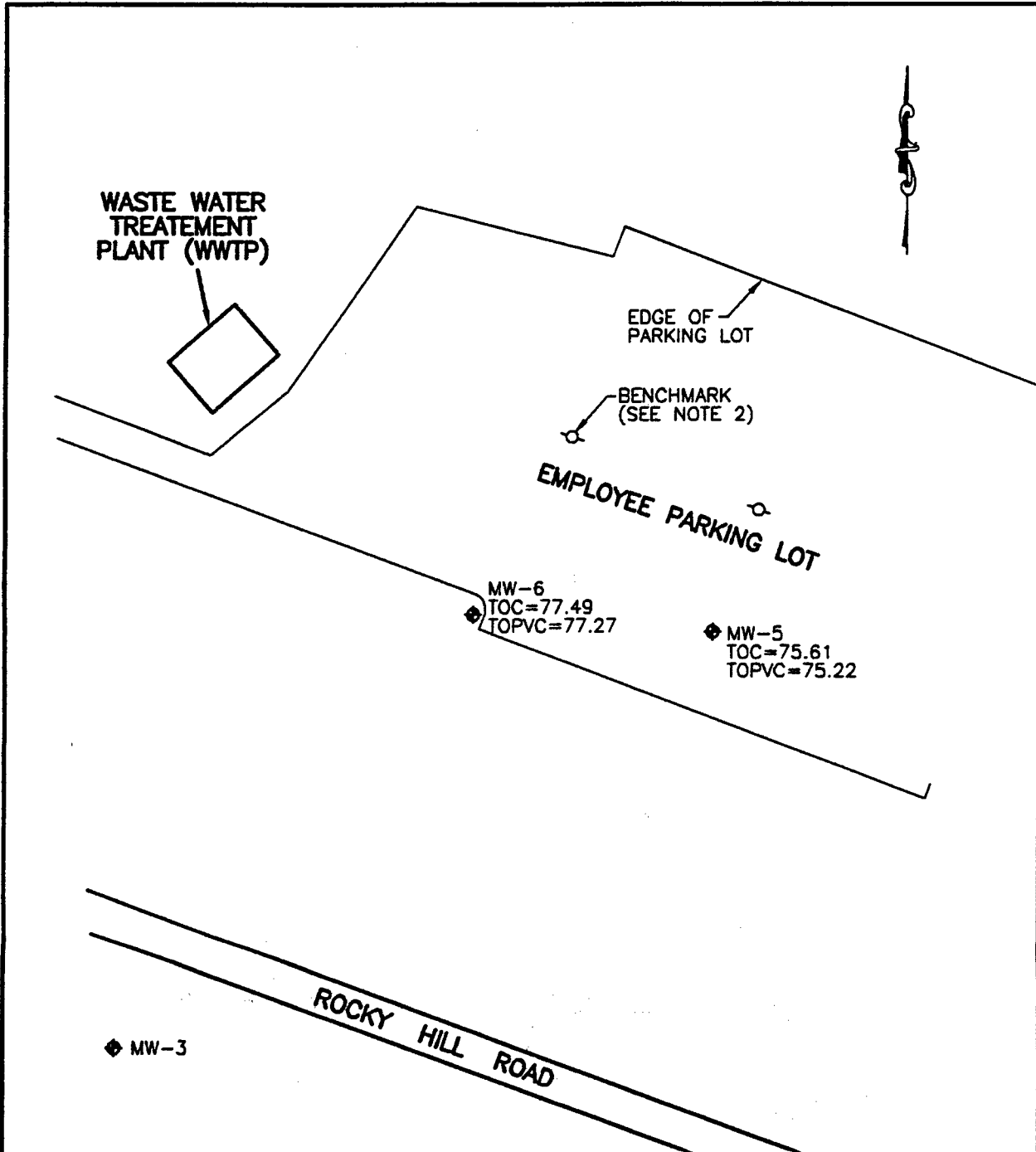

NOTES:

1. BASE PLAN DETAILS ARE BASED ON EXISTING SITE INFORMATION ON BOSTON EDISON DRAWING TITLED "SITE AND UTILITY PLAN", DRAWING NUMBER C-1186, REVISED 6/20/1990.
2. LOCATION OF MONITORING WELLS BASED ON BENCHMARK DATUM PROVIDED ON LORING H. JACOBS CO., DIVISION OF BOSTON SURVEY CONSULTANTS, INC., NORWELL, MA, DRAWING TITLED "AS BUILT LEACHING FACILITY, BOSTON EDISON CO., PILGRIM STATION NO. 600: UNIT 1, DATED MAY 17, 1982, JOB NO. J-507-22", BENCHMARK DATUM = 80.22 N.G.V.D. 1929 DATUM - NORTHERLY BOLT OF LIGHT POLE.
3. ELEVATIONS REFER TO MEAN SEAL LEVEL ELEVATION OF WELLS MW-5 AND MW-6 ARE BASED ON SURVEY CONDUCTED BY SITEC ENGINEERING, INC., ON JANUARY 13, 2006.
4. WELL COVER REPAIRS AT MW-5 AND MW-6 WERE COMPLETED BY DRAGN DRILLING INC. ON DECEMBER 7, 2005.

LEGEND:

- ◆ MONITORING WELL
- LIGHT POLE
- TOC TOP OF CASING (ROADBOX)
- TOPVC TOP OF PVC

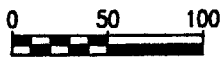

APPROXIMATE SCALE: 1" = 100'



FIGURE 1
SITE PLAN WITH
MONITORING WELLS
ENTERGY

DRAWN BY: WL	REV. NO./DATE: 2/13/2006	CAD FILE: ENT-SP.DWG
-----------------	-----------------------------	-------------------------