



101 ROUND HILL DRIVE
 ROCKAWAY, NJ 07866
 TEL. NUMBER (973) 664-9696
 FAX. NUMBER (973) 664-9699

P-7
29-30500-01M
03034940

FACSIMILE TRANSMITTAL SHEET

| | |
|--|--|
| TO: Mr. Richard Mckinley NRC Inspector | FROM: Ken Ali, Radiation Safety Officer |
| COMPANY: NRC | DATE: 5/19/06 |
| FAX NUMBER: 610-337-5269 | TOTAL NO. OF PAGES INCLUDING COVER: 3 |
| PHONE NUMBER: 610-337-5102 | |
| RE: Appendix to letter faxed on 5/17/06 | |

URGENT FOR REVIEW PLEASE COMMENT PLEASE REPLY PLEASE RECYCLE

NOTES/COMMENTS:

Mr. Mckinley:
 As per our phone conversation , I am sending the appended additional information regarding my close out survey of licensed premises located at 21 Pine Street, Rockaway NJ 07866
 Any questions, please call me @ (973)-664-9696.

Thank you
 Ken Ali RSO

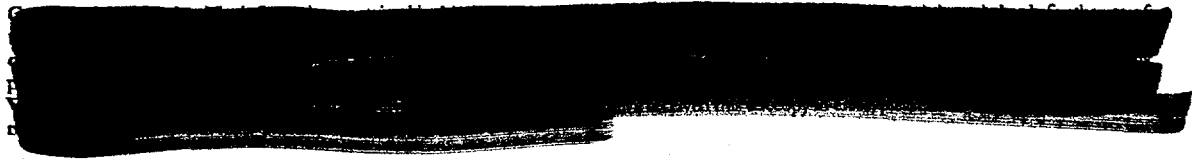

138845

N

**NUCLEAR
DIAGNOSTIC
PRODUCTS**

Attentive Services • Competitive Prices

Letter dated 4/20/06 faxed to NRC on 5/17/06 Re- License 29-30500MD
Appendix 1

Area Surveys of 21 Pine Street Re- Closeout Survey

As per the attached floor plan, the following values were recorded against background readings during my close out surveys

| Area Surveyed | Highest Bkg | Lowest Bkg | Highest Actual Reading | Lowest Actual Reading |
|----------------------|--------------------|-------------------|-------------------------------|------------------------------|
| 1. A | 0.05mR/Hr | 0.03mR/Hr | 0.03mR/Hr | 0.03mR/Hr |
| 2. AA | 0.05mR/Hr | 0.04mR/Hr | 0.04mR/Hr | 0.03mR/Hr |
| 3. C | 0.03mR/Hr | 0.03mR/Hr | 0.03mR/Hr | 0.02mR/Hr |
| 4. CC | 0.04mR/Hr | 0.03mR/Hr | 0.04mR/Hr | 0.02mR/Hr |
| 5. D | 0.05mR/Hr | 0.03mR/Hr | 0.04mR/Hr | 0.02mR/Hr |
| 6. E | 0.03mR/Hr | 0.02mR/Hr | 0.02mR/Hr | 0.02mR/Hr |
| 7. F | 0.03mR/Hr | 0.03mR/Hr | 0.03mR/Hr | 0.03mR/Hr |
| 8. G | 0.02mR/Hr | 0.02mR/Hr | 0.02mR/Hr | 0.02mR/Hr |
| 9. H | 0.02mR/Hr | 0.02mR/Hr | 0.02mR/Hr | 0.02mR/Hr |
| 10. I | 0.03mR/Hr | 0.01mR/Hr | 0.02mR/Hr | 0.01mR/Hr |
| 11. J | 0.02mR/Hr | 0.01mR/Hr | 0.01mR/Hr | 0.01mR/Hr |
| 12. K | 0.02mR/Hr | 0.02mR/Hr | 0.02mR/Hr | 0.01mR/Hr |
| 13. L | 0.02mR/Hr | 0.02mR/Hr | 0.02mR/Hr | 0.02mR/Hr |
| 14. M | 0.02mR/Hr | 0.02mR/Hr | 0.02mR/Hr | 0.01mR/Hr |
| 15. N | 0.02mR/Hr | 0.02mR/Hr | 0.02mR/Hr | 0.02mR/Hr |

All readings were taken with Ludlum survey meter Model 14C with a pancake(44-9) probe, serial # 178199, calibration valid until June 29, 2006. If there are any questions or concerns, please do not hesitate to contact me at (973)664-9696.

Thank you

 Ken Ali Radiation Safety officer

101 Roundhill Drive
 Rockaway, New Jersey 07866

(973) 664-9696
 (973) 664-9699 Fax

FLOOR PLAN

21 Pine Street, Rockaway, NJ 07866

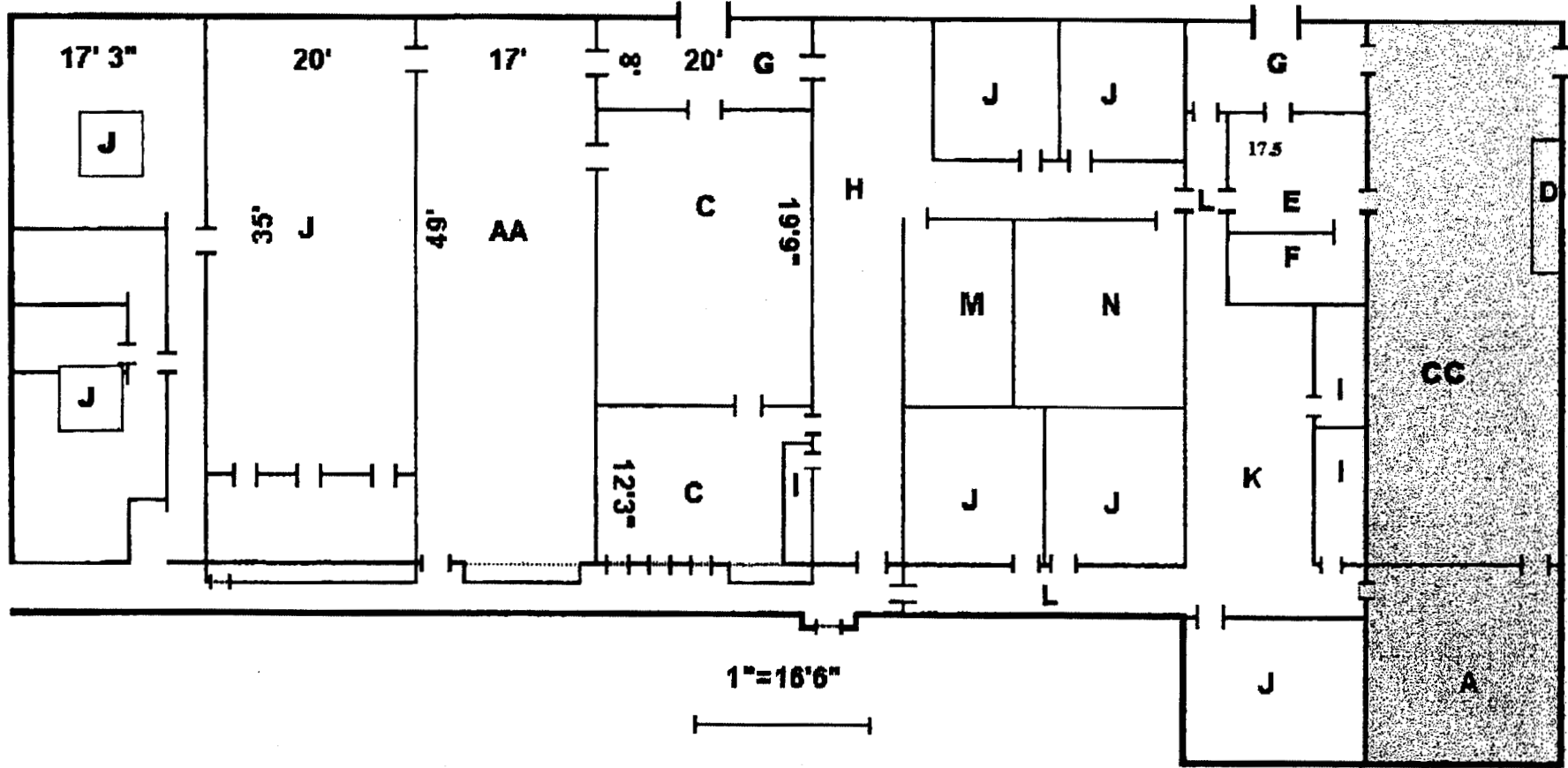

UNRESTRICTED AREA

- G** Delivery Dispatch
- H** Order Entry
- I** Restrooms
- J** Offices /Store Rooms
- K** Lounge/Lunchroom
- L** Hallways
- M** Compounding Area (Unrestricted)
- N** Store Room

RESTRICTED AREA

- A** 131-Iodine & XE-133 Room
- AA** Radioactive Storage
- C** Dispensing Area
- CC** Dispensing Area
- D** Compounding Area
- E** Packaging Area
- F** Blood Labeling Room