

User: WELSHANS, Spec: PIRNIE, STANDARD File: I:\ACAD\PROJ\4812014\CONFORMED-DESIGN\M-22.DWG Scale: 1:1 Date: 12/08/2005 Time: 09:45 Layout: Layout1

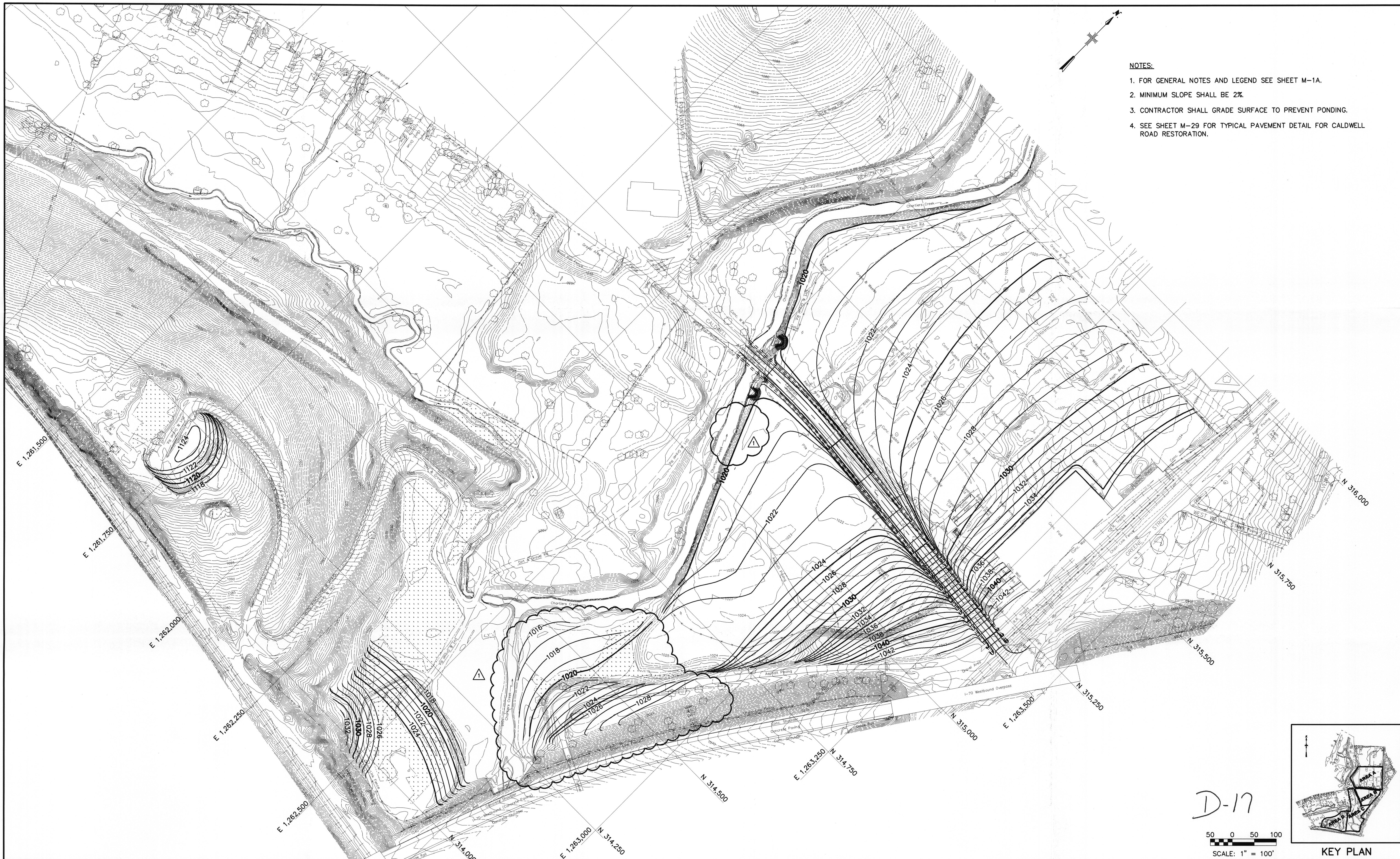

- NOTES:**
1. FOR GENERAL NOTES AND LEGEND SEE SHEET M-1A.
 2. MINIMUM SLOPE SHALL BE 2%.
 3. CONTRACTOR SHALL GRADE SURFACE TO PREVENT PONDING.
 4. SEE SHEET M-29 FOR TYPICAL PAVEMENT DETAIL FOR CALDWELL ROAD RESTORATION.

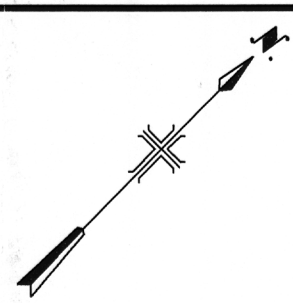

D-17

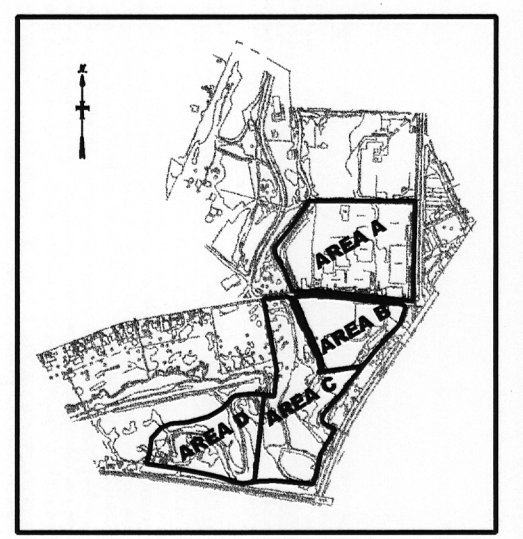
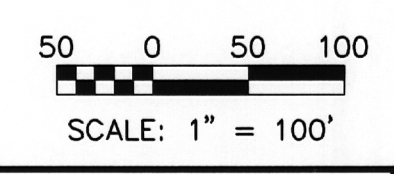

KEY PLAN



REVISIONS			
NO.	BY	DATE	REMARKS
1	TCS	11/15/05	REVISED PER POST BID CHANGE

DES DD
DWN MAW
CKD BEG

MOLYCORP, INC
WASHINGTON, PA

SITE REMEDIATION CONSTRUCTION

FINAL GRADING PLAN

COPYRIGHT © 2005
MALCOLM PIRNIE, INC.
DATE JUNE 2005
M SHEET 22 OF 46
CAD REF. NO. M-22