



Tara Hospital at Brownsville

Country Hospital... World Class Care

MS 16

J-3

January 16, 2006

UPDATE

Ms. Pamela Henderson
Branch Chief
U.S. Nuclear Regulatory Commission
Region 1
475 Allendale Road
King of Prussia, PA 19406-1415

030 20000

RECEIVED
JAN 17 2006
PM 1:29

Re: Termination of NRC License #37-20624-01

Dear Ms. Henderson,

Please terminate our aforesaid NRC license for Brownsville General Hospital, Inc. (tdba TARA Hospital at Brownsville.) The Hospital surrendered its license to the Department of Health on January 8, 2006.

Enclosed you will find a close-out survey by our consulting physicist. If you have any questions please contact me at 724-785-1703.

Sincerely,

Harry Cancelmi
Chief Executive Officer

enclosure

HC/gm

138205

NMOS/PGH MATERIALS-002

Krishnadas Banerjee, Ph. D., FACR., FAAPM.

CONSULTING RADIOLOGIC PHYSICIST

641 Ravencrest Road • Pittsburgh, PA 15215

DIPLOMATE: AMERICAN BOARD OF RADIOLOGY

OFFICE: (412) 963-7069

HOME: (412) 963-7069

e-mail: kbanerjee@JUNO.com

Fax: 412-963-7069

Cell Phone: 412-559-9943

January 17, 2006

Harry Cancelmi
Chief Executive Officer
Brownsville General Hospital
125 Simpson Road
Brownsville, PA 15417

RE: Closeout survey of Nuclear Medicine Department

Dear Mr. Cancelmi:

I have completed the closeout survey of the Nuclear Medicine Department on January 16, 2006 as requested by you.

I did a G.M survey with a Bicon - 2000 survey meter. The survey meter was calibrated on 7/21/05 and its reading against the check source with the Shield open was equal to 1.0 mR/hr. The background counts was between 0.01 and 0.02 mR/hr.

The wipes were counted in a "Caprac" well scintillation counter. Approximately 100 cm² area was wiped in each location. The efficiency of the well counter in the wipe window (between 70 KeV and 300 KeV) was equal to 80.8 %. The minimum detectable activity was equal to 1.68×10^{-5} microcurie. The background count was equal to 254 cpm. Samples taken from the floor are mentioned on the diagram.

For the positions shown in the attached table refer to the Nuclear Medicine dept. diagram.

I also checked the decay room (not shown in the diagram) and there was no contamination.

You can send these table to NRC and the State.

If you have any question please don't hesitate to contact me.

Sincerely,

Krishnadas Banerjee
Krishnadas Banerjee, Ph.D.
(Consulting Physicist)

CONTAMINATION SURVEY RESULTS AT BROWNSVILLE HOSPITAL

G. M. Survey Results			Wipe test results			
Position #	Location	G. M meter reading in mR/hr	Position #	Location	Net cpm	Net dpm
1	near L bock	0.01	1	near L bock	12	15
2	near dose calibrator	0.02	2	near dose calibrator	10	12
3	injection table	0.02	3	injection table	2	2
4	rest room	0.02	4	rest room	3	3
5	camera room	0.01	5	camera room	11	14
6	spectrometer room	0.01	6	spectrometer room	4	5
7	hot lab	0.01	7	hot lab	21	26
8	spectrometer room	0.02	8	spectrometer room	11	14
9	rest room	0.01	9	rest room	16	20
10	computer console	0.01	10	computer console	7	9
11	sink	0.02	11	sink	8	10
12	hot lab	0.01	12	hot lab	9	11
13	hot lab door	0.02	13	hot lab door	14	17
14	corridor	0.01	14	corridor	8	10
15	camera room	0.01	15	camera room	10	12

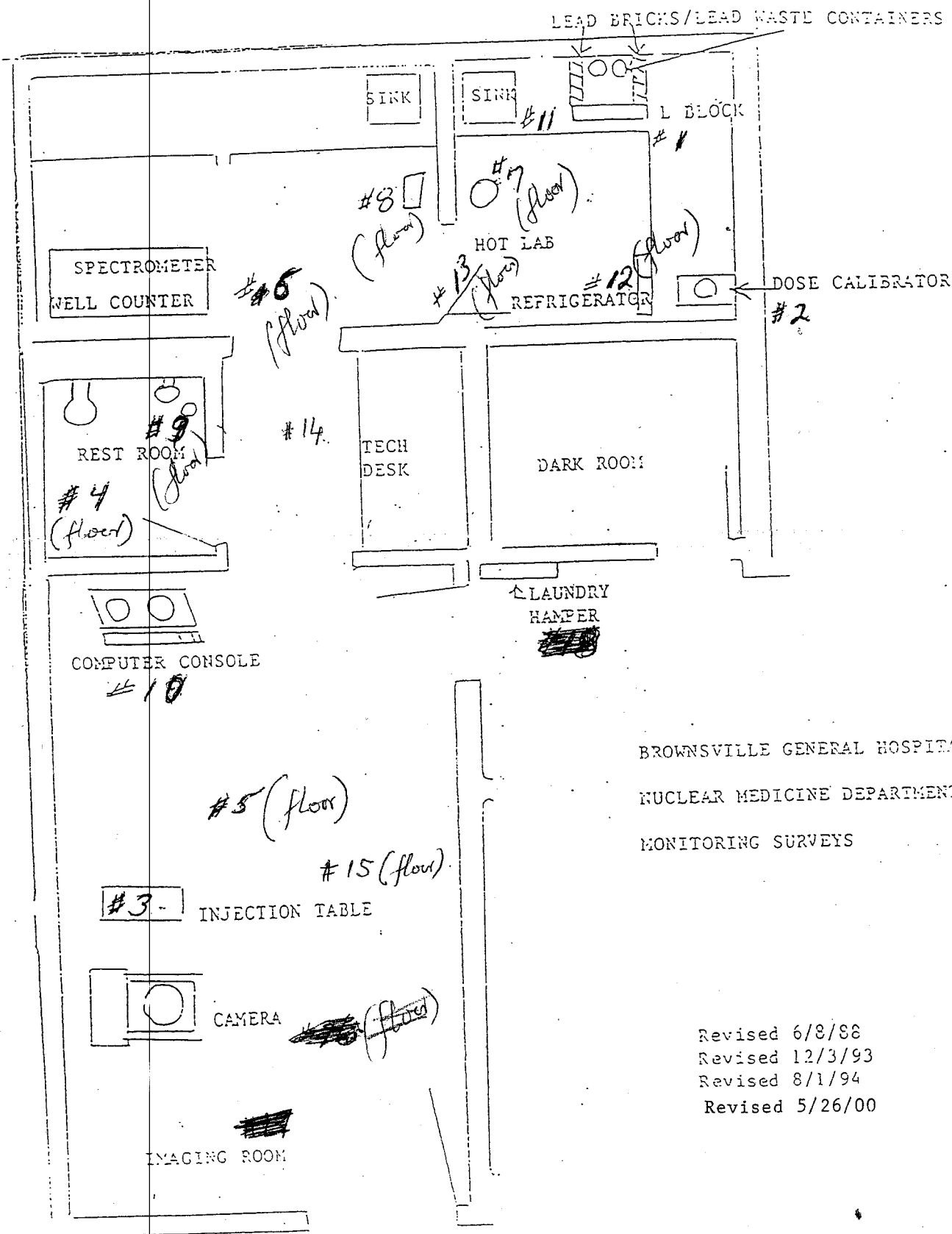

BROWNSVILLE GENERAL HOSPITAL
NUCLEAR MEDICINE DEPARTMENT
MONITORING SURVEYS

Revised 6/8/86
Revised 12/3/93
Revised 8/1/94
Revised 5/26/00

Ps6210