



New Facilities at Hematite Plant 1989

PROGRESS REVIEW
FOR
NUCLEAR REGULATORY COMMISSION
BY
L. N. GROSSMAN
5/24/89

20-2

R3/A3-11

MMS-4/1/89

REVITALIZATION PLAN FEATURES

HEMATITE

- *INCREASED CONVERSION CAPACITY
- *46,000 SQUARE FEET NEW FLOOR SPACE
- *TWO NEW PELLET LINES
 - NEW PRESSES, FURNACES, GRINDERS
 - EXISTING LINE
 - SIX ENRICHMENT BLENDERS
 - DRY POWDER PREPARATION
- *ADDED STORAGE, SHIPPING, & OFFICE SPACE

WINDSOR

- *SEMI-AUTOMATED ROD FABRICATION
 - ENDS MANHANDLING
 - INFORMATION AUTOMATION
 - MULTI-ENRICHMENT
 - PROCESS CONTROL ON WELDERS
 - PELLET STORAGE/RETRIEVAL AUTOMATION
- *NEW FUEL ROD SCANNER
 - THIRD GENERATION
 - ERBIA RETROFIT CAPABILITY
- *ADDED OFFICE SPACE
- *COMPONENTS & ASSEMBLY SHOP UPGRADE

MAY 24 NRC MEETING

HEMATITE CONSTRUCTION & SCHEDULE UPDATE

CONSTRUCTION PROGRESS (SEE ATTACHED DRAWING)

-WAREHOUSE (IN USE)

-PELLET BUILDING

BUILDING COMPLETED - APRIL 14, 1989

SUBFLOOR UTILITIES COMPLETED - MAY 5, 1989

ELECTRICAL UNDERWAY

BEGIN EQUIPMENT INSTALLATION - JUNE 1, 1989

-STORAGE/UTILITY BUILDING

WORK DELAYED DUE TO STRIKE

FOOTINGS 90% COMPLETE

ROOF UP - JUNE 12, 1989

SOIL INSPECTION - JUNE 26 (EARLY) - JULY 10 (LATE)

NRC RELEASE - AUGUST 1, 1989 (ESTIMATED)

-WOMEN'S LOCKER ROOM

DESIGN WORK COMPLETED

CONSTRUCTION COMPLETE - AUGUST 1, 1989 (ESTIMATED)

-7-

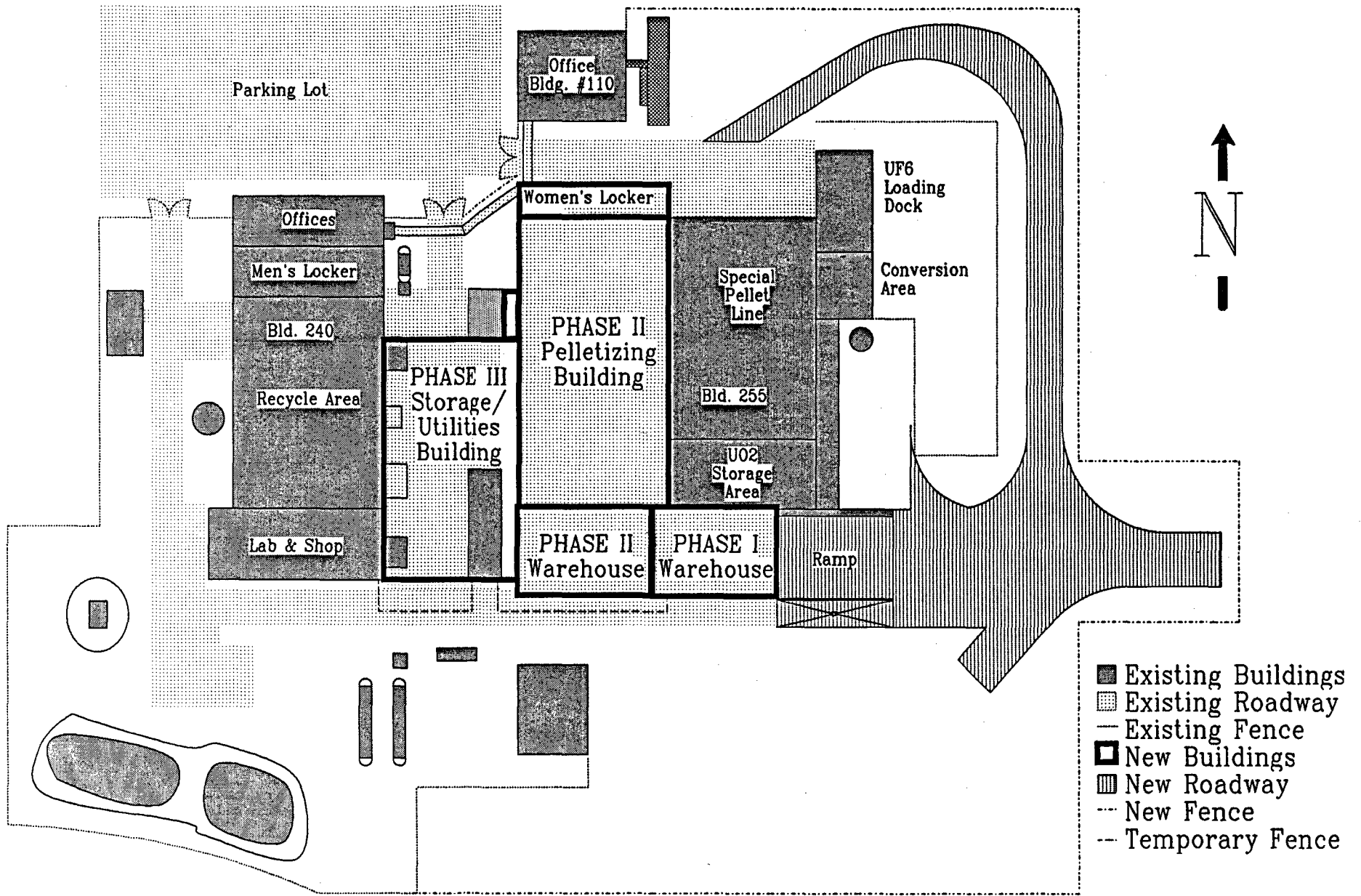

Hematite Facility

DRR 4/24/89

MAY 24 NRC MEETING

HEMATITE CONSTRUCTION & SCHEDULE UPDATE

LINE 1 SCHEDULE PROGRESS (SEE ATTACHED SCHEDULE)

- EQUIPMENT INSTALLED & BEGIN DEPLETED TESTING BY JUNE 30, 1989.
- LINE 1 SCHEDULED FOR SEPTEMBER 1, 1989, PRODUCTION PLAN IS TO KEEP SCHEDULE. QUALIFICATION IS CRITICAL ACTIVITY.

-5-

Hematite Pellet Production
Line 1 - Startup Schedule
5/24/89

1989

March	April	May	June	July	August	Sept.	October
6 13 20 27	3 10 17 24	1 8 15 22 29	5 12 19 26	3 10 17 24 31	7 14 21 28	4 11 18 25	2 9 16 22 30

PELLET BUILDING

Place Roof

Pour Floor

EQUIPMENT

Install Utilities

Bulk Oxide Hoppers

Large Blenders

Slug & Granulate System

Production Press

Dewaxing Furnace

Sintering Furnace

Grind to Ship

HVAC and Dust Control

START UP AND TESTING

Functional Tests

Qualifications

Production

Legend

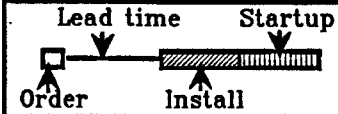

* Revised since last issue

D. R. Rohde 5/18/89

-7-

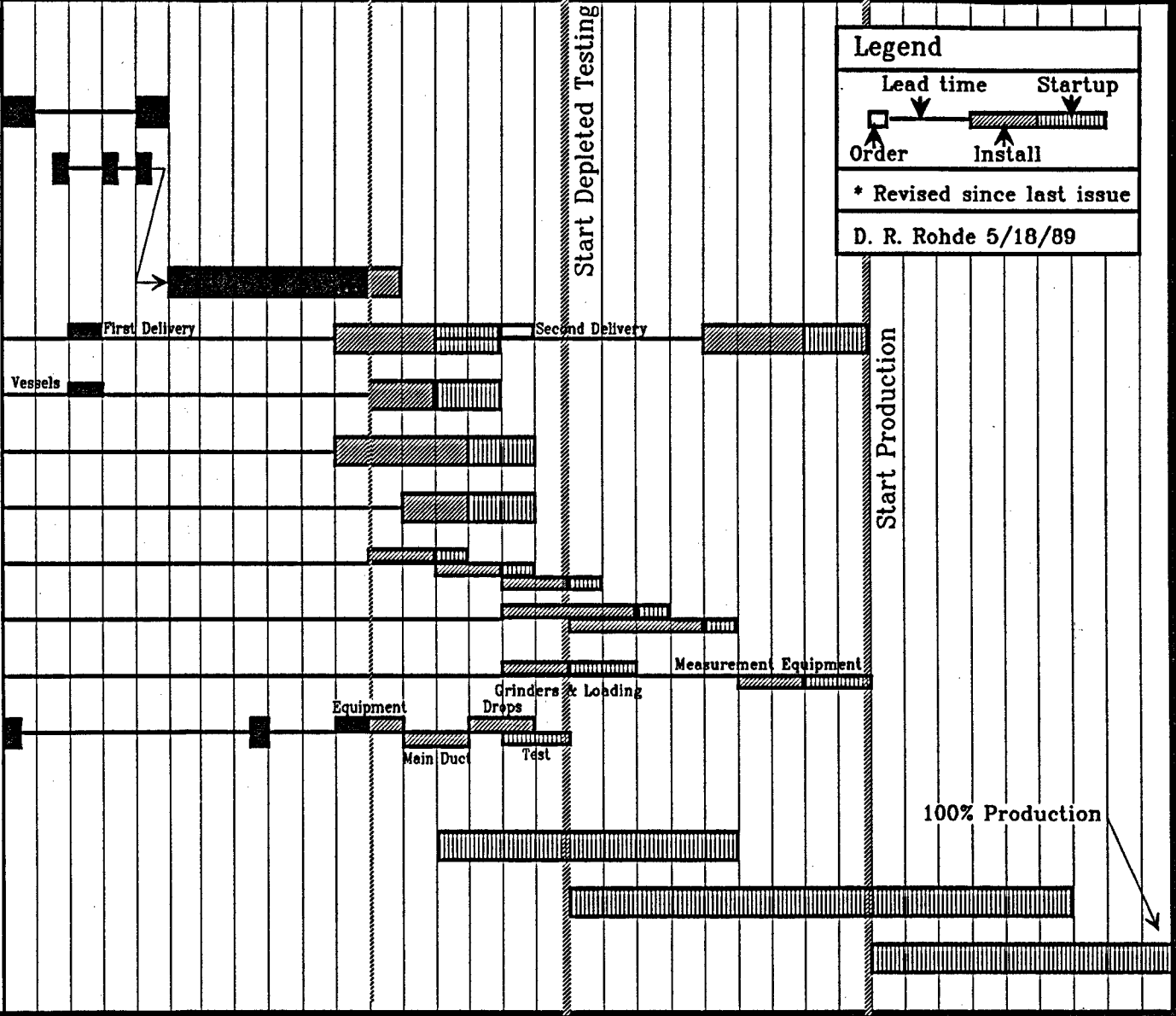

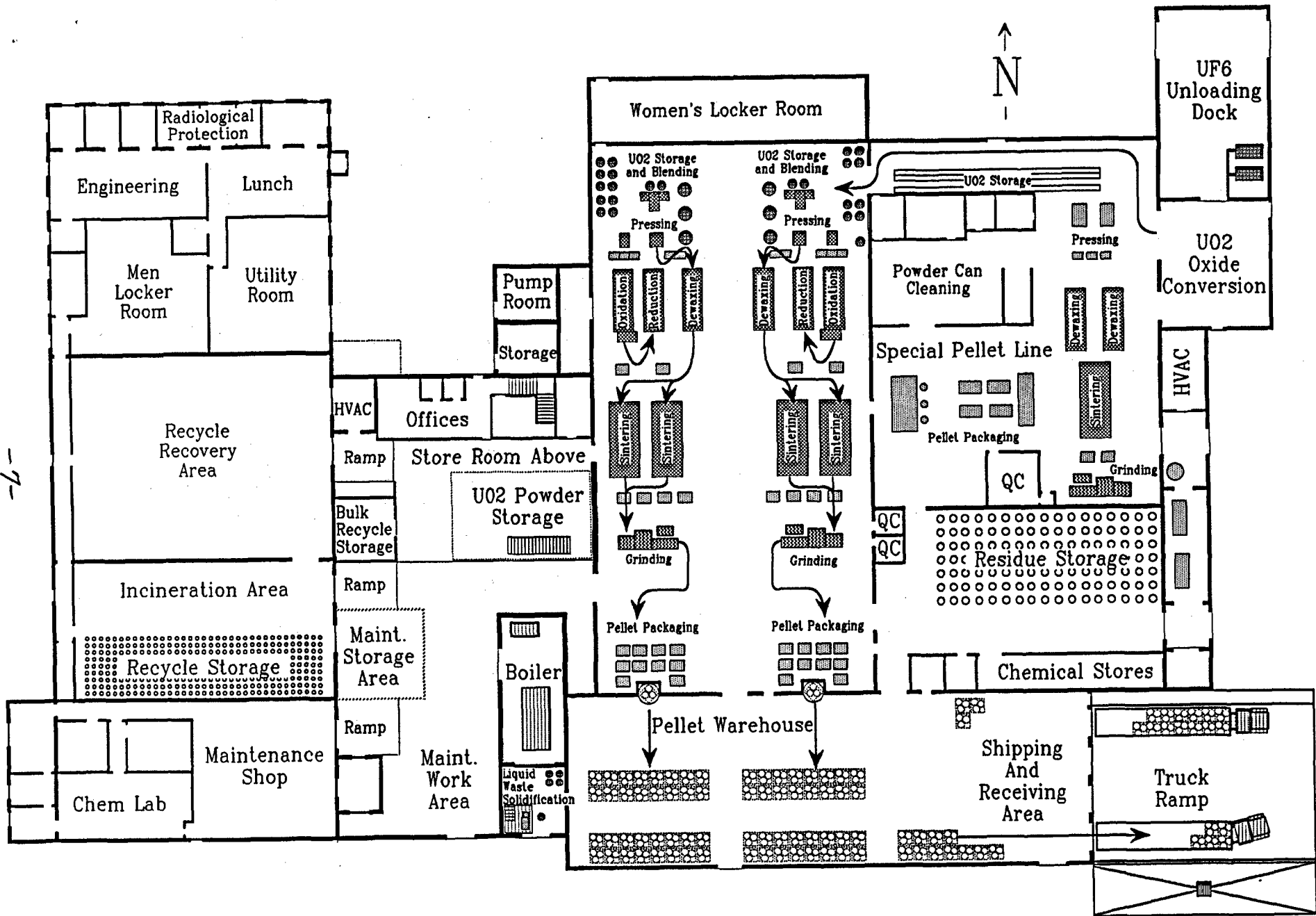

Hematite Equipment Layout

D. R. Rohde
2/2/89

-8-

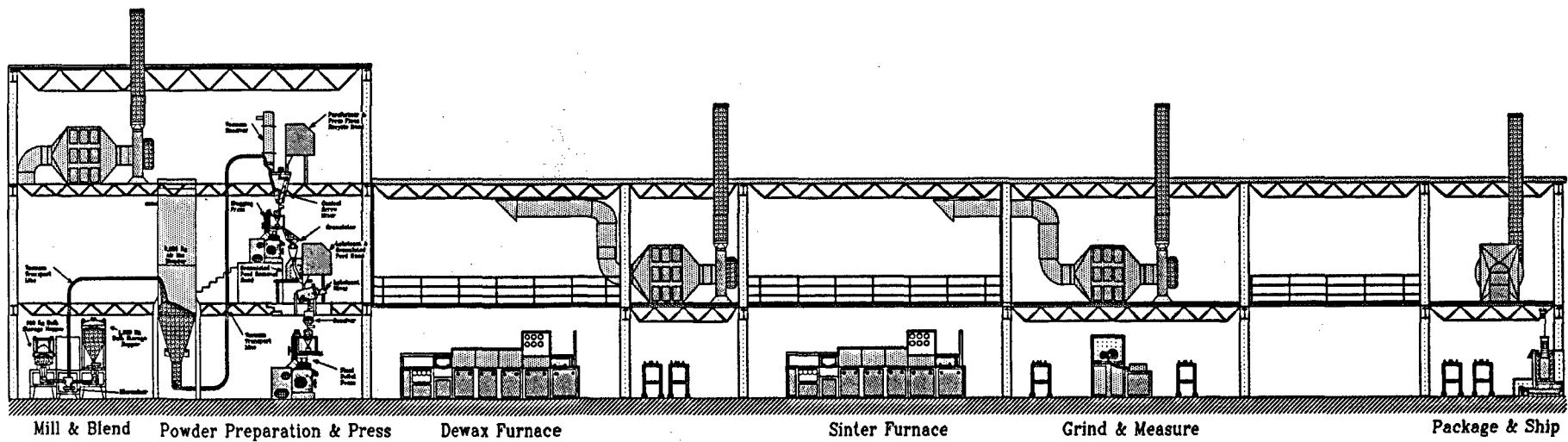

Nuclear Fuel's New Hematite Pellet Production Facility

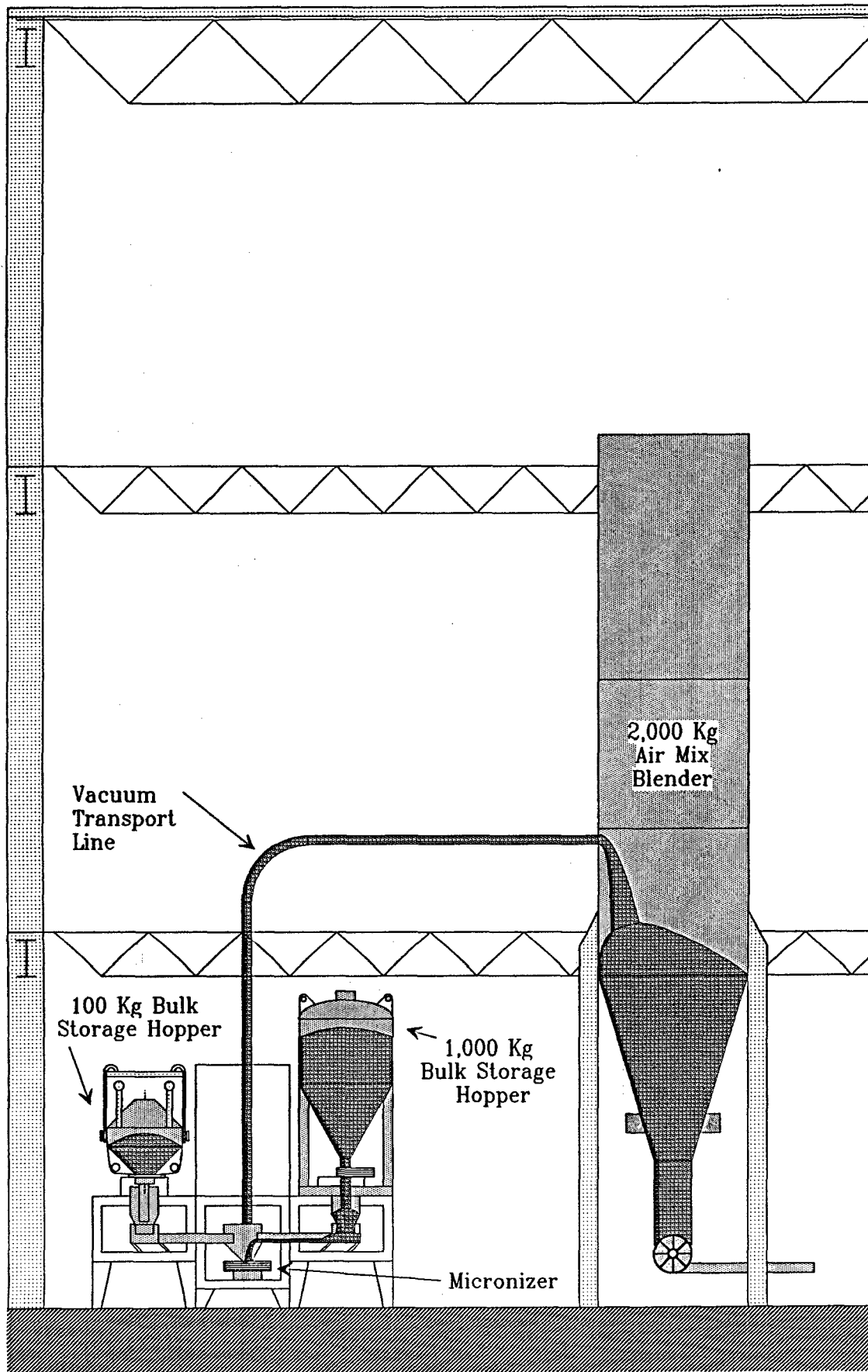

Hematite Micronizing & Blending

D. R. Rohde
2/13/89

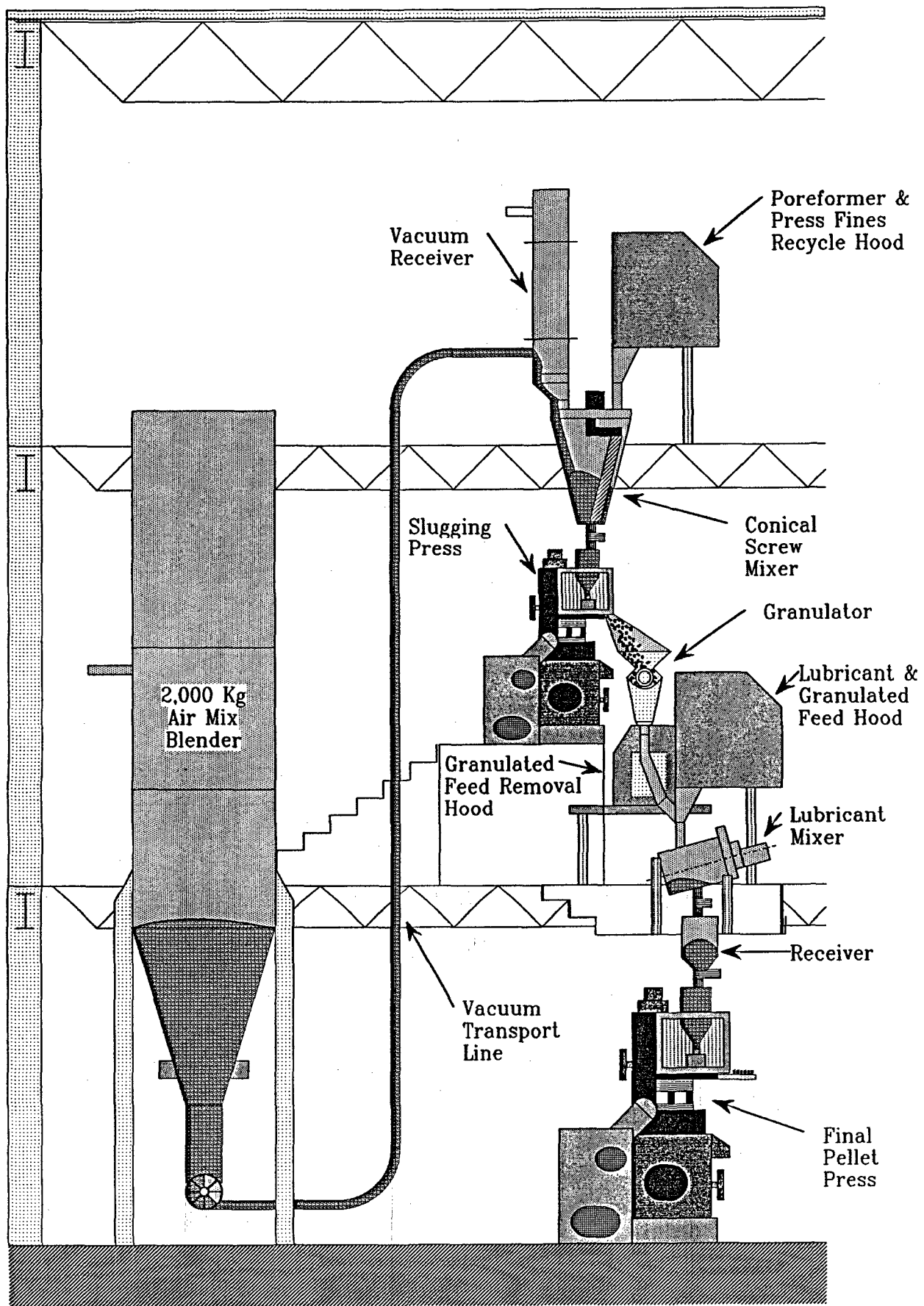

Hematite Press Feed Preparation

D. R. Rohde
2/13/89

Figure II.9-3

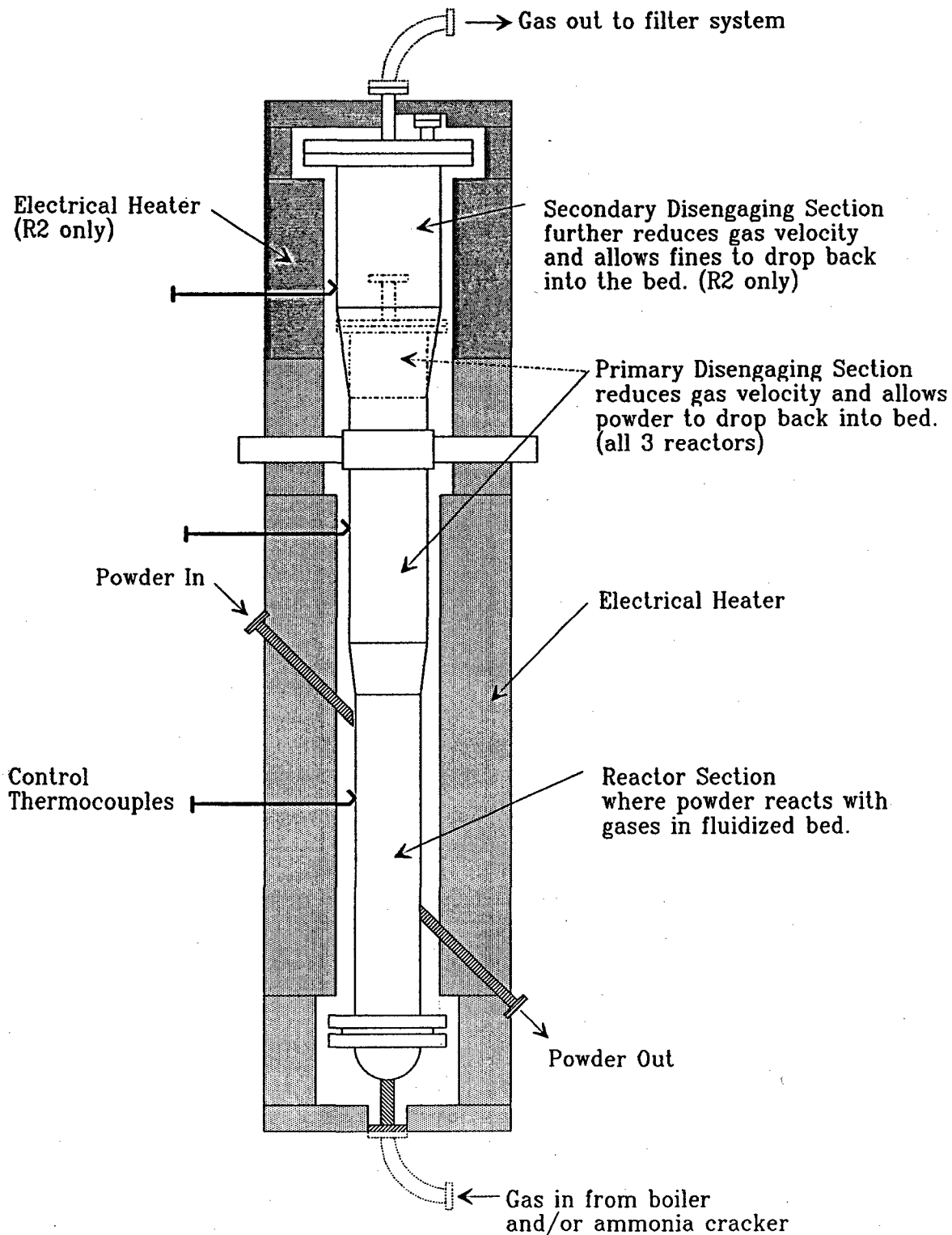

Basic Reactor & Furnace Schematic

License No. SNM-33, Docket 70-36

Revision: 0
(new figure)

Date: 1/19/89
Page: II.9-4a

HEMATITE LICENSE ACTIVITIES

<u>LICENSE AMENDMENT APPLICATION</u>	<u>SUBMIT TO NRC</u>	<u>APPROVED BY NRC</u>	<u>COMMENTS</u>
CONSTRUCTION	09/30/88	10/14/88	
-RELEASE PELLET BLDG SLAB	12/12/88	02/24/89	
-19- -RELEASE UTILITY BLDG SLAB	(07/10/89)	(08/21/89)	TO POUR FLOOR SLAB RELEASE
CONVERSION CHANGE	02/10/89	(06/01/89)	NEEDS NRC ACTION ASAP
ENVIRONMENTAL	03/23/89	(06/15/89)	NRC ACTION NEEDED
DEPLETED STARTUP	03/07/89	(06/15/89)	NRC ACTION NEEDED
PRODUCTION STARTUP	(05/01/89)	(09-01-89)	
LICENSE RENEWAL	(11/89)	(OPEN)	DEFERRED FROM 11/88

CE/NRC CRITICAL ISSUE

AUGUST 1 DECISION TO SHIP BACKUP SINTERING FURNACE FROM WINDSOR TO HEMATITE DEPENDS ON:

- 1) ALL NEW EQUIPMENT ON HAND FOR LINE 1
- 2) NEW PRESS PROCESS DONE & DEMONSTRATED
- 3) PROBABLE APPROVAL OF PRODUCTION LICENSE BY
SEPTEMBER 1, 1989

-13-

- 41 -

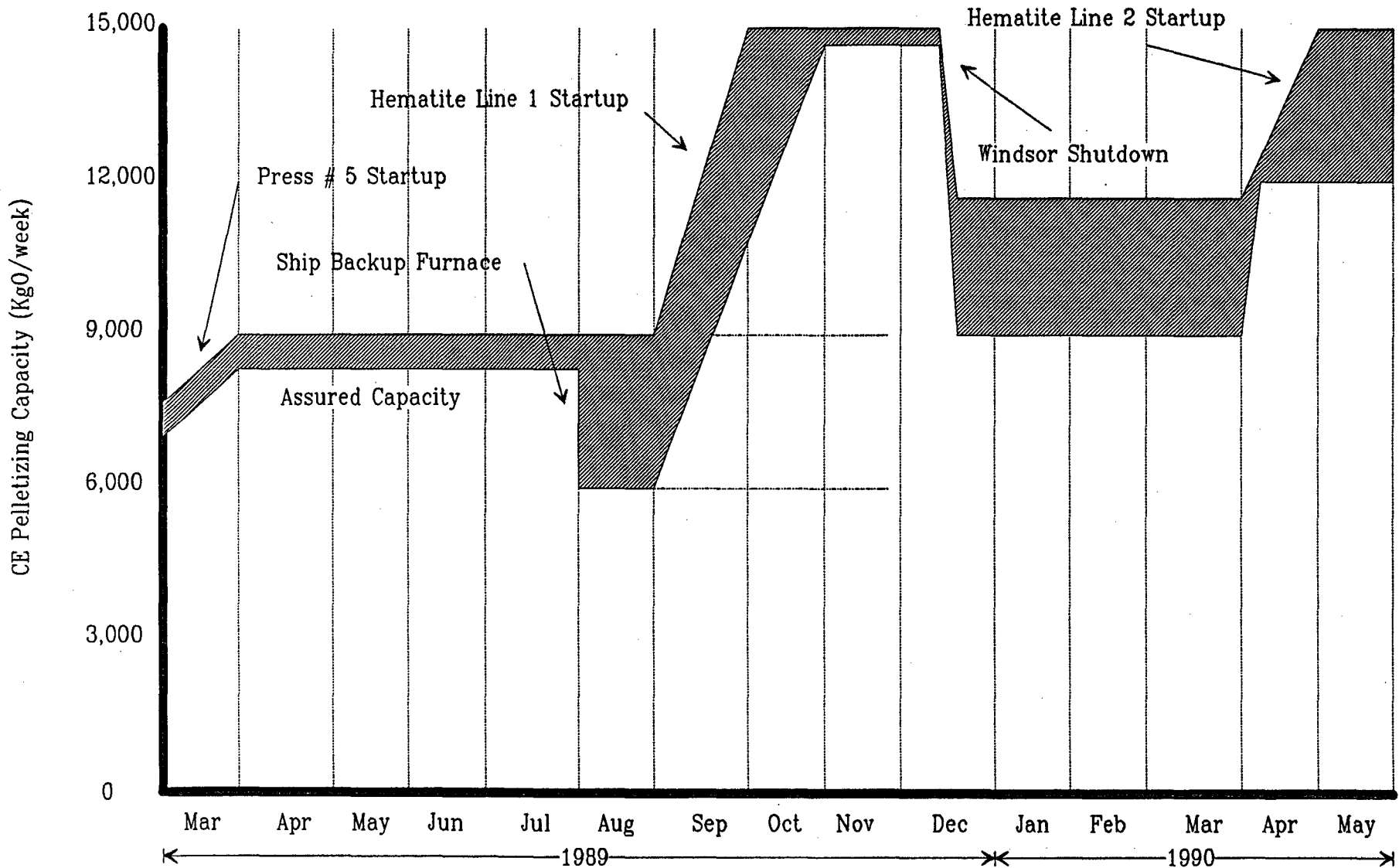

D. R. Rohde

New Pellet Production Transition Plan
Case 2. - Ship Furnace 8-1-89, Shutdown Windsor 12-15-89

-15-

